

We are committed to providing [accessible customer service](#).

If you need accessible formats or communications supports, please [contact us](#).

Nous tenons à améliorer [l'accessibilité des services à la clientèle](#).

Si vous avez besoin de formats accessibles ou d'aide à la communication, veuillez [nous contacter](#).

Technical Report for the

T.L.B. Mine

Completed on July 29, 2022.

Written By Terry Barlow (10000843)

For Terry Barlow (10000843)

Claim #'s

- 604501, 604502, 604503

• Work was performed By myself Terry Barlow as well as.

- Charleen Wright - (witness)

Route of travel,

Heading east out of Manitowadge, on Manitow RD. pass GECO Bridge turn Right on to camp #70 RD. pass thru northern logging Carry on for 24 kilometers to field Lake RD. Turn Right, travel 1.75 Kilometers, Claim Begins. #2 Kilometer sign is on the left there after Carry on RD curves to the left #3 Kilometer sign is on the Right, you are now exiting the claim. Travel thru the claim was Done on foot.

77° 13' 07" N

85° 33' 27" W

77° 13' 06" N

85° 33' 15" W

77° 13' 05" N

85° 33' 20" W

77° 13' 13" N

85° 33' 40" W

no samples sent in last 2 days

Days in the field...

- July 6/21 - Run sluice + pan N/E creek #604503.
* $49^{\circ}13'12.40''$ N. - $85^{\circ}33'04.13''$ W.
- July 27/21 - Metal Detecting - Stripping moss
#604502, 604503, South.
- Aug 9/21 - more research East creek, cut Bush trail
+ Ribbon tape.
- Sept. 7/21 - Metal Detect + Research north side
of Road. #604502 clean moss,
Chip Bedrock
- Oct 27/21 - cut Bush trail, tape west line
#604502.
- Nov. 5/21 - Collect Geo specimens from pit.
pan in creek
 $49^{\circ}13'08.51''$ N. - $85^{\circ}33'25.40''$ W. (sample)
 $49^{\circ}13'05.75''$ N. - $85^{\circ}33'26.04''$ W. (panning)
- Close up camp for season
- MAY 15/22 - open camp, check claims
after a long winter.

- Grass Roots Prospecting.

Bush Wacking, tearing moss, Chipping Rock,
Metal detecting. Test panning & sluicing
in creeks. following up on the previous
years work. collecting samples.

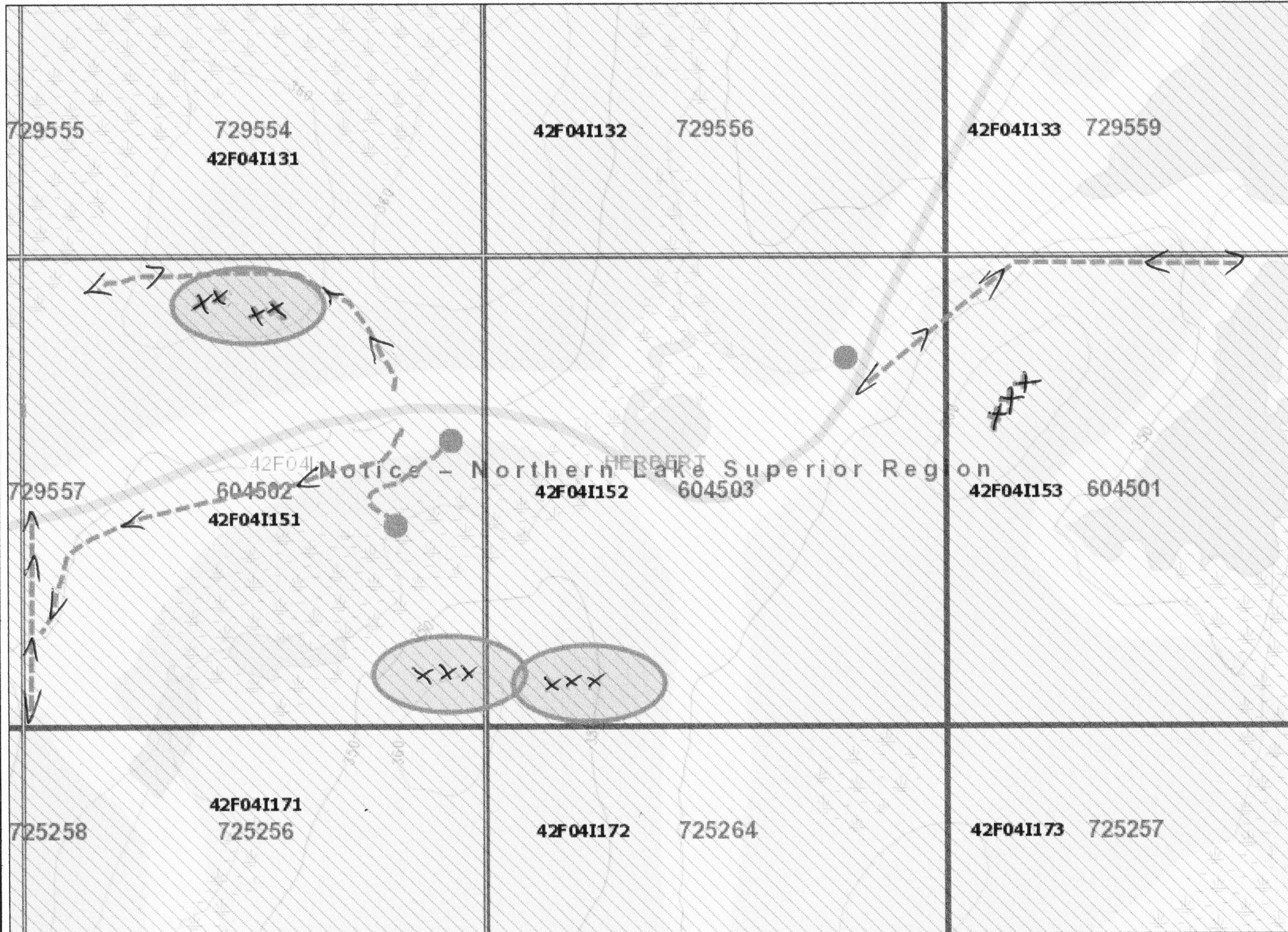

Legend

- Provincial Grid Cell**
 - Available
 - Pending
 - Unavailable
- Mining Claim**
 - Mining Claim
 - Boundary Claim
- Alienation**
 - Withdrawal
 - Notice
- NDM Administrative Boundaries**
 - NDM Townships and Areas
 - Geographic Lot Fabric
 - UTM Grid 1K
 - UTM Grid 10K
 - Mining Division
 - Mineral Exploration and Development Region
 - CLUPA Protected Area - Far North
 - Resident Geologist District
 - Federal Land Other
 - Native Reserves
- AMIS Sites**
 - AMIS Sites
 - AMIS Features
 - Drill Hole
 - Mineral Occurrences
- MLAS Mining History**
 - Withdrawal - History
 - Notice - History
 - Mining Claim - History
 - Mining Land Tenure - History
 - Legacy Claim
- Provincial Grid**
 - Provincial Grid 250K
 - Provincial Grid 50K
 - Provincial Grid Group
- Land Tenure**
 - Surface Rights
 - Mining Rights
 - Mining and Surface Rights
 - Order-in-Council

Those wishing to register mining claims should consult with the Provincial Mining Recorders' Office of the Northern Development and Mines (NDM) for additional information on the status of the lands shown hereon. This map is not intended for navigational, survey, or land title determination purposes as the information shown on this map is compiled from various sources. Completeness and accuracy are not guaranteed. Additional information may also be obtained through the local Land Titles or Registry Office, or the Natural Resources and Forestry. The information shown is derived from digital data available in the Provincial Mining Recorders' Office at the time of downloading from the Northern Development and Mines (NDM) web site.

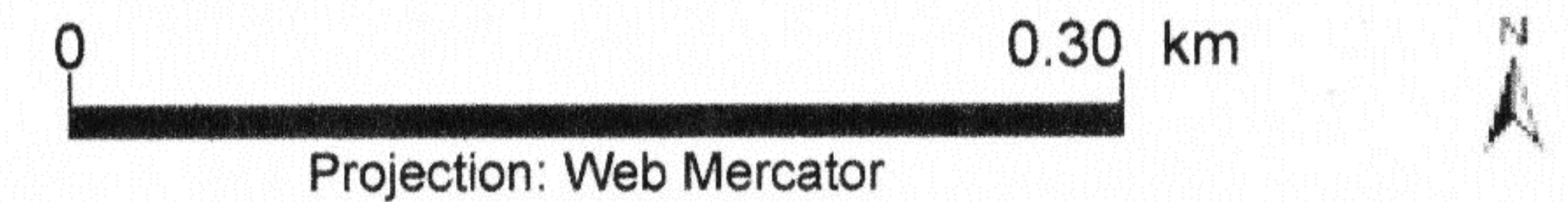

Imagery Copyright Notices: Ontario Ministry of Northern Development, Mines, Natural Resources and Forestry; NASA Landsat Program; First Base Solutions Inc.; Aéro-Photo (1961) Inc.; DigitalGlobe Inc.; U.S. Geological Survey.
© Queen's Printer for Ontario, 2022

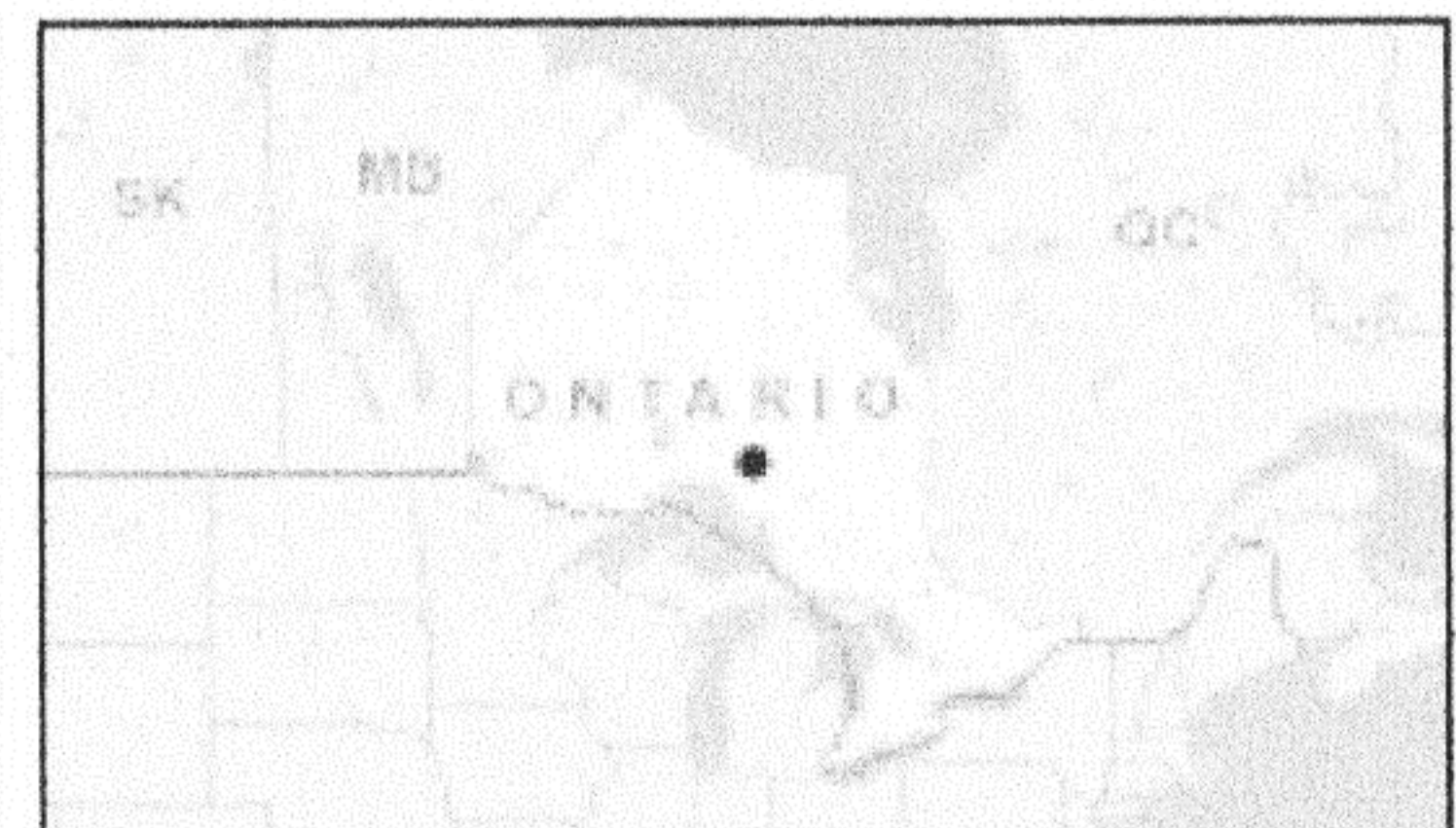

21/22

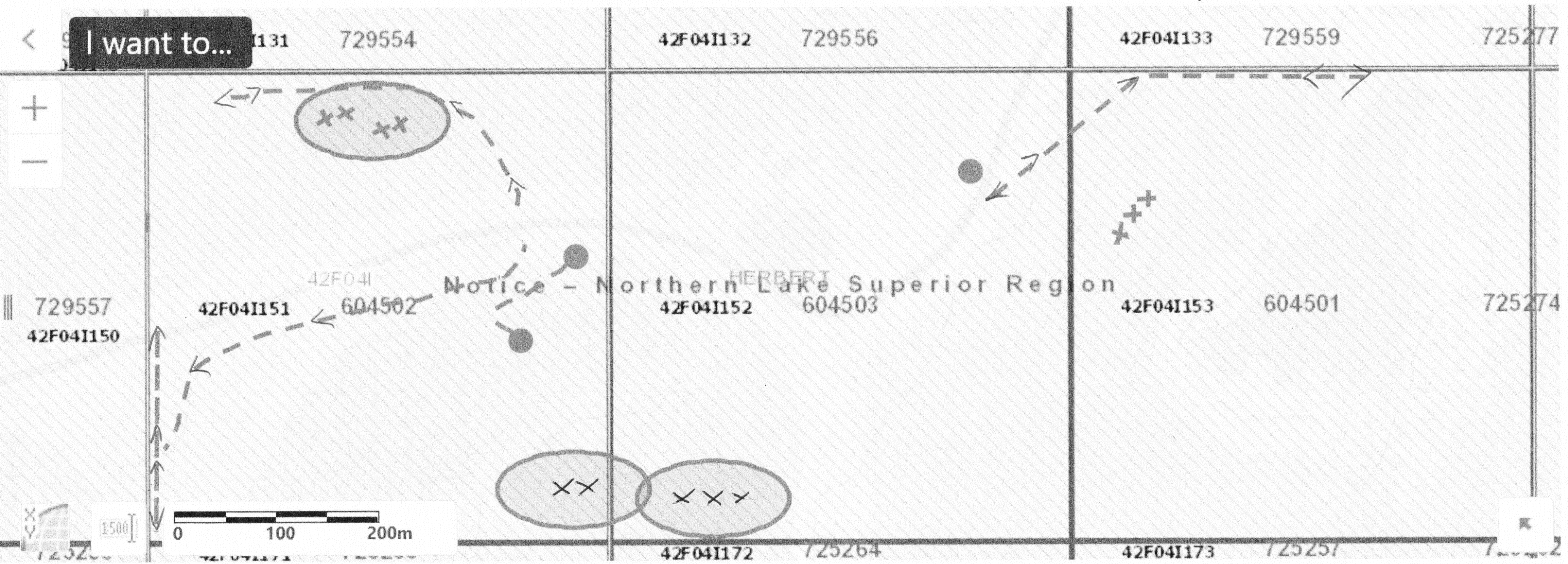

- - PAN + sluice
- ✕ - Stripping moss.
- ←- - → - Bush trail - Tape.
- (with diagonal lines) - Metal Detect.

