

We are committed to providing [accessible customer service](#).

If you need accessible formats or communications supports, please [contact us](#).

Nous tenons à améliorer [l'accessibilité des services à la clientèle](#).

Si vous avez besoin de formats accessibles ou d'aide à la communication, veuillez [nous contacter](#).

REPORT ON THE MINING CLAIM 612383,  
ABERDEN TOWNSHIP  
ALGOMA DISTRICT, ONTARIO

BY  
EVGENIY SEMINENKO, M.Sc

November, 2022

**Table of contents**

**Introduction and objectives**

**Property location and access**

**Geology**

**Current work**

**Conclusions**

**Certificate of Author**

## **Introduction and objectives**

The report was submitted on August 14, 2022 and updated accordingly notice of determination dated on November 3, 2022. See attached file.

This report covers early stage exploration work done in 2022 in mining 612383 claim located in Aberdeen Township, Sault Ste. Marie Mining Division District of Algoma, Ontario. This mining claim was registered by Evgeniy Seminenko in September 11, 2020.

The main objective is find similar Au-Cu mineralization discovered in Kirk Gold Prospect in 1919 and confirmed in 2021 in adjacent mining claim 562417. See picture 1 bellow.

Picture 1

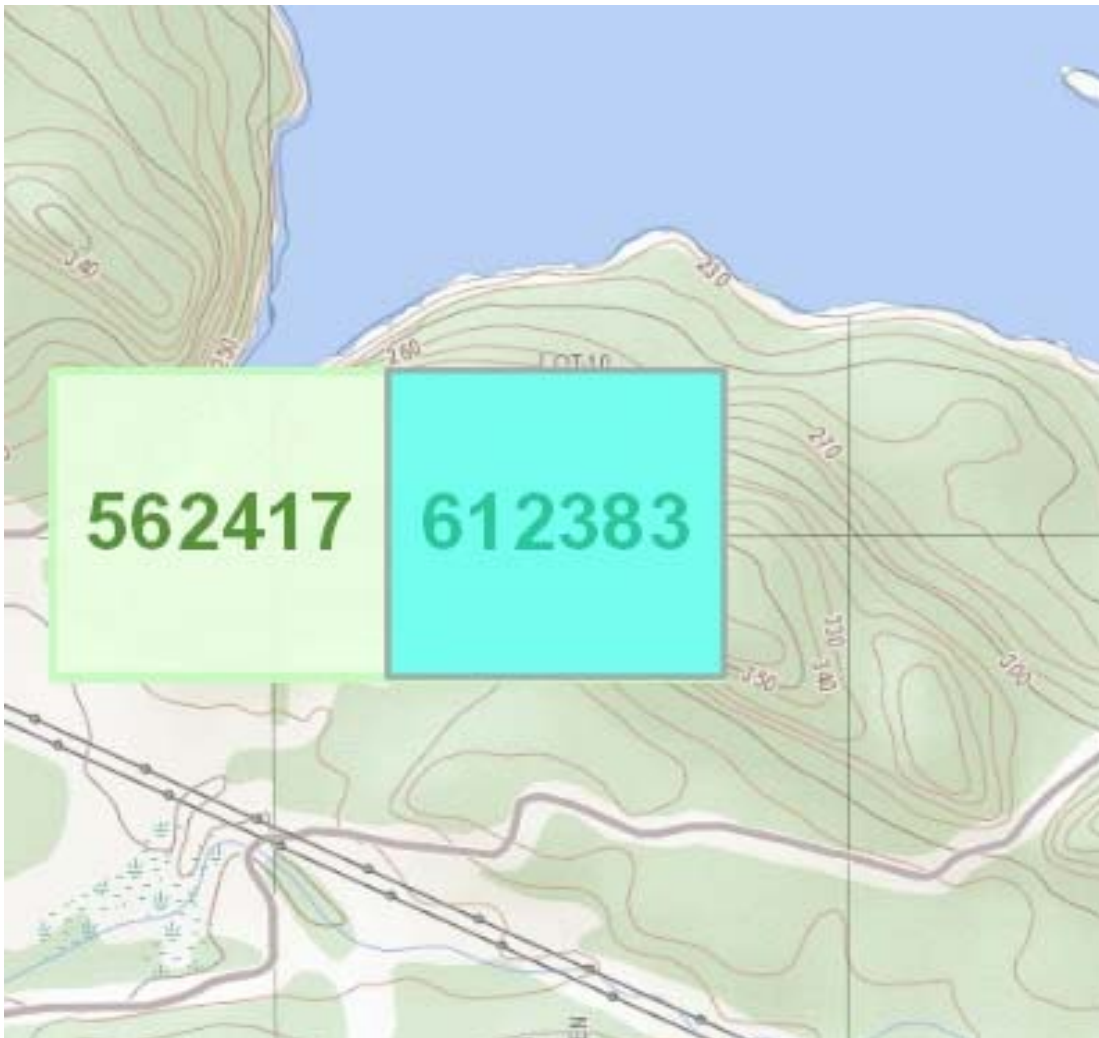

## Property location and access

The Mining claim 612383 located in North-West Ontario. The nearest town is Bruce Mine. From the HW 17 you have to turn to Centre Line Rd than turn to the west of HW 638 after turn to the Bass Lake Rd and follow 3.5 km to the north. See picture 2.

Picture 2

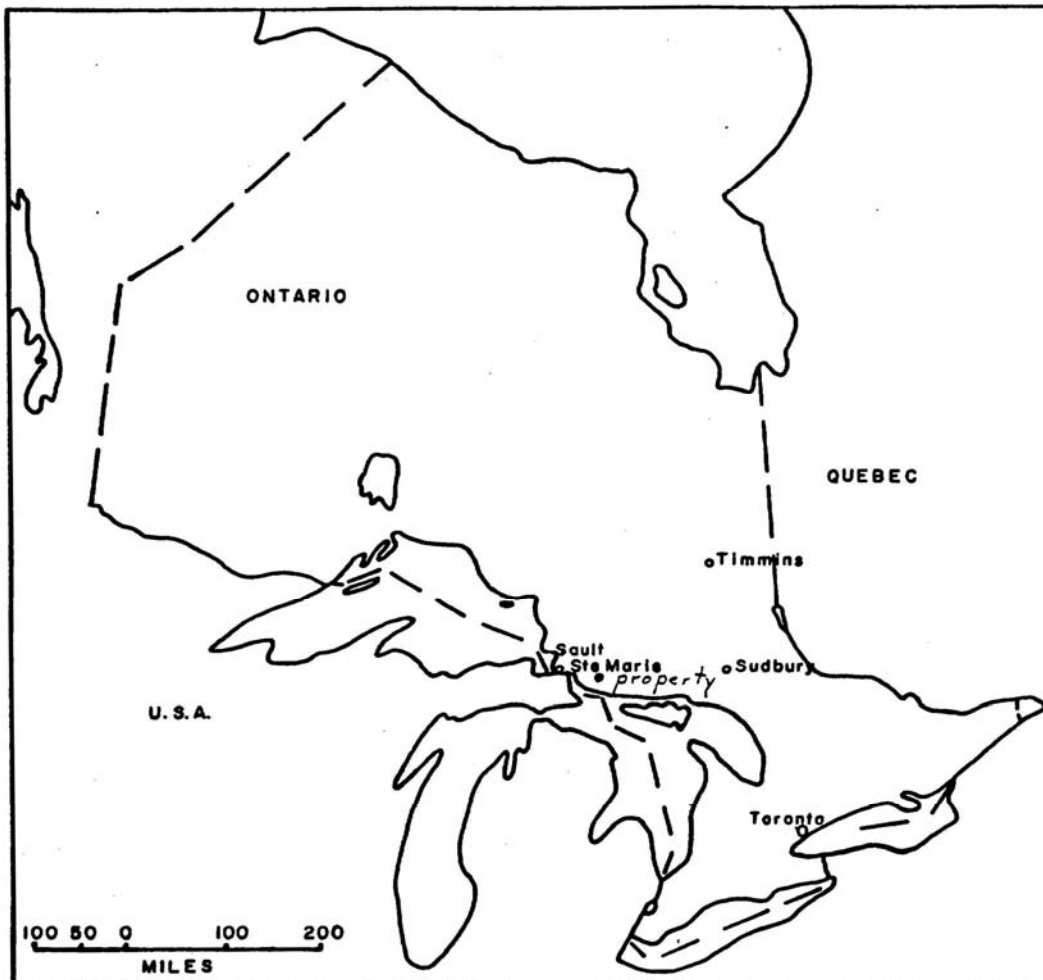

## **Geology:**

Nipissing diabase with granophyres phases has been intruded as an elongated body, probably a sill along the approximate contact between the Mississauga quartzite and the Espanola limestone formation. Within the diabase is quartz-carbonate vein which appears to strike and dip conformably with the stratigraphy.

## **Current work**

During recent exploration work in 2022 ten outcrop samples in Mining Claim 612383 were collected. See daily log, daily log map and GPS images as attached files.

## **Conclusions**

The results of recent exploration work in this mining claim were disappointed. No any mineralized rock was finding. Anyway this area is potential for the new discovery and needs further researching.

## **Certificate of Author**

I, E. Seminenko, reside at home address 176 Simpson Ave, Toronto, ON, M8Z 1E3 hereby certify that:

1. I am graduated Tomsk Polytechnic Institute, Geological Prospecting Faculty, city of Tomsk, Siberia with M.Sc. in Geological Engineering in 1991. My diploma was granted by University of Toronto, Ontario as B.Sc. in Geological Engineering (Equivalency) in 2006.
2. I am a Canadian citizen.
3. I have practiced my profession over 30 years.

**Daily Log in Aberdeen twp. Mining claim 612383**

UTM Zone 17 North

Date	Sample №	East	North	Elevation	Rock type
17-Nov-22	_001	284208	5153209	301	Diabase outcrop
17-Nov-22	_002	284283	5153202	311	Diabase outcrop
17-Nov-22	_003	284412	5153217	341	Diabase outcrop
17-Nov-22	_004	284518	5153209	328	Diabase outcrop
17-Nov-22	_005	284647	5153205	329	Diabase outcrop
17-Nov-22	_009	284494	5153305	297	Diabase outcrop
17-Nov-22	_010	284523	5153232	310	Diabase outcrop
18-Nov-22	_006	284209	5153303	323	Diabase outcrop
18-Nov-22	_007	284271	5153291	342	Diabase outcrop
18-Nov-22	_008	284412	5153301	320	Diabase outcrop.

Mining claim 612383 GPS images, November 2022.

Sample: 001



Sample: 002





Sample: 003



Sample: 004



Sample: 005



Sample: 006



Sample: 007



Sample: 008





Sample: 009



Sample: 010







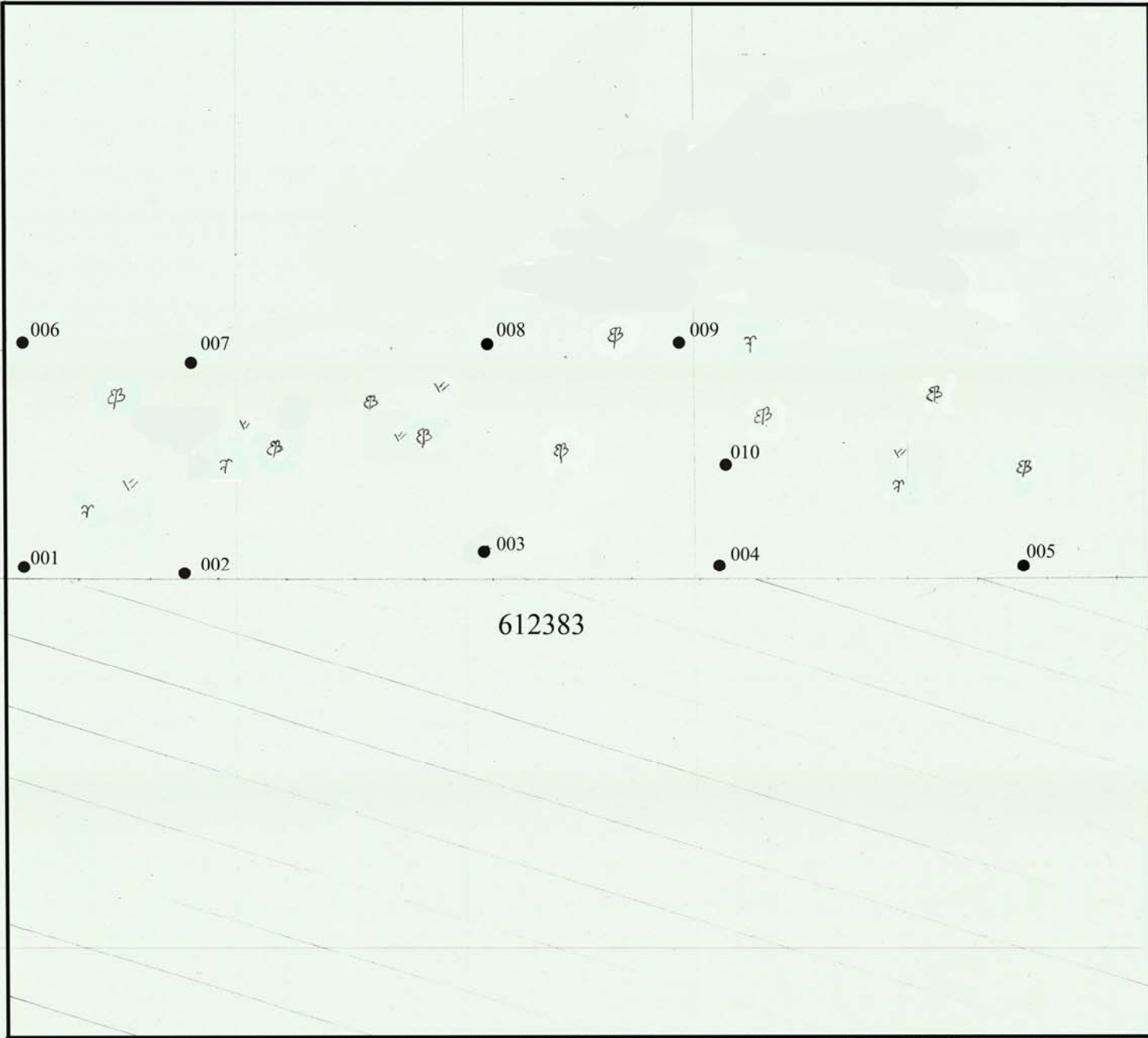

284200 284300 284400 284500 284600 284700

5153450  
5153400  
5153300  
5153200  
5153100  
5153000



LEGEND

-  Mining and Surface Rights
-  Mixed Harwood Forest: Estern white cedar, Black spruce, White pine, Mountain and Wite ash, Willow, Birch, Sugar maple, Trembling aspen, Oak, Beech
-  Shrabs: Elderberry, Sumac, Rasperry, Honeysuckle
-  Verios type of grasses, Ferns, Wild flowers

-  001 Diabase outcrop samples
-  002

612383

CLAIM 612383

Aberdeen Township, Algoma District



Scale 1: 1.000

1 Centimeter = 10 Meters



NAD 83 UTM ZONE 17 N