

We are committed to providing [accessible customer service](#).

If you need accessible formats or communications supports, please [contact us](#).

Nous tenons à améliorer [l'accessibilité des services à la clientèle](#).

Si vous avez besoin de formats accessibles ou d'aide à la communication, veuillez [nous contacter](#).

Witchbay Assessment Report, Witchbay Claims completed May 27, 2022 by Doug Bundy

The claims are located in Code Twp. Provincial Grid 52E09 and are accessible off Hwy. 71 South and East of Kenora about 20K

Turn West on Witchbay Rd. about 5k, Witchbay Rd. is a good Rd. and most of the claims can be reached on foot after the 5K drive in a half ton

The claim owners are Doug Bundy, Dave Burt, Jon Burt and Bob Etherington. Work was performed by Doug Bundy and Dave Burt

2022 Assessment Report (May, June, July) Doug Bundy and Dave Burt (Prospectors) We started the work in early may by cutting the fallen winter trees and brush (this IS NOT) included in the assessment work. We decided to spend some time at the under worked claims to prove some of the grab sample gatherings from years past. We Met at Claim #612166 on the Northwest corner, May 13, 2022. We went East on the North line until we came to claim #101745 then we turned South to claim# 555076 then turned West and back to the powerline. We spent some time on both sides of the powerline because alot of the outcrops were exposed by the line construction and the vegetation had since grown back but was easily set aside. This area hasn't had alot of prospecting done but shows enough promise to spend some time there. Because of the extremely high water this year we had trouble staying on high ground and it made some areas impassable. We did find a very large quartz vein (3 meters wide) it looks like "Bullquartz" with no mineralization. Just to the North we ran into alot of granite that appears to run the same direction as the mineralized outcrops to the south of the granite. We found a similar Bullquartz vein at the old Beck shaft years ago that had good quartz close by so we marked this as an area that deserves more attention with plans to return again this summer.

May 14, 2022 Dave and I met at claim #612996 on Witchbay Rd. and decided that we would try and access Claim # 612169 from the North line of claim #612996 we ran into high water and couldn't get to it. We decided that we should access from the patented claim at the Triggs discovery. We were able to access claim # 612169 from there and had high ground from the West side of the claim until we again ran into flooding from the rain, melted snow and beaver dams. We prospected the West half of the claim as the East half of the claim as still under water.

May 15, 2022 Dave and I met again at claim # 612169 and decided to look at the quartz veins to see if we could remove the old growth and further expose the length of the vein system. We found the quartz veins looked really good but after uncovering the quartz we found it to dip and were unable to find any length to the veins, we marked the area and planned to return for channell cuts and grab samples for assays at a later date after we had prioritized the entire project as to where we wanted to spend the time and moey..

May 16, 2022 (No Work)

May 17, 2022 Dave and I met on Witchbay Rd. and decided we would prospect on claim # 612166. We started at the Northwest corner and prospected on the North line going East then turning South until we arrived at the Northeast corner of claim # 55076 we then turned back to the West until we came back to the powerline and looked at the many outcrops on both sides of the powerline. We spent the rest of the day here and decided to spend more time on this claim and claim # 555076 to the south as they are easy to access on foot and also with the backhoe for overburden removal under our permit # PR-20-000328 at a later date.

/

May 18, 2022 (No work)

May 19, 2022 Dave and I met at claim # 612166 again and decided to spend another day prospecting on this claim. We found some well mineralized outcrops and some evidence of past shallow pits that had been done in the past years (Probably some of the workings by Ed Robecki) Ed had worked this area in 70's and 80's and even had a camp set up at the Stella showing to the West. We flagged some of the areas for "grab samples" later and figured we would come back to open up the most mineralized findings for channel cuts when a total evaluation has been done on the entire prospecting areas done on this report. The further West we went the more mineralized outcrops were found with lots of pyrites and sulfides. Some of the rocks that we found on the edges of the old pits showed an extreme amounts of minerals, so we decided this would be a major point to look at and work for extensions in the future.

May 20 2022 brought rain and threats of rain so we decided to finish prospecting claim # 612166 and then claim # 555076 to the south as this claim shows much promise with heavy mineralizations. We found some old trenching and pits on this claim (555076) The claims are close to the truck so we could get out of any rain that was threatening us. We did mark some mineralization outcrops for stripping to gain length and width to the quartz that seems to be plentiful and easy to get the backhoe into. .

May 22, 2022 We met at Witchbay Rd. and went to claim # 612172 via ATV and foot starting at the Southeast corner of the claim and proceeded North on the East line finding many points of interest along the way and again marked the areas for future sampling and exposure. We went West after arriving at at the corner of claim # 612172 and 166285 but ran into floodings and could only go to the West a short distance so we had to head back to the south to find high ground to continue the prospecting on the Western portion of claim # 612172. With plans to return tomorrow..

May 23 2022 We did find high enough ground yesterday to continue prospecting to the West and arrived at the East line of claim # 539397 then we turned North and prospected until we ran into high water again, We then turned back to the East looking at more outcrops of promise before returning to the ATVs .

May 24, 2022 No Work

May 25, 2022 Dave met me at the old Triggs showing with plans to prospect claim # 612170, . We have extensive work and history of the Triggs but haven't spent alot of time prospecting the area East of the Triggs.. We found several quartz veins that came to surface all the way East to the north shore of Gibi lake. We then decided that we would pause prospecting on claim# 61270 and devote more time to the claims that showed the most minerals (Claims # 612166, 612165 and 555076)

May 26, 2022 We decided to go to claim # 612166 again and do some hand stripping to prepare for extending the vein exposure and for future washing and channel cuts later this

summer under the recently approved exploration permit. We did find the targets we are looking for and will return later.

May 27, 2022 We then decided to head to the Kite lake showings to prospect claims 612165 and claim #612164 that we recently acquired from the Pacific Iron Co. The historic records show at least 4 pits in this area. We went to the diggings and found large rocks stacked around the edges that were full of pyrite in the quartz and side rock. Some of the old assay reports are showing multiple grams and even in some reports ounces of gold. There has not been any extended exposure at this site but the visible veins at the bottom of the pits show a well mineralized quartz vein running to the West, although the pits were full of water we could still see the quartz veins. . We cricrossed to the West and found more pits with some of them at a depth of 20 feet. These pits show the same quartz veins and appear to be trending West towards the Stella Lake showing and historic works. We will bring the backhoe in to open up the existing pits to see if the heavy mineralized veins have the length that we want to see.

The summary of this report is that we found many points of interest that warrant continued prospecting for the start of the exploration permit work to follow this year. My next report on Aug. Sept and October will reflect the future findings from our prospecting ventures. We were fortunate to get as much access to the claims as we did because of the extreme water levels in the bush, hopefully the next series of reports will show more prospecting highlights.

Thank You, Doug Bundy-Dave Burt

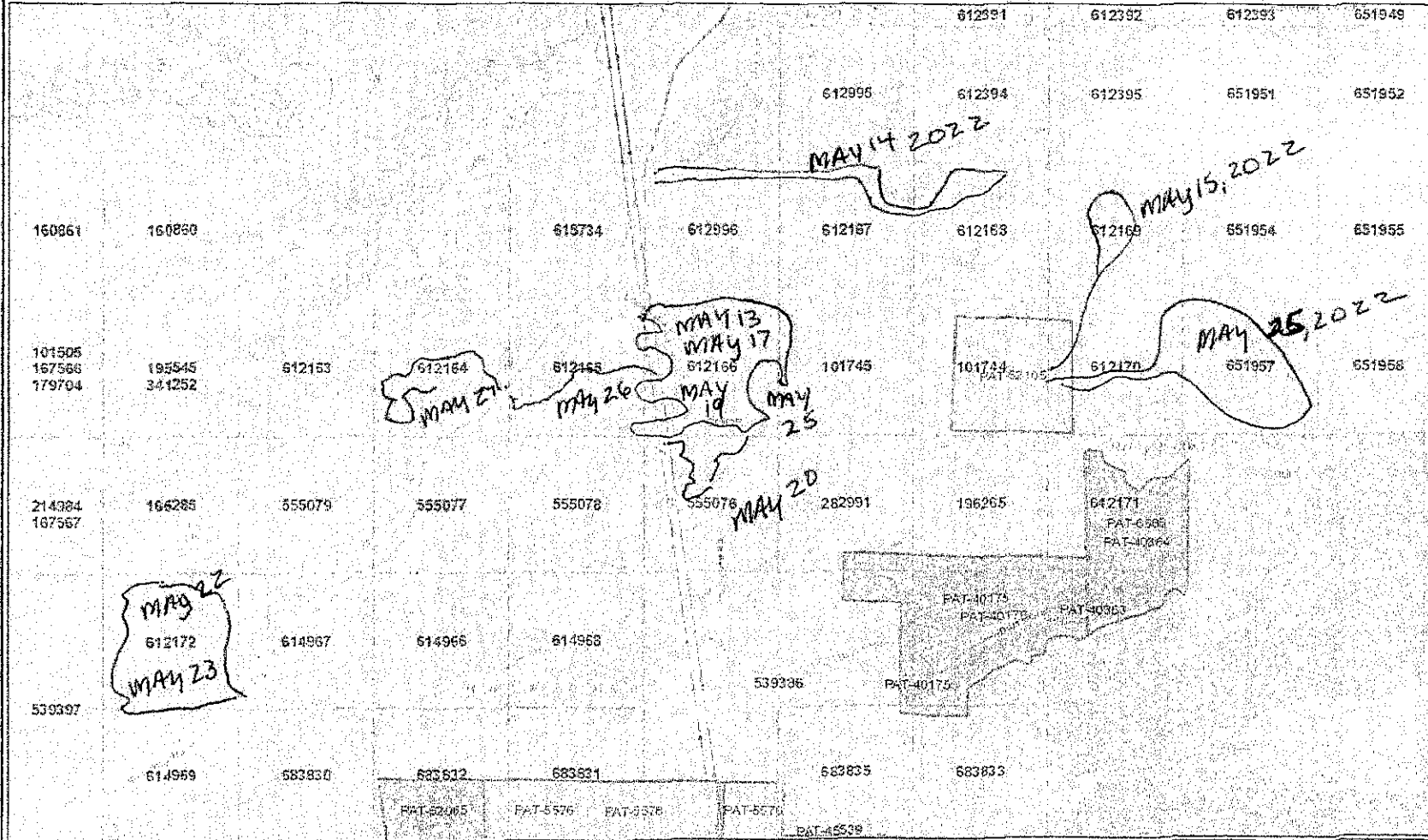

- Legend**
- Provincial Geol Call
 - Available
 - Probing
 - Unavailable
 - Mining Claims
 - Mining Claim
 - Boundary Claim
 - Abandonment
 - Withdrawal
 - Notice
 - NDM Administrative Boundaries
 - NDM Township and Areas
 - Geographic Lot Fabric
 - UTM Grid 10°
 - UTM Grid 10K
 - Mining Division
 - Mineral Exploration and Development Region
 - CULPA Protected Area - Far North
 - Residual Geological District
 - Federal Land Class
 - Nature Reserves
 - AMIS Sites
 - AMIS Features
 - Dell Hole
 - Mineral Occurrence
 - MLAS Mining History
 - Withdrawal - History
 - Notice - History
 - Mining Claim - History
 - Mining Land Tenure - History
 - Legacy Claim
 - Provincial Grid
 - Provincial Grid 25K
 - Provincial Grid 50K
 - Provincial Grid Group
 - Land Tenure
 - Surface Rights
 - Mining Right
 - Mining and Surface Rights
 - Order-in-Council



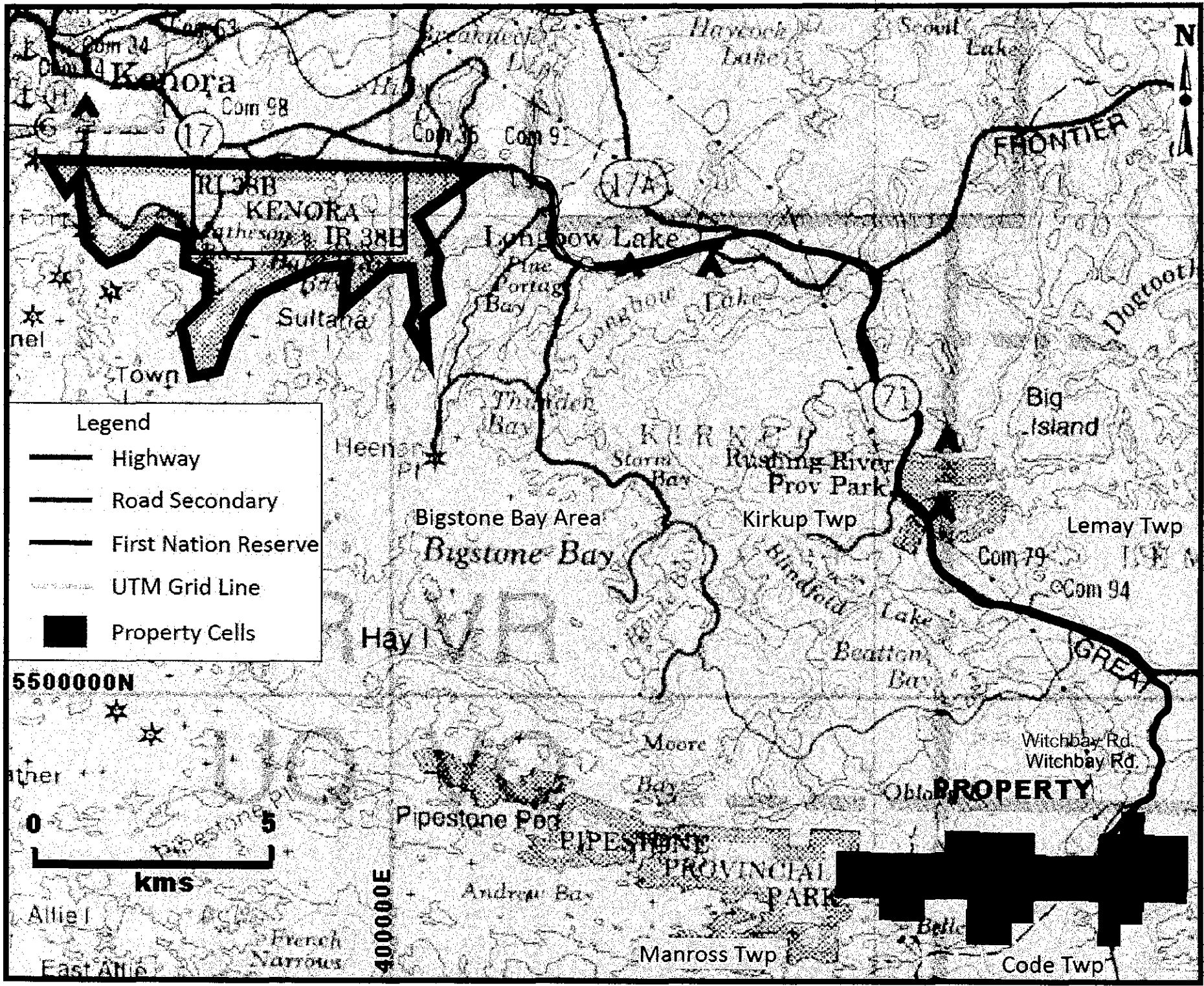

Those wishing to register mining claims should consult with the Provincial Mining Recorder's Office of the Northern Development and Mines (NDM) for additional information on the status of the lands shown hereon. This map is not intended for navigational, survey, or land title determination purposes as the information shown on this map is compiled from various sources. Completeness and accuracy are not guaranteed. Additional information may also be obtained through the local Land Titles or Registry Office, or the Natural Resources and Forestry. The information shown is derived from digital data available in the Provincial Mining Recorder's Office at the time of downloading from the Northern Development and Mines (NDM) web site.

0 0.66 km
Projection: Web Mercator
Imagery Copyright Notices: Ministry of Northern Development, Mines, Natural Resources and Forestry; NASA Landsat Program; First Base Solutions Inc.; Airo-Photo (1991) Inc.; DigitalGlobe Inc.; U.S. Geological Survey.
© Queen's Printer for Ontario, 2022.



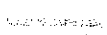

Legend

-  Highway
-  Road Secondary
-  First Nation Reserve
-  UTM Grid Line
-  Property Cells

5500000N



0 5 kms

Allie I
East Allie
French Narrows

4000000E

Pipestone Pkg
PIPESTONE PROVINCIAL PARK
Andrew Bay
Manross Twp

PROPERTY

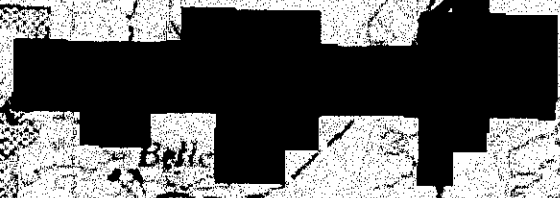

Code Twp