

We are committed to providing [accessible customer service](#).

If you need accessible formats or communications supports, please [contact us](#).

Nous tenons à améliorer [l'accessibilité des services à la clientèle](#).

Si vous avez besoin de formats accessibles ou d'aide à la communication, veuillez [nous contacter](#).

**TROUT LAKE PROPERTY PROSPECTING
RECONNAISSANCE REPORT**

For

MAGABRA RESOURCES CORPORATION

Located On

Mining Claim 585378

In The

TREELINED LAKE AREA – PLAN G-2651

KENORA MINING DIVISION - 10, ONTARIO

NTS GRID: 52L08SW

By

ALASDAIR J.M. MOWAT

Technical Mining Engineer

(---1---)

TABLE OF CONTENTS

TROUT LAKE PROPERTY PROSPECTING RESONNAISSANCE	
REPORT	1
TABLE OF CONTENTS – Report, Maps and Figure	2
A/. TROUT LAKE PROPERTY	3
1/. Ownership	3
2/. Location	3
3/. Access	3
4/. Mineral Commodities	3
5/. Regional Geology	4
6/. Property Geology	4
B/. PROPERTY VISIT	5
C/. DAILEY LOG	5-8
D/. RECOMMENDATIONS	8
E/. EXPENSES.....	8
Qualifications & Exploration Biography	9

FIGURE

Figure # 1 – LEGEND	10
---------------------------	----

MAPS

REGIONAL LOCATION MAP for TROUT LAKE PROPERTY - Map #1...	11
ACCESS & PRIMARY FOCUS AREAS TROUT LAKE PROJECT - Map #2.	12
TROUT LAKE CLAIM 585378 TRAVERSE MAP -Map #3	13

A/. TROUT LAKE PROPERTY

1/. Ownership:

-The property is 100% owned by an Ontario company Megabra Resources Corporation (client #10002588).

-The property claim number is 585378 consisting of 3 contiguous mining claim cells of about 66 hectares.

-The northeast corner of the claim is connected to the southwest corner of claim 168269 of the main Magabra claim group that hosts the Treelined Lake Graphite Occurrence.

2/. Location:

-The claim is recorded in the Treelined Lake Area (Plan G-2651), Kenora Mining (-10) and Forest Division Districts of Ontario located approximately 74 km north of Kenora (Map # 1).

-The NTS co-ordinates 52L08SW - Lat. 50 degrees, 17 minutes, 37.93 seconds North by Long. - 94 degrees, 28 minutes, 18.76 Seconds W. The 3 cells occupy cells 52L08D184, -185 and -186. The centre of the claim is located in UTM Zone 15 (NAD 83) at 395158 E by 5572343 N.

3/. Access:

The property is reach by highway #658 from Kenora to Redditt onto the English River gravel road. A distance of 75 km. Further north there is a trail on the west leading to the Treelined Graphite Occurrence. For this excursion, there is a walking trail at co-ordinate 396639 E by 5571477 N on the west side of the road. This trail leads to a boat cache on the south shore of Trout Lake (396694 E by 5571780 N). The means of travel is by boat during the warm months and by snow machine in the winter period. (Refer to Map # 2).

4/. Mineral Commodities: Graphite, Uranium and /or Thorium.

5/. Regional Geology:

The Trout Lake Property is hosted within a suite of Archean age high-grade metamorphic metasedimentary rocks (dominantly schists and gneisses) enclosed in Granitoid rocks within the English River Subprovince. The Property lies close to a major crustal boundary between the Archean English River Gneiss Belt to the north and the Archean Winnipeg River Pluton to the south. In subject property, the Separation Lake Greenstone Belt lies along the southern border of the English River Subprovince. The Trout Lake Property is located a short distance north of the Separation Lake Greenstone Belt.

6/. Property Geology:

The Trout Lake Property is located to the southwest of the Magabra's Treelined Graphite showing – 396099 E by 5572868 N. The occurrence is identified as a zone of graphite-bearing paragneisses (altered quartzites to arkose to greywacke sedimentary rocks). The “flake graphite” in the paragneisses is considered to represent the re-crystallization at the temperatures and pressures of amphibolites to granulite grade metamorphism of pre-existing “organic carbon” in the original sedimentary rocks.

Field work by the Ontario Geological Survey (OGS) and various claim holders have shown the graphite-bearing units trend +/- N 60 degrees E, dipping steeply to the southeast to vertical, exposing a zone in the order of 75 metres to 100 metres wide by trenching and sampling. The zone strike length of 1 plus kilometers is assumed to extend under the lake onto claim 585378.

Previous exploration activities by past operators consisted of prospecting; ground and airborne Mag – EM geophysical surveys mechanical and manual stripping/washing; geological mapping, rock sampling (grab and diamond saw channeling) and ore beneficiations -3. The graphite/carbon assays returned values up to 11% carbon.

(Note: The Treelined Graphite Zone has been trenched over a strike length of about 600 metres at +/- 100 metre spaced cross-cutting trenches. The zone appears to be open along strike in both southwest to northeast directions. Combining the known strike length of 600 metres with the 75 – 100 metre widths would suggest the presence of a graphite deposit with a significant tonnage potential that, at least in part, could be amenable to open pit mining. Although, it is quite unbelievable that the zone “has not been drill tested”.)

B/.PROPERTY VISIT

Three days of property visits were made on May 18, 19 and 20, 2021. The purpose of the field premier reconnaissance was twofold, as following:

1/. Locate on the island previous prospecting work reported in the OGS-MDI52L08SW00015 document. The location is designated at 395619 E by 5572429 N. (Refer to Map # 2)

2/. Prospect along the northern shore between stop GPS points # 3 to 7 for the presents of graphite believed to be an extension of the Treelined Occurrence zone located about a 1 kilometre to the northeast.

3/. The third day exploring between stop points # 8 to 11. (Refer to Map # 3)

C/. DAILY LOG

The following Stop/Station points referenced on Map # 3 are tied into the noted GPS co-ordinates located in Zone 15 (NAD 83):

#1 - 395619 E by 5572429 N (Island noted in "1" above).

#2 - 395740 E by 5572350 N (small island to the south of #1)

#3 – 395511 E by 5572384 N (main land peninsula)

#4 – 395237 E by 5572286 N

#5 – 394953 E by 5572319 N

#6 – 394900 E by 5572419 N

#7 - 394528 E by 5572373 N

#8 – 395591 E by 5572265 N

(---5---)

#9 – 395457 E by 5572281 N

#10 – 395504 E by 5572171 N

#11 – 395458 E by 5572118 N

(Note: The Geology rock units - Figure #1 – after Blackburn and Young, 2000)

1/. Day 1 – June 18, 2020:

Referencing Map # 2, left from Kenora driving north to Redditt connecting to the English River Road. At the noted Stop # 1 on the map – point GPS 396639 E by 5571477 N parked my vehicle on the west side of the road. Carried my gear and 4 HP outboard motor along the path to Trout Lake – Stop # 2. By boat, as noted on the map, worked my way over to my first primary target Stop # 4. This is the supposed site location noted in the OGS-MDI52L08SW00015 report. (Note: This is the same site spotted as # 1 on Map # 3).

Traversed the island, in detail, but did not locate the noted reported workings. The few exposed rock outcrops, I classified as unit # 6 – High grade metasedimentary rocks . . . with graphite. Refer to Figure #1 – Legend. Tight bush predominately spruce and jack pine.

Returned to the boat and proceeded southeasterly about 100 m to a small island Stop #2 on Map #3 and explored. No trenching .A few visible outcrops, as noted, classified as # 6 rock unit.

From Stop #2 Map #3, proceeded westerly along the south shore of the peninsula to Stop #5 on Map # 2 (Stop # 4 area on Map # 3). Had a quick look and checked the high rock cliff face classifying the rock unit as # 6. Due to the lateness of the day returned to the landing and Kenora.

2/. Day 2 – June 19, 2020:

Returned to Trout Lake and boated along the shore from Stops #3, 4, 5, 6, to # 7 (refer to location Map #3) stopping along the way to exam the rocks. Between Stops #3 to 4, particularly at 4, there is a steep rock face indicating a fault striking about N 55 degrees E. The rocks classified as a unit 6 with graphite as Stop # 5.

Rounding the corner to Stop # 6, the examined rock exposures would fall within geological unit 6 (Graphite present).

(---6---)

From Stop #6, following west along the shore line, boated to Stop #7. The rocks in this vicinity are a mixture of intrusive granite units and metasediments. No visible recognizable graphite.

Comment: From about Stop #3 to just past station # 4, the topography is very steep. The forest is predominately moderate mature jack pine with inclusions of spruce. Between Stations #4 to 5 a topographic valley depression occupied by a predominate spruce forest.

The topographic relief is more uniform between Stop #5 to 7 including jack pine.

There appears to be a gradual change in geological units from metasediments (unit 6) to granite (7) predominate between Stations #6 to 7.

Returned to landing and back to Kenora.

3/. Day 3 – June 20, 2020:

Boated to a shore outcrop between Station #3 and 8. The unit I classified as 6 – metasediments.

Boated to Stop #8 and beached the boat. The shore rocks fall under unit 6. Proceeded northwest in land crossing through a valley of thick mixture of bush. On reaching the summit of high ground traversed southwest to Station #9. The encountered outcrops fall under unit 6. After a walk around proceeded southeasterly back to the lake passing through the valley ending at the shore at Stop #10. The exposed rocks were more granitic placing them in category 7.

From Station #10, walked about 100 m around a rocky knoll composed of unit 7 to Station #11.

is a gradual change in rock units from mixed granitics to metasediments.

This circular inland traverse was difficult to the coniferous vegetation – blow down - and steep topographic terrain.

After returning to the boat cache, picked up the boating gear and drove back to Kenora.

Based on my three (3) days of field reconnaissance, graphite of various degrees is present in the metasediments (refer to Legend figure # 1) particularly in the surrounding area of Station #4 and 5 spotted on Map # 3. Also, there is a close similarity to the Magabra's Treelined Graphite Zone located about one kilometer to the northeast on claim 168269. The location is noted as Station # 3 on Map # 2.

One gets the sense you are dealing with very tight rhythmic isoclinal folding. At this locality due to the width of the zone and parallel faulting may represent a synclinal axis.

(---7---)

In passing, the terrain was rough in passing through the bush with remnants of blow down.

D/. RECOMMENDATIONS

SECOND PHASE:

1/. Although the focus of the reconnaissance was on outlining the graphitic zone and projected extension from the Treelined Occurrence, Uranium and Thorium are noted in the area. These commodities should be included in the next this next following stage of exploration.

2/. Magnetometer and Electromagnetic surveys are to be included. The presents of pyrrhotite assisted in outlying the Treelined Zone and additional zones to the north.

3/. Soil and/or Bio-geochemistry to be included in this program.

THIRD PHASE:

1/. Exploration Permitting.

E/. EXPENSES

3 Days of Field Work @ \$600.00 per day	\$1,800.00
2 Days of Technical Report	<u>1,200.00</u>
TOTAL	<u>\$3,000.00</u>

Report Dated: April 20th, 2022

Report By: Alasdair J. M. Mowat, Technical Mining Engineer
Magabra Resources Corp.'s Agent
Kenora, Ontario

Alasdair (Al) J. M. Mowat
Technical Mining Engineer
Kenora, Ontario P9N 3S1

54 years of exploration, management and administration experience. An honours graduate from Haileybury School of Mines ('70) receiving a Mining Engineering Technician Diploma. Registered Ontario Prospector with the provinces of Ontario ('68). Member of NWOPA, OPA, Manitoba Prospectors, WIM Thunder Bay, ON and WIM Winnipeg, MAN. The exploration/mining representative on the MNR's Kenora Local Citizens Committee (KLCC) regarding forest operations of NW Ontario.

Exploration experiences:

- Falconbridge Nickel Mines Limited (Elliot Lake and Onaping) - "U" exploration and underground mine geologist (Ni, Cu).
- Vaughan Prospecting Syndicate (Toronto) – project development for the Alaskan and U.S. A. Eastern Seaboard – Rare Earths, Ni, Au, Cu.
- Riocanex – Kirkland Lake Au projects.
- Lac Minerals Ltd. – Au exploration in Kirkland Lake, Uchi and Hemlo leading to the discovery of the Hemlo Gold Mine.
- Consolidated Professor Mines Ltd (Duport Gold Mine Property), Shoal Lake/Kenora discovered 2nd Au zone.
- Founder of Golden Terrace Resource Corporation (TSX) – Au exploration in Hemlo and Richardson Lake leading to a new Au discovery.
- Founder of Emerald Fields Resource Corporation (197). Now public company (POC.V) Pacific Iron Ore Corporation discovered "Big Mack" - Li (REM) pegmatite. Other associated property projects are St. Anthony - Au, Code - Au and Scarp Lake - Cu, Au, Ag, F, and REE.
- Officer, Director and VP of Magabra Resources Corp. (2020).

Past membership associations: Alaska Prospectors Association, Timmins Geological Discussion Group, CIM Main Branch Montreal, GAC, Ontario Geological Association (pre-P.GEO.), The U.S. Engineering and Geological Society, Toronto Engineers Club and NPA (pre-'87) and Ontario Association of Certified Engineering Technicians and Technologist (OACETT).

Dated: January 01st, 2022
Dated At: Kenora, Ontario

LEGEND – FIGURE # 1

TROUT LAKE

GRAPHITE PROPERTY

GEOLOGY LEGEND

PHANEROZOIC

CENOZOIC

QUARTERNARY

PLEISTOCENE & RECENT

Clay, sand & gravel

PRECAMBRIAN

6 Quartz-feldspar-mica schists and gneisses,
some with graphite

7(6) Mixed zone of Granitoid rocks and high
grade metasedimentary rocks

SYMBOLS

O #1 Stop / Station

===== Trail

.....>..... Traverse

x Outcrop

 Fault

 Escarpment

GPH Graphite

JP Jack Pine

----- , ----- , Geological Boundary Assumed

Ontario
 Ministry of Northern Development, Mines,
 Natural Resources and Forestry (NDMNRF)
 MLAS Map Viewer

**REGIONAL LOCATION MAP for
 TROUT LAKE PROPERTY**

Notes:

Trout Lake Magabra Resource Corp.s property (claim 585378) located in the Treelined Lake Area, Kenora Mining Division - ON, Z-15, NAD 83, 395158 E -

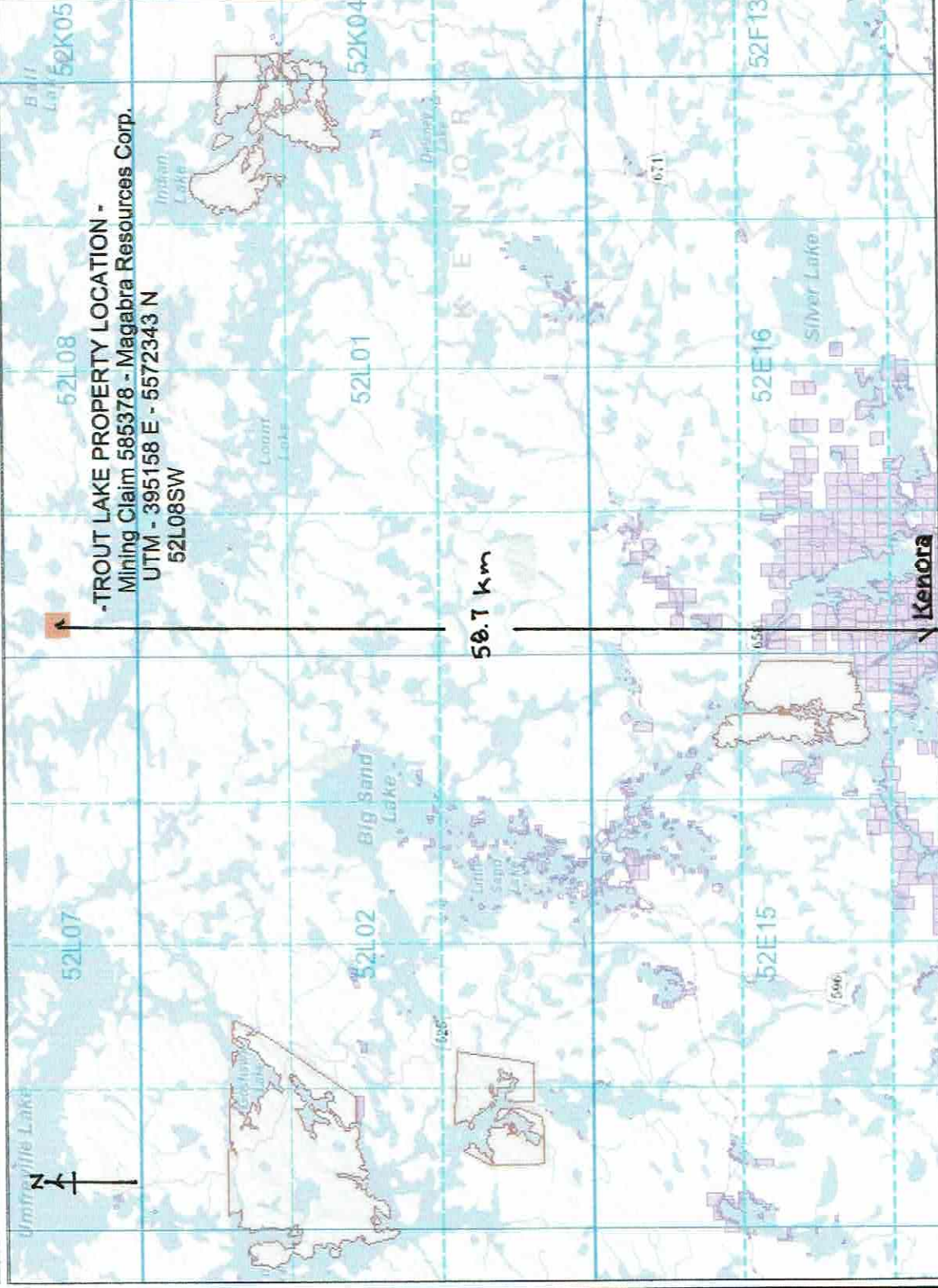

Legend

Provincial Grid Cell	Available	Withdrawal	Mineral Occurrences
Pending	Notice	MLAS Mining History	Windrowal - History
Unavailable	NDM Administrative Boundaries	Notice - History	Mining Claim - History
Mining Claim	NDM Townships and Areas	Mining Land Tenure - History	Mining Land Tenure - History
Mining Claim	Geographic Lot Fabric	Legacy Claim	Provincial Grid
Boundary Claim	UTM Grid 1K	Provincial Grid 250K	Provincial Grid 50K
Allentation	UTM Grid 10K	Provincial Grid Group	Land Tenure
Withdrawal	Mining Division	Surface Rights	Mining Rights
Notice	Mineral Exploration and Development Region	Mining and Surface Rights	Order-in-Council
NDM Administrative Boundaries	CLUPA, Pictetick Area - Fer/Noth		
NDM Townships and Areas	Resident Geologist District		
Geographic Lot Fabric	Federal Land Cher		
UTM Grid 1K	Native Reserves		
UTM Grid 10K	AMIS Sites		
Mining Division	AMIS Features		
Mineral Exploration and Development Region	Drill Hole		
CLUPA, Pictetick Area - Fer/Noth	Mineral Occurrences		
Resident Geologist District	MLAS Mining History		
Federal Land Cher	Windrowal - History		
Native Reserves	Notice - History		
AMIS Sites	Mining Claim - History		
AMIS Features	Mining Land Tenure - History		
Drill Hole	Legacy Claim		
Mineral Occurrences	Provincial Grid		
MLAS Mining History	Provincial Grid 250K		
Windrowal - History	Provincial Grid 50K		
Notice - History	Provincial Grid Group		
Mining Claim - History	Land Tenure		
Mining Land Tenure - History	Surface Rights		
Legacy Claim	Mining Rights		
Provincial Grid	Mining and Surface Rights		
Provincial Grid 250K	Order-in-Council		
Provincial Grid 50K			
Provincial Grid Group			
Land Tenure			
Surface Rights			
Mining Rights			
Mining and Surface Rights			
Order-in-Council			

Those wishing to register mining claims should consult with the Provincial Mining Recorders' Office of the Northern Development and Mines (NDM) for additional information on the status of the lands shown hereon. This map is not intended for navigational, survey, or land title determination purposes as the information shown on this map is compiled from various sources. Completeness and accuracy are not guaranteed. Additional information may also be obtained through the local Land Titles or Registry Office, or the Natural Resources and Forestry. The information shown is derived from digital data available in the Provincial Mining Recorders' Office at the time of downloading from the Northern Development and Mines (NDM) web site.

Imagery Copyright Notices: Ontario Ministry of Northern Development, Mines, Natural Resources and Forestry; NASA Landsat Program; First Base Solutions Inc.; Aéro-Photo (1981) Inc.; DigitalGlobe Inc.; U.S. Geological Survey.
 © Queen's Printer for Ontario, 2022

Scale: 0 to 18.84 km
 Projection: Web Mercator



Ontario
 Ministry of Northern Development, Mines,
 Natural Resources and Forestry (NDMNR)
 MLAS Map Viewer

**ACCESS & PRIMARY FOCUS
 AREAS TROUT LAKE
 PROJECT**

Notes:
 Trout Lake location areas noted by red dots.
 Magabra Res. Corp. claim 585378 recorded in
 Treelined Lake Area, Kenora Mining Div. - 10

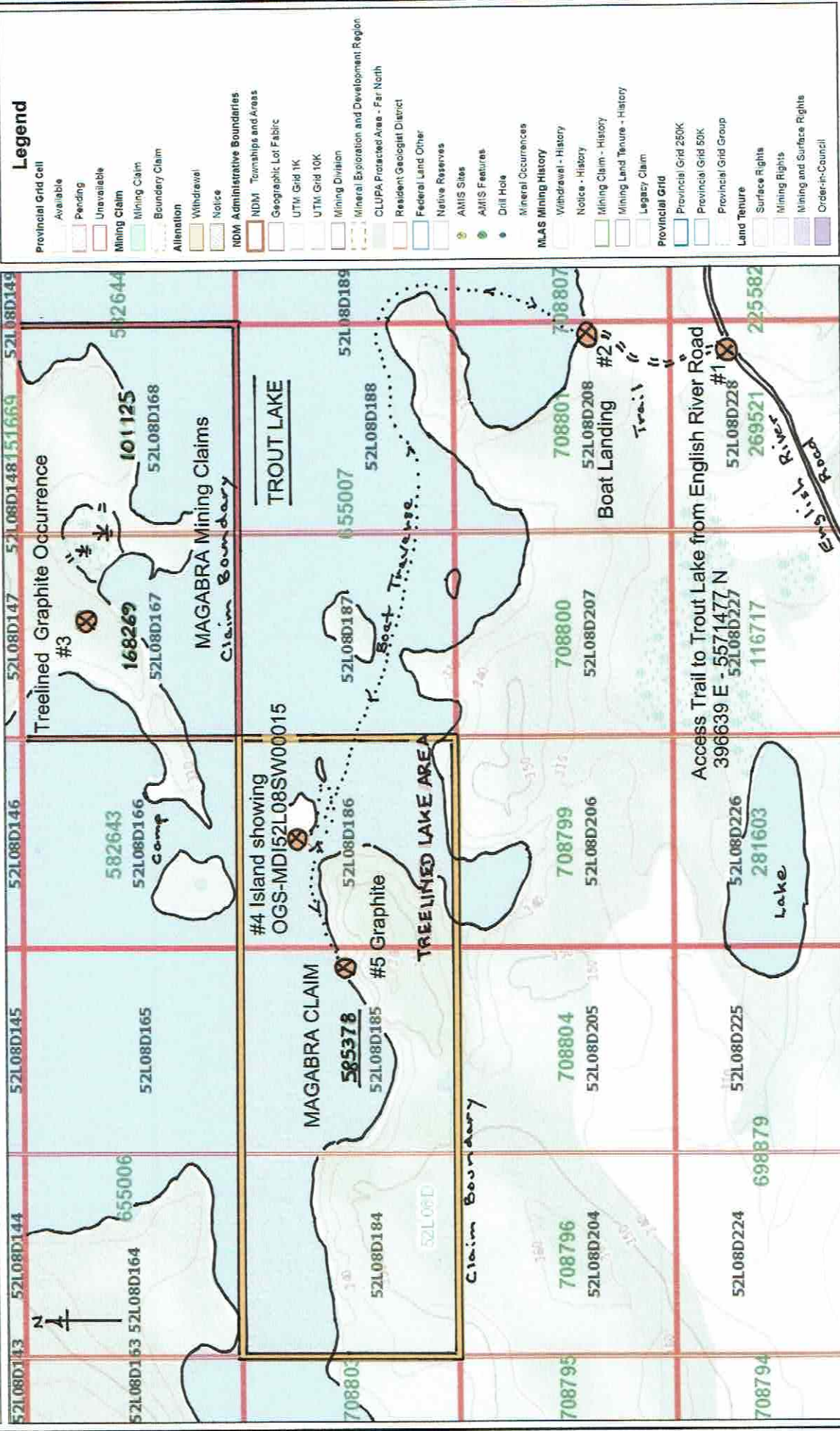

Legend

- Provincial Grid Cell
 - Available
 - Pending
 - Unavailable
- Mining Claim
 - Mining Claim
 - Boundary Claim
- Alienation
 - Withdrawal
 - Notice
- NDM Administrative Boundaries
 - NDM Townships and Areas
 - Geographic Lot Fabric
 - UTM Grid 1K
 - UTM Grid 10K
 - Mining Division
 - Mineral Exploration and Development Region
 - CLUPA Protected Area - Far North
 - Resident Geologist District
 - Federal Land Other
 - Native Reserves
 - AMIS Sites
 - AMIS Features
 - Drill Hole
 - Mineral Occurrences
- MLAS Mining History
 - Withdrawal - History
 - Notice - History
 - Mining Claim - History
 - Mining Land Tenure - History
 - Legacy Claim
- Provincial Grid
 - Provincial Grid 250K
 - Provincial Grid 50K
 - Provincial Grid Group
 - Land Tenure
 - Surface Rights
 - Mining Rights
 - Mining and Surface Rights
 - Order-in-Council



0 0.59 km
 Projection: Web Mercator

Imagery Copyright Notices: Ontario Ministry of Northern Development, Mines, Natural Resources and Forestry; NASA Landsat Program; First Base Solutions Inc.; Aéro-Photo (1981) Inc.; DigitalGlobe Inc.; U.S. Geological Survey.

© Queen's Printer for Ontario, 2022

Those wishing to register mining claims should consult with the Provincial Mining Recorders' Office of the Northern Development and Mines (NDM) for additional information on the status of the lands shown hereon. This map is not intended for navigational, survey, or land title determination purposes as the information shown on this map is compiled from various sources. Completeness and accuracy are not guaranteed. Additional information may also be obtained through the local Land Titles or Registry Office, or the Natural Resources and Forestry. The information shown is derived from digital data available in the Provincial Mining Recorders' Office at the time of downloading from the Northern Development and Mines (NDM) web site.

Ontario
 Ministry of Northern Development, Mines,
 Natural Resources and Forestry (NDMNRF)
 MLAS Map Viewer

TROUT LAKE CLAIM 585378 TRAVERSE MAP

Notes:
 Magabra Res. Corp. mining claim 585378 property
 traverses Claim recorded in Treelined Lake Area,
 Kenora Mining Division - ON.

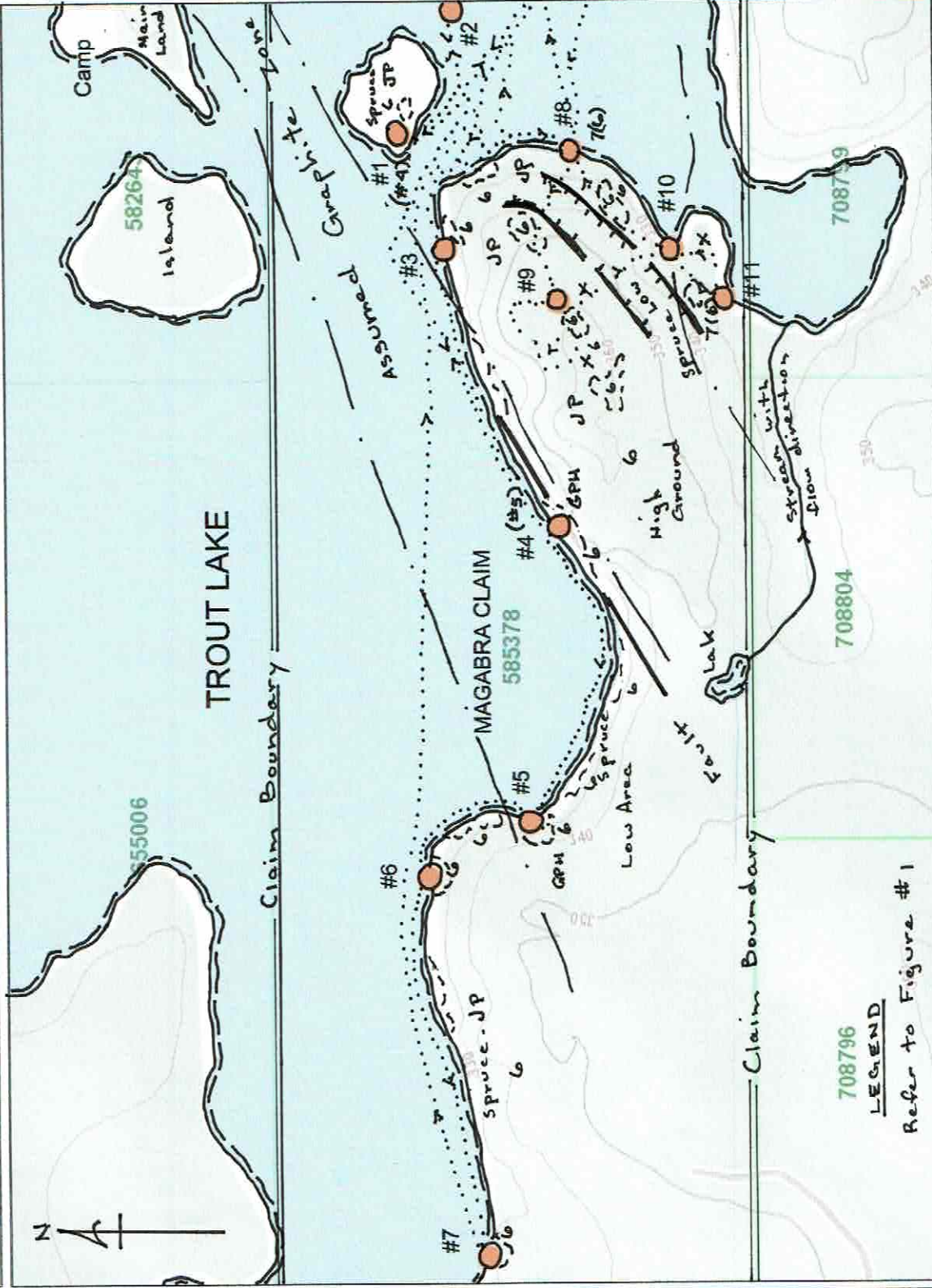

Legend

- Provincial Grid Cell
 - Available
 - Pending
 - Unavailable
- Mining Claim
 - Mining Claim
 - Boundary Claim
- Alienation
 - Withdrawal
 - Notice
- NDM Administrative Boundaries
 - NDM Townships and Areas
 - Geographic Lot Fabric
 - UTM Grid 1K
 - UTM Grid 10K
 - Mining Division
 - Mineral Exploration and Development Region
 - CLUPA Protected Area - Far North
 - Resident Geologist District
 - Federal Land Other
 - Native Reserves
 - AMIS Sites
 - AMIS Features
 - Drill Hole
 - Mineral Occurrences
 - MLAS Mining History
 - Withdrawal - History
 - Notice - History
 - Mining Claim - History
 - Mining Land Tenure - History
 - Legacy Claim
- Provincial Grid
 - Provincial Grid 260K
 - Provincial Grid 50K
 - Provincial Grid Group
- Land Tenure
 - Surface Rights
 - Mining Rights
 - Mining and Surface Rights
 - Order-in-Council



708796
LEGEND
 Refer to Figure # 1

Those wishing to register mining claims should consult with the Provincial Mining Recorders' Office of the Northern Development and Mines (NDM) for additional information on the status of the lands shown hereon. This map is not intended for navigational, survey, or land title determination purposes as the information shown on this map is compiled from various sources. Completeness and accuracy are not guaranteed. Additional information may also be obtained through the local Land Titles or Registry Office, or the Natural Resources and Forestry. The information shown is derived from digital data available in the Provincial Mining Recorders' Office at the time of downloading from the Northern Development and Mines (NDM) web site.

Imagery Copyright Notices: Ontario Ministry of Northern Development, Mines,
 Natural Resources and Forestry; NASA Landsat Program; First Base Solutions Inc.;
 Aéro-Photo (1961) Inc.; DigitalGlobe Inc.; U.S. Geological Survey.
 © Queen's Printer for Ontario, 2022