

We are committed to providing [accessible customer service](#).

If you need accessible formats or communications supports, please [contact us](#).

Nous tenons à améliorer [l'accessibilité des services à la clientèle](#).

Si vous avez besoin de formats accessibles ou d'aide à la communication, veuillez [nous contacter](#).

# Assessment Report

Prepared by: Jean-Pierre Ouellette

---



Glackmeyer Property

Mining Claim # 615031

Dated September 22, 2022

The single cell unit claim # 615031 was explored by myself and my spouse assisting in September and October 2020. The property features an outcrop near the concession road 2&3 in Glackmeyer Township, Cochrane Ontario. The property is vacant of any buildings or improvements and is Crown land. Several samples were collected from the outcrop at various locations and mapped for my reference.

Having no geological training or background, I have attempted to interpret the Technical Standards for reporting Assessment Work (version 2 – July 5, 2018) and would appreciate any insight into this report or what this data might represent (officially or unofficially).

This key map shows the location of the claim and access is by way of Concession 2&3 Glackmeyer Township in the Town of Cochrane, population 5,000.

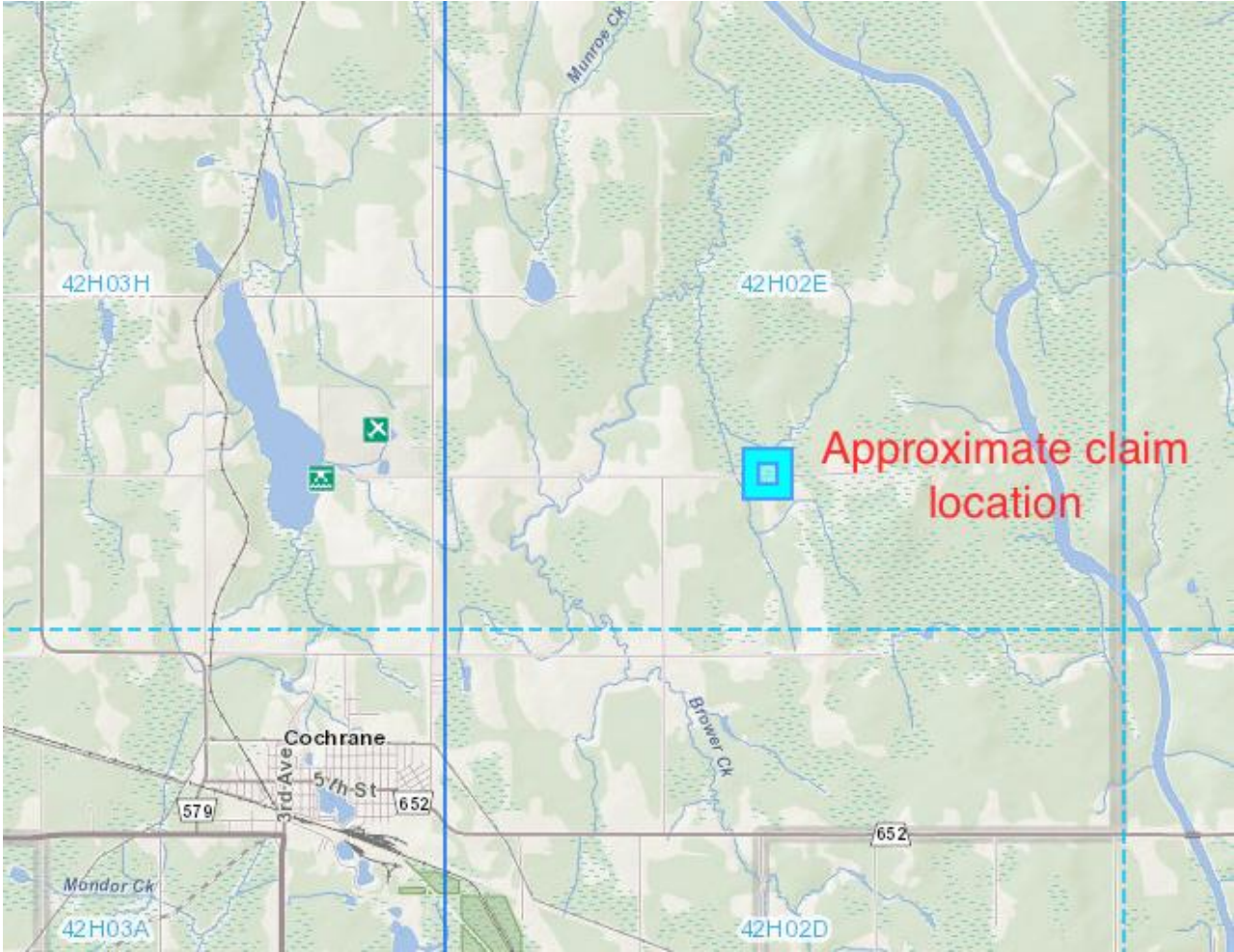

Grassroots prospecting performed at the site is found by following the outcrop northerly from the concession road by foot, along the rock outcrop which is quite evident as the concession crests to the top of a hill. Following the outcrop northerly as far as it goes within the boundary of the mining claim.

Airborne Magnetic Gradiometer and Gamma Spectrometric Surveys:

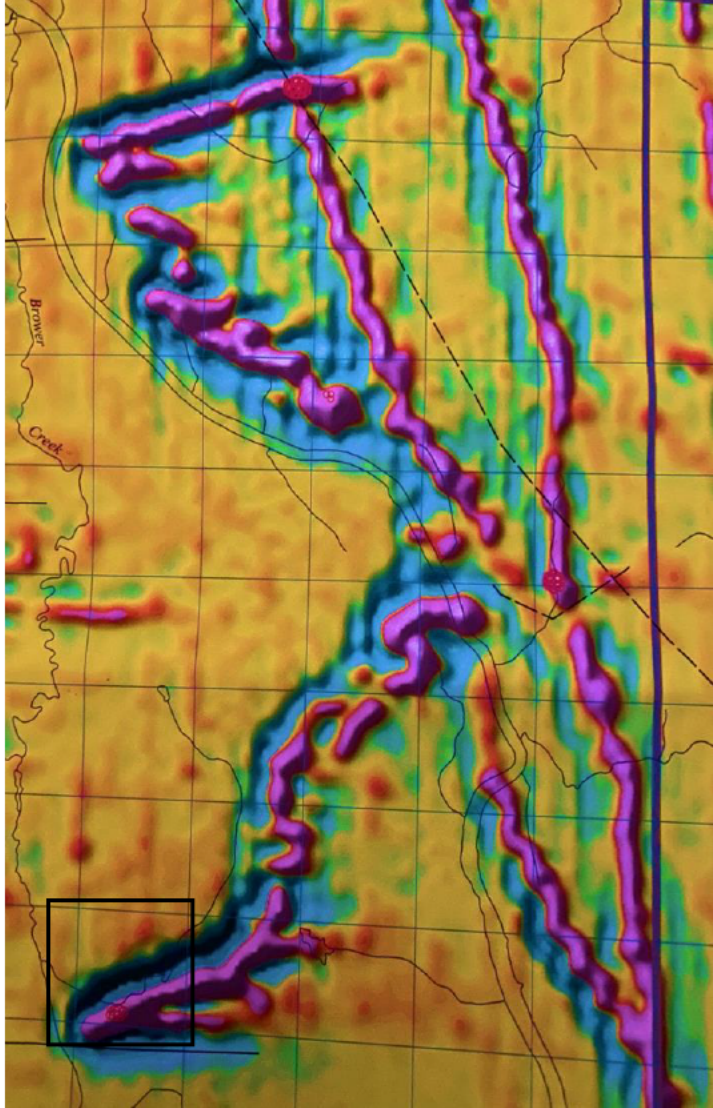

The square above demonstrates the approximate location of the claim area, which I find quite interesting.

OGS Map 82 825, Queen’s Printer for Ontario, 2016

The Cochrane area soils is primarily clay-based, being in the heart of the Great Claybelt of Ontario and terrain is fairly flat with large amounts of overburden over the bedrock. As such, rock outcrops are not common in the area and is likely the reason major mineral discoveries have not occurred here in the past 100 years. Hoping that airborne geophysics will expand valuable economic opportunities to the area.



Typical view of this rock outcrop. Creates a North-South ridge

## Daily Log

In September, time spent viewing maps and geological information to decide which area to claim.

October 6, 2020 – Travelled to the site to get a view of the area and scope the access. Due to a deep ditch, cannot access the lot by vehicle from the concession onto winter trail nearby.

One person working @ \$200/day for 1 day = \$200                      Kilometers travelled: 10

October 8 – Register a claim to the property to allow for grassroots prospecting

October 13 – Travelled to the site with my spouse to see the outcrop first-hand and see how far it travelled along the site before it completely disappears under the overburden. The visible outcrop is probably a half kilometer in length from the concession road at the south, to the northern extent. Time was spent with hand tools to pull back moss and expose any quartz veins and minerals.

Two persons working @ \$200/day for 1 day = \$400                      Kilometers travelled: 10

October 14 – Travelled to the site to strip moss with hand tools and collect hand samples. Pyrite is seen regularly, quartz and other minerals collected to review in closer detail for possible assaying. Samples gathered were identified as Zone 1, with GPS coordinates.

One person working @ \$200/day for 1 day = \$200                      Kilometers travelled:10

October 19 – As above, finding rock samples and labelling the area as Zone 2

One person working @ \$200/day for 1 day = \$200                      Kilometers travelled:10

October 20 – As above, finding rock samples and labelling the area as Zone 3

One person working @ \$200/day for 1 day = \$200                      Kilometers travelled:10













Bedrock indentations were peculiar, not sure if wearing is from erosion or likely glacial activity.



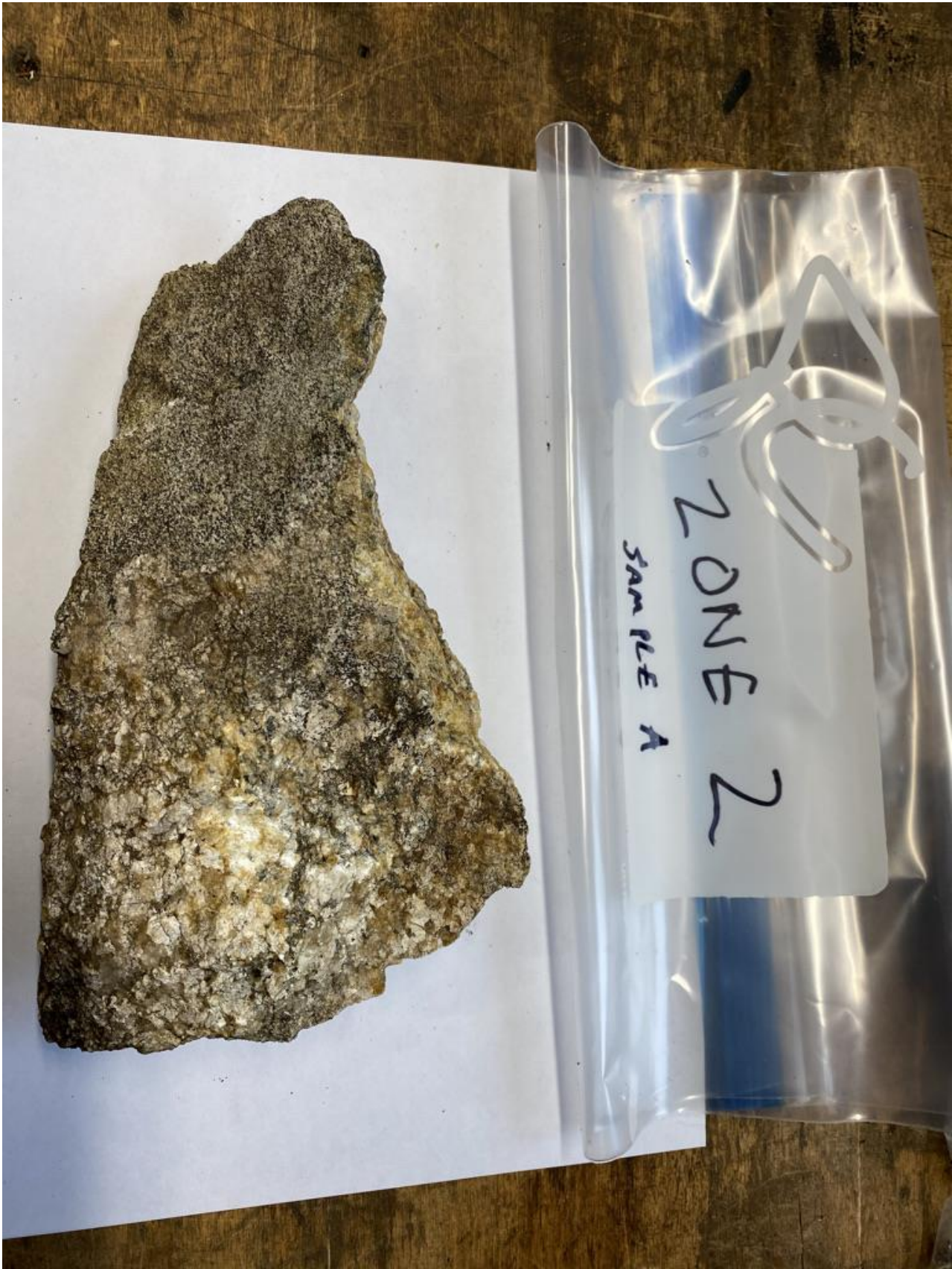







Visible red garnets throughout a few samples

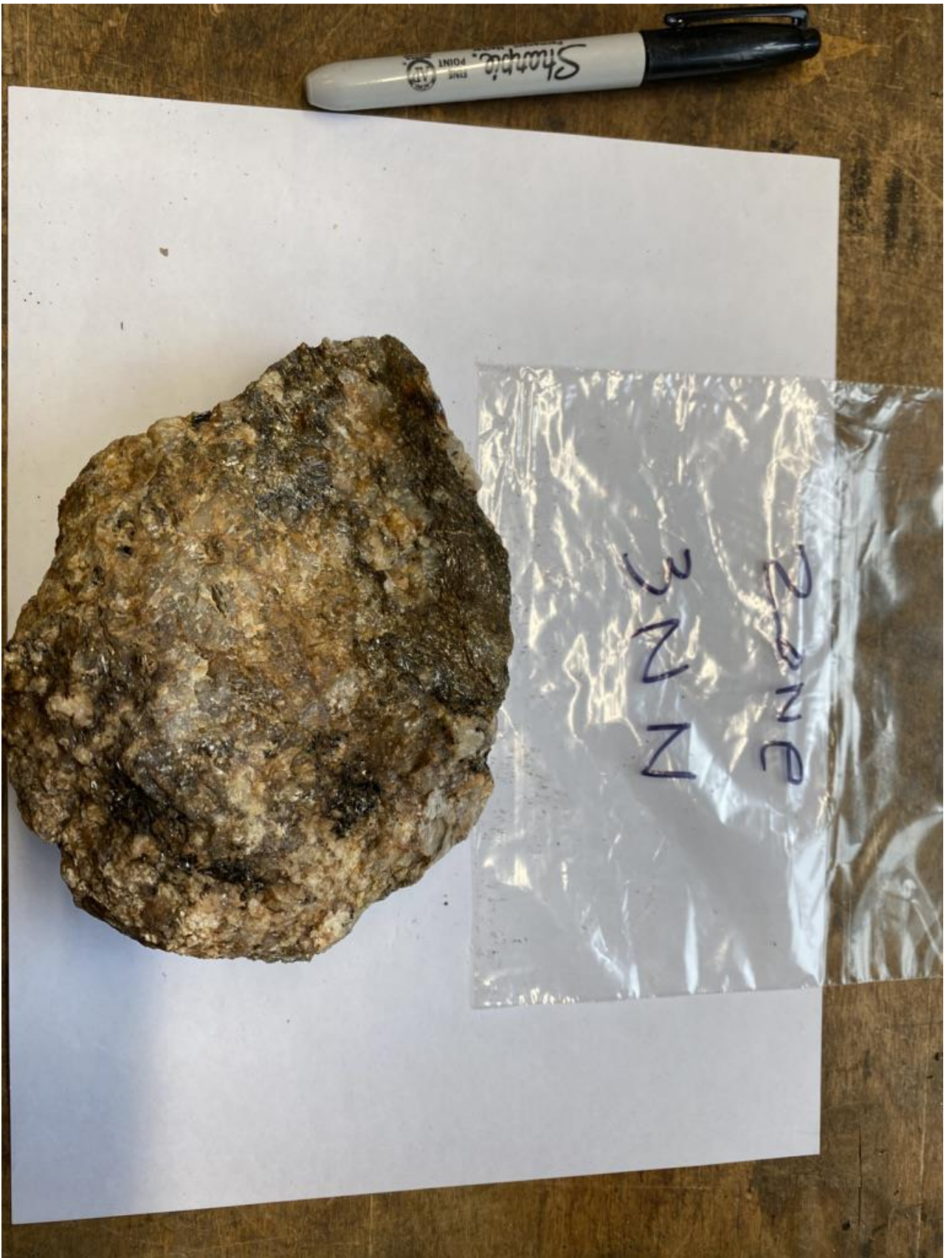





In closing, some difficulty experienced with the local assay lab in Cochrane, being SGS. During the pandemic, they were not inclined to open an account for a small new client. The samples were delivered however, some discussions ensued relative to what assay testing was required as some were to detect for any gold potential whereas the red garnets would need to be sent to their other lab in Kirkfield, Ontario.

I need to follow up with them to see if we can get this completed. Now that the pandemic is mostly subsided, this will be pursued. Results can be updated to this report perhaps, if desired or necessary.

Ministry of Mines

Date: Feb 2, 2023

Submission Number: 5185

Jean-Pierre Ouellette (410210)

Additional information requested from your letter of Dec 19, 2022: "Notice of Determination".

List the cell number on the Provincial Grid: Mining Claim Number 615031

Summarize the number of samples collected:

The area is accessed by maintained concession road. Outcrop is visible from road. Samples areas located approx. 500 feet from road. At the bottom of the outcrop, west of the site, beavers are active with some swamp.

| Sample Number | GPS                 | Site Description  | Sample Description                                      |
|---------------|---------------------|---|---|
| Zone 3 NN     | 49.10371, -80.9409  | Rock outcrop, no overburden, moss, forest cover                     | Granite with some quartz                                |
| Zone 2        | 49.10439, -80.94028 | Rock outcrop, no overburden, moss, forest cover                     | Granite with some quartz. Observed small purple garnets |
| Dam Outcrop   | 49.10495, -80.94039 | Rock outcrop, no overburden, moss, forest cover, view to beaver dam | Granite with some quartz                                |
|               |                     |   |   |

Please advise if this meets with your requirements and thank you for your consideration.

Sincerely,

JP Ouellette



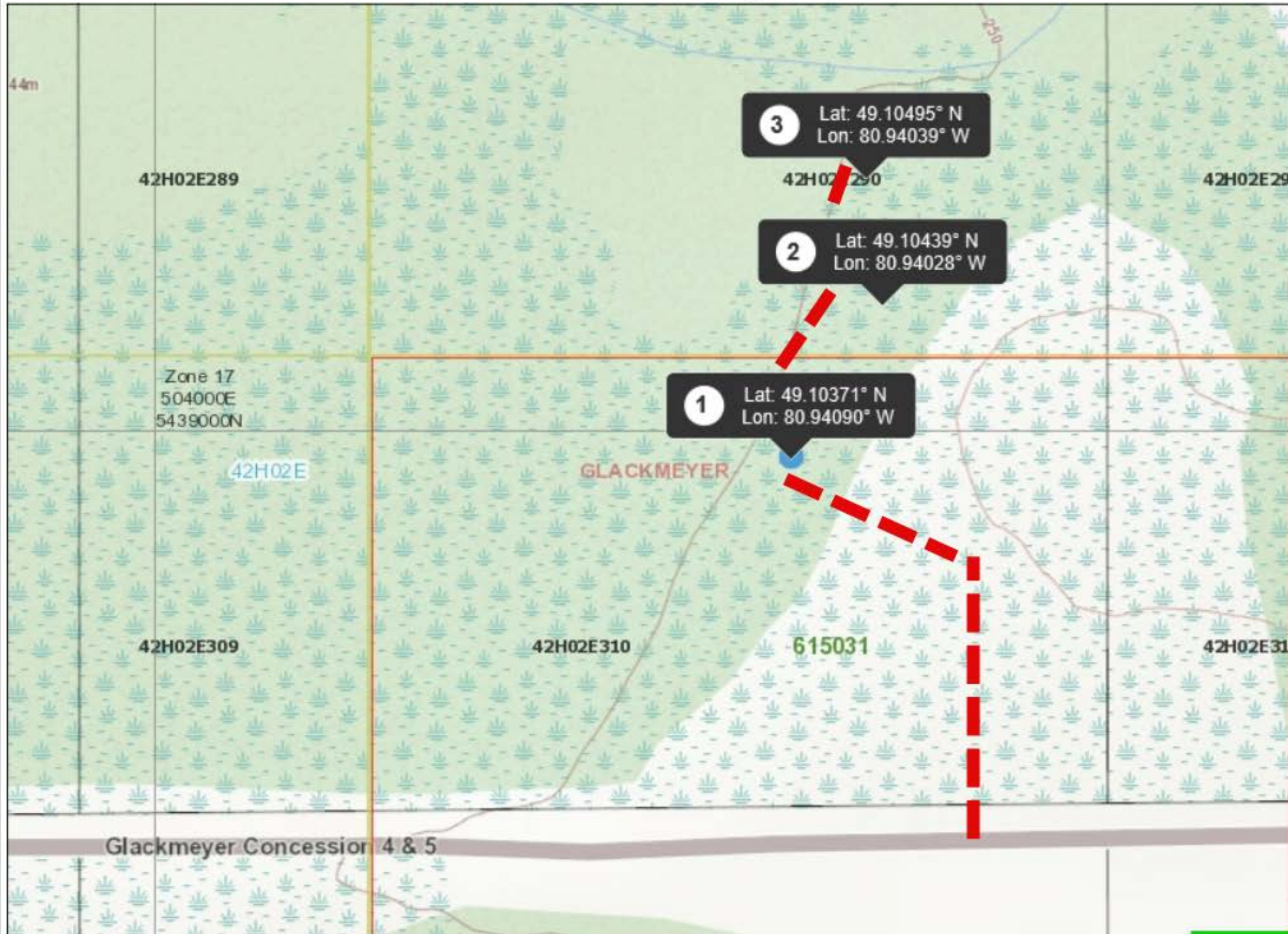

Those wishing to register mining claims should consult with the Provincial Mining Recorders' Office of the Ministry of Mines (MINES) for additional information on the status of the lands shown hereon. This map is not intended for navigational, survey, or land title determination purposes as the information shown on this map is compiled from various sources. Completeness and accuracy are not guaranteed. Additional information may also be obtained through the local Land Titles or Registry Office, or the Ministry of Natural Resources and Forestry. The information shown is derived from digital data available in the Provincial Mining Recorders' Office at the time of downloading from the Ministry of Mines (MINES) web site.

0 0.15 km

Projection: Web Mercator



Imagery Copyright Notices: Ministry of Natural Resources and Forestry (MNR), NASA Landsat Program; First Base Solutions Inc.; Aéro-Photo (1961) Inc.; DigitalGlobe Inc.; U.S. Geological Survey.) web site.

© King's Printer for Ontario, 2023

