

We are committed to providing [accessible customer service](#).

If you need accessible formats or communications supports, please [contact us](#).

Nous tenons à améliorer [l'accessibilité des services à la clientèle](#).

Si vous avez besoin de formats accessibles ou d'aide à la communication, veuillez [nous contacter](#).

PHASE 2 DIAMOND DRILLING PROGRAM: NIPISSING DIABASE PROJECT

LONG TOWNSHIP, SAULT STE. MARIE MINING DIVISION, ONTARIO, CANADA

DARIEN AGGREGATES INC.

222 MARTINDALE RD.

RR#3

ST. CATHARINES, ON

L2R 6P9

September 28th, 2022

Prepared By:



JMK EXPLORATION CONSULTING

147 LAKESIDE DR.

NORTH BAY, ONTARIO

P1A 3E1

JOERG KLEINBOECK, B.SC., P.GEO.

TABLE OF CONTENTS

1.0 INTRODUCTION	2
2.0 PROPERTY DETAILS	3
2.1 Location and Access	3
2.2 Topography and Vegetation	3
2.3 Claims	4
3.0 PREVIOUS WORK.....	6
4.0 GEOLOGY	8
4.1 Property Geology	8
5.0 PHASE 1 DIAMOND DRILLING PROGRAM.....	9
5.1 DIAMOND DRILLING.....	9
6.0 CONCLUSIONS & RECOMMENDATIONS.....	12
6.0 REFERENCES	13

LIST OF FIGURES

Figure 1: Location of the Nipissing Diabase Project.....	4
Figure 2: Tenure of the Nipissing Diabase Project, Long Township.	7
Figure 3: Permitted claims (PR-22-0000376).....	10
Figure 4: Diamond Drill Hole Locations.....	11

LIST OF TABLES

Table 1: Claim Details of the Nipissing Diabase Project.	5
Table 2: Diamond Drill Hole Details. Note: datum in NAD83, Z17N.....	11

LIST OF APPENDICES

Appendix I Statement of Qualifications	
Appendix II: Diamond Drill Logs	
Appendix III: Maps (Plan Map & Sections)	

1.0 INTRODUCTION

JMK Exploration Consulting was engaged by Darien Aggregates Inc. (“Darien”) to complete a technical report for assessment purposes on a second phase diamond drilling completed on their 100% owned Nipissing Diabase Project (“Property”).

The Property is situated in Long Township, located approximately 140 km west-southwest of Sudbury, Ontario. The Project is bounded by UTM coordinates 365570E to 367930E, and 5117690N to 5122390N (NAD83, Z17N) and is covered by National Topographic System (NTS) map sheets 41J/07 and 41J/02. The Property consists of 58 mining claim cells totalling approximately 1,130.5 ha.

Between June 16th and 22nd, 2022, 4 diamond drill holes totalling 502.00 m was completed. The drilling program was designed to expand on the Phase 1 drill program and complete partial fences across the trap rock deposit to a vertical depth of approximately 100 m to confirm the geology of the deposit, confirm the presence of Sudbury-type olivine diabase dyke(s) outlined in previous geological and geophysical programs. The program will allow Darien to review their mining plan as they finalize their aggregate permit application.

Additional work should include an expansion of the geological mapping program that was completed in 2015, as well as further diamond drilling to define the deposit. Mapping in 2015 identified a large Sudbury-type olivine diabase dyke, however, the author was not able to locate it at the time on the east side of a large swamp on mining cell claim 209446. In the fall of 2021, an airborne drone geophysical survey (magnetometer) was completed that identified the location of the dyke on the east half of mining cell claims 209446, 126269, and 142795. Aggregate test work is also recommended for this unit to confirm that the physical and chemical characteristics are similar to the host rock. Further diamond drilling is recommended in the area northeast of DA22-26 to confirm the nature of the geological contact between the Nipissing Diabase and the underlying granite.

2.0 PROPERTY DETAILS

2.1 Location and Access

The Property is situated in Long Township, located approximately 140 km west-southwest of Sudbury, Ontario. The Project is bounded by UTM coordinates 365570 E to 367930 E, and 5117690 N to 5122390 N (NAD83, Z17N) and is covered by National Topographic System (NTS) map sheets 41J/07 and 41J/02.

Access to the claims is provided by an ATV trail located at the end of Pronto Road, located 15 km east of Blind River, Ontario. The western part of the Property can be accessed by boat through Lake Lauzon.

Limited resources and lodging are available in the nearby town of Blind River. However, a full range of equipment, supplies, services, and skilled labour that would be required for any exploration and mining work is available in the nearby city of Greater Sudbury, Ontario.

2.2 Topography and Vegetation

The topography of the area is variable from relatively flay lying, gentle relief in the area of Highway 17 and the north shore of Lake Huron where the elevation is approximately 180 m ASL to relatively rugged with a maximum of 270 m ASL. The topography is controlled by bedrock features and the Nipissing Diabase forms topographic highs with locally steep scarps into lakes and drainages (Lavigne, 2009).



Figure 1: Location of the Nipissing Diabase Project.

2.3 Claims

The Nipissing Diabase Project consists of 58 contiguous unpatented mining cell claims totalling approximately 1,130.5 ha (Figure 2). Details of the unpatented mining cell claims are provided in Table 1. Darien acquired the property through a purchase agreement and subsequently staking additional claims. The unpatented mining claims are 100% owned by Darien.

Table 1: Claim Details of the Nipissing Diabase Project.

Township / Area	Tenure ID	Anniversary Date	Tenure Status	Work Required	Work Applied	Total Reserve
LONG	314041	2022-06-08	Active - On Extension	400	800	0
LONG	314040	2022-06-08	Active - On Extension	400	800	0
LONG	296303	2022-06-08	Active - On Extension	400	800	0
LONG	296302	2022-06-08	Active - On Extension	400	800	0
LONG	296301	2022-06-08	Active - On Extension	200	400	0
LONG	258914	2022-06-08	Active - On Extension	400	800	0
LONG	258913	2022-06-08	Active - On Extension	400	800	0
LONG	230259	2022-06-08	Active - On Extension	400	800	0
LONG	222973	2022-06-08	Active - On Extension	400	800	0
LONG	222972	2022-06-08	Active - On Extension	400	800	0
LONG	211440	2022-06-08	Active - On Extension	200	400	0
LONG	211439	2022-06-08	Active - On Extension	400	800	0
LONG	143438	2022-06-08	Active - On Extension	400	800	0
LONG	143437	2022-06-08	Active - On Extension	400	800	0
LONG	143436	2022-06-08	Active - On Extension	400	800	0
LONG	117078	2022-06-08	Active - On Extension	400	800	0
LONG	100430	2022-06-08	Active - On Extension	400	800	0
LONG	323410	2022-06-08	Active - On Extension	200	400	0
LONG	303907	2022-06-08	Active - On Extension	400	800	0
LONG	220146	2022-06-08	Active - On Extension	400	800	0
LONG	170600	2022-06-08	Active - On Extension	400	800	0
LONG	170599	2022-06-08	Active - On Extension	400	800	0
LONG	170598	2022-06-08	Active - On Extension	400	800	0
LONG	135894	2022-06-08	Active - On Extension	400	800	0
LONG	113140	2022-06-08	Active - On Extension	400	800	0
LONG	113139	2022-06-08	Active - On Extension	200	400	0
LONG	113138	2022-06-08	Active - On Extension	200	400	0
LONG	191843	2022-06-13	Active - On Extension	200	400	0
LONG	102398	2022-06-13	Active - On Extension	200	400	0
LONG	126268	2022-11-25	Active	400	1200	0
LONG	325018	2023-01-17	Active	200	800	0
LONG	276934	2023-01-17	Active	200	800	0
LONG	258420	2023-01-17	Active	200	800	0
LONG	241884	2023-01-17	Active	400	1600	0
LONG	221054	2023-01-17	Active	200	800	0
LONG	156372	2023-01-17	Active	200	800	0
LONG	155702	2023-01-17	Active	400	1600	0
LONG	102218	2023-01-17	Active	400	1600	0
LONG	215212	2023-01-17	Active	200	800	0
LONG	278338	2023-01-17	Active	200	800	0
LONG	276935	2023-01-17	Active	200	800	0
LONG	233087	2023-01-17	Active	200	800	0
LONG	164337	2023-01-17	Active	200	800	0
LONG	221744	2023-01-17	Active	200	800	0
LONG	162458	2023-01-17	Active	200	800	0
LONG	128429	2023-01-17	Active	200	800	0
LONG	237159	2023-06-08	Active	400	1200	0
LONG	324137	2023-11-25	Active	400	1600	0
LONG	294332	2023-11-25	Active	400	1600	0
LONG	257477	2023-11-25	Active	400	1600	0
LONG	221524	2023-11-25	Active	400	1600	0
LONG	221523	2023-11-25	Active	200	800	0
LONG	209447	2023-11-25	Active	200	800	0
LONG	209446	2023-11-25	Active	400	1600	0
LONG	155567	2023-11-25	Active	400	1600	0
LONG	155566	2023-11-25	Active	400	1600	24
LONG	142795	2023-11-25	Active	400	1600	0
LONG	126269	2023-11-25	Active	400	1600	0

3.0 PREVIOUS WORK

2006: Darien Resources Inc. completed limited reconnaissance prospecting.

2009: Darien Resources Inc. completed 5 diamond drill holes totalling 301 m located to the northwest of the current land package.

2011: Darien Resources Inc. completed trenching and bulk sampling on legacy mining claims 3009531, 4219196, and 4223995.

2015: Darien Aggregates Inc. completed the installation of 7 ground water monitoring wells. The diamond drill core was logged and submitted for assessment.

2016: Darien Aggregates Inc. completed geological mapping on legacy mining claim 3009531.

2017: Darien Aggregates Inc. completed the installation of 12 ground water monitoring wells as well as 13 diamond drill holes.

2021: Darien Aggregates Inc. completed an airborne (drone) magnetometer geophysical survey totalling 9.5-line km's covering an area of approximately 62.74 ha.

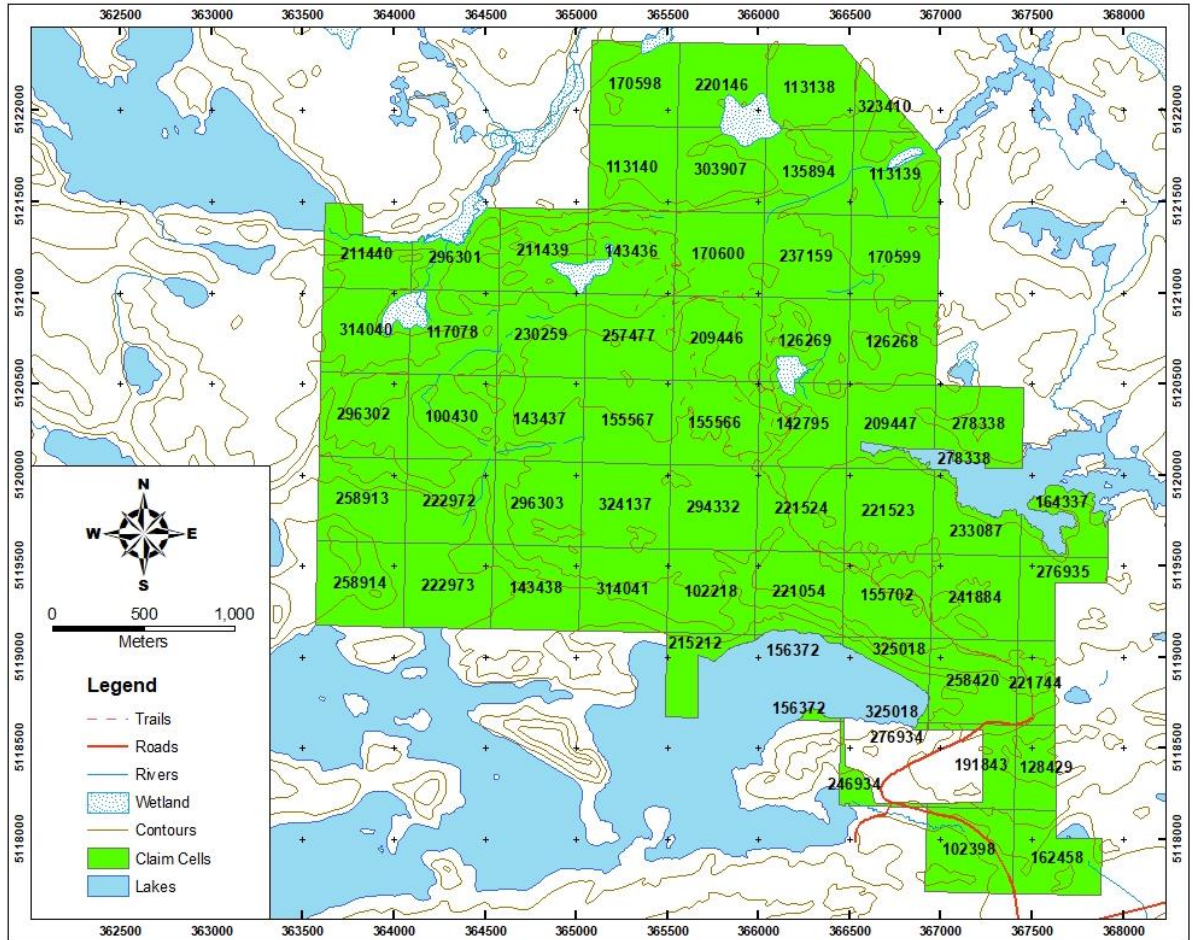

Figure 2: Tenure of the Nipissing Diabase Project, Long Township.

4.0 GEOLOGY

4.1 Property Geology

The Project is located within the Southern Structural Province of the Canadian Shield which, in general terms, consists of an Archean basement overlain by the Early Proterozoic Huronian Supergroup and intruded by a number of felsic to mafic intrusive bodies that range in age from Early to Middle Proterozoic. The Archean rocks exposed on in the Project area consist dominantly of massive to gneissic granitic rocks and lesser amounts of mafic metavolcanic and metasedimentary rocks. Huronian Supergroup rocks present in the Project area include the Lower and Middle Mississagi Formations (feldspathic quartzite, arkose to greywacke, siltstone and argillite respectively) and the Gowganda Formation (interbedded conglomerate, feldspathic quartzite, argillite, and siltstone). Both the Archean rocks (>2,500 Ma) and the Huronian Supergroup sedimentary rocks (2,500 – 2,200 Ma) are intruded by mafic intrusive rocks known as Nipissing Diabase (2,219 Ma) and form west-to-northwest trending, vertical to steeply dipping dyke or sill-like bodies that typically range in thickness from a few metres to < 100 metres, however, a number of thicker intrusions have been mapped. Following the emplacement of the Nipissing Diabase, Sudbury Breccia (1,850 Ma), granitic dykes related to the Cutler Pluton (1,740 Ma), and Sudbury-type Olivine Diabase dykes (1,238 Ma) have intruded all rock types on the Property.

5.0 PHASE 1 DIAMOND DRILLING PROGRAM

5.1 DIAMOND DRILLING

Between June 16th and 22nd, 2022, 4 diamond drill holes totalling 502.00 m were completed on unpatented mining claims 126269, 142795 and 209446, and covered under exploration permit PR-22-000034 (Figure 3). Exploration permit PR-22-000034 permits the proponent from completing mechanized drilling (assembled weight >150 kg) from March 30th, 2022 through to March 29th, 2025.

The drilling program was designed to expand on the Phase 1 drill program and complete partial fences across the trap rock deposit to a vertical depth of approximately 100 m to confirm the geology of the deposit, confirm the presence of Sudbury-type olivine diabase dyke(s) outlined in previous geological and geophysical programs.

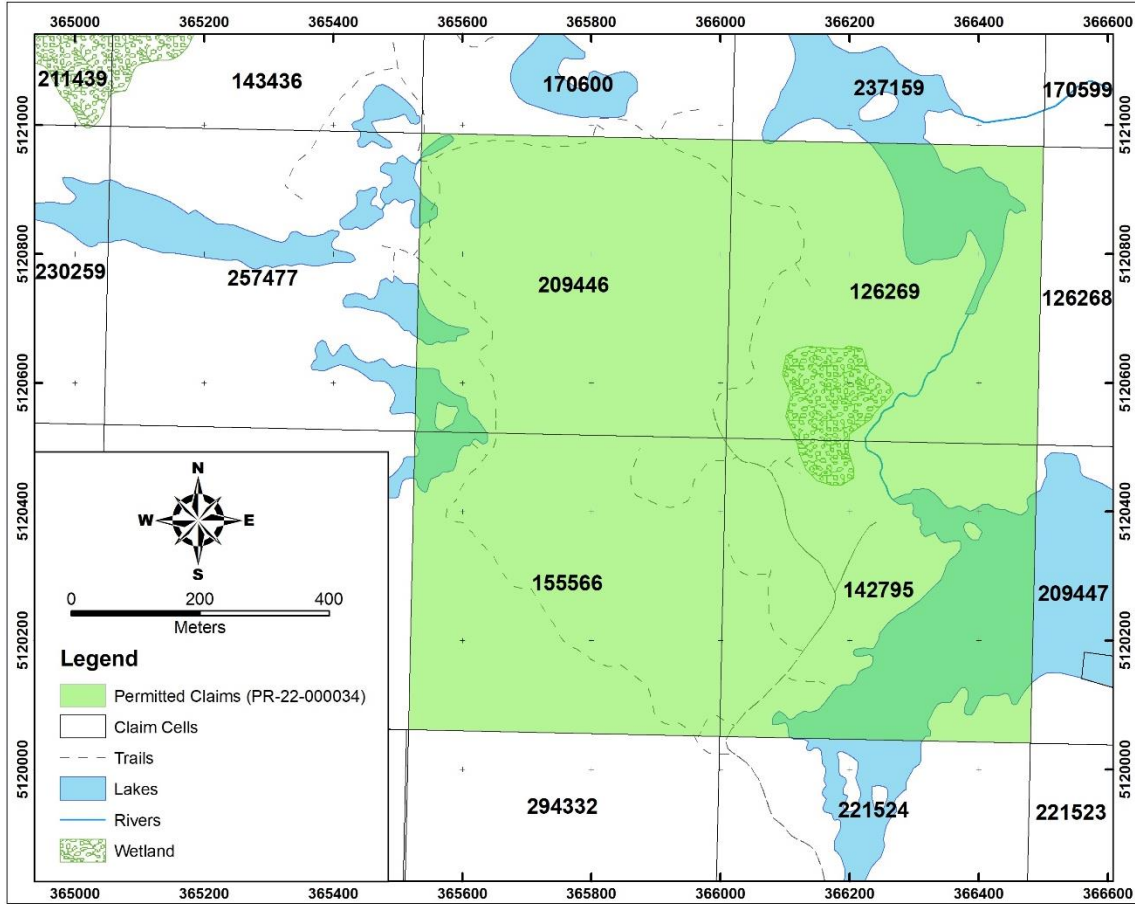

Figure 3: Permitted claims (PR-22-0000376).

Diamond drill hole coordinates are provided in Table 2 and collar locations are shown in Figure 4.

Once the core had been logged and geotechnical measurements completed, metal tags were attached to the core box inscribed with the hole number, box number, and corresponding interval. The core was then cross-piled and stored at a storage facility located 134 Imperial Road, North Bay, Ontario.

Drill logs and maps (plan and section maps) are provided in Appendices II and III respectively.

Table 2: Diamond Drill Hole Details. Note: datum in NAD83, Z17N

DDH	Easting	Northing	Elevation (m)	Azm	Dip	Length (m)
DA22-26	365974	5120570	250	45	-45	151.00
DA22-27	366053	5120469	248	45	-45	100.00
DA22-28	366185	5120311	238	45	-45	121.00
DA22-29	366127	5120272	245	45	-45	130.00

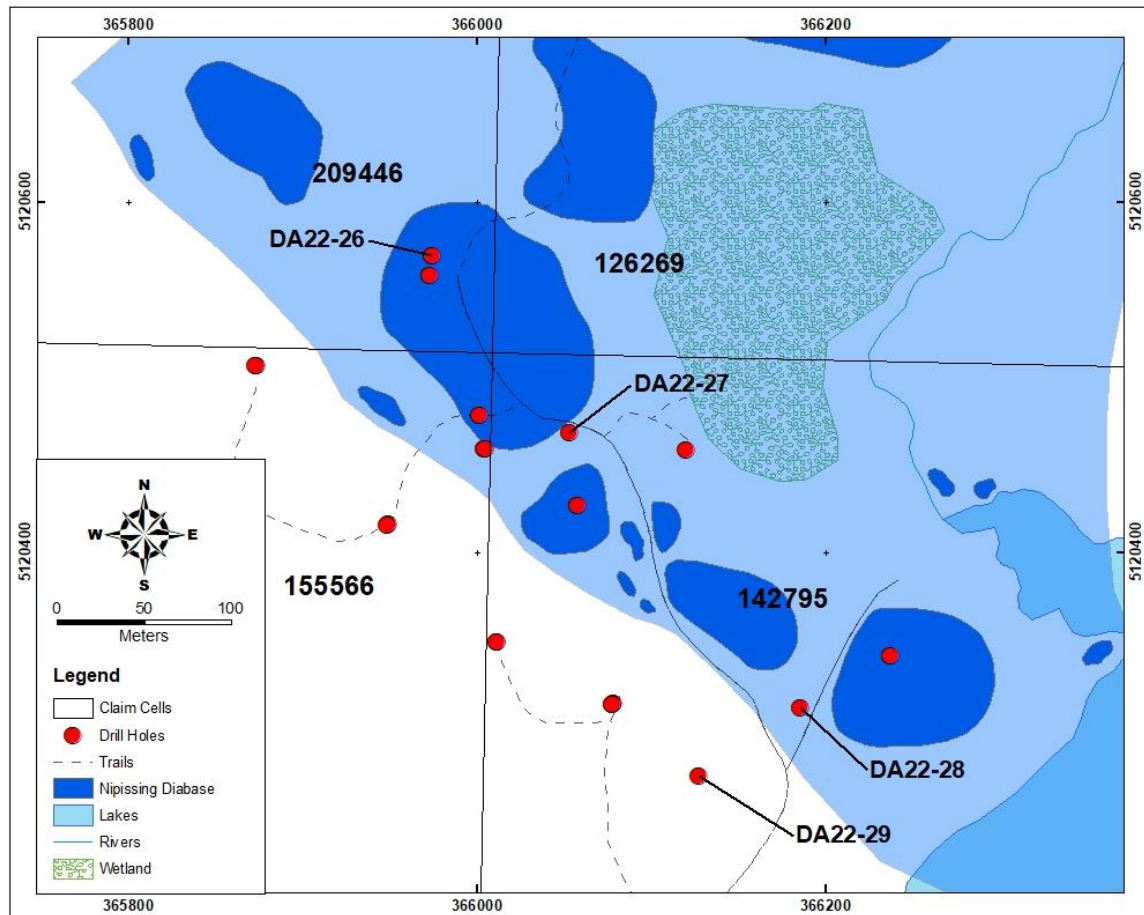

Figure 4: Diamond Drill Hole Locations.

6.0 CONCLUSIONS & RECOMMENDATIONS

The Phase 2 diamond drill program was successful in mapping different lithologies that can be used for towards developing a mining plan for the subject Property. Additional work should include the expansion of the geological mapping program that was completed in 2015, as well as further diamond drilling to define the deposit, specifically in the area northeast of drill hole DA22-26 to confirm the nature of the geological contact between the Nipissing Diabase and the underlying granite.

6.0 REFERENCES

Johns, G.W., McIlraith, S., and Muir, T.L. 2003. Precambrian Geology compilation map –Sault Ste. Marie-Blind River sheet; Ontario Geological Survey, Map 2670, scale 1:250,000.

Kleinboeck, J.M., 2016. 2016 Geological Mapping Program, Nipissing Diabase Project.

Kleinboeck, J.M., 2017. Phase 1 Diamond Drill Program, Nipissing Diabase Project.

Robertson, J.A., 1970. Long & Spragge Townships & part of Indian Reserve #7. Ontario Geological Survey. Map 2186, scale 1:31,680.

Lavigne, J. 2009. Report on Diamond Drilling on Claim 4223988, Nipissing Diabase Project, Long and Striker Townships, Sault Ste. Marie Mining Division. Darien Resources Inc.

Osmani, I.A. 1991. Proterozoic Mafic Dyke Swarms in the Superior Province of Ontario; in Geology of Ontario, Ontario Geological Survey, Special Volume 4, Part 1, p. 661-682.

Appendix I

Statement of Qualifications

Statement of Qualifications

I, Joerg Martin Kleinboeck of 147 Lakeside Drive, North Bay, Ontario, do hereby certify that:

I am a graduate of Laurentian University, Sudbury, Ontario with a B.Sc. Geology, 2000, and have been practising my profession as a geologist since.

I am a member with the Association of Professional Geoscientists of Ontario (#1411).

I hold no interests in the securities of Darien Aggregates Inc. or the claims that comprise the subject Property.



The image shows a handwritten signature in cursive script, followed by a circular professional seal. The seal contains the text 'PROFESSIONAL GEOSCIENTIST' around the top edge, 'JOERG M. KLEINBOECK' in the center, 'PRACTISING MEMBER' below the name, and '1411' at the bottom. The word 'ONTARIO' is written along the bottom inner edge of the seal.

Joerg Martin Kleinboeck
JMK Exploration Consulting
North Bay, Ontario
September 28th, 2022

Appendix II
Diamond Drill Logs

Darien Aggregates Inc.

Survey:	DA22-26	Claims title:	209446	Section:	
		Township:	Long	Level:	Surface
		Range:		Work place:	North Bay, ON
Contractor:	Enviro North	Lot:			
Author:	Joerg Kleinboeck	Start date:	6/16/2022	Description date:	7/28/2022
		End date:	6/18/2022		

Collar

Azimuth: 45.00°
 Dip: -45.00°
 Length: 151.00

System 1

East	365974
North	5120570
Elevation	250

Down hole survey

Type	Depth	Azimuth	Dip	Invalid ...
Trushot	25.00	46.90°	-46.60°	No
Trushot	75.00	51.30°	-45.90°	No
Trushot	127.00	49.00°	-45.90°	No

Type	Depth	Azimuth	Dip	Invalid ...
------	-------	---------	-----	-------------

Number of samples: 0
 Number of QAQC samples: 0
 Total sampled length: 0.00

Description:

Casing left in hole, capped with steel flag.
 Drilling completed under permit PR-22-000034.
 Core stored at 134 Imperial Rd., North Bay, ON.

Core size: BQTK

Cemented: No

Stored: Yes

Darien Aggregates Inc.

		Description	
0.00	0.30	<p>OB Overburden Casing driven to 1.5m.</p>	
0.30	1.25	<p>Gr Granite pink coarse grained massive granite containing partially digested gabbroic material. 1mm chlorite veinlets common throughout, preferentially orientated 35 degrees, also fairly irregular. tr diss py, generally unmineralized. lower contact somewhat diffuse or partially digested.</p>	
1.25	14.71	<p>NDIA Nipissing Diabase grey to dark grey medium to locally very coarse grained massive gabbro. non-magnetic. no visible sulphides. upper contact is altered proximal to granitic intrusion over 2-3m. joints 5-7/m commonly orientated @ 35, 45, 75 degrees TCA. joints are typically coated with minor chlorite and occasional fibrous minerals (rare). lower contact sharp @ 30 deg TCA.</p>	
14.71	15.04	<p>MD Mafic Dyke 30° dark grey to black vfg mafic dyke containing 5% very fine leucoxene xtls. no visible sulphides. very weakly magnetic near upper contact. moderately fractured. lower contact sharp @ 30 deg TCA, but broken.</p>	
15.04	19.18	<p>NDIA Nipissing Diabase grey medium to locally very coarse grained massive gabbro. no visible sulphides. locally weakly magnetic. joints 5-6/m preferably orientated @ 30, 70 deg TCA. lower contact sharp @ 40 deg TCA.</p>	
19.18	19.48	<p>MD</p>	

Darren Aggregates Inc.

Description		
19.48	37.82	<p>Mafic Dyke 45° as from 14.71 to 15.04m. RQD is 0%. lower contact sharp at 40-45 deg TCA.</p> <p>NDIA Nipissing Diabase grey medium to coarse grained massive gabbro. occasional sections slightly leucocratic in appearance due to pervasive albitization about micro-fractures. heavily fractured from 23.50m to 24.25m (RQD=0%) joints 5-6/m preferably orientated @ 20, 55, and 70 deg TCA. no visible sulphides. lower contact sharp @ 30 deg TCA.</p>
37.82	44.15	<p>MD Mafic Dyke dark grey to black fine to medium grained mafic dyke. generally massive with upper and lower contacts chilled over 50-100 cm. becomes coarser grained towards middle of dyke and contains blocks of NDA up to 10-20cm at lower contact. generally non-magnetic except for at the lower contact where there is moderate to strong magnetism. generally unmineralized. several small blebs of py occur @ 38.05m along margins of 6-8mm wide epidote vein orientated @ 60 deg TCA. 39.00-41.75m - weak epidote+quartz veins up to 1-3 mm in width, orientated @ 60-70 deg TCA. lower contact sharp but broken - 70 deg TCA. lower contact broken but sharp (~70 deg TCA.)</p>
44.15	46.65	<p>NDIA Nipissing Diabase grey medium grained massive gabbro. 44.30-44.40m - mafic dyke (as from 38.82-44.15m) @ 65-70 deg TCA. non-magnetic. no visible sulphides. heavily fractured from 46.00-46.65m. lower contact sharp @ 70 deg TCA.</p>
46.65	47.95	<p>MD Mafic Dyke dark grey to black very fine grained massive mafic dyke.</p>

Darien Aggregates Inc.

Description		
47.95	58.35	<p>heavily fractured. non-magnetic. no visible sulphides. lower contact broken.</p> <p>NDIA Nipissing Diabase grey medium grained massive gabbro. generally non-magnetic. heavily fractured from 51.75-53.75m. no visible sulphides. lower contact partially digested but abrupt with granitic intrusive (5-10 deg TCA.)</p>
58.35	62.20	<p>Gr Granite pink coarse grained massive granitic dyke (Cutler Intrusive). non-magnetic. no visible sulphides. 59.70-61.50m - long open-curve fracture at 0-5 deg TCA, infilled with chlorite+carb. heavily fractured from 60.40-60.70m. lower contact is sharp but irregular (generally between 60-70 deg TCA), contains sharp angular material from below lying mafic intrusive dyke.</p>
62.20	103.13	<p>OD Olivine Diabase Dyke typical grey fine to coarse grained massive Sudbury-type Olivine Diabase Dyke. becomes medium to coarse grained within dyke from approx. 67.00m to 95.50m. local fractures infilled with chlorite over 1-2mm. weak pervasive kspar from 98.90-99.20m about partially digested gr clast? generally unmineralized. trace diss/ff py along chlorite-filled fractures. strongly magnetic with 5-8% finely diss magnetite throughout. upper contact is chilled and brecciated/rehealed with chlorite over 40cm. lower contact is chilled over ~ 30cm, sharp, but broken, approx. 45-50 deg TCA.</p>
103.13	143.16	<p>NDIA Nipissing Diabase grey to green medium grained massive gabbro (NDIA).</p>

Darien Aggregates Inc.

		Description	
		<p>generally non-magnetic. weak pervasive chlorite throughout. generally unmineralized, trace fine py throughout. 106.00-106.06m - dark grey to black very fine grained OD dyke @ 70 deg TCA. moderately magnetic (mag sus=4.96) 116.12-117.82m - locally heavily fractured with hematite and chlorite common along fracture surfaces. 125.15-125.78m - pink coarse grained massive granitic dyke, contacts partially digested with trace py (approx 30-40 deg TCA). 126.09-126.43m - pink coarse grained massive granitic dyke, contacts fairly sharp @ 20-30 deg TCA. 126.50-129.20m - heavily fractured. lower contact sharp @ 30 deg TCA. 136.00-136.75m - heavily fractured with hematite, chlorite, and occasionally calcite along fractures surfaces. 139.22-139.24m - 2cm quartz vein @ 65 deg TCA. 139.53-139.55m - 2cm quartz vein @ 65 deg TCA. 149.90-143.16m - strong quartz flooding, highly irregular and up to 15cm in width.</p>	
143.16	151.00	<p>Gr Granite pink coarse grained massive granite. non-magnetic. generally unmineralized except for fine diss py at upper contact occurring along fractures and also disseminated. 144.00-144.03m - 1-2cm wide mafic dyke @ 70 deg TCA, contained minor 1-2mm fragments of granite (mag sus=0.405) fractures 3-4/m, infilled with chlorite.</p>	

Darien Aggregates Inc.

Additional Data				
From	To	Magnetic Susceptibility	Conductivity	
1.00	2.00	0.618	1000	
2.00	3.00	0.528	1000	
3.00	4.00	0.605	1000	
4.00	5.00	0.352	1000	
5.00	6.00	0.407	1000	
6.00	7.00	0.558	1000	
7.00	8.00	0.433	1000	
8.00	9.00	0.902	1000	
9.00	10.00	1.240	1000	
10.00	11.00	1.310	1000	
11.00	12.00	1.210	1000	
12.00	13.00	0.793	1000	
13.00	14.00	1.200	1000	
14.00	15.00	1.180	1000	
15.00	16.00	2.460	1000	
16.00	17.00	1.960	1000	
17.00	18.00	9.140	1000	
18.00	19.00	3.940	1000	
19.00	20.00	1.240	1000	
20.00	21.00	0.802	1000	
21.00	22.00	0.577	1000	
22.00	23.00	0.551	1000	
23.00	24.00	0.633	1000	
24.00	25.00	1.050	1000	
25.00	26.00	1.010	1000	
26.00	27.00	0.701	1000	
27.00	28.00	0.983	1000	
28.00	29.00	0.849	1000	
29.00	30.00	0.726	1000	
30.00	31.00	0.950	1000	
31.00	32.00	0.742	1000	

Darien Aggregates Inc.

Additional Data				
From	To	Magnetic Susceptibility	Conductivity	
32.00	33.00	0.612	1000	
33.00	34.00	0.396	1000	
34.00	35.00	0.490	1000	
35.00	36.00	0.743	1000	
36.00	37.00	0.579	1000	
37.00	38.00	0.769	1000	
38.00	39.00	0.873	1000	
39.00	40.00	0.713	1000	
40.00	41.00	0.596	1000	
41.00	42.00	0.717	1000	
42.00	43.00	0.716	1000	
43.00	44.00	1.170	1000	
44.00	45.00	0.818	1000	
45.00	46.00	1.420	1000	
46.00	47.00	1.030	1000	
47.00	48.00	1.170	1000	
48.00	49.00	1.110	1000	
49.00	50.00	1.300	1000	
50.00	51.00	1.080	1000	
51.00	52.00	0.632	1000	
52.00	53.00	0.383	1000	
53.00	54.00	0.997	1000	
54.00	55.00	0.954	1000	
55.00	56.00	0.920	1000	
56.00	57.00	0.500	1000	
57.00	58.00	0.557	1000	
58.00	59.00	0.178	1000	
59.00	60.00	0.535	1000	
60.00	61.00	0.425	1000	
61.00	62.00	2.500	1000	
62.00	63.00	33.200	1000	

Darien Aggregates Inc.

Additional Data				
From	To	Magnetic Susceptibility	Conductivity	
63.00	64.00	26.700	1000	
64.00	65.00	28.300	1000	
65.00	66.00	29.500	1000	
66.00	67.00	28.300	1000	
67.00	68.00	27.000	1000	
68.00	69.00	27.100	1000	
69.00	70.00	25.800	1000	
70.00	71.00	31.400	1000	
71.00	72.00	28.400	1000	
72.00	73.00	29.900	1000	
73.00	74.00	32.100	1000	
74.00	75.00	31.800	1000	
75.00	76.00	27.500	1000	
76.00	77.00	26.700	1000	
77.00	78.00	28.100	1000	
78.00	79.00	1.770	1000	
79.00	80.00	5.550	1000	
80.00	81.00	22.100	1000	
81.00	82.00	25.600	1000	
82.00	83.00	27.300	1000	
83.00	84.00	25.400	1000	
84.00	85.00	24.500	1000	
85.00	86.00	26.200	1000	
86.00	87.00	26.600	1000	
87.00	88.00	27.700	1000	
88.00	89.00	25.000	1000	
89.00	90.00	27.200	1000	
90.00	91.00	26.700	1000	
91.00	92.00	29.600	1000	
92.00	93.00	23.500	1000	
93.00	94.00	25.500	1000	

Darien Aggregates Inc.

Additional Data				
From	To	Magnetic Susceptibility	Conductivity	
94.00	95.00	31.500	1000	
95.00	96.00	31.100	1000	
96.00	97.00	29.100	1000	
97.00	98.00	28.400	1000	
98.00	99.00	29.800	1000	
99.00	100.00	29.200	1000	
100.00	101.00	31.100	1000	
101.00	102.00	29.900	1000	
102.00	103.00	12.200	1000	
103.00	104.00	0.967	1000	
104.00	105.00	0.227	1000	
105.00	106.00	0.496	1000	
106.00	107.00	0.993	1000	
107.00	108.00	0.900	1000	
108.00	109.00	1.130	1000	
109.00	110.00	1.170	1000	
110.00	111.00	1.100	1000	
111.00	112.00	1.120	1000	
112.00	113.00	0.867	1000	
113.00	114.00	1.160	1000	
114.00	115.00	1.280	1000	
115.00	116.00	1.360	1000	
116.00	117.00	1.400	1000	
117.00	118.00	1.610	1000	
118.00	119.00	1.360	1000	
119.00	120.00	1.650	1000	
120.00	121.00	1.070	1000	
121.00	122.00	1.470	1000	
122.00	123.00	1.240	1000	
123.00	124.00	1.260	1000	
124.00	125.00	0.961	1000	

Darien Aggregates Inc.

Additional Data				
From	To	Magnetic Susceptibility	Conductivity	
125.00	126.00	0.701	1000	
126.00	127.00	0.942	1000	
127.00	128.00	0.968	1000	
128.00	129.00	1.100	1000	
129.00	130.00	1.870	1000	
130.00	131.00	2.270	1000	
131.00	132.00	1.520	1000	
132.00	133.00	1.940	1000	
133.00	134.00	1.400	1000	
134.00	135.00	1.660	1000	
135.00	136.00	1.020	1000	
136.00	137.00	0.920	1000	
137.00	138.00	0.837	1000	
138.00	139.00	0.714	1000	
139.00	140.00	0.543	1000	
140.00	141.00	0.766	1000	
141.00	142.00	0.668	1000	
142.00	143.00	0.043	1000	
143.00	144.00	0.192	1000	
144.00	145.00	0.186	1000	
145.00	146.00	0.209	1000	
146.00	147.00	0.193	1000	
147.00	148.00	0.226	1000	
148.00	149.00	0.187	1000	
149.00	150.00	0.179	1000	
150.00	151.00	0.128	1000	

Darien Aggregates Inc.

RQD					
From	To	RQD length:	Recovered length	Recovered (%)	RQD (%)
4.00	7.00	2.84	2.97	99.00	94.67
7.00	10.00	1.90	2.95	98.33	63.33
10.00	13.00	1.87	2.80	93.33	62.33
13.00	16.00	1.47	2.82	94.00	49.00
16.00	19.00	2.63	3.02	100.67	87.67
19.00	22.00	1.78	2.86	95.33	59.33
22.00	25.00	2.04	2.92	97.33	68.00
25.00	28.00	2.37	2.97	99.00	79.00
28.00	31.00	2.41	3.00	100.00	80.33
31.00	34.00	2.13	2.92	97.33	71.00
34.00	37.00	2.52	3.00	100.00	84.00
37.00	40.00	2.37	2.94	98.00	79.00
40.00	43.00	1.83	2.96	98.67	61.00
43.00	46.00	1.64	3.04	101.33	54.67
46.00	49.00	0.47	3.00	100.00	15.67
49.00	52.00	1.41	2.98	99.33	47.00
52.00	55.00	0.30	2.78	92.67	10.00
55.00	58.00	1.58	3.00	100.00	52.67
58.00	61.00	1.83	2.95	98.33	61.00
61.00	64.00	1.60	2.85	95.00	53.33
64.00	67.00	2.34	3.00	100.00	78.00
67.00	70.00	3.00	3.00	100.00	100.00
70.00	73.00	2.45	2.96	98.67	81.67
73.00	76.00	2.70	3.02	100.67	90.00
76.00	79.00	2.45	3.00	100.00	81.67
79.00	82.00	2.86	2.98	99.33	95.33
82.00	85.00	1.81	2.94	98.00	60.33
85.00	88.00	2.96	2.99	99.67	98.67
88.00	91.00	3.01	3.01	100.33	100.33
91.00	94.00	2.96	3.00	100.00	98.67
94.00	97.00	2.48	2.96	98.67	82.67

Darien Aggregates Inc.

RQD					
From	To	RQD length:	Recovered length	Recovered (%)	RQD (%)
97.00	100.00	2.25	3.00	100.00	75.00
100.00	103.00	1.40	2.94	98.00	46.67
103.00	106.00	2.75	2.98	99.33	91.67
106.00	109.00	2.86	2.99	99.67	95.33
109.00	112.00	2.91	2.99	99.67	97.00
112.00	115.00	2.17	2.96	98.67	72.33
115.00	118.00	1.76	2.85	95.00	58.67
118.00	121.00	2.11	2.80	93.33	70.33
121.00	124.00	2.78	3.00	100.00	92.67
124.00	127.00	2.11	3.00	100.00	70.33
127.00	130.00	1.33	2.80	93.33	44.33
130.00	133.00	2.66	2.98	99.33	88.67
133.00	136.00	2.73	3.00	100.00	91.00
136.00	139.00	2.31	2.90	96.67	77.00
139.00	142.00	2.61	3.00	100.00	87.00
142.00	145.00	2.10	2.98	99.33	70.00
145.00	148.00	2.81	3.00	100.00	93.67
148.00	151.00	2.93	3.00	100.00	97.67

Darien Aggregates Inc.

Survey:	DA22-27	Claims title:	142795	Section:	
		Township:	Long	Level:	Surface
		Range:		Work place:	North Bay, ON.
Contractor:	Enviro North	Lot:			
Author:	Joerg Kleinboeck	Start date:	6/18/2022	Description date:	7/28/2022
		End date:	6/19/2022		

Collar

Azimuth: 45.00°
 Dip: -45.00°
 Length: 100.00

System 1

East	366053
North	5120469
Elevation	248

Down hole survey

Type	Depth	Azimuth	Dip	Invalid ...
Trushot	25.00	41.10°	-45.10°	No
Trushot	55.00	41.20°	-45.00°	No
Trushot	85.00	43.50°	-44.90°	No

Type	Depth	Azimuth	Dip	Invalid ...

Number of samples: 0
 Number of QAQC samples: 0
 Total sampled length: 0.00

Description:

Casing left in hole, capped with steel flag.
 Drilling completed under permit PR-22-000034.
 Core stored at 134 Imperial Rd., North Bay, ON.

Core size: BQ

Cemented: No

Stored: Yes

Darien Aggregates Inc.

		Description	
0.00	0.85	<p>OB Overburden Casing driven to 1.50m.</p>	
0.85	55.50	<p>NDIA Nipissing Diabase grey to green massive gabbro. predominantly medium grained with local coarser grained sections throughout. coarser grained sections are commonly altered by weak pervasive kspar and epidote. generally unmineralized with occasional trace fine disseminated or fracture controlled pyrite. non-magnetic for the most part, local sections that are weakly magnetic. 0.85-2.05m - very coarse grained 8.10-9.35m - very coarse grained 15.30-16.00m - very coarse grained weakly fractured throughout, commonly infilled with 1mm of chlorite. 52.20-55.50m - heavily fractured lower contact sharp but broken.</p>	
55.50	68.08	<p>OD Olivine Diabase Dyke grey fine to medium grained massive olivine diabase dyke (Sudbury-type). 5-8% finely disseminated magnetite throughouth. strongly magnetic (mag sus ranges from 6.88 to 34.00). generally unmineralized. lower contact sharp @ 75 deg TCA.</p>	
68.08	72.92	<p>NDIA Nipissing Diabase as from 0.85 to 55.50m. lower contact sharp but wavy at 65 deg TCA.</p>	
72.92	81.02	<p>OD Olivine Diabase Dyke as from 55.50 to 68.08m. lower contact sharp but irregular, generally @ 30 deg TCA.</p>	
81.02	100.00	<p>NDIA Nipissing Diabase</p>	

Darien Aggregates Inc.

Description	
as from 0.85 to 55.50m. 85.12-85.15m - narrow 2-3cm wide OD dyke @ 65 deg TCA. 85.19-85.32m - narrow 10cm wide OD dyke @ 45 deg TCA.	

Darien Aggregates Inc.

Additional Data				
From	To	Magnetic Susceptibility	Conductivity	
0.00	1.00	0.567	1000	
1.00	2.00	0.738	1000	
2.00	3.00	1.880	1000	
3.00	4.00	1.580	1000	
4.00	5.00	2.730	1000	
5.00	6.00	1.780	1000	
6.00	7.00	4.680	1000	
7.00	8.00	1.350	1000	
8.00	9.00	1.200	1000	
9.00	10.00	2.450	1000	
10.00	11.00	3.500	1000	
11.00	12.00	1.790	1000	
12.00	13.00	2.730	1000	
13.00	14.00	3.990	1000	
14.00	15.00	2.120	1000	
15.00	16.00	0.749	1000	
16.00	17.00	1.360	1000	
17.00	18.00	2.200	1000	
18.00	19.00	1.770	1000	
19.00	20.00	4.040	1000	
20.00	21.00	5.680	1000	
21.00	22.00	3.090	1000	
22.00	23.00	5.960	1000	
23.00	24.00	5.130	1000	
24.00	25.00	4.070	1000	
25.00	26.00	4.520	1000	
26.00	27.00	2.830	1000	
27.00	28.00	2.450	1000	
28.00	29.00	2.260	1000	
29.00	30.00	3.670	1000	
30.00	31.00	2.610	1000	

Darien Aggregates Inc.

Additional Data				
From	To	Magnetic Susceptibility	Conductivity	
31.00	32.00	2.580	1000	
32.00	33.00	1.840	1000	
33.00	34.00	2.000	1000	
34.00	35.00	4.030	1000	
35.00	36.00	1.100	1000	
36.00	37.00	1.230	1000	
37.00	38.00	1.730	1000	
38.00	39.00	1.000	1000	
39.00	40.00	1.150	1000	
40.00	41.00	1.410	1000	
41.00	42.00	1.560	1000	
42.00	43.00	1.330	1000	
43.00	44.00	1.790	1000	
44.00	45.00	1.180	1000	
45.00	46.00	1.390	1000	
46.00	47.00	1.340	1000	
47.00	48.00	1.270	1000	
48.00	49.00	1.150	1000	
49.00	50.00	0.847	1000	
50.00	51.00	0.919	1000	
51.00	52.00	0.849	1000	
52.00	53.00	0.687	1000	
53.00	54.00	0.505	1000	
54.00	55.00	0.510	1000	
55.00	56.00	6.880	1000	
56.00	57.00	30.100	1000	
57.00	58.00	32.000	1000	
58.00	59.00	34.000	1000	
59.00	60.00	32.900	1000	
60.00	61.00	28.200	1000	
61.00	62.00	27.800	1000	

Darien Aggregates Inc.

Additional Data				
From	To	Magnetic Susceptibility	Conductivity	
62.00	63.00	27.600	1000	
63.00	64.00	27.400	1000	
64.00	65.00	30.600	1000	
65.00	66.00	31.200	1000	
66.00	67.00	10.100	1000	
67.00	68.00	33.800	1000	
68.00	69.00	0.905	1000	
69.00	70.00	0.764	1000	
70.00	71.00	0.653	1000	
71.00	72.00	0.670	1000	
72.00	73.00	24.100	1000	
73.00	74.00	24.800	1000	
74.00	75.00	29.200	1000	
75.00	76.00	22.600	1000	
76.00	77.00	28.500	1000	
77.00	78.00	28.600	1000	
78.00	79.00	28.100	1000	
79.00	80.00	30.600	1000	
80.00	81.00	16.000	1000	
81.00	82.00	4.520	1000	
82.00	83.00	2.040	1000	
83.00	84.00	2.200	1000	
84.00	85.00	2.500	1000	
85.00	86.00	2.670	1000	
86.00	87.00	1.540	1000	
87.00	88.00	2.260	1000	
88.00	89.00	1.350	1000	
89.00	90.00	1.160	1000	
90.00	91.00	1.990	1000	
91.00	92.00	1.880	1000	
92.00	93.00	2.820	1000	

Darien Aggregates Inc.

Additional Data				
From	To	Magnetic Susceptibility	Conductivity	
93.00	94.00	2.780	1000	
94.00	95.00	1.200	1000	
95.00	96.00	1.290	1000	
96.00	97.00	1.710	1000	
97.00	98.00	1.330	1000	
98.00	99.00	1.050	1000	
99.00	100.00	0.875	1000	

Darien Aggregates Inc.

RQD					
From	To	RQD length:	Recovered length	Recovered (%)	RQD (%)
1.00	4.00	2.26	2.96	98.67	75.33
4.00	7.00	2.78	3.05	101.67	92.67
7.00	10.00	2.57	2.93	97.67	85.67
10.00	13.00	2.15	2.97	99.00	71.67
13.00	16.00	2.34	3.05	101.67	78.00
16.00	19.00	1.83	2.85	95.00	61.00
19.00	22.00	2.45	2.92	97.33	81.67
22.00	25.00	2.07	2.95	98.33	69.00
25.00	28.00	2.62	3.02	100.67	87.33
28.00	31.00	2.19	2.94	98.00	73.00
31.00	34.00	2.08	2.97	99.00	69.33
34.00	37.00	1.45	2.94	98.00	48.33
37.00	40.00	2.45	2.99	99.67	81.67
40.00	43.00	2.35	3.01	100.33	78.33
43.00	46.00	2.98	2.98	99.33	99.33
46.00	49.00	2.67	3.00	100.00	89.00
49.00	52.00	2.28	3.00	100.00	76.00
52.00	55.00	0.54	2.95	98.33	18.00
55.00	58.00	1.87	2.98	99.33	62.33
58.00	61.00	2.67	2.96	98.67	89.00
61.00	64.00	2.96	2.99	99.67	98.67
64.00	67.00	2.76	2.94	98.00	92.00
67.00	70.00	2.06	3.00	100.00	68.67
70.00	73.00	2.75	2.98	99.33	91.67
73.00	76.00	1.74	2.95	98.33	58.00
76.00	79.00	1.60	2.74	91.33	53.33
79.00	82.00	1.25	3.00	100.00	41.67
82.00	85.00	1.89	2.96	98.67	63.00
85.00	88.00	1.54	2.96	98.67	51.33
88.00	91.00	2.41	2.99	99.67	80.33
91.00	94.00	2.30	2.98	99.33	76.67

Darien Aggregates Inc.

RQD						
From	To	RQD length:	Recovered length	Recovered (%)	RQD (%)	
94.00	97.00	1.67	2.92	97.33	55.67	
97.00	100.00	2.42	3.00	100.00	80.67	

Darien Aggregates Inc.

Survey:	DA22-28	Claims title:	142795	Section:	
		Township:	Long	Level:	Surface
		Range:		Work place:	North Bay, ON.
Contractor:	Enviro North	Lot:			
Author:	Joerg Kleinboeck	Start date:	5/20/2022	Description date:	7/28/2022
		End date:	6/22/2022		

Collar

Azimuth: 45.00°
 Dip: -45.00°
 Length: 121.00

System 1

East	366185
North	5120311
Elevation	238

Down hole survey

Type	Depth	Azimuth	Dip	Invalid ...
Trushot	25.00	46.50°	-44.50°	No
Trushot	76.00	50.50°	44.20°	No
Trushot	121.00	49.60°	-43.60°	No

Type	Depth	Azimuth	Dip	Invalid ...

Number of samples: 0
 Number of QAQC samples: 0
 Total sampled length: 0.00

Description:

Casing left in hole, capped with steel flag.
 Drilling completed under permit PR-22-000034.
 Core stored at 134 Imperial Rd., North Bay, ON.

Core size: BQTK

Cemented: No

Stored: Yes

Darien Aggregates Inc.

		Description	
0.00	0.60	<p>OB Overburden Casing driven to 1.50m.</p>	
0.60	30.03	<p>NDIA Nipissing Diabase greyish-green medium to coarse grained massive gabbro. generally non-magnetic and unmineralized. fractures common throughout at various angles TCA (10, 25, 70 deg), commonly infilled with chlorite with lesser amounts of hematite and calcite. weak pervasive albitization throughout, with moderate pervasive albitization and/or potassic alteration common along margins of fractures. 6.15-7.38m - quartz-chlorite vein @ 30-40 deg TCA. 14.30-14.65m - heavily fractured. 20.00-21.50m - heavily fractured. 29.00-30.03m - heavily fractured lower contact sharp but wavy (approx. 70 deg TCA).</p>	
30.03	30.30	<p>OD Olivine Diabase Dyke dark grey to black very fine grained (chilled) mafic dyke (OD?) strongly magnetic (mag sus=29.600). no visible mineralization. lower contact sharp @ 70 deg TCA.</p>	
30.30	62.60	<p>NDIA Nipissing Diabase as from 0.60 to 30.03m. locally very weakly magnetic. 33.55-33.85m - heavily fractured. 36.65-36.82m - heavily fractured. 48.80-49.00m - heavily fractured. 48.30-48.64m - pink granitic dyke @ 20 deg TCA. 49.66-49.84m - pink granitic dyke @ 20 deg TCA. 51.12-52.00m - heavily fractured. 58.24-59.32m - pink granitic dyke @ 20 deg TCA. lower contact gradational, marked by an abrupt decrease in albitization.</p>	

Darrien Aggregates Inc.

Description	
62.60	77.50
<p>62.04-62.05m - 1-2cm dark grey to black very fine grained massive mafic dyke (OD?) @ 70 deg TCA. very weakly magnetic (mag sus=1.59)</p> <p>NDIA</p> <p>Nipissing Diabase</p> <p>dark grey fine to medium grained massive gabbro.</p> <p>generally has a higher averaged magnetic susceptibility than previous unit.</p> <p>71.42-71.47cm - 3 cm dark grey very fine grained chilled mafic dyke (OD) orientated @ 40 deg TCA.</p> <p>71.90-77.50m - 25% irregular pink granitic dykes, often containing angular fragments of NDIA.</p> <p>75.60-77.50m - late mafic dyke containing sub-rounded granitic clasts <10cm in diameter, also contains numerous irregular quartz veinlets.</p> <p>contacts are difficult to see.</p> <p>no visible mineralization.</p> <p>generally non-magnetic.</p> <p>lower contact sharp but broken over 15-20cm.</p>	
77.50	97.13
<p>OD</p> <p>Olivine Diabase Dyke</p> <p>dark grey fine to medium grained massive olivine diabase dyke.</p> <p>no visible mineralization.</p> <p>moderately to strongly magnetic.</p> <p>fractures and joints commonly rehealed with chlorite, occurring as minor surface coatings or up to 3mm of gouge.</p> <p>lower contact sharp @ 80 deg TCA, chilled over 2-3cm.</p> <p>note: sample taken from 80.00m to 86.50m for aggregate test work.</p>	
97.13	121.00
<p>NDIA</p> <p>Nipissing Diabase</p> <p>grey to green medium grained massive gabbro.</p> <p>generally unmineralized and non-magnetic.</p> <p>99.06-99.-08m - dark grey to black very fine grained (chilled) mafic dyke (OD) orientated @ 70 deg TCA.</p> <p>97.10-108.00m - weak pervasive chlorite-altered section with moderate chlorite occurring as 1-2mm fractures fills.</p> <p>114.70-117.00m - moderate to locally heavily fractured.</p> <p>116.60-116.62m - 2cm qtz vein @ 65 deg TCA.</p>	

Darien Aggregates Inc.

Additional Data				
From	To	Magnetic Susceptibility	Conductivity	
0.00	1.00	0.269	1000	
1.00	2.00	0.543	1000	
2.00	3.00	0.565	1000	
3.00	4.00	0.436	1000	
4.00	5.00	0.483	1000	
5.00	6.00	0.645	1000	
6.00	7.00	0.535	1000	
7.00	8.00	0.624	1000	
8.00	9.00	0.637	1000	
9.00	10.00	0.649	1000	
10.00	11.00	0.556	1000	
11.00	12.00	0.461	1000	
12.00	13.00	0.506	1000	
13.00	14.00	0.548	1000	
14.00	15.00	0.570	1000	
15.00	16.00	0.514	1000	
16.00	17.00	0.585	1000	
17.00	18.00	0.539	1000	
18.00	19.00	0.519	1000	
19.00	20.00	0.573	1000	
20.00	21.00	0.439	1000	
21.00	22.00	0.590	1000	
22.00	23.00	0.534	1000	
23.00	24.00	0.594	1000	
24.00	25.00	0.474	1000	
25.00	26.00	0.547	1000	
26.00	27.00	0.550	1000	
27.00	28.00	0.595	1000	
28.00	29.00	0.547	1000	
29.00	30.00	29.600	1000	
30.00	31.00	0.541	1000	

Darien Aggregates Inc.

Additional Data				
From	To	Magnetic Susceptibility	Conductivity	
31.00	32.00	0.646	1000	
32.00	33.00	0.578	1000	
33.00	34.00	0.561	1000	
34.00	35.00	0.441	1000	
35.00	36.00	0.528	1000	
36.00	37.00	0.398	1000	
37.00	38.00	0.272	1000	
38.00	39.00	0.434	1000	
39.00	40.00	0.423	1000	
40.00	41.00	0.513	1000	
41.00	42.00	0.467	1000	
42.00	43.00	0.529	1000	
43.00	44.00	0.535	1000	
44.00	45.00	0.616	1000	
45.00	46.00	0.806	1000	
46.00	47.00	0.571	1000	
47.00	48.00	0.599	1000	
48.00	49.00	0.613	1000	
49.00	50.00	0.394	1000	
50.00	51.00	1.150	1000	
51.00	52.00	1.090	1000	
52.00	53.00	1.200	1000	
53.00	54.00	1.190	1000	
54.00	55.00	0.923	1000	
55.00	56.00	0.687	1000	
56.00	57.00	0.662	1000	
57.00	58.00	0.663	1000	
58.00	59.00	0.156	1000	
59.00	60.00	1.270	1000	
60.00	61.00	1.070	1000	
61.00	62.00	1.030	1000	

Darien Aggregates Inc.

Additional Data				
From	To	Magnetic Susceptibility	Conductivity	
62.00	63.00	1.850	1000	
63.00	64.00	1.760	1000	
64.00	65.00	1.730	1000	
65.00	66.00	0.930	1000	
66.00	67.00	2.420	1000	
67.00	68.00	0.889	1000	
68.00	69.00	0.826	1000	
69.00	70.00	0.627	1000	
70.00	71.00	0.244	1000	
71.00	72.00	0.560	1000	
72.00	73.00	0.479	1000	
73.00	74.00	0.502	1000	
74.00	75.00	0.712	1000	
75.00	76.00	1.170	1000	
76.00	77.00	0.828	1000	
77.00	78.00	28.700	1000	
78.00	79.00	29.300	1000	
79.00	80.00	30.000	1000	
80.00	81.00	30.500	1000	
81.00	82.00	27.400	1000	
82.00	83.00	28.500	1000	
83.00	84.00	29.200	1000	
84.00	85.00	27.600	1000	
85.00	86.00	24.800	1000	
86.00	87.00	24.300	1000	
87.00	88.00	28.700	1000	
88.00	89.00	29.500	1000	
89.00	90.00	32.800	1000	
90.00	91.00	31.400	1000	
91.00	92.00	29.400	1000	
92.00	93.00	32.000	1000	

Darien Aggregates Inc.

Additional Data				
From	To	Magnetic Susceptibility	Conductivity	
93.00	94.00	31.300	1000	
94.00	95.00	30.400	1000	
95.00	96.00	36.800	1000	
96.00	97.00	14.800	1000	
97.00	98.00	2.860	1000	
98.00	99.00	3.060	1000	
99.00	100.00	2.670	1000	
100.00	101.00	2.810	1000	
101.00	102.00	3.110	1000	
102.00	103.00	4.020	1000	
103.00	104.00	4.120	1000	
104.00	105.00	4.800	1000	
105.00	106.00	2.560	1000	
106.00	107.00	3.060	1000	
107.00	108.00	1.010	1000	
108.00	109.00	0.971	1000	
109.00	110.00	1.760	1000	
110.00	111.00	1.950	1000	
111.00	112.00	2.180	1000	
112.00	113.00	1.230	1000	
113.00	114.00	1.610	1000	
114.00	115.00	1.810	1000	
115.00	116.00	1.040	1000	
116.00	117.00	1.900	1000	
117.00	118.00	1.400	1000	
118.00	119.00	1.700	1000	
119.00	120.00	0.908	1000	
120.00	121.00	1.210	1000	

Darien Aggregates Inc.

RQD					
From	To	RQD length:	Recovered length	Recovered (%)	RQD (%)
1.00	4.00	2.77	2.96	98.67	92.33
4.00	7.00	2.50	2.96	98.67	83.33
7.00	10.00	2.81	2.89	96.33	93.67
10.00	13.00	2.69	3.00	100.00	89.67
13.00	16.00	2.44	2.99	99.67	81.33
16.00	19.00	2.88	2.96	98.67	96.00
19.00	22.00	1.15	2.95	98.33	38.33
22.00	25.00	0.98	2.98	99.33	32.67
25.00	28.00	2.83	2.99	99.67	94.33
28.00	31.00	1.58	3.00	100.00	52.67
31.00	34.00	2.47	2.90	96.67	82.33
34.00	37.00	2.61	2.98	99.33	87.00
37.00	40.00	2.11	2.94	98.00	70.33
40.00	43.00	2.54	2.99	99.67	84.67
43.00	46.00	2.20	2.95	98.33	73.33
46.00	49.00	2.08	2.92	97.33	69.33
49.00	52.00	1.41	2.83	94.33	47.00
52.00	55.00	2.40	2.99	99.67	80.00
55.00	58.00	2.58	3.01	100.33	86.00
58.00	61.00	2.98	3.05	101.67	99.33
61.00	64.00	2.20	3.02	100.67	73.33
64.00	67.00	2.84	3.03	101.00	94.67
67.00	70.00	2.54	2.95	98.33	84.67
70.00	73.00	2.04	2.89	96.33	68.00
73.00	76.00	2.38	2.99	99.67	79.33
76.00	79.00	1.12	2.95	98.33	37.33
79.00	82.00	2.26	3.00	100.00	75.33
82.00	85.00	2.49	2.98	99.33	83.00
85.00	88.00	2.75	3.00	100.00	91.67
88.00	91.00	1.86	2.96	98.67	62.00
91.00	94.00	2.33	3.00	100.00	77.67

Darien Aggregates Inc.

RQD					
From	To	RQD length:	Recovered length	Recovered (%)	RQD (%)
94.00	97.00	2.19	2.98	99.33	73.00
97.00	100.00	1.42	3.00	100.00	47.33
100.00	103.00	1.58	2.95	98.33	52.67
103.00	106.00	1.42	2.92	97.33	47.33
106.00	109.00	2.12	3.00	100.00	70.67
109.00	112.00	1.74	2.96	98.67	58.00
112.00	115.00	1.96	2.98	99.33	65.33
115.00	118.00	1.26	3.00	100.00	42.00
118.00	121.00	2.04	2.98	99.33	68.00

Darien Aggregates Inc.

Survey:	DA22-29	Claims title:	142795	Section:	
		Township:	Long	Level:	Surface
		Range:		Work place:	North Bay, ON.
Contractor:	Enviro North	Lot:			
Author:	Joerg Kleinboeck	Start date:	6/22/2022	Description date:	7/28/2022
		End date:	6/24/2022		

Collar

		System 1	
Azimuth:	45.00°	East	366127
Dip:	-45.00°	North	5120272
Length:	130.00	Elevation	245

Down hole survey

Type	Depth	Azimuth	Dip	Invalid ...
Trushot	25.00	46.60°	-46.20°	No
Trushot	76.00	46.80°	-45.70°	No
Trushot	130.00	48.50°	-45.10°	No

Type	Depth	Azimuth	Dip	Invalid ...

Number of samples: 0
 Number of QAQC samples: 0
 Total sampled length: 0.00

Description:

Casing left in hole, capped with steel flag.
 Drilling completed under permit PR-22-000034.
 Core stored at 134 Imperial Rd., North Bay, ON.

Core size: BQTK

Cemented: No

Stored: Yes

Darien Aggregates Inc.

Description		
0.00	0.51	<p>OB Overburden Casing driven to 1.50m.</p>
0.51	40.42	<p>Gr Granite generally grey to pink coarse grained massive granite. locally weakly foliated. angular to partially digested mafic xenoliths up to 5cm common. contains <5% mafic dykes up to 80cm, but generally <5cm in width. local small epidote veinlets 1mm - 8mm in width, quartz veins up to 1cm in width. non to locally weakly magnetic. heavily fractured from 6.30 - 7.50m, 12.25-12.70m, 27.60-29.01m minor hem +/- chlorite common along fracture surfaces, hematite also common pervasively about quartz veins. no visible mineralization. lower contact sharp but broken (approx. 60 deg TCA), marked by 2cm quartz+hem veinlet.</p>
40.42	130.00	<p>NDIA Nipissing Diabase dark grey to green medium grained massive gabbro. local weak pervasive patches of albitization, commonly about chlorite-filled fractures. weakly magnetic. 82.75-84.70m - heavily fractured, multiple low angle fractures between 0 to 15 deg TCA. 92.14-92.22m - irregular black vfg massive mafic dyke, moderately magnetic. 102.45-102.48m - 3cm wide black vfg massive mafic dyke, moderately magnetic, orientated @ 70 deg TCA. 119.88-120.08m - 15cm grey very fine grained mafic dyke. margins are chilled, orientated at 40 deg TCA. non-magnetic.</p>

Darien Aggregates Inc.

Additional Data				
From	To	Magnetic Susceptibility	Conductivity	
0.00	1.00	3.520	1000	
1.00	2.00	3.110	1000	
2.00	3.00	3.560	1000	
3.00	4.00	5.790	1000	
4.00	5.00	0.702	1000	
5.00	6.00	1.930	1000	
6.00	7.00	0.558	1000	
7.00	8.00	0.575	1000	
8.00	9.00	0.941	1000	
9.00	10.00	0.608	1000	
10.00	11.00	1.210	1000	
11.00	12.00	0.808	1000	
12.00	13.00	0.238	1000	
13.00	14.00	3.000	1000	
14.00	15.00	2.570	1000	
15.00	16.00	1.890	1000	
16.00	17.00	1.070	1000	
17.00	18.00	2.130	1000	
18.00	19.00	0.423	1000	
19.00	20.00	0.561	1000	
20.00	21.00	0.625	1000	
21.00	22.00	2.060	1000	
22.00	23.00	1.130	1000	
23.00	24.00	3.100	1000	
24.00	25.00	4.680	1000	
25.00	26.00	2.270	1000	
26.00	27.00	0.588	1000	
27.00	28.00	3.100	1000	
28.00	29.00	1.240	1000	
29.00	30.00	0.415	1000	
30.00	31.00	0.543	1000	

Darien Aggregates Inc.

Additional Data				
From	To	Magnetic Susceptibility	Conductivity	
31.00	32.00	0.321	1000	
32.00	33.00	0.170	1000	
33.00	34.00	0.273	1000	
34.00	35.00	0.269	1000	
35.00	36.00	0.379	1000	
36.00	37.00	0.165	1000	
37.00	38.00	0.257	1000	
38.00	39.00	0.131	1000	
39.00	40.00	0.053	1000	
40.00	41.00	0.747	1000	
41.00	42.00	0.744	1000	
42.00	43.00	0.648	1000	
43.00	44.00	0.677	1000	
44.00	45.00	0.665	1000	
45.00	46.00	0.617	1000	
46.00	47.00	0.573	1000	
47.00	48.00	0.780	1000	
48.00	49.00	0.740	1000	
49.00	50.00	0.667	1000	
50.00	51.00	1.670	1000	
51.00	52.00	6.440	1000	
52.00	53.00	5.700	1000	
53.00	54.00	0.894	1000	
54.00	55.00	7.330	1000	
55.00	56.00	0.586	1000	
56.00	57.00	7.860	1000	
57.00	58.00	2.430	1000	
58.00	59.00	1.400	1000	
59.00	60.00	3.570	1000	
60.00	61.00	10.000	1000	
61.00	62.00	7.780	1000	

Darien Aggregates Inc.

Additional Data				
From	To	Magnetic Susceptibility	Conductivity	
62.00	63.00	7.230	1000	
63.00	64.00	3.660	1000	
64.00	65.00	2.760	1000	
65.00	66.00	1.390	1000	
66.00	67.00	8.680	1000	
67.00	68.00	11.300	1000	
68.00	69.00	9.680	1000	
69.00	70.00	6.200	1000	
70.00	71.00	2.130	1000	
71.00	72.00	2.670	1000	
72.00	73.00	5.090	1000	
73.00	74.00	1.520	1000	
74.00	75.00	4.370	1000	
75.00	76.00	3.370	1000	
76.00	77.00	2.960	1000	
77.00	78.00	2.730	1000	
78.00	79.00	1.250	1000	
79.00	80.00	5.320	1000	
80.00	81.00	2.430	1000	
81.00	82.00	2.880	1000	
82.00	83.00	0.628	1000	
83.00	84.00	0.995	1000	
84.00	85.00	1.180	1000	
85.00	86.00	1.480	1000	
86.00	87.00	0.999	1000	
87.00	88.00	1.290	1000	
88.00	89.00	7.790	1000	
89.00	90.00	7.460	1000	
90.00	91.00	5.910	1000	
91.00	92.00	5.850	1000	
92.00	93.00	6.240	1000	

Darien Aggregates Inc.

Additional Data				
From	To	Magnetic Susceptibility	Conductivity	
93.00	94.00	4.330	1000	
94.00	95.00	2.300	1000	
95.00	96.00	3.950	1000	
96.00	97.00	3.410	1000	
97.00	98.00	4.920	1000	
98.00	99.00	2.390	1000	
99.00	100.00	4.010	1000	
100.00	101.00	2.670	1000	
101.00	102.00	3.390	1000	
102.00	103.00	3.020	1000	
103.00	104.00	2.410	1000	
104.00	105.00	2.230	1000	
105.00	106.00	1.780	1000	
106.00	107.00	1.260	1000	
107.00	108.00	1.630	1000	
108.00	109.00	1.510	1000	
109.00	110.00	2.130	1000	
110.00	111.00	2.400	1000	
111.00	112.00	2.090	1000	
112.00	113.00	2.210	1000	
113.00	114.00	2.010	1000	
114.00	115.00	2.350	1000	
115.00	116.00	2.590	1000	
116.00	117.00	2.470	1000	
117.00	118.00	3.820	1000	
118.00	119.00	3.190	1000	
119.00	120.00	1.120	1000	
120.00	121.00	3.080	1000	
121.00	122.00	3.200	1000	
122.00	123.00	2.690	1000	
123.00	124.00	2.110	1000	

Darien Aggregates Inc.

Additional Data

From	To	Magnetic Susceptibility	Conductivity	
124.00	125.00	1.990	1000	
125.00	126.00	1.750	1000	
126.00	127.00	1.760	1000	
127.00	128.00	1.600	1000	
128.00	129.00	2.290	1000	
129.00	130.00	1.450	1000	

Darien Aggregates Inc.

RQD					
From	To	RQD length:	Recovered length	Recovered (%)	RQD (%)
1.00	4.00	2.79	3.00	100.00	93.00
4.00	7.00	1.98	3.00	100.00	66.00
7.00	10.00	2.38	2.80	93.33	79.33
10.00	13.00	2.25	2.90	96.67	75.00
13.00	16.00	2.66	2.98	99.33	88.67
16.00	19.00	2.41	2.98	99.33	80.33
19.00	22.00	2.74	2.96	98.67	91.33
22.00	25.00	2.20	3.00	100.00	73.33
25.00	28.00	2.18	2.94	98.00	72.67
28.00	31.00	1.47	2.98	99.33	49.00
31.00	34.00	1.90	3.01	100.33	63.33
34.00	37.00	2.44	2.96	98.67	81.33
37.00	40.00	2.87	3.00	100.00	95.67
40.00	43.00	1.50	2.95	98.33	50.00
43.00	46.00	2.00	2.93	97.67	66.67
46.00	49.00	2.52	3.00	100.00	84.00
49.00	52.00	1.84	2.97	99.00	61.33
52.00	55.00	2.51	3.00	100.00	83.67
55.00	58.00	2.75	3.00	100.00	91.67
58.00	61.00	2.64	3.00	100.00	88.00
61.00	64.00	2.99	2.99	99.67	99.67
64.00	67.00	2.57	2.98	99.33	85.67
67.00	70.00	2.81	2.94	98.00	93.67
70.00	73.00	1.45	3.01	100.33	48.33
73.00	76.00	1.40	2.99	99.67	46.67
76.00	79.00	2.36	2.99	99.67	78.67
79.00	82.00	2.61	3.01	100.33	87.00
82.00	85.00	0.84	3.00	100.00	28.00
85.00	88.00	2.49	2.99	99.67	83.00
88.00	91.00	2.69	2.98	99.33	89.67
91.00	94.00	2.41	2.99	99.67	80.33

Darien Aggregates Inc.

RQD					
From	To	RQD length:	Recovered length	Recovered (%)	RQD (%)
94.00	97.00	2.84	2.99	99.67	94.67
97.00	100.00	2.39	2.98	99.33	79.67
100.00	103.00	2.47	2.99	99.67	82.33
103.00	106.00	2.62	3.00	100.00	87.33
106.00	109.00	2.98	2.98	99.33	99.33
109.00	112.00	3.00	3.00	100.00	100.00
112.00	115.00	2.80	2.96	98.67	93.33
115.00	118.00	2.51	2.98	99.33	83.67
118.00	121.00	3.01	3.01	100.33	100.33
121.00	124.00	2.91	2.98	99.33	97.00
124.00	127.00	3.06	3.06	102.00	102.00
127.00	130.00	2.66	2.97	99.00	88.67

Appendix III

Maps (Sections and Plan Map)

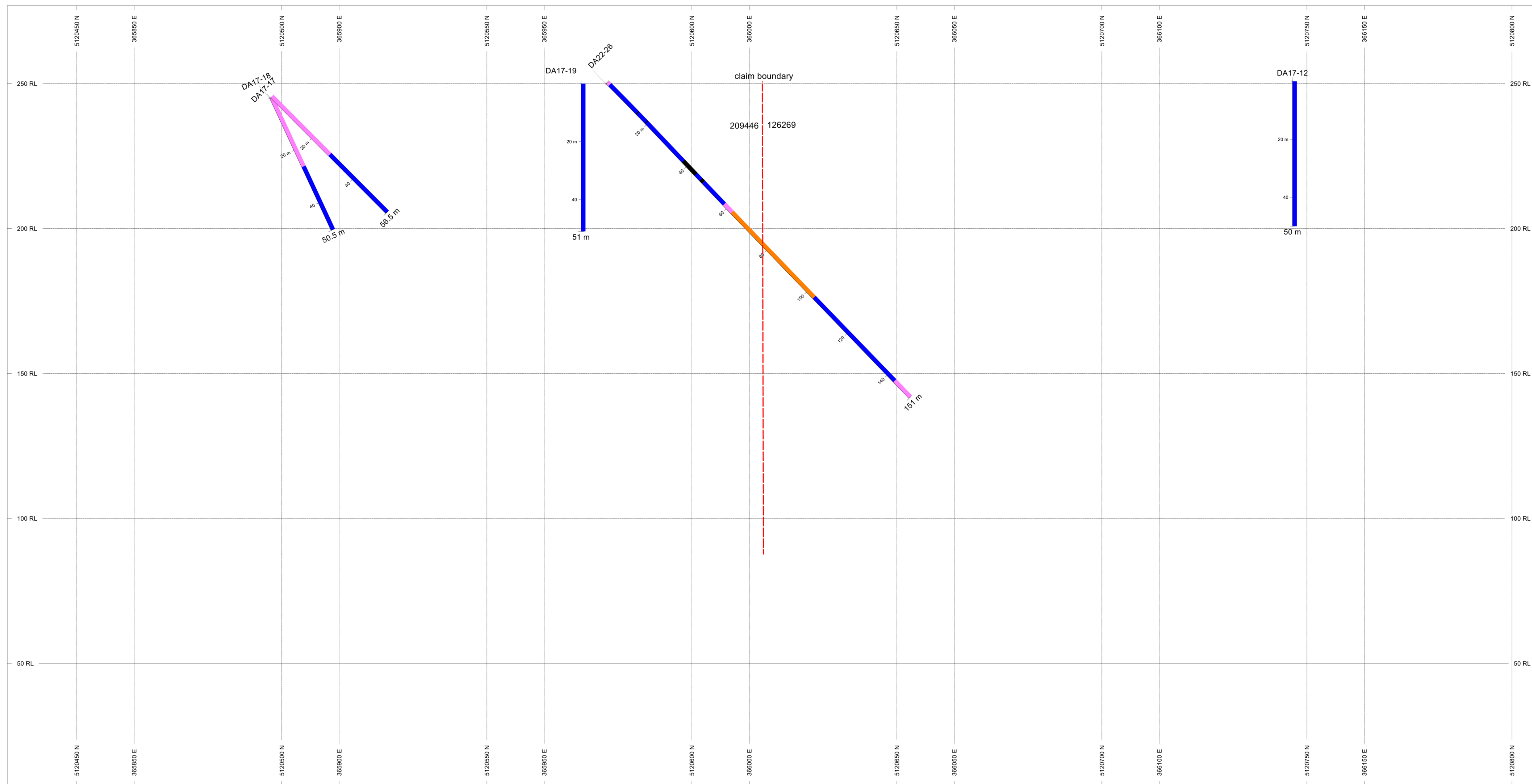
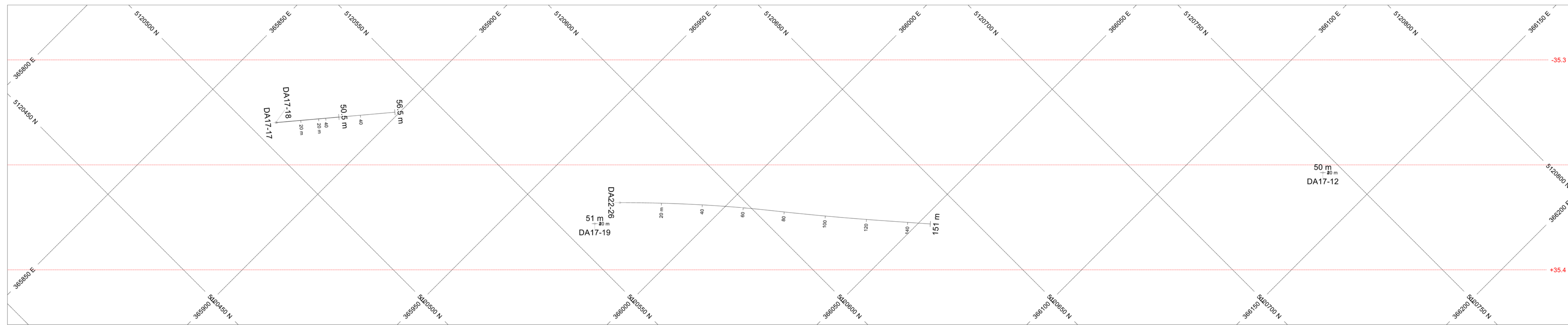

ROCK CODES	PAT	LABEL	DESCRIPTION
Litho	MD	MD	Mafic Dyke
	NDIA	NDIA	Nipissing Diabase
	OIB	OIB	Overburden
	GR	GR	Granite
	OD	OD	Olivine Diabase Dyke

SECTION SPECS:
 REF. PT. E, N 366006 m 5120620 m
 EXTENTS 528.8 m 269.1 m
 SECTION TOP, BOT 276.9 m 7.82 m
 TOLERANCE +/- 35.35 m

SCALE 1 : 750
 (m)
 NAD83 / UTM zone 17N

AZIMUTH = 45°

Darien Aggregates Inc.
 Nipissing Diabase Project
 Long Township, ON

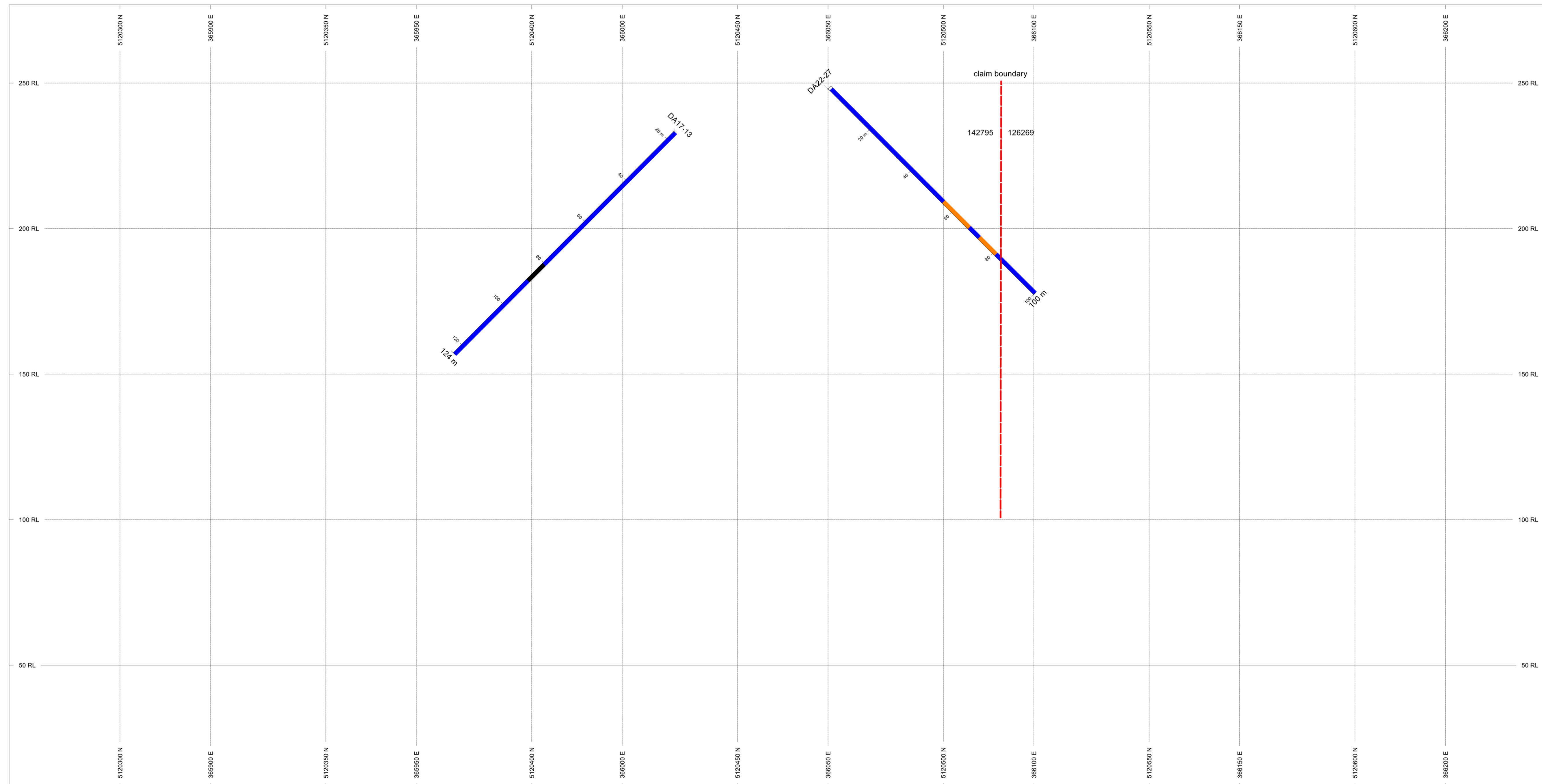
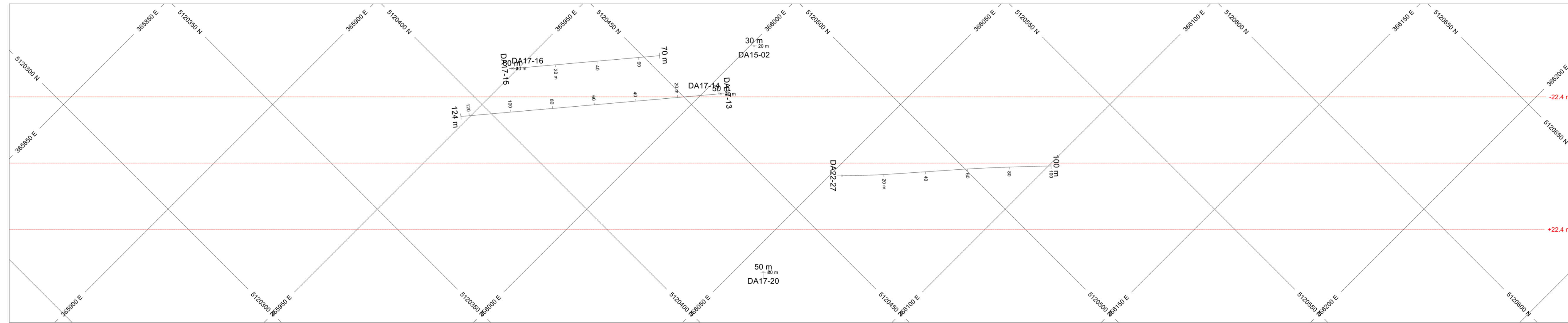

ROCK CODES	PAT	LABEL	DESCRIPTION
Litho	MD	■	Mafic Dyke
	NDIA	■	Nipissing Diabase
	OB	■	Overburden
	OD	■	Olivine Diabase Dyke

SECTION SPECS:
 REF. PT. E, N 366038 m 5120460 m
 EXTENTS 528.8 m 269.1 m
 SECTION TOP, BOT 276.9 m 7.62 m
 TOLERANCE +/- 22.4 m

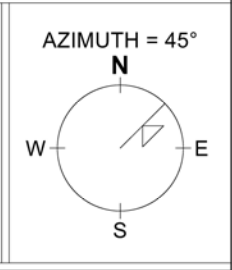
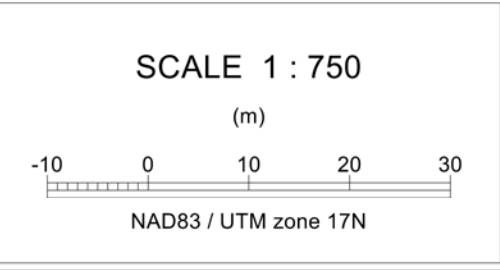

Darien Aggregates Inc.
 Nipissing Diabase Project
 Long Township, ON

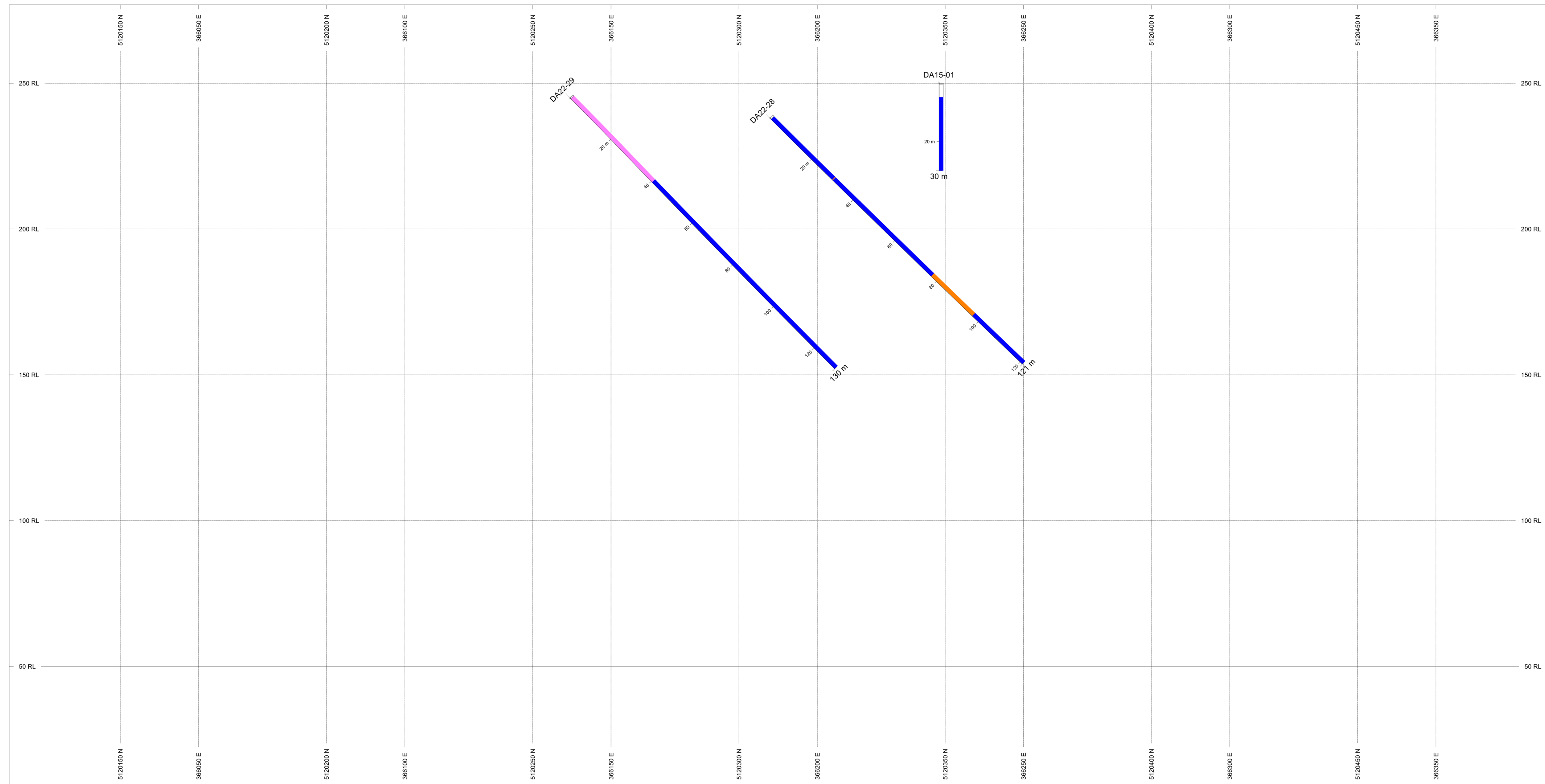
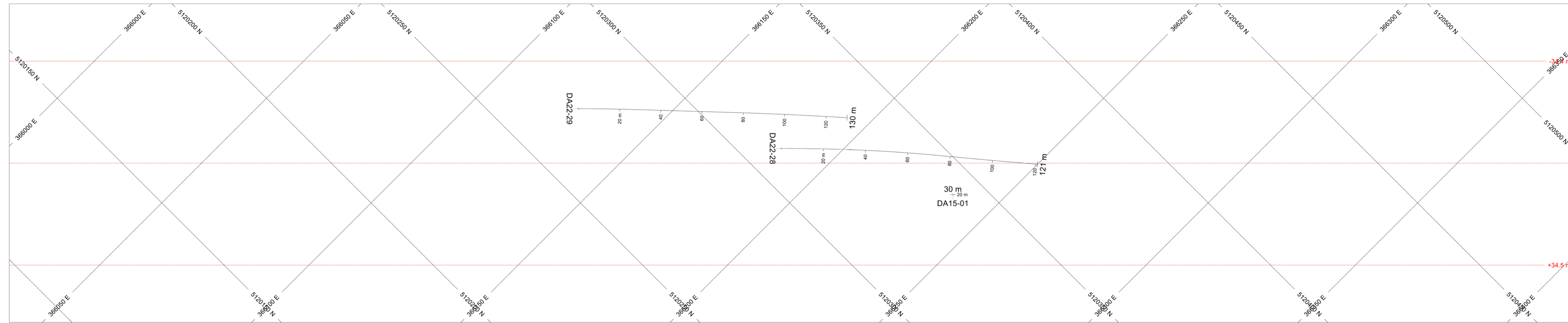

ROCK CODES	PAT.	LABEL	DESCRIPTION
Liho		FZ	Fault Zone
		NDIA	Nipissing Diabase
		OB	Overburden
		GR	Granite
		OD	Olivine Diabase Dyke

SECTION SPECS:
 REF. PT. E, N 366191 m 5120310 m
 EXTENTS 528.8 m 269.1 m
 SECTION TOP, BOT 216.9 m 7.62 m
 TOLERANCE +/- 34.45 m

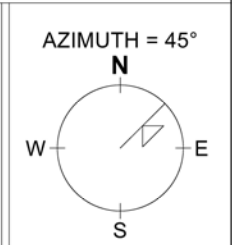
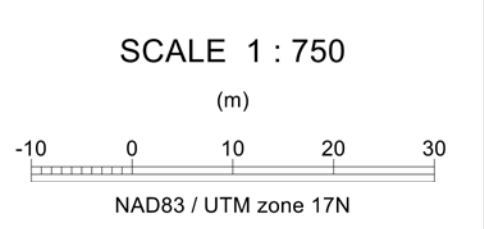

Darien Aggregates Inc.
 Nipissing Diabase Project
 Long Township, ON

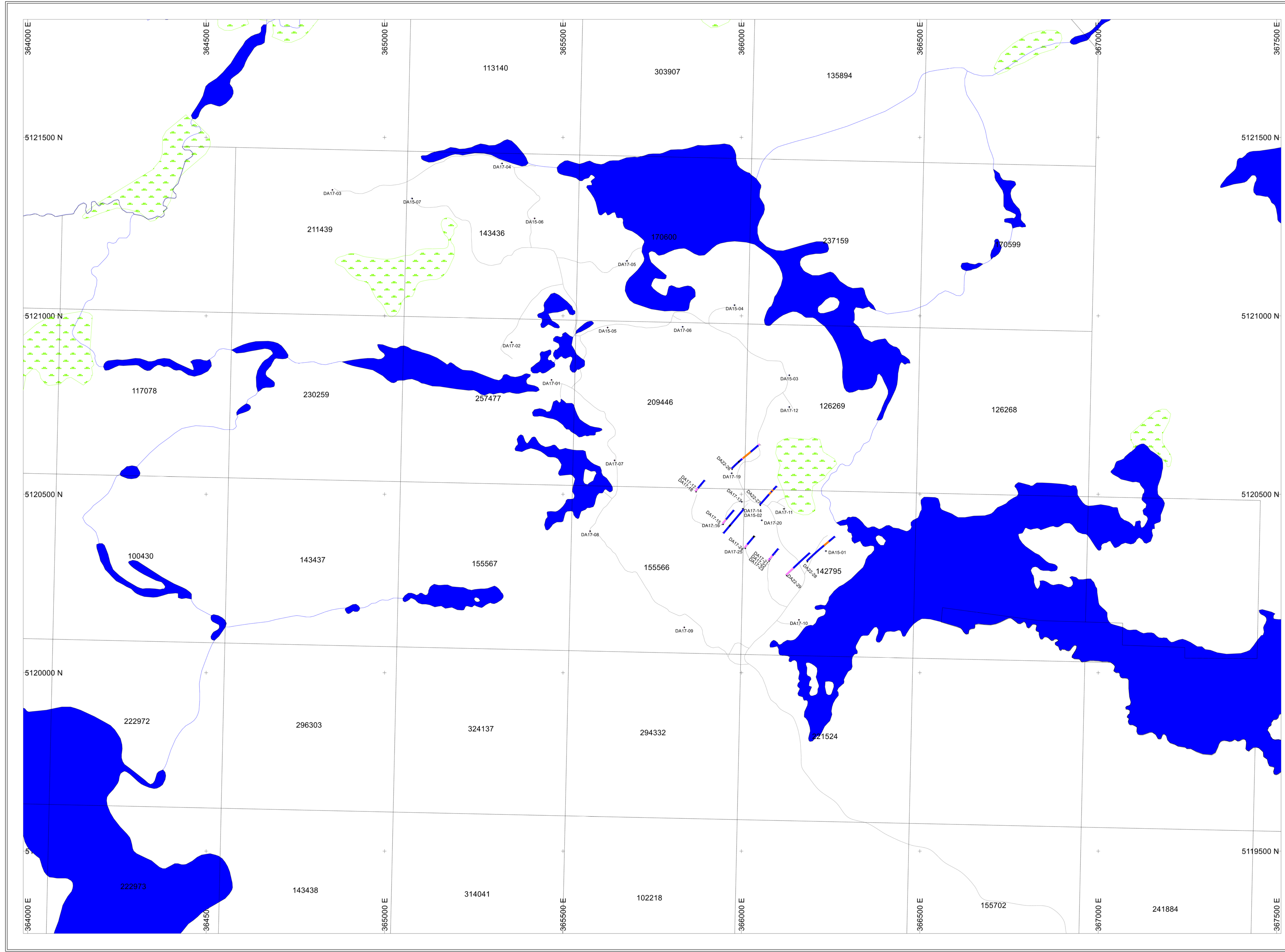

ROCK CODES	PAT	DESCRIPTION
Litho	FZ	Fault Zone
	MD	Mafic Dyke
	NDIA	Nipissing Diabase
	OB	Overburden
	QV	Quartz Vein
	GR	Granite
	OD	Olivine Diabase Dyke

PLAN SPECS:
 REF. PT. E, N 365800 m 5121000 m
 EXTENTS 3525 m 2962 m
SCALE 1 : 5000
 (m)
 NAD83 / UTM zone 17N

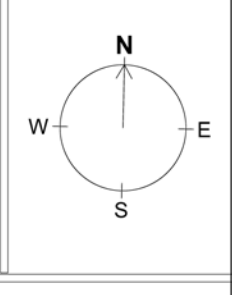

Darien Aggregates Inc.
 Nipissing Diabase Project
 DDH Collars w Traces
 Long Township, ON.

note: work completed in 2022
 covered by PR-22-000034