

We are committed to providing [accessible customer service](#).

If you need accessible formats or communications supports, please [contact us](#).

Nous tenons à améliorer [l'accessibilité des services à la clientèle](#).

Si vous avez besoin de formats accessibles ou d'aide à la communication, veuillez [nous contacter](#).

Stripping and Sampling
Miller Lake Gold Project
Nicol Township
Gowganda
Claims # 215738, 122435

July, August, September, October, November 2022



Report by Sherry Swain Nov. 14/22

Index

	Page
Access and location.....	1
Status and map.....	2
Previous work, claim map,general geology.....	3
Daily log.....	4
Stripped area map and sample descriptions.....	5
Sample descriptions.....	6
Photo.....	7
Location map of stripped area on claim.....	8
Assay results and recommendations.....	9
Photos.....	10,11,12,13
Assay Certificates	

Access and Location

The claims are located via Hwy 560 west about 8 km. from the hamlet of Gowganda.

There is a logging road 2 km east of Gowganda which leads to the northern boundary of the claim group.

The claims are adjoining patented mining claims.



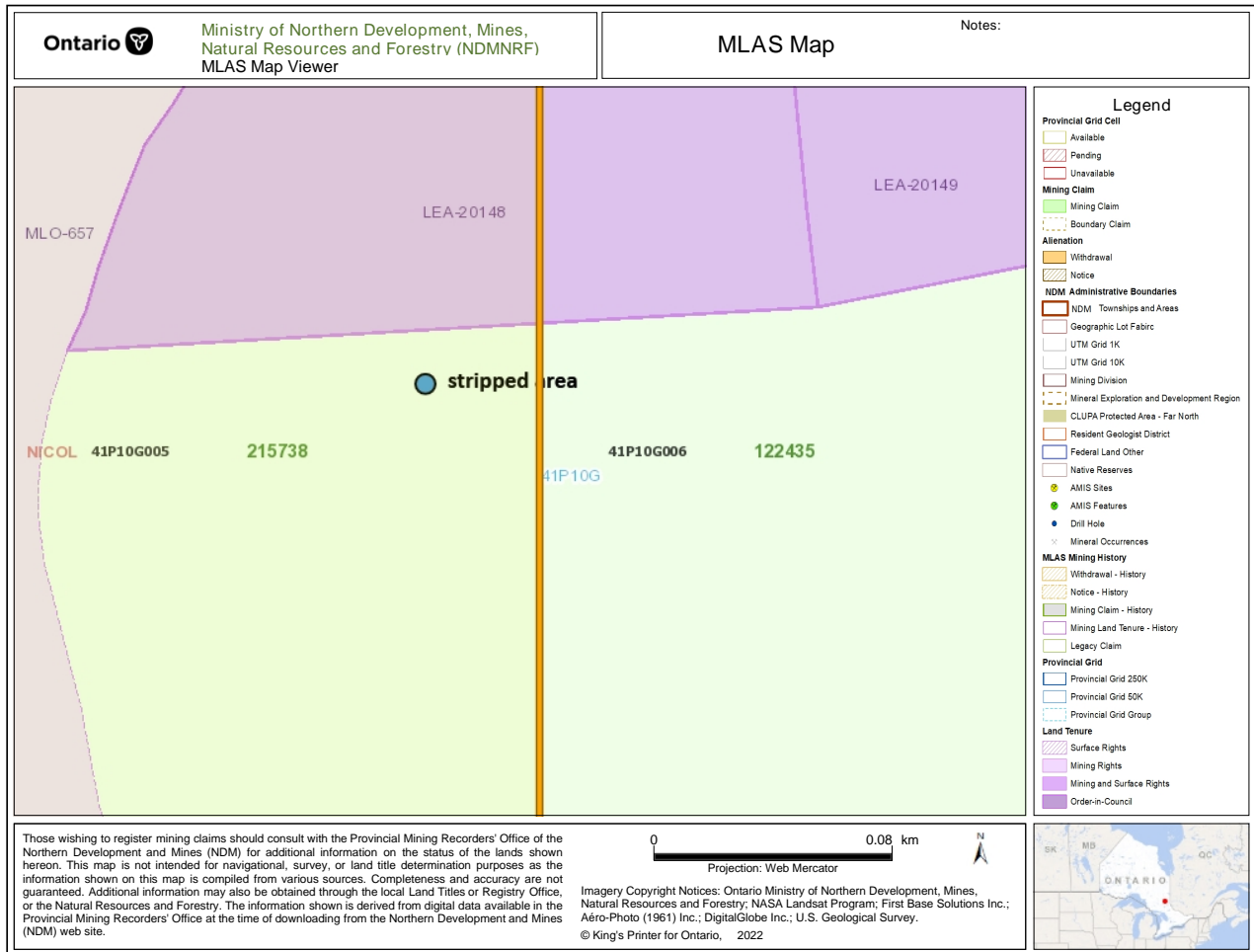

Status

The claims are held 100% in the name of Sherry Swain A48087.

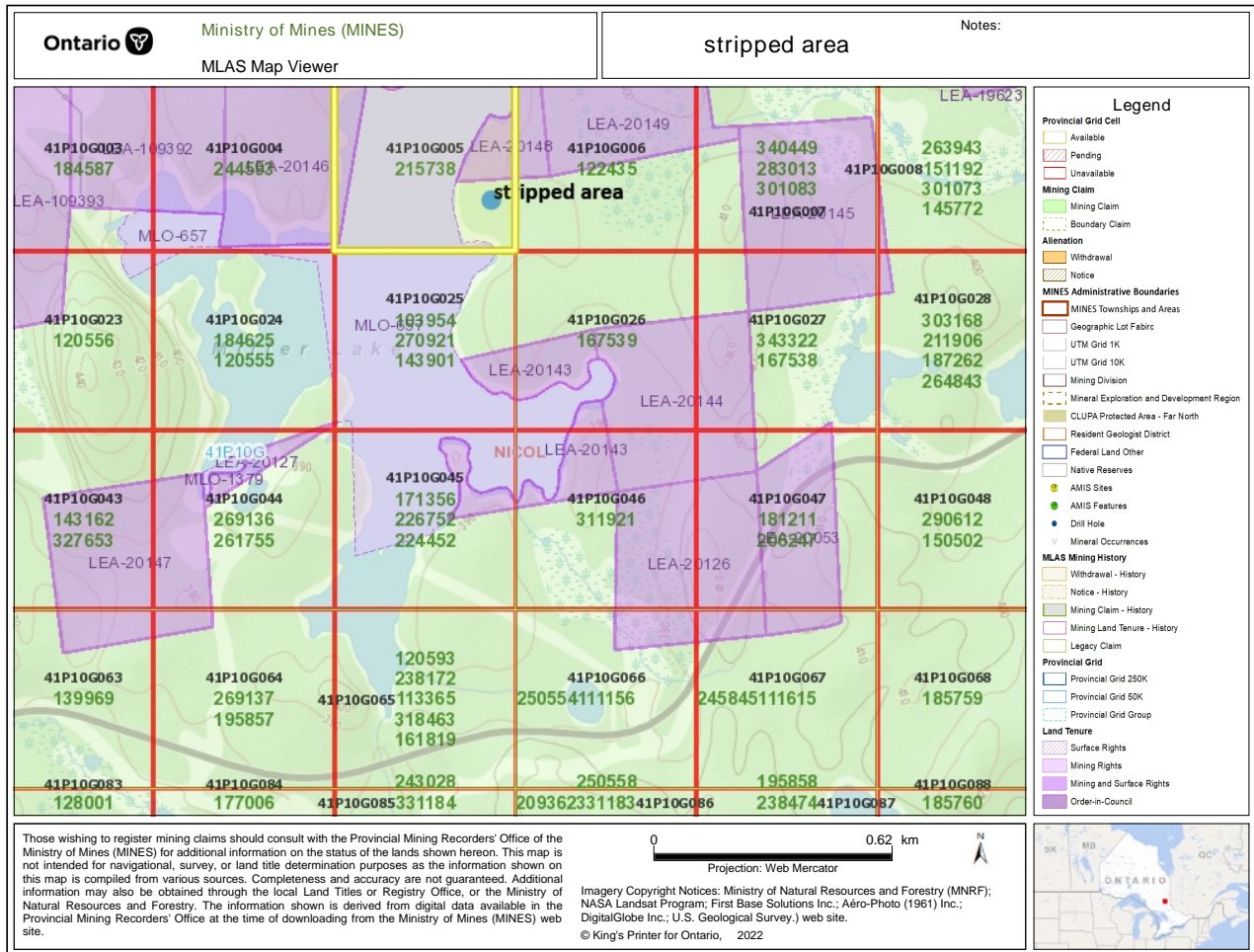

Previous work

Two holes were drilled in the 1950's under the Millcrest -Brunhurst option. There was no drill log available.

The only other recorded work was by the current claimholder.

General Geology

The claims are underlain by early Precambrian Metavolcanic rocks.

This assemblage has been intruded by Matachewan diabase dykes striking north-south.

Coarse grained metavolcanics are found throughout the sequence. One thin section contained about 20% percent carbonate minerals. (OGS report 175)

Pyroclastic units and amygdaloidal lavas occur locally in the metavolcanics and pillow tops east of the south end of Miller lake.

Daily Log

July 24/22- site prep. Flagging and blazing trail to location to be stripped and cutting brush. 521070 e, 5278983 n. from logging road. 9 am to 3 pm.
see Map 1

Aug. 2/22- 7am to 10 am. Walked excavator into stripping site. Supervised the stripping from 10 am to noon. Cleaned rock from noon until 4 pm.

Aug.5/22- Helper was Fred Swain licence A48046. Started with helper cleaning rock and sampling at 8 am and finished at 4 pm.

Sept.2/22- Prospected, cleaned and sampled rock at site from 9am until 4 pm.

Oct.4/22-Prospected , cleaned and sampled stripped area. 8 am until 3pm.

Oct.11/22-Started mapping site and sampled. 8:30 am till 3 pm.

Oct.24/22- Finished mapping site and sampled. 9:30 until 4pm.

Excavator used for stripping was a Deere 120 and was operated by Al Tulpin.

Exploration permit number PR-21-000030

Equipment used for hand grubbing was shovel, brooms, pick and sledge hammers.

Hand grubbing was done by Fred Swain and Sherry Swain.

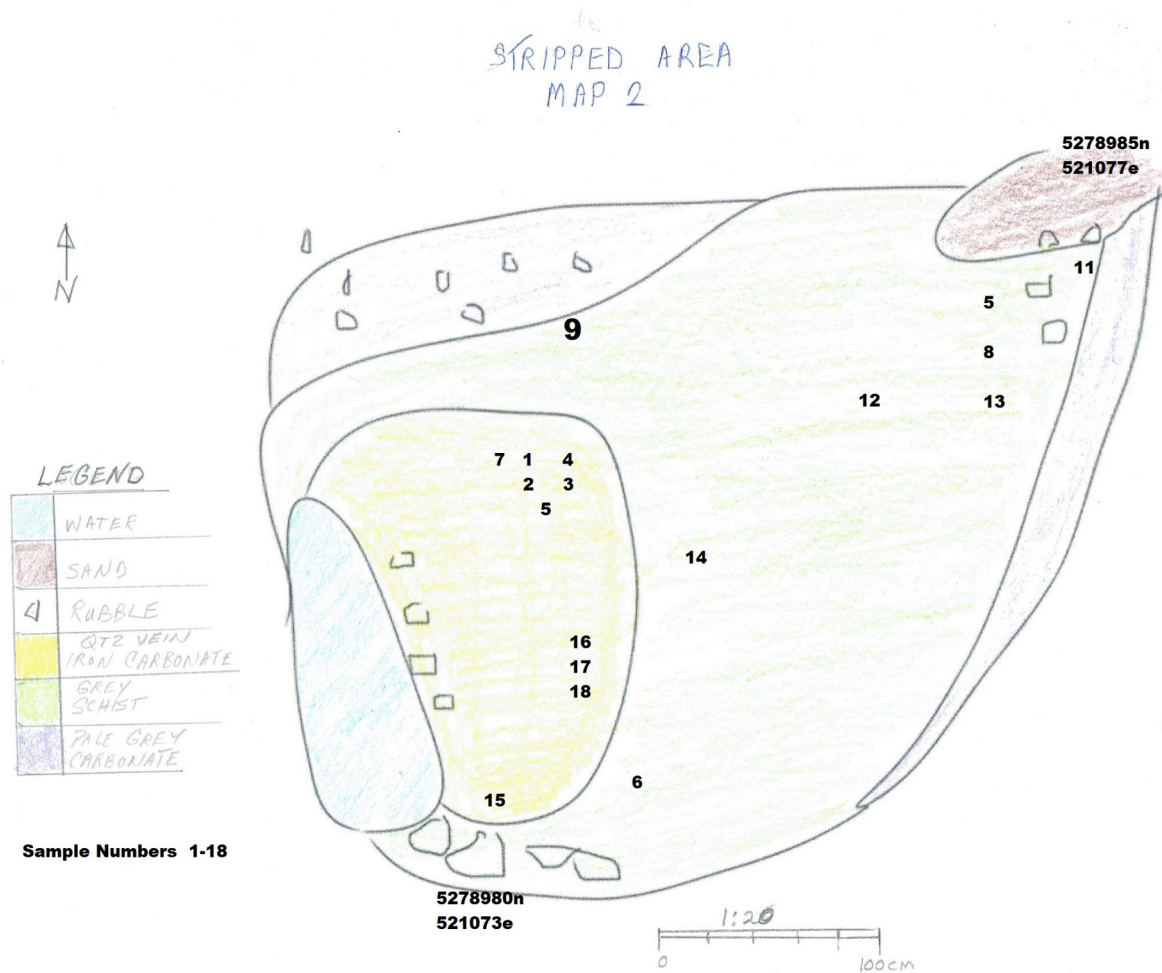

Soil was removed and broken bedrock underneath was piled to the side.

1.25 cubic meters of rock and dirt was piled from the 5 m by 5 m stripped area.

Sample Descriptions in Stripped area

1. Rusty altered grey carbonate with minor pyrite
2. Quartz calcite vein with chalcopyrite cubes and rust, pink colour
3. Pink/grey carbonate with pyrite cubes and rusty veinlets
4. Quartz calcite vein with small pyrite cubes
5. Rusty veinlets in quartz calcite

6. Light grey schist with narrow (1cm) calcite stringers. Chalcopyrite cubes and fine pyrite
7. Pink grey carbonate with fine pyrite in rusty veinlets
8. Light grey schist with fine pyrite
9. Fuchsite blebs in grey carbonate with minor chalcopyrite in veinlets
10. lost
11. Light grey schist with 30% chalcopyrite cubes, 2680 ppb, Au
12. Rusty altered grey carbonate and fine pyrite
13. Light grey schist with 10% chalcopyrite cubic and fine pyrite
14. Light grey carbonate with quartz blebs and 30% fine silver pyrite
15. Orange rusty quartz with quartz blebs and fine silver pyrite
16. Pink grey carbonate with 3 cm. wide quartz vein with chalcopyrite cubes
17. Grey carbonate with quartz veinlets containing fine silver pyrite,
310 ppb, Au
18. Light grey carbonate with rusty quartz veinlets and fine silver pyrite
200 ppb, Au

Schist -sample 11 area – 2680 ppb Au



STRIPPING CLAIM 215738
 AUGUST 2, 2022
 MAP 1



LEGEND

	STRIPPED AREA
	RUBBLE
	WATER
	FOREST
	CLAIM LINE
	MATCHEWAN DIABASE
	CARBONATE ALTERATION
	SCHIST

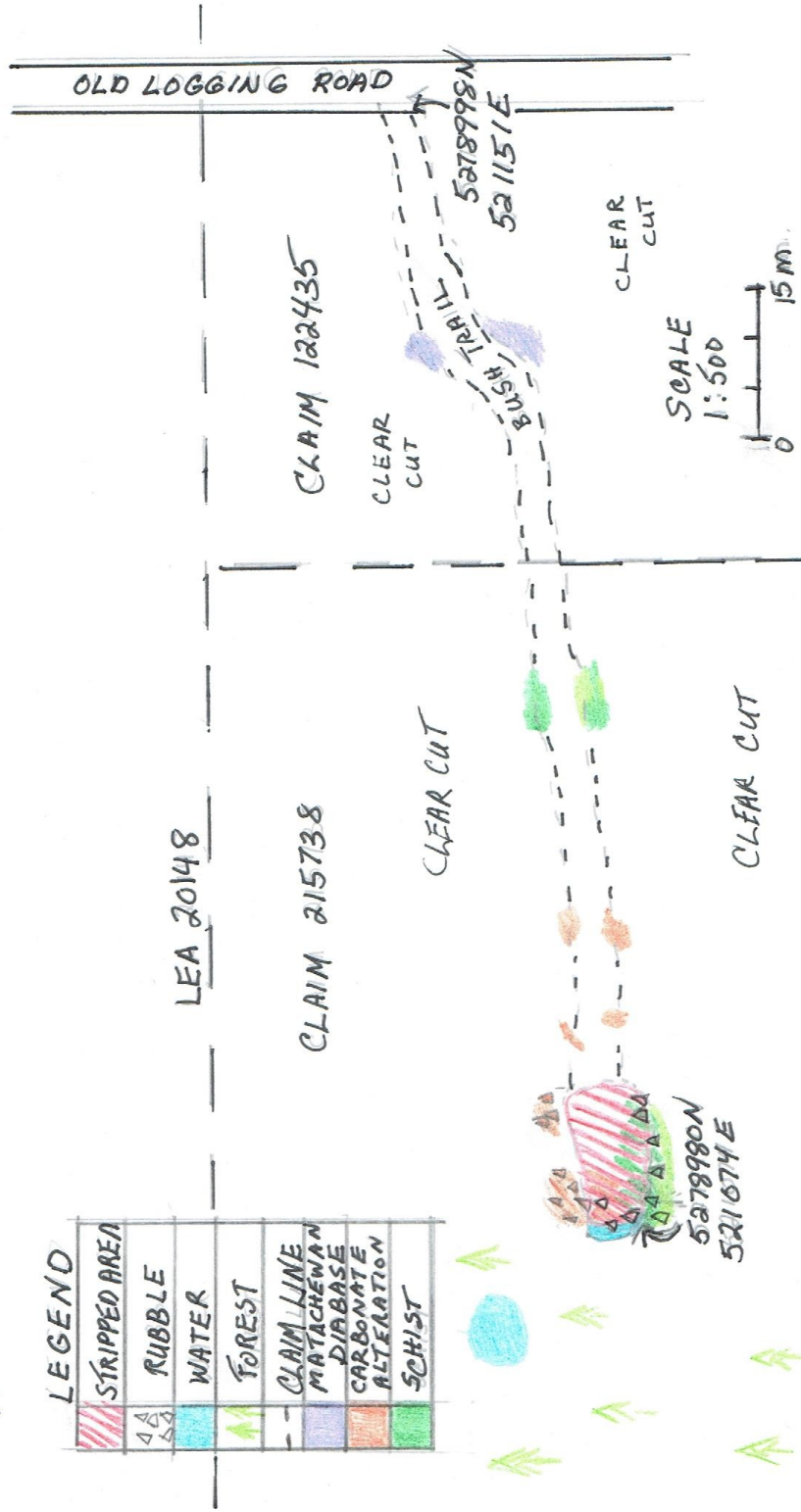

Assays

MLS 02- 30 ppb Au
MLS 08- 70 ppb Au
MLS 09- 40 ppb Au
MLS 11- 2680 ppb Au
MLS 13- 20 ppb Au
MLS 14- 240 ppb Au
MLS 15- 20 ppb Au
MLS 16- 50 ppb Au
MLS 17- 310 ppb Au
MLS 18- 200 ppb Au

Recommendations

Further sampling and assaying of the stripped area as well as washing of rock. The anomalous gold values of previous assaying, 7.8 g/M as well as the sample 2680 ppbAu make it an interesting showing and in my opinion worthwhile.













Established 1928

Swastika Laboratories Ltd

Assaying - Consulting - Representation

Page 1 of 1

Assay Certificate

Certificate Number: 22-5236

Company: **Sherry Swain**

Project:

Report Date:

17-Oct-22

Attn: **Sherry Swain**

We hereby certify the following Assay of 3 rock/grab samples
submitted 13-Oct-22 by Sherry Swain

Sample Number	Au FA-MP ppb
Blank Value	< 2
OREAS L13	1270
MLS 13	20
MLS 14	240
MLS 15	20

Certified by

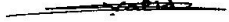
Valid Abu Ammar

1 Cameron Ave., P.O. Box 10, Swastika, Ontario P0K 1T0
Telephone (705) 642-3244 Fax (705) 642-3300

Company: **Sherry Swain**

Project:

Report Date: 30-Aug-22

Attn: **Sherry Swain**

We hereby certify the following Assay of 3 rock/grab samples submitted 26-Aug-22 by Sherry Swain

Sample Number	Au FA-MP ppb
Blank Value	10
OXG179	1080
MLS 02	30
MLS 08	70
MLS 09	40

Certified by _____

Valid Abu Ammar



Established 1928

Swastika Laboratories Ltd

Assaying - Consulting - Representation

Page 1 of 1

Assay Certificate

Certificate Number: 22-5431

Company: **Sherry Swain**

Project:

Report Date: 28-Oct-22

Attn: **Sherry Swain**

We hereby certify the following Assay of 3 rock/grab samples submitted 25-Oct-22 by Sherry Swain

Sample Number	Au FA-MP ppb
Blank Value	10
OREAS L13	1300
MLS16	50
MLS17	310
MLS18	200

Rush

Certified by

Valid Abu Ammar

1 Cameron Ave., P.O. Box 10, Swastika, Ontario P0K 1T0
Telephone (705) 642-3244 Fax (705) 642-3300



Swastika Laboratories Ltd

Assaying - Consulting - Representation

Page 1 of 1

Assay Certificate

Certificate Number: 22-4749

Company: **Sherry Swain**
Project:
Attn: **Sherry Swain**

Report Date: **13-Sep-22**

We hereby certify the following Assay of 1 rock/grab samples
submitted 08-Sep-22 by Sherry Swain

Sample Number	Au FA-MP ppb
Blank Value	10
OREAS L13	1300
MLS 11	2680

Certified by _____

Valid Abu Ammar

1 Cameron Ave., P.O. Box 10, Swastika, Ontario P0K 1T0
Telephone (705) 642-3244 Fax (705) 642-3300

Miller Lake Stripping , Nicol Twp. 2022

Category	Date	Description	Amounts	Totals
Site prep	07/24/22	trail cutting to site	300	\$300.00
supervising stripping	08/02/22	site supervisorsite supervisor	300	\$300.00
cleaning stripped area	08/05/22	2 persons cleaning/sampling 2x300		\$600.00
sampling and cleaning	09/02/22	sampling and cleaning	300	\$300.00
sampling cleaning	10/04/22	prospected and sampled	300	\$300.00
sampling mapping	10/11/22	prospected anmapped	300	\$300.00
mapping	10/24/22	mapping	300	\$300.00
assay	09/08/22			\$90.00
assay	10/31/22			\$108.00
assay	09/14/22			\$30.00
assay	10/18/22			\$90.00
food	22/10/14		4.69	
food	10/21/22		16.93	\$21.62
Mileage 7 days @ 36km x.75		to claim and return		\$189.00
Gas	22/10/25	take samples to lab in Swastika		\$38.65
excavator	08/02/22			\$500.00
postal	22/09/06	assays	18.48	
	22/10/12	assays	21.46	\$39.94

Sheet1

report writing

11/14/22

\$300.00

Total

\$3,807.21