

We are committed to providing [accessible customer service](#).

If you need accessible formats or communications supports, please [contact us](#).

Nous tenons à améliorer [l'accessibilité des services à la clientèle](#).

Si vous avez besoin de formats accessibles ou d'aide à la communication, veuillez [nous contacter](#).

Grass Roots Prospecting

Preacher Road Prospecting & Sampling for AU

Owners- Ed Barkauskas (Client No. 104892)

Sherridon Johnson (Client No.149509)

Author-Ed Barkauskas

Completion date of report- November 15 ,2022

The Job was-- 3 days in the field program and completed by 2 prospectors, from May 17th to November 15th. Ed Barkauskas (Lic. S7082- PH 807 737 4460)
Sherridon Johnson (Lic. 1000862 PH 807 220 3950)

This was performed in the Kenora mining division, Lower Manitou Lake area, on Claim numbers-705176,705177,716363

This is a remote area and not easily accessed. It can be accessed by Hwy 72 to Hwy 502 then onto Preacher Road, a logging road approximately 200 kilometers from Sioux lookout and from that point walk through old cutover and wet lowlands. We choose to access this area by road (See map insert). A total of 14 grab samples were taken in various areas along the above-mentioned claim blocks (3 Claim blocks). These samples will be analyzed for gold by Act labs in Dryden. No permits or plan was required for this type of exploration.

DAILY LOG Note all GPS locations of samples will be shown on a separate document. (Datum Nad 83 with Latitude & Longitude)

May 17th Began prospecting area and took 4 grab samples for assays. Samples were found in a Mafic structure on top and blow ridges, in a Felsic porphyry with quartz flooding and heavily laden with sulphides CPY 1 %, PY 2 % slightly magnetic-2 Prospectors.

August 17th Traversed to same location as months before then started prospecting the area. Took 5 Grab samples for assaying. Found in a Mafic structure along bottom ridge, with QTZ stringers and QTZ eyes, laden with sulphides, CPY 1%, PY 3%. (See map insert)- 2 Prospectors.

October 20th Traversed into claims. Took 5 grab samples, Samples were in mafic structure, massive sulphides, looked cherty, CPY 1%, PY 2% magnetic Partite – (See map insert) - 2 prospectors

October 25 and August 26th Transport samples to Dryden Ontario from Sioux lookout by truck to Act labs for analysis. 1 prospector

Traverses will be shown on maps with samples. Samples were extracted by a sledge/hoe implement with little impact to the environment. Each sample area was marked with flagging tape and GPS catalogued on a Word spread sheet or Excel spread sheet.

RESULTS from: The assays indicated large amounts of gold in 6 out of the 14 samples taken. Two of these samples were close to 5000 ppb This would warrant further assays. Furthermore, this is a small representative area sampled on these claim blocks. The other samples were relatively high in gold ppm numbers, which further excites me to keep on prospecting these claims. There are more indicators of gold in this rock structure, which would warrant further exploration on remaining un explored claim blocks. Map datum used was NAD 83 and Lats. & Longs. and UTM coordinates. Several maps enclosed indicating, Track log by dates, overview of route taken by truck to access the claims to Preacher Road. Enclosed is an XCEL spread sheet of an overview of locations, dates, descriptions of sampled area. Claims prospected are owned by Ed Barkauskas and Sherridon Johnson. Any questions please call ED B. 807 737 4460



Report No.: A22-12411
Report Date: 09-Sep-22
Date Submitted: 26-Aug-22
Your Reference: Preacher

Ed Barkauskas

ATTN: Ed Barkauskas

CERTIFICATE OF ANALYSIS

5 Core samples were submitted for analysis.

Table with 3 columns: Analytical package(s) requested, Testing Date, and details for samples 1A2-Dryden and 1A3-Dryden.

REPORT A22-12411

This report may be reproduced without our consent. If only selected portions of the report are reproduced, permission must be obtained.

Notes:

If value exceeds upper limit we recommend reassay by fire assay gravimetric-Code 1A3



CERTIFIED BY:

Handwritten signature of Elitsa Hrischeva

Elitsa Hrischeva, Ph.D.
Quality Control Coordinator

ACTIVATION LABORATORIES LTD.
264 Government Road, Dryden, Ontario, Canada, P8N 2R3
TELEPHONE +807 223-6168 or +1.888.228.5227 FAX +1.905.648.9613
E-MAIL Dryden@actlabs.com ACTLABS GROUP WEBSITE www.actlabs.com

Analyte Symbol	Au	Au
Unit Symbol	ppb	g/tonne
Lower Limit	5	0.03
Method Code	FA-AA	FA- GRA
1031984	6	
1031985	< 5	
1031986	< 5	
1031987	2670	
1031988	> 5000	15.7

Analyte Symbol	Au	Au
Unit Symbol	ppb	g/tonne
Lower Limit	5	0.03
Method Code	FA-AA	FA- GRA
OREAS 238 (Fire Assay) Meas	2960	
OREAS 238 (Fire Assay) Cert	3030	
Oreas E1336 (Fire Assay) Meas	504	
Oreas E1336 (Fire Assay) Cert	510.000	
OREAS 258 (Fire Assay) Meas		11.0
OREAS 258 (Fire Assay) Cert		11.15
OREAS L15 Meas		7.28
OREAS L15 Cert		7.18
Method Blank	< 5	
Method Blank		< 0.03



Report No.: A22-15634
 Report Date: 14-Nov-22
 Date Submitted: 25-Oct-22
 Your Reference:

Ed Barkauskas

CERTIFICATE OF ANALYSIS

5 Core samples were submitted for analysis.

The following analytical package(s) were requested:		Testing Date:
1A2-Dryden	QOP AA-Au (Au - Fire Assay AA)	2022-11-04 20:24:54
1A3-Dryden	QOP AA-Au (Au - Fire Assay Gravimetric)	

REPORT **A22-15634**

This report may be reproduced without our consent. If only selected portions of the report are reproduced, permission must be obtained. If no instructions were given at time of sample submittal regarding excess material, it will be discarded within 90 days of this report. Our liability is limited solely to the analytical cost of these analyses. Test results are representative only of material submitted for analysis.

Notes:

If value exceeds upper limit we recommend reassay by fire assay gravimetric-Code 1A3



CERTIFIED BY:

Rob Hoffman
 Region Manager

ACTIVATION LABORATORIES LTD.
 264 Government Road, Dryden, Ontario, Canada, P8N 2R3
 TELEPHONE +807 223-6168 or +1.888.228.5227 FAX +1.905.648.9613
 E-MAIL Dryden@actlabs.com ACTLABS GROUP WEBSITE www.actlabs.com

Analyte Symbol	Au
Unit Symbol	ppb
Lower Limit	5
Method Code	FA-AA
PR-OCT 20	62
PR1-OCT 20	9
PR2-OCT 20	4840
PR3-OCT 20	65
SH PR4-OCT 20	207

Analyte Symbol	Au
Unit Symbol	ppb
Lower Limit	5
Method Code	FA-AA
OREAS 238 (Fire Assay) Meas	2990
OREAS 238 (Fire Assay) Cert	3030
Oreas E1336 (Fire Assay) Meas	510
Oreas E1336 (Fire Assay) Cert	510.000
Method Blank	< 5

ID	lat	lon	ele	time	magvar	name
1	49.28852	-92.767	478.3333	2022-10-21T19:01:14	PR	OCT20
2	49.28842	-92.7673	478.3083	2022-10-21T19:23:50	PR1	OCT20
3	49.28855	-92.7668	474.3917	2022-10-21T19:35:53	PR2	OCT20
4	49.28847	-92.7669	473.4542	2022-10-21T19:47:17	PR3	OC20
5	49.28854	-92.7668	478.8375	2022-08-17T19:18:40	PR987	
6	49.28855	-92.7668	479.5106	2022-08-17T19:42:14	PR988	
1	49.28889	-92.7658	475.9061	2022-08-17T18:37:13	EBPR2	
2	49.28886	-92.7659	476.5265	2022-08-17T18:52:06	EBPR3	
3	49.28891	-92.7658	476.4028	2022-08-17T18:04:05	EBPREACH	
1	49.28884	-92.7657	475.4925	2022-05-17T18:00:00	743006	
2	49.28882	-92.7657	475.4929	2022-05-17T18:05:05	743007	
3	49.28886	-92.7658	475.4928	2022-05-17T18:15:00	743008	
4	49.28887	-92.7658	475.4927	2022-05-17T18:30:00	743009	

Final Report
Activation Laboratories

Report Number: A22-06594

Report Date: 20/5/2022

Analyte Symbol	Au	Au
Unit Symbol	ppb	g/tonne
Detection Limit	5	0.03
Analysis Method	FA-AA	FA-GRA
743006	5	
743007	< 5	
743008	> 5000	6.99
743009	5	

} Preacher
sh

15 0517035 UTM
5459592

49.28884 - 92.7657 Lat + Long

May 17 / 2022
Date Sample taken

Sample Area Preacher Rd
By Dates taken 2022

Total 14 Samples Taken



Backroad Mapbooks ON v7.0
Ontario Backroad GPS Maps v7
© Backroad Mapbooks 2016

2022-11-25 4:22:20 AM

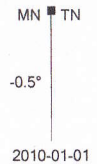
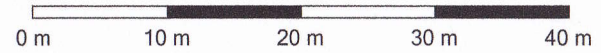

GARMIN

Sample Area Preacher Rd
By Dates taken 2022

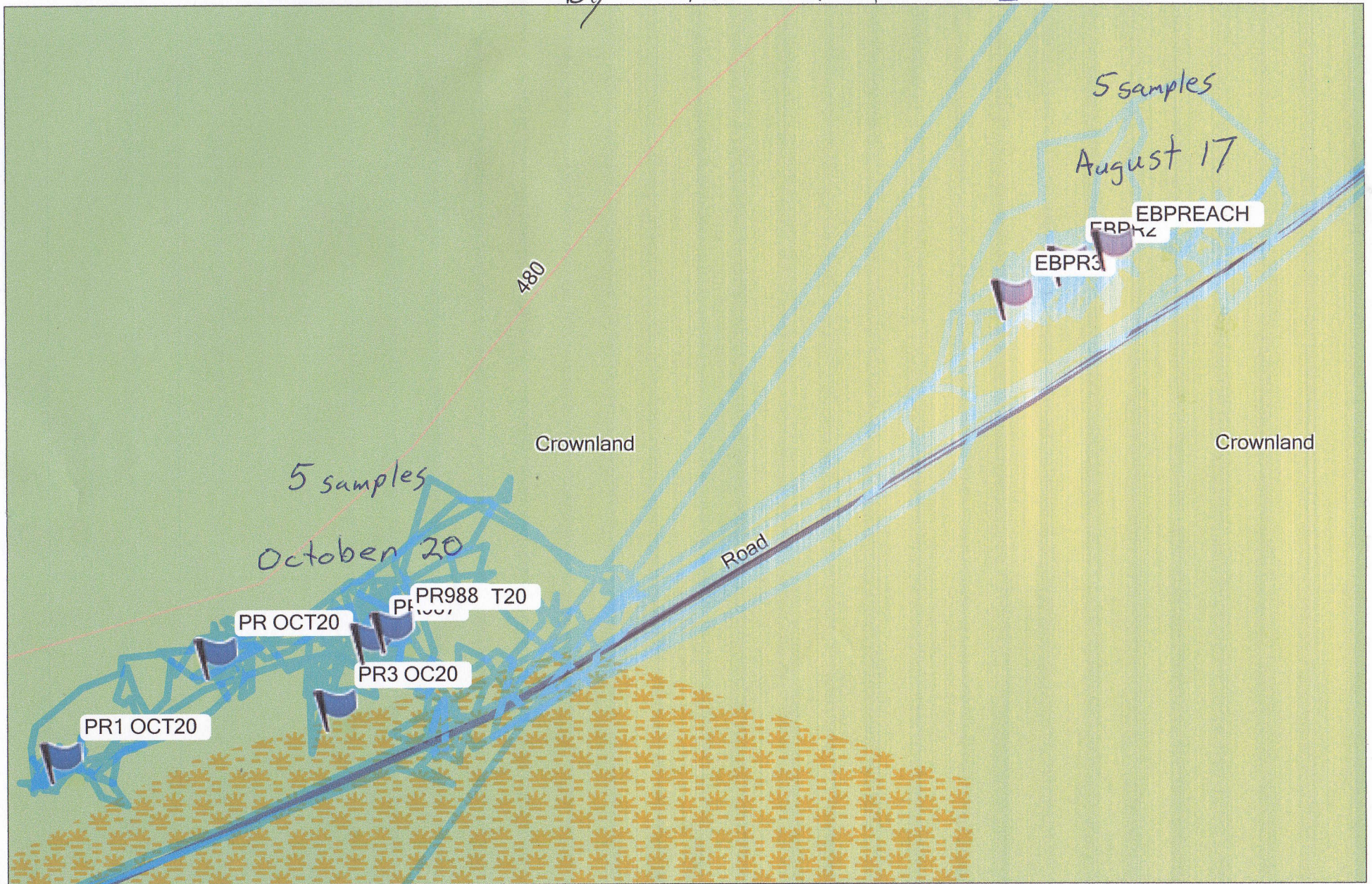

11 Claim Blocks Barkauskas / Johnson



Ministry of Mines (MINES)

MLAS Map Viewer

MLAS Map

Notes:

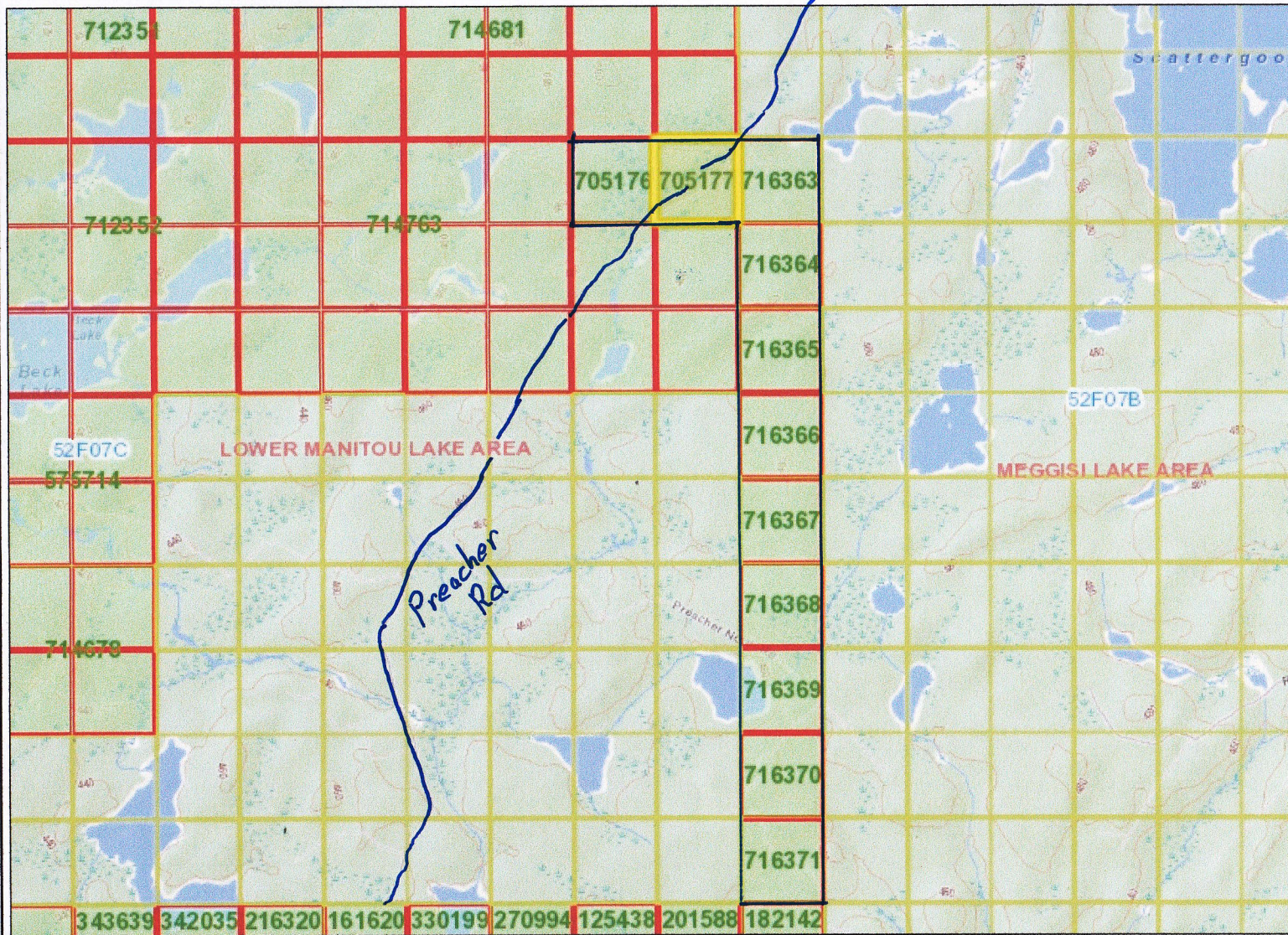

- ### Legend
- Provincial Grid Cell**
 - Available
 - Pending
 - Unavailable
 - Mining Claim**
 - Mining Claim
 - Boundary Claim
 - Alienation**
 - Withdrawal
 - Notice
 - MINES Administrative Boundaries**
 - MINES Townships and Areas
 - Geographic Lot Fabric
 - UTM Grid 1K
 - UTM Grid 10K
 - Mining Division
 - Mineral Exploration and Development Region
 - CLUPA Protected Area - Far North
 - Resident Geologist District
 - Federal Land Other**
 - Native Reserves
 - AMIS Sites
 - AMIS Features
 - Drill Hole
 - Mineral Occurrences
 - MLAS Mining History**
 - Withdrawal - History
 - Notice - History
 - Mining Claim - History
 - Mining Land Tenure - History
 - Legacy Claim
 - Provincial Grid**
 - Provincial Grid 250K
 - Provincial Grid 50K
 - Provincial Grid Group
 - Land Tenure**
 - Surface Rights
 - Mining Rights
 - Mining and Surface Rights
 - Order-in-Council

Those wishing to register mining claims should consult with the Provincial Mining Recorders' Office of the Ministry of Mines (MINES) for additional information on the status of the lands shown hereon. This map is not intended for navigational, survey, or land title determination purposes as the information shown on this map is compiled from various sources. Completeness and accuracy are not guaranteed. Additional information may also be obtained through the local Land Titles or Registry Office, or the Ministry of Natural Resources and Forestry. The information shown is derived from digital data available in the Provincial Mining Recorders' Office at the time of downloading from the Ministry of Mines (MINES) web site.

0 1.66 km

Projection: Web Mercator

Imagery Copyright Notices: Ministry of Natural Resources and Forestry (MNR); NASA Landsat Program; First Base Solutions Inc.; Aéro-Photo (1961) Inc.; DigitalGlobe Inc.; U.S. Geological Survey.) web site.

© King's Printer for Ontario, 2022



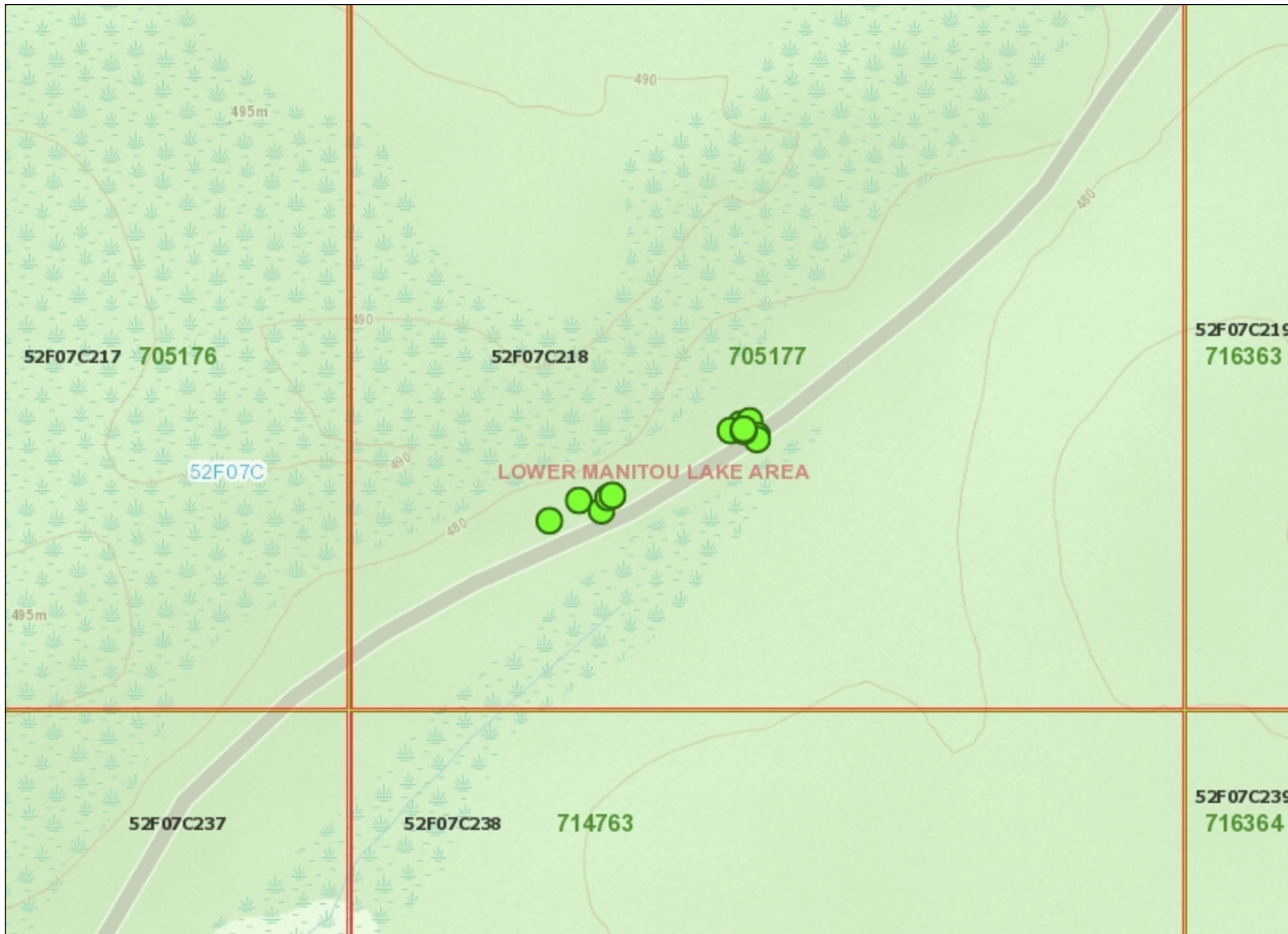

Legend

- Provincial Grid Cell**
 - Available
 - Pending
 - Unavailable
- Mining Claim**
 - Mining Claim
 - Boundary Claim
- Alienation**
 - Withdrawal
 - Notice
- MINES Administrative Boundaries**
 - MINES Townships and Areas
 - Geographic Lot Fabric
 - UTM Grid 1K
 - UTM Grid 10K
 - Mining Division
 - Mineral Exploration and Development Region
 - CLUPA Protected Area - Far North
 - Resident Geologist District
 - Federal Land Other
 - Native Reserves
- AMIS Sites**
 - AMIS Sites
 - AMIS Features
 - Drill Hole
 - Mineral Occurrences
- MLAS Mining History**
 - Withdrawal - History
 - Notice - History
 - Mining Claim - History
 - Mining Land Tenure - History
 - Legacy Claim
- Provincial Grid**
 - Provincial Grid 250K
 - Provincial Grid 50K
 - Provincial Grid Group
- Land Tenure**
 - Surface Rights
 - Mining Rights
 - Mining and Surface Rights
 - Order-in-Council

Those wishing to register mining claims should consult with the Provincial Mining Recorders' Office of the Ministry of Mines (MINES) for additional information on the status of the lands shown hereon. This map is not intended for navigational, survey, or land title determination purposes as the information shown on this map is compiled from various sources. Completeness and accuracy are not guaranteed. Additional information may also be obtained through the local Land Titles or Registry Office, or the Ministry of Natural Resources and Forestry. The information shown is derived from digital data available in the Provincial Mining Recorders' Office at the time of downloading from the Ministry of Mines (MINES) web site.



Imagery Copyright Notices: Ministry of Natural Resources and Forestry (MNR); NASA Landsat Program; First Base Solutions Inc.; Aéro-Photo (1961) Inc.; DigitalGlobe Inc.; U.S. Geological Survey.) web site.
 © King's Printer for Ontario, 2023



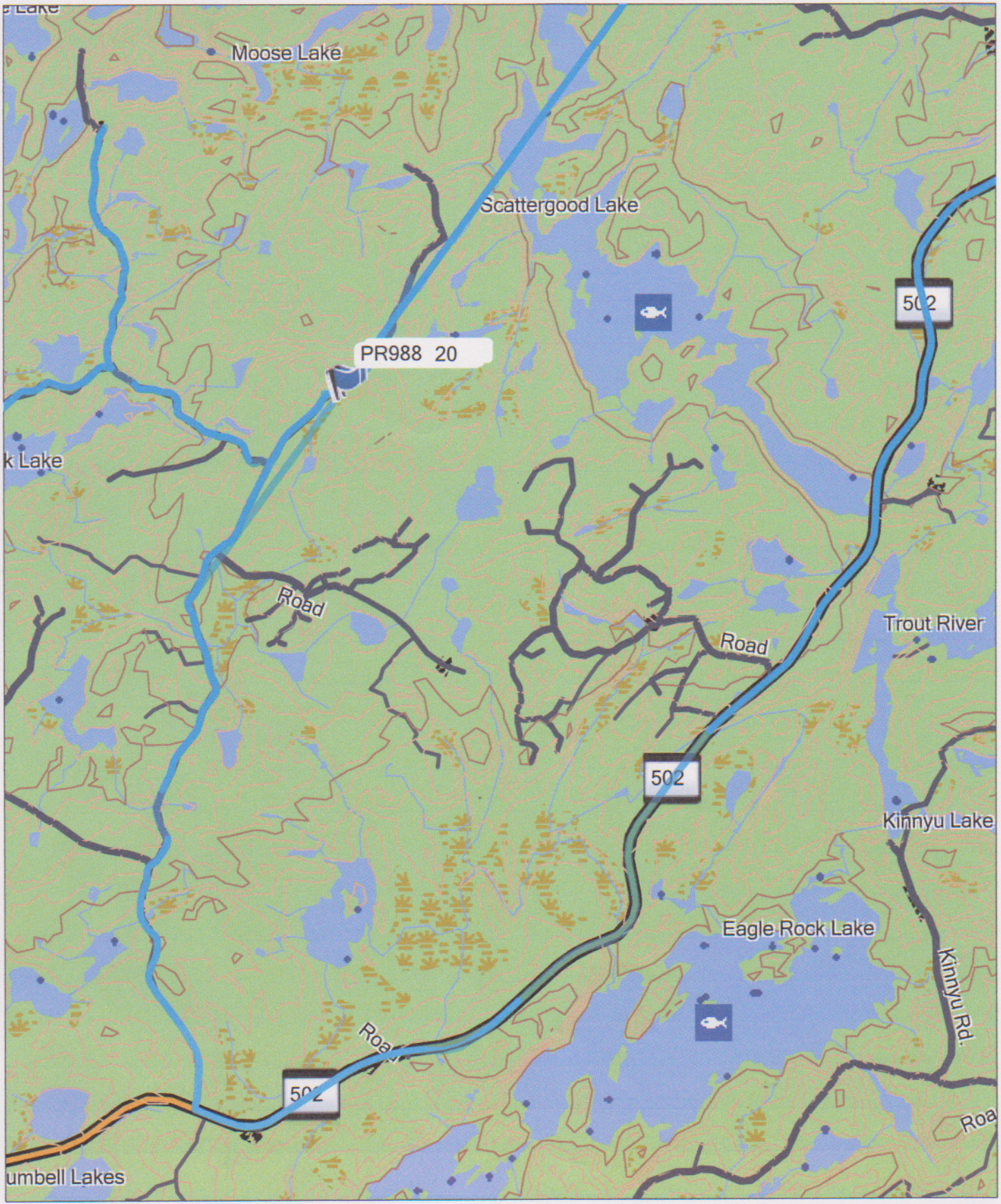

Backroad Mapbooks ON v7.0
 Ontario Backroad GPS Maps v7
 © Backroad Mapbooks 2016

*one way
 200 KM*

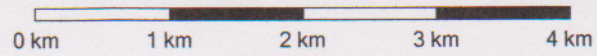

MN TN
 -0.5°
 2010-01-01

2022-11-19 3:29:27 AM

Hwy 72
GARMIN.

TO → Route taken from Sioux Lookout → Hwy 502 → Preacher Road → to claims