

DIAMOND DRILLING



31C11SW0009 13 ELZEVIR

010

TOWNSHIP: Elzevir

REPORT No.: 13

WORK PERFORMED BY: James Leon Byer

<u>CLAIM No.</u>	<u>HOLE No.</u>	<u>FOOTAGE</u>	<u>DATE</u>	<u>NOTE</u>
EO 582135	1	55.0	Nov/81	(1)
	2	102.0	Nov/81	(1)
	3	193.0	Nov/81	(1)

NOTES: (1) #58-81

ELZEVR TWP.

#58-81

592066

(P) S.R.O.
(P) S.R.O.

592065

EO	EO
582135 S.R.O.	582136
582133 S.R.O.	582134

EO	EO	EO
582034	582035	582037
(P) S.R.O.	(P) S.R.O.	
582033	582036	582038

EO
582032
(P) S.R.O.
EO
582031

EO	EO
582028	582029
(P) S.R.O.	(P) S.R.O.
EO	EO
582027	582029

OPEN FOR

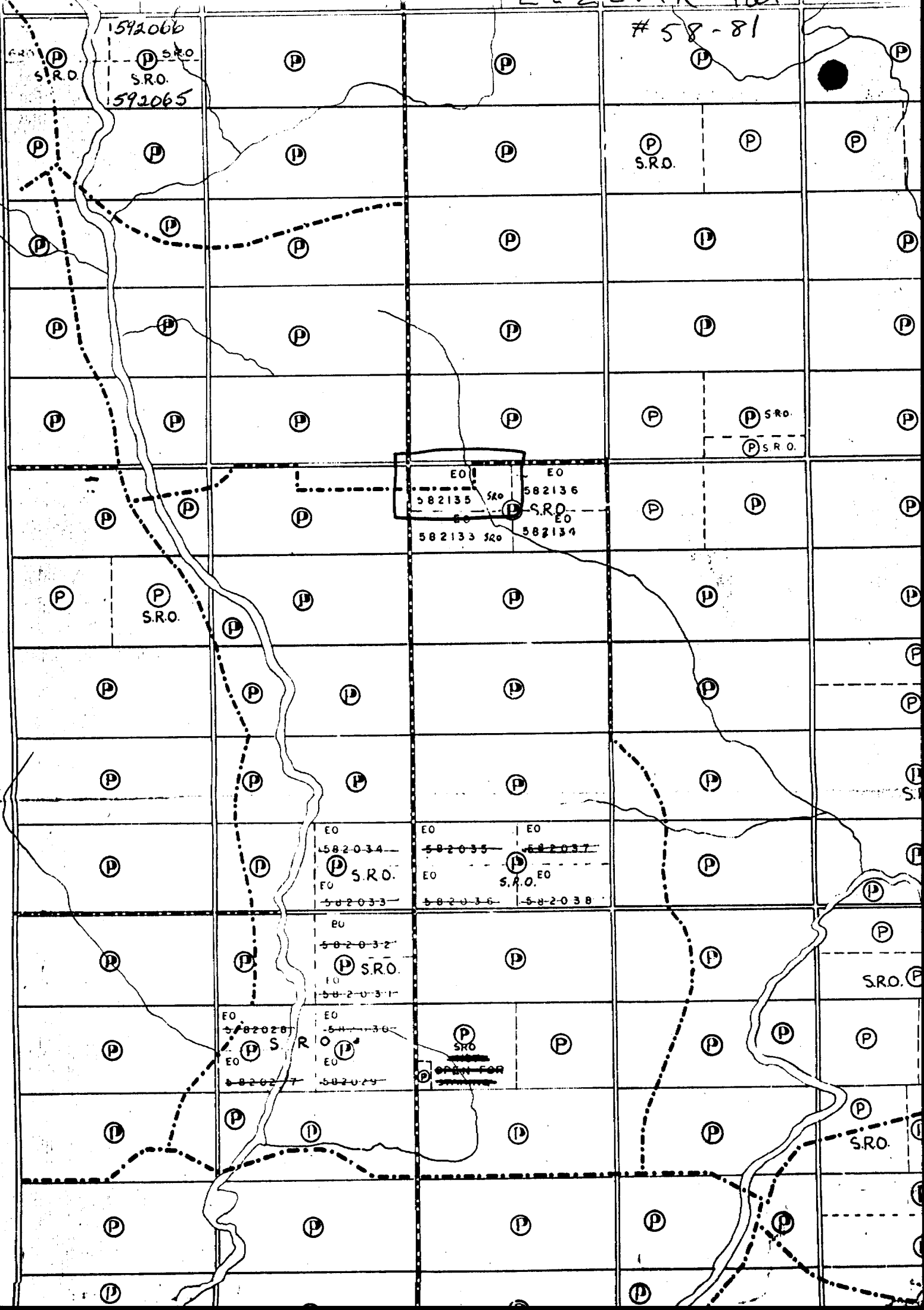



**Diamond
Drilling
Log**

Fill in on
every page

Hole No. 2 Page No.

Drilling Company <i>Eastern Ontario Diamond Drilling Co.</i>		Collar Elevation <u>700</u>	Bearing of hole from true North <i>vertical</i>	Total Footage <u>102</u>	Dip of Hole at Collar <u>90</u>	Location of hole in relation to a fixed point on the claim. <i>330'</i> <i>OH #2</i> <i>E.O. 582135</i>	Map Reference No.	Claim No. <i>E.O. 582135</i>
Date Hole Started <i>Nov. 4th/81</i>	Date Completed <i>Nov. 5th/81</i>	Date Logged <i>Nov. 9th/81</i>	Logged by <i>C. Roger Young</i>		Ft.		Location (Twp., Lot, Con. or Lat. and Long.) <i>N.W. 1/4 Lot 10, Con. III Elzevir</i>	Property Name <i>Elzevir Lake</i>
Exploration Co., Owner or Optionee <i>James Leon Byer</i>		Date Submitted <i>Nov. 16th/81</i>	Submitted by (Signature) <i>James Leon Byer</i>		Ft.			
					Ft.			
					<u>102</u> Ft. <u>90</u>			

Footage		Rock Type	Description <small>Colour, grain size, texture, minerals, alteration, etc.</small>	Planar Feature Angle*	Core Specimen Footage †	Your Sample No.	Sample Footage		Sample Length	Assays †	
From	To						From	To			
<u>0</u>	<u>19</u>	<u>OVERBURDEN</u>	<u>Whiteish very fine grained sand</u>								
<u>19</u>	<u>37</u>	<u>Quartz</u>	<u>very dense and mostly pure white</u>								
<u>37</u>	<u>92</u>	<u>Quartz - Hornblende</u>	<u>Fine grained - white to brownish with some banding</u>								
<u>92</u>	<u>102</u>	<u>Quartz - Gneiss - Hornblende</u>	<u>medium grained greenish</u>								
		<u>End of hole</u>									



**Diamond
Drilling
Log**

Fill in on
every page

Hole No. **3** Page No.

Drilling Company <i>Eastern Ontario Diamond Drilling Co.</i>		Collar Elevation <i>700</i>	Bearing of hole from true North <i>N 20° E</i>	Total Footage <i>193</i>	Dip of Hole at Collar <i>45°</i>	Location of hole in relation to a fixed point on the claim. <i>100 m 23</i>	Map Reference No.	Claim No. <i>E.O. 522/35-</i>
Date Hole Started <i>Nov. 6th</i>	Date Completed <i>Nov. 11th</i>	Date Logged <i>Nov. 14/81</i>	Logged by <i>C. Roger Young</i>	Ft.	Ft.		Location (Twp., Lot, Con. or Lat. and Long.) <i>N.W. 1/4 Lot 10, Con. III Elzevir</i>	
Exploration Co., Owner or Optionee <i>James Leon Byer</i>		Date Submitted <i>Nov. 16th 81</i>	Submitted by (Signature) <i>James Leon Byer</i>	Ft.	Ft.	Property Name <i>Elzevir Talc</i>		
				<i>193</i>	<i>45°</i>			

Footage		Rock Type	Description Colour, grain size, texture, minerals, alteration, etc.	Planar Feature Angle *	Core Specimen Footage †	Your Sample No.	Sample Footage		Sample Length	Assays †
From	To						From	To		
<i>0</i>	<i>9</i>	<i>Overburden</i>	<i>Castles & boulders</i>							
<i>9</i>	<i>48</i>	<i>Talc - magnesite</i>	<i>grayish</i>							
<i>48</i>	<i>92</i>	<i>Serpentine</i>	<i>bit rock greenish</i>							
<i>92</i>	<i>95</i>	<i>Talc - magnesite</i>	<i>grayish</i>							
<i>95</i>	<i>112</i>	<i>Serpentine</i>	<i>bit rock greenish</i>							
<i>112</i>	<i>140</i>	<i>Talc - magnesite</i>	<i>grayish</i>							
<i>140</i>	<i>152</i>	<i>Amphibole</i>	<i>blackish green</i>							
<i>152</i>	<i>193</i>	<i>Talc - magnesite</i>	<i>grayish</i>							
		<i>End of hole</i>								