

DIAMOND DRILLING



31C11SW0010 17 ELZEVIR

010

Township: Elzevir

Report No: 17

WORK PERFORMED FOR: James Leon Byer

RECORDED HOLDER: SAME AS ABOVE [x]

: OTHER []

<u>CLAIM NO.</u>	<u>HOLE NO.</u>	<u>FOOTAGE</u>	<u>DATE</u>	<u>NOTE</u>
EO 747953	85-1	130'	Sept/85	(1)
EO 747954	85-2	270'	Sept/85	(1)

NOTES: (1) #80-85



Fill in on
every page

Hole No. 85-2	Page No. 1
------------------	---------------

Drilling Company EASTERN ONTARIO DIAMOND DRILLING		Collar Elevation	Bearing of hole from true North S 30° E	Total Footage 270	Dip of Hole at Collar 40	Location of hole in relation to a fixed point on the claim. 747954 DH#2 +00' 500'	Map Reference No.	Claim No. E.O. 747954
Date Hole Started SEPT. 16, 1985	Date Completed SEPT. 20, 1985	Date Logged OCT. 19/85	Logged by U. KRETSCHMAR		Ft.		Location (Twp., Lot, Con. or Lat. and Long.) N.E. 1/4 LOT. 5, CON. VI ELZEVIR TWP	Property Name HAY LOFT
Exploration Co., Owner or Optionee BILL BUSH SHARBOT LK. CNT.		Date Submitted DEC 30/85	Submitted by (Signature) <i>James h. Byer</i>		Ft.			
			<i>James h. Byer</i>		270 Ft. 40			

Footage		Rock Type	Description Colour, grain size, texture, minerals, alteration, etc.	Planar Feature Angle *	Core Specimen Footage †	Your Sample No.	Sample Footage		Sample Length	Assays †	
From	To						From	To			
0	2		collar								
2	20		broken core moderately magnetic chlorite schist & hornblende porphyroblastic chlorite tremolite schist minor carbonate alteration, weakly magnetic								
20	29		predominantly grevish green argillaceous chloritic rock probable meta-andesite minor pyrite veins perpendicular to core								
29	33		dolomitic carbonate alteration minor hornblende								
33	37		mixed carbonate and altered hornblende porphyroblastic amphibolite, probably metagabbro								
37	95		hornblende amphibolite, minor talc zones up to 1 ft. thick, massive to slightly foliated foliation at 45 to core, talc interstitial up to 30% pyrite veins 1 cm thick at 68, 72, 93 ft. minor carbonate veining, up to 3 in. thick at 59 ft. minor light green, v.f.g. chloritic mineral as veins & associated with pyrite								
95	100		gradational contact to talcose rock								
100	155		talc zone, talc-chlorite about 30%, less magnetic than amphibolite foliation up to 50-70 to core minor hornblende porphyroblastic sections weakly magnetic minor pyrite veining light grayish green colour								

* For features such as foliation, bedding, schistosity, measured from the long axis of the core.

† Additional credit available. See Assessment Work Regulations.

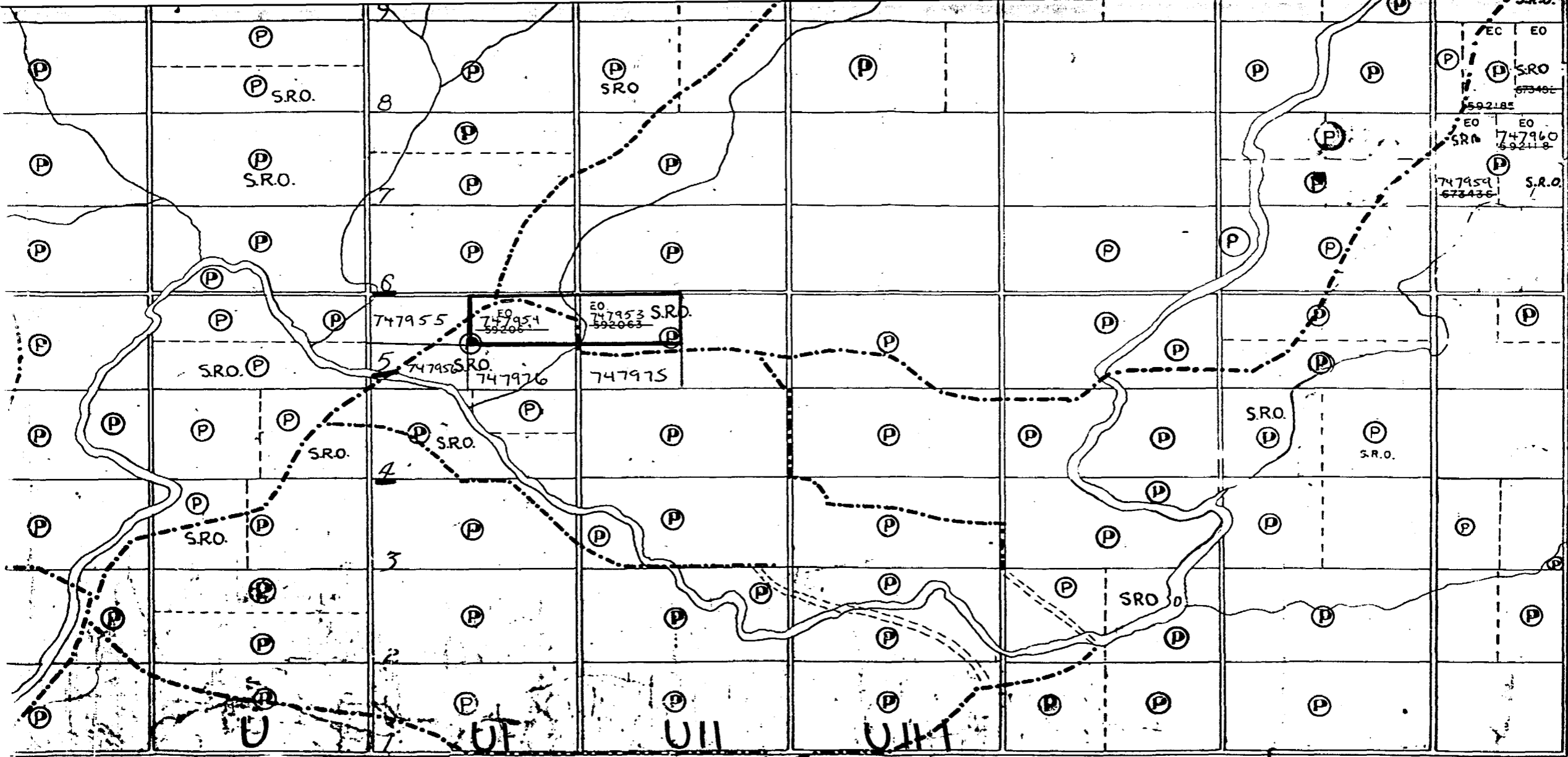

M89
 HUNGERFORD
 ELZEVIR TWP.
 DISTRICT MANAGER
 TWEED

LEGEND

CANCELLED PATENTED LAND	C	MINING RIGHTS ONLY	M.R.O.
BROWN LAND SALE LEASES	P	SURFACE RIGHTS ONLY	S.R.O.
LOCATED LAND	CS		
IN POSSESSION OF OCCUPATION	LOC		
	LO		

NATURAL RESOURCES

JAN 1 1985



Name and Postal Address of Recorded Holder: **JAMES LEON BYER**
 RR#3 TWEED ONT. KOK-350
 Prospector's Licence No.: **A44247**

Summary of Work Performance and Distribution of Credits

Total Work Days Cr. claimed 400	Mining Claim			Mining Claim			Mining Claim		
	Prefix	Number	Work Days Cr.	Prefix	Number	Work Days Cr.	Prefix	Number	Work Days Cr.
for Performance of the following work. (Check one only) <input type="checkbox"/> Manual Work <input type="checkbox"/> Shaft Sinking Drifting or other Lateral Work. <input type="checkbox"/> Compressed Air, other Power driven or mechanical equip. <input type="checkbox"/> Power Stripping <input checked="" type="checkbox"/> Diamond or other Core drilling <input type="checkbox"/> Land Survey	①	747953	200						
	②	747954	200						

Required Information eg: type of equipment, Names, Addresses, etc. (See Table below)

DIAMOND DRILL
 ✓ **EASTERN ONTARIO DIAMOND DRILLING LIMITED.**
 BILL BUSH
 SHARROT LK ONT. KOK 2PO
 TEL: 1-613-279-2105
 DRILLING DONE ON
 SEPT 5th to SEPT 9th, 1985
 SEPT 16th to SEPT 20th, 1985.
 CORE - AX
 HOLE #1 - 130 ft EO 747953
 #2 - 270 ft EO 747954
 WORK ASSIGNMENT
 EO 747954
 4,000 - 70 = 3,930 days balance

ONTARIO GEOLOGICAL SURVEY
 ASSESSMENT FILES
 RESEARCH OFFICE
 DEC 3 1985
 RECEIVED

RECEIVED
 DEC 30 1985
 RECORDS OFFICE - TORONTO

Date of Report: **DEC 30/85**
 Recorded Holder or Agent (Signature): *James L Byer*

Certification Verifying Report of Work

I hereby certify that I have a personal and intimate knowledge of the facts set forth in the Report of Work annexed hereto, having performed the work or witnessed same during and/or after its completion and the annexed report is true.

Name and Postal Address of Person Certifying: **SAME AS ABOVE**

Date Certified: **Dec 30/85**
 Certified by (Signature): *James L Byer*

Table of Information/Attachments Required by the Mining Recorder

Type of Work	Specific information per type	Other information (Common to 2/or more types)	Attachments
Manual Work	Nil	Names and addresses of men who performed manual work/operated equipment, together with dates and hours of employment.	Work Sketch: these are required to show the location and extent of work in relation to the nearest claim post.
Shaft Sinking, Drifting or other Lateral Work			
Compressed air, other power driven or mechanical equip.	Type of equipment	Names and addresses of owner or operator together with dates when drilling/stripping done.	
Power Stripping	Type of equipment and amount expended. Note: Proof of actual cost must be submitted within 30 days of recording.		
Diamond or other core drilling	Signed core log showing; footage, diameter of core, number and angles of holes.	Nil	Work Sketch (as above) in duplicate
Land Survey	Name and address of Ontario land surveyer.		Nil

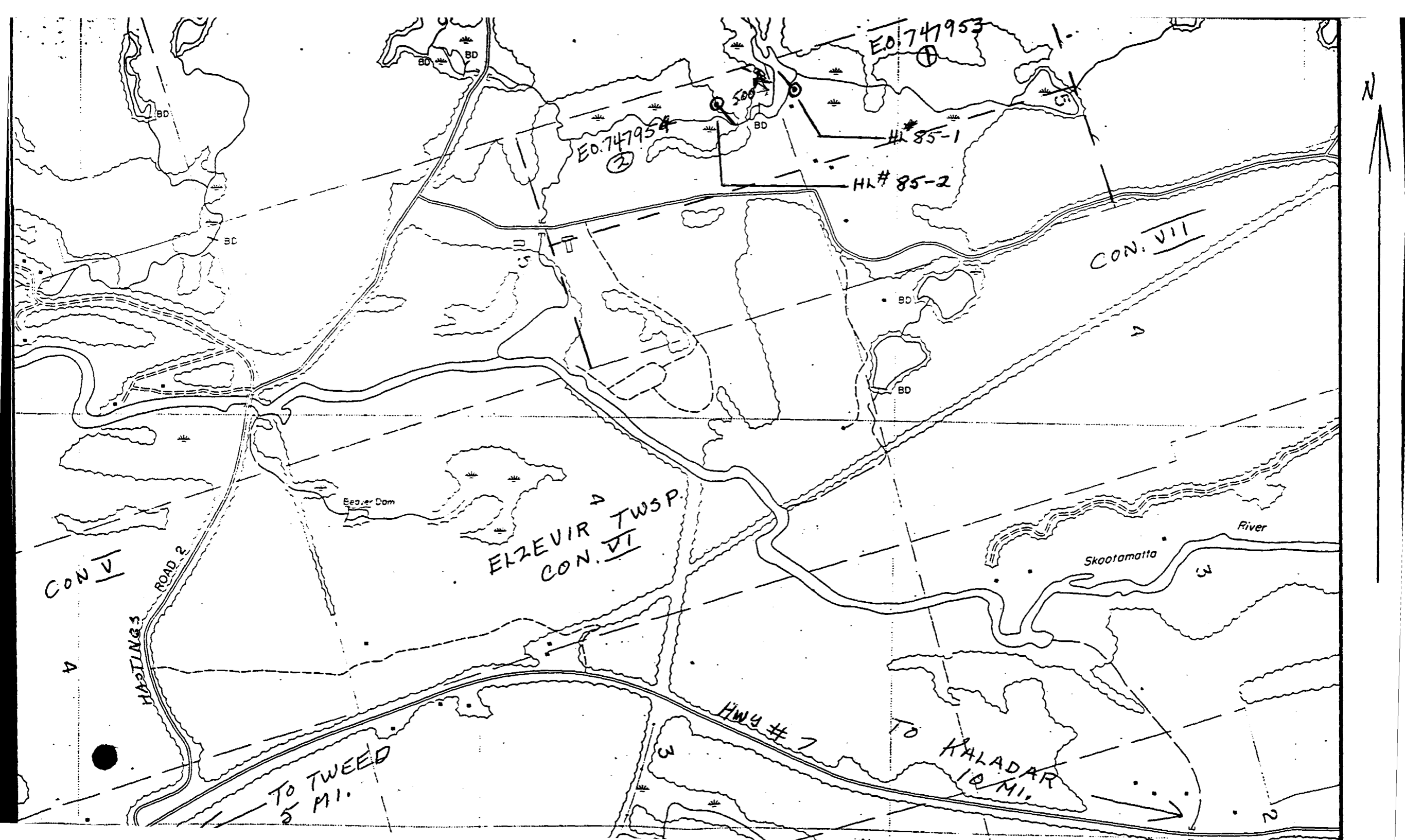

N

EO. 74795
①

EO. 74795
②

HL # 85-1

HL # 85-2

CON. VII

EZEVIR TWSP.
CON. VI

CON. V

HAYLING'S ROAD

Skootamatta River

TO TWEED
5 MI.

HWY # 7

TO KALADAR
10 MI.