

Diamond Drilling



31C12NW0018 20 METHUEN

010

Township of METHUEN

Report No: 20

Work performed by: M.R. Tripp

Claim No	Hole No	Footage	Date	Note
E.O. 39064	#1	295'	May/74	(1) (2)
	10-A	141.5'	July/74	(2)
E.O. 39065	2-A	152'	May/74	(2)
E.O. 219760	3-A	150'	May/74	(2)
	4-A	151'	May/74	(2)
E.O. 219758	5-A	150'	May/74	(2)
E.O. 219761	6-A	235'	May/74	(2)
E.O. 402791	7-A	200'	June/74	(2)
	8-A	207'	June/74	(2)
	9-A	150'	July/74	(2)

Notes:

(1) Logs for 124'-295' in this report. See Methuen #15 for shallower footage.

(2) 5/3/74

DIAMOND DRILL CORE LOG

H. 1

~~100~~

Footage	Description
125'	Metadiorite - medium grained with some magnetite and trace sulphide. magnetite magnetite.
130'	8" Shear zone
	5" localized concentration of magnetite.
135'	No Core " Fracture zone with hornblende magnetite and chlorite. Metadiorite.
140'	quartz, feldspar vein localized concentrations of magnetite and some coarse grained biotite
145'	Disseminated pyrite and arsenopyrite.
	Fracture - shear zone Coarse grained pinkish feldspar and quartz in vein.
150'	Gabbro with very minor magnetite and sparse, disseminated fine-grained sulphides - mainly pyrite, pyrrhotite and traces of chalcopyrite.
155'	
160'	

Footage	Description
160	Gabbro as described above
165	
170	Texture somewhat diabasic in appearance.
175	Amphibolite.
180	Diabasic textured but still gabbro. Local enrichment of magnetite Shear zone.
185	Localized enrichment of magnetite.
190	Localized enrichment of magnetite. Fracture
195	

2.00'

Gabbro with localized enrichment of magnetite, with sparse disseminated fine-grained sulphides

2.05

2.10

Coarse-grained gabbro

2.15

Pink coloured feldspar with quartz - pegmatitic.

Almost amphibolitic.

2.20

Gabbro with minor magnetite and sparse sulphides.

Thin strings of arsenopyrite and pyrrhotite.

2.25

Medium to fine-grained granulitic rock - possibly a meta volcanic. Minor magnetite with in zones 4 to 6" wide.
Diorite lens.

2.30

Gabbro in contact with granodiorite.

240

Gabbro

245

localized enrichment of magnetite

250

255

Diabasic textured gabbro

260

265

Gabbro with minor magnetite

270

Gabbro.
Granulitic material
Dioritic rock
Gabbro

220'

Diorite with minor quartz.

285'

290'

295'

No Core

300'

Feet

Description

No core.

5'

Gabbro with minor magnetite and a trace amount of disseminated fine-grained sulphides.

10'

Shear-zone.

Gabbro as above.

15'

Quartz-feldspar vein.

Shattered alteration zone - large hornblende.

20'

No core

25'

- Band of fine-grained granitic material

30'

Gabbro as described above.

35'

Note
Footage

No. 2 page 2.

Description.

Gabbro

40'

Zone of fine-grained granulitic material.

45'

Gabbro

50'

Sugary appearance

55'

Mud seam 2" wide.

60'

Gabbro with sparse disseminated magnetite and fine-grained sulphide.

65'

70'

75'

Footage

Description

50

Gabbro as described above.

85

- Zone of fine-grained material
Coarse-grained hornblende

90

Fine-grained zone of dioritic material
which is granulitic in appearance but
lacks quartz.

95

100

Gabbro - equigranular with minor
dispersed magnetite and traces
of sulphides.

105

110

115

Footage

Description

120

Gabbro as described above.

125

130

Gabbro as above but grain-size somewhat smaller.

135

140

145

150

Footage

Description

5'

No core - overburden

10'

Gabbro - medium grained with disseminated accessory magnetite and traces of sulphides

25'

Epidotized fracture.

15'

Gabbro as described above.

20'

Quartz-feldspar vein.

25'

Gabbro.

Coarse-grained hornblende and calcite with lenses of pyrite and arsenopyrite

30'

35'

75'

Footage

Description

40'

Gabbro as described above.

45'

50'

55'

Coarse-grained hornblende.

60'

Core-surface has mottled appearance and contains less magnetite than gabbro above

65'

70'

Coarse-grained hornblende.

75'

Footage

Description

80'

85'

90'

95'

100'

105'

110'

115'

Gabbro with disseminated accessory amounts of magnetite plus trace amounts of pyrite, pyrrhotite and chalcopyrite

Granulitic in appearance - metadiorite?

Gabbro as described above

As above metadiorite?

Gabbro.

Footage

Description

120'

Gabbro as described above

125'

130'

135'

A gabbro in composition but the average grain size was much smaller than that immediately above and below.

140'

145'

Gabbro with disseminated accessory amounts of magnetite and traces of sulphide.

150'

End of hole.

Footage

Description

5'

No core

10'

Gabbro - partially decomposed by weathering.

15'

20'

Gabbro - medium grained with accessory amounts of magnetite and occasional grains of pyrite, pyrrhotite and chalcopyrite disseminated throughout.

25'

30'

35'

40'

45'

50'

55'

60'

65'

70'

75'

Gabbro as described above.

80'

Fracture-shear with coarse-grained hornblende and quartz.

85'

Gabbro as described above.

90'

Vein of fractured quartz.

95'

Gabbro as described above

100'

105'

110'

115'

Footage

Description

120'

Quartz-filled fracture

125'

Gabbro - as described above but with occasional coarse-grained crystals of plagioclase - porphyritic in appearance.

130'

Gabbro with accessory amounts of magnetite and sparse sulphide minerals disseminated along the length of the core.

135'

140'

145'

150'

Footage

Description

Box is marked "Overburden 3'".
No core except for a few pieces of
weathered gabbro.

5'

10'

Gabbro with accessory amounts of
magnetite and sparse sulphides
disseminated throughout core.

15'

No core

20'

Gabbro as described above.

25'

Gabbro is shattered - perhaps resulting
from drilling.

30'

Gabbro as described above.

35'

100ft

Description

110'

Gabbro as described above.

115'

120'

125'

130'

Healed fracture of quartz and coarse-grained hornblende.

135'

Gabbro as described above but exhibiting gneissosity with some segregation of the mafic constituents.

140'

145'

Footage

Description

No core.

Massive hornblende.
 Calcite vein containing coarse-grained
 arsenopyrite and pyrite.
 Quartz vein with lenses of coarse-grained
 arsenopyrite and pyrite.

Gabbro

Quartz vein.

Granite with abundant biotite to
 127' and abundant quartz to 130'

Partly gneissic to 132' then biotite,
 hornblende granite to 135'

Biotite much less common with hornblende
 the major mafic mineral to 147'

Some increase in the amount of quartz
 present.

120'

125'

130'

135'

140'

145'

150'

Footage

Description.

Box marked "Overburden 1'6"
-Core starts at 0'.

5'

Gabbro - medium grained with accessory amounts of magnetite and some traces of sulphides disseminated in the core

10'

Zone of gabbro slightly more coarse-grained than in the first 5 feet.
Sheared zone

Shear

15'

Gabbro as described above.

20'

25'

30'

Gabbro with medium grain-size. Magnetite, pyrite, pyrrhotite present in very small amount.

35'

age

Description

Gabbro as described above.

Diorite - medium-grained with trace amounts of magnetite and pyrite.

Gabbro as described above.

Diorite as described above.

Gabbro.

Quartz vein

Diorite.

Gabbro

Pegmatitic quartz and potash feldspar.

Gabbro as described above.

Granite, or anorthosite or Medium to fine-grained with all the appearance of an aplite.

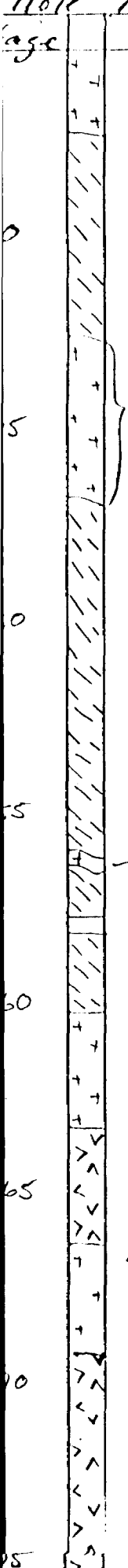

colage

Description

Diorite as described above.

80

Gabbro - medium to fine-grained with accessory amounts of magnetite disseminated throughout.

85

Coarse-grained hornblende.

90

Gabbro as described above on this page - but magnetite may be present in excess of 5% by weight.

95

100

105

Fracture - quartz-filled.

110

115

No core.

160'

165'

170'

175'

180'

185'

190'

195'

Gabbro as described above.

Biotite concentration

Gabbro as described above but with distinctly visible dark bands an inch to three inches wide at irregular intervals along the length of the core

1017

Description

200'

205'

210'

215'

220'

225'

230'

235'

Gabbro as described above.

Diorite - medium grained with small amounts of magnetite. Sulphides present in trace amount.

No - core

Footage	Description
No core.	
5'	
10'	Hornblende-biotite gneiss exhibiting well developed banding - i.e. segregation of minerals. Arsenopyrite and pyrite are present as fine-grained dispersed particles throughout the core.
15'	
20'	Quartz vein.
25'	Gneiss as described above but sulphide minerals less in evidence.
30'	
35'	

Description

Scale

	→	Sampled at some earlier date
40'	→	Quartz vein with lenses of relatively coarse-grained arsenopyrite and pyrite.
		Gneiss as described above.
45'	→	Vein 3mm wide of arsenopyrite.
		Gneiss as described above but with sulphides as abundant as in section 5'-20'
50'		Sulphides almost absent.
		Quartz vein
55'		
	→	Epidote
60'	→	Sampled at some earlier date
		Shear or fracture zone.
65'		No core.
		Granitic.
70'		No core
		Granite - core in fragments.
75'		

Scale

Description

80'

85'

90'

95'

100'

105'

110

115'

Granite
No core

No core

No core

Gneiss
Sampled at some earlier date.

Granite gneiss - pink in colour.
Epidotized zones at irregular intervals.

No core

Hornblende - biotite gneiss.

No core

Hornblende - biotite gneiss

No core

No core

Hornblende - biotite gneiss but grain size somewhat smaller than overlying gneiss.

Fine-grained diorite? - granulite?

Footage

Description

Diorite - fine grained.

120'

Gneiss as described above but grain-size somewhat smaller than overlying gneiss. Sulphides sparse.

125'

130'

Two quartz stringers

135'

Quartz veins

Gneiss as above.

Mud seam

140'

145'

Gneiss as described above but no visible sulphides.

150'

No core

155'

footage ●

Description.

	→	No core
160'	→	Epidote
	Gneiss - appears to have been migmatized.	
	Epidotized zones in this section.	
165'	Gneiss with no epidote.	
	No core	
	Seam of quartz containing arsenopyrite and pyrite.	
170'	→	Sampled at some earlier date
	Gneiss with sparse sulphide mineralization.	
175'	No core.	
	→	Fracture zone with hematitic clay Minor increase in sulphides.
180'	Gneiss with sparse sulphides.	
	185'	
185'		
190		

100' 100'

Description

195'

Sheared zone with hematitic clay in fractures

200'

Sampled at some earlier date

Footage

Description

5'

No core

10'

Barren quartz vein

Hornblende gneiss with minor sulphides.

Barren quartz vein.

15'

Minor chalcopyrite visible.

20'

Gneiss as described above but with some arsenopyrite and pyrite visible.

25'

No core

30'

1" of biotite

35'

Gneiss as described above with sparse sulphide mineralization.

Eastag

Description:

Gneiss as described above.

Seam of biotite and arsenopyrite.
Quartz vein

40'

45'

Gneiss with biotite more abundant than in overlying horizons. Grain size slightly diminished. Sulphides present but in trace amount.

50'

55'

Gneiss as described above but grain-size normally medium

60'

65'

70'

Quartz vein

75'

Collage

Description

80'

Gneiss - continuation of rock from 50' down

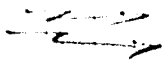

Sampled at some earlier date.
Coarse-grained arsenopyrite

85'

Gneiss

90'



Quartz vein

95'

Gneiss.

100'

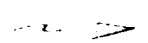

Quartz vein with arsenopyrite, pyrite, chalcopyrite

105'

Gneiss.

110'

115'

Depth

Description

120'

Gneiss as described above.

125'

130'

Quartz vein

135'

Localized concentration of arsenopyrite

140'

145'

150'

Quartz vein containing coarse-grained pyrite and arsenopyrite.

Mostly biotite.

Barren quartz vein

No core

Quartz vein with pyrite and arsenopyrite.

155'

Foolage

Description

160'

Gneiss - same as in upper horizons,
Grain size somewhat smaller.

165'

170'

175'

→ Epidote.

→ Quartz veins.

Gneiss - fine-grained

180'

→ Epidote

Sulphides still sparse but more evident.

185'

→ Epidote.

→ Coarse-grained chalcoprite in stringers

Epidotized layers are common.

190'

stage

Description

Gneiss - same as for 176'-180'.

Resembles granulite.

Epidote

175'

200'

Barren quartz vein

205'

No core

Epidotized

210'

215'

220'

225'

Footage

Description

5

No core

10

Largely rock fragments largely of biotite with minor pyrite.

Altered wallrock resembling gabbro.

15

Quartz vein containing arsenopyrite, pyrite and pyrrhotite
Bands of sulphide - pyrite and marcasite

20

Gneiss, meta-sediment or arkose?

→ Biotite rich veins.

Same as for 16'-21'.

25

Same as for 16'-21' but finer-grained

30

Fragmented biotite-rich core-lumps

→ Quartz vein
Arkose?

35

→ Quartz vein with pyrite-arsenopyrite coatings on fractures.

Footage

Description

→ Quartz fracture with sulphides.

→ Quartz vein

40

Gneiss - hornblende, biotite with minor arsenopyrite and pyrite disseminated through core.

45

→ Localized concentrations of sulphides.

50

55

60

Gneiss - as described for 38'-48' above.

65

70

75

Footage

Description

80

Gneiss - as described for 38'-48'

85

90

95

100



Lens of arsenopyrite

105

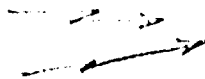

Coarse-grained arsenopyrite

Scattered very narrow lenses of sulphides

110

115

Footage

Description

Sulphide stringer.

120

Gneiss as described above.
Arsenopyrite and pyrite with
occasional chalcopyrite disseminated
through to 150'

125

130

135

Gneiss as described above.

140

145

150

Footage

Description

No core

Weathered-decomposed gabbro

No core

→ Calcite seam.

Gabbro - appears to have been affected by metamorphism. The core surface exhibits colour banding resulting from partial segregation of the mafic minerals and plagioclase.

→ Breccia or zones of hornblende.

Gabbro as described above but with an increase of plagioclase over mafics from 20' to 25'.

35'

Footage

Description

40'

Gabbro with occasional coarse grains of hornblende. Rock exhibits evidence of metamorphism

→

Epidote and calcite

45'

→

Epidote and calcite

Some fracturing of core between 45' and 50'

50'

Finely disseminated sulphides seen - occurring interstitial to matrix minerals.

55'

Grain-Size of gabbro minerals slightly finer grained than above.

60'

65'

Fractured seam of quartz and feldspar. Pyrite and chalcopyrite present.

Diorite - medium grained.

70'

- Fault or shear zone.

75'

Footage

Description

Mixture of diorite and gabbro.

80'

85'

Occasional slips coated with calcite.

90'

Diorite - medium grained with isolated grains of pyrite, pyroxene and chalcopyrite. This diorite is relatively high in hornblende and might be considered intermediate between diorite and gabbro.

95'

100'

105'

Gabbro - grain-size medium but becoming slightly more coarse with increasing depth.

110'

115'

Footage

Description

Gabbro.

120'

Sand seam? →

125'

Gabbro as described above but with increase in grain-size of constituent minerals

130'

135'

Gabbro as described above
Trace amounts of fine-grained pyrrhotite, pyrite and chalcopyrite persist as finely disseminated grains interspersed interstitial to grains of plagioclase and hornblende.

140'

145'

#53
EO 39064



ONT

THE MINING ACT
EASTERN ONTARIO

RECEIVED

AUG 19 1974



31C12NW0018 20 METHUEN

900

To the Recorder of

M. R. Tripp

I,
name of Recorded Holder

465 Bloor St. West, Oshawa, Ontario

Miner's Licence

A 40055

Post Office Address

do hereby report the performance of 1707.5 days of 'Diamond Drilling' type of work

not before reported to be applied on the following contiguous claims

Claim No.	Days	Claim No.	Days	Claim No.	Days
.....
.....	see attached statement	
.....
.....
.....
.....
.....

All the work was performed on Mining Claim (s) EO 39064-65, 21972, 21973, 21974, 40055
(In the case of geological and/or geophysical survey (s) where more than 18 claims are involved attach a schedule)

READ CAREFULLY: THE FOLLOWING INFORMATION IS REQUIRED BY THE MINING RECORDER.

For Manual Work, Stripping or Opening up of Mines, Sinking Shafts or Other Actual Mining Operations - Names and addresses of the men who performed the work and the dates and hours of their employment.

For Diamond and other Core Drilling - Footage, No. and angle of holes and diameter of core. Name and address of owner or operator of drill. Dates when drilling was done. Signed core log and sketch in duplicate.

For Compressed Air or Other Power Driven or Mechanical Equipment

Type of drill or equipment. Names and addresses of men engaged in operating equipment and the dates and hours of their employment.

For Power Stripping - Type of equipment. Name and address of owner or operator. Amount expended. Dates on which work was done. Proof of actual cost must be submitted within 30 days of recording.

With each of the above types of work sketches are required to show the location and extent of the work in relation to the nearest claim post. In the case of diamond or other core drilling the sketch must be submitted in duplicate.

For Geophysical, Geological, Geochemical Surveys and Expenditure Credits - the name of author of report. Covering dates of survey (linecutting & office). Type of instrument used. Total amount of expenditure. Technical reports, maps, expenditure breakdown, receipts must be filed in duplicate with the Minister within 60 days of recording.

For Land Survey - the name and address of Ontario Land surveyor.

The Required Information is as Follows: (Attach a list if this space is insufficient)

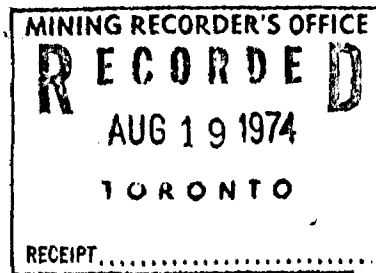

Date Aug 15th 1974

Signature of Recorded/Holder or Agent

The Mining Act
Certificate Verifying Report of Work

I, Marshall R. Tripp
Post Pmny, Pmt. R.R. # 2
(Post Office Address)

hereby certify:

1. That I have a personal and intimate knowledge of the facts set forth in the report of work annexed hereto, having performed the work or witnessed same during and/or after its completion.
2. That the annexed report is true.

Dated Aug 15th 1974 Marshall R. Tripp
Signature

THE PENALTY FOR MAKING A FALSE STATEMENT IN THIS REPORT AND/OR CERTIFICATE IS \$500. OR SIX MONTHS IMPRISONMENT OR BOTH

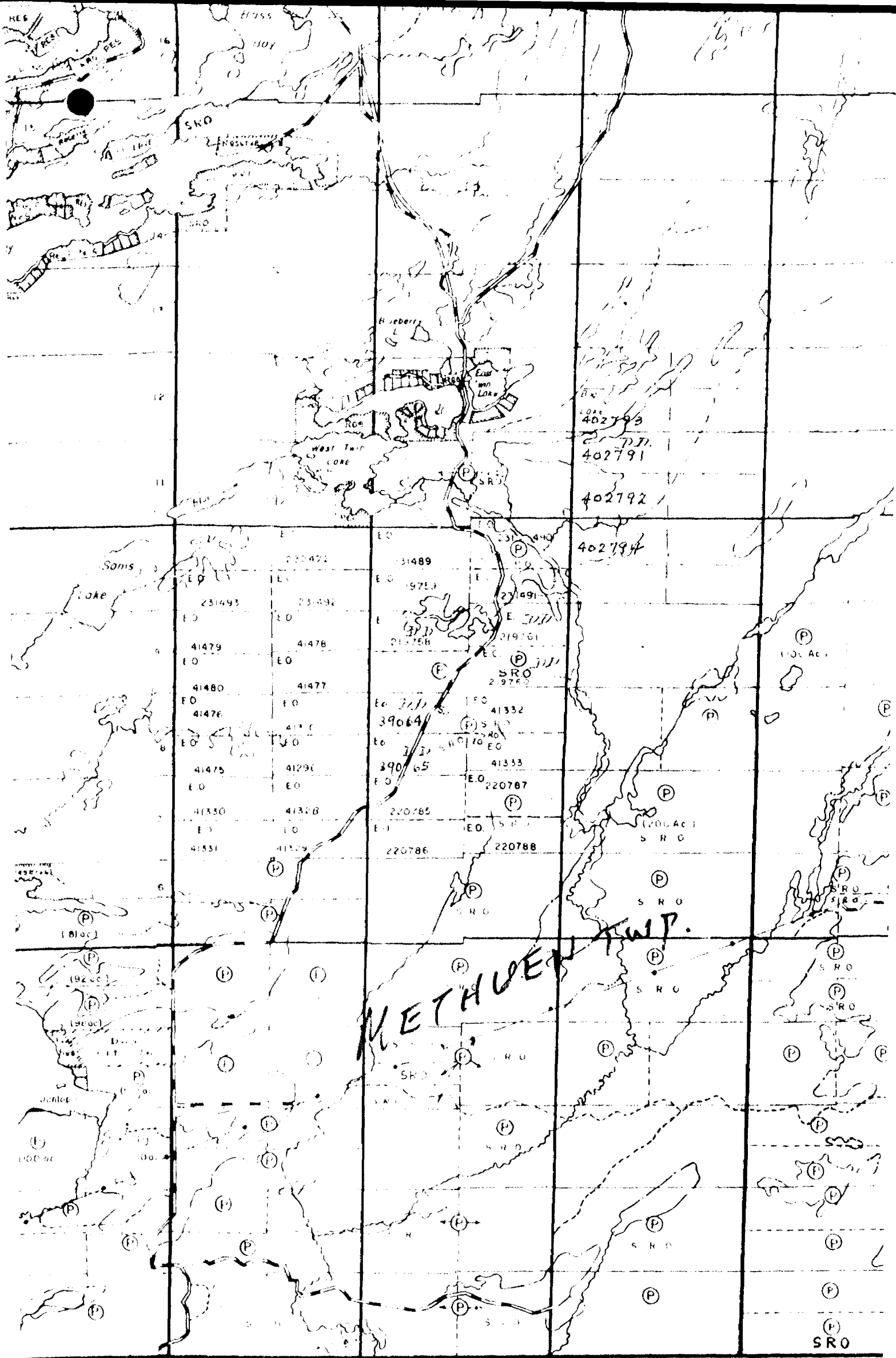

V
Twp. (N53)

IV III II I
#1 53/74 M.R. TRIPP
METHUEN TWP

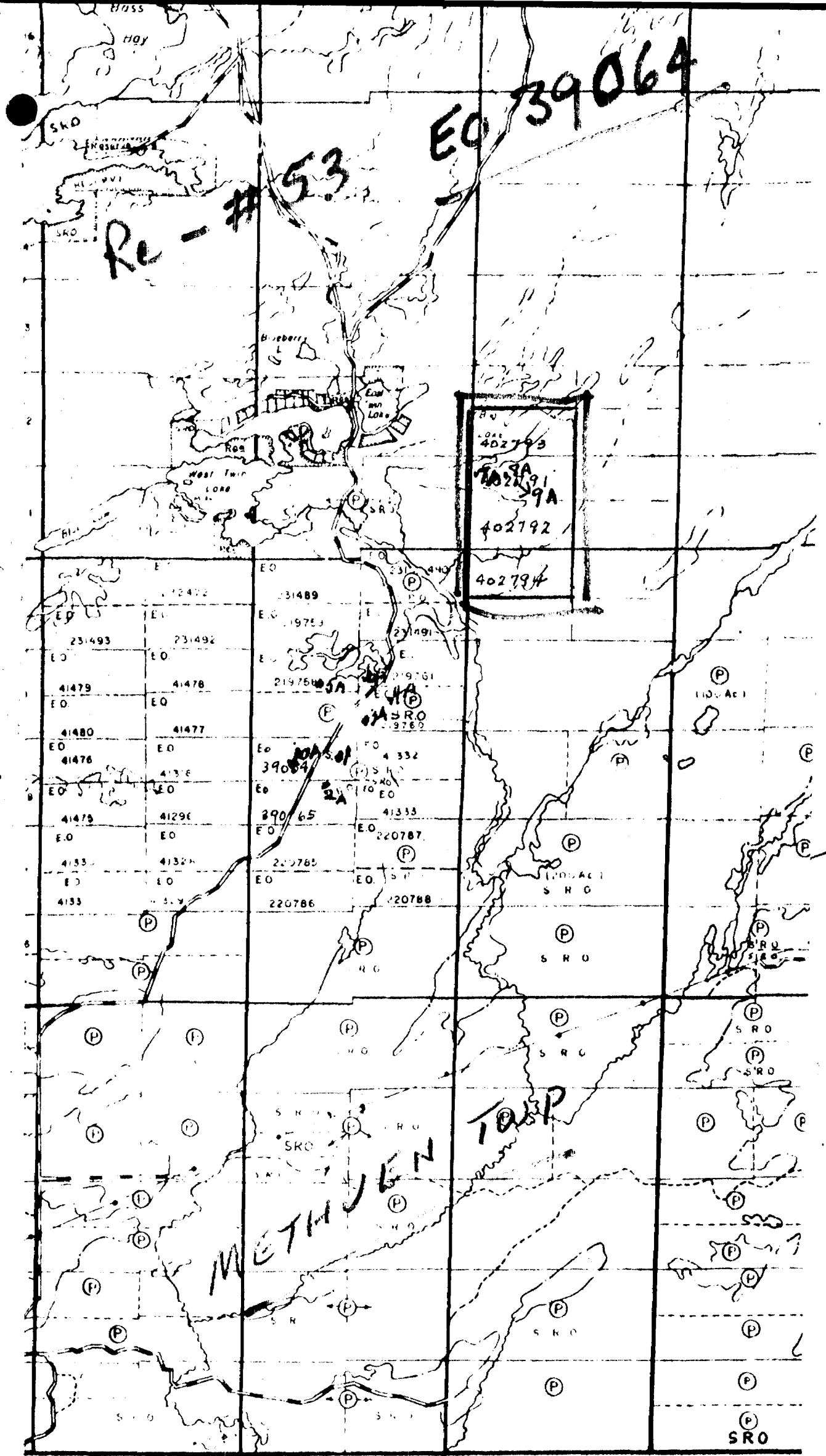

Re - # 53

EO 39064

402793
 402791
 402792
 402794

39064

METHUEN TWP

12
 11
 10
 9
 8

IV

III

II

I

53)

No 1 Hole continuation of previous No 1 Hole

125' to 300'

Located on claim No 39064, 400' S. of N. Boundary
and 300 W. of E. Boundary

N.W. $\frac{1}{4}$ Lot 8 Con 3 Methuen Twp PETERBOROUGH CTY.

No 2 A Hole Located on claim No 39065, 40' S of N

Boundary and 500' W of E Boundary

S.W. $\frac{1}{4}$ Lot 8. Con 3 METHUEN Twp Peterborough City

No 3 A hole on claim 219760

100' E of W. Boundary and 200' N. of S. Boundary

S.E. $\frac{1}{4}$ Lot 9 Con 3 Methuen Twp Peterborough City.

No 4 A hole on claim No. 219760

300' E of W. Boundary and 600' N of S. Boundary

S.E. $\frac{1}{4}$ of Lot 9 Con 3. METHUEN TWP PETERBOROUGH CITY

No 5 A hole on claim No 219758

100' N. of S. Boundary and 600' W. of E. Boundary

N.W. $\frac{1}{4}$ Lot 9 Con. 3. METHUEN TWP PETERBOROUGH CITY.

No 6 A Hole on claim No. 219761

50' E. of W Boundary and 100' N. of S Boundary

N.E. $\frac{1}{4}$ Lot 9 Con 3 MET HUEN TWP. PETERBOROUGH CTY.

No 7 A Hole on claim No 402791

50' E of W. Boundary and 300' South of N Boundary.

N.W. $\frac{1}{4}$ Lot 11 Con 2 METHUEN TWP PETERBOROUGH CITY

No 8 A HOLE on claim No 402791

550' E. of W. Boundary and 300' S. of N Boundary

N.W. $\frac{1}{4}$ Lot 11 Con 2 METHUEN TWP PETERBOROUGH CITY

No. 9A Hole on claim No. 402791

~~750'~~ 750' E. of W. Boundary and 350' south of N. Boundary
NW. $\frac{1}{4}$ Lot 11 Con 2 METHUEN Twp PETERBOROUGH CTY.

No. 10A Hole on claim No. 39864

500' S. of N. Boundary and 1200' W. of E. Boundary
NW. $\frac{1}{4}$ of Lot 8 Con 3 METHUEN Twp. PETERBOROUGH CTY.

Distribution of Assessment Work - 1707.5 days

Methuen Twp.

EO 41328	-	90	
29	-	90	
30	-	90	
31	-	90	
32	-	90	
33	-	90	540
EO 41475	-	69	
76	-	90	
77	-	85	
78	-	85	
79	-	86	
80	-	85	500
EO 220785	-	60	
86	-	60	
87	-	60	
88	-	60	240
EO 231489	-	60	
90	-	60	
91	-	60	
92	-	60	
93	-	60	
EO 232472	-	60	360
EO 219758	-	67.5	67.5
			<hr/>
			1,707.5

Marshall R. Jupp

Location of Diamond Drill Holes

Methuen Twp.

HO 219758	-	150 ft.	=	150
HO 219761	-	235 ft.	=	235
HO 219760	-	150 ft. & 151 ft.	=	301
HO 39064	-	171 ft. & 141.5 ft.	=	312.5
HO 39065	-	152 ft.	=	152
HO 402791	-	200 ft., 207 ft. & 150'	=	557

TOTAL: 1,707.5 ft.

*Hold Reports
see list*

Marshall P. Fupp

SHARBOT LAKE, ONT.,
KOH 2PO

May 10th 1974

Mr. Joe Tripp,
R.R. 2,
Port Perry, Ontario.

IN ACCOUNT WITH
EASTERN ONTARIO DIAMOND DRILLING

JAMES T. PRENTICE — Prop.

- ★ MINERAL EXPLORATION
- ★ WATER WELLS
- ★ ASSESSMENT WORK
- ★ SOIL SAMPLING

— NO JOB TOO SMALL —

INVOICE ~~XXXX~~
74-I

hole # 1	deepen from 124' - 295' - 171 ft.				
" # 2-A	0 - 152				
" # 3-A	0 - 150				
	473 ft.	4.50			2128.50
	20 core boxes		2.50	50.00	
	7% P.S.T.			3.50	
				53.50	53.50
<u>MOVING:</u>	(additional to the 4 Hrs. allotted for each move, as per contract.)				
	from hole #1 to hole # 2-A ----3 hrs.				
	" " #2-A " " # 3-A ----4 "				
	7 hrs.	15.00			105.00
					<u>2287.00</u>

ALL ACCOUNTS ARE DUE WHEN RENDERED

ANGLE OF HOLE :

1 - VERTICAL

2A - VERTICAL

3A - VERTICAL

Marshall R. Tripp

SHARBOT LAKE, ONT.,

May 29

19 74

KOH 2PO

Joe Tripp
c/o Tripp Construction Limited,
465 Bloor St. W.,
Oshawa, Ontario. L1E 5Y5

IN ACCOUNT WITH

EASTERN ONTARIO DIAMOND DRILLING

JAMES T. PRENTICE — Prop.

- ★ MINERAL EXPLORATION
- ★ WATER WELLS
- ★ ASSESSMENT WORK
- ★ SOIL SAMPLING

— NO JOB TOO SMALL —

INVOICE # 74-2

.....

#4-A	0	to	151 ft.		
5-A	0	to	150		
6-A	0	to	235 536 ft.	4.50	2412.00
DRILLING: 1/2	(hole #5-A, to overcome caving, 10 ft.)			3.00	30.00
DRILLING:	(additional to the 4 hrs allotted for each move, as per contract)				
	from hole # 4-A to #5-A 7 hrs.				
	" " # 5-A to #6-A 3				
	10 hrs.			15.00	150.00
22	13 core boxes			2.50	55.00
	7% P.S.T. on boxes				3.85
					<u>2650.85</u>

ALL ACCOUNTS ARE DUE WHEN RENDERED

Paid by cheque - June 3rd / 74
J. J.

ANGLE OF HOLE:

4A - VERTICAL

5A - VERTICAL

6A - VERTICAL

Marshall B. [Signature]

SHARBOT LAKE, ONT.

June 28

1974

KOH 2PO

Mr. Joe Tripp,
c/o Tripp Construction Limited,
465 Bloor St. W.,
Oshawa, Ontario. LIJ 515

IN ACCOUNT WITH

EASTERN ONTARIO DIAMOND DRILLING

JAMES T. PRENTICE — Prop.

INVOICE # 74-3

- ★ MINERAL EXPLORATION
- ★ WATER WELLS
- ★ ASSESSMENT WORK
- ★ SOIL SAMPLING

— NO JOB TOO SMALL —

# 7-A	0	to	200 ft.				
8-A	0	to	<u>207</u> 407 ft.	4.50			1831.50
			17 core boxes 7% P.S.T.	2.50	42.50		
					<u>2.98</u>		
					45.48		45.48
MOVING: (additional to 4 hrs. allotted for each move, as per contract) from 6-A to 7-A ---- 20 hrs. @				1500			300.00
							<hr/>
							2176.98

ALL ACCOUNTS ARE DUE WHEN RENDERED

ANGLE OF HOLE:

7A — 35 degrees

8A — 35 degrees

Marshall P. Tripp

SHARBOT LAKE, ONT., July 10 1974
 KOH 2PO

Mr. Joe Tripp,
 c/o Tripp Construction Ltd.,
 465 Bloor St. W.,
 Oshawa, Ontario. L1J 5Y5

IN ACCOUNT WITH

EASTERN ONTARIO DIAMOND DRILLING

JAMES T. PRENTICE — Prop.

INVOICE # 74-4

- ★ MINERAL EXPLORATION
- ★ WATER WELLS
- ★ ASSESSMENT WORK
- ★ SOIL SAMPLING

— NO JOB TOO SMALL —

hole # 9-A	0	to	150 ft.				
" #10-A	0	to	<u>141 1/2</u> 291 1/2 ft.	4.50			1311.75
		I2 core boxes		2.50		30.00	
			7% P. S. T.			2.10	
						<u>32.10</u>	32.10
MOVING:	(additional to 4 hrs. allotted for each move, as per contract)						
	TRIP	from 9-A	to 10-A ----- 14 hrs	15.00			<u>210.00</u>
							1553.85
CREDIT:	advance payment made at start of job						<u>1000.00</u>
			balance				<u>553.85</u>

ALL ACCOUNTS ARE DUE WHEN RENDERED

ANGLE of Hole:

9A - 35 degrees

10A - VERTICAL

Marshall B. Tripp