

010

Diamond Drilling

Township OF METHUEN

Report NO: 13

Work performed by: H. F. TAYLOR

Claim NO	Hole NO	Footage	Date	Note
EO 22817 (NW ¼ 8/III)	1	42'	Oct/56	
	3	42'	Oct/56	
	4	48'	Oct/56	
	5	53'	Oct/56	
	6	43'	Oct/56	
	EO 22819 (SW ¼ 8/III)	7	27'	Oct/56
8		48'	Oct/56	
9		55'	Oct/56	

8 DDH 358'

Notes:

E.O. 22817

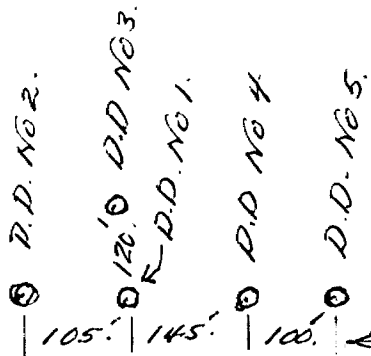

Drill Footage.
No 1 - 42.0'
~~No 2 - 22.0'~~
No 3 - 42.0'
No 4 - 48.0'
No 5 - 53.0'

209.0'
185.

To scale.
Scale 1" = 200'

No 1 Post



900'

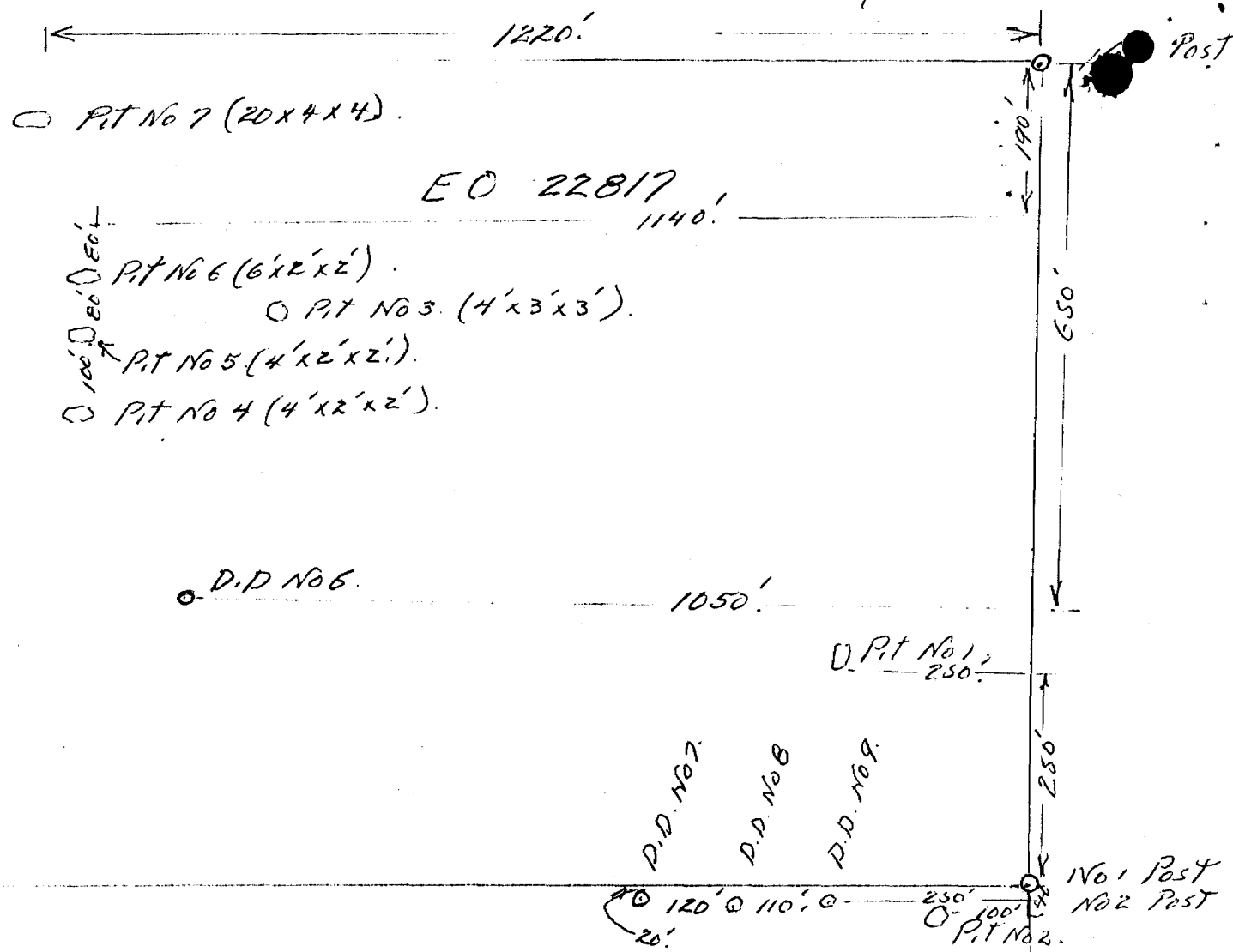

Drill footage

D.P. No 6 - 113.0'

D.D No 7 - 27.0'

D.P No 8 - 48.0'

D.D No 9 - 55.0'

173.0'

No 1 & 2 Pits - Old rock pits cleaned out

No 3 & 4 Pits - Trenches To rock in overburden

EO. 22819

Scale 1" = 200'

Handwritten signature

Diamond drill hole No. 1.

Claim No E O 22817 Methuen Twp.

dip - Vertical

Length - 42.0'

Date started - Oct 4/56

Date finished - Oct 5/56.

Log:

- 0-2.0 - Casing
2-7.0 - Coarse ore, heavy to massive mineral in gabbro.
7.0-12.0 - Medium mineral, fair pyrite
2 ft ground ore.
12.0-17.0 Heavy mineral, fair pyrite
17.0-22.0 " " " "
22.0-27.0 " " " "
27.0-32.0 Slight mineral neg. pyrite
in gabbro.
32.0-37.0 Slight mineral in gabbro.
37.0-42.0 Poritic gabbro, slight mineral.
End of hole at 42.0.

Note - "Mineral" refers to combined magnetite, ilmenite and hematite.

Signed

H F Taylor
P. Eng.

1-8-189

Diamond drill hole No 3.

Claim No E.O 22817 Methuen Twp.

dip - Vertical,
length 42.0'

Date started - Oct 8 1956

Date finished Oct 8 1956

Log.

0 - 2.0	Casing
2.0 - 7.0	Gabbro, med. mineral.
7.0 - 9.0	Barren acid dyke.
9.0 - 17.0	Gabbro, fair mineral.
17.0 - 27.0	" " "
27.0 - 37.0	" " "
37.0 - 42.0	Silicified and granitized gabbro.

End of hole at 42.0

H. F. Taylor
P. Eng.

Diamond Drill No 4

Claim No E.O 22817 Methuen Twp.

Dip Vertical

Length 48.0'

Date Started - Oct 9 1956

Date Finished - Oct 10 1956

Log

0-0 - 5.0	Casing				
5.0 - 10.0	Barro	heavy mineral	neg. pyrite		
10.0 - 15.0	"	"	"	"	"
15.0 - 20.0	"	"	"	"	"
20.0 - 25.0	"	Very Heavy mineral	"	"	"
25.0 - 30.0	"	"	"	"	"
30.0 - 35.0	"	"	"	"	"
35.0 - 40.0	"	Heavy mineral	"	"	"
40.0 - 48.0	Heavy	massive mineral			

End of hole at 48.0

Note "mineral" refers to combined magnetite, ilmenite and hematite.

Signed
H. J. Taylor
P. Eng.

Diamond drill hole No 5.

Class No E.O 22817 Methuen Twp.

Dip - Vertical

Length - 53.0 ft.

Date Started - Oct 11 1956

" finished - Oct 12 1956.

Liq.

0.0 - 1.0	Casing		
1.0 - 6.0	Cable	medium mineral.	
6.0 - 11.0	"	"	"
11.0 - 16.0	"	"	"
16.0 - 21.0	"	"	"
21.0 - 26.0	"	"	"
26.0 - 31.0	"	"	"
31.0 - 36.0	"	"	"
36.0 - 41.0	"	"	"
41.0 - 46.0	"	"	"
46.0 - 53.0	"	med. to heavy mineral.	

Note - "mineral refers to magnetite
ilmenite and hematite.

H. H. Taylor.

Diamond drill hole No 6.

Claim No E.O 22817. Metheun Twp.

Dip - Vertical

Length - 43.0

Date Started - Oct 13th 1956

" Finished - " 15 1956.

Log.

0-0 - 7.0	Collar.
3- 0 - 8.0	Heavy to massive mineral.
8.0 - 13.0	Heavy mineral slight pyrite
13.0 - 18.0	Heavy to massive mineral.
18.0 - 23.0	Medium to heavy mineral.
23.0 - 28.0	Medium mineral in gabbro.
28.0 - 33.0	Medium to heavy mineral
33.0 - 38.0	" " " "
38.0 - 43.0	Medium mineral with granite stringer at 43.0.

End of hole at 43.0.

Note "mineral" refers to magnetite
ilmenite and hematite.

Signed
W. H. Taylor
P. Eng.

Diamond Drill hole No 7.

Claim No E.O 22819.

Dip Vertical

Length - 27.0

Date Started - Oct 16/56

Date Finished - Oct 16/56.

Log

0.0 - 5.0 - Heavy to massive mineral
5.0 - 10.0 - " " " "
10.0 - 18.0 - Heavy mineral.
18.0 - 22.0 - massive mineral.
22.0 - 23.5 - heavy mineral.
23.5 - 27.0 - Fine grained basic rock
with horizontal shearing
slight mineralization.

End of hole at 27.0

Note - "mineral" refers to
magnetite, ilmenite and hematite

Signed
H F Taylor.

Diamond drill hole No 8.

Claim No E.O 22819.

Dip - Vertical

Length - 48.0 ft.

Date Started - Oct 17/56

Date Finished - Oct 18/56.

Log.

0.0 - 5.0 - medium to heavy mineral. in gabbro
5.0 - 10.0 - Heavy mineral in gabbro
10.0 - 15.0 - " to massive mineral
15.0 - 20.0 - " " " "
20.0 - 25.0 - Heavy mineral in gabbro.
25.0 - 30.0 - Heavy to massive mineral
30.0 - 35.0 - " " " "
35.0 - 43.0 - " " " "
43.0 - 48.0. Silicification at 43.0 - Slight
to medium mineral 43.5 - 45.0.
Very slight mineral 45.0 - 48.0
in fine grained basic rock.

End of hole at 48.0

Note "Mineral" refers to combined
magnetite, ilmenite and hematite.

Signed
H. J. Taylor.

Diamond drill hole No 9.

Claim No E.O 22819.

Dip - Vertical

Length - 55.0 ft

Date started - Oct 19/56.

Date finished - Oct 20/56.

Log.

0.0 - 5.0	Gabbro. slight to medium mineral.
5.0 - 10.0	" " " "
10.0 - 15.0	Medium to heavy mineral in gabbro
15.0 - 20.0	Medium mineral
20.0 - 25.0	Slight to medium mineral.
25.0 - 30.0	Medium mineral in gabbro
30.0 - 35.0	Slight to medium mineral in gabbro
35.0 - 40.0	" " " " " "
40.0 - 45.0	" " " " " "
45.0 - 50.0	" " " " " "
50.0 - 55.0	" " " " " "

End of hole - Note - "Mineral" refers to combined magnetite, ilmenite and hematite.

Signed
H. F. Taylor.