

FINAL SUBMISSION-TECHNICAL REPORT  
METHUEN TWP. BLACK GRANITE.

SEPT 18, 1992

WILLIAM JAY BROWN



010

OTHER APPLICANT FOR THIS PROJECT WILLIAM A. BROWN

LOCATION: SOUTHERN ONTARIO MINING DIVISION  
NORTH HALF METHUEN TWP. W<sup>1</sup>/<sub>2</sub> L10 C III

GEOLOGY: THE DEPOSIT IS AN ANORTHOSITIC  
GABBRO INTRUSIVE

OBJECTIVES OF 1<sup>ST</sup> OPAP GRANT (W.J. BROWN)

- TO FIND BEST STRIPPING TARGETS OUT OF NATURALLY EXPOSED OUTCROPS
- TO ACCESS THE PROPERTY AND STRIP AS MUCH AS POSSIBLE, STAYING WITHIN BUDGET.
- TO WASH THE STRIPPED ROCK WITH A PUMP AND FIRE HOSES.
- TO MAP THE WASHED ROCK AND DECIDE WHERE AND HOW IS THE BEST WAY TO SPEND THE 2<sup>ND</sup> OPAP GRANT (W.A. BROWN)

ACCESS: NORTH FROM HWY #7 + #30 INTERSECTION  
IN HAVELOCK 25 MILES. 1 MILE SOUTH  
OF TWIN LAKES ON WEST SIDE OF ROAD.

WORK ~~WAS~~ DONE ON CLAIMS 231489 (L)

219759 (L)

WORK DONE: TWO DAYS WERE SPENT PROSPECTING TO DECIDE WHERE TO STRIP AND HOW TO ACCESS THE PROPERTY.

SIX DAYS WERE SPENT STRIPPING WITH A 100 G DRESSER CRAWLER LOADER, EXPOSING AN AREA OF ABOUT 270' X 110'. AS WELL AS THE STRIPPING, A DECENT ROAD,  $\approx$  GOOD ENOUGH FOR PICK UPS, WAS PUSHED FOR ABOUT 500 FEET FROM THE COUNTY ROAD. THE MAJORITY OF THE FILL FOR THE ROAD CAME FROM THE OVERBURDEN FROM THE HILL STRIPPED, SOME FROM ALONG THE ROAD, AND ONE LOAD OF FINE FILL HAD TO BE PURCHASED FOR IN THE DITCH OF THE COUNTY ROAD.

THE NEXT STEP WAS WASHING THE HILL WITH A 2" HONDA PRESSURE PUMP, DRAWING THE WATER FROM THE NEARBY BEAVER POND. THIS STEP TOOK 14 DAYS WITH ONE PERSON ON THE HOSE AND ONE SHOVELLING AND PULLING HOSES AROUND. IT SEEMED A SLOW PROCESS, BUT PROVED TO VERY EFFECTIVE AND SUCCESSFUL.

AT THIS POINT THE PROPERTY WAS VISITED BY ED SOLONYKA AND STEVE VAN HAAFTEN.

THE NEXT STEP WAS TO LAY OUT A 10' X 10' GRID AND PLOT THE SURFACE FRACTURES ON A MAP TO GET A BETTER OVERALL VIEW OF WHERE THE BIGGER BLOCKS ARE CONCENTRATED.

RESULTS: THE AREA WITH THE MOST POTENTIAL FOR BIG BLOCKS IS IN THE SOUTHERNMOST PART OF THE STRIPPED AREA "AREA (A)". WITHOUT HAVING ANY REFERENCE TO HORIZONTAL BEDDING, IT IS COMMON IN THIS AREA FOR BLOCK SIZE ON SURFACE TO BE 4'x6', 6'x6', 6'x8' AND UP TO 8'x8', 10'x10' AND 12'x12'.

"AREA (B)" HAS QUITE REGULAR JOINTING PATTERNS WITH POTENTIAL BLOCK SIZES OF 3'x6' to 6'x8'.

"AREA (C)" IS THE TOP OF THE HILL AND HAS GOOD POTENTIAL FOR BIG BLOCKS BUT MAY BE HARDER TO MINE BECAUSE THERE ARE SMALLER WASTE BLOCKS THAT WOULD HAVE TO BE DEALT WITH FIRST.

CONCLUSIONS: THE COLOR AND GRAIN SIZE OF THIS "BLACK GRANITE" IS PROVING TO BE VERY UNIFORM.

MORE STRIPPING WILL FIND MORE BIG BLOCKS. WE DONT HAVE A DRILL TARGET THAT WOULD WARRANT HIRING A DRILL. THE BIGGEST, BEST LOOKING BLOCKS IN THE SOUTHEAST PART OF "AREA (A)" - MORE SPECIFICALLY 130 TO 150S, 35 TO 50 EAST HAPPENED TO BE WHERE THE STRIPPING STOPPED. THE TOPOGRAPHY IN THAT AREA IS DIPPING TO THE EAST. MORE STRIPPING ALONG THE HILL TO THE SOUTH AND DOWN THE SLOPE TO THE EAST WILL PROBABLY UNCOVER MORE BIG BLOCKS AND QUITE POSSIBLY A FREE FACE TO THE EAST TO BEGIN EXTRACTING BLOCKS FROM. IN DOING THIS STRIPPING, THE OVERBURDEN CAN BE USED TO EXTEND THE ROAD ALONG THE LOW GROUND TO THIS MOST INTERESTING AREA.

## RECOMMENDATIONS:

MY RECOMMENDATIONS ARE TO CHANGE  
THE SECOND OPAP GRANT BUDGET,  
(WILLIAM A. BROWN'S) FOR THE PROPERTY.

## ORIGINAL PROPOSED BUDGET FOR W.A. BROWN OPAP GRANT

EXTRACT TEST BLOCKS	\$ 3500.00
DIAMOND DRILL 250' @ \$20.00/ft.	\$ 5000.00
MILEAGE AND EXPENSES	\$ 1500.00
	<hr/>
	\$10,000.00

## RECOMMENDED CHANGES TO BUDGET FOR W.A. BROWN OPAP GRANT

SECOND PHASE STRIPPING	\$ 2500.00
HAND STRIP HYDRAULIC	\$ 3500.00
EXTRACT TEST BLOCKS	\$ 3000.00
MILEAGE AND EXPENSES	\$ 1000.00
	<hr/>
	\$10,000.00

I PLAN TO START THE SECOND PHASE  
OF STRIPPING BEFORE THE END OF SEPTEMBER

William Jay Brown.

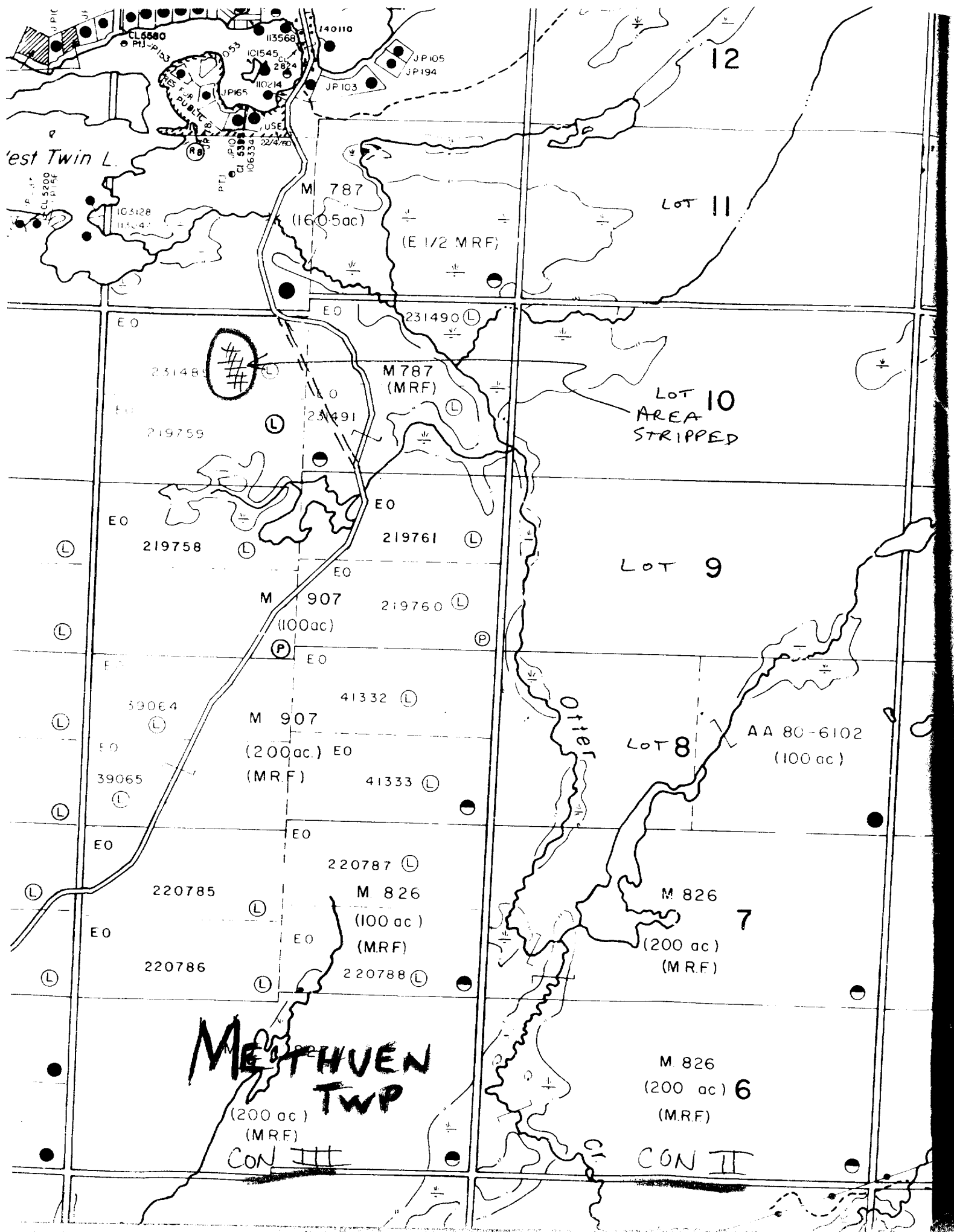

West Twin L.

12

LOT 11

LOT 10  
AREA  
STRIPPED

LOT 9

LOT 8

AA 80-6102  
(100 ac)

7

M 826  
(200 ac) 6  
(M.R.F)

CON II

METHUEN  
TWP

(200 ac)  
(M.R.F)

CON III

M 787  
(160.5ac)

(E 1/2 MRF)

M 787  
(MRF)

M 907  
(100ac)

M 907  
(200ac.) EO  
(M.R.F)

M 826  
(100 ac)  
(M.R.F)

M 826  
(200 ac)  
(M.R.F)

231485

219759

219758

39064

39065

220785

220786

231490

231491

219761

219760

41332

41333

220787

220788

EO

EO

EO

EO

EO

EO

EO

EO

EO

EO

EO

EO

EO

EO

EO

L

L

L

L

L

L

L

L

L

L

L

L

L

L

L

L

L

L

L

L

LOT 8

AA 80-6102  
(100 ac)

M 826  
(200 ac)  
(M.R.F)

M 826  
(200 ac) 6  
(M.R.F)

CON II

METHUEN  
TWP

(200 ac)  
(M.R.F)

CON III

M 787  
(160.5ac)

(E 1/2 MRF)

M 787  
(MRF)

M 907  
(100ac)

M 907  
(200ac.) EO  
(M.R.F)

M 826  
(100 ac)  
(M.R.F)

M 826  
(200 ac)  
(M.R.F)

231485

219759

219758

39064

39065

220785

220786

231490

231491

219761

219760

41332

41333

220787

220788

EO

EO

EO

EO

EO

EO

EO

EO

EO

EO

EO

EO

EO

EO

EO

L

L

L

L

L

L

L

L

L

L

LOT 8

AA 80-6102  
(100 ac)

M 826  
(200 ac)  
(M.R.F)

M 826  
(200 ac) 6  
(M.R.F)

CON II

METHUEN  
TWP

(200 ac)  
(M.R.F)

CON III

M 787  
(160.5ac)

(E 1/2 MRF)

M 787  
(MRF)

M 907  
(100ac)

M 907  
(200ac.) EO  
(M.R.F)

M 826  
(100 ac)  
(M.R.F)

M 826  
(200 ac)  
(M.R.F)

231485

219759

219758

39064

39065

220785

220786

231490

231491

219761

219760

41332

41333

220787

220788

EO

EO

EO

EO

EO

EO

EO

EO

EO

EO

EO

EO

EO

EO

EO

L

L

L

L

L

L

L

L

L

L

LOT 8

AA 80-6102  
(100 ac)

M 826  
(200 ac)  
(M.R.F)

M 826  
(200 ac) 6  
(M.R.F)

CON II

METHUEN  
TWP

(200 ac)  
(M.R.F)

CON III

M 787  
(160.5ac)

(E 1/2 MRF)

M 787  
(MRF)

M 907  
(100ac)

M 907  
(200ac.) EO  
(M.R.F)

M 826  
(100 ac)  
(M.R.F)

M 826  
(200 ac)  
(M.R.F)

231485

219759

219758

39064

39065

220785

220786

231490

231491

219761

219760

41332

41333

220787

220788

EO

EO

EO

EO

EO

EO

EO

EO

EO

EO

EO

EO

EO

EO

EO

L

L

L

L

L

L

L

L

L

L

LOT 8

AA 80-6102  
(100 ac)

M 826  
(200 ac)  
(M.R.F)

M 826  
(200 ac) 6  
(M.R.F)

CON II

METHUEN  
TWP

(200 ac)  
(M.R.F)

CON III

M 787  
(160.5ac)

(E 1/2 MRF)

M 787  
(MRF)

M 907  
(100ac)

M 907  
(200ac.) EO  
(M.R.F)

M 826  
(100 ac)  
(M.R.F)

M 826  
(200 ac)  
(M.R.F)

231485

219759

219758

39064

39065

220785

220786

231490

231491

219761

219760

41332

41333

220787

220788

EO

EO

EO

EO

EO

EO

EO

EO

EO

EO

EO

EO

EO

EO

EO

L

L

L

L

L

L

L

L

L

L

LOT 8

AA 80-6102  
(100 ac)

M 826  
(200 ac)  
(M.R.F)

M 826  
(200 ac) 6  
(M.R.F)

CON II

METHUEN  
TWP

(200 ac)  
(M.R.F)

CON III

M 787  
(160.5ac)

(E 1/2 MRF)

M 787  
(MRF)

M 907  
(100ac)

M 907  
(200ac.) EO  
(M.R.F)

M 826  
(100 ac)  
(M.R.F)

M 826  
(200 ac)  
(M.R.F)

231485

219759

219758

39064

39065

220785

220786

231490

231491

219761

219760

41332

41333

220787

METHUEN S.P.T.  
REFERENCES

AREAS WITHDRAWN FROM DISPOSITION

M.R.O.	MINING RIGHTS ONLY	S.R.O.	SURFACE RIGHTS ONLY	M.S.S.	MINING AND SURFACE RIGHTS
4647 7/	Surface Mining R/S 5786				
521/75	SR & MR				
1402/85	SR, D.				

NOTES

ACREAGE SHOWN IN BRACKETS ON PATENTED LOTS ARE IN ACCORDANCE WITH EACH RESPECTIVE DEED

SYSTEM OF SURVEY: DOUBLE PRICED, HALF-ANGLE TRIANGULATION. SEE SPECIAL ACT 10, GEOLOGICAL CHAPTER 10: 244

ALL MINING CLAIMS ARE SUBJECT TO SURVEY (Sec 118 of the Mining Act)

DATE OF ISSUE  
MAY - 7 1990

LEGEND

HIGHWAY AND ROUTE NO.	(Symbol)
TRAIL	(Symbol)
SURVEYED LINES	(Symbol)
TOWNSHIP BASE LINES ETC.	(Symbol)
LOTS MINING CLAIMS PARCELS ETC.	(Symbol)
UNDEVELOPED LINES	(Symbol)
LOT LINES	(Symbol)
PARCEL BOUNDARY	(Symbol)
MINING CLAIMS ETC.	(Symbol)
RAILWAY AND RIGHT OF WAY	(Symbol)
UTILITY LINES	(Symbol)
NON PERENNIAL STREAM	(Symbol)
FLOODING OF FLOODING RIGHTS	(Symbol)
SUBDIVISION OR COMPOSITE PLAN	(Symbol)
RESERVATIONS	(Symbol)
ORIGINAL SHORELINE	(Symbol)
MARSH OR MUSKEG	(Symbol)
MINES	(Symbol)
TRAVELER MONUMENT	(Symbol)

DISPOSITION OF CROWN LANDS

TYPE OF DOCUMENT	SYMBOL
PATENT SURFACE & MINING RIGHTS	(Symbol)
PATENT SURFACE RIGHTS ONLY	(Symbol)
MINING RIGHTS ONLY	(Symbol)
LEASE SURFACE & MINING RIGHTS	(Symbol)
SURFACE RIGHTS ONLY	(Symbol)
MINING RIGHTS ONLY	(Symbol)
LICENSE OF OCCUPATION	(Symbol)
ORDER IN COUNCIL	(Symbol)
RESERVATION	(Symbol)
CANCELLED	(Symbol)
LAND & GRAVEL	(Symbol)

SCALE: 1 INCH = 20 CHAINS

1:50,000

TOWNSHIP  
**METHUEN** (SOUTH HALF)  
M.N.R. ADMINISTRATIVE DISTRICT  
**BANCROFT**  
MINING DIVISION  
SOUTHERN ONTARIO  
LAND TITLES / REGISTRY DIVISION  
**PETERBOROUGH**

Ministry of Natural Resources  
Ontario

Ministry of Northern Development and Mines

5th FEBRUARY, 1987

G-3053

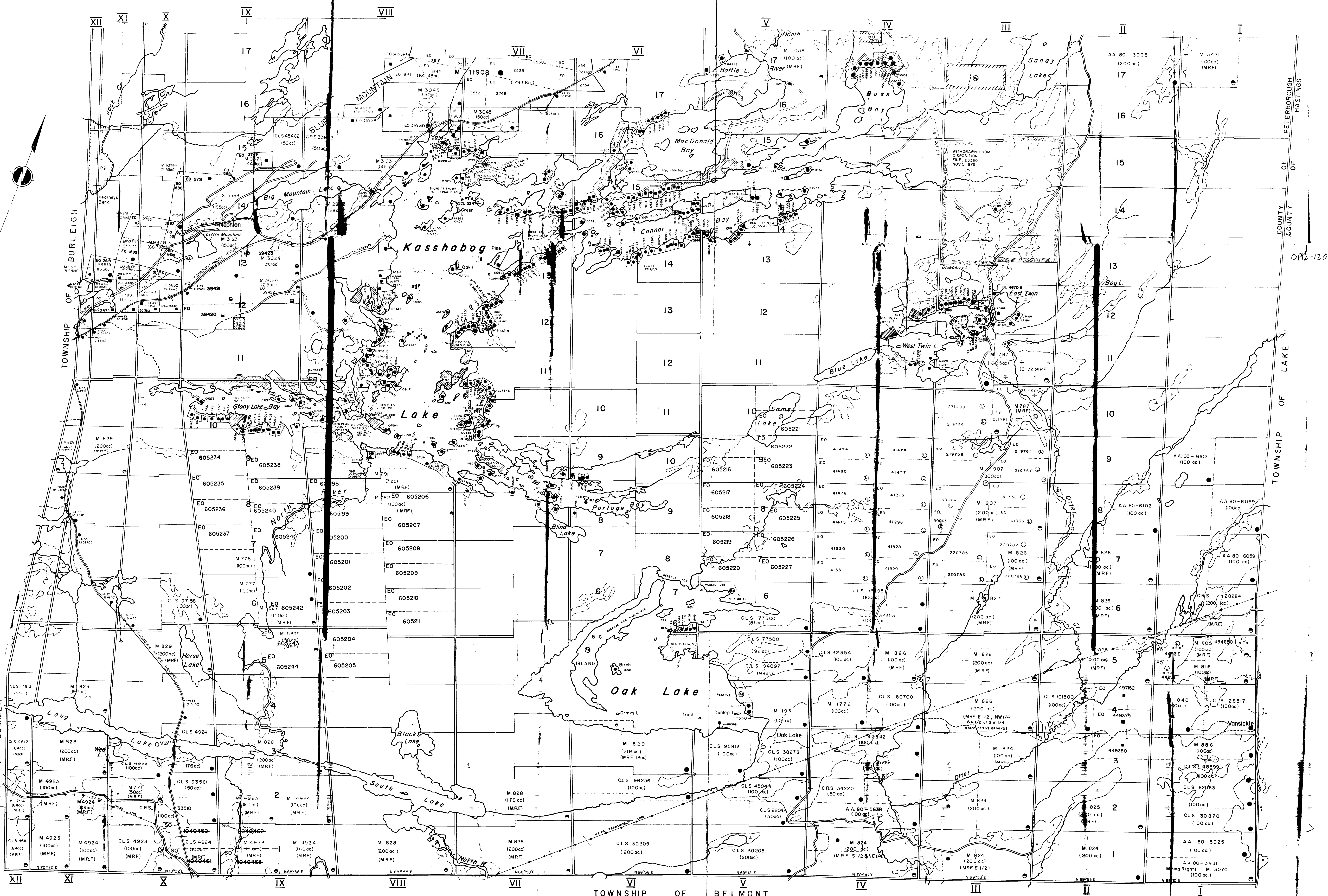

B

# METHUEN TWP BLACK GRANITE 1ST PHASE STRIPPING

SCALE: 1 INCH = 10 FEET

JOINTING AND FRACTURE PLOT.

120+00N

110+00N

100+00N

90+00N

80+00N

70+00N

60+00N

50+00N

40+00N

30+00N

20+00N

10+00N

0+00N

10+00S

20+00S

30+00S

40+00S

50+00S

60+00S

70+00S

80+00S

90+00S

100+00S

110+00S

120+00S

130+00S

140+00S

150+00S

160+00S

170+00S

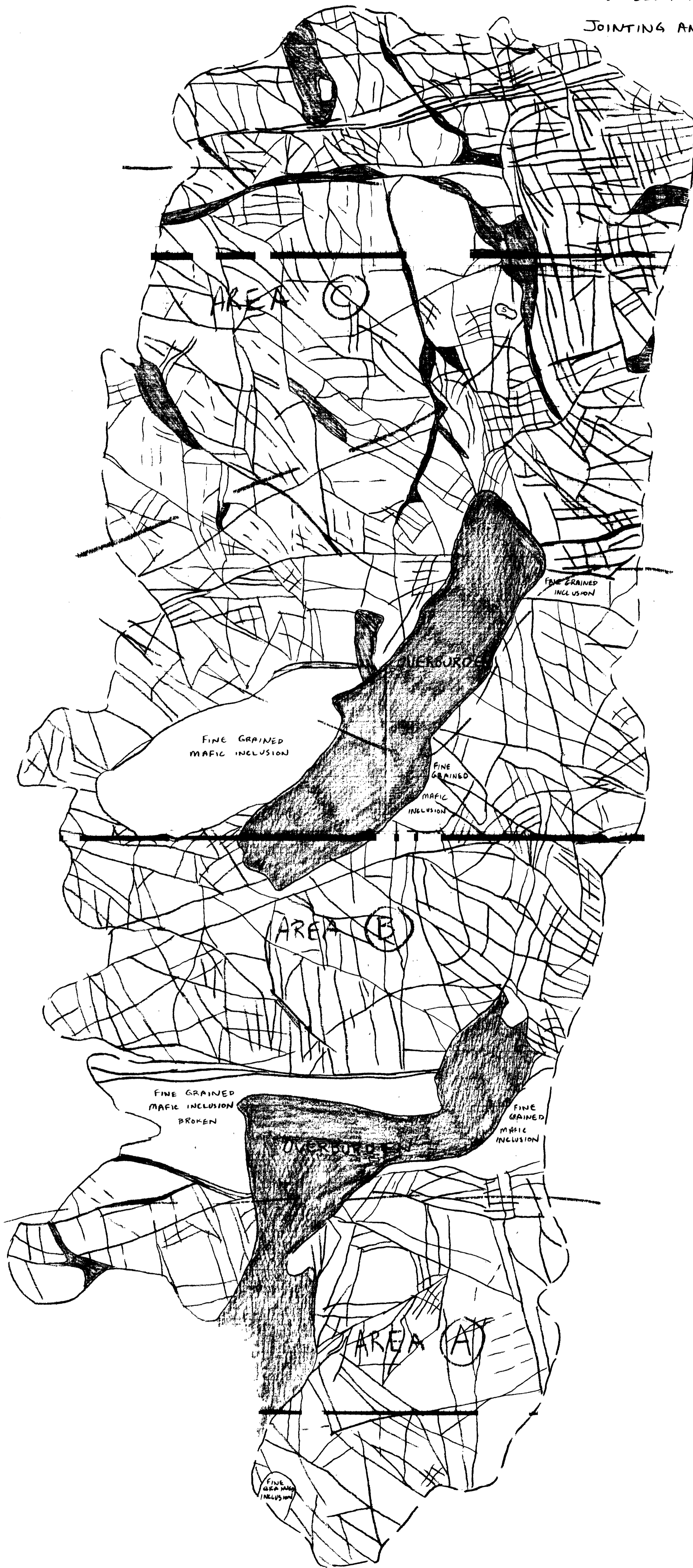

1  
B

