

2. 26262

TRIGAN RESOURCES INC.
ASSESSMENT REPORT
WEST GABBRO PROPERTY
METHUEN TOWNSHIP, SOUTHERN ONTARIO DISTRICT

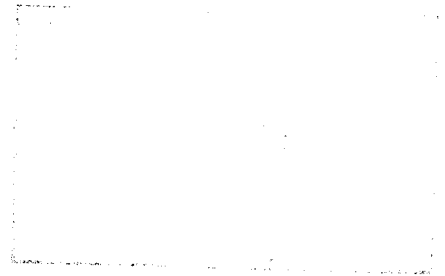

PROVINCIAL RECORDING
OFFICE - SUDBURY
RECEIVED
SEP 09 2003
A.M. *in m* 2:30 P.M.
7 | 8 | 9 | 10 | 11 | 12 | 1 | 2 | 3 | 4 | 5 | 6

August 31st, 2003



CONTENTS

	Page
SUMMARY	2
INTRODUCTION	2
PROPERTY	
Location and Access	2
Property Description and Status	3
REGIONAL GEOLOGY	3
PROPERTY GEOLOGY	3
WORK CARRIED OUT	
Introduction	4
Diamond Drilling	4
Borehole Lithology	6
Borehole Sampling and Aggregate Testing	7
STATEMENT OF QUALIFICATIONS	8
APPENDIX	
Borehole logs WG-1 to WG-10	9
FIGURES	
Figure 1: Location and Claim Map	2a
Figure 2: Borehole Location Map	In Pocket
Figure 3: Borehole Vertical Section	In Pocket
TABLES	
Table 1: Claim Status	3
Table 2: Borehole Summary	5-6
Table 3: Borehole Lithology	7

SUMMARY

Trigan Resources of Aurora, Ontario owns eight contiguous claims in the southwest part of Methuen Township, covering the western portion of a gabbroic body known as the West Gabbro.

In August 2003 Trigan Resources carried out a drilling program of ten holes (WG-1 to WG-10) for a total of 405 m to test the West Gabbro for its aggregate potential.

The drill holes intersected medium grained gabbro with adsorbed metasedimentary inclusions cut by granite dykes. All three lithologies form tough, cohesive rocks which should have properties suitable for aggregate resource material.

Representative bulk samples were taken from each borehole and submitted for aggregate testing. Results of these tests are pending.

INTRODUCTION

The Trigan West Gabbro Methuen Property was acquired for its potential as a source of high quality bedrock aggregate.

In July and August of 2003 a ten-hole diamond drilling program was undertaken to evaluate the quality of the bedrock as an aggregate resource in an area adjacent to and east of the railway line. Ten vertical holes were drilled to depths of between 100 and 150 m for a total of 405.2 m. Samples of core have been submitted for aggregate testing.

This report describes the results of the drilling program

PROPERTY

Location and Access

The property is located in the south half of Methuen Township in southern Ontario (Figure 1). The western boundary of the property is on the Township line between Methuen and Burleigh and Drummer Townships to the west. Regional road No. 6 runs north to south approximately 1 km west of the property and provides the easiest means of access. A dirt trail running eastwards from this road provides foot access to the northwest part of the property (Figure 2). The CPR branch rail line from Havelock to the Unimin operation at Nephton crosses the property from south to north.

Drill access to the property is greatly impeded by private land on one hand and by rough terrain and swamp on the other. Negotiations the railway operators for access up the railway line and with private land owners for the easiest access eastwards from Regional road #6, were both unsuccessful. Instead the drill rig had to be mobilized from the road running around the southwest arm of Kasshabog Lake. This route had to be carefully laid out to avoid steep slopes and the maze of swamps typical of the area (Figure 2).

The topography of the northern part of the property is characterized by a rugged ridge of red granite. As the gabbro contact is approached from the north, the terrain becomes more moderate but is characterized by extensive, beaver-dammed swamps.

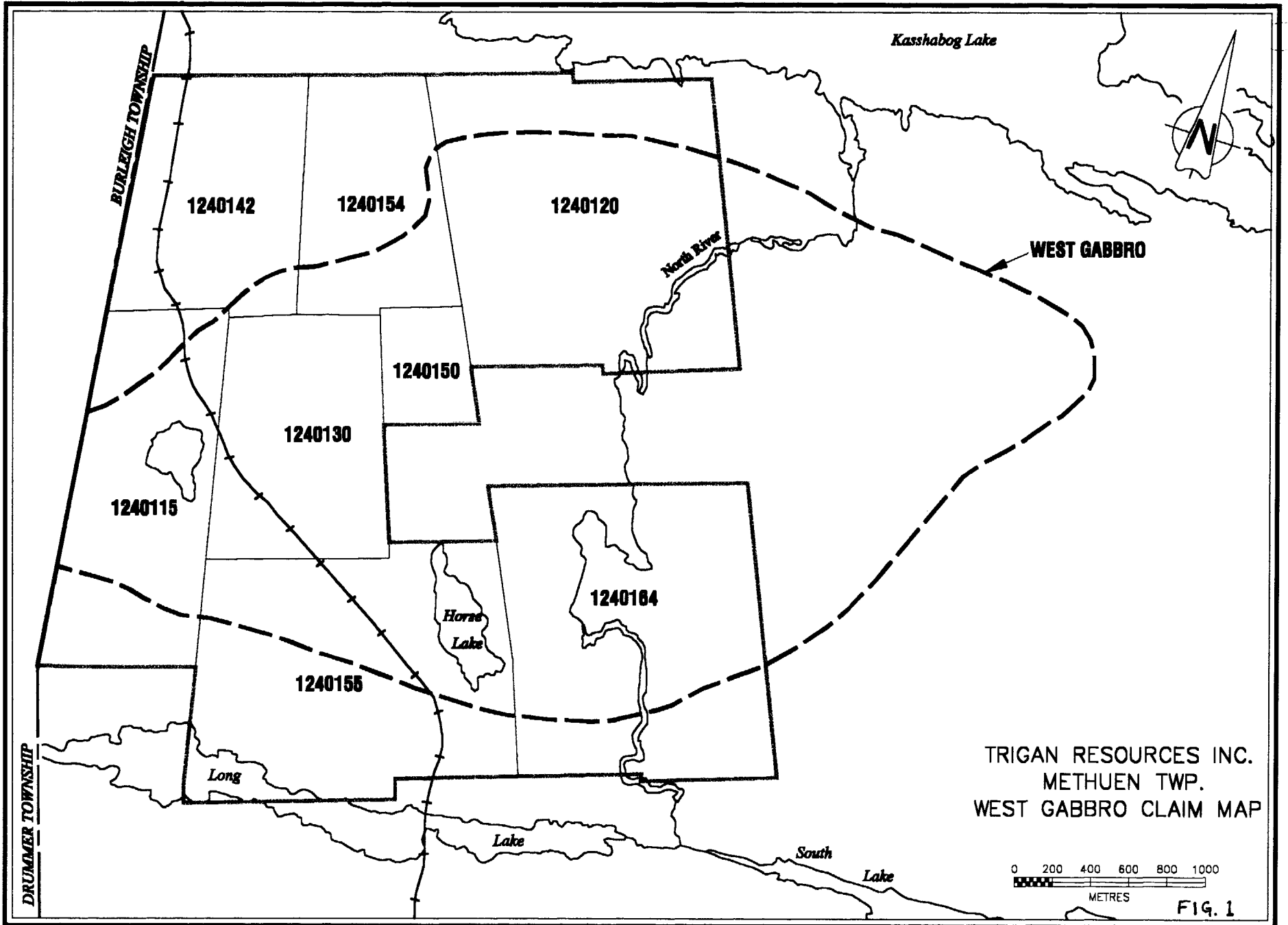

TRIGAN RESOURCES INC.
METHUEN TWP.
WEST GABBRO CLAIM MAP

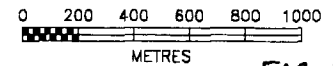

FIG. 1

Property Description and Status

The property is registered in the name of Trigan Resources Inc. 445 Beacon Hall Drive, Aurora, Ontario, L4G 3G8. The property consists of eight contiguous claims located within Concessions IX to XII and Lots 4 to 9 of the southern half of Methuen Twp in Southern Ontario. The claims were recorded between December 9th 1999 and March 6th 2000 (Figure 2 and Table 1). Previous assessment work on these claims was filed December 5th 2001 (Submission No.2.22696, Transaction No.WO190.31321).

Extensions of Time on these claims (except 1240130) was applied for and granted by the Provincial Recording Office. Claim 1240120 was extended to September 6th 2003 and claims 1240115, 1240142, 1240150, 1240154, 1240155 and 1240164 to September 10th 2003.

Claim 1240130 has assessment applied to the amount of \$14,670.

Table 1
West Gabbro Claims Status

Claim No	Recording Date	Due Date	Units	Comments
1240115	Dec 10 th , 1999	Dec 10 th 2002	12	Under Extension to Sept 10 th 2003
1240120	March 6 th 2000	March 6 th 2003	10	Under Extension to Sept 6 th 2003
1240130	Dec 10 th 1999	Dec 10 th 2003	8	\$14,670 in applied assessment
1240142	Dec 10 th 1999	Dec 10 th 2002	12	Under extension to Sept 10 th 2003
1240150	Dec 10 th 1999	Dec 10 th 2002	2	Under Extension to Sept 10 th 2003
1240154	Dec 10 th 1999	Dec 10 th 2002	8	Under Extension to Sept 10 th 2003
1240155	Dec 10 th 1999	Dec 10 th 2002	12	Under extension to Sept 10 th 2003
1240164	Dec 9 th 1999	Dec 9 th 2002	10	Under extension to Sept 10 th 2003

REGIONAL GEOLOGY

Methuen Township is underlain by mainly northeast-trending Late Precambrian, Grenville metasedimentary rocks intruded by younger granitic gneisses, granites syenites and gabbros. The metasedimentary rocks have been subjected to multiphase deformation and regional metamorphism. Contact metamorphism is evident especially around some of the gabbroic intrusives. Flat lying Ordovician limestone and dolomitic limestone occurs as isolated outliers in the southern part of the Township (ODM Map 1960e).

Two ovoid-shaped, easterly-trending, basic to intermediate intrusions semi-conformably intrude the Grenville metasediments in the area of the property (Figure 2). These two intrusions, referred to as the East Gabbro and the West Gabbro, vary in composition through gabbroic anorthosite to gabbro to monzonite. The gabbroic anorthosite and gabbro portions of the intrusions are the focus for the establishment of an aggregate resource. In the easternmost part of the Eastern Gabbro, gabbroic anorthosite hosts a pipe-like occurrence of semi-massive to massive ilmenite mineralization.

PROPERTY GEOLOGY

The claims primarily cover the basic to intermediate intrusive rocks of the West Gabbro, which to the north and south is in contact with reddish granitoid rocks, commonly described as "red granite", of variable composition and texture.

The gabbro typically consists of 1:1 plagioclase and mafic minerals (augite and/or hornblende). Near surface weathering of this rock imparts a reddish hue to the plagioclase but in fresh samples the plagioclase is light grey. The contacts between the gabbro and the red granite are very diffuse; in the contact area there appears to be much intermixing of the two rocks possibly as inclusions of granite in gabbro or remobilization of the granite at the gabbro contact and intrusion of this remobilized material into the gabbro.

On a regional scale it appears that the gabbro is intruded into the granite (i.e. the granite is earlier than the gabbro) but in detail in the diamond drill core it is obvious that later granite dykes cut the gabbro. This could result from remobilization of the granite after intrusion of the gabbro

The granitoid rocks outside the limit of the gabbro commonly contain inclusions of banded or gneissic metasedimentary rocks which generally maintain their orientation to the regional trends.

WORK CARRIED OUT

Introduction

Previous work by Trigan Resources on the East Gabbro has established an extensive resource of high quality bedrock aggregate in the area of the gabbro southeast of the titanium occurrence. Trigan viewed the West Gabbro as another possible high quality gabbro aggregate resource with the added advantage of proximity to a rail line and use of this as a mode of transportation.

Reconnaissance mapping and sampling of the West Gabbro in 2001 confirmed the presence of the gabbro and a sample sent for aggregate testing came back with favourable results. Before proceeding further it was decided to test the area immediately east of the rail track by drilling 10 widely spaced (200 – 300 m) vertical diamond drill holes, each to a depth of approximately 50 m. This drilling provided fresh material for aggregate testing and provided information regarding the consistency of the material to a depth of 50 m.

Contractors and personnel involved in the work are as follows:

- Don Phipps, 98 Kingsmount Blvd., Sudbury, Ontario, P3E 1K6. Phone: 705-673-2510
- Oakridge Environmental Ltd., P.O. Box 431, Peterborough, Ontario, K9J 6Z3. Phone: 705-745-1181
- Agile Drilling Inc, 76 Henry St., Garson, Ontario, P3L 1A4. Phone: 705-693-4101

Don Phipps supervised the work, logged and sampled the core and wrote this assessment report.

Oakridge Environmental Ltd. carried out property ownership investigations and negotiations and searched for alternative access routes into the drilling area. They also prepared the borehole location map and the drill section diagram.

Agile Drilling Inc carried out the diamond drilling, using a Longyear 28 diamond drill machine mounted on a Komatsu "Morooka" rubber tracked carrier. The drill was mobilized onto the property July 26th and the drilling program was completed on August 24th. The holes were drilled with a BQ thin-wall drill string providing core slightly less than NQ in size.

Diamond Drilling

Ten vertical holes (WG 1 to 10) were drilled for a total of 405 m (1329 ft). The following table summarizes the information on the holes. Drill logs for each hole are filed in the Appendix.

Table 2
Borehole Summary of Diamond Drilling on West Gabbro Methuen Twp. August 2003
 (All holes drilled vertical)

Borehole #	UTM (Nad 27) Location		Depth (m)	Abbreviated Log		
				From	To	Rock Type
WG-1	0262250E	4941917N	43.10	00.00	1.50	Casing
				1.50	3.84	Gabbro
				3.84	4.34	Granite and gabbro
				4.34	17.21	Gabbro
				17.21	17.93	Granite
				17.93	19.97	Gabbro
				19.97	20.72	Granite
				20.72	21.50	Gabbro
				21.50	22.31	Granite
				22.31	36.95	Gabbro
				36.95	39.87	Granite
				39.87	43.10	Gabbro EOH
WG-2	0262320	4941673	43.28	00.00	1.04	Casing
				1.04	43.28	Gabbro EOH
WG-3	0262377	4941426	45.72	00.00	0.98	Casing
				0.98	5.41	Gabbro
				5.41	8.62	Granite
				8.62	45.72	Gabbro EOH
WG-4	0262164	4941346	45.72	00.00	0.86	Casing
				0.86	1.12	Granite
				1.12	3.88	Gabbro
				3.88	4.67	Granite
				4.67	7.18	Gabbro
				7.18	7.94	Metasediment
				7.94	8.57	Gabbro
				8.57	19.18	Metasediment
				19.18	21.33	Granite
				21.33	32.47	Metasediment
				32.47	37.53	Gabbro
				37.53	45.72	Metasediment EOH
WG-5	0262622	4941366	45.72	00.00	1.04	Casing
				1.04	32.00	Gabbro
				32.00	36.31	Metasediment
				36.31	40.29	Gabbro
				40.29	45.72	Gabbro EOH

WG-6	0262541	4941129	38.10	00.00	1.20	Casing
				1.20	2.46	Gabbro
				2.46	5.30	Metasediment
				5.30	6.33	Granite
				6.33	24.48	Metasediment
				24.48	25.47	Granodiorite
				25.47	38.10	Metasediment EOH
WG-7	0262789	4940982	33.92	00.00	0.82	Casing
				0.82	12.60	Gabbro
				12.60	13.24	Granite
				13.24	22.18	Gabbro
				22.18	22.64	Granite
				22.64	25.52	Gabbro
				25.52	26.62	Silicified breccia
				26.62	31.02	Gabbro
				31.02	31.45	Granite
				31.45	33.92	Gabbro EOH
WG-8	0262910	4940836	31.86	00.00	1.06	Casing
				1.06	12.97	Granodiorite/gabbro
				12.97	14.96	Granodiorite
				14.96	21.00	Gabbro
				21.00	21.97	Granodiorite
				21.97	22.53	Gabbro
				22.53	25.30	Granite
				25.30	27.20	Granodiorite
				27.20	31.86	Metasediment EOH
WG-9	0262804	4940711	41.21	00.00	1.05	Casing
				1.05	41.21	Gabbro EOH
WG-10	0262526	4940873	36.58	00.00	0.98	Casing
				0.98	36.58	Gabbro EOH

The holes were drilled to a depth of between 31.8 m (104 ft) and 45.7 m (150 ft). Core recovery for all the holes was excellent. The core is currently stored at the residence of William Brown in Havelock (RR#2, Havelock, K0L 1Z0).

Borehole Lithology

Rock types encountered included varying proportions of gabbro, granite and minor granodiorite and hornfelsed metasedimentary inclusions. Gabbro is the dominant rock type in most of the holes. A breakdown of the percentage of each rock type in the boreholes is given in Table 3

The gabbro is a fresh, grey, medium grained rock with 40 to 50% mafic content. Commonly contained within the gabbro are finer grained, granular gabbroic patches which are probably hornfelsed, partially

absorbed metasedimentary inclusions. The gabbro contains no sulphides and is weakly magnetic. Boreholes WG-2, 9 and 10 are essentially 100% gabbro with minor sedimentary inclusions and minor granite veining. Boreholes WG-1, 3, 5 and 7 contain > 85% gabbro. Holes WG-4 and 6 contain significantly less gabbro (24% and 3% respectively) with metasediment being the major lithology.

Table 3
Borehole Lithology

Borehole #	% Gabbro	% Granite	% Metased
WG-1	87	13	-
WG-2	100.0	-	-
WG-3	93	7	-
WG-4	24	8	68
WG-5	90	-	10
WG-6	3	6	91
WG-7	92	5	3
WG-8	41	44	15
WG-9	100	-	-
WG-10	100	-	-

Granite occurs as dykes cutting through the gabbro. These dykes are rarely more than a meter wide and commonly only a few centimeters wide. The granite is typically pink, medium to coarse grained with only minor mafic mineral content. Patches of black tourmaline concentrations occur in the granite. Granite rarely exceeds 10% of the core lithology. A more mafic variety of granite (termed granodiorite) is prominent (44%) in borehole WG-8. The granodiorite may be a hybrid rock resulting from the contamination of granite by either gabbro and/or metasediment.

The metasedimentary inclusions occur in varying concentrations in the gabbro. They are characteristically finer grained than the gabbro, granular, light grey in colour and, for the most part, lack any igneous texture. In some inclusions there is some development of igneous texture even to the point of a weakly porphyroblastic texture. Some metasedimentary inclusions retain evidence of layering or banding. Boreholes WG-4 and 6 contain significant intersections of metasedimentary material with a corresponding much lower gabbro content.

Sampling and Aggregate Testing

The core was sampled by taking a 5 to 8 cm piece of core from the start of each row in the core box. This method ensured a random, unbiased sampling of the core to give a representative sample of each borehole.

Samples from holes WG-1, 2 and 3 were combined into one sample; these three holes are predominantly gabbro (87%, 100% and 93% respectively). Samples from the remaining holes were made into one sample for each hole for a total of eight separate samples.

The eight samples were submitted to John Emery Geotechnical Engineering Ltd. at 109 Woodbine Downs Boulevard, Toronto, M9W 6Y1 for aggregate testing. The results of these tests are pending.

STATEMENT OF QUALIFICATIONS

The writer of this report, Don Phipps, is the Geological Consultant to Trigan Resources Inc. He is a certified member of the APGO, a member of the Canadian Institute of Mining and Metallurgy, and the Prospectors and Developers Association of Canada. The professional qualifications of the writer include the following.

Graduate of the Camborne School of Mines with Mining Diploma

Graduate of McGill University, B.Sc.Honours Geology

Graduate of the Massachusetts Institute of Technology, M.Sc. in Oceanography

Over 30 years as a practicing professional geologist, mainly in the field of mineral exploration.

.....



APPENDIX



Ministry of Northern Development and Mines / Ministère du Développement du Nord et des Mines

Diamond Drilling Log / Journal de forage au diamant

Complete this form and related sketch in duplicate. Remplir en deux exemplaires la présente formule et le croquis annexe

Fill in on every page. Remplir ces cases à chaque page.

Hole No. Forage n°: **WG-1**
Page No. Page n°: **1**

Under section 8 of the Mining Act, this information is used to maintain a public record. Aux termes de l'article 8 de la Loi, ces renseignements serviront à tenir à jour les dossiers publics.

Drilling Company Compagnie de forage Agile Drilling	Core Size Dimensions de la carotte BQ thin wall	Collar Elevation Elevation du collier	Bearing of hole from true North Position du forage par rapport au nord vrai	Total Footage Avancement total du forage 43.10 m	Dip of Hole at Inclinaison du forage au Collier/collier 90	Address/Location where core stored Adresse/endroit où la carotte est stockée William Brown RR #2 Havelock Ontario, K0L 1Z0	Map Reference No. N° de référence sur la carte	Claim No. N° de concession minière 124030
Date Hole Started Date de commencement du forage July 31/03	Date Completed Date d'achèvement Aug 04/03	Date Logged Date d'inscription au journal Aug 05/03	Logged by (print) Inscrit par (écrire en lettres moulées) Don Phipps				Location (Twp, Lot, Con. or Lat. and Long.) Emplacement (canton, lot, concession, ou latitude et longitude) Methuen Twp, Conc 1 Lot 7 UTM (Nad 27) 0262250E 4941917N	
Exploration Co. Owner or Optionee Compagnie d'exploration, propriétaire ou titulaire d'option Trigan Resources			Logged by (Signature) Inscrit par (signature) <i>Donna Phipps</i>				Property Name Nom de la propriété West Gabbro	

Footage/Avancement		Rock type	Description (Colour, grain size, texture, minerals, alteration, etc.)	Angle of foliation angle des schistes ou schistosité	Stratification stratification des schistes	Thin Section N° de section	Assays/Analyses minéralogiques	
From/De	To/A	Type de roche	Description (Couleur granulométrie, texture, minéraux, transformation, etc.)				From/De	To/A
0.0	1.5	Casing						
1.5	3.84	Gabbro	Two phases of fresh, unaltered gabbro, a coarser grained phase (40%) and a finer grained phase (60%). Both phases composed of 50% plagioclase and 50% mafics. Weakly magnetic. Trace pyrite					
3.84	4.34	Granite and Gabbro	Mainly a pink granite with c.5% biotite. Non-magnetic. Includes about 40% gabbro as above					
4.34	7.83	Gabbro	M.g Gabbro as above with 5-10% finer grained patches					
7.83	12.04	Gabbro	Mixture of finer (70%) and coarser (30%) grained phases of gabbro. Includes 0.14 m of granite					
12.04	12.87	Leuco-gabbro	Light grey sugary textured f.g. leuco gabbro with 20% mafics					
12.87	17.21	Gabbro	Zone of mixed f.g. and m.g. gabbro					
17.21	17.93	Granite	C.g. more mafic (20%), weakly magnetic granite with gabbroic patches					
17.93	19.97	Gabbro	M.g. gabbro with minor mixing with pink granite. Minor pink feldspar phenocrysts in gabbro					
19.97	20.72	Granite	M.g. pink granite with 5-10% biotite					
20.72	21.50	Gabbro	Variable gabbro with more mafic zones. 1 cm qtz vein with minor py. cpy and magnetite					
21.50	22.31	Granite	As previously		21.8			Thin Section
22.31	36.95	Gabbro	Variable gabbro with m.g. and finer grained sections plus 30 cm of pinkish granitic portions		34.0			Thin Section
36.95	39.87	Granite	Same m.g. granite with 5-10% biotite. Last 30 cm grades into f.g. gabbro.					
39.87	43.10	Gabbro	F.g. mafic gabbro (70% mafics) with two sections (30 cm and 38 cm) of granite		43.1			Thin Section
	43.10		EOH					

*For features such as foliation, bedding, schistosity, measured from the long axis of the core

*Exemples de caractéristiques : foliation, schistosité, stratification. L'angle est mesuré par rapport à l'axe longitudinal de la carotte



Ministry of Northern Development and Mines
Ministère du Développement du Nord et des Mines

Diamond Drilling Log
Journal de forage au diamant

Complete this form and related sketch in duplicate.
Remplir en deux exemplaires la présente formule et le croquis annexé

Fill in on every page
Remplir ces cases à chaque page

Hole No. Forage n°	Page No. Page n°
WG-2	1

Under section 8 of the Mining Act, this information is used to maintain a public record. Aux termes de l'article 8 de la Loi, ces renseignements serviront à tenir à jour les dossiers publics.

Drilling Company Compagnie de forage Agile Drilling	Core Size Dimensions de la carotte BQ thin wall	Collar Elevation Élévation du collier	Bearing of hole from true North Position du forage par rapport au nord vrai	Total Footage Avancement total du forage 43.28	Dip of Hole at Inclinaison du forage au Collar/collier 90	Address/Location where core stored Adresse/endroit où la carotte est stockée William Brown RR # 2 Havelock Ontario K0L 1Z0	Map Reference No. N° de référence sur la carte	Claim No. N° de concession minière 124030
Date Hole Started Date de commencement du forage August 4th	Date Completed Date d'achèvement August 5th	Date Logged Date d'inscription au journal August 6th	Logged by (print) Inscrit par (écrire en lettres moullées) Don Phipps		F1/P1		Location (Twp, Lot, Con. or Lat. and Long.) Emplacement (canton, lot, concession, ou latitude et longitude) Methuen Twp, Conc 10, lot 7 UTM (Naa 27) 0262320E 4941673N	
Exploration Co., Owner or Options Compagnie d'exploration, propriétaire ou titulaire d'option Trigan Resources			Logged by (Signature) Inscrit par (signature) <i>Donna Phipps</i>		F1/P1		Property Name Nom de la propriété West Gabbro	

Footage/Avancement		Rock type	Description (Colour, grain size, texture, minerals, alteration, etc.)	Placer Footage Forage de placier (mètres)	Loss Footage Pertes de forage (mètres)	Total Sample Length Longueur totale de l'échantillon (mètres)	Sample Length Longueur de l'échantillon (mètres)	Assays/Analyses minéralogiques	
From/De	To/A	Type de roche	Description (Couleur, granulométrie, texture, minéraux, transformation, etc.)			From/De	To/A		
00.0	1.04	Casing							
1.04	43.28	Gabbro	The entire hole is in gabbro, predominantly medium grained with minor textural variations. There are minor patches of finer grained gabbroic material and minor veining of granitic veins 1-2 cm wide. There are rare carbonate-chlorite-pyrite slips up to 1 cm wide and at a low core angle i.e near vertical.		12.8			Thin	Section
	43.28	EOH							

*For features such as foliation, bedding, schistosity, measured from the long axis of the core
*Exemples de caractéristiques : foliation, schistosité, stratification. L'angle est mesuré par rapport à l'axe longitudinal de la carotte



Ministry of Northern Development and Mines
Ministère du Développement du Nord et des Mines

Diamond Drilling Log
Journal de forage au diamant

Complete this form and related sketch in duplicate.
Remplir en deux exemplaires la présente formule et le croquis annexé

Fill in on every page
Remplir ces cases à chaque page

Hole No. Forage n°	Page No. Page n°
WG-4	1

Under section 8 of the Mining Act, this information is used to maintain a public record. Aux termes de l'article 8 de la Loi, ces renseignements serviront à tenir à jour les dossiers publics.

Drilling Company Compagnie de forage Agile Drilling	Core Size Dimensions de la carotte	Collar Elevation Elevation du collier	Bearing of hole from true North Position du forage par rapport au nord vrai	Total Footage Avancement total du forage 45.72	Dip of Hole et Inclinaison du forage au Collar/collier 90	Address/Location where core stored Adresse/l'endroit où la carotte est stockée <i>William Brown RR # 2 Havelock Ontario, K0L 1Z0</i>	Map Reference No. N° de référence sur la carte	Claim No. N° de concession minière 124030
Date Hole Started Date de commencement du forage Aug 8/03	Date Completion Date d'achèvement Aug 9/03	Date Logged Date d'inscription au journal Aug 9/03	Logged by (print) Inscrit par (écrite en lettres moules) Don Phipps	F1/P1	F1/P1	Location (Twp, Lot, Con. or Lat. and Long.) Emplacement (canton, lot, concession, ou latitude et longitude) Methuen Twp, Conc 11, Lot 7 UTM (Nad 27) 0262164E 4941346 N	Property Name Nom de la propriété West Gabbro	
Exploration Co., Owner or Options Compagnie d'exploration, propriétaire ou titulaire d'option Trigan Resources			Logged by (Signature) Inscrit par (signature) <i>Donald Phipps</i>	F1/P1	F1/P1			
				F1/P1	F1/P1			
				F1/P1	F1/P1			

Footage/Avancement		Rock type Type de roche	Description (Colour, grain size, texture, minerals, alteration, etc.) Description (Couleur, granulométrie, texture, minéraux, transformation, etc.)	True Dip Angle - mesuré des stratifications vraies	True Dip Angle - mesuré des stratifications vraies	True Dip Angle - mesuré des stratifications vraies	Remarks Remarques	Remarks Remarques	Remarks Remarques
From/De	To/À								
00.00	00.86	Casing							
00.86	1.12	Granite	Typical m.g. pink granite of the area						
1.12	3.88	Gabbro	Variably textured gabbro - m.g. to finer grained						
3.88	4.67	Granite	Hybnd, finer grained portions at contacts with gabbro						
4.67	7.18	Gabbro	Typical gabbro with 10 cm finer grained metased. inclusion						
7.18	7.94	Metasediment	Inclusion of hornfelsed banded siliceous metasediment						
7.94	8.57	Gabbro	Typical m.g gabbro						
8.57	19.18	Metasediment	A tough hornfelsed metasediment inclusion. Fine grained, minor local banding, weakly magnetic. Composition 50% mafics (biot? and amphibole?)		15.20				Thin Section
19.18	21.33	Granite	Typical m.g. pink granite. Contacts at 70 degrees.						
21.33	32.47	Metasediment	Lt. grey to light green hornfelsed metasediment. A tough competent rock with local banding or gneissosity. Cut by four granite dikelets 2-5 cm wide. Minor m.g gabbroic patches.						
32.47	37.53	Gabbro	Typical m.g. massive uniform gabbro with 40 - 50% mafics. Upper contact at 70 degrees conformable with banding in metasediment. Lower contact at 30 degrees.						
37.53	45.72	Metasediment	Same metasediment as previously		40.04				Thin Section
	45.72	EOH							

0204 (P1)(R1)
*For features such as foliation, bedding, schistosity, measured from the long axis of the core
*Exemples de caractéristiques : foliation, schistosité, stratification L angle est mesuré par rapport à l'axe longitudinal de la carotte



Ministry of
Northern Development
and Mines

Ministère du
Développement du Nord
et des Mines

**Diamond
Drilling
Log**

**Journal de
forage au
diamant**

Complete this form and
related sketch in duplicate.
Remplir en deux exemplaires la
présente formule et le croquis annexé

Fill in on every page
Remplir ces cases
à chaque page

Hole No. Forage n°	Page No Page n°
WG-5	1

Under section 8 of the Mining Act, this information is used to maintain a public record. Aux termes de l'article 8 de la Loi, ces renseignements serviront à tenir à jour les dossiers publics.

Drilling Company Compagnie de forage Agile Drilling	Core Size Dimensions de la carotte BQ Thin wall	Collar Elevation Elevation du collier	Bearing of hole from true North/Position du forage par rapport au nord vrai	Total Footage Avancement total du forage 45.72 m	Dip of Hole at Inclinaison du forage au Collar/collier 90	Address/Location where core stored Adresse/endroit où la carotte est stockée William Brown RR #2 Havelock Ontario, K0L 1Z0	Map Reference No. N° de référence sur la carte	Claim No. N° de concession minière 1240130
Date Hole Started Date de commencement du forage Aug 9/03	Date Completed Date d'achèvement Aug 19/03	Date Logged Date d'inscription au journal Aug 20/03	Logged by (print) Inscrit par (écrire en lettres moulées) Don Phipps		F (I/P)		Location (Twp, Lot, Con. or Lat and Long.) Emplacement (canton, lot, concession, ou latitude et longitude) Methuen Twp. Conc.X, Lot 7 UTM (Nad 27): 0262622E, 4941366N	
Exploration Co., Owner or Optionee Compagnie d'exploration, propriétaire ou titulaire d'option Trigan Resources Inc			Logged by (Signature) Inscrit par (signature) <i>Donald Phipps</i>		F (I/P)		Property Name Nom de la propriété West Gabbro	

Footage/Avancement		Rock type	Description (Colour, grain size, texture, minerals, alteration, etc.)	Notes	Notes	Notes	Notes	Notes	Notes	Notes
From/De	To/A	Type de roche	Description (Couleur, granulométrie, texture, minéraux, transformation, etc.)							
00.00	1.04	Casing								
1.04	32.00	Gabbro	Mainly m.g. mafic gabbro (50%-60% mafics) with many small finer grained patches thought to be adsorbed metasedimentary inclusions. These inclusions are usually 5 to 10 cm in core length with a few up to almost a meter. A total of about 25% of this section is represented by this finer grained metasedimentary material							
32.00	36.31	Metasediment	A very heterogeneous rock with garnet, mafic mineral (hornblende?) and magnetite rich portions interspersed with gabbroic patches and f.g. metasediment patches. Intruded by 37 cm of granite dyke with contacts at 45 degrees. This unit resembles a skarn rock and is probably an adsorbed sedimentary inclusion.							
36.31	40.29	Gabbro	Gabbro same as to 32.00 m above. A mixture of m.g. and finer grained gabbro.							
40.29	45.72	Gabbro	Massive m.g. gabbro with 5% -10% granite dyklets 2 to 23 cm wide and mostly with high contact angles.							
	45.72	EOH								

*For features such as foliation, bedding, schistosity, measured from the long axis of the core.
*Exemples de caractéristiques: foliation, schistosité, stratification. L'angle est mesuré par rapport à l'axe longitudinal de la carotte.



Ministry of Northern Development and Mines / Ministère du Développement du Nord et des Mines

Diamond Drilling Log / **Journal de forage au diamant**

Complete this form and related sketch in duplicate. Remplir en deux exemplaires la présente formule et le croquis annexe

Fill in on every page Remplir ces cases à chaque page

Hole No. Forage n°: **WG-6**
Page No. Page n°: **1**

Under section 8 of the Mining Act, this information is used to maintain a public record. Aux termes de l'article 8 de la Loi, ces renseignements serviront à tenir à jour les dossiers publics

Drilling Company Compagnie de forage Agile Drilling Inc	Core Size Dimensions de la carotte BQ Thinwall	Collar Elevation Elevation du collier	Drilling of hole from true North/Position du forage par rapport au nord vrai	Total Footage Avancement total du forage 38.10 m	Dip of Hole at Collar/Collier Inclinaison du forage au Collier/collier 90	Address/Location where core stored Adresse/endroit où la carotte est stockée William Brown RR # 2 Havelock Ontario K0L 1Z0	Map Reference No. N° de référence sur la carte	Claim No. N° de concession minière 1240130
Date Hole Started Date de commencement du forage Aug 19/03	Date Completed Date d'achèvement Aug 20/03	Date Logged Date d'inscription au journal Aug 21/03	Logged by (print) Inscrit par (écrire en lettres mouées) Don Phipps	Logged by (Signature) Inscrit par (signature) <i>Donna Phipps</i>	F1/P1 F1/P2 F1/P3 F1/P4	Location (Twp., Loc., Con. or Lat. and Long.) Emplacement (canton, lot, concession, ou latitude et longitude) Methuen Twp., Conc X, Lot 6 UTM (Nad 27): 026541E, 4941129W	Property Name Nom de la propriété West Gabbro	

Footage/Avancement		Rock type	Description (Colour, grain size, texture, minerals, alteration, etc.)	Notes	Assays/Analyses
From/De	To/À	Type de roche	Description (Couleur, granulométrie, texture, minéraux, transformation, etc.)		
00.00	1.20	Casing			
1.20	2.46	Gabbro	M.g gabbro with 40 - 50% mafics		
2.46	5.30	Metasediment	Tough, light grey, f.g., siliceous metasediment with minor mafic mineral and mafic rich patches.		
5.30	6.33	Granite	Pink granite dyke with contacts at c. 45 degrees.		
6.33	7.82	Metasediment	40 cm of light grey siliceous metasediment followed by grey-green softer and more mafic metased.		
7.82	16.61	Metasediment	Hornfelsed, very tough, light grey to pinkish grey siliceous metasediment with local more mafic patches. Cut by granite dykes 30 and 74 cm wide with contact angles varying from 20 degrees to almost parallel to CA		
16.61	24.48	Metasediment	Generally a more mafic variety of metasediment with local more igneous looking texture. Cut by minor granite dykes up to 10 cm wide.		
24.48	25.47	Granodiorite/gabbro	Weakly porphyroblastic m.g. granodiorite with c. 30% mafics		
25.47	38.10	Metasediment	Mainly light grey, f.g., tough, hornfelsed siliceous metasediment with 20% more mafic, grey-green sections. Cut by 20% pink granite dykes up to 50 cm wide.		
	38.10	EOH			

*For features such as foliation, bedding, schistosity, measured from the long axis of the core. Exemples de caractéristiques: foliation, schistosité, stratification. L'angle est mesuré par rapport à l'axe longitudinal de la carotte



Ministry of
Northern Development
and Mines

Ministère du
Développement du Nord
et des Mines

**Diamond
Drilling
Log**

**Journal de
forage au
diamant**

Complete this form and
related sketch in duplicate.
Remplir en deux exemplaires la
présente formule et le croquis annexe

Fill in on every page
Remplir ces cases
à chaque page

Hole No. Forage n°	Page No. Page n°
WG-7	1

Under section 8 of the Mining Act, this information is used to maintain a public record. Aux termes de l'article 8 de la Loi, ces renseignements serviront à tenir à jour les dossiers publics.

Drilling Company Compagnie de forage Agile Drilling Inc	Core Size Dimensions de la carotte BQ thinwall	Collar Elevation Elevation du collier	Logging of hole from true North Position du forage par rapport au nord vrai	Total Footage Avancement total du forage 33.92	Dip of Hole at Inclinaison du forage au Collar/collier 90	Address/Location where core stored Adresse/endroit où la carotte est stockée William Brown RR# 2 Havelock Ontario K0L 1Z0	Map Reference No. N° de référence sur la carte	Claim No. N° de concession minière 1240130
Date Hole Started Date de commencement du forage Aug 20/03	Date Completed Date d'achèvement Aug 21/03	Date Logged Date d'inscription au journal Aug 22/03	Logged by (print) Inscrit par (écrire en lettres moulées) Don Phipps		F1/P1		Location (Twp, Lot, Con. or Lat. and Long.) Emplacement (canton, lot, concession ou latitude et longitude) Methuen Twp. Conc. X, Lot 6 UTM (Nad 27): 0262789E, 4940982N	
Exploration Co., Owner or Optionee Compagnie d'exploration, propriétaire ou titulaire d'option Trigan Resources Inc			Logged by (Signature) Inscrit par (signature) <i>Donald Phipps</i>		F1/P1		Property Name Nom de la propriété West Gabbro	

Footage/Avancement		Rock type	Description (Colour, grain size, texture, minerals, alteration, etc.)	Number of Samples Number de échantillons	Number of Analyses Number de analyses
From/De	To/A	Type de roche	Description (Couleur, granulométrie, texture, minéraux, transformation, etc.)	From/De	To/A
00.00	0.82	Casing			
0.82	12.60	Gabbro	Variable rock of gabbroic composition and a semi-igneous texture; small feldspar porphyroblasts occur in a f.g. granular matrix. This appears to be a rock transitional between a hornfelsed metasediment and a gabbro. Locally there is weak banding or gneissosity. Weakly magnetic throughout. Minor small granite dykes.		
12.60	13.24	Granite	Typical pink granite with areas which are almost pegmatitic in grain size. Contacts at 20 degrees.		
13.24	22.18	Gabbro	Same gabbro as to 12.60 m above but slightly more mafic.		
22.18	22.64	Granite	Granite dyke with patch of black tourmaline. Contacts at 70 degrees to CA		
22.64	25.52	Gabbro	Same gabbro as above.		
25.52	26.62	Breccia	A zone of reheated, very hard and very tough silicified breccia. Could be an inclusion in the gabbro.		
26.62	31.02	Gabbro	Same gabbro as above.		
31.02	31.45	Granite			
31.45	33.92	Gabbro	Same as above.		
	33.92	EOH			

*For features such as foliation, bedding, schistosity, measured from the long axis of the core
*Exemples de caractéristiques: foliation, schistosité, stratification L'angle est mesuré par rapport à l'axe longitudinal de la carotte



Ministry of Northern Development and Mines
Ministère du Développement du Nord et des Mines

Diamond Drilling Log
Journal de forage au diamant

Complete this form and related sketch in duplicate.
Remplir en deux exemplaires la présente formule et le croquis annexé

Fill in on every page
Remplir ces cases à chaque page

Hole No. Forage n°	Page No. Page n°
WG-8	1

Under section 8 of the Mining Act, this information is used to maintain a public record. Aux termes de l'article 8 de la Loi, ces renseignements serviront à tenir à jour les dossiers publics.

Drilling Company Compagnie de forage Agile Drilling Inc	Core Size Dimensions de la carotte BQ thinwall	Collar Elevation Elevation du collier	Blurring of hole from true North/Position du forage par rapport au nord vrai	Total Footage Avancement total du forage 31.86 m	Dip of Hole at Inclinaison du forage au Collar/collier 90	Address/Location where core stored Adresse/endroit où la carotte est stockée <i>William Brown RR # 2 Havelock Ontario K0L 1Z0</i>	Map Reference No. N° de référence sur la carte	Claim No. N° de concession minière 1240155
Date Hole Started Date de commencement du forage Aug 21/03	Date Completed Date d'achèvement Aug 22/03	Date Logged Date d'inscription au journal Aug 23/03	Logged by (print) Inscrit par (écrite en lettres moulées) Don Phipps	F1/P1	F1/P1	Location (Twp., Lot, Con. or Lat. and Long.) Emplacement (canton, lot, concession, ou latitude et longitude) Methuen Twp., Conc. X, Lot 5 UTM (Nad 27): 0262910E, 4940836N	Property Name Nom de la propriété West Gabbro	
Exploration Co., Owner or Optionee Compagnie d'exploration, propriétaire ou titulaire d'option Trigan Resources Inc.			Logged by (Signature) Inscrit par (signature) <i>Donald Phipps</i>	F1/P1	F1/P1			
				F1/P1	F1/P1			
				F1/P1	F1/P1			

Footage/Avancement		Rock type	Description (Colour, grain size, texture, minerals, alteration, etc.)	Notes	Notes	Notes	Notes	Notes	Notes	Notes
From/De	To/A	Type de roche	Description (Couleur, granulométrie, texture, minéraux, transformation, etc.)	Notes	Notes	Notes	Notes	Notes	Notes	Notes
00.00	1.06	Casing								
1.06	12.97	Granodiorite/gabbro	A heterogeneous rock consisting of pinkish, weakly porphyroblastic granodiorite (similar to the granite but with a higher mafic content) mixed with more gabbroic sections, some m.g. and some finer grained.							
12.97	14.96	Granodiorite	Pink m.g. weakly porphyroblastic granodiorite.							
14.96	21.00	Gabbro	Weakly igneous textured gabbroic melange (transitional between gabbro, granodiorite and metasediment?). Includes a 48 cm granite dyke with massive black tourmaline at one contact. Contacts at c. 90 degrees to CA.							
21.00	21.97	Granodiorite	Light grey, m.g. granodiorite							
21.97	22.53	Gabbro	Same as to 21.00 m above							
22.53	25.30	Granite/Qtz vein	Pink granite dyke with quartz-rich portions. Scattered patches of black tourmaline.							
25.30	27.20	Granodiorite	40 cm section of finer grained, more mafic granodiorite, 2 cm quartz vein and then into porphyroblastic granodiorite with 35% mafic minerals.							
27.20	31.86	Metasediment	Weakly banded, grey, granular metasediment. Non-magnetic.							
	31.86	EOH								

*For features such as foliation, bedding, schistosity, measured from the long axis of the core.
*Exemples de caractéristiques: foliation, schistosité, stratification. L'angle est mesuré par rapport à l'axe longitudinal de la carotte.



Ministry of Northern Development and Mines / Ministère du Développement du Nord et des Mines

Diamond Drilling Log / **Journal de forage au diamant**

Complete this form and related sketch in duplicate. Remplir en deux exemplaires la présente formule et le croquis annexé

Fill in on every page / Remplir ces cases à chaque page

Hole No. / Forage n°	Page No. / Page n°
WG-9	1

Under section 8 of the Mining Act, this information is used to maintain a public record. Aux termes de l'article 8 de la Loi, ces renseignements serviront à tenir à jour les dossiers publics.

Drilling Company Compagnie de forage Agile Drilling Inc.	Core Size Dimensions de la carotte BQ Thinwall	Collar Elevation Elevation du collier	Isolating of hole from true North Position du forage par rapport au nord vrai	Total Footage Avancement total du forage 41.21 m	Dip of Hole at Inclinaison du forage au Collar/collier 90	Address/Location where core stored Adresse/endroit où la carotte est stockée William Brown RR# 2 Havelock Ontario. K0L 1Z0	Map Reference No. N° de référence sur la carte	Claim No. N° de concession minière 1240155
Date Hole Started Date de commencement du forage Aug 22/03	Date Completed Date d'achèvement Aug 23/03	Date Logged Date d'inscription au journal Aug 24/03	Logged by (print) Inscrit par (écrire en lettres moulées) Don Phipps		F1/P1		Location (Twp, Lot, Con. or Lat. and Long.) Emplacement (canton, lot, concession, ou latitude et longitude) Methuen Twp. Conc X., Lot 6 UTM (Nad 27): 0262804E, 4940711N	Property Name Nom de la propriété West Gabbro
Exploration Co., Owner or Optionee Compagnie d'exploration, propriétaire ou titulaire d'option Trigan Resources Inc.			Logged by (Signature) Inscrit par (signature) <i>Donal Phipps</i>		F1/P1			
					F1/P1			
					F1/P1			

Footage/Avancement		Rock type	Description (Colour, grain size, texture, minerals, alteration, etc.)	From/De	To/A	Assays/Analyses minéralurgiques
From/De	To/A	Type de roche	Description (Couleur, granulométrie, texture, minéraux, transformation, etc.)	From/De	To/A	
00.00	1.05	Casing				
1.05	41.21	Gabbro	Typical uniform gabbro with c. 50% mafic minerals. Minor finer grained patches. Minor c.g granite dykes 5.50 to 5.80 m (Contact angle 30 degrees), 14.38 to 14.62 m (contact angle 70 degrees), 31.17 to 31.60 (contacts at 25 degrees), and 36.78 to 37.14 (contacts at 70 degrees). Includes minor f.g., grey, granular metasediment inclusions.			
	41.21	EOH				

*For features such as foliation, bedding, schistosity, measured from the long axis of the core.
*Exemples de caractéristiques : foliation, schistosité, stratification. L'angle est mesuré par rapport à l'axe longitudinal de la carotte.



Ministry of Northern Development and Mines

Ministère du Développement du Nord et des Mines

Diamond Drilling Log / **Journal de forage au diamant**

Complete this form and related sketch in duplicate. REMPLIR EN DEUX EXEMPLAIRES LA PRÉSENTE FORMULE ET LE CROQUIS ANNEXÉ

Fill in on every page. REMPLIR CES CASES À CHAQUE PAGE

Hole No. Forage n°	Page No. Page n°
WG-10	1

Under section 8 of the Mining Act, this information is used to maintain a public record. Aux termes de l'article 8 de la Loi, ces renseignements serviront à tenir à jour les dossiers publics.

Drilling Company Compagnie de forage Agile Drilling Inc.	Core Size Dimensions de la carotte BQ Thinwall	Collar Elevation Élévation du collier	Bearing of hole from true North/Position du forage par rapport au nord vrai	Total Footage Avancement total du forage 36.58 m	Dip of Hole at Inclinaison du forage au Collar/collier: 90	Address/Location where core stored Adresse/endroit où la carotte est stockée William Brown RR # 2 Havelock Ontario. K0L 1Z0	Map Reference No. N° de référence sur la carte	Claim No. N° de concession minière 1240130
Date Hole Started Date de commencement du forage Aug 23/03	Date Completed Date d'achèvement Aug 24/03	Date Logged Date d'inscription au journal Aug 24/03	Logged by (print) Inscrit par (écrire en lettres moulées) Don Phipps	F1/P1	F1/P1	F1/P1	F1/P1	Location (Twp, Lot, Con. or Lat. and Long.) Emplacement (canton, lot, concession, ou latitude et longitude) Methuen Twp., Conc. X, Lot 6 UTM (Nad 27): 0262526E, 4940873N
Exploration Co., Owner or Optionee Compagnie d'exploration, propriétaire ou titulaire d'option Trigan Resources Inc.	Logged by (Signature) Inscrit par (signature) <i>Donna Phipps</i>		Property Name Nom de la propriété West Gabbro					

Footage/Avancement		Rock type	Description (Colour, grain size, texture, minerals, alteration, etc.)	Placer Footage Forage à l'échelle de mètres	Core Recovery Forage à l'échelle en pourcentage des mètres	Yield Sample No. N° d'échantillon du prospecteur	Sample Length Longueur de l'échantillon	Assays/Analyses minéralogiques
From/De	To/A	Type de roche	Description (Couleur, granulométrie, texture, minéraux, transformation, etc.)				From/De	To/A
00.00	0.98	Casing						
0.98	36.58	Gabbro	The typical m.g gabbro with minor finer grained patches. Many small granite dykes cut the gabbro as follows: 2.90 - 3.13 m. contacts at 45 degrees					
			4.39 - 4.90 " " 30 "					
			8.10 - 8.30 " " 45 "					
			8.62 - 8.83 " " 30 "					
			10.20 - 10.70 " " 80 "					
			15.79 - 16.04 " " 70 "					
			18.69 - 18.81 " " 60 "					
			26.28 - 26.58 " " 50 "					
			7% of the core is granite dyke material					
36.58		EOH						

*For features such as foliation, bedding, schistosity, measured from the long axis of the core.
*Exemples de caractéristiques : foliation, schistosité, stratification. L'angle est mesuré par rapport à l'axe longitudinal de la carotte.

Date: 2003-SEP-16

GEOSCIENCE ASSESSMENT OFFICE
933 RAMSEY LAKE ROAD, 6th FLOOR
SUDBURY, ONTARIO
P3E 6B5

TRIGAN RESOURCES INC.
ATTEN :J.B. REGAN
445 BEACON HILL DRIVE
AURORA, ONTARIO
L4G 3G8 CANADA

Tel: (888) 415-9845
Fax:(877) 670-1555

Submission Number: 2.26262
Transaction Number(s): W0390.01426

Dear Sir or Madam

Subject: Approval of Assessment Work

We have approved your Assessment Work Submission with the above noted Transaction Number(s). The attached Work Report Summary indicates the results of the approval.

At the discretion of the Ministry, the assessment work performed on the mining lands noted in this work report may be subject to inspection and/or investigation at any time.

If you have any question regarding this correspondence, please contact BRUCE GATES by email at bruce.gates@ndm.gov.on.ca or by phone at (705) 670-5856.

Yours Sincerely,



Ron Gashinski
Senior Manager, Mining Lands Section

Cc: Resident Geologist

Trigan Resources Inc.
(Claim Holder)

Donald Phipps
(Agent)

Assessment File Library

Trigan Resources Inc.
(Assessment Office)

Date / Time of Issue: Tue Sep 16 15:10:24 EDT 2003

TOWNSHIP / AREA
METHUEN (SOUTH)

PLAN
G-3053

ADMINISTRATIVE DISTRICTS / DIVISIONS

Mining Division
Land Titles/Registry Division
Ministry of Natural Resources District

Southern Ontario
PETERBOROUGH
BANCROFT

TOPOGRAPHIC

- Administrative Boundary
- Township
- Community Loc.
- Precinct Pk.
- Major Roadway
- C.R., P.O. & Pk.
- Contour
- New Banks
- Mine Footprints
- Railway
- Road
- Trail
- Natural Gas Pipeline
- Utilities
- Trees

Land Tenure

- Proposed Permit
- Surface Use Mining Rights
- Surface Rights Only
- Mining Rights Only
- Leasehold Patent
- Surface Use Mining Rights
- Surface Rights Only
- Mining Rights Only
- Lateral Concession
- User Not Specified
- Surface Use Mining Rights
- Surface Rights Only
- Mining Rights Only
- Land Use Permit
- Order to Cease Work (not open for leasing)
- Water Power License Agreement
- Mining Plan
- Filed Copy Mining Claims

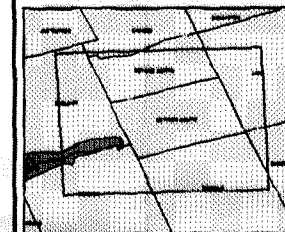

LAND TENURE WITHDRAWALS

- Mining Land Withdrawal Description
- Mining and Other Land Withdrawals
- Mining Rights Withdrawals
- Surface Use Mining Rights Withdrawals
- Mining Rights Withdrawals

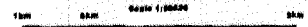

LAND TENURE WITHDRAWAL DESCRIPTIONS

Identifier	Type	Date	Description
0770	Ver	Jan 1, 2001	FLOODED LANDS
0771	Ver	Jan 1, 2001	FLOODED LANDS
0772	Ver	Jan 1, 2001	FLOODED LANDS
0773	Ver	Jan 1, 2001	FLOODED LANDS
0774	Ver	Jan 1, 2001	FLOODED LANDS
0775	Ver	Jan 1, 2001	FLOODED LANDS
0776	Ver	Jan 1, 2001	FLOODED LANDS
0777	Ver	Jan 1, 2001	FLOODED LANDS
0778	Ver	Jan 1, 2001	FLOODED LANDS
0779	Ver	Jan 1, 2001	FLOODED LANDS
0780	Ver	Jan 1, 2001	FLOODED LANDS
0781	Ver	Jan 1, 2001	FLOODED LANDS
0782	Ver	Jan 1, 2001	FLOODED LANDS
0783	Ver	Jan 1, 2001	FLOODED LANDS
0784	Ver	Jan 1, 2001	FLOODED LANDS
0785	Ver	Jan 1, 2001	FLOODED LANDS
0786	Ver	Jan 1, 2001	FLOODED LANDS
0787	Ver	Jan 1, 2001	FLOODED LANDS
0788	Ver	Jan 1, 2001	FLOODED LANDS
0789	Ver	Jan 1, 2001	FLOODED LANDS
0790	Ver	Jan 1, 2001	FLOODED LANDS
0791	Ver	Jan 1, 2001	FLOODED LANDS
0792	Ver	Jan 1, 2001	FLOODED LANDS
0793	Ver	Jan 1, 2001	FLOODED LANDS
0794	Ver	Jan 1, 2001	FLOODED LANDS
0795	Ver	Jan 1, 2001	FLOODED LANDS
0796	Ver	Jan 1, 2001	FLOODED LANDS
0797	Ver	Jan 1, 2001	FLOODED LANDS
0798	Ver	Jan 1, 2001	FLOODED LANDS
0799	Ver	Jan 1, 2001	FLOODED LANDS
0800	Ver	Jan 1, 2001	FLOODED LANDS
0801	Ver	Jan 1, 2001	FLOODED LANDS
0802	Ver	Jan 1, 2001	FLOODED LANDS
0803	Ver	Jan 1, 2001	FLOODED LANDS
0804	Ver	Jan 1, 2001	FLOODED LANDS
0805	Ver	Jan 1, 2001	FLOODED LANDS
0806	Ver	Jan 1, 2001	FLOODED LANDS
0807	Ver	Jan 1, 2001	FLOODED LANDS
0808	Ver	Jan 1, 2001	FLOODED LANDS
0809	Ver	Jan 1, 2001	FLOODED LANDS
0810	Ver	Jan 1, 2001	FLOODED LANDS
0811	Ver	Jan 1, 2001	FLOODED LANDS
0812	Ver	Jan 1, 2001	FLOODED LANDS
0813	Ver	Jan 1, 2001	FLOODED LANDS
0814	Ver	Jan 1, 2001	FLOODED LANDS
0815	Ver	Jan 1, 2001	FLOODED LANDS
0816	Ver	Jan 1, 2001	FLOODED LANDS
0817	Ver	Jan 1, 2001	FLOODED LANDS
0818	Ver	Jan 1, 2001	FLOODED LANDS
0819	Ver	Jan 1, 2001	FLOODED LANDS
0820	Ver	Jan 1, 2001	FLOODED LANDS
0821	Ver	Jan 1, 2001	FLOODED LANDS
0822	Ver	Jan 1, 2001	FLOODED LANDS
0823	Ver	Jan 1, 2001	FLOODED LANDS
0824	Ver	Jan 1, 2001	FLOODED LANDS
0825	Ver	Jan 1, 2001	FLOODED LANDS
0826	Ver	Jan 1, 2001	FLOODED LANDS
0827	Ver	Jan 1, 2001	FLOODED LANDS
0828	Ver	Jan 1, 2001	FLOODED LANDS
0829	Ver	Jan 1, 2001	FLOODED LANDS
0830	Ver	Jan 1, 2001	FLOODED LANDS
0831	Ver	Jan 1, 2001	FLOODED LANDS
0832	Ver	Jan 1, 2001	FLOODED LANDS
0833	Ver	Jan 1, 2001	FLOODED LANDS
0834	Ver	Jan 1, 2001	FLOODED LANDS
0835	Ver	Jan 1, 2001	FLOODED LANDS
0836	Ver	Jan 1, 2001	FLOODED LANDS
0837	Ver	Jan 1, 2001	FLOODED LANDS
0838	Ver	Jan 1, 2001	FLOODED LANDS
0839	Ver	Jan 1, 2001	FLOODED LANDS
0840	Ver	Jan 1, 2001	FLOODED LANDS
0841	Ver	Jan 1, 2001	FLOODED LANDS
0842	Ver	Jan 1, 2001	FLOODED LANDS
0843	Ver	Jan 1, 2001	FLOODED LANDS
0844	Ver	Jan 1, 2001	FLOODED LANDS
0845	Ver	Jan 1, 2001	FLOODED LANDS
0846	Ver	Jan 1, 2001	FLOODED LANDS
0847	Ver	Jan 1, 2001	FLOODED LANDS
0848	Ver	Jan 1, 2001	FLOODED LANDS
0849	Ver	Jan 1, 2001	FLOODED LANDS
0850	Ver	Jan 1, 2001	FLOODED LANDS
0851	Ver	Jan 1, 2001	FLOODED LANDS
0852	Ver	Jan 1, 2001	FLOODED LANDS
0853	Ver	Jan 1, 2001	FLOODED LANDS
0854	Ver	Jan 1, 2001	FLOODED LANDS
0855	Ver	Jan 1, 2001	FLOODED LANDS
0856	Ver	Jan 1, 2001	FLOODED LANDS
0857	Ver	Jan 1, 2001	FLOODED LANDS
0858	Ver	Jan 1, 2001	FLOODED LANDS
0859	Ver	Jan 1, 2001	FLOODED LANDS
0860	Ver	Jan 1, 2001	FLOODED LANDS
0861	Ver	Jan 1, 2001	FLOODED LANDS
0862	Ver	Jan 1, 2001	FLOODED LANDS
0863	Ver	Jan 1, 2001	FLOODED LANDS
0864	Ver	Jan 1, 2001	FLOODED LANDS
0865	Ver	Jan 1, 2001	FLOODED LANDS
0866	Ver	Jan 1, 2001	FLOODED LANDS
0867	Ver	Jan 1, 2001	FLOODED LANDS
0868	Ver	Jan 1, 2001	FLOODED LANDS
0869	Ver	Jan 1, 2001	FLOODED LANDS
0870	Ver	Jan 1, 2001	FLOODED LANDS
0871	Ver	Jan 1, 2001	FLOODED LANDS
0872	Ver	Jan 1, 2001	FLOODED LANDS
0873	Ver	Jan 1, 2001	FLOODED LANDS
0874	Ver	Jan 1, 2001	FLOODED LANDS
0875	Ver	Jan 1, 2001	FLOODED LANDS
0876	Ver	Jan 1, 2001	FLOODED LANDS
0877	Ver	Jan 1, 2001	FLOODED LANDS
0878	Ver	Jan 1, 2001	FLOODED LANDS
0879	Ver	Jan 1, 2001	FLOODED LANDS
0880	Ver	Jan 1, 2001	FLOODED LANDS
0881	Ver	Jan 1, 2001	FLOODED LANDS
0882	Ver	Jan 1, 2001	FLOODED LANDS
0883	Ver	Jan 1, 2001	FLOODED LANDS
0884	Ver	Jan 1, 2001	FLOODED LANDS
0885	Ver	Jan 1, 2001	FLOODED LANDS
0886	Ver	Jan 1, 2001	FLOODED LANDS
0887	Ver	Jan 1, 2001	FLOODED LANDS
0888	Ver	Jan 1, 2001	FLOODED LANDS
0889	Ver	Jan 1, 2001	FLOODED LANDS
0890	Ver	Jan 1, 2001	FLOODED LANDS
0891	Ver	Jan 1, 2001	FLOODED LANDS
0892	Ver	Jan 1, 2001	FLOODED LANDS
0893	Ver	Jan 1, 2001	FLOODED LANDS
0894	Ver	Jan 1, 2001	FLOODED LANDS
0895	Ver	Jan 1, 2001	FLOODED LANDS
0896	Ver	Jan 1, 2001	FLOODED LANDS
0897	Ver	Jan 1, 2001	FLOODED LANDS
0898	Ver	Jan 1, 2001	FLOODED LANDS
0899	Ver	Jan 1, 2001	FLOODED LANDS
0900	Ver	Jan 1, 2001	FLOODED LANDS

IMPORTANT NOTICES

Users should consult the Mining Land Tenure Map and the Mining Land Tenure Withdrawal Descriptions for a complete description of the mining rights and other interests in the land. The Mining Land Tenure Map is a summary map and does not show all details of the mining rights and other interests in the land. The Mining Land Tenure Withdrawal Descriptions provide a detailed description of the mining rights and other interests in the land.

For more information, please contact the appropriate land registry office.

2.26262
PDRILL

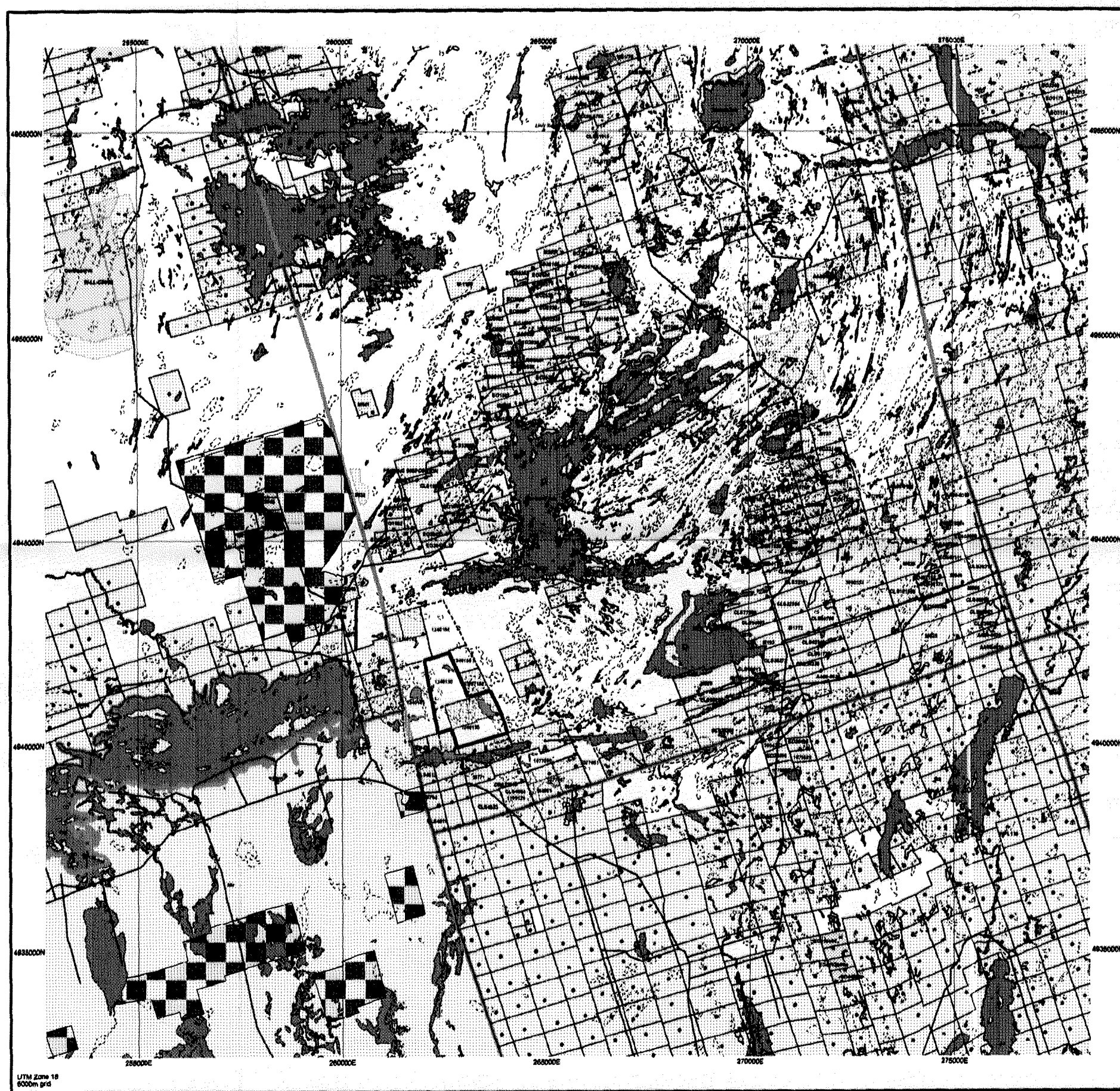

UTM Zone 18
6000m grid

General Information and Limitations

This map may not show unregistered land leases and interests in land including certain patents, leases, mortgages, rights of way, mining rights, or other forms of disposition of land as shown from the Crown. Also, certain land uses and uses that require a permit may not be shown.

For more information, please contact the appropriate land registry office.



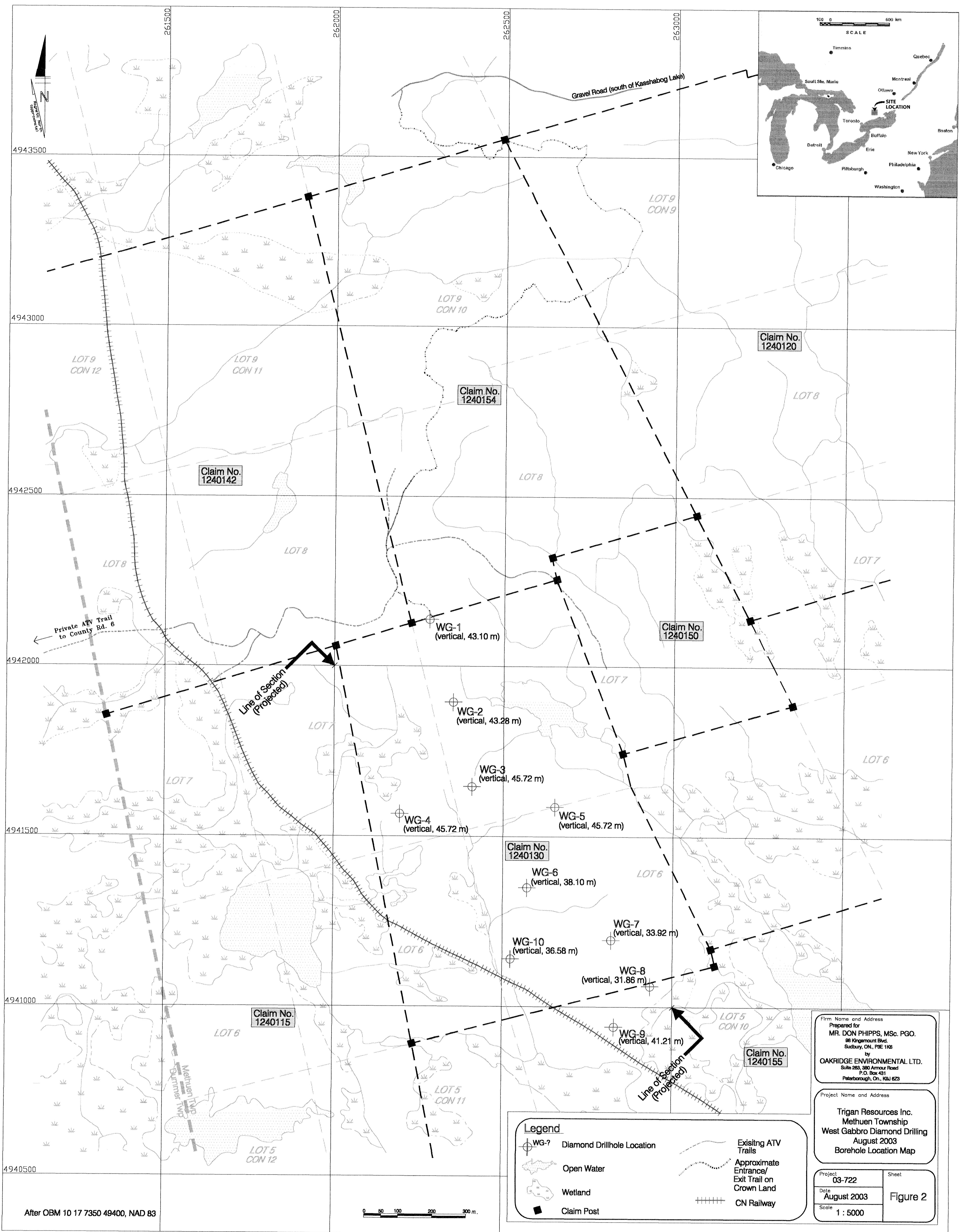

After OBM 10 17 7350 49400, NAD 83

0 50 100 200 300 m.

Firm Name and Address Prepared for MR. DON PHIPPS, MSc. PGO. 88 Kingmount Blvd. Sudbury, ON, P3E 1K6 by OAKRIDGE ENVIRONMENTAL LTD. Suite 203, 390 Armour Road P.O. Box 431 Peterborough, On., K9J 6Z3	
Project Name and Address Trigan Resources Inc. Methuen Township West Gabbro Diamond Drilling August 2003 Borehole Location Map	
Project 03-722	Sheet Figure 2
Date August 2003	Scale 1 : 5000

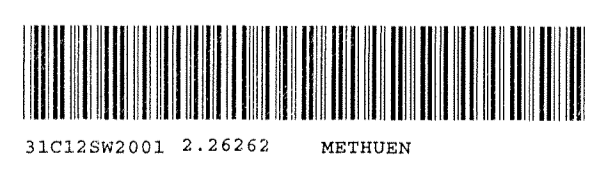





NW-SE Drill Section

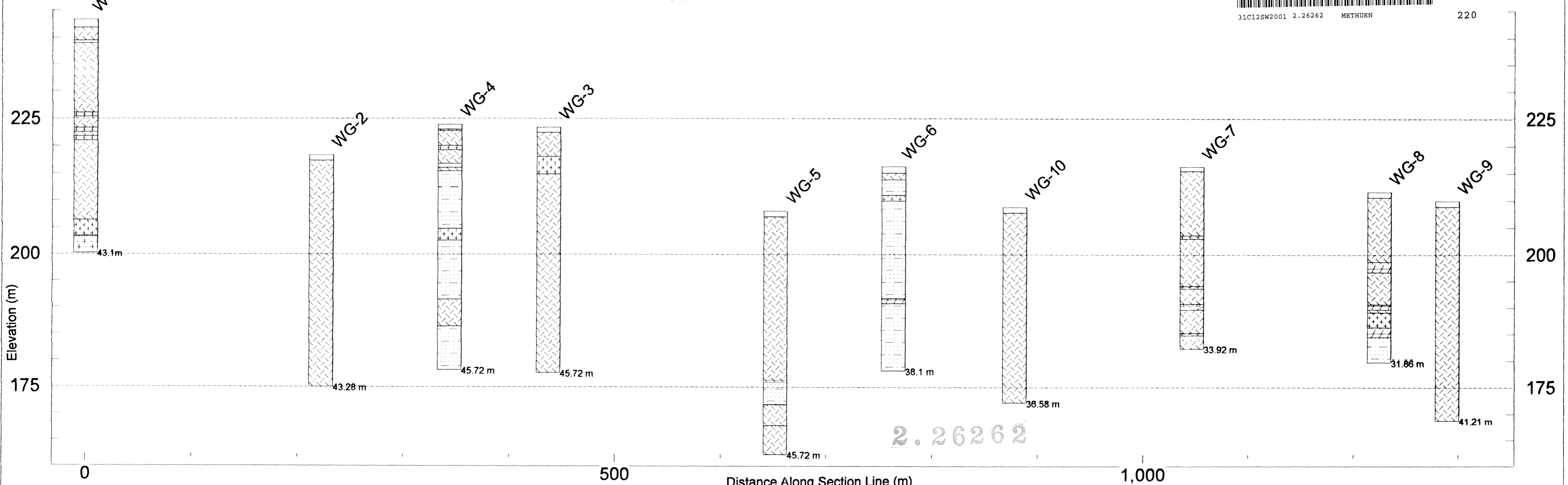

31C12SW2001 2.26262 METHUEN 220

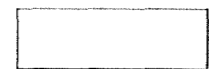

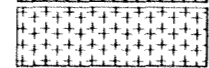
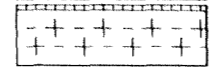
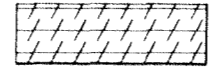
Trigan Resources Inc.
Methuen Twp., West Gabbro Project

-  Casing
-  Gabbro
-  Granite
-  Gabbro & Granite
-  Granodiorite
-  Metasediments
-  Silicified Breccia

Diamond Drilling Contractor: Agile Drilling Inc.
Logged By: Mr. Don Phipps, P. Geo.

Mining Claims: SO 1240130 & 1240155
Vertical Scale: 1:500 / Horizontal Scale 1:2,500
All Holes Drilled Vertical
Plotted By: Oakridge Environmental Ltd.

See Figure 2 for Line of Section

Figure 3