



31C14NE0004 18 CLARENDON

010

DIAMOND DRILLING

Township: Clarendon

Report No: 18

WORK PERFORMED FOR: St. Joe Canada

RECORDED HOLDER: SAME AS ABOVE []

: OTHER []

<u>CLAIM NO.</u>	<u>HOLE NO.</u>	<u>FOOTAGE</u>	<u>DATE</u>	<u>NOTE</u>
EO 673566	FL-85-9	597	Nov/85	(1)

NOTES: (1) #13-86

DIAMOND DRILL RECORD

NAME OF PROPERTY Fernleigh
 HOLE NO. FL-85-9 LENGTH 182.0m
 LOCATION Claim No. E0673566
 LATITUDE 27+05N DEPARTURE 27+48E
 ELEVATION _____ AZIMUTH 160° DIP 50°
 STARTED 21 November 1985 FINISHED 22 November 1985

Meters	DIP	AZIMUTH	Meters	DIP	AZIMUTH
61	50°				
100	50°				

HOLE NO. FL-85-9 SHEET NO. 1

REMARKS
 Drilled by: Midwest Drilling
 Core Size: BQ

LOGGED BY W. Johnson
[Signature]

METERAGE		DESCRIPTION	SAMPLE				ASSAYS					
FROM	TO		NO.	% SULPHIDES	Meterage			Cu ppm	Zn ppm	Ag ppm	Pb ppm	Au ppb
					FROM	TO	TOTAL					
0.0	2.70	<u>Casing/Overburden</u>										
2.70	19.20	<u>Quartz-muscovite-biotite-chloritoid(?) - staurolite-magnetite±kyanite ±garnet schist; quartz-muscovite biotite = 60-70%; chloritoid(?) or biotite = 10%; staurolite 10-15%; kyanite, magnetite=5%.</u> 5.55 - 5.65 : quartz-biotite vein 8.06 - 8.36 : pegmatitic quartz-staurolite-biotite 5.50 -14.00 : 5% kyanite - corroded crystals 14.50-14.60 : conformable quartz vein 17,60-19.20 : 5-10% garnet in dark brown/bluish rock with 1% py. 16.00 : foliation makes 67½° angle with core therefore dip 62.5°.										
19.20	23.80	<u>Dolomitic marble</u> ; white/cream, massive; same as elsewhere. 19.20-20.00 : 1% carbonate and/or tetrahydrate; 1% py. 20.00-20.88 : 1-2% sphalerite, 1% py. 20.88-23.80 : trace carbonate, pyrite, sphalerite. 23.60 : few grains sphalerite, galena.	12742		17.60	19.20	1.60	53	200	0.1	18	10
			12743	2	19.20	20.00	0.80	70	500	3.2	444	30
			12744	2	20.00	20.88	0.88	201	1275	4.7	194	35
			12745	Tr	20.88	22.30	1.42	25	270	1.3	87	<5
			12746	Tr	22.30	23.80	1.50	21	230	1.0	74	<5
23.80	26.00	<u>Calcitic and dolomitic marble</u> ; tan; including streaks of brown biotite and pale green tremolite; trace py. 25.00-25.25 : including 2 small bands py-sphalerite 25.40 : crystalline graphite. 25.40-26.00 : minor sphalerite.	12747		23.80	26.00	2.20	26	300	1.0	189	<5
26.00	31.60	<u>Dolomitic marble</u> ; tan/pink; trace pyrite	12748		26.00	28.00	2.00	21	155	0.5	53	<5
			12749		28.00	30.00	2.00	8	74	0.1	26	<5
			12750		30.00	31.60	1.60	18	73	0.4	36	5

DIAMOND DRILL RECORD

NAME OF PROPERTY Fernleigh

HOLE NO. FL-85-9 SHEET NO. 2

METERAGE		DESCRIPTION	SAMPLE				ASSAYS					
FROM	TO		NO.	SULPHIDES	Meters			Cu ppm	Zn ppm	Ag ppm	Pb ppm	Au ppb
					FROM	TO	TOTAL					
31.60	38.90	Dolomitic marble; gray with white layers and streaks, trace pyrite and carbonate.	12751		31.60	34.00	2.40	22	90	0.4	28	< 5
			12752		34.00	36.50	2.50	8	56	0.2	15	< 5
38.90	69.80	Metapelite; black, graphitic sulphide-rich; some metasiltstone layers; 20% calcite; minor calcite veining, some subparallel to core; foliation at 43m is 73° to core axis; 3-5% py as coarse streaks, very fine coatings on cleavage and very fine dissemination.	12753		36.50	38.90	2.40	11	135	0.2	33	< 5
			12754		38.90	40.90	2.00	41	155	0.2	22	5
			12755		40.90	42.90	2.00	32	125	0.2	24	< 5
		52.30-52.50 : calcite quartz veins with py seam.	12756		52.10	52.60	0.50	36	95	1.1	71	< 5
		69.10-69.30 : calcite, quartz veins with py seam.	12757		69.00	69.80	0.80	47	105	0.4	22	< 5
69.80	84.70	Metapelite; dark brown, black; 15-20% small white specks of quartz or ?; rock is largely fine grained biotite, quartz, muscovite.										
		80.10-81.20 : including 2 veins to 5% pyrite in quartz replacement vein.	12758		80.10	81.20	1.10	48	105	0.2	17	< 5
		83.85-83.92 : white quartz vein with 2% py.	12759		83.85	84.70	0.85	46	185	0.3	21	< 5
84.70	115.00	Calcitic marble; medium gray, medium grained, massive muscovite with occasional banded intervals, minor quartz or calcite veining, occasional pelitic layers; minor py (<1%) throughout; minor quartz, calcite veins; minor folding.										
		88.55-88.60 : quartz vein with 2% py.	12760		88.50	90.50	2.00	9	16	0.2	6	< 5
		90.40-90.50 : 5% py in dark, pelitic section										
		96.00 : foliation is 75° to core axis.										
		99.25-99.35 : quartz vein, 1% py.	12761		99.25	101.00	1.75	11	30	0.2	6	< 5
		102.20-102.40: narrow quartz veins with py, sphalerite.	12762		101.00	102.40	1.40	12	300	0.2	18	< 5
		113.25-115.00: minor biotite-rich sections.										
115.00	121.05	Metapelite; black/dark brown/dark gray; 3-5% py; fine grained with minor biotite (chloritoid?) grains	12763		115.00	117.00	2.00	42	245	0.3	27	< 5
			12764		117.00	119.00	2.00	42	122	0.1	11	< 5
			12765		119.00	121.05	2.05	42	135	0.2	11	< 5
121.05	182.00	Calcitic marble; mostly layered (bedded?); fine medium grained, massive medium grained marble sections to 1m ; py associated with graphite/pelitic layers; < 1% py overall.										

DIAMOND DRILL RECORD

NAME OF PROPERTY Fernleigh

HOLE NO. FL-85-9 SHEET NO. 3

METERAGE		DESCRIPTION	SAMPLE			ASSAYS					
FROM	TO		NO.	Meters			Cu ppm	Zn ppm	Ag ppm	Pb ppm	Au ppb
				FROM	TO	TOTAL					
121.05	182.00	CONT'D									
		122.25-125.80 : including several quartz-carbonate veins to 0.35m with fuchsite and 2%py	12766	121.05	122.80	1.75	20	45	0.2	10	<5
			12767	122.80	124.40	1.60	10	16	0.2	10	<5
		129.50 : graded beds indicate possible tops to North.	12768	124.40	125.80	1.40	9	40	0.2	12	<5
		132.70-134.00 : several narrow calcite-pyrite fractures subparallel to core,	12769	132.70	134.00	1.30	19	110	0.2	25	<5
		138.00 : foliation at 78° to core axis.									
		137.80-138.20 : calcite-pyrite fractures subparallel to core.	12770	137.80	138.20	0.40	13	270	0.3	22	<5
		148.13-148.33 : grey quartz veins, cherty									
		148.60-148.76 : dark brown, biotite-rich band.									
		151.20 - 151.30 : calcite									
		153.60-154.80 : several vuggy calcite-pyrite veins subparallel to core.	12771	153.60	154.80	1.20	13	560	0.3	27	<5
		157.00-159.10 : several x-cutting, subparallel, calcite pyrite veins	12772	157.00	159.10	2.10	9	260	0.3	16	<5
		164.55-166.65 : quartz and calcite veins.	12773	164.55	166.65	2.10	11	600	0.5	60	<5
		168.70-169.10 : brecciated zone with vuggy calcite.	12774	166.65	169.10	2.45	11	70	0.3	17	<5
		180.00 : foliation at 88° to core axis.									
	182.00	E.O.H.									



Name and Postal Address of Recorded Holder: ST. JOE CANADA INC
 Prospector's Licence No.: T-3608
 111 RICHMOND STREET WEST STE 1116 TORONTO ONT M5H 2J4

Summary of Work Performance and Distribution of Credits

Total Work Days Cr. claimed 606 597	Mining Claim			Mining Claim			Mining Claim		
	Prefix	Number	Work Days Cr.	Prefix	Number	Work Days Cr.	Prefix	Number	Work Days Cr.
for Performance of the following work. (Check one only)	EO	673566	298.5						
		673567	298.5						

Manual Work
 Shaft Sinking Drifting or other Lateral Work.
 Compressed Air, other Power driven or mechanical equip.
 Power Stripping
 Diamond or other Core drilling
 Land Survey

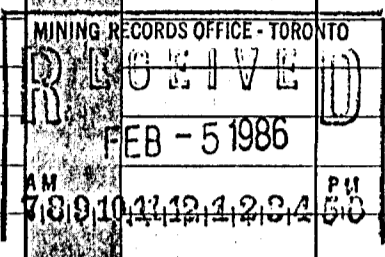

All the work was performed on Mining Claim(s): 673566

Required Information eg: type of equipment, Names, Addresses, etc. (See Table Below)

I drill hole located on 673566. Length 192m (~~606~~ 597') Azimuth 160°
 Start date Nov. 21/85 end date Nov. 22/85 Dip 50°
 Drilled by Midwest Drilling, 180 Cree Crescent, Winnipeg, Manitoba. R3T 3W1 Foreman Don Howdle
 Logged by Wayne Johnson, 5 Pine St. N. Ontario L1A 3G4
 BQ sized core
 WORK ASSIGNMENT
 EO 673566
 4,000 - 298.5 = 3,701.5 days balance.

Date of Report: Jan 31/86
 Recorded Holder or Agent (Signature): Robin Jewett

Certification Verifying Report of Work
 I hereby certify that I have a personal and intimate knowledge of the facts set forth in the Report of Work annexed hereto, having performed the work or witnessed same during and/or after its completion and the annexed report is true.

Name and Postal Address of Person Certifying: Robin Jewett

Date Certified: Jan 31/86
 Certified by (Signature): Robin Jewett

Table of Information/Attachments Required by the Mining Recorder

Type of Work	Specific information per type	Other information (Common to 2 or more types)	Attachments
Manual Work	Nil	Names and addresses of men who performed manual work/operated equipment, together with dates and hours of employment.	Work Sketch: these are required to show the location and extent of work in relation to the nearest claim post.
Shaft Sinking, Drifting or other Lateral Work			
Compressed air, other power driven or mechanical equip.	Type of equipment	Names and addresses of owner or operator together with dates when drilling/stripping done.	
Power Stripping	Type of equipment and amount expended. Note: Proof of actual cost must be submitted within 30 days of recording.		
Diamond or other core drilling	Signed core log showing; footage, diameter of core, number and angles of holes.	Nil	Work Sketch (as above) in duplicate
Land Survey	Name and address of Ontario land surveyor.		Nil

CLARENDON Twp
M-77

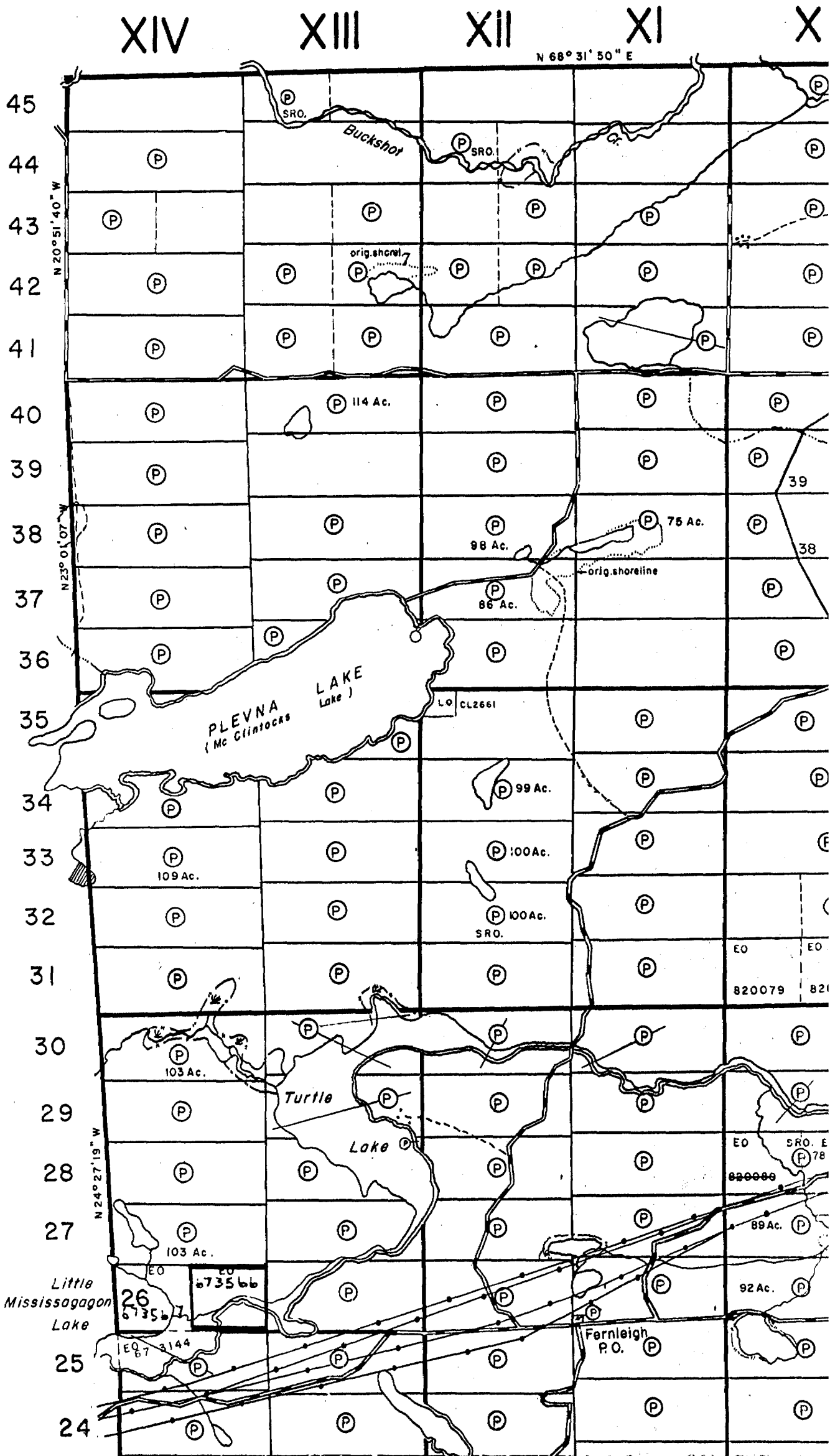

p. (M.50)

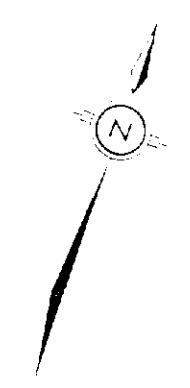
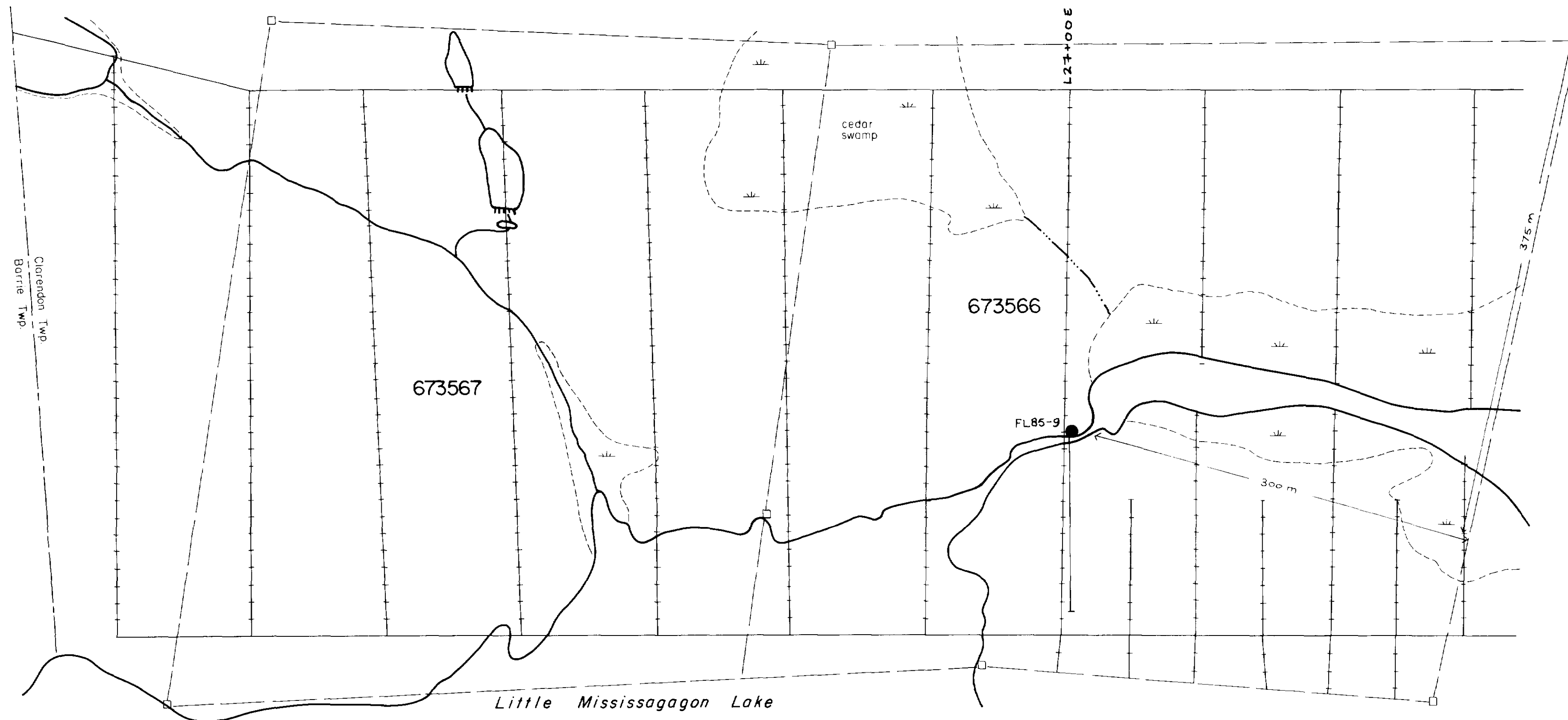

LEGEND
 □ Claim post
 — Claim line

St. Joe Canada Inc.

Fernleigh Option
 Ontario N.T.S. 31C/14

DRILL HOLE LOCATION
FL-85-9

SCALE 1:2500
 50 0 50 100 150 200
 metres

Jeff Meek & Associates Ltd.
 Drafting & Cartographic Services

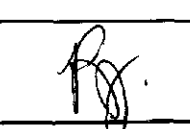

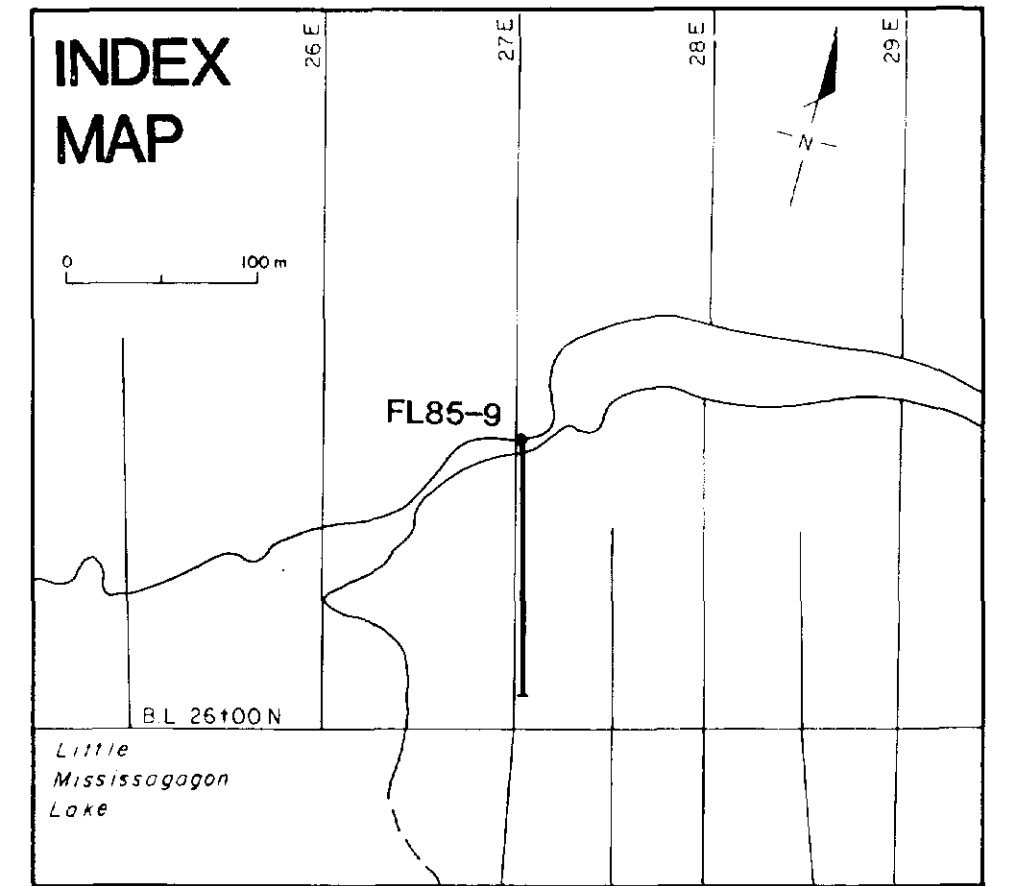
S

N

COLLAR (0 m)

-50 m

-100 m

-150 m

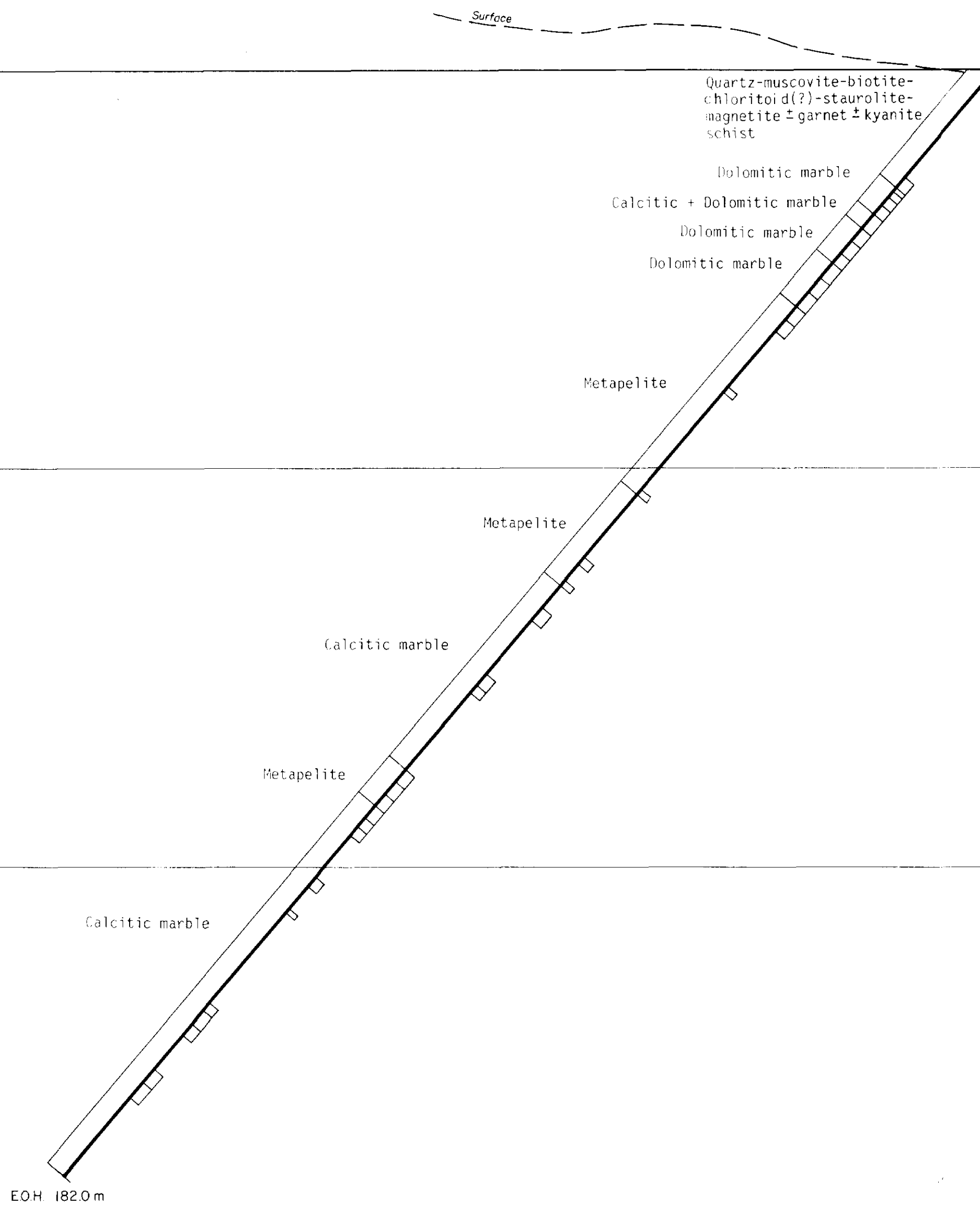

E.O.H. 182.0 m

St. Joe Canada Inc.			
FERNLEIGH OPTION			
Clarendon Township, Ontario - N.T.S. 31C/14			
Vertical Cross Section			
DRILL HOLE FL85-9			
Facing S 70° W			
SCALE 1:500			
GEOLOGIST: W. Johnson, T. Dickson	DRAWN BY: Jeff Meek & Associates Ltd.	DATE: November 85	PLAN #
AZIMUTH: 160°		COLLAR LOCATION: 27+05 N / 27+48 E	

