



31C14SE0041 21 BARRIE

010

Diamond Drilling

Township OF BARRIE

Report NO: 21

Work performed by: ARNOLD HARDIE

Claim NO	Hole NO	Footage	Date	Note
EO 30483	1	39'	Mar/66	
	2	40'	Mar/66	

Notes:

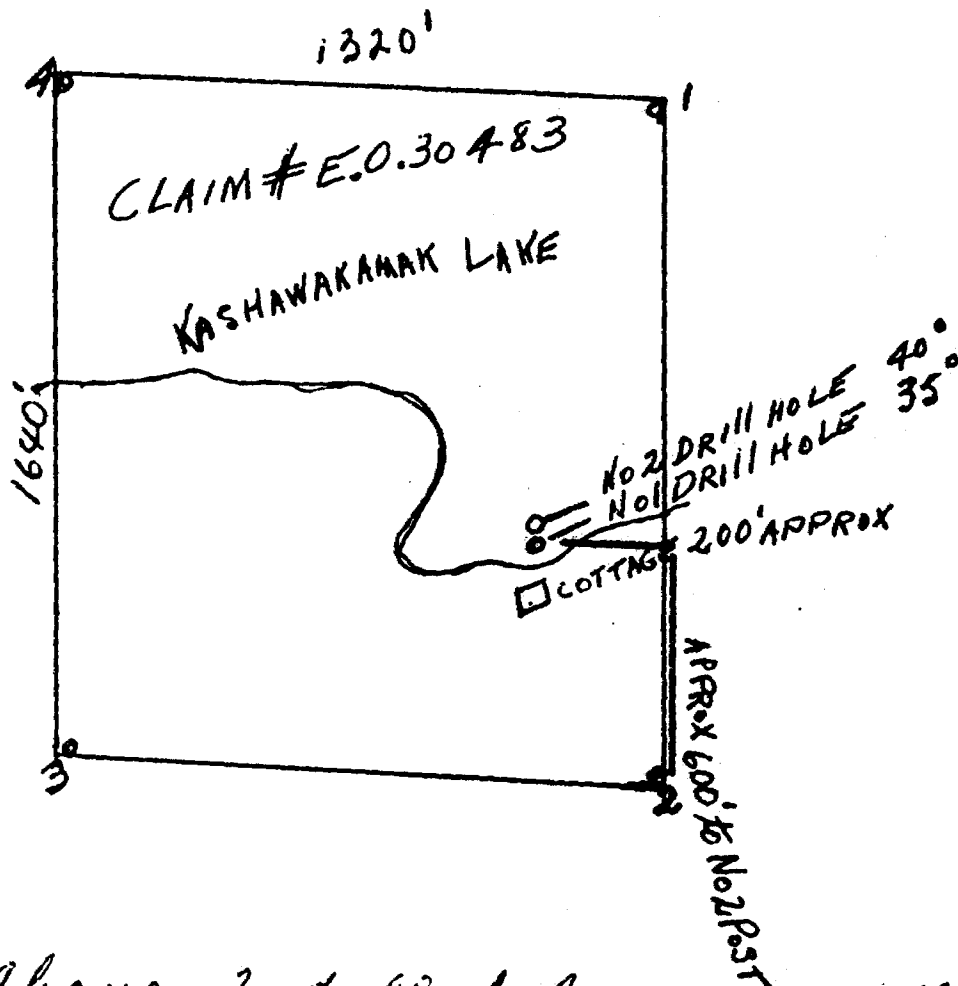

The above 2 drill holes were drilled
 8 feet off shore on claim # E.O. 30483
 and from a north to south direction

Arnold A. Hardie
 May 10/66

Property _____

DIAMOND DRILL RECORD

Hole No. 2 Sheet No. _____ Lat. _____ Total Depth 40'
 Section _____ Dep. _____ Elev. Collar _____
 Date begun _____ Bearing _____ Elev. Bottom _____
 Date finished _____ Angle 40°

DEPTH FEET	FORMATION	SAMPLE NO.	WIDTH OF SAMPLE	GOLD \$	SLUDGE GOLD. \$
0-5	limb burden - carbonyl				
5-10	limestone cut by numerous veins of quartz, some very minor lead & sphalerite finely disseminated				
10-15	limestone light blue grey in color well very fine tinged of quartz & calcite				
15-20	limestone cut by a number of narrow quartz veins up to 4" in width in some places 10" in width some with galena & sphalerite				
20-25	limestone cut by very fine veins of sphalerite finely disseminated				
25-30	limestone of a very light grey color cut by long veins of quartz & sphalerite minor amounts of finely disseminated galena appear in the fractures & within the veins.				
30-40	Due to bad blocking the last 10 feet of core was not recovered and therefore this hole had to be abandoned				

Arnold G. Harter
Mar 10/66

Property Claim # E030483 Barre Twp.

DIAMOND DRILL RECORD

Hole No. 1 Sheet No. _____ Lat. _____ Total Depth 39'
 Section _____ Dep. _____ Elev. Collar _____
 Date begun Mar 5/66 Bearing _____ Elev. Bottom _____
 Date finished Mar 5/66 Angle 35°

DEPTH FEET	FORMATION	SAMPLE NO.	WIDTH OF SAMPLE	GOLD \$	SLUDGE GOLD. \$
0-5	Overburden - casing				
5-10	Limestone cut by numerous veinlets of quartz some very minor lead & zinc finely disseminated				
10-15	Limestone - light blue gray in colour with very fine stringers of quartz & calcite				
15-20	Limestone cut by a number of narrow quartz stringers 2 to 3 inches wide and one 8 inches wide some minor galena & sphalerite				
20-25	Limestone cut by very fine veinlets of (zinc sphalerite) with some finely disseminated galena				
25-30	Limestone cut by tiny veinlets of quartz & calcite with very minor galena & sphalerite				
30-35	Limestone of a very light grey color cut by tiny veinlets of quartz and sphalerite minor amounts of finely disseminated galena appear in the fracture & within the veinlets				
35-39	mud slown dark brown dirt				

Arnold G. Hurdell
31 Mar. 10/66