



31D09NW8567 29 CAVENDISH

010

Diamond Drilling

Township of Cavendish

Report No: 29

Work performed by: Quebec Uranium Mining Corporation

| Claim No | Hole No | Footage | Date | Note |
|------------|---------|---------|--------|------|
| E.O. 34269 | C-1 | 357' | Oct/69 | |
| | C-2 | 342.5' | Oct/69 | |
| | C-4 | 293' | Oct/69 | |
| E.O. 34368 | C-3 | 307' | Oct/69 | |
| E.O. 34381 | C-5 | 208' | Oct/69 | |

Notes:

Autopositive Enclosed

Hole No. C-1

DIAMOND DRILL LOG

QUEBEC URANIUM MINING CORPORATION

Company

Suite 400, 621 Craig Street West, Montreal 101, Quebec
Address

DIAMOND DRILLING BY (Co. Name) Continental Diamond Drilling Co., Ltd.,

CLAIM NO. (Prospector's Licence No.) 20-34269 ~~CLAIM NO. 20-34269~~

TOWNSHIP Cavendish Twp. PROVINCE Ontario

Collar
LOCATION 275' south, 100' east of Post 4, 20-34269

DIP-COLLAR -45° STRIKE East (Mag.)

200 ft. -42° LENGTH 352'

ft. ELEVATION

ft. LATITUDE 2+75 N

ft. DEPARTURE B.L. # 2

Date Started October 18, 1969 Date Finished October 20, 1969

*# 82/69 Cavendish Twp.
Quebec Uranium Mng Corp.*

H.C. = 261'
V.C. = 241'

LOGGED BY:

R.L. Alexander
R.L. Alexander, B.Sc.
Geologist

| From | To | DESCRIPTION | Sample No. | Length Feet | ANALYSES | | | |
|--------|--------|--|------------|-------------|----------|--|--|--|
| | | | | | | | | |
| 0 | 4.0 | Casing (C/B). | | | | | | |
| 4.0 | 93.9 | QUARTZ-BIOTITE GNEISS, grey to dark grey, few sections nearly black, salt and pepper appearance, gneissosity and alternating bands of siliceous minerals with biotite and mafic minerals at 65°-70° to core axis. No apparent sulphide minerals, background radioactivity. 38-45 nearly black, high in mafic minerals. A few rusty fractures, and odd quartz or granite veinlet. Lower contact at 55-60° to core axis. | | | | | | |
| 93.9 | 127 | GRANITE, pink, odd white or quartz rich section, fractured, nearly massive, minor mica and mafic minerals. 93.9-102 darker, rusty to brownish red caste, likely due to hematite along fractures. No apparent sulphides, radioactivity at background. | | | | | | |
| 127 | 129(?) | QUARTZ-BIOTITE GNEISS, lignation 70° to core axis, not banded, lower contact gradational and obscure. | | | | | | |
| 129(?) | 157 | DIORITE OR DIABASE ?, sills or dikes, no chilled edges, but very fine grained | | | | | | |

Cavendish Property, Ontario

PROPERTY
C-1
HOLE No. _____

DIAMOND DRILL LOG

PAGE No. _____

1

R. P. Alexander

| From | To | DESCRIPTION | Sample No. | Length Feet | ANALYSES | | | | |
|-------|-------|--|------------|-------------|----------|--|--|--|--|
| | | | | | | | | | |
| | | to medium grained sections with gradational changes, dark greenish gray, dense, massive and hard. Odd pyrite speck, high in mafic minerals, some minor slips and joints. | | | | | | | |
| | | 149.5-150.1 breccia zone, quartz-carbonate, biotite and mafic minerals, contacts 30° to core axis. | | | | | | | |
| | | Lower contact obscure over 1 foot, with frequent carbonate lined slips at 50-60° to core axis. | | | | | | | |
| 157 | 160.1 | QUARTZ-BIOTITE GNEISS, salt and pepper appearance, detrital, faint gneissosity 60° to core axis, lower contact 45-50° to core axis. | | | | | | | |
| 160.1 | 200 | GRANITE, medium to coarse, some pegmatitic phases, pink to rusty red, a few light, quartz rich sections, less than 10% mafic minerals, fractured, hematite staining. Background radioactivity, lower contact 90° to core axis. | | | | | | | |
| | | 168-0.7 ft. gneiss inclusion. | | | | | | | |
| 200 | 337.8 | QUARTZ-BIOTITE GNEISS, gneissosity and banding 70-80° to core axis (see 4-93.9), several slips paralleling core. 256-0.5 ft., breccia, sediment fragments, quartz-carbonate | | | | | | | |

PROPERTY Cavendish Property, Ontario

HOLE No. C-1

DIAMOND DRILL LOG

PAGE No. 2

H. R. Alexander

| From | | DESCRIPTION | Sample No. | Length Feet | ANALYSES | | | |
|-------|-------|--|------------|-------------|----------|--|--|--|
| | | | | | | | | |
| | | and hematite, contacts 30° to core axis. | | | | | | |
| | | 266-269 breccia, fracture zones, most slips 20° to parallel to core. | | | | | | |
| | | 291-294 granitized, bands of quartz and feldspar, lower contact 45-50° to core axis. | | | | | | |
| 337.8 | 348.9 | DIABASE, (GRANITE?), massive fine to medium grained, dark pink to reddish brown, mostly feldspar, minor mafics, odd quartz (?), lower contact at 70° to core. Some tight slips at 65-70° to core axis. | | | | | | |
| 348.9 | 357 | QUARTZ-BIOTITE GNEISS, gneissosity 80°-85° to core axis, minor banding. | | | | | | |
| | 357 | End of Hole C-1 | | | | | | |
| | | NOTE:- Radioactivity of all core was background or less than 1/2 more than background. | | | | | | |
| | | 14 Specimens of core taken at the following footages:- | | | | | | |
| | | 22, 47.7, 70.8, 88.3, 117.5, 132.5, 160, 182, 220, 245, 275, 299, 323.5, 347.2. | | | | | | |

PROPERTY Cavendish Property, Ontario

HOLE No. C-1

DIAMOND DRILL LOG

PAGE No. 3

R. H. Alexander

DIAMOND DRILL LOG

QUEBEC URANIUM MINING CORPORATION

Company

Suite 400, 621 Craig Street West, Montreal 101, Quebec
Address

DIAMOND DRILLING BY (Co. Name) Continental Diamond Drilling Co. Ltd.

CLAIM NO. (Prospector's Licence No.) EO-34269

TOWNSHIP Cavendish PROVINCE Ontario

Collar

LOCATION 115' south, 100' east of Post # 4, EO-34269

DIP-COLLAR -45° STRIKE East (Mag.)

200 ft. -44° LENGTH 342.5 feet

ft. ELEVATION

ft. LATITUDE $1+25^{\circ}$

ft. DEPARTURE B.L. # 2

Date Started October 22, 1969 Date Finished October 23, 1969

H.C. = 245'
V.C. = 240'

LOGGED BY:

R.L. Alexander
R.L. Alexander, BSc
Geologist

| From | To | DESCRIPTION | Sample No. | Length Feet | ANALYSES | | | |
|------|-------|--|------------|-------------|----------|--|--|--|
| | | | | | | | | |
| 0 | 4.0 | Casing (C/B). | | | | | | |
| 4.0 | 32.0 | GRANITE, medium to coarse grained, slightly pegmatitic, pink to reddish brown, some hematitic stain and fractured. Low in mafic minerals, few quartz bands. 30.8-32 40% mafic minerals. | | | | | | |
| 32.0 | 46.7 | DIABASE OR (DIABASE?), very fine grained, massive, very dark gray, a few carbonate filled slips, upper and lower contacts at 65 and 80 to core axis. | | | | | | |
| 46.7 | 91.7 | GRANITE, (see 4.0-32.0) 77-78.6 fine grained, nearly massive quartz-biotite gneiss inclusion. 81-83.7 see (77-78.6) 90.5-91 Quartz-biotite gneiss inclusion. | | | | | | |
| 91.7 | 301.5 | QUARTZ-BIOTITE GNEISS, some fracturing and contortion. 91.7-99 gneissosity 70-80° to core. 99-106 gneissosity 35-40° to core, granitized. 106-111 gneissosity, 15-20° to core 111-117 gneissosity 45° to core, weakly granitized. 117-149 gneissosity 80-50° to core | | | | | | |

PROPERTY Cavendish Township, Ontario

HOLE No. C-2

DIAMOND DRILL LOG

R. H. Alexander

| From | To | DESCRIPTION | Sample No. | Length Feet | ANALYSES | | | |
|---|-------|--|------------|-------------|----------|--|--|--|
| | | | | | | | | |
| | | with some granitized sections. | | | | | | |
| | | 149-301.5 gneissosity 50-80° with some contortion and folding, several slips, a few minor breccia zones (less than 6 inches), intensity of banding varies. | | | | | | |
| 301.5 | 320.5 | DIABASE OR GRANITE(?), dark pink to reddish brown, massive, fine to medium grained, very little quartz, some biotite and muscovite, upper 4 feet coarser, more granitic. Upper contact 40-45° and lower one 30-35° to core axis. | | | | | | |
| 320.5 | 342.5 | QUARTZ-BIOTITE GNEISS, gneissosity and varying intensity of banding at 80° to core axis, a few short sections weakly granitized. | | | | | | |
| | 342.5 | feet- End of Hole C-2 | | | | | | |
| NOTE:- Radioactivity of all core was background or less than $\frac{1}{2}$ more than background count. 14 specimens of core taken at the following footages:- 15, 34.2, 63.5, 87.7, 110.3, 137, 157, 180, 204, 229, 252, 278, 311.3, 336.5. | | | | | | | | |

Gavendish Property, Ontario

PROPERTY C-2
HOLE No. _____

DIAMOND DRILL LOG

PAGE No. 2

W. H. Alexander

Hole No. C-3

DIAMOND DRILL LOG

QUEBEC URANIUM MINING CORPORATION

Company

Suite 400, 621 Craig Street West, Montreal 101, Quebec
Address

DIAMOND DRILLING BY (Co. Name) Continental Diamond Drilling Co., Ltd.

CLAIM NO. (Prospector's Licence No.) EO-34368

TOWNSHIP Oavendish PROVINCE Ontario

Collar

LOCATION 450' west, on claimline, Post # 2, EO-34368

DIP-COLLAR -45° STRIKE N 60° W (Mag.)

200 ft. -39° LENGTH 307'

ft. ELEVATION

ft. LATITUDE L 0 + 00 N

ft. DEPARTURE 32 + 00 W

Date Started October 25, 1969

Date Finished October 26, 1969

H.C. = 231'
V.C. = 202'

LOGGED BY:

R.L. Alexander
R.L. Alexander, BSc
Geologist

| From | To | DESCRIPTION | Sample No. | Length Feet | ANALYSES | | | |
|-------|-------|---|------------|-------------|----------|--|--|--|
| | | | | | | | | |
| 0 | 4.0 | CASING. | | | | | | |
| 4.0 | 13.3 | QUARTZ-BIOTITE GNEISS, very dark grey, salt and pepper appearance, gneissocity 40-50° to core axis. | | | | | | |
| 13.3 | 14.3 | GRANITE-DYANITE(?), reddish brown, very fine grained, massive, 10% or less minute mafic minerals. Upper contact 70°, lower 125° to core axis. | | | | | | |
| 14.3 | 203 | QUARTZ-BIOTITE GNEISS, very dark grey, salt and pepper appearance, gneissocity 40-60° to core axis, some banding, a few sections with pink feldspar or granitized(?). A few fractures and minor contortions, 58-0.4' white, fine granite, at 50° to core axis. 88.5-0.2' white granite. | | | | | | |
| 203 | 208.1 | GRANITE, fine to medium grained, nearly massive, deep pink to reddish brown, 10% or less mafics, mostly biotite, some light micas. Upper contact 55°, lower contact 80° to core axis. | | | | | | |
| 208.1 | 307 | QUARTZ-BIOTITE GNEISS, see above section, gneissocity 60-80° to core axis. 242.1-242.6 Granite inclusion or aplite dike(?), contacts 70° to core axis. | | | | | | |

Cavendish Township, Ontario.

PROPERTY
6-3
HOLE No.

DIAMOND DRILL LOG

PAGE No. 1

R. H. Alexander

| From | DESCRIPTION | Sample No. | Length Feet | ANALYSES | | | |
|--------|---|------------|-------------|----------|--|--|--|
| | | | | | | | |
| | 246.1-0.2' granite. | | | | | | |
| | 291-293 feldspathized and epidotized | | | | | | |
| | 294.3-297 feldspathized and epidotized. | | | | | | |
| | 307.0 feet end of hole C-3 | | | | | | |
| NOTE:- | Radioactivity of all core was background or less than half more than background count. 13 specimens of core were taken from the following footages:- 24, 49, 73, 99.5, 125, 147, 172, 197, 205, 224, 249, 274, 296.7. | | | | | | |
| | | | | | | | |
| | | | | | | | |
| | | | | | | | |
| | | | | | | | |
| | | | | | | | |
| | | | | | | | |
| | | | | | | | |
| | | | | | | | |
| | | | | | | | |
| | | | | | | | |
| | | | | | | | |
| | | | | | | | |
| | | | | | | | |
| | | | | | | | |
| | | | | | | | |
| | | | | | | | |
| | | | | | | | |
| | | | | | | | |
| | | | | | | | |
| | | | | | | | |
| | | | | | | | |
| | | | | | | | |
| | | | | | | | |
| | | | | | | | |
| | | | | | | | |
| | | | | | | | |

PROPERTY Cavendish Township, Ontario
HOLE No. C-3

DIAMOND DRILL LOG

R. L. Alexander

Hole No. C-4

DIAMOND DRILL LOG

QUEBEC URANIUM MINING CORPORATION

Company

Suite 400, 621 Craig Street West, Montreal 101, Quebec
Address

DIAMOND DRILLING BY (Co. Name) Continental Diamond Drilling Co. Ltd.

CLAIM NO. (Prospector's Licence No.) 30-34269 ~~XXXXXXXXXXXXXXXXXXXX~~
Claim Nos. to and

TOWNSHIP Cavendish PROVINCE Ontario

Collar

LOCATION 750' south, 453' east of Post # 4

DIP-COLLAR -45° STRIKE N 45° W (Mag.)

200 ft. -42° LENGTH 293 feet

ft. ELEVATION

ft. LATITUDE L 8 + 00 S

ft. DEPARTURE 22 + 97 W

Date Started October 27, 1969 Date Finished October 28, 1969

H.C. = 214'
V.C. = 199'

LOGGED BY: R.L. Alexander
R.L. Alexander, BSc.
Geologist

| From | To | DESCRIPTION | Sample No. | Length Feet | ANALYSES | | | |
|-------|-------|--|------------|-------------|---|--|--|--|
| | | | | | | | | |
| 0 | 8.5 | CASING. | | | | | | |
| 8.5 | 46.7 | QUARTZ-BIOTITE GNEISS, dark grey, lighter bands of siliceous minerals, gneissosity and banding 75-80° to core axis, a few fractures and ribs of granite (1/2-2 inches) lower contact 75° to core axis. | | | | | | |
| 46.7 | 113.5 | GRANITE, pink to reddish brown hematitic stains and fractures, nearly massive, medium to coarse grained (pegmatitic), a few light or quartz-rich sections, less than 10% mafics and micaceous minerals. | | | | | | |
| 113.5 | 293.0 | QUARTZ-BIOTITE GNEISS, gneissosity 65-70° to core axis, similar to above but banding less distinct, a few quartz, quartz-carbonate ribs and fractures. 178.1-178.7 granite, pink, fine to medium grained, massive. | | | | | | |
| | | | | | NOTE:- Radioactivity of all core was background or less than half more than background count. 12 specimens of core were taken from the following footages:- 24.3, 46, 57, 84, 109, 134, 159, 184, 210, 235, 262, 287. | | | |
| | 293.0 | feet - end of Hole C-4 | | | | | | |

PROPERTY Cavendish Township, Ontario.

HOLE No. C-4

DIAMOND DRILL LOG

PAGE No. 1

R. R. Alexander

DIAMOND DRILL LOG

QUEBEC URANIUM MINING CORPORATION

Company

Suite 400, 621 Craig Street West, Montreal 101, Quebec

Address

DIAMOND DRILLING BY (Co. Name) Continental Diamond Drilling Co. Ltd.

CLAIM NO. (Prospector's Licence No.) EO-34381

TOWNSHIP Cavendish PROVINCE Ontario
Collar

LOCATION 520 feet north, 240 feet east, Post # 3 Claim EO-34381

DIP-COLLAR -45° STRIKE S 60° E (Mag.)

200 ft. -45° LENGTH 208 feet

ft. ELEVATION

ft. LATITUDE L 28 + 12 S

ft. DEPARTURE 37 + 40 W

Date Started October 30, 1969 Date Finished October 30, 1969

H.C. = 147'
V.C. = 147'

LOGGED BY: R.L. Alexander
R.L. Alexander, BSc.
Geologist

| From | To | DESCRIPTION | Sample No. | Length Feet | ANALYSES | | | |
|------|-------|--|---|-------------|----------|--|--|--|
| | | | | | | | | |
| 0 | 3.0 | CASING. | | | | | | |
| 3.0 | 70.5 | INTERBANDS PEGMATITE AND GRANITE. Pegmatite is coarse, fractured, pink with light colored (quartz-rich) sections, 5% or less biotite, mica and mafics. Granite, reddish brown, fine to medium grained, nearly massive, 10% or less fine mafic and biotite crystals, low in quartz. 3-5 fine grained granite. 6.2-8.5 fine grained granite. 18.7-29.6 fine grained granite. 37-40.5 fine grained granite. 65.3-69 fine grained granite. | | | | | | |
| 70.5 | 208.0 | GRANITE, reddish brown, fine to medium grained, nearly massive, 10% or less fine mafics and micas, mainly biotite. 195.3-196.7 pegmatite band. 208.0 feet - end of hole C-5 | NOTE: Radioactivity of all core was background or less than half more than background count. 9 specimens of core were taken from the following footages: 7, 32, 57, 77, 102, 127, 152, 177, 202. | | | | | |

PROPERTY Cavendish Township, Ontario

HOLE No. C-5

DIAMOND DRILL LOG

PAGE No. 1

R. H. Alexander

LOT 11

LOT 12

LOT 13

LOT 14

LOT 15

LOT 16

KEY MAP
SCALE - 1 INCH = 25 MILES

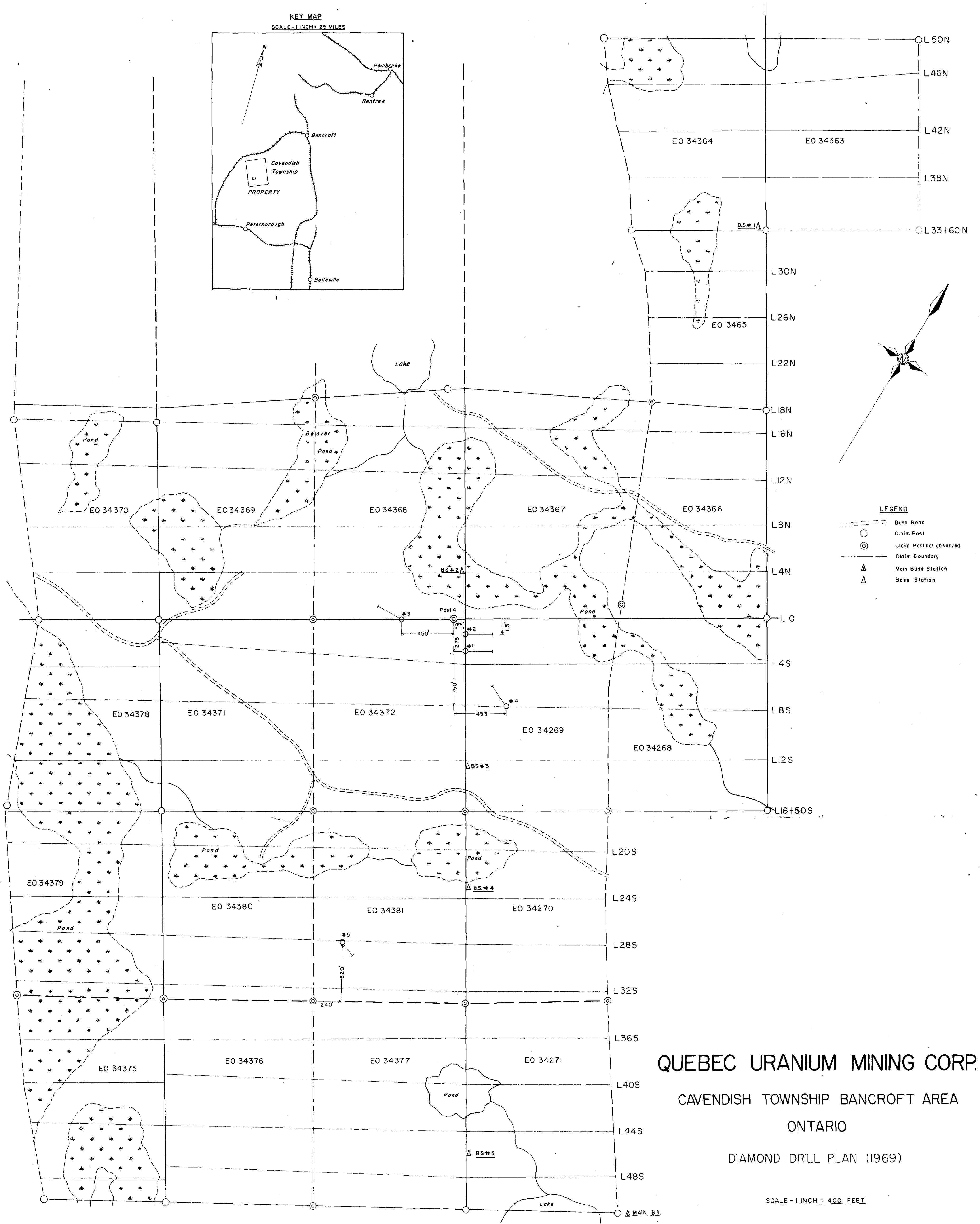
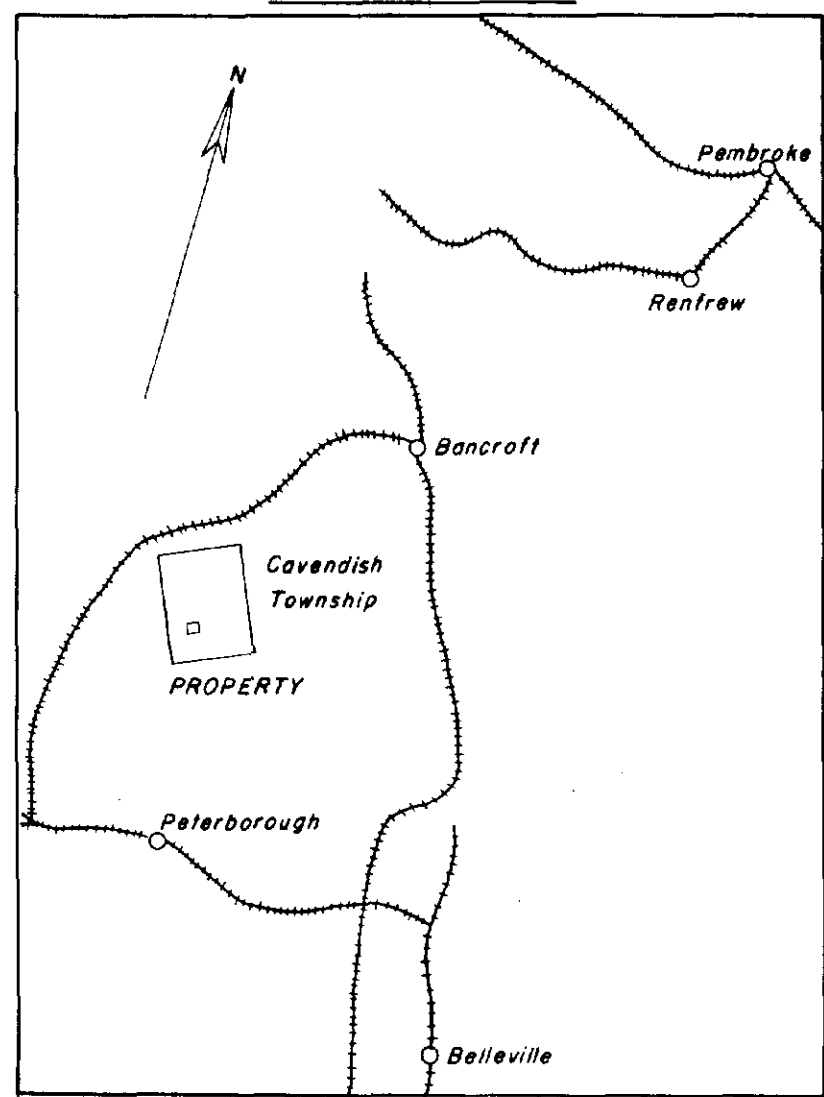

- LEGEND**
- Bush Road
 - Claim Post
 - Claim Post not observed
 - Claim Boundary
 - Main Base Station
 - Base Station

QUEBEC URANIUM MINING CORP.

CAVENDISH TOWNSHIP BANCROFT AREA

ONTARIO

DIAMOND DRILL PLAN (1969)

SCALE - 1 INCH = 400 FEET

R. A. Alexander, B.Sc.
Geologist

