

2.18426

Physical Assessment Work Report Mining Claim SO 1150872, South
Half Lots 15 and 16, Concession XI, Monmouth Township (G-1298),
Haliburton County, Southern Ontario Mining Division for the
Period of April 4 to April 19, 1998



31D16NW2001 2.18426 MONMOUTH

010

S Harper

S. Harper, Hon. B.Sc., M. Sc. Crd.
Exploration Geologist
Toronto, Ontario
April 1998



31D16NW2001

2.18426

MONMOUTH

010C

TABLE OF CONTENTS

INTRODUCTION	
1.1 LOCATION	4
1.2 ACCESS	4
1.3 PROPERTY	4
1.4 PHYSIOGRAPHY, VEGETATION AND WILDLIFE	7
1.5 HISTORY AND PREVIOUS WORK	7
GEOLOGY AND OBSERVATIONS	
2.1 REGIONAL GEOLOGY	7
2.2 LOCAL GEOLOGY	8
CONCLUSIONS AND RECOMMENDATIONS	8
REFERENCES	9
STATEMENT OF COST	10
DATES OF EXPLORATION ACTIVITY	10

LIST OF FIGURES

Property Location Map
Claim Location Map

5
6

INTRODUCTION

1.1 BRIEF PHYSICAL WORK DESCRIPTION

One old trench was 'cleaned up' to permit geological examination. In addition, some work was done along strike of the vein to reveal the vein contact. This work required minor overburden stripping and bedrock trenching. Most work was done using hand equipment including picks, shovels, crowbars, winches, hammers and chisels. A Pionjar 120 rock drill/breaker ('jackhammer') was also used. All work was done under the supervision of S. Harper (author). On average 12 hours were worked per person per day.

The work done revealed the vein to consist of areas of massive, coarse grained anhedral to subhedral black to green amphibole, massive coarse grained anhedral white calcite, massive medium grained anhedral reddish apatite, and rarely pinkish subhedral to euhedral microcline that ranged up to a few inches in size. The country rock consisted of grey colored massive, banded quartzite. The northern vein contact was discovered and exposed. The vein dipped vertical in the exposed area. The strike of the vein was not measured at this time. The vein is at least 10 feet wide, however, the southern vein contact was not found so the vein could be substantially wider.

1.2 LOCATION

The property consists of a single mining claim of two units having mining claim number SO 1150872. The mining claim is located on Lot 15 South half, and Lot 16 South half, Concession XI, Monmouth Township (G-1298), Haliburton County, Southern Ontario Mining Division at Latitude 44° 58' 40" N and Longitude 78° 17' 23" W, UTM 713008mE, 4983003mN, Zone 17, NTS 31 D/16 (Gooderham). Figure 1 shows the mining claim location within southern Ontario.

1.3 ACCESS

There is good road access to the mining claim. To reach the property travel north on Highway 121 from the village of Tory Hill for 0.2 km to Gibson Road. Turn left onto Gibson Road and continue for 0.95 km (Sabina, 1986). At this point the road deteriorates and is only suitable for vehicles with high clearance. Continue for another 460 metres. Most of the showings are located to the south (left) of the road.

1.4 PROPERTY

The property consists of a single mining claim SO 1150872 that comprises two mining units (500mN-S X 800m E-W). The mining claim is located on the south halves of Lots 15 and 16, Concession XI, Monmouth Township (G-1298), Haliburton County, Southern Ontario Mining Division (Figure 2). The mining claim was staked by S. Harper and O. Bolton, both of Toronto, on September 2, 1992 and recorded on October 2, 1992 for Sharpmin Developments Incorporated, 153 St. George Street, Suite 407, Toronto, Ontario M5R 2L9. The mining rights are still held by Sharpmin Developments Incorporated.

The surface rights are privately owned. Surface rights ownership was investigated in the fall of 1992 at which time it was held by E. Bradamore, Box 603, Minden, Ontario, K0M 2K0; R. and W. Andrew, 24 Strathy Road, Ajax, Ontario, L1S 2V1; D. Cowle, 309 Elgin Street East, Oshawa, Ontario, L1G 1T5; and P. Madill, Box 136, Londesborough, Ontario, N0M 2H0. The surface rights owners were advised of intention to perform assessment work in the fall of 1992 as required by the Ontario Mining Act.

During claim staking it was found that the southern boundary of Lots 15 and 16 had been recently surveyed.

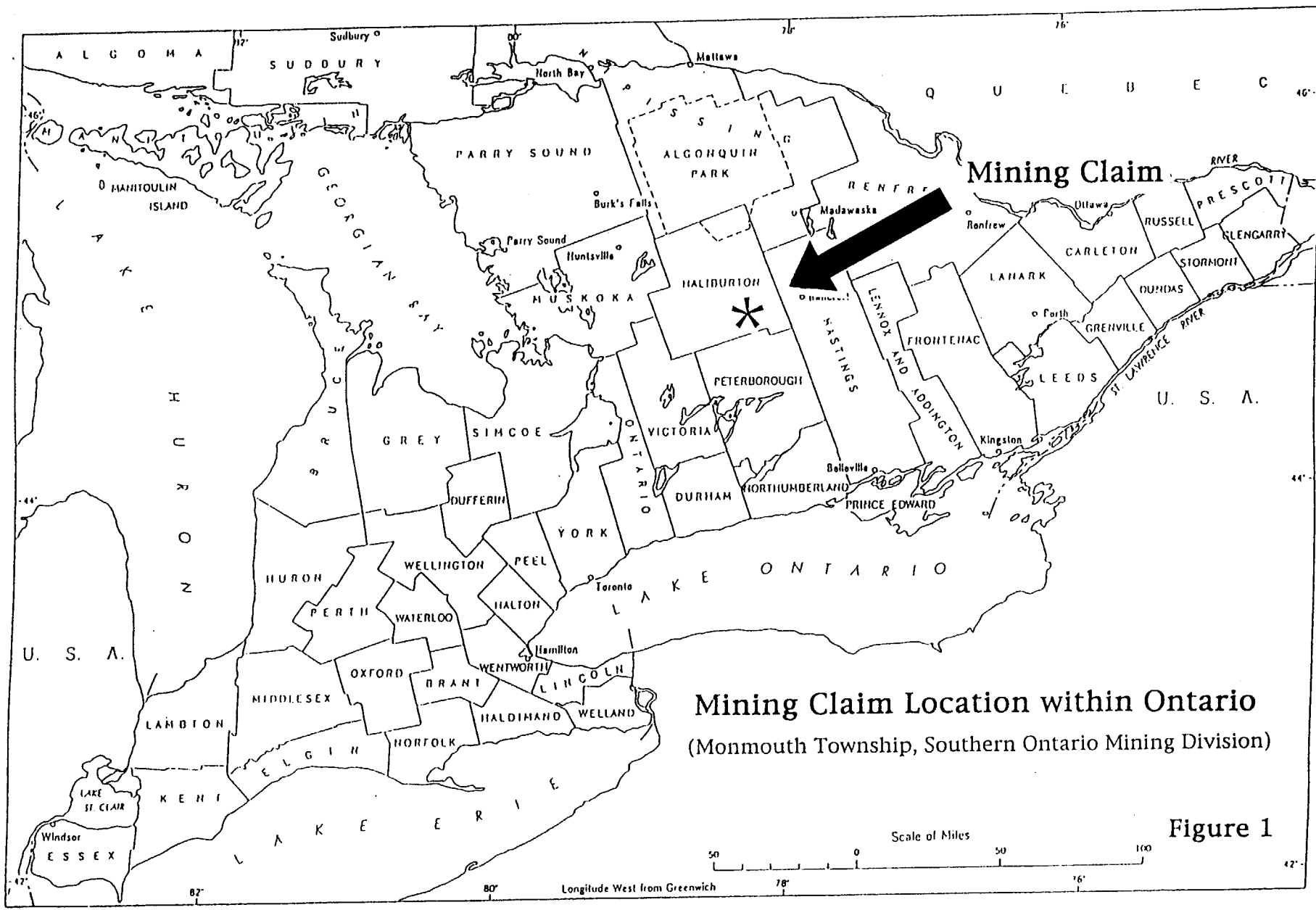

Mining Claim Location within Ontario
 (Monmouth Township, Southern Ontario Mining Division)

Figure 1

Key Map of Mining Claim SO1150872,
Lot 15 S 1/2 and 16 S 1/2 Con. XI Monmouth
Township, Haliburton County, Southern Ontario
Mining Division

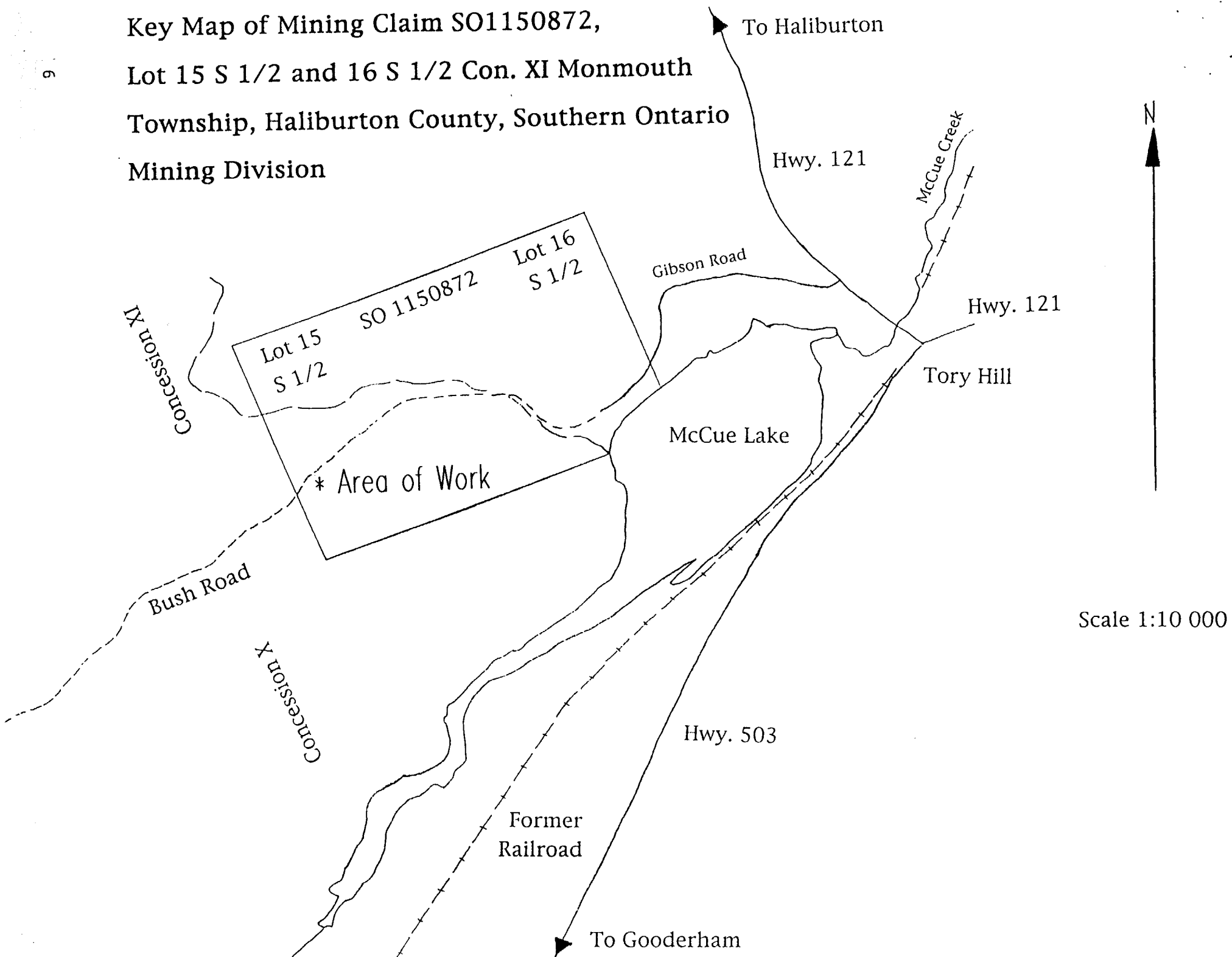

Scale 1:10 000

1.5 PHYSIOGRAPHY, VEGETATION AND WILDLIFE

The property consists of land with moderate relief. Low areas are swampy and the property borders McCue Lake at the southeastern corner. An intermittent stream crosses the property from the northwest to the southeast corner exiting into McCue Lake. The lowest elevation on the property is along the southeastern corner (approximately 370 metres). The highest elevation is along the northern boundary of the property where an east-northeast trending ridge occurs. This ridge has an elevation of approximately 440 metres.

The property is tree covered. The trees are primarily hardwoods consisting mostly of small to medium sized maple. Spruce and cedar occupy low areas. The spruce are commonly 6 to 10 feet high and very abundant, obscuring the geology, pits, trenches and the adit.

Black bear, deer, ruffed grouse and blue jays have been encountered on the property by Sharpmin Developments Incorporated personnel in the past. During this work nothing was observed but ruffed grouse were heard drumming.

The climate is typical of south-central Ontario with warm relatively dry summers and mild accumulations of snow in the winters.

1.6 HISTORY AND PREVIOUS WORK

The mining claim contains several pits and trenches. These were excavated around the turn of the century during exploration for phosphate.

In the southwest corner of the property there are several pits, trenches and an adit. The adit has been driven 30 feet north into the side of a hill (Satterly, 1943, p. 20; Armstrong and Gittins, 1968).

In 1976 Imperial Oil Limited conducted a geological and radiometric survey for uranium which included Lot 15, Concession XI (Lowe, 1977).

Sharpmin Developments Incorporated performed minor assessment work between July 28 and August 8, 1993. This work consisted of minor excavation and geological sampling. They also prepared a geological report for part of the property in August 1994.

No additional assessment files were found on record at the Ministry of Northern Development and Mines, Mines Library, 2nd floor, MacDonald Block, Toronto.

There has been considerable unrecorded overburden stripping and bedrock trenching (some trenches of considerable size) done by mineral collectors in recent years. Work done by mineral collectors has included the use of portable drills and explosives.

In addition to the above work, there are several references to the property in published literature which are summarized as follows:

Satterly (1943) describes previous work performed on the property.

Hewitt (1967) summarizes Satterly (1943).

Armstrong and Gittins (1968) reprint Satterly's description.

Hewitt (1969) gives directions to the showing and shows its location on a small, simplified regional geology map.

Bancroft Chamber of Commerce (1982) gives directions and lists minerals.

Sabina (1986) gives directions to the site describes the workings and associated minerals.

Trueman (1993) summarizes the Bancroft Chamber of Commerce (1982) and Sabina (1986).

GEOLOGY AND OBSERVATIONS

2.1 REGIONAL GEOLOGY

The mining claim is located in the Bancroft Terrane of the Central Metasedimentary Belt of the Grenville Structural Province. Most of the Bancroft Terrane has been subjected to middle to upper amphibolite facies metamorphism (Easton, 1992).

2.2 LOCAL GEOLOGY

Rock exposure on the property is poor, with few outcrops which are of small size. In addition, rock exposure at the showings is poor as the showings are overgrown and any exposed rock is generally heavily stained or moss-, lichen-, or soil-covered.

Country rocks exposed at surface on the property consist of quartzite, marble, syenite (possibly a feldspar rich metasedimentary rock or a fenitized rock rather than a true igneous syenite), amphibolite and feldspathic gneiss.

Several coarsely crystalline calcite veins containing large anhedral to euhedral crystals of biotite, hornblende, microcline, apatite and minor quartz occur on the property. In addition to these minerals, Sabina (1986) reports thorite, thorianite, uranophane, serpentine, pyroxene and chondrodite for the property. These minerals weren't found during the present survey and Sabina does not describe their occurrence so it is unknown if these minerals occur in the calcite veins. The calcite veins strike northwest and dip steeply, crosscutting the foliation of the country rocks. Most of the veins are narrow in width but some are several feet in width.

CONCLUSIONS AND RECOMMENDATIONS

The trenches, pits and adit on the property are overgrown and obscured by staining, moss and rock and soil debris. They need to be cleaned, brush in the vicinity of the showings needs to be cut, overburden stripped, and bedrock trenching done to allow examination of the mineralization. The work done during this exploration was done on one trench. It revealed additional information about part of one vein. It is recommended that detailed geological mapping and lithogeochemical sampling be done on the exposed portion of the vein. As well, additional 'clean up work' needs to be done on this vein and other veins.

REFERENCES

- Armstrong, H.S. and J. Gittins (1968) Geology of Glamorgan and Monmouth Townships, Haliburton County. Ontario Department of Mines, Open File Report No. 5021, p. 111-112
- Bancroft Chamber of Commerce (1982) Bancroft's Guide to Rockhounding, p. 12.
- Easton, R. M. (1992) The Grenville Province and the Proterozoic History of Central and Southern Ontario; *in* Geology of Ontario. Ontario Geological Survey, Special Volume 4, part 2, p. 714-904.
- Hewitt, D. F. (1969) Geology and Scenery, Peterborough, Bancroft and Madoc Area; Ontario Deptment of Mines, Geology Guide Book 3, p. 56, 61.
- (1967) Phosphate in Canada. Ontario Department of Mines, Mineral Resources Circular No. 6, p. 42.
- Lowe, B. (1977) Geological and Radiometric Surveys of Claims E.O. 460880 to 460883 inclusive E.O. 463209 to 463216 inclusive, Monmouth Township, Ontario. Imperial Oil Limited, Toronto, Ontario
- Sabina, A. P. (1986) Rocks and Minerals for the Collector: Bancroft - Parry Sound area and Southern Ontario. Geological Survey of Canada, Miscellaneous Report 39, p. 57-59.
- Satterly, J. (1943) Mineral Occurences in the Haliburton Area. Ontario Department of Mines, Annual Report Volume LII, Part II, p. 20.
- Trueman, B., (1993) A Rockhound's Paradise 1; Bancroft and Region. WVEC, North York, Ontario.

STATEMENT OF COST

Labour	
S. Harper, Hon. B. Sc., M. Sc. Cand., geologist, 5.5 days @ \$150/day	\$825
R. Franklin, assistant, 5.5 days @ \$150/day	825
M. Harper, assistant, 1 day @ \$150/day	150
K. Fyffe, assisstant, 1 day @ \$150/day	150
Accomodation and Food	
5.5 days @ \$40/day/person	520
Travel	
vehicle and fuel, 5.5 days @\$60/day	330
Pionjar 120, drill steels, wedges, fuel, 3 days@\$150/day	450
ATV and trailer 2 days @\$300/day	600
additional vehicle, 1 day@\$60/day	60
Report Preparation	
0.5 days @\$200/day	100
Total Cost of Exploration and Travel	\$4010

DATES OF EXPLORATION ACTIVITY

DATE	PERSONNEL
April 4, 1998 Half Day	S. Harper, R. Franklin
April 5, 1998	S. Harper, R. Franklin
April 6, 1998	S. Harper, R. Franklin
April 7, 1998	S. Harper, R. Franklin
April 8, 1998 Half Day	S. Harper, R. Franklin
April 11, 1998 Half Day	S. Harper, R. Franklin
April 12, 1998	S. Harper, R. Franklin, M. Harper, K. Fyffe

SHARPMIN DEVELOPMENTS INCORPORATED

Suite 407, 153 St. George Street, Toronto, Ontario, CANADA M5R 2L9
Telephone (416) 712-2738, FAX (416) 968-0094 (9AM to 5PM ONLY)

This may contain PRIVILEGED AND CONFIDENTIAL INFORMATION intended for the addressee. If you are not the addressee or someone responsible for delivering it to the addressee, you are hereby notified that any dissemination or copying of this is strictly prohibited. If you have received this in error, please notify us immediately by telephone for further instructions. Thank you.

NUMBER OF PAGES, INCLUDING THIS PAGE: 4, IN DUPLICATE

ATTENTION: Geoscience Assessment Office

933 Ramsey Lake Road

6th Floor

Sudbury, Ontario

P3E 6B5

Telephone 888-415-9846, or 705-670-5858 (Lucille Jerome)

Fax 705-670-5881

REGARDING: TRANSACTION NUMBER W9890.00015, SUBMISSION NUMBER 2.18426
August 27, 1998

Dear Sir/Madam,

- 1) Please find following maps for the above transaction number.
- 2) The work consisting of cleaning part of an old trench, and work along the strike of the vein to reveal the vein contact (minor stripping and trenching) **WAS DONE OVER A DISTANCE OF APPROXIMATELY 30 FEET (9.1 METRES) BY 10 FEET (3.0 METRES).**
- 3) The nature of the rocks and mineralization exposed was in the submitted report, "The work done revealed the vein to consist of areas of massive, coarse grained anhedral to subhedral black to green amphibole, massive coarse grained anhedral white calcite, massive medium grained anhedral reddish apatite, and rarely pinkish subhedral to euhedral microcline that ranged up to a few inches in size. The country rock consisted of grey colored massive, banded quartzite. The northern vein contact was discovered and exposed. The vein dipped vertical in the exposed area. The strike of the vein was not measured at this time. The vein is at least 10 feet wide, however, the southern vein contact was not found so the vein could be substantially wider."
- 4) No sampling was done at the time. Sampling and additional work may be done in the future.
- 5) A graphic and/or a bar scale are on the following maps. The north direction are on the maps, with the sketch map of Area of Work having a Magnetic North.

Respectfully,

Scott Harper

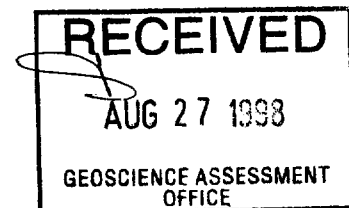

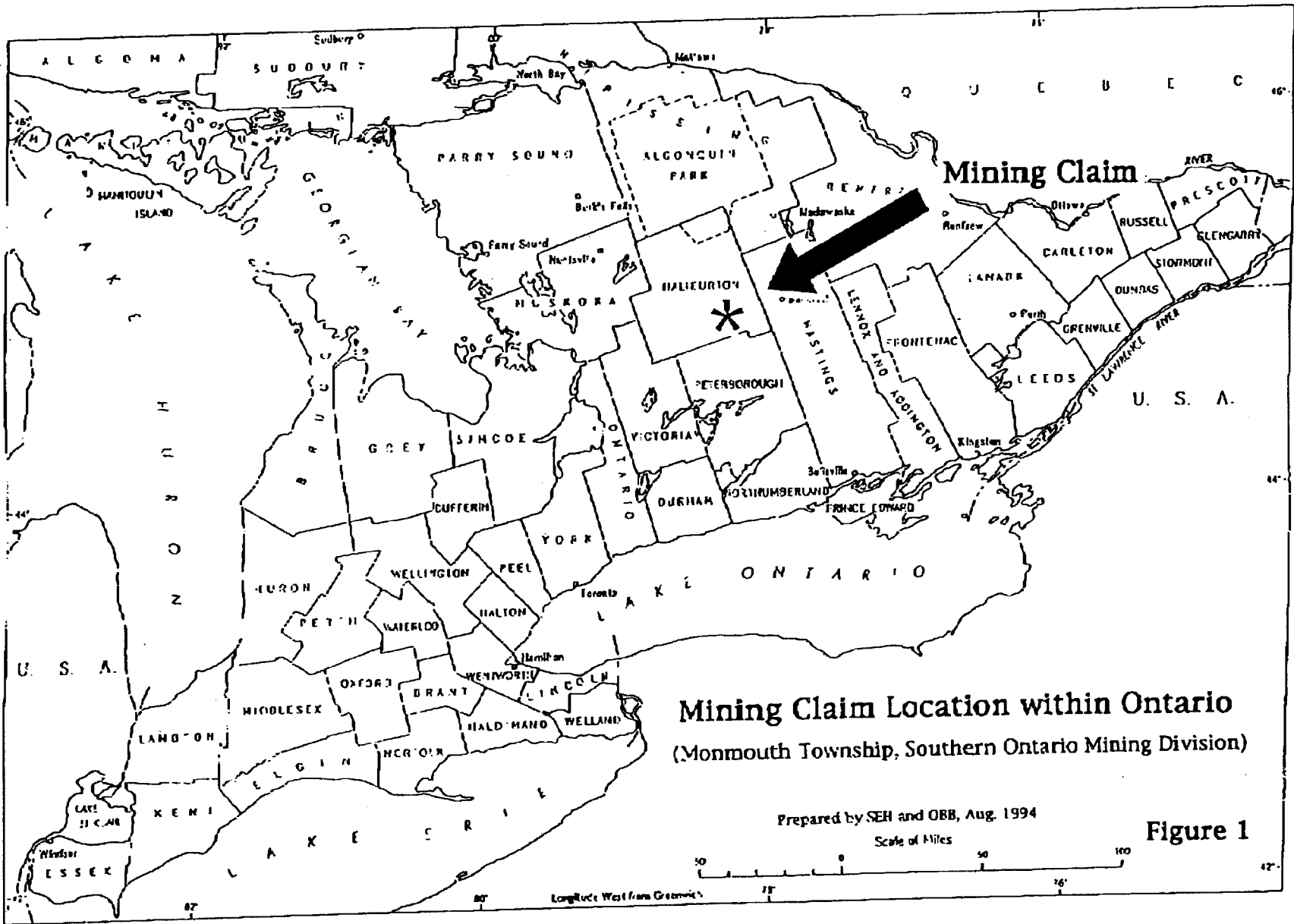

Mining Claim Location within Ontario
 (Monmouth Township, Southern Ontario Mining Division)

Prepared by SEH and OBB, Aug. 1994

Scale of Miles

Figure 1

Key Map of Mining Claim SO1150872,
Lot 15 S 1/2 and 16 S 1/2 Con. XI Monmouth
Township, Haliburton County, Southern Ontario
Mining Division

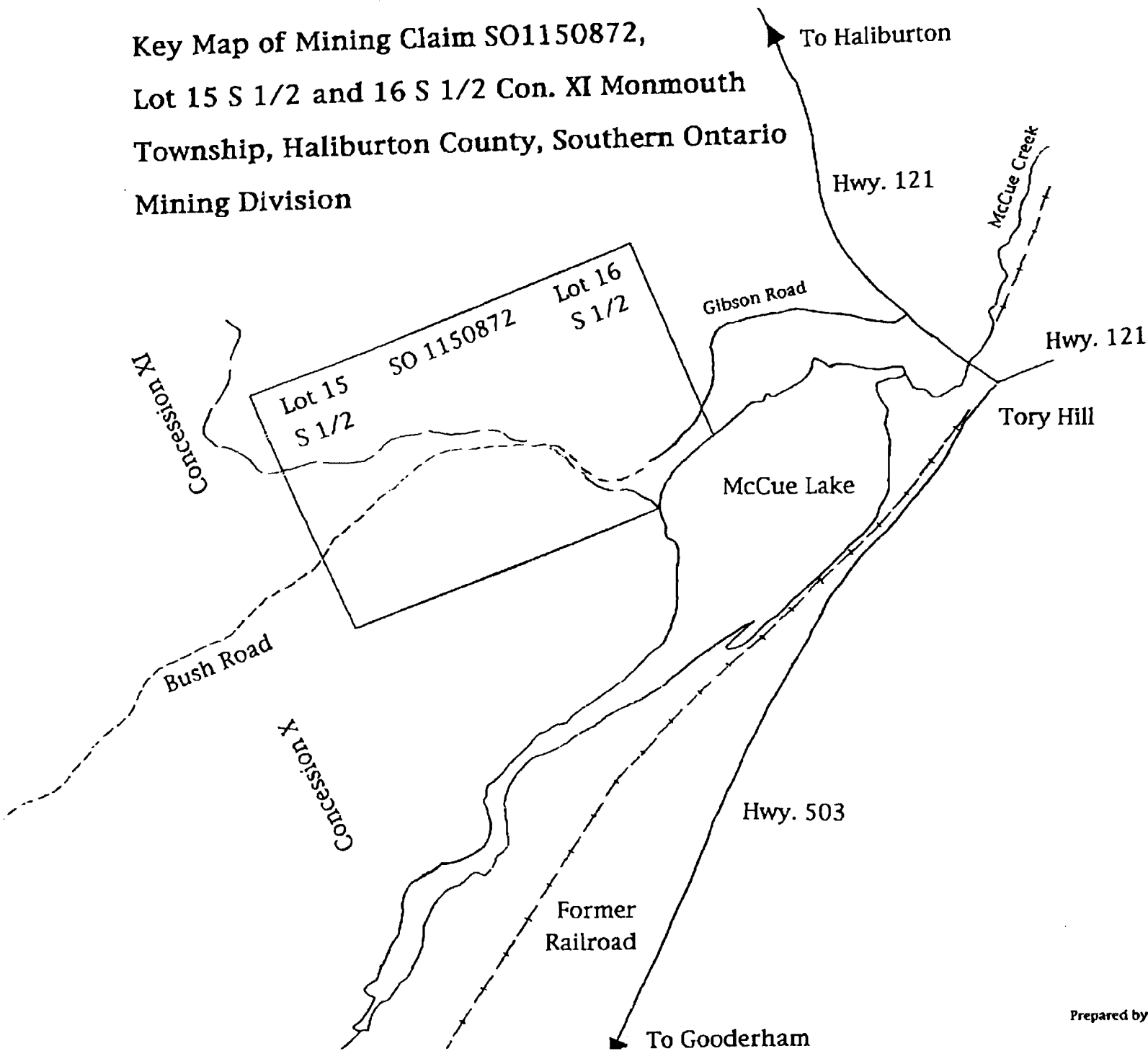

Scale 1:10

Prepared by OBB and SEH, Aug. 1994

AUG 27 '98 13:55

416 968 0094

PAGE: 07

FROM : FORBES ENG'G

PHONE NO. : 416 968 0094

P07

Monmouth Township
Scale 1:5000

Magnetic North

Lot 16

Lot 15

Mining Claim 1150872

Trail

Most Work Done Here

Area of Stripping and Trenching

MCC

McCue Lake



Ministry of
Northern Development
and Mines

Declaration of Assessment Work Performed on Mining Land

Transaction Number (office use) W9890.00015
Assessment Files Research Imaging



31D16NW2001 2.18426 MONMOUTH

900

Sections 65(2) and 66(3) of the Mining Act. Under section 8 of the Mining Act, this report work and correspond with the mining land holder. Questions about this collection report and Mines, 3rd Floor, 933 Ramsey Lake Road, Sudbury, Ontario, P3E 8B5.

Instructions: - For work performed on Crown Lands before recording a claim, use form 0240.
- Please type or print in ink.

2.18426

1. Recorded holder(s) (Attach a list if necessary)

Name <i>Sharpmin Developments Incorporated</i>	Client Number <i>294139</i>
Address <i>407-153 St. George St. Toronto, Ontario M5R 2L9</i>	Telephone Number <i>416-412-2738</i>
	Fax Number
Name	Client Number
Address	Telephone Number
	Fax Number

2. Type of work performed: Check (✓) and report on only ONE of the following groups for this declaration.

Geotechnical: prospecting, surveys, assays and work under section 18 (regs) Physical: drilling stripping, trenching and associated assays Rehabilitation

Work Type <i>Trenching</i>	Office Use
	Commodity
	Total \$ Value of Work Claimed <i>4,010</i>
Dates Work Performed From <i>April 4, 1998</i> To <i>April 12, 1998</i>	NTS Reference
Global Positioning System Data (if available)	Mining Division <i>Southern Ontario</i>
Township/Area <i>Monmouth</i>	Resident Geologist District <i>Tuxedo</i>
M or G-Plan Number	

Please remember to: - obtain a work permit from the Ministry of Natural Resources as required;
- provide proper notice to surface rights holders before starting work;
- complete and attach a Statement of Costs, form 0212;
- provide a map showing contiguous mining lands that are linked for assigning work;
- include two copies of your technical report.

3. Person or companies who prepared the technical report (Attach a list if necessary)

Name <i>S. Harper</i>	Telephone Number
Address <i>As Above</i>	Fax Number
Name	Telephone Number
Address	Fax Number
Name	Telephone Number
Address	Fax Number

4. Certification by Recorded Holder or Agent

I, *S. Harper* (Print Name), do hereby certify that I have personal knowledge of the facts set forth in this Declaration of Assessment Work having caused the work to be performed or witnessed the same during or after its completion and, to the best of my knowledge, the annexed report is true.

Signature of Recorded Holder or Agent <i>S Harper</i>	Date <i>Apr 21, 1998</i>
Agent's Address <i>As Above</i>	Telephone Number
	Fax Number

0241 (03/97)

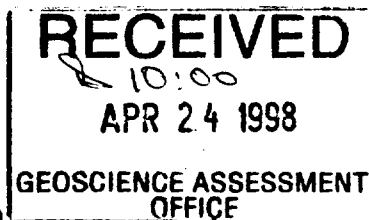
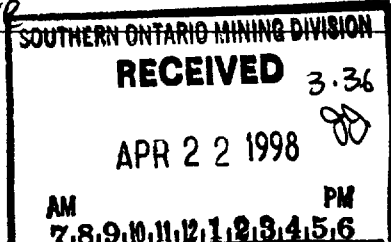

Deemed July 21/98

5. Work to be recorded and distributed. Work can only be assigned to claims that are contiguous (adjoining) to the mining land where work was performed, at the time work was performed. A map showing the contiguous link must accompany this form.

W9890.00015

Mining Claim Number. Of work done on other eligible mining land, show in this column the location number indicated on the claim map.	Number of Claim Units. For other mining land, list hectares.	Value of work performed on this claim or other mining land.	Value of work applied to this claim.	Value of work assigned to other mining claims.	Bank. Value of work to be distributed at a future date
eg TB 7827	18 ha	\$28,825	N/A	\$24,000	\$2,825
eg 1234567	12	0	\$24,000	0	0
eg 1234568	2	\$ 8,892	\$ 4,000	0	\$4,892
1 SO 1150972	2	\$4010	\$3681	0	\$329
2					
3					
4					
5					
6					
7					
8					
9					
10					
11					
12					
13					
14					
15					
Column Totals					

I, S. Harper (Print Full Name), do hereby certify that the above work credits are eligible under subsection 7 (1) of the Assessment Work Regulation 6/96 for assignment to contiguous claims or for application to the claim where the work was done.

Signature of Record Holder or Agent Authorized in Writing: S. Harper Date: Apr 27/98

6. Instructions for cutting back credits that are not approved.

Some of the credits claimed in this declaration may be cut back. Please check (✓) in the boxes below to show how you wish to prioritize the deletion of credits:

- 1. Credits are to be cut back from the Bank first, followed by option 2 or 3 or 4 as indicated.
- 2. Credits are to be cut back starting with the claims listed last, working backwards; or
- 3. Credits are to be cut back equally over all claims listed in this declaration; or
- 4. Credits are to be cut back as prioritized on the attached appendix or as follows (describe):

Note: If you have not indicated how your credits are to be deleted, credits will be cut back from the Bank first, followed by option number 2 if necessary.

For Office Use Only.

Received Stamp

RECEIVED
MAY - 1 1998
GEOSCIENCE ASSESSMENT OFFICE

Deemed Approved Date	Date Notification Sent
Date Approved	Total Value of Credit Approved
Approved for Recording by Mining Recorder (Signature)	

0241 (03/87)



Personal information collected on this form is obtained under the authority of subsection 6 (1) of the Assessment Work Regulation 6/96. Under section 8 of the Mining Act, this information is a public record. This information will be used to review the assessment work and correspond with the mining land holder. Questions about this collection should be directed to a Provincial Mining Recorder, Ministry of Northern Development and Mines, 3rd Floor, 933 Ramsey Lake Road, Sudbury, Ontario, P3E 6B5.

2.18426

Table with 4 columns: Work Type, Units of work, Cost Per Unit of work, Total Cost. Rows include Labour, Pioneer 120 drill, ATV + trailer, Associated Costs (Report writing), Transportation Costs (Travel, Additional vehicle), Food and Lodging Costs (Accommodation and Food), and Total Value of Assessment Work (4010).

Calculations of Filing Discounts:

- 1. Work filed within two years of performance is claimed at 100% of the above Total Value of Assessment Work.
2. If work is filed after two years and up to five years after performance, it can only be claimed at 50% of the Total Value of Assessment Work.

TOTAL VALUE OF ASSESSMENT WORK x 0.50 = Total \$ value of worked claimed.

Note:
- Work older than 5 years is not eligible for credit.
- A recorded holder may be required to verify expenditures claimed in this statement of costs within 45 days of a request for verification and/or correction/clarification.

Certification verifying costs:

I, S. Harper, do hereby certify, that the amounts shown are as accurate as may reasonably be determined and the costs were incurred while conducting assessment work on the lands indicated on the accompanying

Declaration of Work form as Agent I am authorized to make this certification. (recorded holder, agent, or state company position with signing authority)

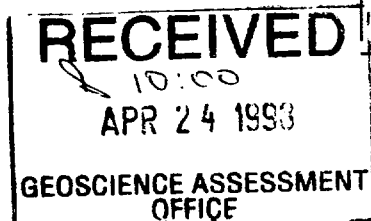

Signature: S. Harper, Date: Apr 21/98

August 28, 1998

S. Harper
SHARPMIN DEVELOPMENTS INCORPORATED
407-153 ST. GEORGE STREET
TORONTO, ONTARIO
M5R 2L9

Visit our website at:
www.gov.on.ca/MNDM/MINES/LANDS/mlsmnpge.htm

Dear Sir or Madam:

Submission Number: 2.18426

Status

Subject: Transaction Number(s): W9890.00015 Approval After Notice

We have reviewed your Assessment Work submission with the above noted Transaction Number(s). The attached summary page(s) indicate the results of the review. **WE RECOMMEND YOU READ THIS SUMMARY FOR THE DETAILS PERTAINING TO YOUR ASSESSMENT WORK.**

If the status for a transaction is a 45 Day Notice, the summary will outline the reasons for the notice, and any steps you can take to remedy deficiencies. The 90-day deemed approval provision, subsection 6(7) of the Assessment Work Regulation, will no longer be in effect for assessment work which has received a 45 Day Notice. Allowable changes to your credit distribution can be made by contacting the Geoscience Assessment Office within this 45 Day period, otherwise assessment credit will be cut back and distributed as outlined in Section #6 of the Declaration of Assessment work form.

Please note any revisions must be submitted in DUPLICATE to the Geoscience Assessment Office, by the response date on the summary.

If you have any questions regarding this correspondence, please contact Lucille Jerome by e-mail at jeromel2@epo.gov.on.ca or by telephone at (705) 670-5858.

Yours sincerely,



ORIGINAL SIGNED BY
Blair Kite
Supervisor, Geoscience Assessment Office
Mining Lands Section

Work Report Assessment Results

Submission Number: 2.18426

Date Correspondence Sent: August 28, 1998

Assessor: Lucille Jerome

Transaction Number	First Claim Number	Township(s) / Area(s)	Status	Approval Date
W9890.00015	1150872	MONMOUTH	Approval After Notice	August 28, 1998

Section:

10 Physical PTRNCH

10 Physical PSTRIP

The map provided serves well as a location map, however, all future physical work submissions must contain the following information on a detail map in order to receive assessment work credit:

- i) the dimension of workings, trenches and stripping,
- ii) the nature of the rocks and mineralization exposed,

Correspondence to:

Resident Geologist
Tweed, ON

Recorded Holder(s) and/or Agent(s):

S. Harper
SHARPMIN DEVELOPMENTS INCORPORATED
TORONTO, ONTARIO

Assessment Files Library
Sudbury, ON

C-1538

C-1538

WMT HTUOMOM

WMT HTUOMOM

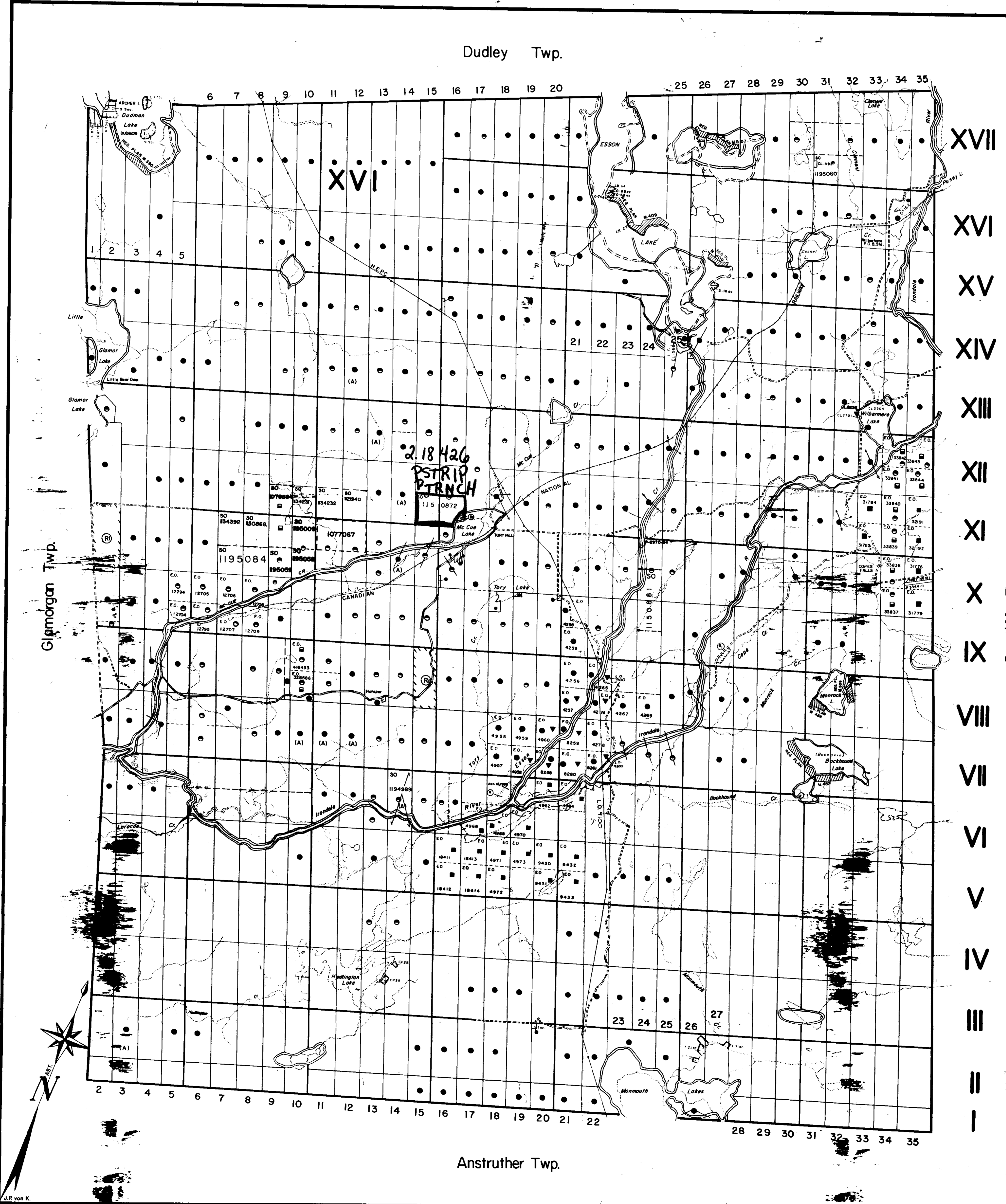

LEGEND

HIGHWAY AND ROUTE No.

OTHER ROADS

TRAILS

SURVEYED LINES: TOWNSHIP, RANGE LINES, ETC. / LOTS, MINING CLAIMS, PARCELS, ETC.

UNSURVEYED LINES: LOT LINES, PARCEL BOUNDARY, MINING CLAIMS ETC.

RAILWAY AND RIGHT OF WAY

UTILITY LINES

NON-PERENNIAL STREAM

FLOODING OR FLOODING RIGHTS

SUBDIVISION OR COMPOSITE PLAN

RESERVATIONS

ORIGINAL SHORELINE

MARSH OR MUSKEG

MINES

TRAVERSE MONUMENT

DISPOSITION OF CROWN LANDS

TYPE OF DOCUMENT	SYMBOL
PATENT, SURFACE & MINING RIGHTS	
SURFACE RIGHTS ONLY	
MINING RIGHTS ONLY	
LEASE, SURFACE & MINING RIGHTS	
SURFACE RIGHTS ONLY	
MINING RIGHTS ONLY	
LICENCE OF OCCUPATION	
ORDER-IN-COUNCIL	
RESERVATION	
CANCELLED	
SAND & GRAVEL	
LAND ACQUISITION	

SCALE: 1 INCH = 40 CHAINS

NOTES

This Map Is Not To Be Used FOR SURVEY PURPOSES

Original shoreline shown thus:

F.R.I. shoreline shown thus:

Patents Map shoreline shown thus:

For status of summer resort locations shown thus:

Please contact Ministry of Natural Resources.

GRAVEL AND SAND

DATE OF ISSUE

JUN 22 1988

PROVINCIAL RECORDING OFFICE - SUDBURY

AREAS WITHDRAWN FROM DISPOSITION

M.R.O. - MINING RIGHTS ONLY

S.R.O. - SURFACE RIGHTS ONLY

M + S - MINING AND SURFACE RIGHTS

Description	Order No.	Date	Disposition	File
SEC. 35/79	W-30-89/96	85/02/28	S.R.O.	19550

THE INFORMATION THAT APPEARS ON THIS MAP HAS BEEN COMPILED FROM VARIOUS SOURCES AND ACCURACY IS NOT GUARANTEED. THOSE WISHING TO STATE MINING CLAIMS SHOULD CONSULT WITH THE MINING RECORDER, MINISTRY OF NORTHERN DEVELOPMENT AND MINES, FOR ADDITIONAL INFORMATION ON THE STATUS OF THE LANDS SHOWN HEREON.

400' SURFACE RIGHTS RESERVATION AROUND ALL THE LAKES AND RIVERS

SEC. 35/90 W-30-81/94 27/05/94 M.R.O. 19550

TOWNSHIP

MONMOUTH

M.N.R. ADMINISTRATIVE DISTRICT

MINDEN

MINING DIVISION

SOUTHERN ONTARIO

LAND TITLES / REGISTRY DIVISION

HALIBURTON

Ministry of Natural Resources Ontario

Ministry of Northern Development and Mines

DATE: FEBRUARY, 1987

Number: **G-1298**

XVII
XVI
XV
XIV
XIII
XII
XI
X
IX
VIII
VII
VI
V
IV
III
II
I

C-1538

C-1538

