



**ONTARIO PROSPI
FINAL SUBMISSN**



010

INSTRUCTIONS: Please read the guidebook before completing form Please type or print
Submit completed form and supporting documentation by January 31, 1995 (May 31, 1995 for winter program) to:
Incentives Office (Mining and Land Management Branch)
Ministry of Northern Development & Mines
5th Floor, 933 Ramsey lake Rd., Sudbury, Ontario P3E 6B5

TO BE COMPLETED BY SUCCESSFUL GRANTEES AFTER PROJECT COMPLETION AND ACCOMPANIED BY WRITTEN REPORTS, MAPS, ETC.

Applicant Bert Wickern Regular Project Winter Project
File Number 94-409

Proposed project area(s) (Twp. or claim map name, latitude and longitude) Completed?
1. Ryerson Twp., District of Parry Sound Yes No
Claim No.: SO 1091690, SO 1091691, SO 1092177 & SO 1092178
2. _____ Yes No

Changes to proposed project(s) (if any)
As reported to the Incentives Office, extra time was spent prospecting for Specialty Aggregates, sample removal and laboratory testing. Test results of these are very good so far. The Values and Assays of 100 pounds (fist-size) samples, submitted to M.T.O. and U.ofT. are enclose
List other co-owners of the property with OPAP grants that worked on project

I. WORK PERFORMED BY APPLICANT (Summary of Section IV)

1. Project #1 area/name Ryerson Twp., District of Parry Sound, No. days worked by applicant
Claims: SO 1091690, SO 1091691, SO 1092177 & SO 1092178

Traditional prospecting No. of samples 83 (that's only you) 15
Geological surveys Scale _____
Geophysical surveys Type _____ Miles/km _____
Geochemical surveys Type _____ No. of samples _____
Drilling Type Punjar (Gas) Ft./m 210 Ft. 5
Stripping/Trenching Method Manual, Pick & Shovel, Backhoe, wash with high-pressure Pump 24
Other Type Chainsaw ahead of hydraulic Backhoe, gravel & extend access trails, strip, measure joint spacing. 16
TOTAL 60

Form filled out by Applicant Other (please specify) _____
Report prepared by Applicant Other (please specify) _____

I. WORK PERFORMED BY APPLICANT (Continued)

2. Project #2 area/name _____		No. days worked by applicant
Traditional prospecting	No. of samples _____	_____
Geological surveys	Scale _____	_____
Geophysical surveys	Type _____ Miles/km _____	_____
Geochemical surveys	Type _____ No. of samples _____	_____
Drilling	Type _____ Ft./m _____	_____
Stripping/Trenching	Method _____	_____
Other	Type _____	_____
	TOTAL	_____
TOTAL DAYS (ALL PROJECTS)	A.	60
(Attach additional sheets for additional project areas as required)		

II. EXPENDITURES (total of all projects) - Summary of I and II

1. Number of working days by applicant	60 Days	
(A) x \$100/day		\$ <u>6000.--</u>
2. Number of report preparation days by applicant x \$100/day		\$ <u>200.--</u>
3. Analyses/Assay costs	cut & polish samples, assays	\$ <u>556.--</u>
4. Equipment rentals/supplies (specify)		
Compressor, Duro-Pump, Hoses,	\$ _____	
16" McCulloch Chainsaw	\$ _____	\$ <u>837.--</u>
.....	\$ _____	
5. Contract services (state type)	Geologist,	
450E John Deere Tractor, operated,	\$ _____	3,082
450C Hydraulic Backhoe, Truck,	\$ _____	2602.--
Rubber-Tired Backhoe, operated	\$ _____	
.....	\$ _____	
6. Travel (state method: road, air, etc.)		
Road, Gas & Oil	\$ _____	\$ <u>492.--</u>
.....	\$ _____	
.....	\$ _____	
7. Food and Accommodation	Groceries, Propane for Camper	\$ <u>570.--</u>
8. Other expenses (specify, e.g. helpers)		
Explosives, Caps	\$ <u>83.00</u>	\$ <u>83.--</u>
.....	\$ _____	
.....	\$ _____	
		11,820.--
TOTAL EXPENDITURES		\$ <u>11,340.--</u>

V. SIGNIFICANT RESULTS (please complete)

Project Area	New Showings and/or Anomalies	Commodity	Best Analyses
Everson TWP., Claim SO1091691, Sample No. 31A, small Block cut yielded an attractive, silvery textured in black, decorative architectural Building Tile. Claim SO 1092177 (Leased), Sample No.s 96, 30A and 92 (shown on enclosed Maps) were found suitable for Rip-Rap (Roofing), Freeze Thaw Loss Value of 1, Lab.No. 94-B-0089 is excellent. Laboratory test results enclosed with this report.			
Claim No. SO 1092177, 96A and 96B, Amphibolite, stripping reveals favourable joint-patterns for Block removal.			

No further claims staked

VII. OPTION AGREEMENTS RESULTING FROM OPAP PROJECT (please complete)

Optionee	Property/Claims	Dollar Value of Work Commitment
Samples of gneissic granite of three different colours and patterns are being made available to interested Granite Processors, now. We are also in the process of testing slip-resistant Meta Gabros and gneissic equivalents.		

The Ministry of Northern Development and Mines may verify all statements related to and made herein this application.

1. I am the person named in the Final Submission Form under the Ontario Prospectors Assistance Program.
2. I am ordinarily a resident of Canada.
3. I have complied with all the requirements of the said program.
4. I understand that it is an offence under the Ontario Mineral Exploration Act, R.S.O. 1990, to make a false or misleading statement and that all statements and all other information submitted in support of the said application are true and correct.
5. I was not employed by the Ministry while in receipt of the OPAP grant.
6. I am not the spouse, child, sibling or parent of a Ministry employee.
7. I am aware that any other Provincial or Federal Government financial assistance received for said application will be deducted from the amount of incurred "Total Eligible Expenses".

It is an Offence under subsection 8(1)(A) of the Ontario Mineral Exploration Act, R.S.O. 1990 to knowingly furnish false or misleading information.

Personal information on this form is obtained under the authority of the Ontario Mineral Exploration Act, R.S.O. 1990 sections 2, 3 and 4 and the Ontario Prospectors Assistance Program Regulation, sections 4, 5 and 6. The financial and technical information will be used for the purpose of determining the eligibility of the applicant to

have a program designated for financial assistance and the amount of such assistance. Other information such as statistical information about the individual projects will be used for the purpose of determining the overall effectiveness of the program. It may be disclosed for those purposes and I consent to its disclosure for such

purposes. Questions about this collection should be directed to Supervisor, Incentives Office, Mining and Land Management Branch, Ministry of Northern Development and Mines, 5th Floor, 933 Ramsay Lake Road, Sudbury, Ontario P3E 6B5, Toll free 1-800-265-0834

Signature of Applicant *Bert Wickern*

Date JANUARY 18, 1995

Name (print) Bert Wickern, Apt. 706, 1305 Wilson Ave., Toronto, Ont., M3M 1J2



ONTARIO PROSPECTORS' ASSISTANCE PROGRAM (OPAP) REGULATIONS

Regulation 887, R.R.O. 1990

1. In this Regulation,

"designated" means designated by the Minister under subsection 3 (3);

"eligible exploration expenses" means expenses allowed under section 5. O. Reg. 559/89, s. 1.

2. For the purposes of this Regulation, a prescribed mineral resource is any rock, mineral or composite of minerals other than crushed rock used for construction purposes, sand, gravel, natural gas and petroleum. O. Reg. 559/89, s. 2.

3.—(1) In this section,

"associate", where used to indicate a relationship with any person, means,

- (a) a corporation of which the person beneficially owns, directly or indirectly, equity shares carrying more than 30 per cent of the voting rights attached to all outstanding equity shares of the corporation,
- (b) a partner other than a joint venture partner with respect to a proposed project under this Regulation,
- (c) a trust or estate in which the person has a beneficial interest of more than 30 per cent or serves as trustee or in a similar capacity,
- (d) parent, child, brother or sister of the person,
- (e) a person of the opposite sex to whom the person is married or with whom the person is living in a conjugal relationship outside marriage, or
- (f) any other relative of the person or of a person mentioned in clause (e) who has the same home as the person.

"equity share" means a share of any class of shares of a corporation carrying voting rights under all circumstances and a share of any class of shares carrying voting rights by reason of the occurrence of any contingency that is continuing;

"person" means

- (a) an individual, partnership or limited partnership,
- (b) an unincorporated association, syndicate or organization,
- (c) a trust, trustee, executor, administrator or other legal representative, or

(d) a corporation,

(2) An individual who proposes to carry out a project of exploration in Ontario may apply for designation of the project on a form to be provided by the Minister. O. Reg. 559/89, s. 3(1,2).

(3) Subject to subsection (4), the Minister may designate a project if,

- (a) the application is submitted before eligible exploration expenses are incurred on the project;
- (b) the applicant has the legal right to perform exploration on the land on which the project is to be carried out;
- (c) the applicant has provided evidence of having sound knowledge of mineral prospecting technology obtained through experience or training;
- (d) the applicant is committing sufficient financial resources to ensure the completion of the project;
- (e) the applicant clearly specifies the method of carrying out the project and demonstrates that the method meets appropriate exploration standards; and
- (f) where the work consists of prospecting on Crown land, the applicant holds a valid Ontario Prospectors' Licence. O. Reg. 559/89, s. 3(3); O. Reg. 532/90, s. 1.

(4) A project is not eligible to be designated if the applicant is,

- (a) regularly entitled to receive proceeds from the output of a mine anywhere in the world, other than a royalty; or
- (b) an associate of any person who is regularly entitled to receive proceeds from the output of a mine anywhere in the world, other than a royalty.

(5) Subject to subsection (6) only one application for designation may be submitted for each proposed project.

(6) Two or more individuals may apply for separate designations of a proposed project if,

- (a) the work consists of prospecting on Crown land; or
- (b) the work consists of prospecting on land in respect of which they are the co-holders of the mining rights.

(7) A proposed project may consist of work to be carried out in more than one geographical area.

(8) A designation under subsection (3) expires on the date specified therein.

(9) At the time a project is designated, the Minister may pay to the applicant an amount equal to one-half of the proposed eligible exploration expenses, up to the maximum set out in section 8. O. Reg. 559/89, s. 3(4-9)

4. (1) An individual whose project has been designated shall, before the expiry of the designa-

tion, submit a final submission on a form to be provided by the Minister. O. Reg. 559/89, s. 5(9); 89, s. 4(1); O. Reg. 532/90, s. 2(1)

(2) Upon the filing of a final submission, the Minister may, subject to section 8, pay to the applicant a grant equal to the amount of eligible exploration expenses incurred in respect of the project, less the amount paid to the applicant under subsection 3 (9). O. Reg. 559/89, s. 4(2); O. Reg. 532/90, s. 2(2)

(3) If a final submission is not submitted before the expiry of the designation of a project,

- (a) the amount paid under subsection 3 (9) shall be returned to the Minister; and
- (b) no further amounts are payable in respect of the designated project. O. Reg. 559/89, s. 4(3); O. Reg. 532/90, s. 2(3)

5.—(1) Subject to subsection (2), eligible exploration expenses consist of,

- (a) the expenses for services, personnel, supplies, accommodation, machinery rental and transportation of personnel, supplies and machinery incurred under a designated project with respect to,
 - (i) prospecting on the property, if such activity includes the preparation of a report and a map showing traverses and observations made,
 - (ii) geotechnical surveys, including ground or airborne geophysical surveys, geological surveys and geochemical surveys, including overburden test drilling, if such activities include the preparation of maps and reports,
 - (iii) the establishment of a grid by line cutting, including picketing and chaining, or by compass line and flagging, where dictated by circumstances, if the grid established is used to carry out a survey,
 - (iv) stripping, trenching and the taking of samples, if such activities include the preparation of plans and reports,
 - (v) assays and analyses, if such activities include the preparation of maps and reports and the submission of assay or geochemical certificates, and
 - (vi) surface drilling for exploration purposes only, including mobilization, demobilization and core logging and the preparation of plans, sections, drill logs and reports;

(b) a daily allowance of \$100 for the time spent by an applicant working on a designated project, if a daily log outlining the applicant's work activity is submitted.

(2) In calculating eligible exploration expenses,

III. DETAILED LIST OF EXPENDITURES (Summarize in Section II)

Date	Recipient of Payment	Explanation	Amount
MAY 14, 94	ESSO, HUNTSVILLE	GAS	30.00
MAY 15, 94	A & P, HUNTSVILLE	FOOD	34.00
MAY 15, 94	MAKI, SPRUCEDALE	PROPANE FOR CAMPER	20.00
MAY 17, 94	KIDD HARDWARE	SUNDRIDGE, EXPLOSIVES, CAPS	63.00
MAY 17, 94	ESSO, SUNDRIDGE	GAS	25.00
MAY 20, 94	TOVI RENTAL	RENT 16" CHAINSAW	59.00
MAY 22, 94	VALUE-MART, BURKS FALLS	FOOD	32.00
MAY 22, 94	SHELL, BURKS FALLS	GAS	20.00
MAY 24, 94	A & P, HUNTSVILLE	FOOD	18.00
MAY 24, 94	ESSO, HUNTSVILLE	GAS	30.00
JUNE 12, 94	ESSO, HUNTSVILLE	GAS	25.00
JUNE 12, 94	MAKI, SPRUCEDALE	PROPANE FOR CAMPER	20.00
JUNE 13, 94	VALUE MART BURKS FALLS	FOOD	42.00
JUNE 14, 94	HEDGIE CONTRACTOR	BACK HOE WORK	120.00 ✓
JUNE 16, 94	SHELL, BURKS FALLS	GAS BURKS FALLS	20.00
JUNE 20, 94	A & P, HUNTSVILLE	FOOD	37.00
JUNE 20, 94	ESSO, HUNTSVILLE	GAS	30.00
JUNE 22, 94	GEORGE TAYLOR, U.OFT.	THIN SECTIONS	115.00
JUNE 23, 94	ANDREW ABRAHAM, U.OFT.	PETRO. ANALYSIS	45.00
JUNE 24, 94	ITALIAN MARBLE LTD.	CUT & POLISH SAMPLES	268.00
JUNE 24, 94	H. PRYCHODZKI	TRUCK SAMPLE BLOCK	140.00
JULY 2, 94	ESSO, HUNTSVILLE	GAS SPRUCEDALE, ONT	30.00
JULY 2, 94	A & P, HUNTSVILLE	FOOD	32.00
JULY 3, 94	DURO - PUMP	RENT PUMP & HOSES	60.00
JULY 23, 94	TOVI RENTAL	RENT 16" McCULLOCH CHAINSAW	59.00
JULY 23, 94	WAG, EMSDALE	GAS	32.00
JULY 24, 94	VALUE MART, BURKS FALLS	FOOD	47.00
JULY 24, 94	TOVI RENTAL	ATLAS COPCO COMPRESSOR (GAS)	192.00 ✓
JULY 29, 94	H. PRYCHODZKI	RUBBER TIRE BACK HOE	382.00 ✓
JULY 30, 94	VALUE MART, BURKS FALLS	FOOD	55.00
JULY 30, 94	SHELL BURKS FALLS	GAS	35.00
JULY 31, 94	PROPANE FOR CAMPER MAKI, SPRUCEDALE		20.00
AUGUST 2, 94	WAG, EMSDALE	GAS	30.00
AUGUST 20, 94	ESSO, HUNTSVILLE	GAS	35.00
AUGUST 20, 94	A & P, HUNTSVILLE	FOOD	38.00
AUGUST 20, 94	TOVI RENTAL	ATLAS COPCO COMPRESSOR	96.00 ✓
AUGUST 22, 94	H. PRYCHODZKI	TRUCK SAMPLE BLOCK	140.00
AUGUST 25, 94	VALUE MART, BURKS FALLS	FOOD	41.00
AUGUST 26, 94	H. PRYCHODZKI, CONTRACTOR, JOHN DEERE BACK HOE SPRUCEDALE, ONT.		320.00 ✓

Mileage rate claimed _____ km at 30¢/km for use of own vehicle

CARRY FORWARD: 2857.00
TOTAL _____

Attach additional sheets as required.

PLEASE TURN TO SHEET NO. II :

III. DETAILED LIST OF EXPENDITURES (Summarize in Section II)

Date	Recipient of Payment	Explanation	Amount
CARRY OVER FROM PREVIOUS PAGE TOTAL FORWARD:			2857.00
AUGUST 26, 94	TOVI RENTAL	ATLAS COPCO COMPRESSOR	192.00
AUGUST 26, 94	ESSO, HUNTSVILLE	GAS	35.00
AUGUST 26, 94	MAKI, SPRUCEDALE	PROPANE FOR CAMPER	20.00
AUGUST 28, 94	W. MIDDLE BROOK	SPRUCEDALE, 450E DOZER	440.00
AUGUST 9, 94	U. OF T., TORONTO	CUT & POLISH SAMPLES	128.00
AUGUST 29, 94	DURO PUMP CO.	RENT PUMP & HOSES	60.00
AUGUST 29, 94	TOVI RENTAL	RENT 16" McCULLOCH CHAINSAW	59.00
AUGUST 29, 94	A & P. HUNTSVILLE	FOOD	33.00
AUGUST 29, 94	WAG., EMSDALE	GAS	20.00
AUGUST 30, 94	H. PRYCHODZKI,	JOHN DEERE 460E BACKHOE	220.00
SEPTEMBER 1, 94	W. MIDDLE BROOK,	CONTRACTOR, 450C BACKHOE	200.00
SEPTEMBER 2, 94	DURO PUMP CO.	RENT PUMP & HOSES	30.00
SEPTEMBER 2, 94	VALUE MART	BURKS FALLS, FOOD	40.00
SEPTEMBER 2, 94	ESSO SHELL	BURKS FALLS, GAS	30.00
SEPTEMBER 4, 94	H. PRYCHODZKI,	CONTRACTOR 450C JOHN DEERE SPRUCEDALE	460.00
SEPTEMBER 25, 94	A & P. HUNTSVILLE	FOOD	41.00
SEPTEMBER 25, 94	ESSO, HUNTSVILLE	GAS BURKS FALLS	35.00
SEPTEMBER 26, 94	W. MIDDLE BROOK,	CONTRACTOR, J.D. 450C BACKHOE	180.00
SEPTEMBER 27, 94	DURO PUMP CO.	RENT PUMP & HOSES	30.00
SEPTEMBER 29, 94	WAG., EMSDALE	GAS	30.00

TOTAL: 5140.00

Mileage rate claimed _____ km at 30¢/km for use of own vehicle

TOTAL _____

Attach additional sheets as required.

IV. DAILY REPORTS (Summarize work activity in Section I)

Day	Project Area	Date	Work Performed	Map-Area ID.No.:
1	Claim S01092177 NW710' #2Post	May 14, 94	cut and remove underbrush	96A
2	same area	" 15, 94	strip Amphibole, manual	96A
3	same area	" 16, 94	strip, Pick&Shovel, Cutter	96A
4	same area	" 17, 94	strip, Pick&Shovel, Scraper	96A
5	same area	" 18, 94	remove samples for assay	96A
6	Claim S01092178 NW900' #2Post	" 19, 94	cut and remove underbrush	8
7	same area	" 20, 94	prospect, strip manual	8
8	same area	" 21, 94	prospect, strip manual, cut	8
9	same area	" 22, 94	strip red Orthoclase, manual	8
10	same area	" 24, 94	strip, Pick & Shovel	8
11	same area	" 25, 94	hand-steel, remove samples	8
12	Claim S01091690 NW380' #2Post	June 9, 94	prospect, cut underbrush	04
13	same area	" 10, 94	prospect, strip Meta-Gabro	04
14	same area	" 12, 94	prospect, hand-steel	04
15	same area	" 13, 94	prospect, remove samples	04
16	Claim S01091691 NE430' #3Post	" 14, 94	cut around Backhoe	KS
17	same area	" 15, 94	Pick&Shovel around Backhoe	KS
18	same area	" 16, 94	strip manual, sweep clean	KS
19	same area	" 17, 94	hand-steel, take samples	KS
20	Claim S01091690 N590' #2Post	" 18, 94	prospect, cut underbrush	30
21	same area	" 19, 94	strip Tremolite, manual	19A
22	same area	" 20, 94	hand-steel, sample taken	19A
23	Claim S01092177 W510' #2Post	July 2, 94	strip with Backhoe	30A
24	same area	" 3, 94	clean with Pick&Shovel	30A
25	same area	" 4, 94	wash showing with Duro-Pump	30A
26	Claim S01092177 NE750' #3Post	" 5, 94	Prospect Tremolite/Actinol	19
27	same area	" 6, 94	strip & wash with Duro-Pump	19
28	same area	" 7, 94	strip & Pick & Shovel	92
29	same area	" 8, 94	sample, wash with Duro-Pump	96
30	Claim S01092177 NW830' #2Post	" 23, 94	widen trail with Chainsaw	96A
31	same area	" 24, 94	clear trail for Back-Hoe	96A
32	same area	" 25, 94	use AtlasCopco Compressor	96A
33	same area	" 26, 94	drill&channel (Compressor)	96A
34	same area	" 27, 94	channel-sample (fistsize)	96A
35	Claim S01091691 N800' #3Post	" 28, 94	cut trees around Backhoe	31A
36	same area	" 29, 94	Pick&Shovel around Backhoe	31A
37	same area	" 30, 94	strip Meta-Gabro, Backhoe	31A
38	same area	" 31, 94	hand-steel, remove samples	31A
39	same area, N883' #3Post	August 1, 94	sledge, hand-steel, samples	31A
40	same area	" 2, 94	Pick&Shovel, sample Gabro	31A
41	same area, N830' #3Post	" 21, 94	drill 4' vertical holes	31A

Attach additional sheets as required.

see next sheet, II
please

Sheet IIIV. DAILY REPORTS

Day	Project Area	Date	Work Performed	Map-Area ID.No.
42	Claim S01091691 N830' #3Post	August 27, 94	remove small block, to be cut and polished for samples	31
43	same area	" 23, 94	remove red garnet for assay	19
44	Claim S01092177 W480' #2Post	" 24, 94	prospect pink Albite outcrop	30
45	same area	" 25, 94	cut trees around Backhoe	30
46	same area	" 26, 94	strip with Backhoe and pick	30
47	same area	" 27, 94	drill, hand-steel, channel	30
48	same area	" 28, 94	wash with high pressure pump remove pink Albite samples	30
49	Claim S01092177 NW950' #2Post	" 29, 94	widen trail with chainsaw	96
50	same area	" 30, 94	work with John Deere 450E	96
51	same area	" 31, 94	bulldoze trail to outcrop	96
52	same area	September 1, 94	strip outcrop with Backhoe	96
53	same area	" 2, 94	wash with high-pressure pump	96
54	Claim S01092178 N570' #2Post	" 3, 94	extend trail to showing and widen, with John Deere Dozer	96
55	same area	" 4, 94	strip Amphibole with Backhoe	96
56	same area	" 5, 94	strip with Pick and Shovel	96
57	same area N590' to NW830' #2Post	" 26, 94	strip with J.D.450C Backhoe	96
58	same area	" 27, 94	wash stripped area, Duro Pump	96
59	same area	" 28, 94	hand-steel, take samples	96
60	Claim S01092177 NW950' #2Post	" 29, 94	sledge-hammer and wedges, remove Amphibole samples	96

R E P O R T

December 28, 1994

Township of Rverson, District of Parry Sound,
Claims SO 1092177 (Leased), SO 1091690, SO 1091691 and SO 1092178.
I am pleased to have this opportunity to submit to you this
Report of Prospecting, stripping and Sample removal, activities as
outlined in the detailed Final Submission Form Daily Reports.

While prospecting the above claims, we selected several promising outcrops for stripping. The overburden consists of sandy loam, 6" to 2 Feet approx. overall. To make these working areas accessible, we re-opened old skidding trails of previous logging operations using a John Deere, 450E Bulldozer. We had to rent a 16" McCulloch chainsaw, to cut down and clean obstructing poplar trees. To respect the environment we are happy to clean up worked-over areas as we move along.

We stripped an area 40x18' No.96A, north of No.96, shown on the enclosed location map. The stripped material is a dark green to black Amphibolite, Ca,Fe,Mg composition, with white Plagioclase veinlets and grains, like No.96, "Algonquin Black". This material also takes a high polish. Light reflections from the numerous oriented cleavage surfaces of the crystals produce a sparkling silky luster. The joints pattern favors future block removal. The joint spacing is 2 to 3m. Stripping uncovered some horizontal joints running along the base of the eastern vertical face for approx. 40'.

To the northwest, on Claim SO1092178, approx. 900' NW of No.2 Post, we prospected around the strike of outcrop No.8, a red medium to coarse grained, close to salmon coloured Orthoclase Feldspar Dike. We manually stripped an area of approx. 12' wide by 38' in length by about 3'10" high. Only two fractures were noticed so far. This dike intrudes banded grey to black gneiss, with quartz-feldspar layers throughout. We traced this dike for 180'. More stripping is planned in the spring of next year, as this very attractive feldspar is tough, hardness 6½ to 7. The material is suitable for tiles, slabs, inside and outside covering (Geoscience Laboratories Report).

On Claim SO1091690, prospecting led to the discovery of a 148'x16', 142'x14' and 280'x15' pink Albite and K-feldspar Dike, No.8A. Thin Section Descriptions by Andrew P.G. Abraham, M.Sc., U. of T. are referring to No.8A under the title: Granitic Rock no slide #, please find a copy enclosed with this report. This dike intrudes banded grey to black gneiss, with quartz-feldspar layers throughout. It is located 273'to 843' north/east of the #3 Post, 138'to 154' east of the north/south property line. Only a few vertical fractures were observed while prospecting. This outcrop deserves to be stripped next year. Removed samples were cut and polished. The material is a very attractive pale pink (likely from hematite) and reflecting veinlets and grains of quartz produce a pearly luster.

Also on Claim SO1091690, approx. 190' north/west of the #2 Post, follow-up prospecting led to the discovery of a dark-green to greyish black Meta-Gabro outcrop, No.04. We manually stripped an area here of approx. 22'x 39'. Samples were removed by the hand-steel method for X-ray powder diffraction analysis and thin section petrographic examinations.

see Page II, please

R E P O R T of Prospecting, stripping and sample removal, activities as outlined in the detailed Final Submission Form Daily Reports.

On Claim SO 1091691, 430' north/east of the #3 Post, and another 440' north/east thereof we revisited two previously grab-sampled KS and flagged outcrops of a pale, pink K-feldspar (perthite) granite gneiss. We stripped these outcrops, 20'x24' and 24'x30' respectively with a rubber-tired backhoe and manually with pick and shovel. We also removed samples and had these cut, sawn and polished at the U.of T. for hand-samples to be mailed out to interested people of the industry.

On Claim SO1091600, 500' north of #2 Post, we prospected around two outcrops, No.30 and No.19A, Ca tremolite-actinolite, with some grains of quartz and chlorite and almandine-pyrope garnets. We then stripped the showings, 16'x32' and 9'x30' approx. respectively, manually with pick and shovel. We removed some samples of this attractive, lilac to deep-green material to be test-polished at the U.of T. and we also had thin sections made for spectrographic analysis of the garnets. We are still awaiting some of the results.

On Claim SO1092177 (Leased), 510' west of the #2 Post, we stripped away overburden on the west side of No.30A, using a Backhoe. We then cleaned the showing with Pick and Shovel and washed it with a Duro-highpressure pump, to check for and measure the distance between cracks and fissures. This particular location should be favourable for 1m to 2m Dia. size Block removal.

Also on Claim SO1092177 (Leased), 750' north/east of #3 Post, showing No.19, an area 16'x30' approx. was stripped manually with Pick and Shovel, then washed with a Duro high pressure pump. Samples of a nice deep-green Tremolite-Actinolite were removed, to be sawn and polished for tile samples.

Also on Claim SO1092177 (Leased), approx. 450' west of #2 Post, showings No.92 and No.96 were stripped by us with Pick and Shovel, then washed with a Duro high pressure pump. We removed samples from here, trimmed down to about fist-size, to be submitted later to the M.T.O. as Specialty Aggregates for testing by their laboratory. To be analysed for slip resistance and skid resistance for possible use in HL (hot-laid) highway asphalt. We were granted permission by the Incentives Office, Sudbury, to include prospecting for Specialty Aggregates in the OPAP report this year. Please find up to date test results from the M.T.O. Laboratory and petrographic examination data enclosed with this report.

On Claim SO1092177 (Leased), in a general north/west direction, we re-opened an old skidding trail, using a chainsaw and a John Deere, 450E Bulldozer, to access No.96A, approx. 830' north/west of #2 Post. A dark grey to greenish black Amphibolite Gneiss, fine to medium grain, was channel-sampled by us, using a AtlasCopco compressor. We removed approx. 100 pounds of samples, trimmed to fist-size to be submitted later to M.T.O. for testing by their laboratory.

see Page III, please

R E P O R T of Prospecting, stripping and sample removal, activities as outlined in the detailed Final Submission Form Daily Reports.

Claim S01091691, we cleaned up an old skidding trail with a 16" McCulloch chainsaw and a rubber-tired backhoe to gain access to outcrop No. 31A, a dark green to black coloured Meta-Gabro, fine to medium grained. We stripped an area of approx. 16x30' of what looks like a massive flow tholeiitic basalt-gabro, with the latter being intruded by pink granite pegmatite. We stripped most of the showing with the rubber-tired back-hoe and cleaned up with Pick and Shovel and removed small samples for thin sections. Later we returned to the same showing and removed a small, 3'x2x4' Block, to be cut in to tile samples. The area is located approx. 830' north of the #3 Post, and 180' north of the "new trail" to Beaver Pond, shown on the enclosed Location Map.

Claim S01091691, 520' and 640' north of #3 Post, north and south of the "new trail to Beaver Pond" are two showings No. 17. We prospected this area and stripped and cleaned these two sections, 12'x14' south and 16'x22' north of the "new trail" and removed and flagged samples, clusters of green and red garnets in a greyish, dark green to black, fine grained to brecciated matrix. We had thin sections made at the University of Toronto, to be presented for spectographic analysis. Earlier identifications of pyrope-dominant garnets from the general vicinity of No. 17 made us aware of the various ratios in garnets and other indicator minerals, to be of significance to us. Please find examination results and pertaining descriptions by Dr. Srebrni Petrov, Department of Chemistry, University of Toronto and Robert A. Ramik, Department of Mineralogy, Royal Ontario Museum, Toronto, enclosed for you with this report.

On Claim S01092177, approx. 480' north/west of #2 Post, to access outcrop No. 30B, we reopened an old skidding trail with a 16" McCulloch chainsaw and a 450 John Deere backhoe. We stripped the outcrop, 19'x28', a pink plagioclase feldspar with small specks of black Biotite, fine to medium grained, with the backhoe and pick and shovel. We washed the stripped area with a high-pressure Duro pump, then cut and removed channel samples, using fine-point and broad chisels off a Atlas Copco compressor. We ceased using explosives for dimension-stone sample removal, as it seems to open cracks over some distance, even a small charge could be too much next to where you expect to remove a block. This pink feldspar takes a very high polish, is attractive and would make beautiful counter tops. Hand samples are being sawn and polished, to be sent out to interested processors of the stone industry.

Claim S01092177, 950' north/west of the #2 Post, we widened a skid-trail, cutting-up poplar trees with a rented, 16" McCulloch chainsaw and bulldozed a new trail to the south side of a steep-sloping 30 to 40 meters high relief to No. 96B, using a John Deere 450E. We stripped an area 18'x54' with a John Deere 450C Backhoe. The material is a banded Quartz-Feldspar-Hornblende-Gneiss, trending north by north/west, with almost vertical dip, fine to medium grained, dark green to charcoal grey. We washed the showing with a Duro high-pressure pump. The joints pattern is favorable overall for possible future block removal here.

see Page IV, please

R E P O R T of Prospecting, stripping and sample removal, activities as outlined in the detailed Final Submission Form Daily Reports.

We returned to this stripped showing later, to remove several samples, approx. 2 to 3 pounds each, using a sledge-hammer and wedges, to be sawn and polished in to hand-samples. Also from No. 96C and No. 96D. Access to these showings was gained by widening and extending old haulage trails with a John Deere Bulldozer, to approx. 590' north of #? Post to approx. 830' north/west of #? Post, Claim S01092178. Areas (2) of 14'x39' each, were stripped by us, using a J.D.450C Backhoe, Pick and Shovel and then washed, with a high-pressure Duro waterpump. The joints-pattern is favourable, please find a fracture plan enclosed with this report. The material is a banded, Quartz-Feldspar-Amphibolite Gneiss, fine to medium grained, hardness 6, dark greenish-grey to black. It is very beautiful when polished and takes a high polish. The reading on a gloss meter is 92, which is very good.

We have had several property visits this year by interested parties of the private sector of the stone industry, as we are working towards obtaining an option from an established processor or quarrier for our dimension stone. Members of the MNDM staff, Sudbury office, have also been very helpful with advise and information, whenever needed. Miss Daniele Spethmann has promised a property visit for early next year. Samples of our "Algonouin Black", a dark greyish green to black Amphibolite, Ca,Fe,Mg composition with white Quartz veinlets and grains, are being displayed at international trade shows or symposia of the MNDM now. Representative samples of this very attractive material are being mailed out, and are being made available to interested members of the stone industry. Mr. J.E(Ted) Muir, M.Sc., Toronto, Macdonald Block, introduced a quarrier and an interested wholesaler to us. A X-ray powder diffraction analyses of sample #31 (equivalent to #96), by the OGS. Geoscience Laboratories Report by Peter Lightfoot and Srebri Petrov, July 22, 1991 made us aware that this material could be suitable for traprock use.

We visited Mr. Chris A. Rogers, M.Sc., Head, Soils and Aggregates Section, MTO Ministry of Transportation, with grab-samples of #31, #92 and #96. On the strength of the appearances of these samples, we were encouraged to present a 100 pound (@approx.fist-size) quantity sample, to the laboratory of MTO for complete testing. Petrographic examination of the rock was performed by David A. Williams, Petrographer, MTO, Downsview, Ont. Several evaluations were performed under the supervision of Robert G. Gorman, Aggregate Resources Technician, under Report No. MTO MAIDB No.M03-94. We passed 7 out of 10 tests, but failed on the Magnesium Sulphate Soundness and both Abrasion Loss tests (should all 3 be lower).The contacted geologists are of the opinion, that the tested material was to "dry and weathered", taken too close to the surface, to show good Abrasion Value Tests results. We are invited to provide more fresh material, from drill core, for another Abrasion Value Test. The other test results were good. Messrs. Dave Villard, Aggregate Supervisor, Northern Region, Bob Gorman and David Williams, MTO Toronto Head Office, came up to our property for an inspection visit.

see Page V, please

P a g e V

R E P O R T of Prospecting, stripping and sample removal, activities as outlined in the detailed Final Submission Form Daily Reports.

On November 2, 1994, a nice sunny day, we were able to study the stripped areas with the MTO team and show them where we had taken the evaluated samples. Other outcrops were also looked at carefully. Locations suitable for drilling were suggested to us. It was suggested to drill 3 vertical, 10 m holes, possibly a 1 7/8" diameter, to be able to submit fresh material for another test run.

Thanks to the OPAP financial assistance we were able to do a lot of work this year. Some very thorough prospecting led to the discovery and stripping of showings with very good potential. Please find maps, photos, assays and other documentation enclosed for you, with this report.

Thank you,

Bob Dicks

For Survey F

face rights reservation

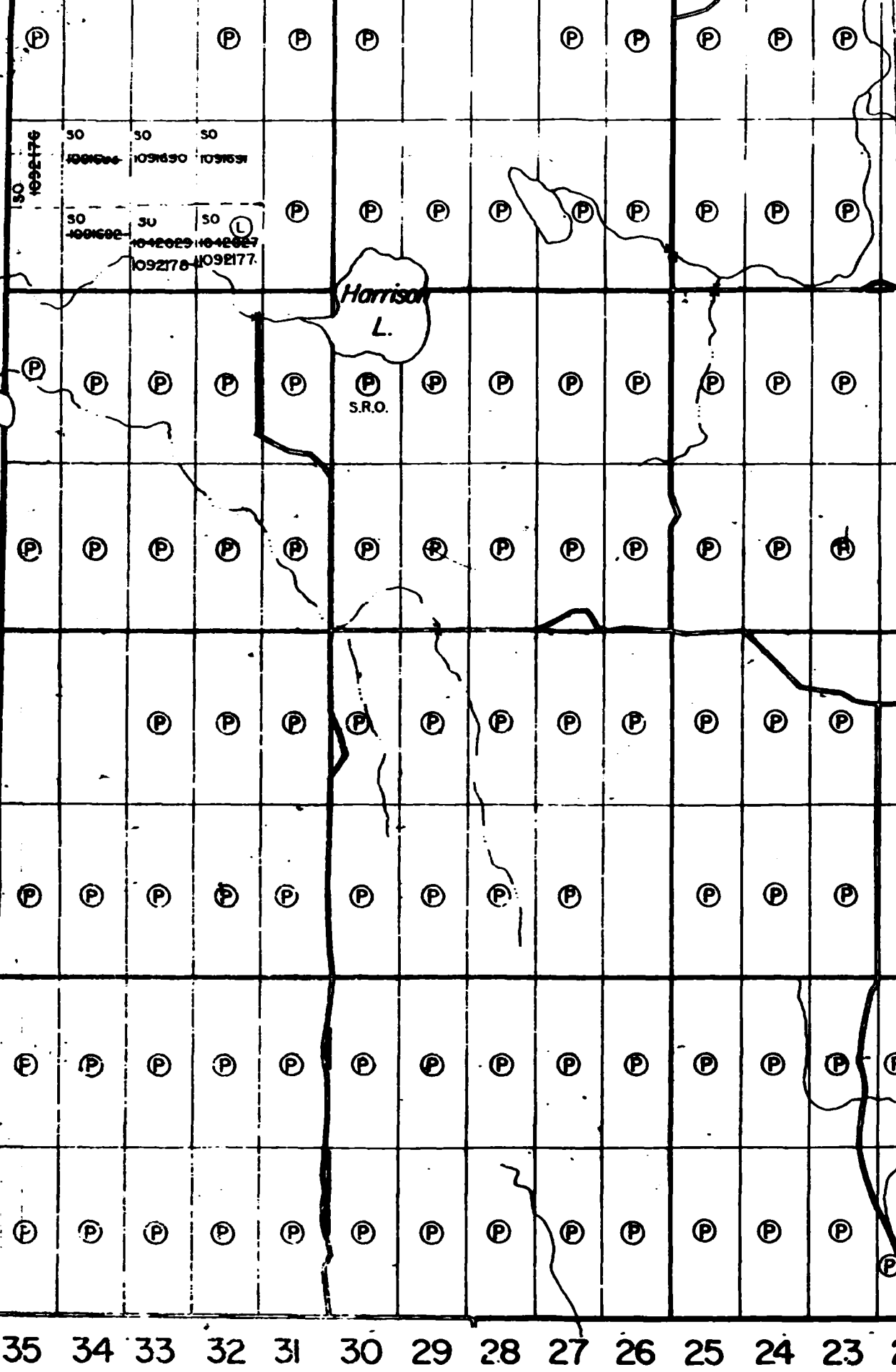

DATE OF
11/11
SOUTHERN
MINING D

FORMATION THAT
IS ON THIS MAP
HAS BEEN COMPILED
FROM VARIOUS SOURCES.
ACCURACY IS NOT
GUARANTEED. THOSE
GOING TO STAKE MINES
SHOULD CONSULT WITH
THE MINING DEPARTMENT,
MINISTRY OF NATURAL
RESOURCES DEVELOPMENT
AND MINES, FOR AD-
DITIONAL INFORMATION
ON THE STATUS OF THE
LAND SHOWN HEREON

35 34 33 32 31 30 29 28 27 26 25 24 23 22

TWP. OF RYERSON, DISTRICT
OF PARRY SOUND

PLAN NO. 1

RYERSON TOWNSHIP LOCATION MAP OF STRIPPING AND SAMPLE REMOVAL AND PROSPECTING

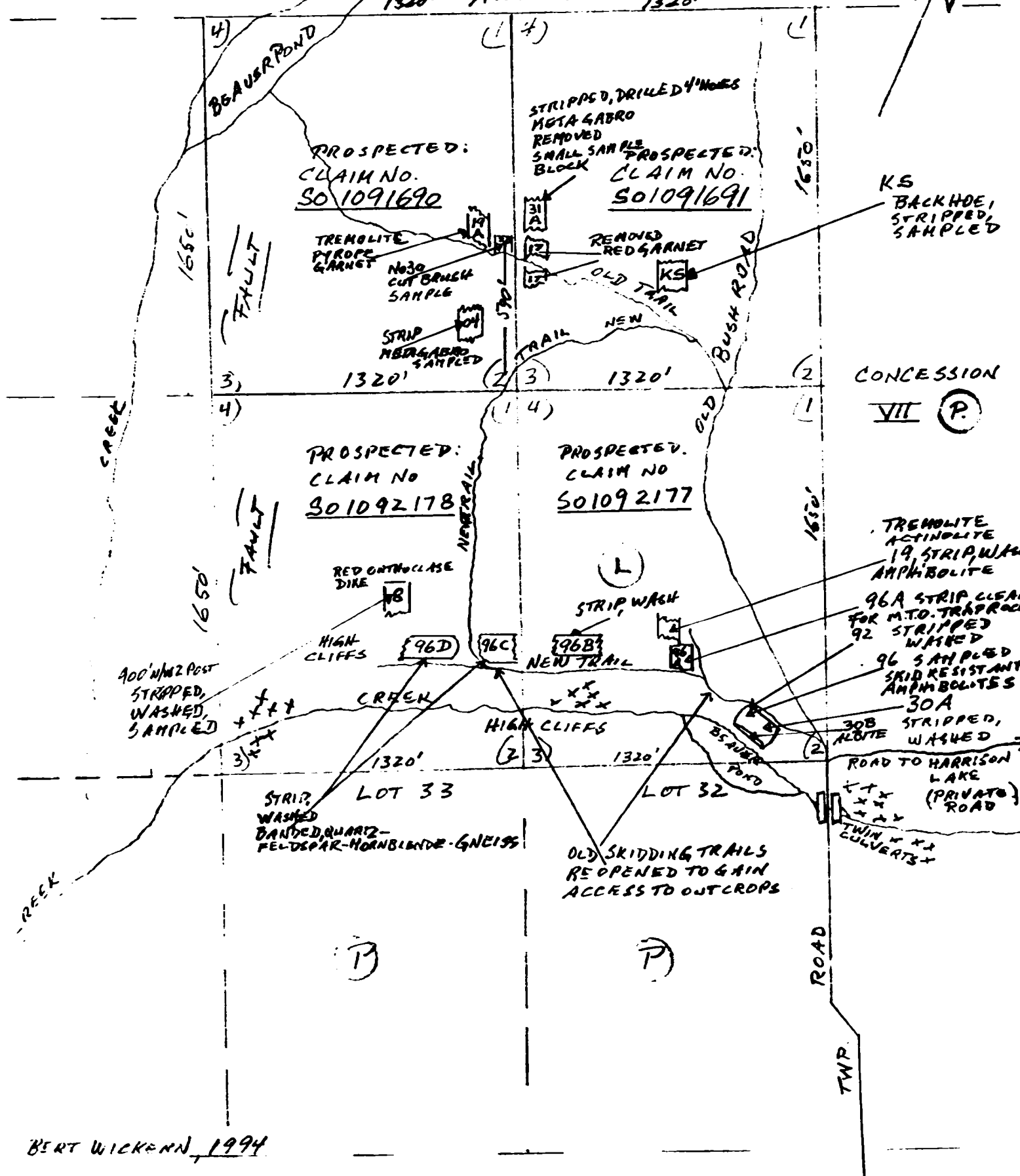
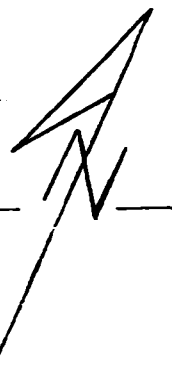

RYERSON TOWNSHIP
 LOCATION MAP OF STRIPPING

PROSPECTING, SAMPLE REMOVAL
 1320'

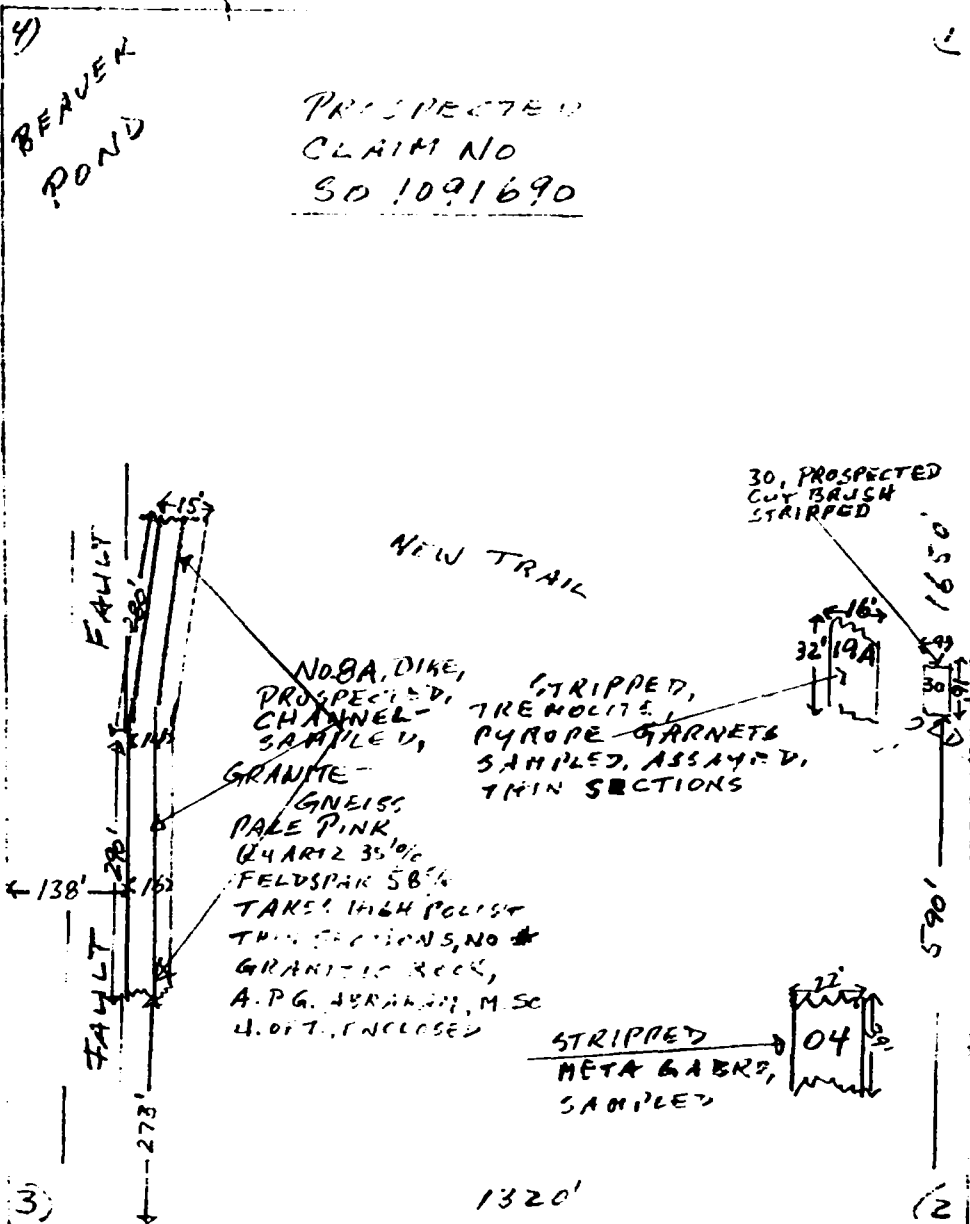
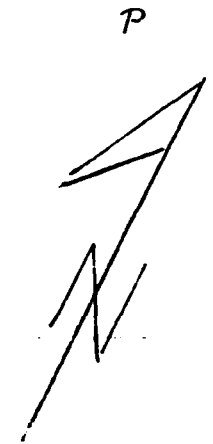

CLAIM No.
 501091691

LOT 33, CON. VII

BERT WICKERIJ,
 1973

CLAIM NO
 501092178

RYERSON TOWNSHIP

LOCATION MAP OF STRIPPING

PROSPECTING, SAMPLE REMOVAL
1320'



4)

1

PROSPECTED
CLAIM NO.
SO 1091691

CLAIM NO
SO 1091690

STRIPPED,
DRILLED 4 HOLES,
5" CENTRES, PRIMACORD,
REMOVED SMALL
META-6 AERO
SAMPLE BLOCK, 3+3+2'6"

PROSPECTED,
REMOVED PYROPE
GARNET SAMPLES 24
FOR THIN SECTIONS

KS
OUTCROPS
STRIPPED
WITH BACKHOE,
PICK & SHOVEL
HAND-STEEL
SAMPLES REMOVED
PALE, PINK
FELDSPAR,
TAKES HIGH
POLISH

NEW TRAIL TO:
BOWER POND

OLD SKIDDING-
TRAILS REOPENED

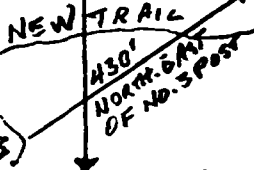
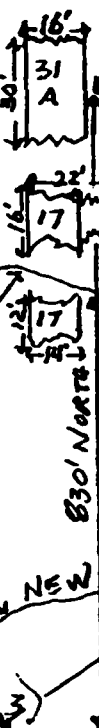

OLD BUSK ROAD

1650'

1320'
LOT 32

2

CONCESSION

VII

CLAIM NO.
SO 1092177

BERT WICKERN, 1994

P.

RYERSON TOWNSHIP

LOCATION MAP OF STRIPPING,

PROSPECTING, SAMPLE REMOVAL

1320'

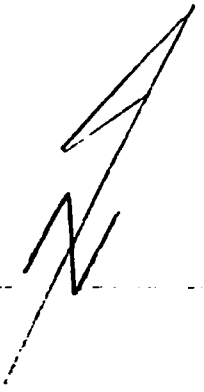

PROSPECTED
CLAIM NO
SD 1092178

No. 8B
GRANIT-GNEISS,
PALE PINK,
DIKE, TAKES
HIGH POLISH,
SAMPLED



STRIPPED, WASHED
RED, MEDIUM TO COARSE-
GRAINED ORTHOCLASE
DIKE, STRIKE NORTH, TO
NORTH WEST

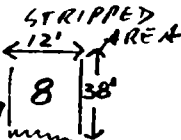

STRIPPED, WASHED:
BANDED, QUARTZ-
FELDSPAR-HORNBLende-
GNEISS, STRIKE NORTH



CLAIM NO.
SD 1092177

1650'

FAULT

1650'

STRIKE NORTH

HIGH CLIFFS

CREEK

NEW TRAIL

CREEK

HIGH CLIFFS

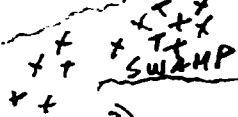

OLD SKIDDING TRAILS
REOPENED TO THE
STRIPPED SHOWINGS

3)

1320'

2)

LOT 33, CON. VII

BERT WICKERN,
1994.

(P)

(P)

RYERSON TOWNSHIP

LOCATION MAP OF STRIPPINGS

PROSPECTING, SAMPLE REMOVAL

1320'

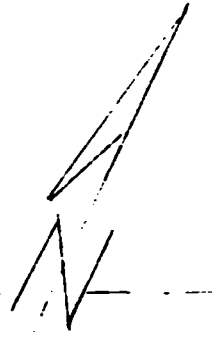

4)

1

PROSPECTED
(L. ASSED) CLAIM NO.
SO 1092177

CLAIM NO.
SO 1092178

CONCESSION
VII

P

OLD TRAILS
REOPENED WITH
JOHN DEERE
BULLDOZER

STRIP, WASHED
BANNED QUARTZ
FELDSPAR-HORNBLAND
GNEISS - FAVOURABLE
JOINTS-PATTERN
POSSIBLE BLOCK-REMOVAL

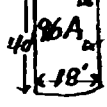
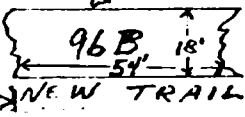

PROSPECTED
NORTH BY
NORTH WEST
STRIKES
OUTCROPS
META-
GABRO

ACTINOLITE
TREMOLITE
STRIPPED,
WASHED

FAVOURABLE
SADDLE JOINTS

STRIP, CLEANED
DARK GREEN
AMPHIBOLITE
FOR POSSIBLE
BLOCK REMOVAL

BUSH
OLD

1650'

92 SAMPLED
STRIPPED &
WASHED FOR
MTO TRAP ROCK
SAMPLES

96 SAMPLED SKI:
RESISTANT
AMPHIBOLITES

30A STRIPPED FOR
JOINT PATTERN
30B STRIPPED ALBITE

ROAD TO
HARRISON LAKE
(PRIVATE
ROAD)

CREEK
HIGH CLIFFS

BEAVER
POND

1320'

LOT 32, CON. VII

BEHT WICKERN,
1924.

P

TWP ROAD

CREEK
TWIN
CULVERTS

No. 96 C CLAIM SO 1092178 APPROX. 570' NORTH OF 2 POST
BANDED, QUARTZ-FELDSPAR-AMPHIBOLITE GNEISS
STRIPPED AREA OF PART OF
LOWER, SOUTHEAST PART OF OUTLINE OF
A 307040M HIGH RELIEF.

TIGHT BANDINGS
 SEALED FOLDING POINTS

VERTICAL, OPEN JOINTS

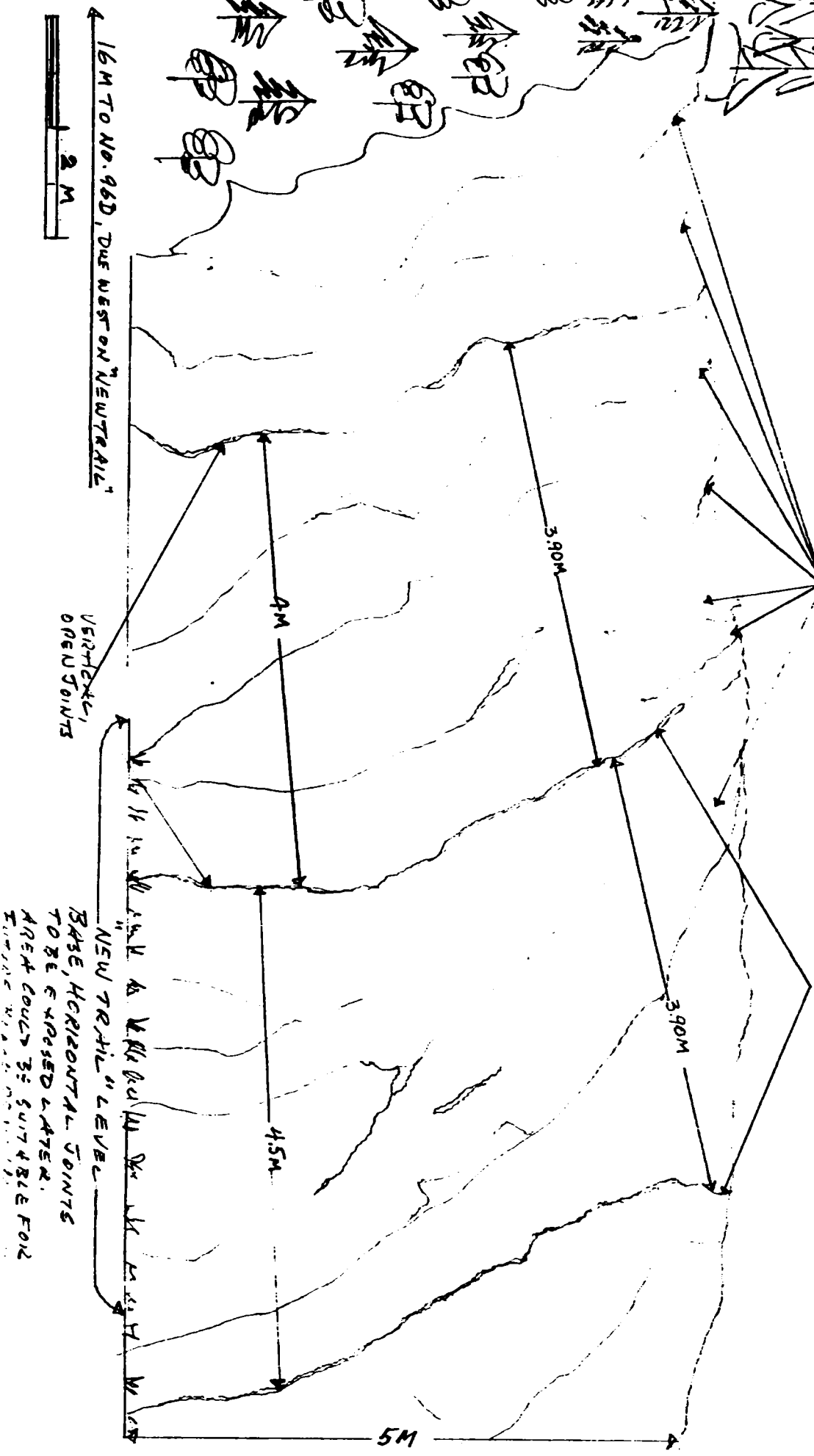
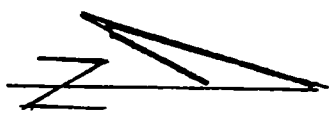

**LABORATORY TEST RESULTS
GRAB ROCK SAMPLES
BERT WICKERN PROPERTY
MAIDB NO. M03-094**

Lab. No.	94-B-9089
Field No.	94-B-1103
Date Received	94 08 03

Rock Type	Amphibolite Gneiss
Petrographic Number: Granular H.L. and Concrete	102 149
L.A. Abrasion Loss (%)	51
Absorption, %	0.518
Bulk Relative Density	2.851
Polished Stone Value	56
Aggregate Abrasion Value	8.3
Pass 75 μ m, %	2.3
Magnesium Sulphate Soundness Coarse Aggregate, %	8
Micro-Deval Abrasion Loss Coarse Aggregate, %	15.7
Freeze Thaw Loss Coarse Aggregate	1

PETROGRAPHIC EXAMINATION OF ROCK, ETC.

SAMPLE NUMBER 1

DATE: 91 10 06

LOCATION BEPT WICKERH QUARRY (MAGHETAWAN 94)

HAND SPECIMEN DESCRIPTION

COLOUR dark gray
SIZE 10cm x 7cm x 5cm
SHAPE irregular
DISCONTINUITIES poorly foliated
TEXTURE medium grained
STRENGTH strong

THIN SECTION DESCRIPTION

MINERAL	%	GRAIN SHAPE	GRAIN SIZE(μ m)		REMARKS
			RANGE	MODE	
feldspar	50	subhedral- anhedral	100-1500	800	
amphibole	30	"	50-1000	500	
biotite	10	"	50-500	250	
quartz	4	anhedral	50-300	150	
calcite	3	subhedral	50-400	150	
magnetite	3	anhedral- subhedral	50-500	150	

ROCK NAME Amphibolite Gneiss.

DISCUSSION The rock is unlikely to be subject to asphalt stripping and alkali reactivity.

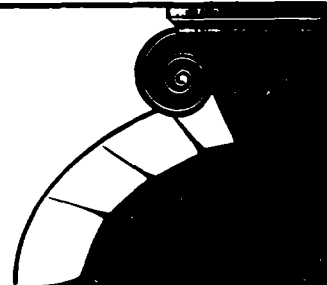

Mr. Burt Wickern
1305 Wilson Ave., Apt. 706
Toronto, Ontario
M3M 1J2

Dr. Srebri Petrov
Department of Chemistry
Lash Miller Labs, PXRD, Room 417
University of Toronto
80 St George Str.
Toronto, Ont. M5S 1A1

RE: Analysis of rock samples.

One mineral sample labelled as #38 was submitted for characterization and mineral identification. X-ray Powder Diffraction Analysis was carried out.

The dark mafic sample is a metamorphic amphibolite rock. The main component in it is a green to black AMPHIBOLE with a composition of a Ca, Mg, Fe-hornblende. It is intimately undergrown with abundant white to pink PLAGIOCLASE with a composition of oligoclase (anorthite - albite solid solution series). Some BIOTITE is also found to present there. No any traces of quartz are identified in the sample.

The composition of the rock, its density, hardness (above 6.0) and the lack of quartz could recommend this material as suitable for use as a traprock.

July 15, 1994

Service Manager:

Dr. Sr. Petrov.



Department of Chemistry

University of Toronto TORONTO ONTARIO M5S 1A1

B. WICKERN
APT 706, 1305 WILSON AVE.
TORONTO, ONTARIO
M3M 1J2

IDENTIFICATION

One sample, labeled as PIPE 2 was submitted for mineral identification. X-ray powder diffraction analysis of different parts of the sample was carried out.

RESULTS: The sample is a basic metamorphic amphibolite rock. The main minerals there are **QUARTZ** and a dark-green to black **AMPHIBOLE** with Ca-Fe-Mg composition, intergrown with **PYROXENE** (AUGITE-DIOPSIDE type). There are also a significant abundance of pink **GARNET** grains. The diffraction pattern shows a Ca-void **SPESSARTINE** composition (Mn,Al-silicate). The yellowish grains of **FELDSPARS** are identified as a Plagioclase-type (Na,Ca-composition). Some abundance of isolated dark colored **MICA**-grains were also found there.

This completes all analytical work on sample entered in your name on MAY 18, 1993.

Fee received: No charge.

JULY 12, 1993.

Service Manager:

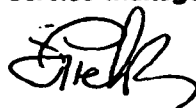

Dr. Srebrj Petrov.

Thin Section Descriptions for Bert Wickern

Thin section 3-PIPE

This rock is medium- to coarse-grained, inequigranular, with a granoblastic texture and a dark green colouration broken by the presence of orange garnets and greyish pools of quartz and feldspar. No deformational fabric and igneous textures are visible in the thin section.

The garnets are subhedral in thin section and still have an orange colour suggesting that they are almandine. garnet comprise between 10% and 15% of the thin section.

Orthopyroxene occurs as pink to green pleochroic crystals with angular grain boundaries and showing straight extinction and 90 cleavage. The latter is also in equilibrium with a distinctly pleochroic (brown to dark olive green) hornblende and minor reaction rims between the two are seen. Possible symplectic intergrowth of clinopyroxene and orthopyroxene is also seen.

Trace amounts of interstitial quartz and carbonate are seen and the latter occurs as an interstitial mineral with epidote around some of the garnets.

Opaque minerals occur in trace amounts as pyrite and chalcopyrite and minor iron oxides.

Andrew P. G. Abraham M.Sc.

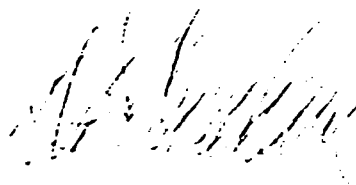

Thin Section Descriptions for Bert Wickern

Granitic Rock no slide #

Coarse-grained inequigranular with a granoblastic texture.

Quartz comprises approximately 35% of the thin section with feldspar (pale pink) comprising approximately 58%. The feldspar is predominantly saussuritized plagioclase (Albite) and K-feldspar (perthite and minor microcline). Accessory phases, epidote, zircon and chlorite, make up less than 2% of the thin section, with chlorite probably forming as an alteration product after biotite.

A dark grey opaque slightly magnetic mineral comprises approximately 5% of the thin section. Under reflected light two main phases are identified hematite/maghemite and ilmenite. The latter has a weak anisotropism and a pale cream to purple colour and occurs as a cleavage exsolution phase of the former. Although there are no internal reflections, common with hematite, the major phase is not isotropic and therefore cannot be magnetite. This phase is likely hematite and possibly maghemite. The opaque minerals are associated with epidote and quartz suggesting that they are part of the late syn-deformational alteration of the rock. Trace amounts of late carbonate veinlets are also seen.

There is a strong planar fabric developed in the rock which is seen in the thin section. The opaques follow this foliation and help define it along with alignment of feldspars. It is likely that this rock is a granitic gneiss or late granite/granodioritic dike intruding the country rock.

Andrew P. G. Abraham M.Sc.

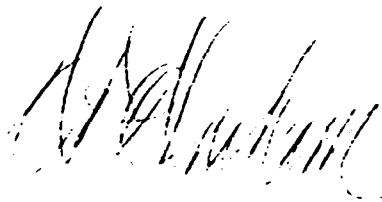

Mr Bert Wickern
1305 Wilson Avenue, Apt 706,
Toronto, Ontario
M3M 1J2

July 22 1993

Dear Mr Wickern

To summarize our telephone conversation last Monday, I have compared the two garnet samples that you had submitted for identification to a garnet from Gore Mountain, New York, using semiquantitative X-ray fluorescence spectrometry. The Gore Mountain material lies roughly at the pyrope-almandine midpoint. Thus a member of this series with a magnesium:silicon peak height ratio that is significantly greater than that of the Gore Mountain garnet is likely to be a pyrope, whereas one with a lower ratio is likely to be an almandine. The peak height ratios for your samples are:

	#30A	#2 red	Gore Mtn
Ca:Si	5	8	3
Fe:Si x10	6	5	5
Al:Si x100	3	3	3
Mg:Si x2000	1	0.6	6

The magnesium:silicon peak height ratios for your garnets indicate that they lie on the almandine side of the mid-point. The calcium:silicon ratios suggest that the grossular content may be significant. I am not in a position to advise you how to apply this information. However, had these results shown a magnesium:silicon ratio greater than that of the Gore Mountain garnet (indicating a pyrope-dominant garnet), I would have advised you to get a quantitative analysis on the material before making an exploration decision. As I stated, I am willing to run one more sample in a similar manner.

I enclose a copy of a table showing typical garnet compositions from various rock types. Note that a significant pyrope component can be present in garnets from a number of rock types. Good hunting!

Regards,

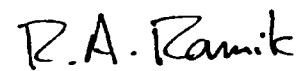

Robert A. Ramik
Technician

Owner's copy

TEMPORARY RECEIPT

Depositor Bert Wickham Date May 13, 94

Address Apt 706, 1305 W. Leslie Ave Toronto

Phone no. 614-3070

Object(s) 1 hand specimen, several (5) thin sections

Bert

- garnet-pyroxene rocks are probably metamorphosed mafic rocks originally of igneous origin (eg. gabbroic or dioritic dikes). Hand specimen is similar to 4 geo. px sections, in this respect.
- feldspar rich section may be a trondjemite or similar composition.

Bob to

Information given on this receipt is
subject to verification by the Museum

PURPOSE:

- | | |
|--|--|
| <input type="checkbox"/> Gift Approval | <input checked="" type="checkbox"/> Identification |
| <input type="checkbox"/> Loan Approval | <input type="checkbox"/> Photography |
| <input type="checkbox"/> Purchase Approval | <input type="checkbox"/> Other |

Curator R. Ramik

Objects which are received as gifts or for consideration as gifts, purchases or loans are covered under the Museum's insurance policy.
Objects received for identification only, will be given the same care the Museum devotes to its own property, but no responsibility can be assumed in case of loss or damage by fire, theft or otherwise. Objects must be collected within one week of notification. The Museum regrets that it cannot guarantee to hold material beyond that time, due to lack of storage space.

KEEP THIS RECEIPT: It must be surrendered to reclaim objects listed above.



Ontario

Ministry of
Northern Development
and Mines

Ontario
Geological
Survey

77 Grenville Street
11th Floor
Toronto, Ontario
M7A 1W4
Telephone 965-1337

Geoscience
Laboratories
Report

Issued to:

B. WICKERN
APT 706, 1305 WILSON AVE.
TORONTO, ONTARIO
M3M 1J2

IDENTIFICATION

Two samples were submitted for identification: # 30-a for mineralogical characteristic of the whole rock and # 31 - for determination of the main dark mineral. X-ray powder diffraction analyses were carried out.

SAMPLE # 30-A: This rock consists mainly of dark green to black amphibole with Ca, Fe, Mg composition. There are quartz veins and grains between amphibole crystals. No asbestos minerals were found. This material could be suitable for outside and inside tiles.

SAMPLE # 31: The main dark mineral is amphibole with composition close to that of hastangstite (Ca subgroup, Mg, Fe member). This material could be suitable for traprock use.

The black mineral in pink feldspar sample contains mainly hematite.

This completes all analytical work on samples entered in your name on JULY 18, 1991.

Fee received: No charge.

PETER LIGHTFOOT, Chief

SREBRI PETROV, XRD Scientist.
July 22, 1991.



Ontario

Ministry of
Northern Development
and Mines

Ontario
Geological
Survey

120 Queen Street
11th Floor
Toronto, Ontario
M5H 1K4
Telephone 965-1237

Geoscience
Laboratories
Report

Directed to

B. WICKERN
APT 706, 1305 WILSON AVE.
TORONTO, ONTARIO
M3M 1J2

0014-92

IDENTIFICATION

One sample, #96 was submitted for mineral identification. X-ray powder diffraction analysis was carried out.

SAMPLE # 96: The sample is a metamorphic amphibolite rock. The main minerals there are dark-green to black **AMPHIBOLE** with Ca-Fe-Mg composition, intergrown with **MICA** and fine grained **QUARTZ**. The pink grains are Fe, Mg-rich **GARNET** (almandine-pyrope series).

This material could be suitable for outside and inside tiles and for floors and steps as well. The amphibolites are more slip-resistant when wet comparing with other materials such as marbles.

This completes all analytical work on sample entered in your name on MAY 18, 1992.

Fee received: No charge.

PETER LIGHFOOT, Chief

SREBRI PETROV, XRD Scientist.

JUNE 29, 1992.



Issued to

B. WICKERN
APT 706, 1305 WILSON AVE.
TORONTO, ONTARIO
M3M 1J2

0 0 0 1 - 92

IDENTIFICATION

One sample, #92 was submitted for mineral identification. X-ray powder diffraction analysis was carried out.

SAMPLE # 92: The sample is a basic metamorphic amphibolite rock. The main minerals there are dark-green to black **AMPHIBOLES** with a complex Na-Ca-Fe-Mn composition, intergrown with **MICA**. The pink grains are Mn-rich **GARNET** (almandine-spessartine series). There are also **FELDSPARS** (andesine) and **CARBONATES** (fluorapatite). The small bright grains content **PYRITE** and **CORUNDUM**.

This completes all analytical work on sample entered in your name on APRIL 10, 1992.

Fee received: No charge.

PETER LIGHFOOT, Chief

SREBRI PETROV, XRD Scientist

MAY 20, 1992



Ontario

Ministry of
Northern Development
and Mines

Ontario
Geological
Survey

77 Grenville Street
11th Floor
Toronto, Ontario
M7A 1W4
Telephone 965-1337

Geoscience
Laboratories
Report

Issued to:

A. WICKERN
33 INDIAN ROAD
TORONTO, ONTARIO
M6R 2V2

0020-90

<u>SAMPLE NUMBER</u>	<u>GOLD Au oz/ton</u>
2	<0.01
7	0.86

This is an interim report for samples entered in your name on
MAY 3, 1990; additional work will follow as soon as possible.

Fees Received: COUPONS

Chris Riddle, Chief

MAY 10, 1990

Except by special permission reproduction of these results must include any qualifying remarks made by this ministry with reference to any sample.

BERT WICKERN
ALWINE WICHERN

1305 WILSON AVENUE
SUITE 706
TORONTO, ONTARIO
M3M 1J2

MAY 14, 15, 16, 17, 18, 19 20, 21, 22, 1994	-	8-10 hrs. per day
JUNE 9, 10, 12, 13, 14, 15 16, 17, 18, 19, 20, 22 23 1994	-	8-10 hrs. per day
JULY 2, 3, 4, 5, 6, 7, 8, 23, 24, 25, 26, 27, 28, 29, 30, 31 1994	-	8-10 hrs. per day
AUG. 1, 2, 9, 20, 21, 22, 23, 24, 25, 26, 27, 28 1994	-	8-10 hrs. per day
SEPT 1, 2, 3, 4, 5, 25, 26, 27, 28, 29 1994	-	8-10 hrs. per day
BACKHOE - HEDGIE CONTRACTORS BURKS FALLS, ONTARIO POA 1C0	-	JUNE 14, 1994
TRUCK RENTAL - H. PRYCHODZKI & SPRUCEDALE, ONTARIO RUBBER P0A 1Y0 TIRE BACKHOE	-	June 24, July 29, Aug. 22, 26, 30 Sept. 4, 1994
CHAINSAW - TOVI RENTALL COMPRESSOR	-	July 23, 24, Aug. 20, 26, 29 1994
450C BACKHOE - W. MIDDLEBROOK BURKS FALLS, ONTARIO POA 1C0	-	Aug. 28, Sept. 1, 26, 1994

Spence Twp.

III

II

I

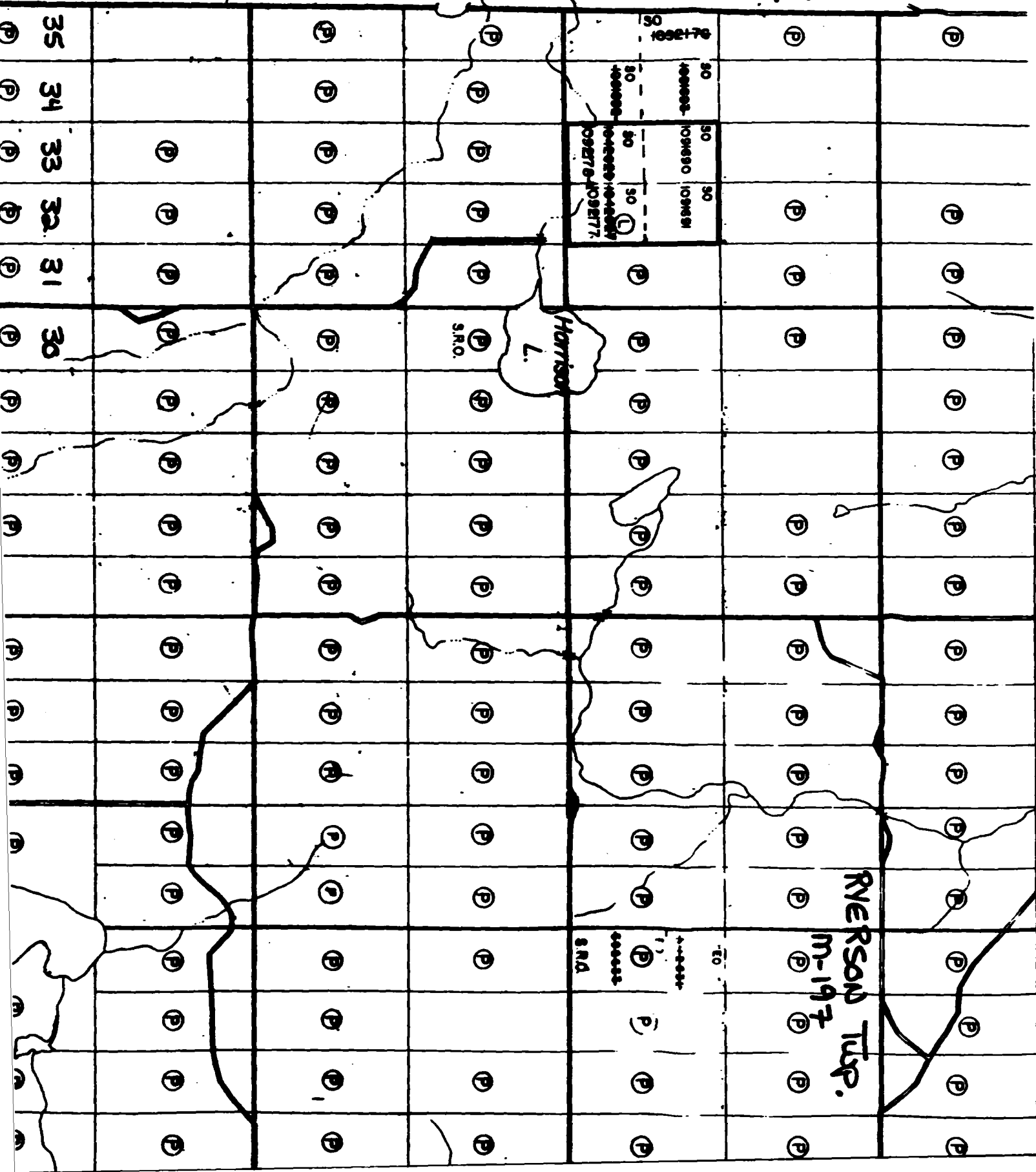

35

34

33

32

31

30

HARRISON L.

RIVERSON TWP.
M-197

S.R.O.

S.R.O.

50

50

50

50

50

50

50

50

50

50

50

50

50

50

50

50

50

50

50

50

50

P

P

P

P

P

P

P

P

P

P

P

P

P

P

P

P

P

P

P

P

P

P

P

P

P

P

P

P

P

P

P

P

P

P

P

P

P

P

P

P

P

P

P

P

P

P

P

P

P

P

P

P

P

P

P

P

P

P

P

P

P

P

P

P

P

P

P

P

P

P

P

P

P

P

P

P

P

P

P

P

P

P

P

P

P

P

P

P

P

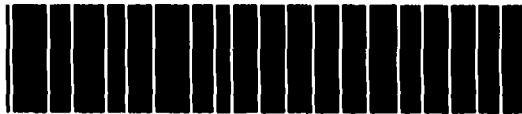

31E12SE0007 W9590.00004 RYERSON

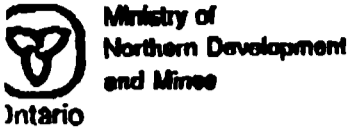

Report of Work Conducted After Recording Claim

Transaction Number
W9590.00004

Mining Act

Personal information collected on this form is obtained under the authority of the Mining Act. This information will be used for correspondence. Questions about the collection should be directed to the Provincial Manager, Mining Lands, Ministry of Northern Development and Mines, Fourth Floor, 159 Cedar Street, Sudbury, Ontario, P2E 6A5, telephone (705) 670-7284.

- Instructions:
- Please type or print and submit in duplicate.
 - Refer to the Mining Act and Regulations for requirements of filing assessment work or consult the Mining Recorder.
 - A separate copy of this form must be completed for each Work Group.
 - Technical reports and maps must accompany this form in duplicate.
 - A sketch, showing the claims the work is assigned to, must accompany this form.

Recorded Holder(s) BERT WICKERN, & ALWINE WICKERN	Client No. 208582 208516
Address APT. 706, 1305 WILSON AVE, TORONTO, ONT. M3H-1J2	Telephone No. 416-614-3070
Filing Division SOUTHERN ONTARIO	Township/Area RYERSON
Date Work Performed	From: To:

Work Performed (Check One Work Group Only)

Work Group	Type
Geotechnical Survey	
Physical Work, Including Drilling	BULLDOZING AND MANUAL LABOUR
Rehabilitation	
Other Authorized Work	
Assays	
Assignment from Reserve	

Total Assessment Work Claimed on the Attached Statement of Costs \$ **23,140**

Note: The Minister may reject for assessment work credit all or part of the assessment work submitted if the recorded holder cannot verify expenditures claimed in the statement of costs within 30 days of a request for verification.

Persons and Survey Company Who Performed the Work (Give Name and Address of Author of Report)

Name	Address
SEE ATTACHED	

(Attach a schedule if necessary)

Certification of Beneficial Interest * See Note No. 1 on reverse side

I certify that at the time the work was performed, the claims covered in this work report were recorded in the current holder's name or held under a beneficial interest by the current recorded holder.

Date JAN 17/95	Recorded Holder or Agent (Signature) <i>Alwine Wickern</i>
--------------------------	---

Certification of Work Report

I certify that I have a personal knowledge of the facts set forth in this Work report, having performed the work or witnessed same during and/or after its completion and assessed report is true.

Name and Address of Person Certifying
BERT WICKERN AS ABOVE

Telephone No. (416) 614-3070	Date JAN. 17/95.	Certified By (Signature) <i>Alwine Wickern</i>
--	----------------------------	---

Recorder or Office Use Only

Total Value Or. Recorded \$23,140	Date Recorded Jan 17/95	Mining Recorder <i>[Signature]</i>	Received By RECEIVED
	Deemed Approval Date Jan 18/95	Date Approved Jan. 18/95	JAN 17 1995
	Date Notation for Amendments Part		AM 7:00 PM

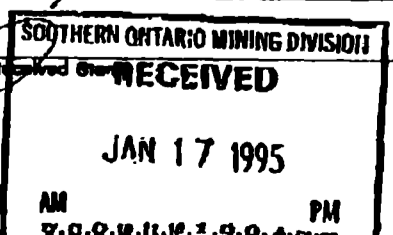

Work Report Number for Applying Reserve	Claim Number (see Note 2)	Number of Claim Units
	1091690	1
	1091691	1
	1092178	1
	1092177	1
Total Number of Claims		4

Value of Assessment Work Done on this Claim	Value Applied to this Claim
4,628	800
4,628	800
4,628	800
9,256	-
Total Value Work Done	23,140
Total Value Work Applied	2,400

Value Assigned from this Claim	Reserve: Work to be Claimed at a Future Date
	3,828
	3,828
	3,828
	9,256
Total Assigned From	20,740

Credits you are claiming in this report may be cut back. In order to minimize the adverse effects of such deletions, please indicate from which claims you wish to prioritize the deletion of credits. Please mark (✓) one of the following:

- Credits are to be cut back starting with the claim listed last, working backwards.
- Credits are to be cut back equally over all claims contained in this report of work.
- Credits are to be cut back as prioritized on the attached appendix.

In the event that you have not specified your choice of priority, option one will be implemented.

Note 1: Examples of beneficial interest are unrecorded transfers, option agreements, memorandum of agreements, etc., with respect to the mining claims.

Note 2: If work has been performed on patented or leased land, please complete the following:

I certify that the recorded holder had a beneficial interest in the patented or leased land at the time the work was performed.	Signature <i>Bob Fisher</i>	Date JANUARY 17, 1995
---	--------------------------------	--------------------------



Ministry of
Northern Development
and Mines

Ministère du
Développement du Nord
et des mines

**Statement of Costs
for Assessment Credit**

**État des coûts aux fins
du crédit d'évaluation**

Mining Act/Loi sur les mines

Transaction No./N° de transaction

W9590.00004

Personal information collected on this form is obtained under the authority of the Mining Act. This information will be used to maintain a record and ongoing status of the mining claim(s). Questions about this collection should be directed to the Provincial Manager, Minings Lands, Ministry of Northern Development and Mines, 4th Floor, 159 Cedar Street, Sudbury, Ontario P3E 6A5, telephone (705) 670-7264.

Les renseignements personnels contenus dans la présente formule sont recueillis en vertu de la Loi sur les mines et serviront à tenir à jour un registre des concessions minières. Adresser toute question sur la collecte de ces renseignements au chef provincial des terrains miniers, ministère du Développement du Nord et des Mines, 159, rue Cedar, 4^e étage, Sudbury (Ontario) P3E 6A5, téléphone (705) 670-7264.

1. Direct Costs/Coûts directs

Type	Description	Amount Montant	Totals Total global
Wages Salaires	Labour Main-d'oeuvre	\$18,000	
	Field Supervision Supervision sur le terrain		18,000
Contractor's and Consultant's Fees Droits de l'entrepreneur et de l'expert- conseil	Type		
	ASSAYS	\$ 556	556
Supplies Used Fournitures utilisées	Type CHAINSAW 16' McCulloch	\$ 177	
	EXPLOSIVES CAPS	\$ 83	
	ATLAS COPCO COMPRESSOR	\$ 480	
	RUBBER-TIRED BACKHOE	\$ 382	1,122 850
	Equipment Rental Location de matériel	Type BACKHOE 450 JOHN DEERE	\$1,280
	HIGH PRESSURE DURO PUMP	\$ 180	
	BULLDOZER 450E JOHN DEERE	\$ 660	2,120 2,382
Total Direct Costs Total des coûts directs			\$21,798

2. Indirect Costs/Coûts indirects

** Note: When claiming Rehabilitation work Indirect costs are not allowable as assessment work.
Pour le remboursement des travaux de réhabilitation, les coûts indirects ne sont pas admissibles en tant que travaux d'évaluation.

Type	Description	Amount Montant	Totals Total global
Transportation Transport	Type GAS & OIL	\$ 492	
			492
Food and Lodging Nourriture et hébergement	FOOD & LODGING	\$570	570
Mobilization and Demobilization Mobilisation et démobilisation	TRUCK FOR SAMPLES	\$140	280
		\$140	
Sub Total of Indirect Costs Total partiel des coûts indirects			1342
Amount Allowable (not greater than 20% of Direct Costs) Montant admissible (n'excédant pas 20 % des coûts directs)			1342
Total Value of Assessment Credit (Total of Direct and Allowable Indirect costs)		Valeur totale du crédit d'évaluation (Total des coûts directs et indirects admissibles)	23,140

Note: The recorded holder will be required to verify expenditures claimed in this statement of costs within 30 days of a request for verification. If verification is not made, the Minister may reject for assessment work all or part of the assessment work submitted.

Note : Le titulaire enregistré sera tenu de vérifier les dépenses demandées dans le présent état des coûts dans les 30 jours suivant une demande à cet effet. Si la vérification n'est pas effectuée, le ministre peut rejeter tout ou une partie des travaux d'évaluation présentés.

Filing Discounts

1. Work filed within two years of completion is claimed at 100% of the above Total Value of Assessment Credit.
2. Work filed three, four or five years after completion is claimed at 50% of the above Total Value of Assessment Credit. See calculations below:

Total Value of Assessment Credit	Total Assessment Claimed
	x 0.50 =

Remises pour dépôt

1. Les travaux déposés dans les deux ans suivant leur achèvement sont remboursés à 100 % de la valeur totale susmentionnée du crédit d'évaluation.
2. Les travaux déposés trois, quatre ou cinq ans après leur achèvement sont remboursés à 50 % de la valeur totale du crédit d'évaluation susmentionné. Voir les calculs ci-dessous.

Valeur totale du crédit d'évaluation	Evaluation totale demandée
	x 0,50 =

Certification Verifying Statement of Costs

I hereby certify:
that the amounts shown are as accurate as possible and these costs were incurred while conducting assessment work on the lands shown on the accompanying Report of Work form.

that as RECORDED HOLDER I am authorized
(Recorded Holder, Agent, Position in Company)

to make this certification

Attestation de l'état des coûts

J'atteste par la présente :
que les montants indiqués sont le plus exact possible et que ces dépenses ont été engagées pour effectuer les travaux d'évaluation sur les terrains indiqués dans la formule de rapport de travail ci-joint.

Et qu'à titre de _____ je suis autorisé
(titulaire enregistré, représentant, poste occupé dans la compagnie)

à faire cette attestation.

Signature a. Wickham Date JAN 17, 1995
[Signature]

Chapman Twp.

THE TOWNSHIP OF

RYERSON

DISTRICT OF
PARRY SOUND

SOUTHERN ONTARIO
MINING DIVISION

SCALE: 1-INCH=40 CHAINS

LEGEND

PATENTED LAND	Ⓟ
CROWN LAND SALE	C.S.
LEASES	Ⓛ
LOCATED LAND	Loc.
LICENSE OF OCCUPATION	L.O.
MINING RIGHTS ONLY	M.R.O.
SURFACE RIGHTS ONLY	S.R.O.
ROADS	—
IMPROVED ROADS	—
KING'S HIGHWAYS	—
RAILWAYS	—
POWER LINES	—
MARSH OR MUSKEG	—
MINES	—
CANCELLED	—

NOTES

This Twp. Is Not To Be Used
For Survey Purposes

400' Surface rights reservation around all lakes and rivers.

DATE OF ISSUE

JAN 18 1995

SOUTHERN ONTARIO
MINING DIVISION

THE INFORMATION THAT APPEARS ON THIS MAP HAS BEEN COMPILED FROM VARIOUS SOURCES, AND ACCURACY IS NOT GUARANTEED. THOSE WISHING TO STAKE MINING CLAIMS SHOULD CONSULT WITH THE MINING RECORDER, MINISTRY OF NORTHERN DEVELOPMENT AND MINES, FOR ADDITIONAL INFORMATION ON THE STATUS OF THE LANDS SHOWN HEREON

PLAN NO. M-197

ONTARIO
MINISTRY OF NATURAL RESOURCES
SURVEYS AND MAPPING BRANCH

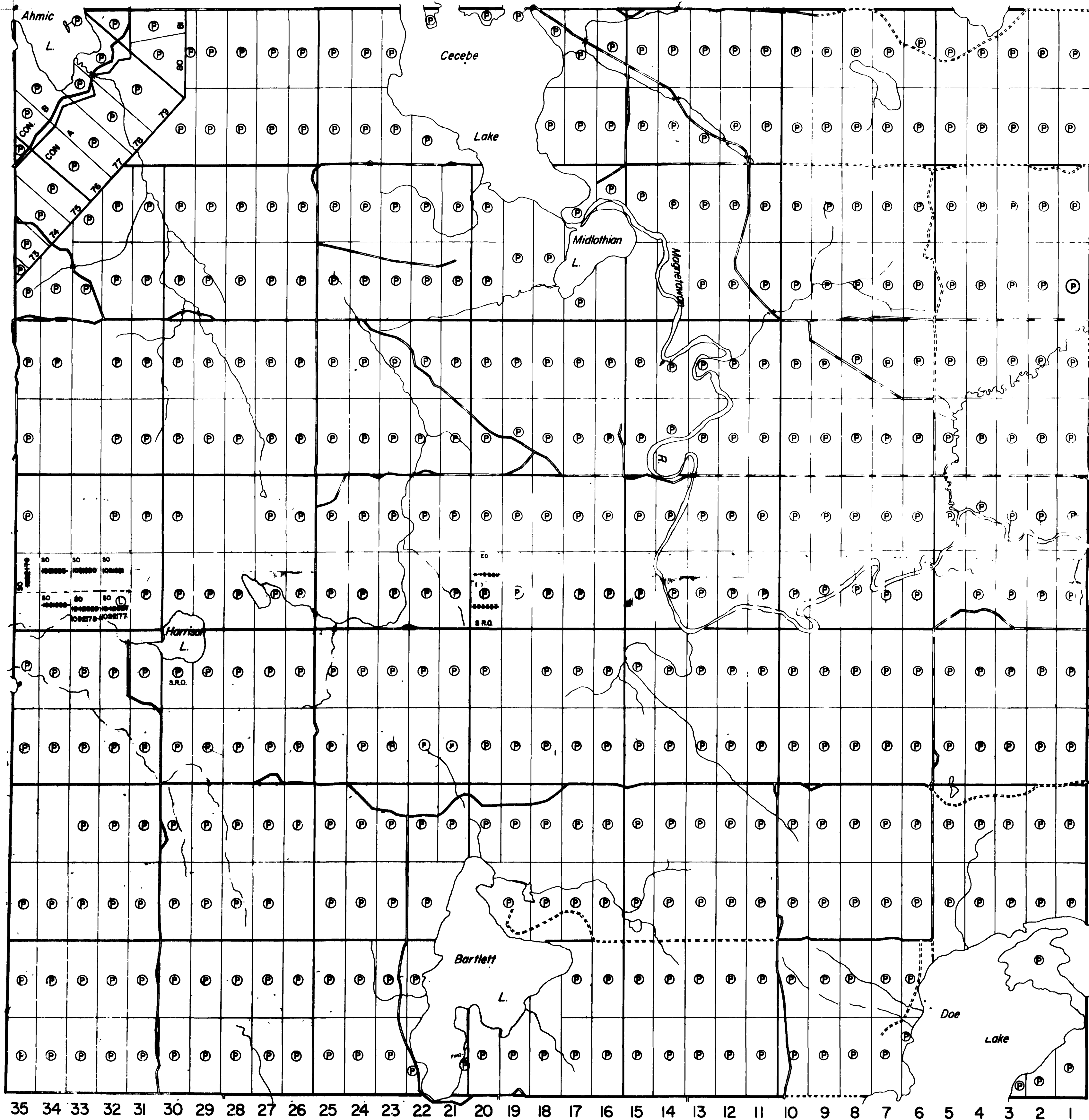

XIV
XIII
XII
XI
X
IX
VIII
VII
VI
V
IV
III
II
I

Spence Twp.

Armour Twp.

McMurrich Twp.

