

Lount Township

Summary

2.20.00

Richard E. Bain Lic # C37981.

Days	#	People	Type of work	Desc. sheet.	Map sheets
5	-	4	- cutting trees.	- A	- (A1) (A6)
1	-	1	- bulldozing	- B	- (A1) to (A6)
1	-	2	- sweeping of rocks	- B	- (A1) to (A6)
1	-	1	- Assisting (Mike Cosco) description of rock.	- C	- (B1) to (B6)
2	-	1	- drawing maps and recording work.	- D	



31E13SE2004 2.20750 LOUNT

010

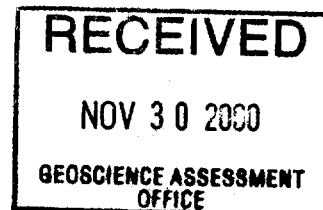

Richard E Bain Lic # C37981

A

Cutting and clearing of trees.

I hired Bob Miller and his wife, also Anne Noble to help me cut and clear off five outcrops. It took us six days, about six hours per day. We are a little old for this work, but we got it done.

See maps from (A1) to (A6)

Dates worked	cutting + clearing	outcrop sheet #	Claim #
Aug 31/2000	4 people	(A1)	1229451
Sept 5/2000	4 people	(A2)	1229907
Sept 6/2000	4 people	(A3)	1229907
Sept 9/2000	4 people	(A4)	1229748
Sept 22/2000	4 people	(A5)	1237069
No trees on this claim		(A6)	1231457

Please find attached receipts for the three people hired totalling \$ 980.00 for cutting and clearing. Also work done by J & S Construction for bulldozing totalling \$ 505.57. - (Excellent price, I think they must be looking for future work)

cutting	\$ 980.00
Bulldozing	<u>505.57</u>
Total	\$ 1,485.57

J & S CONSTRUCTION

R.R. 1
Magnetawan, Ontario POA 1P0

J. JOHNSTON
(705) 387-4205

DATE SEPT 27 2000

MR. RICHARD E BAIN #307482 ONTARIO LTD.

ADDRESS

BULLDOZER RENTAL			
OLD NIPISSING ROAD			
NORTH OF MAGNETAWAN.			
CLEAN OFF OUTCROP.			
0.5 HRS @ \$55.00 HR		412	50
1.0 HRS @ \$60.00 HR		60	00
FLOATING, ONE WAY			
SUB-TOTAL		472	50
G.S.T. #106475080		33	07
PAID BY CHEQUE			
SEPT 27, 2000			

RECEIVED ABOVE IN GOOD ORDER

RB5-85

TAX

TOTAL 505 57

ROCK POINT ELECTRIC

R.R. 1 KEARNEY

POA 1M0

636 0204

Sept 15 2000

NAME 307482 ONT LTD

ADDRESS HUNTSVILLE ONT

SOLD BY	C.O.D.	*CHARGE	ON ACCT	ACCT FWD
		LABOUR TO CLEAR		
		TREES & BRUSH AT		
		SITE 4 DAYS		
				\$480 00
		SEP 22/2000		
		1 DAY EXTRA		SEP 29 120 00
		Paid by Cheque		600 00
		Robert Miller		
39		SIGNATURE		

G3MCR-2

Sept 25/00.

Rec'd from Co # 307482 Ontario Ltd
% Richard C. Bain, the sum of \$300.00
for cutting and removing brush on claim
sites for five working days.

Anne Noble

Oct 2/00

Rec'd from # 307482 Ontario Ltd
% Richard C. Bain the sum of \$80.00
for clearing brush from claims. (8 hrs)

A. Noble

Lount Township

B

Richard E. Bain Lic# C37981

Sept 26/2000

I Richard E Bain drove from Huntsville to Lount Township, 90km to assist in the bulldozing of six outcrops on five claims in Lount Township.

We worked about eight hours (Mike Cossec) resident geologist said we had done an excellent job. The bulldozing costs were very reasonable, they said they are looking for work in the future.

See maps from (AI) to (Ab)

For location on claims see map 7.

Sept 27/2000

I drove to J. S Construction and paid them for their work. Please find receipt for \$505.57.

Sept 30/2000

Mike Cossec wanted the outcrops washed down but there was no water nearby, so Anne and I swept them off with brooms, it worked well, as Mike said, it was an excellent job. It took the two of us eight hours, it was a good job the soil was dry.

See maps (AI) to (Ab) for outcrops swept off, and map 7 for location of claim.

Hount Township

C

Richard E. Bain Lic# C37981.

Oct 25/2000

On this day (Mike Cosco) resident geologist came to the claims, to look over the work we had done, he said we had done an excellent job.

Mike thought the grade of garnet was the best he had seen, he said it might take a couple of years to sell it, as there isn't a big demand for garnet.

All outcrops have garnet, some more than others, have gneiss mixed with the garnet, also calcite. This is shown on all maps marked from (B1) to (B6). Map #7 will show location of outcrops on claims.

Lount Township

D

Richard E Bain Lic # C37981

There is a total of five claims.

I have drawn 7 maps - 6 maps are outcrops, map #7 shows the location of the outcrops on the claim eg - (AI) outcrop should show you the approx. length and width of the area cut and cleared, done so that the bulldozer operator would know where to push off the top soil. These areas are marked on the map as (ACB - area cut and bulldozed, also the dates we did the cutting and the date that the bulldozer worked, the date that we swept. Each outcrop has a claim number and to find out where (AI) outcrop is refer to map (#7)

All maps with B in front of the number, eg. (BI) refer to the type of mineral or rock found on each outcrop.

It took me about two days to draw up the maps. I hope they are to your satisfaction.

Maps (A1) to (A6)

show area cut and bulldozed
and dates work done

Map 7 shows location of
outcrop on claim.



31E13SE2004

2.20750

LOUNT

020

CLAIM # 1229907

LOCAL TOWNSHIP

CLAIM # 1229451

FOR LOCATION OF THIS OUTCROP SEE SHEET # 7

OUTCROP # AI

LOC ON MAP # 7

Mostly SPRUCE

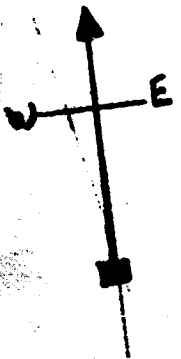

TRAIL IN

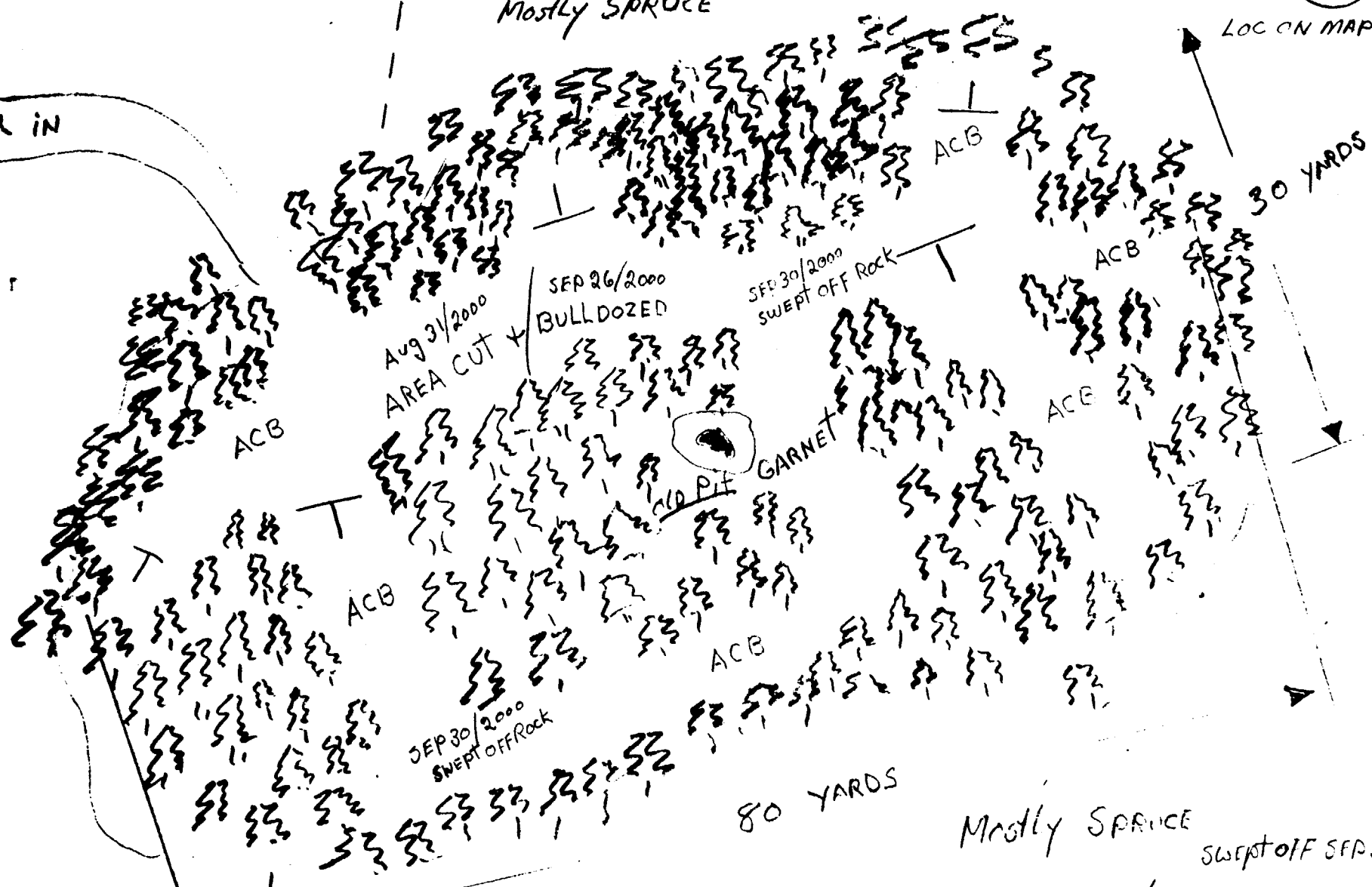

(ACB) - AREA CUT & BULLDOZED
AUG 31/2000 SEP 26/2000

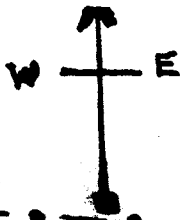

LOUNT 100000000
CLAIM # 1229907

SCALE 1 INCH = 10 YARDS

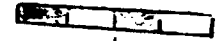

5 10 - YARDS

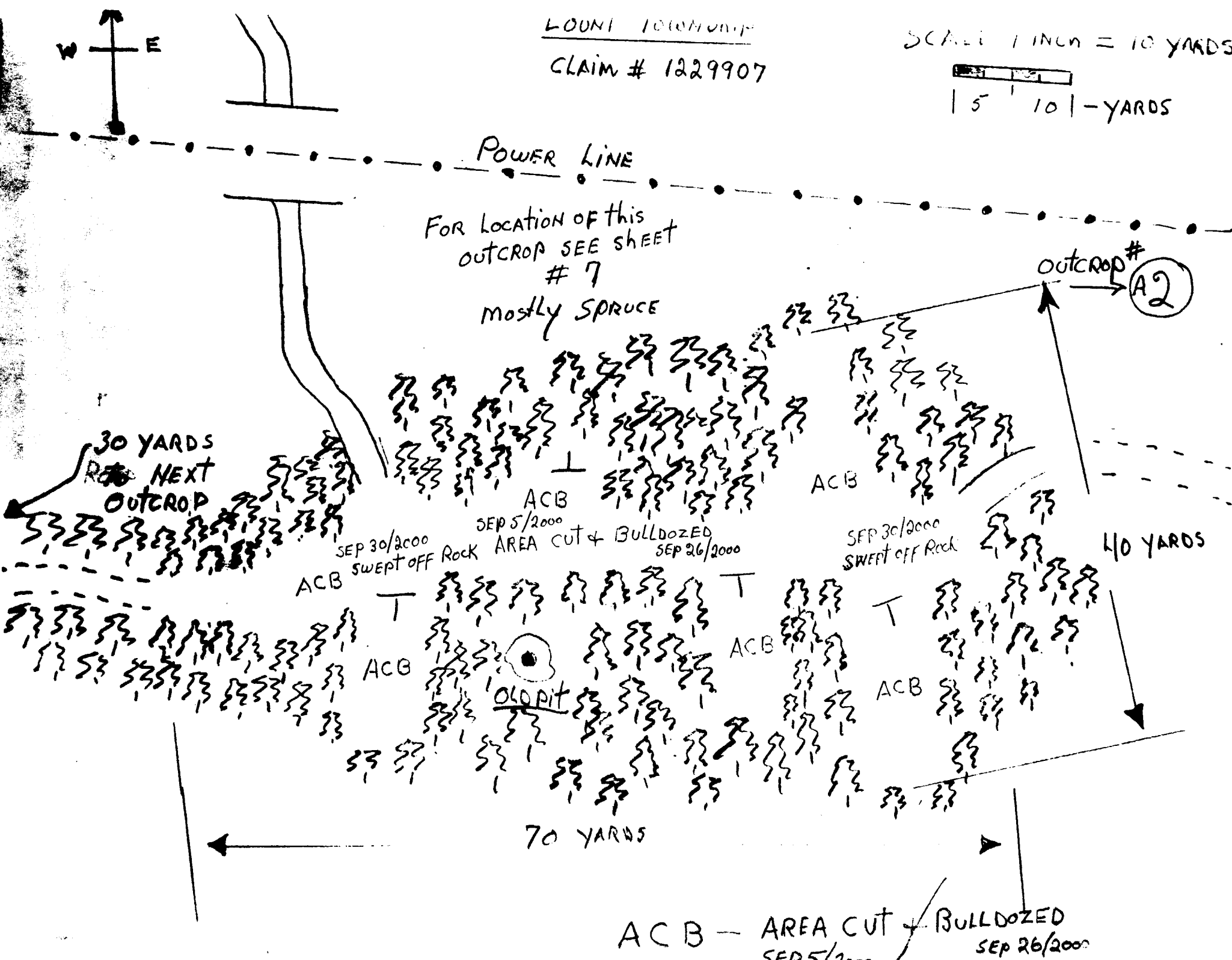

POWER LINE

FOR LOCATION OF THIS
OUTCROP SEE SHEET
7

Mostly SPRUCE

OUTCROP # A2

30 YARDS
ROCK NEXT
OUTCROP

SEP 30/2000
SWEEP OFF
ROCK

SEP 5/2000

AREA CUT + BULLDOZED

SEP 26/2000

SEP 30/2000
SWEEP OFF ROCK

40 YARDS

70 YARDS

ACB - AREA CUT + BULLDOZED
SEP 5/2000 SEP 26/2000

OLOPIT

ACB

ACB

ACB

ACB

ACB

ACB

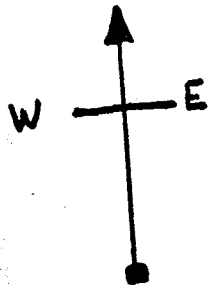

LOUNT TOWNSHIP

CLAIM # 1229907

SCALE 1 INCH = 10 YARDS

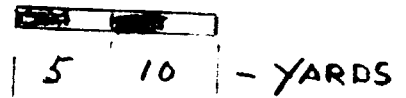

FOR LOCATION OF THIS
OUTCROP SEE SHEET
7

OUTCROP #
→ (A3)

ACB - AREA CUT & BULLDOZED
SEP 6/2000 SEP 26/2000

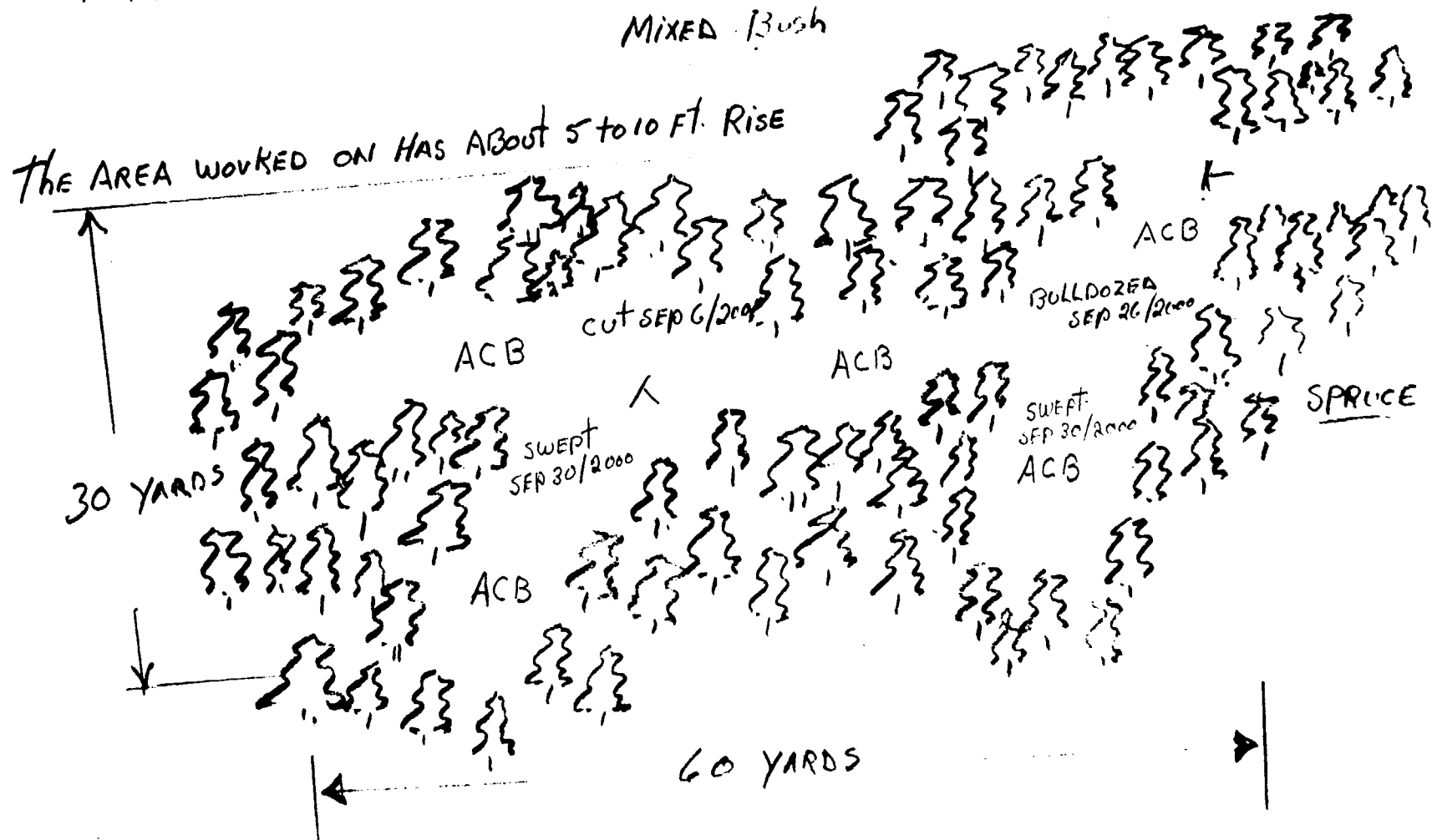

FOR LOCATION OF THIS
OUTCROP SEE SHEET
7

LOUNT TOWNSHIP CLAIM # 1229748

OUTCROP #
A4

SCALE 1 INCH = 10 YARDS

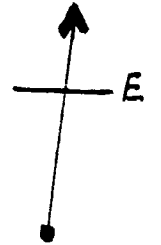
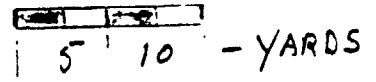

ACB - AREA CUT BULLDOZED
SEP 9/2000 SEP 26/2000
30 FT OR MORE RISE

GARNET OUTCROW

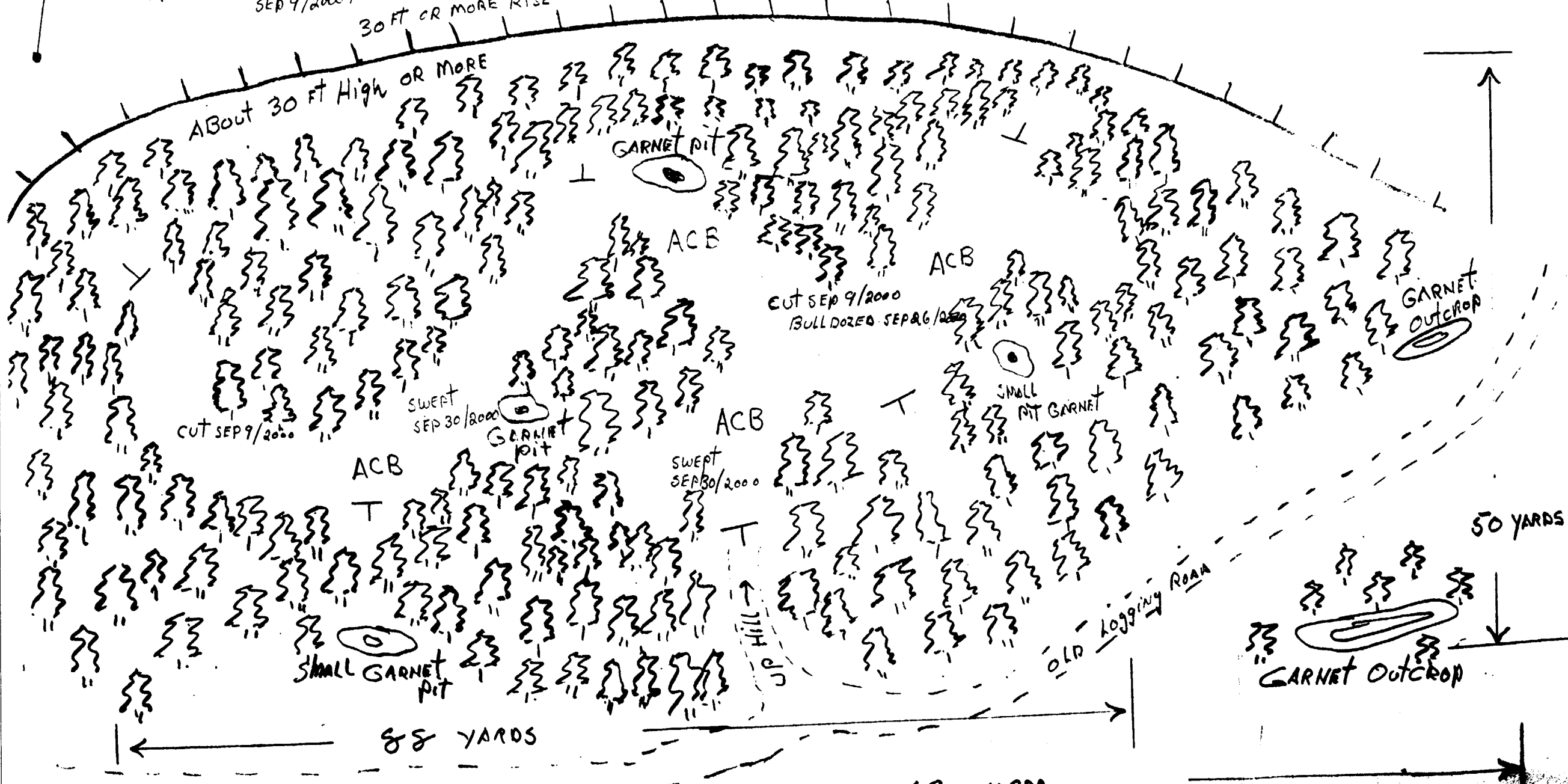

ABOUT 30 FT HIGH OR MORE

GARNET PIT

ACB

CUT SEP 9/2000
BULLDOZED SEP 26/2000

ACB

GARNET OUTCROP

CUT SEP 9/2000

SWEPT
SEP 30/2000

GARNET PIT

SWEPT
SEP 30/2000

ACB

SMALL
PIT GARNET

ACB

SMALL GARNET PIT

50 YARDS

88 YARDS

130 YARDS

OLD LOGGING ROAD

GARNET OUTCROP

LOUNT TOWNSHIP

CLAIM 1237069

SCALE 1 INCH = 10 FEET

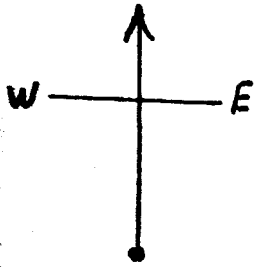

OUTCROP #
A5

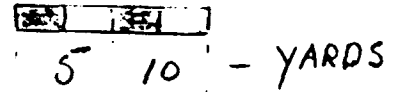

SEP 22/2000 / SEP 26/2000
ACB - AREA CUT / BULLDOZED
FOR LOCATION OF THIS OUTCROP
SEE SHEET # 7

← CLAIM LINE
CLAIM 1229748

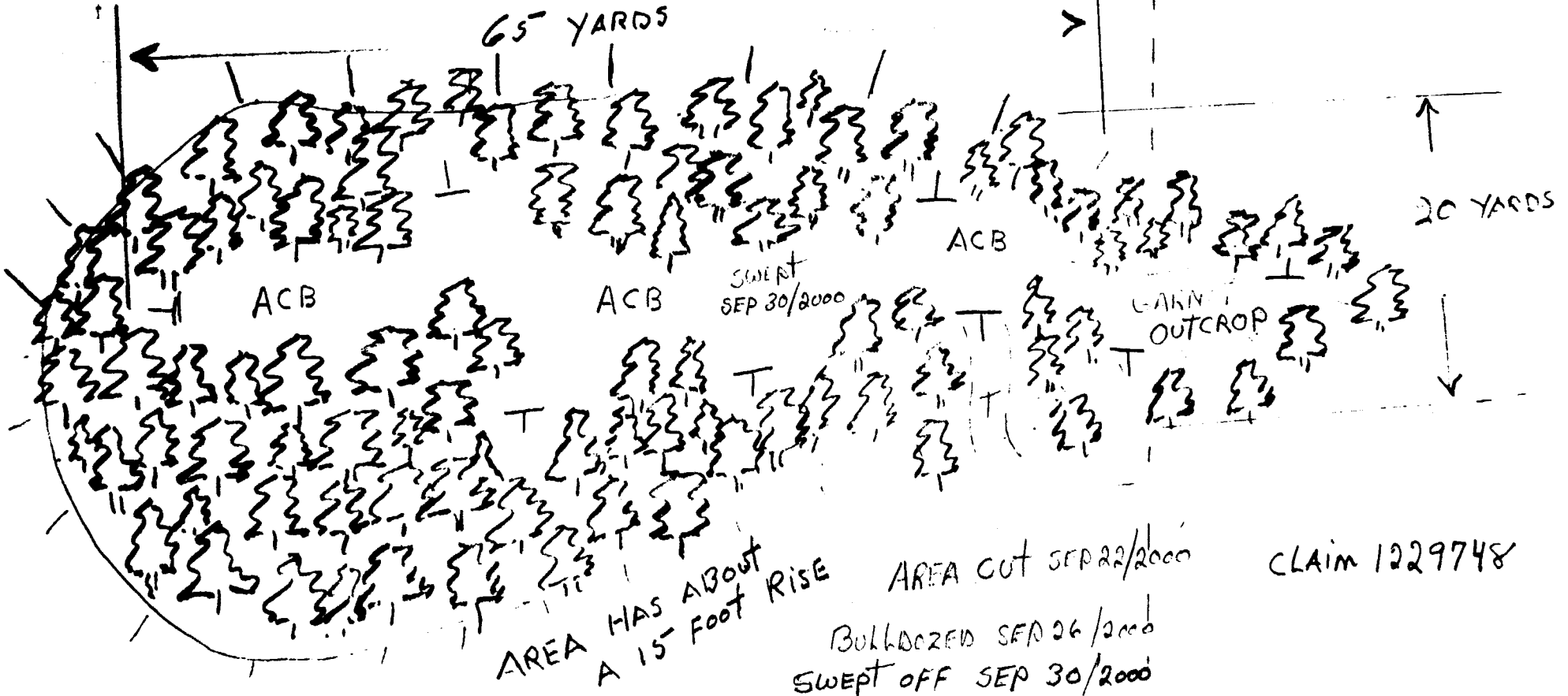

LOONI TOWNSHIP

CLAIM 1231457

→ **AG**

OUTCROP #

FOR LOCATION OF THIS
OUTCROP SEE SHEET
7

SCALE 1 INCH = 20 YARDS



10 | 20 | - 20 YARDS

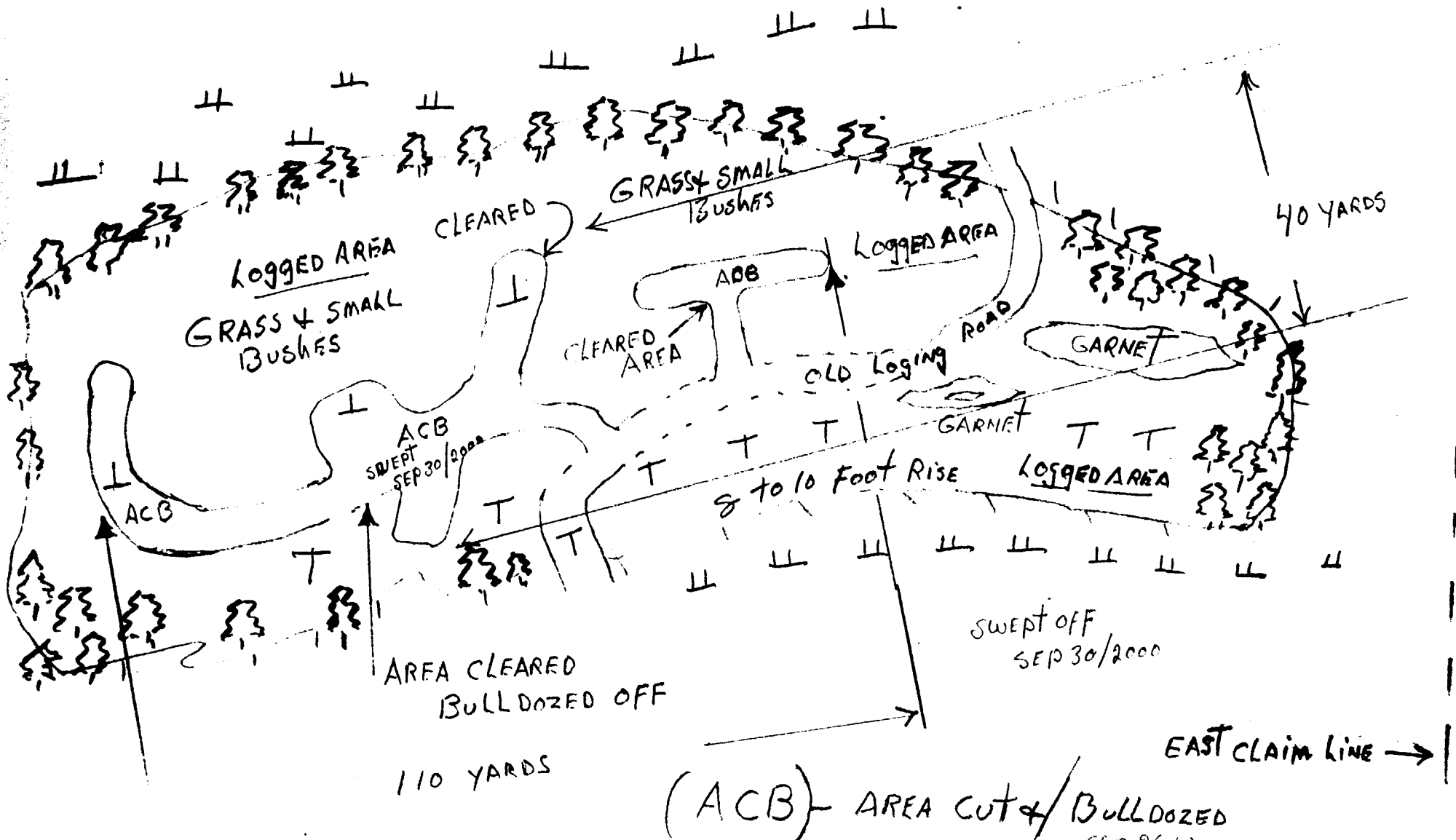
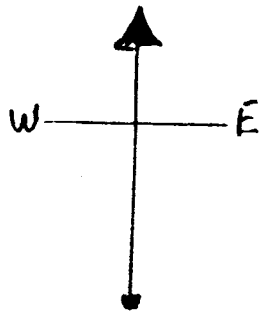

(ACB) AREA CUT & BULLDOZED



31E13SE2004 2.20750 LOUNT

030

Maps (B1) to (B6)

show type of mineral and rock found on cleared area of outcrop.

Map 7 will show location of outcrop on claim.

CLAIM # 1229907

LOUNT TOWNSHIP

SCALE 1 INCH = 10 YARDS

CLAIM # 1229451

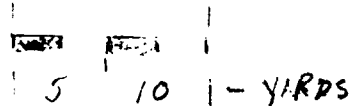

(BI) OC

Mostly SPRUCE

LOC ON MAP #7

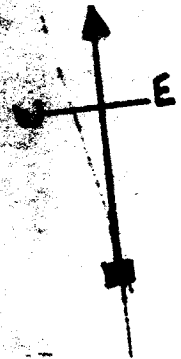

TRAIL IN

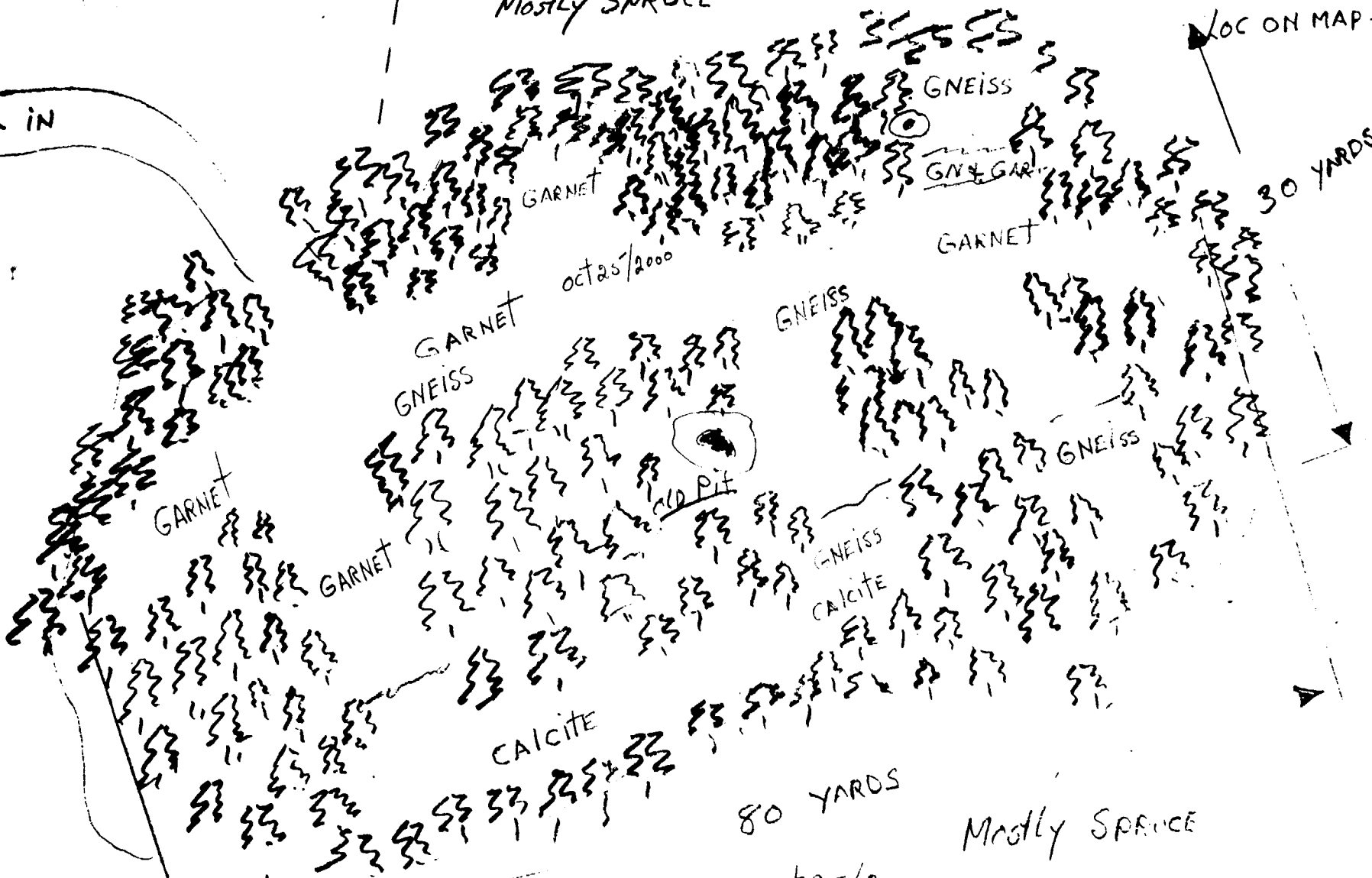

OCT 25 / 2000
FORM OF MINERAL
OR ROCK FOUND

LOUNT TOWNSHIP

CLAIM # 1229907

SCALE 1 INCH = 10 YARDS

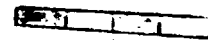

15 10 | - YARDS

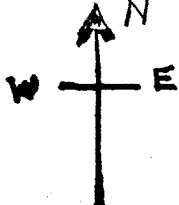

POWER LINE

Mostly SPRUCE

(B 9) OC
LOC ON MAP # 7

30 YARDS
TO NEXT
OUTCROP

GARNET
& GNEISS

GNEISS

40 YARDS

GARNET

GARNET

GARNET

15' GARNET

GNEISS

GNEISS

GARNET

OLD PIT

GNEISS

70 YARDS

OCT 25/2000
FORM OF MINERAL
OR ROCK FOUND

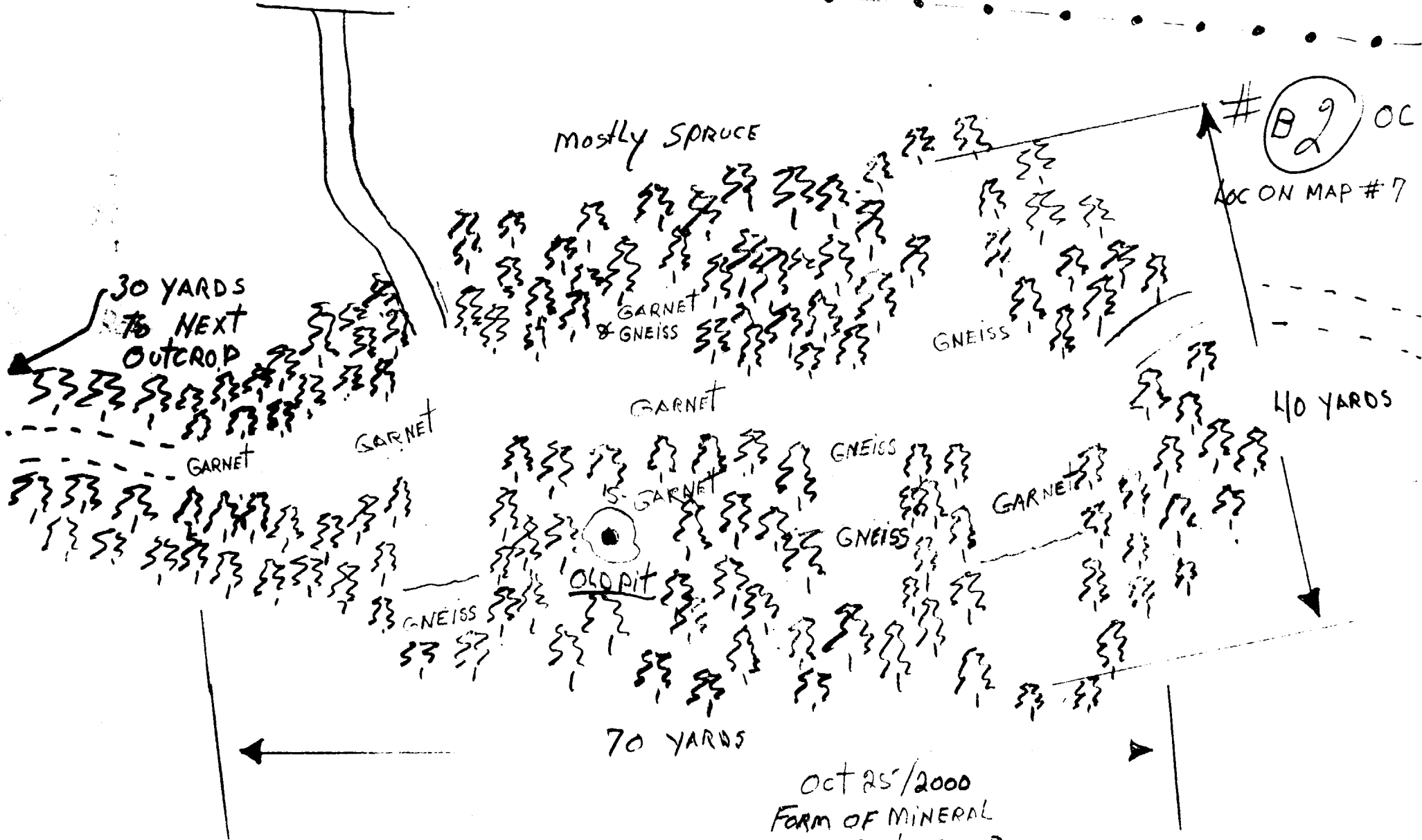

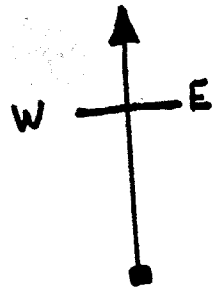

LOUNT Township

Claim # 1229907

SCALE 1 INCH = 10 YARDS

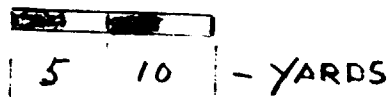

Oct 25/2000
FORM OF MINERAL
OR ROCK FOUND

B3 OC
LOC ON MAP #7

2.20750

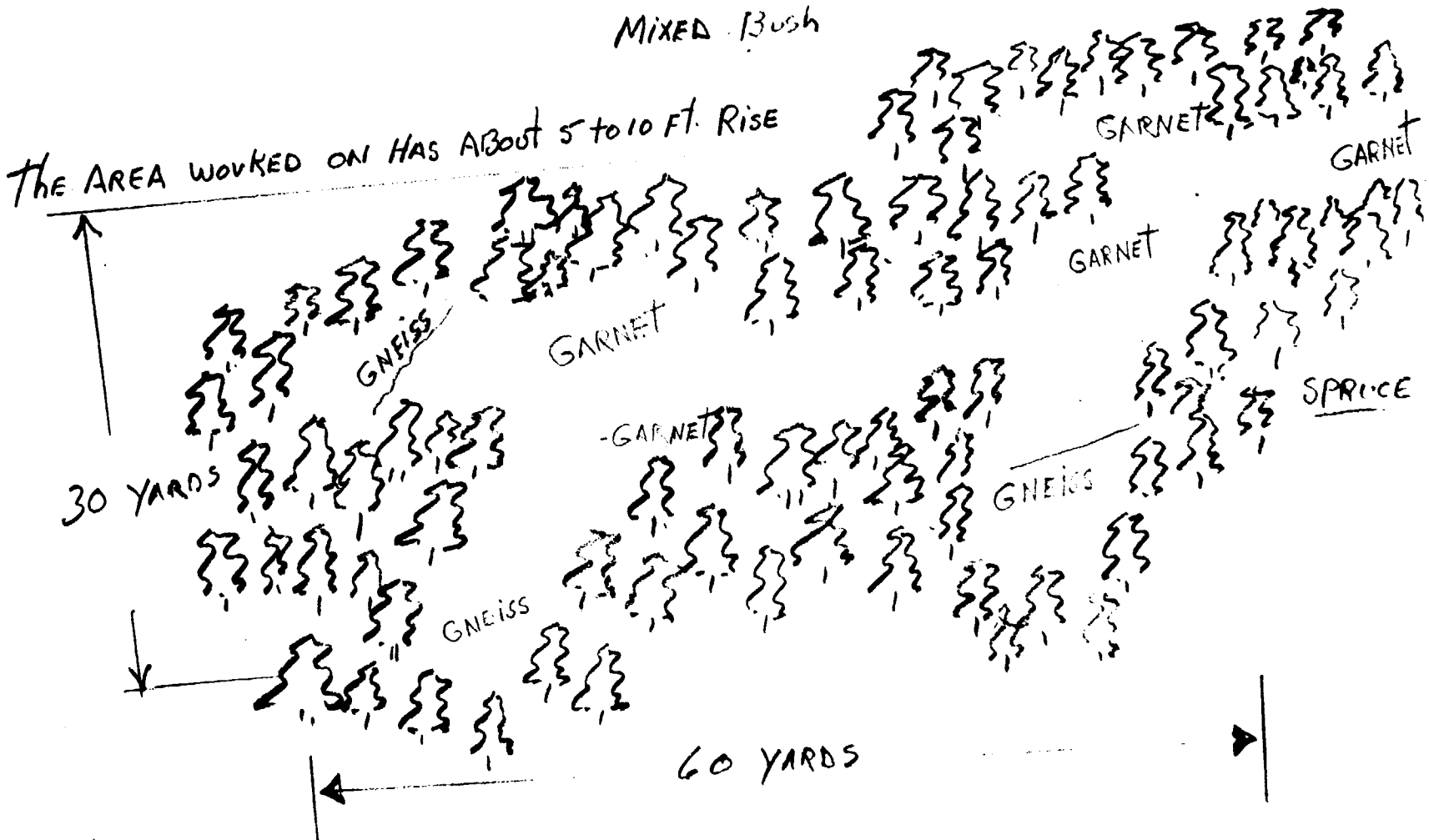

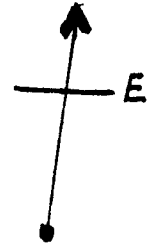

20250

Oct 25/2000
FORM OF MINERAL
OR ROCK FOUND

Lount Township
CLAIM # 1229748

GARNET OUTCROP

B
4 OC
LOC ON MAP # 7

SCALE 1 INCH = 10 YARDS

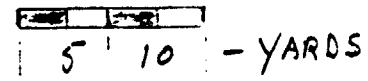

B
4 OC
LOC ON MAP # 7

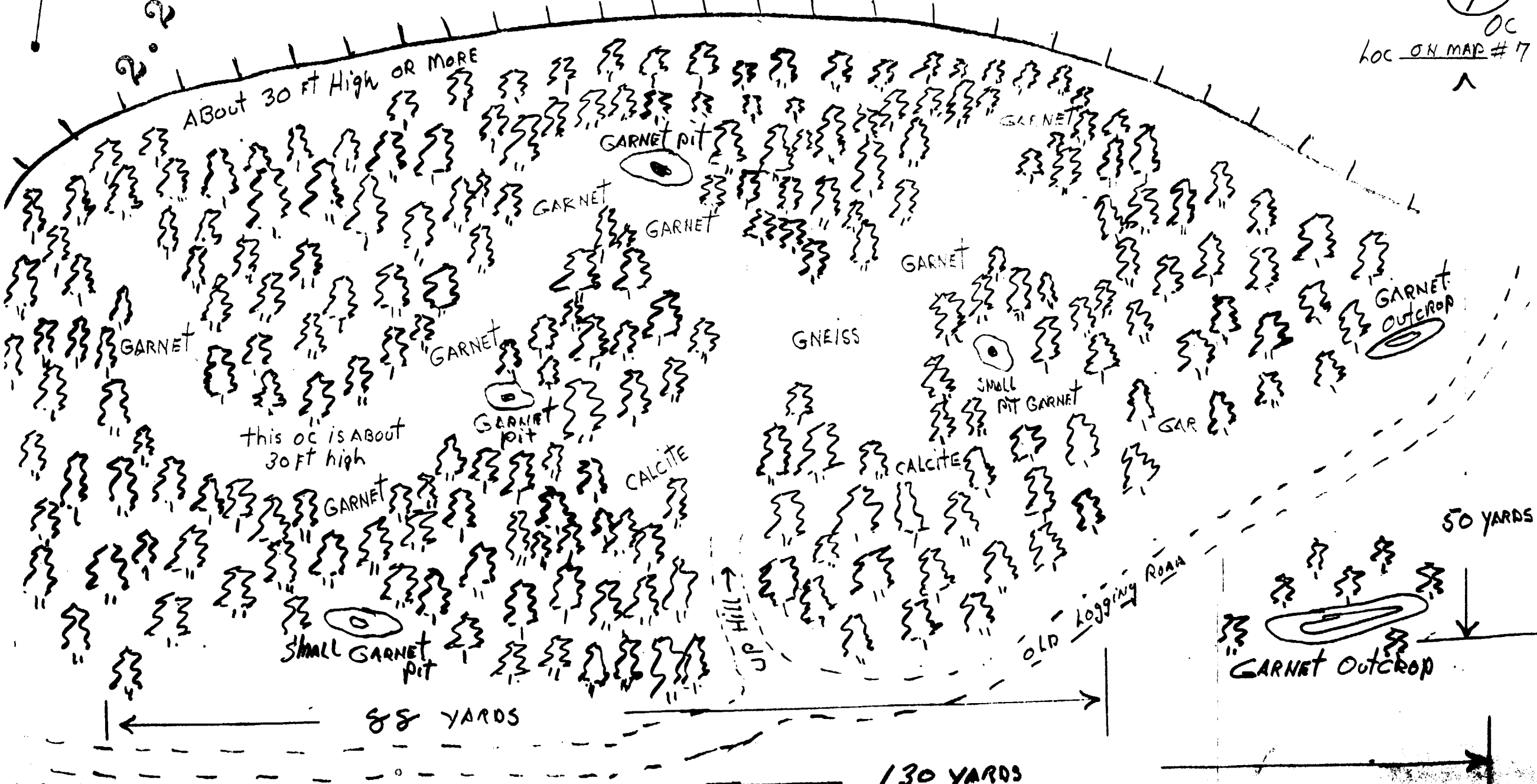

LOUNI TOWNSHIP

CLAIM 1237069

SCALE 1 INCH = 10 YARDS

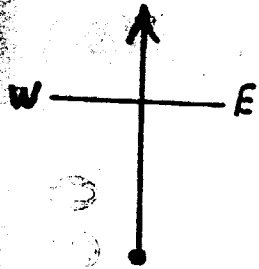

B5 OC



5 10 - YARDS

LOC ON MAP #7

OCT 25/2000
FORM OF MINERAL
OR ROCK FOUND

← CLAIM LINE
CLAIM 1229748

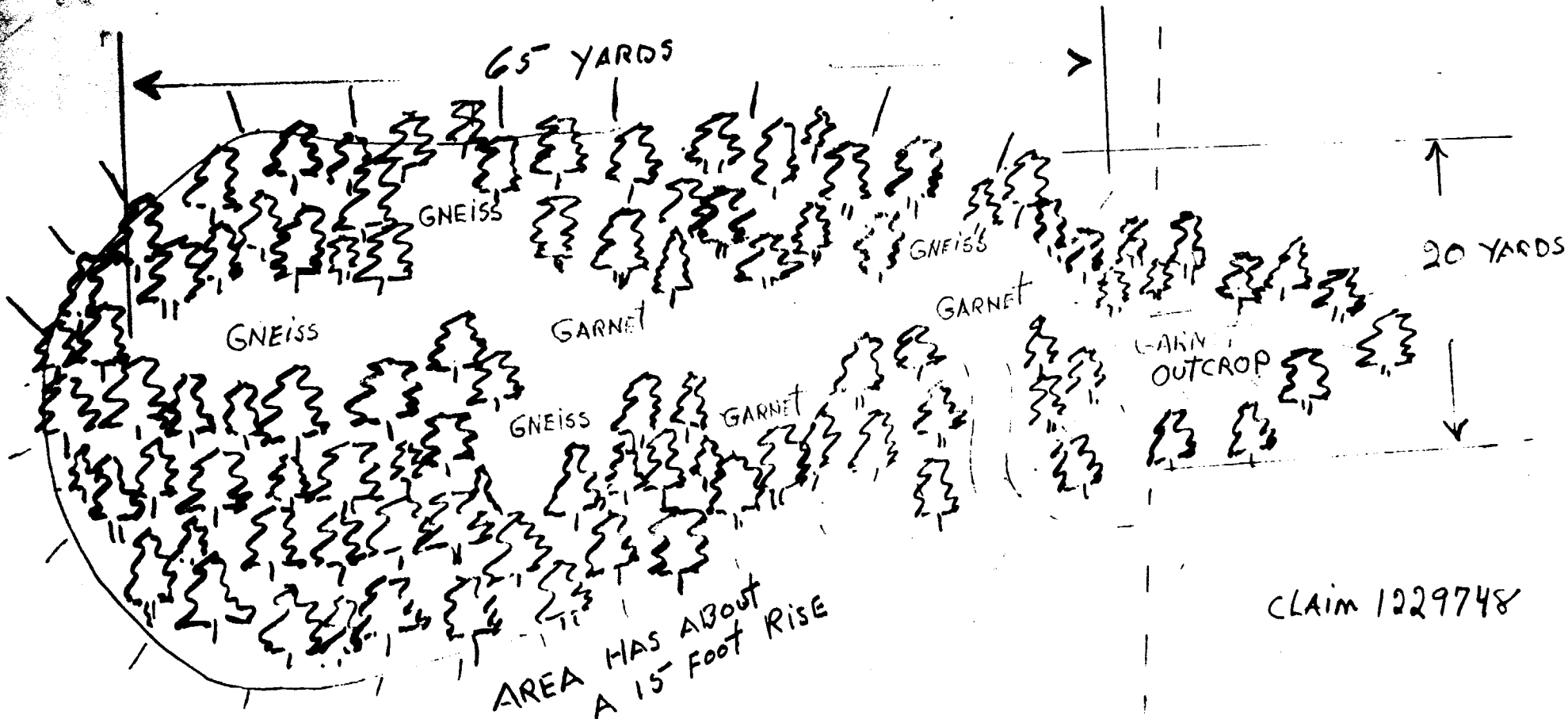

CLAIM 1229748

LOUNI TOWNSHIP

CLAIM 1231457 # (B6) 0C

SCALE 1 INCH = 20 YARDS

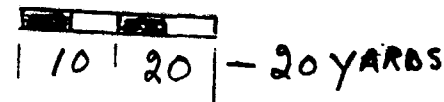
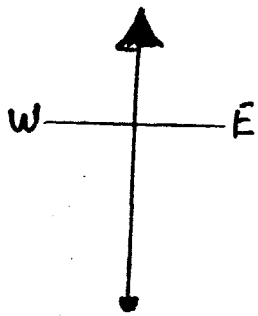

OCT 25/2000
FORM OF MINERAL
OR ROCK FOUND

LOC ON MAP # 7

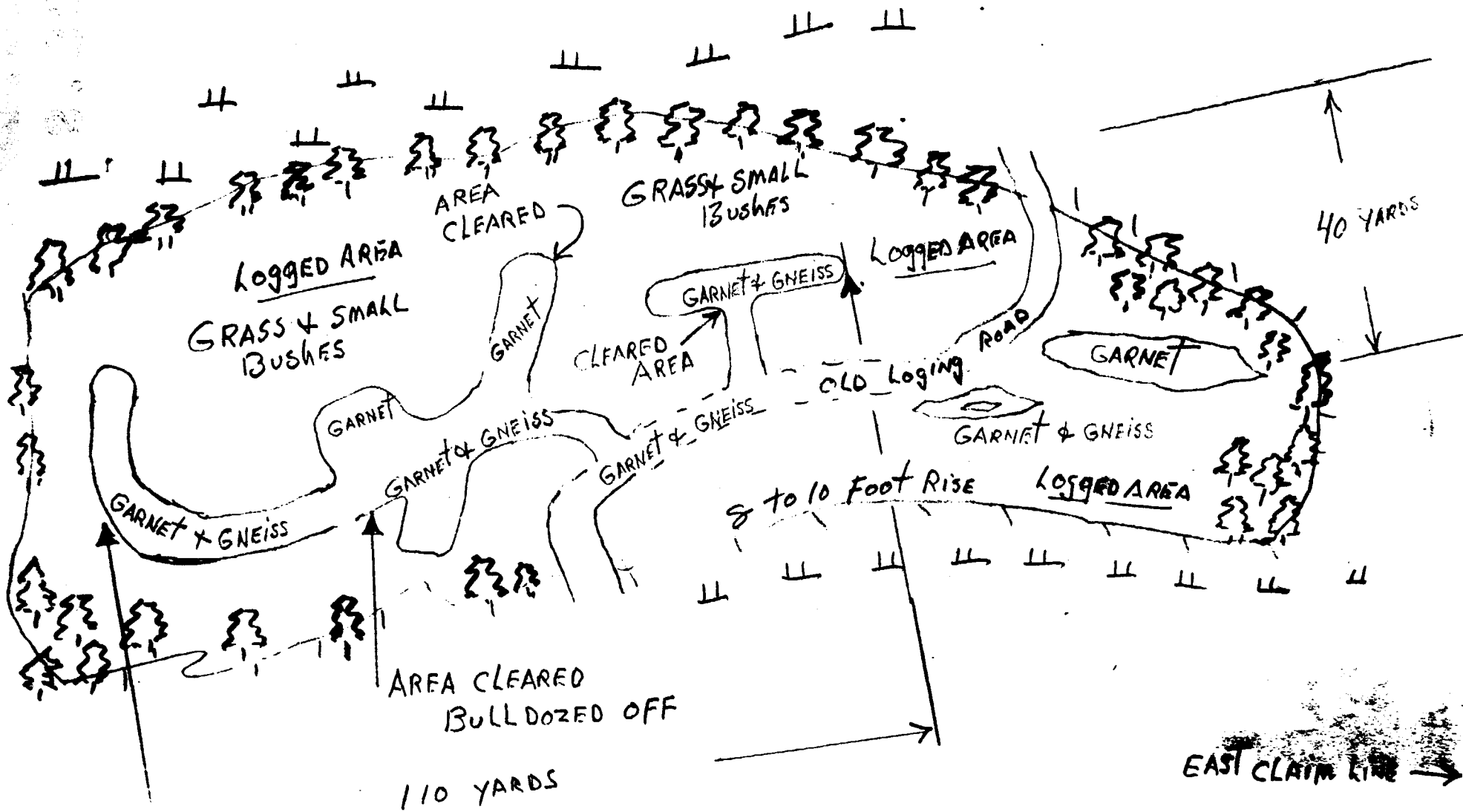

2.20.50

Lount Township

CLAIMS SHEETS → # 7

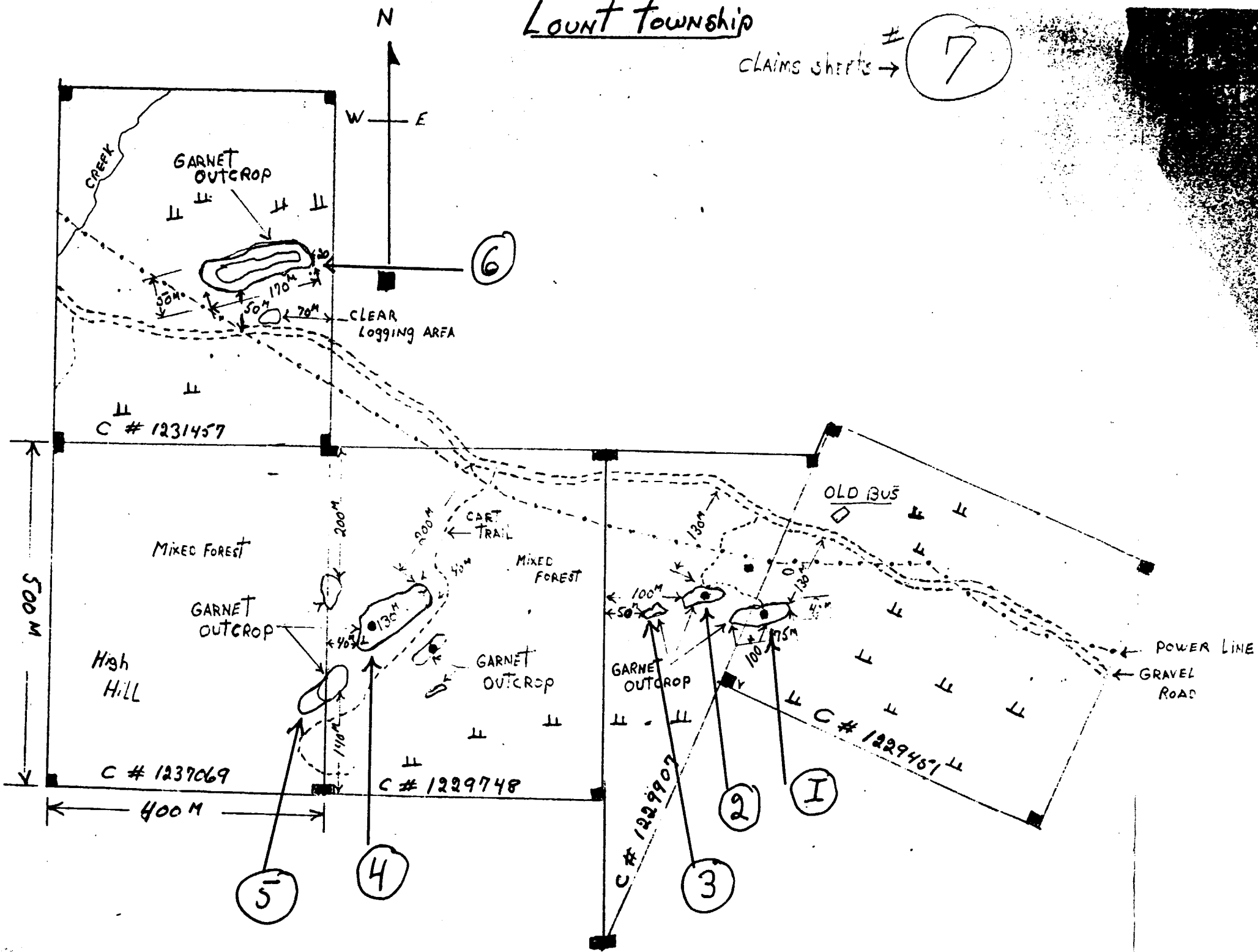

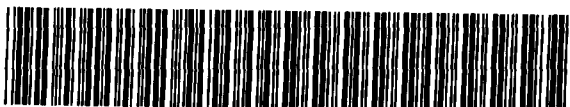

31E13SE2004 2.20750 LOUNT 900

Subsection 65(2) and 66(3) of the Mining Act. Under section 8 of the Mining Act, assessment work and correspond with the mining land holder. Questions about this form should be directed to Northern Development and Mines, 3rd Floor, 933 Ramsey Lake Road, Sudbury, Ontario N2P 2L5.

Instructions: - For work performed on Crown Lands before recording a claim, use form 0240.
 - Please type or print in ink.

2.20750

1. Recorded holder(s) (Attach a list if necessary)

Name RICHARD E BAIN	Client Number 302775
Address RR # 3 G. Box 241 HUNTSVILLE ONT P1H2J4	Telephone Number 705-789-0592
	Fax Number
Name	Client Number
Address	Telephone Number
	Fax Number

2. Type of work performed: Check (✓) and report on only ONE of the following groups for this declaration.

Geotechnical: prospecting, surveys, assays and work under section 18 (regs)	Physical: drilling stripping, trenching and associated assays	Rehabilitation
Work Type Cutting bush and stripping Drawing maps and recording work. Cleaning off outcrops. Geological assessment by (Mike Cosco) ✓		Office Use
Dates Work Performed From 31 Day 08 Month 00 Year To 25 Day 10 Month 00 Year		Commodity
Global Positioning System Data (if available)		Total \$ Value of Work Claimed 4837
Township/Area LOUNT	M or G-Plan Number	NTS Reference
		Mining Division Southern Ontario
		Resident Geologist District Sudbury

Please remember to: - obtain a work permit from the Ministry of Natural Resources as required;
 - provide proper notice to surface rights holders before starting work;
 - complete and attach a Statement of Costs, form 0212;
 - provide a map showing contiguous mining lands that are linked for assigning work;
 - include two copies of your technical report.

3. Person or companies who prepared the technical report (Attach a list if necessary)

Name SAME	Telephone Number
Address	Fax Number
Name	Telephone Number
Address	Fax Number
Name	Telephone Number
Address	Fax Number

4. Certification by Recorded Holder or Agent

I, **RICHARD E BAIN** (Print Name), do hereby certify that I have personal knowledge of the facts set forth in this Declaration of Assessment Work having caused the work to be performed or witnessed the same during or after its completion and, to the best of my knowledge, the annexed report is true.

Signature of Recorded Holder or Agent Richard E Bain	Date Nov. 30/2000
Agent's Address	Telephone Number
	Fax Number

0241 (03/97)

NOTE AFTER DEC 30th/00 contact at
Richard E Bain
20005 SE 100 TERR.
INGLIS FL. 34449.

TEL 352-447-0283.

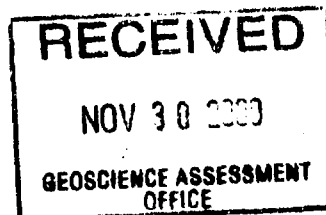

H2905

to be recorded and distributed. Work can only be assigned to claims that are contiguous (adjoining) to the mining work was performed, at the time work was performed. A map showing the contiguous link must accompany this

W0090.00087

2.20750

Claim Number. Or if work was done on other eligible mining land, show in this column the location number indicated on the claim map.	Number of Claim Units. For other mining land, list hectares.	Value of work performed on this claim or other mining land.	Value of work applied to this claim.	Value of work assigned to other mining claims.	Bank. Value of work to be distributed at a future date
eg TB 7827	16 ha	\$26,825	N/A	\$24,000	\$2,825
eg 1234567	12	0	\$24,000	0	0
eg 1234568	2	\$ 8,892	\$ 4,000	0	\$4,892
1 1229907	1	800.00	800.00		
2 1229748	1	800.00	800.00		
3 1231457	1	800.00 614.00	800.00 614.00		\$186.00
4 1229451	1	1200.00 1014.00	1200.00 1014.00		\$186.00
5 1237069	1	1237.57	1237.57		
6					
7					
8					
9					
10					
11					
12					
13					
14					
15					
Column Totals	5	4837.57	4837.57		

Using original Amounts. Client crossed off wrong amounts (work performed) h.p.

I, RICHARD E BAIN (Print Full Name), do hereby certify that the above work credits are eligible under subsection 7 (1) of the Assessment Work Regulation 6/96 for assignment to contiguous claims or for application to the claim where the work was done.

Signature of Recorded Holder or Agent Authorized in Writing: Richard E Bain Date: Nov 30/2000

6. Instruction for cutting back credits that are not approved.

Some of the credits claimed in this declaration may be cut back. Please check (✓) in the boxes below to show how you wish to prioritize the deletion of credits:

- 1. Credits are to be cut back from the Bank first, followed by option 2 or 3 or 4 as indicated.
- 2. Credits are to be cut back starting with the claims listed last, working backwards; or
- 3. Credits are to be cut back equally over all claims listed in this declaration; or
- 4. Credits are to be cut back as prioritized on the attached appendix or as follows (describe):

Note: If you have not indicated how your credits are to be deleted, credits will be cut back from the Bank first, followed by option number 2 if necessary.

For Office Use Only

Received Stamp	Deemed Approved Date	Date Notification Sent
	Date Approved	Total Value of Credit Approved
	Approved for Recording by Mining Recorder (Signature)	

0241 (03/97)

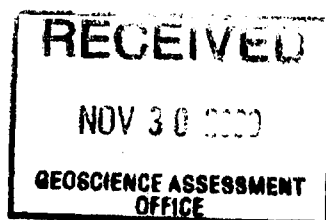

Information collected on this form is obtained under the authority of subsection 6 (1) of the Assessment Work Regulation 6/96. Under section 8 of the Assessment Act, this information is a public record. This information will be used to review the assessment work and correspond with the mining land holder. For further information about this collection should be directed to a Provincial Mining Recorder, Ministry of Northern Development and Mines, 3rd Floor, 933 Ramsey Lake Road, Sudbury, Ontario, P3E 6B5.

2,200.50

Work Type	Units of work Depending on the type of work, list the number of hours/day worked, metres of drilling, kilometres of grid line, number of samples, etc.	Cost Per Unit of work	Total Cost
CUTTING TREES (4 people)	5	600.00	3,000.00
BULLDOZING (1 person)	1	150.00	150.00
Cleaning rocks (2 people)	1	150.00	300.00
Assisting geologist identify rocks.	1	150.00	150.00
drawing maps + recording work (1 person)	2	150.00	300.00
Associated Costs (e.g. supplies, mobilization and demobilization).			
Bulldozing (receipt enclosed)	1 day		505.50
Transportation Costs			
1,440 Km to and from claims		.30 per k	432.00
Food and Lodging Costs			
Total Value of Assessment Work			4,837.57

Calculations of Filing Discounts:

1. Work filed within two years of performance is claimed at 100% of the above Total Value of Assessment Work.
2. If work is filed after two years and up to five years after performance, it can only be claimed at 50% of the Total Value of Assessment Work. If this situation applies to your claims, use the calculation below:

TOTAL VALUE OF ASSESSMENT WORK $\times 0.50 =$ Total \$ value of worked claimed.

Note:

- Work older than 5 years is not eligible for credit.
- A recorded holder may be required to verify expenditures claimed in this statement of costs within 45 days of a request for verification and/or correction/clarification. If verification and/or correction/clarification is not made, the Minister may reject a or part of the assessment work submitted.

Certification verifying costs:

I, RICHARD E BAIN (please print full name), do hereby certify, that the amounts shown are as accurate as may reasonably be determined and the costs were incurred while conducting assessment work on the lands indicated on the accompanying

Declaration of Work form as _____ I am authorized to make this certification (recorded holder, agent, or state company position with signing authority)

Signature <u>Richard E Bain</u>	Date <u>Nov 30/2008</u>
------------------------------------	----------------------------

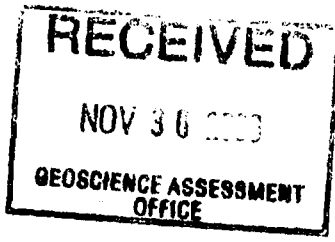

April 6, 2001

Richard E. Bain
307482 ONTARIO LIMITED
RR# 3, GROUP BOX 241
HUNTSVILLE, ONTARIO
P1H-2J4

Geoscience Assessment Office
933 Ramsey Lake Road
6th Floor
Sudbury, Ontario
P3E 6B5

Telephone: (888) 415-9845
Fax: (877) 670-1555

Dear Sir or Madam:

Submission Number: 2.20750

Status

Subject: Transaction Number(s): W0090.00087 Approval After Notice

We have reviewed your Assessment Work submission with the above noted Transaction Number(s). The attached summary page(s) indicate the results of the review. **WE RECOMMEND YOU READ THIS SUMMARY FOR THE DETAILS PERTAINING TO YOUR ASSESSMENT WORK.**

If the status for a transaction is a 45 Day Notice, the summary will outline the reasons for the notice, and any steps you can take to remedy deficiencies. The 90-day deemed approval provision, subsection 6(7) of the Assessment Work Regulation, will no longer be in effect for assessment work which has received a 45 Day Notice. Allowable changes to your credit distribution can be made by contacting the Geoscience Assessment Office within this 45 Day period, otherwise assessment credit will be cut back and distributed as outlined in Section #6 of the Declaration of Assessment work form.

Please note any revisions must be submitted in DUPLICATE to the Geoscience Assessment Office, by the response date on the summary.

If you have any questions regarding this correspondence, please contact JIM MCAULEY by e-mail at james.mcauley@ndm.gov.on.ca or by telephone at (705) 670-5858.

Yours sincerely,



ORIGINAL SIGNED BY
Lucille Jerome
Acting Supervisor, Geoscience Assessment Office
Mining Lands Section

Work Report Assessment Results

Submission Number: 2.20750

Date Correspondence Sent: April 06, 2001

Assessor: JIM MCAULEY

Transaction Number	First Claim Number	Township(s) / Area(s)	Status	Approval Date
W0090.00087	1229907	LOUNT	Approval After Notice	April 05, 2001

Section:

10 Physical PSTRIIP

The 45 days outlined in the Notice dated February 19, 2001 have passed. No new information has been provided.

Assessment work credit has been approved as outlined on the attached Distribution of Assessment Work Credit sheet.

The assessment credit is being reduced by \$1,270. The TOTAL VALUE of assessment credit that will be allowed, based on the information provided in this submission, is \$3,567.

At the discretion of the Ministry, the assessment work performed on the mining lands noted in this work report may be subject to inspection and/or investigation at any time.

Correspondence to:

Resident Geologist
Sudbury, ON

Recorded Holder(s) and/or Agent(s):

Richard E. Bain
307482 ONTARIO LIMITED
HUNTSVILLE, ONTARIO

Assessment Files Library
Sudbury, ON

Distribution of Assessment Work Credit

The following credit distribution reflects the value of assessment work performed on the mining land(s).

Date: April 06, 2001

Submission Number: 2.20750

Transaction Number: W0090.00087

<u>Claim Number</u>	<u>Value Of Work Performed</u>
1229907	590.00
1229748	590.00
1231457	590.00
1229451	885.00
1237069	912.00
Total: \$	3,567.00

LEGEND

- CANCELLED
- PATENTED LAND
- CROWN LAND SALE
- LEASES
- LOCATED LAND
- LICENSE OF OCCUPATION
- MINING RIGHTS ONLY
- SURFACE RIGHTS ONLY

- C
- P
- C.S
- L
- LOC
- L.O
- M.R.O
- S.R.O

400' Surface rights reservation around all lakes & rivers.

LOUNT

EASTERN ONTARIO MINING DIVISION
Scale 40 Chains - 1 Inch

PRINGLE

Areas withdrawn from staking under Section 4th of the Mining Act, R.S.O. 1970

File	Date	Disposition
160707	31/8/72	S.R.O
171870	22/7/85	S.R.M.R
	22/7/85	S.R.O Order No W 3-85
SEC. 35 W.L.L.C75/89 ONT May 11/89 M&S		
SEC. 35 W.L.L.C 80/00 May 30/00 M&S		

THE INFORMATION THAT APPEARS ON THIS MAP HAS BEEN COMPILED FROM VARIOUS SOURCES AND ACCURACY IS NOT GUARANTEED. THOSE WISHING TO STAKE MINING CLAIMS SHOULD CONSULT WITH THE MINING RECORDER, MINISTRY OF NORTHERN DEVELOPMENT AND MINES, FOR ADDITIONAL INFORMATION ON THE STATUS OF THE LANDS SHOWN HEREON.

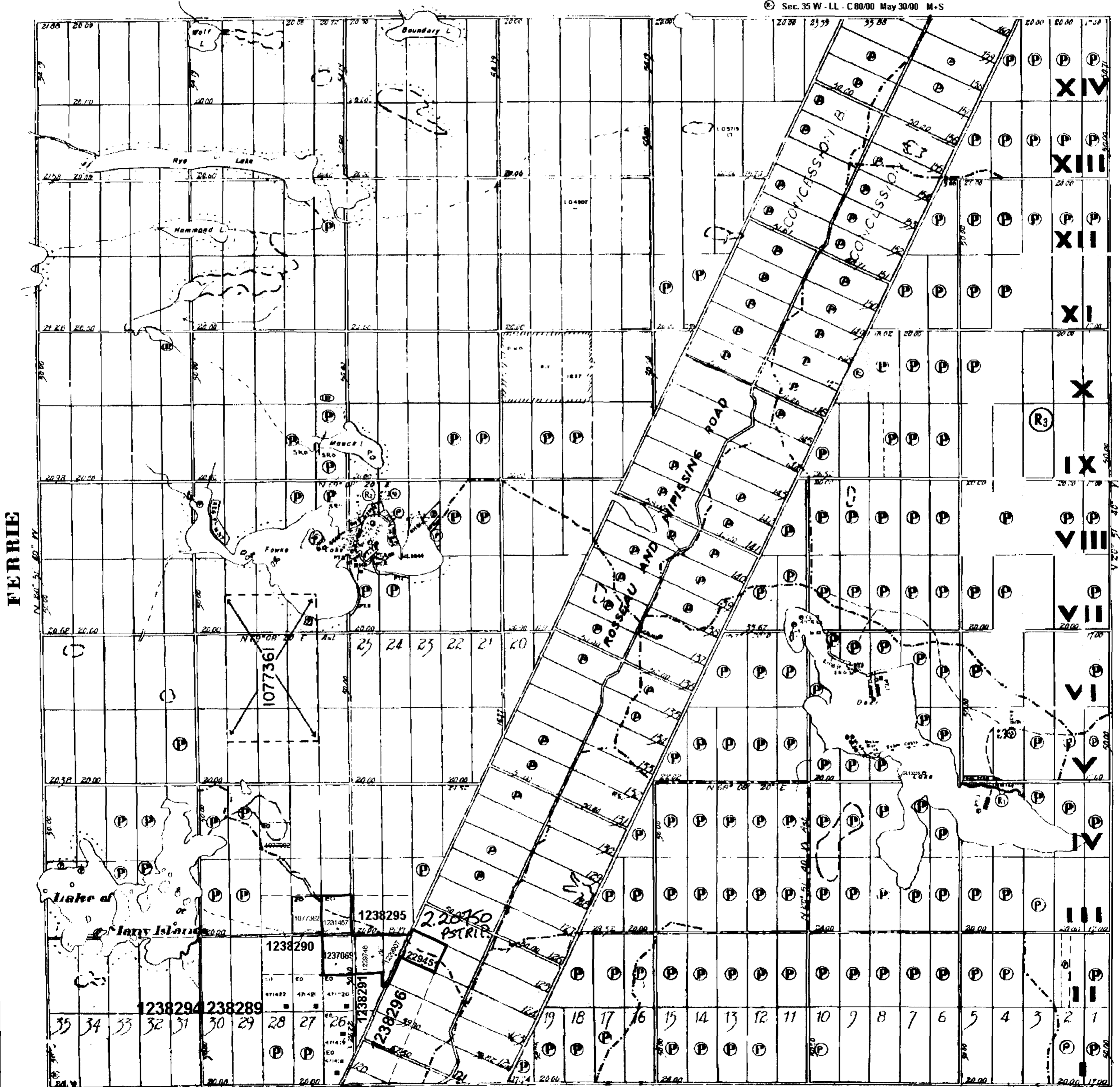

FERRIE

MACHAR

CHAPMAN
LOUNT TWP

