



DESCRIPTION OF WORK AND RESULTS

Cripple Creek Flagstone Prospect

This site was discovered in 1993 during prospecting for stone performed by the author (Figure 3). After completion of a geological survey over a flagged grid, backhoe and manual stripping over part of the Cripple Creek flagstone prospect in McCraney Township was performed during August 16 to October 24, 1995 (*see* Figure 4, Photos 1 and 2). Eighteen hours of backhoe work was carried out during August 27-29 and was performed by Chartrand Bulldozing of Emsdale using a Massey-Ferguson 60H backhoe with front-end loader. Other work during August 27, 1994 to October 4, 1995 consisted of prospecting, geological surveying, and sampling, including preparation of a thin section for petrographic analysis (Mandziuk 1994). Easy access for future bulk sampling and extraction of granitic gneiss flagstone from a potential quarry face was readily established during stripping in 1995, and a small pile of loosened material weighing approximately one tonne was pulled off the face by a steel cable attached to the backhoe. The loose material broke up during descent to reveal the presence of good quality flagstones in both orange-pink and schistose sparkling grey colours, with good splitting properties in a variety of thicknesses (~1cm to >20cm). Selected samples of these flagstones were stockpiled at the stripped site. Other loose material exposed during the stripping had slab surface dimensions of up to 1.5m across. Greater than 60% of the stone exposed at the site is estimated to be amenable to a variety of possible landscaping and decorative building stone applications, and this percentage should increase with selective light blasting of the face to penetrate less weathered material.

The stripping site is part of a 300-metre ridge of steep to overhanging northeast dipping (35-45°) rock scarps trending along, and situated approximately 50 to 60 metres east of, the road (formerly a railway) leading to Rain Lake in Algonquin Park (Figure 4). From Highway 11, the site is accessible via Highway 518 past Kearney, east for approximately 20 kilometres to 0.5 kilometres past Round Lake. The rock scarp at the stripped site is approximately 15m high and stepped with moderate overhangings. Orange-pink granitic gneiss comprises most of the rock which is strongly foliated and banded with a finely sparkling sugary lustre and grey biotitic ribbons set in a granoblastic quartzofeldspathic matrix (0.5mm), with evenly dispersed porphyroblasts of lensoid to streaky quartz+feldspar. The stone is variably flaggy to fissile, well-layered, hard, tough, and attractive; with a characteristic streaky felsic ribbon lineation typical of Grenville paragneisses occurring within ductile shear zones. Sparkling, greyish granitic gneiss with more than 20% mafic biotitic layers comprises less than 1/3 of the stripped area and is gradationally interlayered with the orange-pink granitic gneiss. The colour and fabric variations among these two types of gneisses is complementary with regard to combined flagstone applications. On average, the mineral components and their volumetric ranges consist of perthitic potassium feldspars (40-45%), quartz (30-35%), plagioclase (10-15%), biotite (5-20%), and magnetite (1-2%). The rocks are considered to be metamorphically derived from interbedded arkoses and arkosic wackes.

THIN SECTION PETROGRAPHIC ANALYSIS: Z94-9/24 Cripple Creek (unit 1)

MINERALOGY:	%
K-feldspar (perthite)	40-45
Quartz	30-35
Plagioclase feldspar (albite)	10-15
Biotite	5
Opagues	1-2
Alteration of feldspars (sausserite)	1-2
Garnet (almandine)	Trace
Zircon	Trace

The perthitic intergrowth consists of parallel to subparallel exsolved plagioclase blebs hosted by alkali feldspar. Average grain size is 0.5mm. Opaque phase is magnetic (magnetite). Varying proportions of the mafic and felsic minerals give the rock a banded appearance and the alignment of the biotite grains imparts a strong and pervasive mineral foliation to the rock. Approximate plagioclase composition was obtained via the Michel-Lévy method.

The structural geology of the Cripple Creek prospect is the result of strong shearing along a zone of ductile thrust faulting on the northern boundary of the Novar lithotectonic domain (Mandziuk 1994). The low to moderate density of jointing on the prospect has a range of spacing from 0.5m to >2.0m. Most of the rocky ridge consists of flaggy exposures which can be manually split; and multiple-face side-hill extraction by light blasting and mechanized quarrying is proposed for this deposit. The marketable flagstone resources in this deposit are estimated to be approximately 100,000 tonnes, with a 30-40% volume of waste or secondary lesser value material.

Sausage Lake Dimension Stone Prospect

The Sausage Lake prospect in Laurier Township is located 6.5 kilometres southeast of Highway 11 at Trout Creek, along the recently upgraded South River road (Figure 5). This prospect was discovered in 1993 during regional prospecting for dimension stone. The work carried out by the author on this two-claim block unit has included prospecting, geological mapping over a flagged grid (*see* Map), petrographic analysis, preparation of sample polished tiles, extraction of a test block for ASTM testing, diamond drilling, and backhoe and manual stripping. Altered coarse grained massive anorthosite and gabbroic (mafic) anorthosite (unit 1) comprise the most abundant and best quality rock type for dimensional stone on the property. The rock is attractive and unique from the perspective of a potential 'granite' stone commodity. The colouration is greyish to brownish purple with a faint plagioclase schiller and a well-developed porphyroblastic fabric. Mineralogy consists of plagioclase (30-40%), potassium feldspar (20-25%), quartz (10-15%), amphibole+biotite (10-20%), garnet (<5%), and magnetite (~1%). Medium to fine grained phases of the anorthosite (unit 2) are related hypabyssal rocks of similar colour and composition which occur as minor dykes generally a few metres in width or less. Hybridized mottled rocks enriched in potassium feldspar (unit 3) and associated diabase (unit 4) were also observed during the previous work on the property. Thin (1-5mm), planar quartz-feldspar veining is found in all rock types, but does not appreciably diminish the appearance of the potential stone resources.

THIN SECTION PETROGRAPHIC ANALYSIS: Z94-11/8 Sausage Lake (unit 1)

MINERALOGY:	%
Plagioclase feldspar (oligoclase-andesine)	30-35
K-feldspar (orthoclase)	20-25
Quartz	10-15
Amphibole (hornblende)	5-10
Biotite	5-10
Garnet (almandine)	5
Quartz + K-spar granophyric intergrowth	3
Opagues (magnetite)	1
Zircon	Trace
Apatite	Trace
Alteration of feldspars (sausserite + sericite)	to 1%

The plagioclase grains show bent polysynthetic twinning and a undulose extinction. The large size of the plagioclase grains (to 5mm) compared to the rest of the mineralogy (average 0.5mm) imparts a porphyroblastic fabric to the rock. The garnets are pink in colour (almandine-rich) and the opaque phase is strongly magnetic (magnetite). Strong undulose extinction and bent albite twins make the determination of plagioclase feldspar composition difficult.

THIN SECTION PETROGRAPHIC ANALYSIS: Z94-11/8 Sausage Lake (unit 3)

MINERALOGY:	%
K-feldspar (orthoclase?)	35-40
Plagioclase feldspar (An ₂₇ - oligoclase)	15-20
Quartz	15-20
Biotite	3-5
Opagues (magnetite)	2-3
Amphibole (hornblende)	2
Garnet (almandine)	1-2
Zircon	Trace
Apatite	Trace
Fe-oxide staining	5-10
Alteration of feldspars (sausserite + sericite)	5-10

The large size of the K-feldspar grains (to 1cm) compared to the rest of the mineralogy (average 0.5mm) imparts a porphyroblastic fabric to the rock. Plagioclase is highly sausseritized: with a few grains to 90%. Approximate plagioclase composition was obtained via the Michel-Lévy method. Opaque phase is magnetic (magnetite). The garnets are pink in colour (almandine-rich), highly fractured and are altered to iron-oxides.

Three diamond drill holes (total length 52.21m) of vertical dip were put down over the Sausage Lake prospect in July and August 1995. The drill was a portable gasoline-powered Winkie model which was transported by all-terrain-vehicle and fastened by bolt to the outcrop surfaces during drilling. Locations are shown on the accompanying map and additional details are provided on drill logs and sections. Drilling was performed over Area 1 (*see* Map), which was identified during prospecting work in 1994 as a primary favourable area for initial test quarrying (Mandziuk 1994). The purpose of the drilling component of this project was to assess lithological uniformity, building stone quality, fracturing, and potential quarry block reserves in the western part of the Sausage Lake prospect. The drill holes were situated to form a roughly triangular pattern

designed to provide as much significant information on Area 1 as possible. The constraints on hole locations were: physiography, ATV access, depth of overburden, and water supply for drilling. The drill core is stored in Toronto.

The best results from drilling were obtained in drill holes SLZ95-1 and SLZ95-2, and in the upper 10 metres of hole SLZ95-3. Competent unfractured sections of uniform fabric and composition which are greater than 1 metre in length along the core axis comprise the favourable horizons. Most of the fracturing encountered was generally minor and localized or related to horizontal sheeting; and would contribute an average waste factor of about 10-20%. The depth of pale grey coloured weathering in drill core is generally less than 25cm. A more significant waste factor of >20% is related to the combination of: (1) small but prominent faults at 10-20° T.C.A. which are generally spaced a few metres apart, have limonitic or hematitic coatings and selvages, and altered margins mottled by red K-feldspars; (2) cataclastic zones of a few centimetres in width which contain granulated and rounded plagioclase porphyroblasts in a mafic-enriched and microfractured matrix; (3) narrow cross-cutting dykes of diabase and inhomogeneous intermediate anorthosite dykes and hybridized rocks such as occur in the lower half of hole SLZ95-2. In the east part of Area 1 the number of dykes and hybridized rocks appears to increase on surface and at depth, and thus limits the extent of quarriable stone in that direction. The potential extent of good stone in the flat area of shallow overburden to the north is more favourable.

Drill logs for holes SLZ95-1, SLZ95-2, and SLZ95-3 are presented on the following pages and drill sections are included in the appendices in Figures 6-8.

**Sausage Lake Stone Prospect
Hole: SLZ95-1**

Claim: 1040764, South 1/2 Lot 25 Con. 13, McClintock Twp. Grid Location: 1+25E, 0+01N
Drilled by: W.C. Ellerington Start: July 4, 1995 Finish: July 8, 1995 Dip: 90⁰ Depth: 14.76m
Core: "E" (7/8") Logged by: Z. Mandziuk Oct. 4, 1995, Core stored: 31 Nassau St. Toronto.

<u>DEPTH</u> metres	<u>DESCRIPTION</u>
0.00 - 6.41	<u>Unit 1b</u> : Mafic Anorthosite. Coarse grained, porphyroblastic to massive; with subhedral, ovoid, weakly labradorescent, and moderately strained plagioclase porphyroblasts comprising up to 40% of the essential minerals. Plagioclase megacrysts (up to >20mm) are occasionally rimmed and penetrated by quartz + potassium feldspar, and supported by a sparse interlocking and interstice-filling inequigranular matrix of subhedral quartz + potassium feldspar (15-25%), amphibole + biotite (10-20%), red garnet (<2%), and finely dispersed magnetite (~1%). The rock is dark greyish-purple to brownish-purple; and generally uniform and competent in sections of over 1 metre along the core axis. Gradations into darker cataclastic zones with granulated and poorly-sorted broken feldspar porphyroblasts within a mafic biotitic matrix occur at depths of 3.35-3.60m and 3.98-4.04m.
6.41 - 6.75	<u>Unit 1a</u> : Intermediate Anorthosite. Lighter grey colouration than above unit and mottled with pinkish K-feldspars, and reddish hematitic alteration near intersecting fractures at 6.70m. This interval is a zone of weak alteration with gradational contacts.
6.75 - 11.33	<u>Unit 1b</u> : Mafic Anorthosite. Uniformly coarse grained, porphyroblastic, and massive with occasional thin pinkish quartz + K-feldspar planar veining. Same as interval 0.00-6.41m. Interstitial randomly oriented, irregular flame-like mafic patches are composed of fine to medium grained amphibole + biotite + magnetite. Megacrystic plagioclase porphyroblasts are uniformly distributed within an inequigranular subhedral groundmass.
11.33 - 11.60	<u>Unit 4</u> : Diabase Dyke. Fine grained, grey, with sharp upper and lower contacts at 32 ⁰ T.C.A.
11.60 - 13.63	<u>Unit 1a</u> : Intermediate Anorthosite. Coarse grained, porphyroblastic; similar to 0.00-6.41m with a lighter grey colour. Spotty red hematitic staining of potassium feldspars at 11.60-11.78m and 13.47-13.56m.

continued...

Hole: SLZ95-1

13.63 - 14.76 Unit 2a: Intermediate Anorthosite Dyke. Fine grained, light-grey + purple, weakly foliated at shallow angles (10-30°) T.C.A. Sharp upper contact at ~90° T.C.A. Mineralogy is similar to overlying coarse grained intermediate anorthosite.

14.76m End of Hole.

FRACTURES:

Depth (m) / Angle to Core Axis / Type

0.20 / 40 / minor localized fault, iron oxide stain
0.71 / 40 / minor fault, limonitic
1.78 / 40 / minor fault, iron oxide stain
3.77 / 20 / fault gouge, iron oxide stain
6.57-6.75 / 15-45 / intersecting microfractures, iron oxide stain
9.46 / 35 / microfracture, quartz filled crack and seal
10.20 / 25 / chloritic selvage
13.79 / 30 / minor, iron oxide stain

PINK QUARTZ-FELDSPAR VEINING (1-5mm):

Depth (m) / Angle to Core Axis

4.11 / 35
4.24 / 45
4.35 / 45
7.58 / 30
7.74-7.83 / discordant pink pegmatite
8.28 / 85
9.16-9.20 / discordant pink pegmatite
10.43 / 25
10.85 / 40
11.66 / 45
12.75 / 60
13.33 / 80
14.27 / 45
14.27-14.50 / quartz filled tension gashes
14.50 / 45

Signed:



DIAMOND DRILL LOG
Sausage Lake Stone Prospect
Hole: SLZ95-2

Claim: 1040764, South 1/2 Lot 25 Con. 13, McClintock Twp. Grid Location: 2+16E, 0+04N
Drilled by: W.C. Ellerington Start: Aug. 4, 1995 Finish: Aug. 6, 1995
Dip: 90⁰ Depth: 22.49m Core: "E" (7/8") Logged by: Z. Mandziuk Oct. 4, 1995, Core stored:
31 Nassau St. Toronto.

<u>DEPTH</u> metres	<u>DESCRIPTION</u>
0.00 - 4.95	<u>Unit 1b:</u> Mafic Anorthosite. Dark grey + purple, coarse grained, massive to porphyroblastic. Ovoid, twinned, subhedral plagioclase megacrysts (up to 25mm) display weak schiller and random orientations with 20-25% interstitial flame-like mafic patches of amphibole + biotite +/- magnetite. The inequigranular, polygonal, and porphyroblastic fabric is uniformly distributed. Plagioclase + subordinate and secondary potassium feldspar comprise ~ 60% of the rock. The matrix is composed of granoblastic interlocking quartz + feldspars (10-15%), and the late crystallizing and altered mafic patches of amphibole (5-10%), biotite (5-10%), garnet (2-3%), magnetite (1-2%). Most of this interval is fairly competent, with attractive dark coloured patterns and coarse textures.
4.95 - 5.49	<u>Unit 1b:</u> Mafic Anorthosite. Medium to coarse grained with plagioclase porphyroblasts <10mm; mottled red hematitic alteration of potassium feldspars associated with fractures.
5.49 - 10.54	<u>Unit 1b:</u> Mafic Anorthosite. Same as 0.00-4.95m with well-developed coarse porphyroblastic fabric, minor localized fracturing, and uniform competent intervals of over 1m along core axis.
10.54 - 11.20	<u>Unit 1b:</u> Mafic Anorthosite. Inhomogenous cataclastic zone of microfracturing, granulated feldspars, and limonitic staining.
11.20 - 11.64	<u>Unit 1b:</u> Mafic Anorthosite. Same as 0.00-4.95m.
11.64 - 11.97	<u>Unit 1b:</u> Mafic Anorthosite. Cataclastic zone same as 10.54-11.20m.
11.97 - 12.35	<u>Unit 1b:</u> Mafic Anorthosite. Same as 0.00-4.95m.
12.35 - 12.66	<u>Unit 4:</u> Diabase Dyke. Grey, silicified and contaminated; upper and lower contacts at 10 ⁰ and 20 ⁰ T.C.A.
12.66 - 13.13	<u>Unit 1b:</u> Mafic Anorthosite. Same as 0.00-4.95m.

continued...

Hole: SLZ95-2

- 13.13 - 13.38 Unit 1b: Mafic Anorthosite. Cataclastic zone same as 10.54-11.20m
- 13.38 - 13.77 Unit 4: Diabase Dyke. Same as 12.35-12.66m; upper and lower contacts at 90° and 20° T.C.A.
- 13.77 - 14.89 Unit 1a: Intermediate Anorthosite. Medium to coarse grained, plagioclase porphyroblasts <15mm.
- 14.89 - 15.47 Unit 2a: Intermediate Anorthosite Dyke. Fine grained, light grey + purple, contacts at 20° T.C.A.
- 15.47 - 15.73 Unit 1a: Intermediate Anorthosite. Same as 13.77-14.89m.
- 15.73 - 16.78 Unit 2a: Intermediate Anorthosite Dyke. Contacts at 20° T.C.A.
- 16.78 - 18.36 Unit 1b: Mafic Anorthosite. Same as 0.00-4.95m; quartz filled crack and seal fracturing.
- 18.36 - 19.29 Unit 2a: Intermediate Anorthosite Dyke. Contacts at 20° T.C.A.
- 19.29 - 19.68 Unit 1b: Mafic Anorthosite. Same as 0.00-4.95m.
- 19.68 - 20.40 Unit 2a: Intermediate Anorthosite Dyke. Contacts at 20° T.C.A.
- 20.40 - 20.65 Unit 1b: Mafic Anorthosite. Same as 0.00-4.95m.
- 20.65 - 21.00 Unit 2a: Intermediate Anorthosite Dyke. Contacts at 20° T.C.A.
- 21.00 - 22.49 Unit 1b: Mafic Anorthosite. Same as 0.00-4.95m.
- 22.49m End of Hole.

continued...

Hole: SLZ95-2

FRACTURES:

Depth (m) / Angle to Core Axis / Type

4.23 / 15 / minor localized
4.96 / 15 / iron oxide stain
5.35 / 25 / iron oxide stain
7.50 / 25 / quartz sealed microfracture
8.60 / 10 / iron oxide stain
10.16 / 45 / minor
10.36 / 45 / minor
10.54-11.20 / microfractures in cataclastic zone
11.42 / 25 / microfracture, iron oxide stain
11.64-11.97 / microfractures in cataclastic zone
14.00 / 10 / fault, quartz filled, iron oxide stain
16.85-18.30 / 10-15 / zone of quartz sealed microfractures
21.20 / 20 / minor, iron oxide stain

PINK QUARTZ-FELDSPAR VEINING (1-5mm):

Depth (m) / Angle to Core Axis

2.53 / 35 diffuse with faint definition
3.60 / 45 faint
3.74 / 55 coarse grained
3.94 / 35 faint
4.90 / 50 faint
7.25 / 40 faint
7.67 / 30 faint
9.46 / 50
10.23 / 65
10.29 / 30
12.96 / 50
17.25 / 45
17.44 / 50

Signed: *J. Mandzaris*

DIAMOND DRILL LOG
Sausage Lake Stone Prospect
Hole: SLZ95-3

Claim: 1040764, South 1/2 Lot 25 Con. 13, McClintock Twp. Grid Location: 1+45E, 0+69N
Drilled by: W.C. Ellerington Start: Aug. 22, 1995 Finish: Aug. 24, 1995
Dip: 90° Depth: 14.96m Core: "E" (7/8") Logged by: Z. Mandziuk Oct. 4, 1995, Core stored:
31 Nassau St. Toronto.

<u>DEPTH</u> metres	<u>DESCRIPTION</u>
0.00 - 8.00	<u>Unit 1a</u> : Intermediate Anorthosite. Fine to medium grained light-grey + purple; feldspar 50-60%, quartz 10-20%, biotite + amphibole 10-20%, garnet 1-5%, magnetite + pyrite 1%. Massive to weakly foliated, recrystallized, inequigranular to seriate (0.3-1.5mm), granoblastic polygonal quartzo-feldspathic matrix with interspersed subhedral plagioclase porphyroblasts (<5mm) and diffused, streaky, irregular-shaped patches (2-15mm) of aggregated fine to medium grained biotite + amphibole. Mafic patches are unoriented to weakly aligned within gradational zones of about 5-15cm along core axis, imparting overall weakly developed gneissic fabric with foliation approximately 37° T.C.A. Pyrite occurs as widely dispersed subhedral grains < 1.0mm. Weathered zone at 0.00-0.25m has a weakly bleached lighter grey colour with spotty red iron oxide staining.
8.00 - 8.13	<u>Unit 3a</u> : Mottled Intermediate Anorthosite. Slightly lighter grey-purple colour mottled with spotty pink anhedral feldspar porphyroblasts (1-3mm). Possibly a zone of weak potassic alteration. Composition and fabric very similar to above unit.
8.13 - 9.19	<u>Unit 1a</u> : Intermediate Anorthosite. Same as 0.00-8.00m with occasional pinkish feldspar grains (<3mm).
9.19 - 11.25	<u>Unit 1ab</u> : Intermediate to Mafic Anorthosite. Same as above unit with slightly darker colouration imparted by finely dispersed magnetite. Competent with uniform composition.
11.25-12.72	<u>Unit 1a</u> : Intermediate Anorthosite. Same as 0.00-8.00m. Competent, uniform composition.
12.72-13.89	<u>Unit 3a</u> : Mottled Intermediate Anorthosite. Same as 8.00-8.13m.
13.89-14.96	<u>Unit 1a</u> : Intermedite Anorthosite. Same as 0.00-8.00m.
14.96m	End of Hole.

continued...

Hole: SLZ95-3

FRACTURES:

Depth (m) / Angle to Core Axis / Type

1.41 / ~90 / minor, localized
1.70-1.95 / ~90 / minor
2.20 / ~90 / sheeting
3.12 / ~90 / minor
3.49 / 15 / minor fault, iron oxide stain
3.67 / 15 / microfracture
3.95 / ~90 / sheeting
6.49 / 17 / minor fault, iron oxide stain
12.29-12.37 / 0-76 / discontinuous microfractures < 10cm
12.66 / 75 / minor
12.89 / 16 / minor fault, iron oxide stain
14.16 / 10 / minor fault, chloritic selvage

PINK QUARTZ-FELDSPAR VEINING (1-5mm wide):

Depth (m) / Angle to Core Axis

2.48 / 58
5.83 / 29
5.86 / 39
6.20 / 50
6.40 / 50
7.28 / discordant pink pegmatite
10.94 / 54
14.39 / 64
14.74 / 55
14.79 / 55
14.81 / 55
14.85 / 55

Signed:



FIGURE 6.

DIAMOND DRILL HOLE SECTION

Claim: 1040764 Grid Location: 1+25E, 0+01N

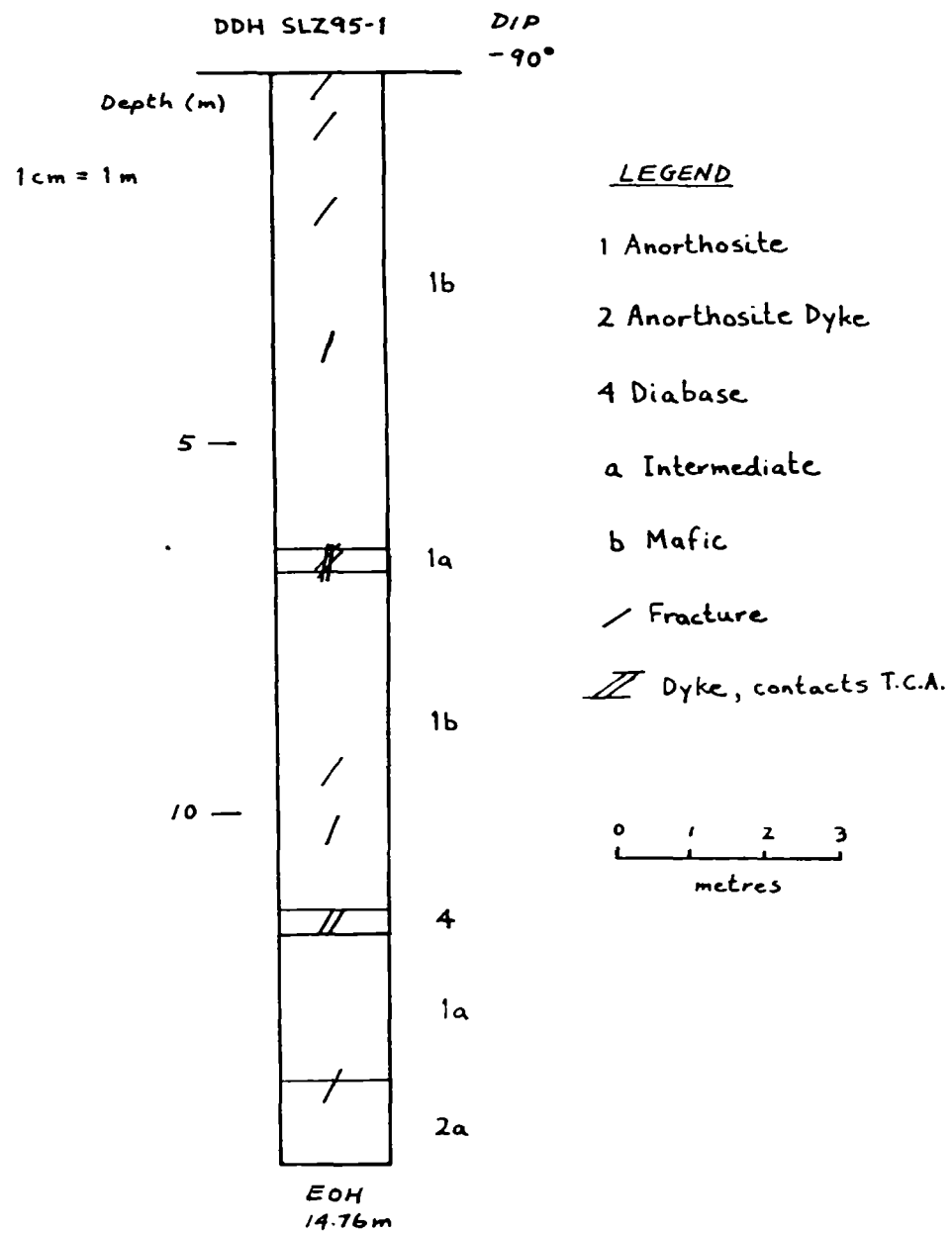

FIGURE 7.

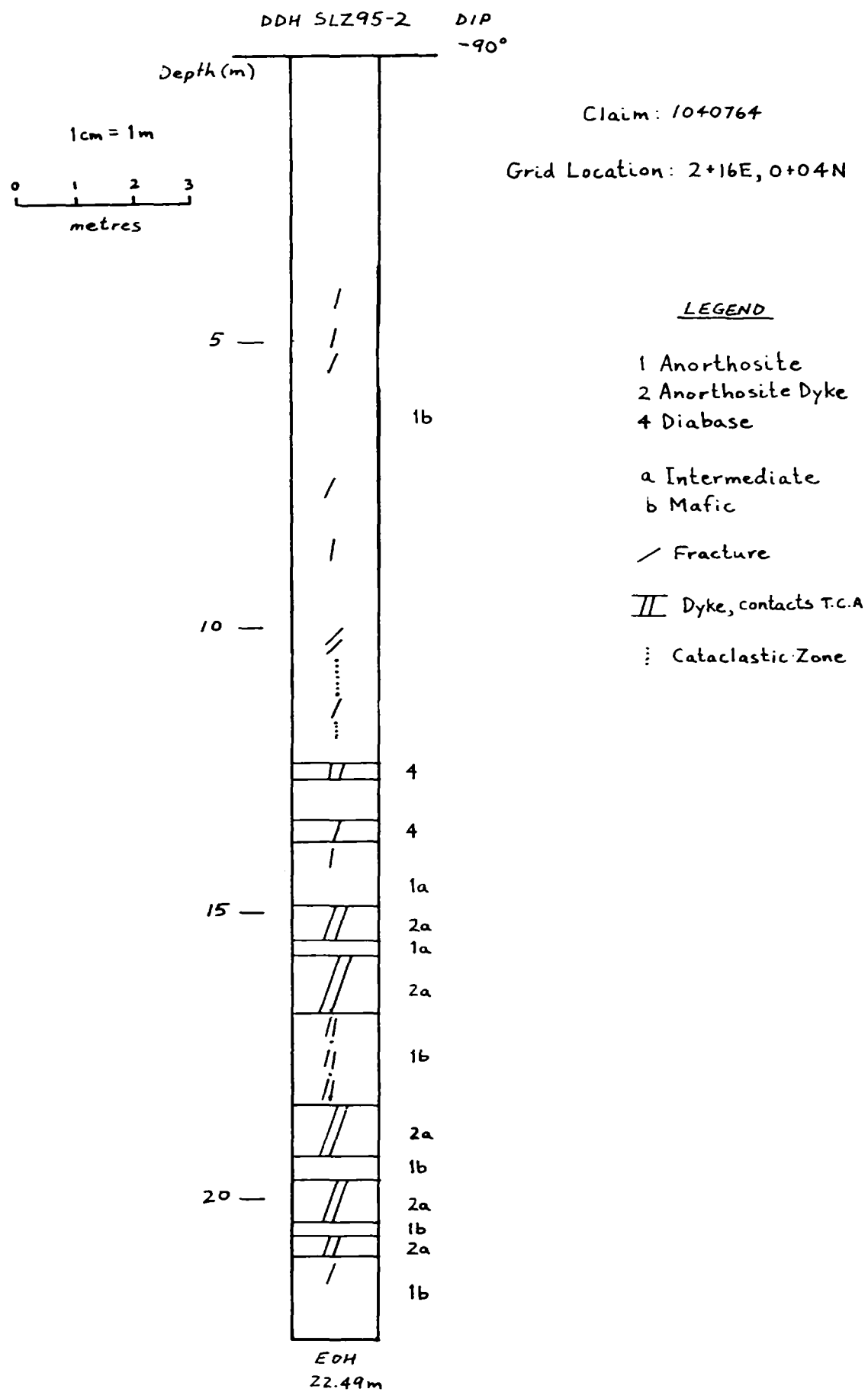
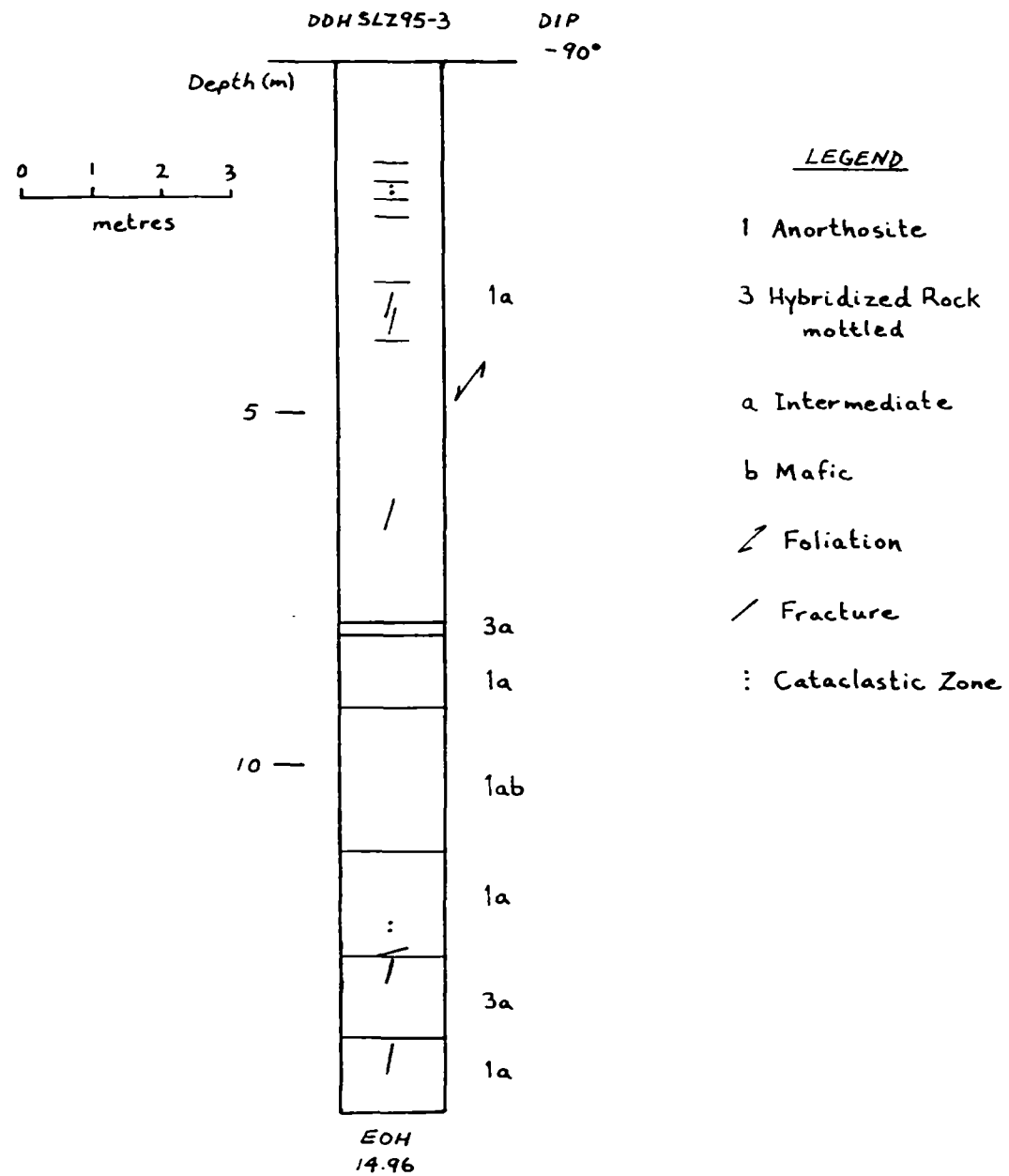

FIGURE 8.

Claim 1040764

Grid Location: 1+45E, 0+69N



After completion of diamond drilling, twenty-two hours of backhoe stripping on the Sausage Lake prospect were performed during September 15-17, 1995 by G. McGuire of Trout Creek using a Komatsu D65 crawler-excavator over a steep side-hill outcrop on which hole SLZ95-1 was put down. The location of the stripping is shown on the accompanying map and the surface features are recorded in Photos 3 and 4. Several large (up to tens of tonnes), loose blocks of potential commercial stone material consisting of coarse grained mafic anorthosite were exposed during the stripping. The top of the outcrop was further stripped manually, and access was also established to the top of the outcrop during backhoe stripping. This will facilitate initial test extraction of stone quarry blocks. Some of the major fractures are discernable on the photos; and outcrop examination indicates that, with adequate equipment, at least several small to medium size blocks could be extracted from this site with negligible complication. The top surface of the outcrop is roughly horizontal and is about 250 square metres in area. The top and sides are suitable for in-line drilling off of squared quarry blocks. Many of the small joints seen on the surface are discontinuous, probably not extending to depths beyond one or two metres. A general indication of more continuous fractures is the presence of hematitic or limonitic slevages, and altered margins along narrow minor faults which tend to weather out into rounded grooves on outcrop surfaces. The density of the fault fractures is generally moderate with spacings of a metre or more; and their dips are mostly near vertical. Sample polished tiles of coarse mafic anorthosite were prepared in 1994 and presented at a dimensional stone show in Sudbury. The response to the stone from industry representatives has been favourable.

By approximate extrapolation and estimated continuity of lithologic properties from the available information (Figure 9), a possible potential reserve of over 20,000 quarry blocks of minimum size of about 3m³ could occur in Area 1 of the prospect. Extraction of a quarry block from the stripped site around hole SLZ95-1 is now possible, and would provide further information on the nature of minor fractures at depth. The less accessible Area 2 in the central part of the grid is estimated to contain similar reserves of coarse mafic anorthosite.

CONCLUSIONS AND RECOMMENDATIONS

The results of work on the Cripple Creek flagstone prospect and on the Sausage Lake dimension stone prospect are favourable for further commitments of resources and pre-development activities towards establishment of quarrying operations. Planned future work includes some further stripping and removal of small quantities of stone for test processing and marketing. Support for additional work is being sought from stone producing companies and from developers with interests in the Ontario stone industry.

The technical assistance and advice of staff of the Ontario Geological Survey and the Mining and Land Management Branch of the Ministry of Northern Development and Mines during the course of prospecting projects for building stone carried out by the author is gratefully acknowledged.

10/16/00
10/20/00
10/20/00

ADDENDUM TO REPORT OF WORK

Cripple Creek Flagstone Prospect, McCraney Township (page 4)

Physical Work

Contractor: Chartrand Bulldozing, Emsdale

Backhoe equipment: Massey Ferguson 60H backhoe and front-end loader

Operator dates/hours worked: Aug 27/2hrs, Aug 28/8hrs, Aug 29/8hrs

Hourly rates: Operator \$17/hr Backhoe and transportation \$34/hr

Sausage Lake Dimension Stone Prospect, Laurier Township (page 15)

Physical Work

Contractor: G. McGuire, Trout Creek

Backhoe equipment: Komatsu D65S crawler-excavator

Operator dates/hours worked: Sept 15/2hrs, Sept 16/10hrs, Sept 17/10hrs

Hourly rates: Operator \$27/hr Backhoe and transportation \$90/hr

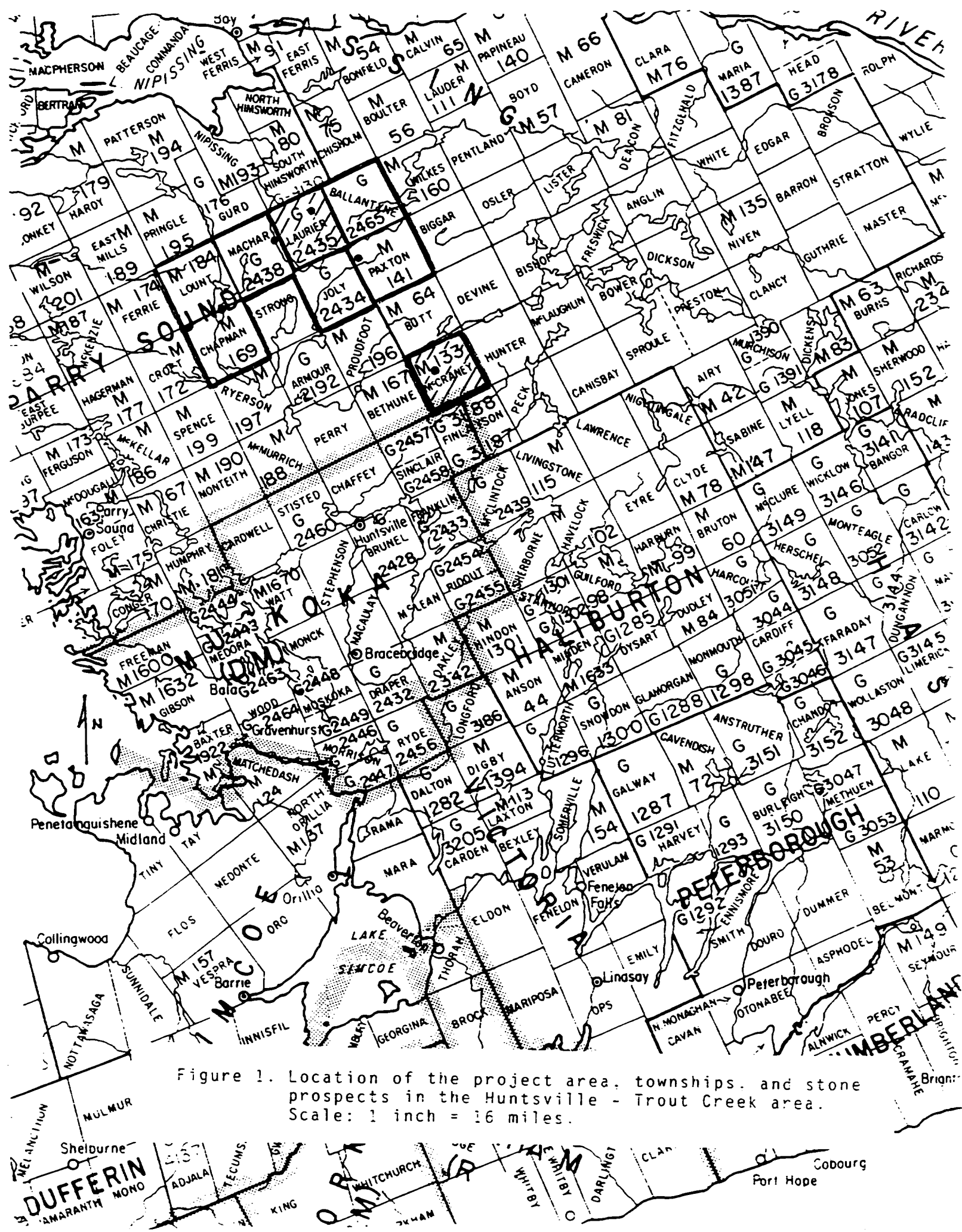

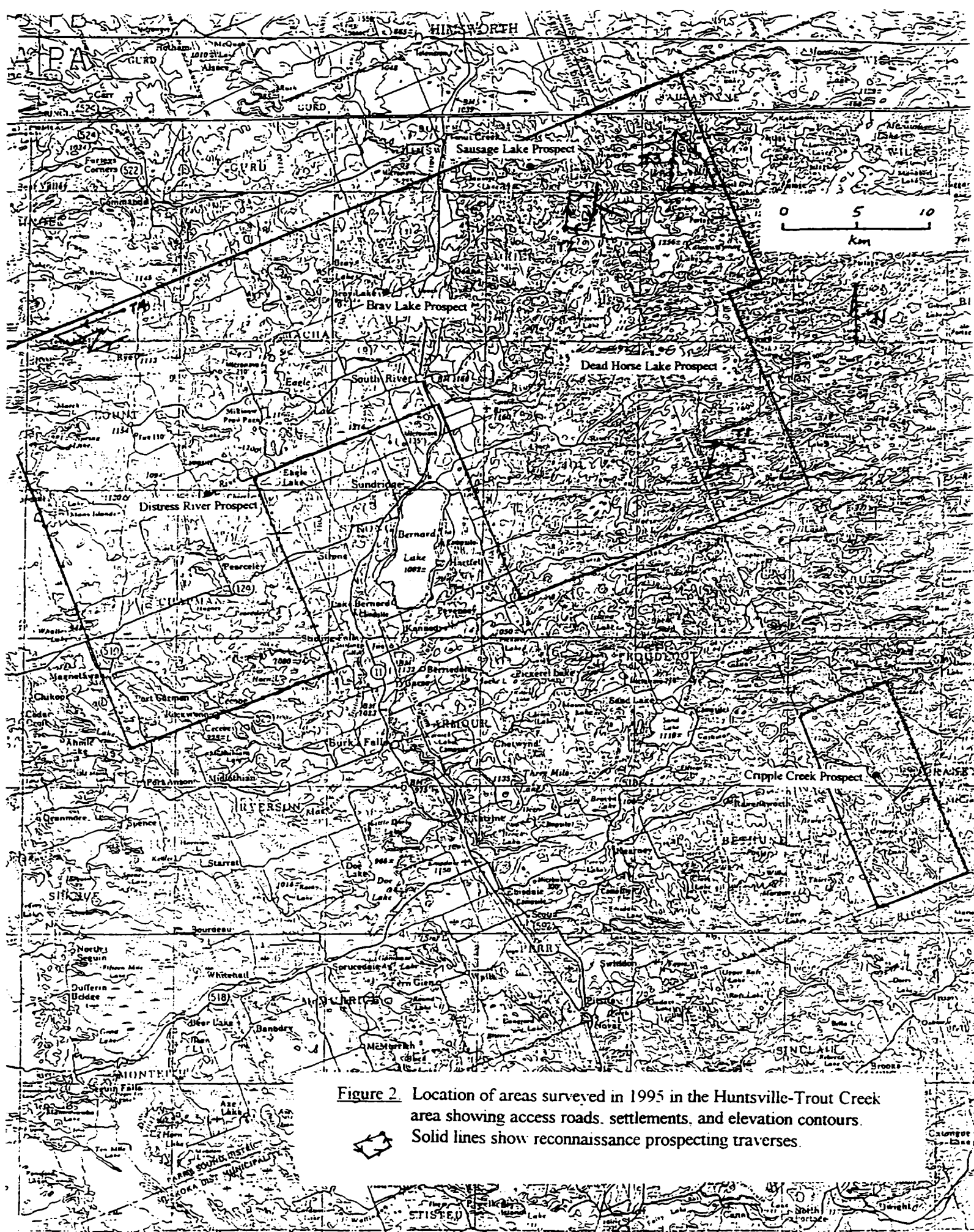
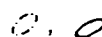

Figure 2. Location of areas surveyed in 1995 in the Huntsville-Trout Creek area showing access roads, settlements, and elevation contours. Solid lines show reconnaissance prospecting traverses.



Legend and symbols for accompanying maps

 Generalized outcrop area examined

Overall Building Stone Potential

1 Good

2 Moderate

3 Poor

* (For Regional Prospecting Only)

Significant Positive (underlined>, or Negative Features

a Access (e.g. a = good access)

d Dimensional stone prospect

f Flagstone prospect

e Exposure

j Jointing, fracturing density

m Deleterious minerals

r Relief

u Lithological uniformity

x Attractiveness

* (For Regional Prospecting Only)

--> Regional prospecting traverse in 1994

 Large boulder, block

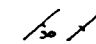
 Foliation/gneissosity - inclined, vertical

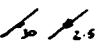
 Prominent jointing - inclined, vertical; spacing

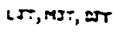
 Low, medium, dense jointing

 Pegmatitic

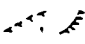
 Slope, incline; scarp

 Average local relief, metres

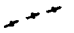
 Crest of hill, ridge

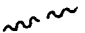
 Fault, lineament

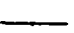
 Grid line, station

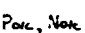
 Poor outcrop, No outcrop

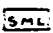
 Small, medium, large block reserves
(<10, 10-15, 15-20+ tonne)

 Proposed test quarry site

 Swamp, marsh

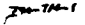
 Sample, rock

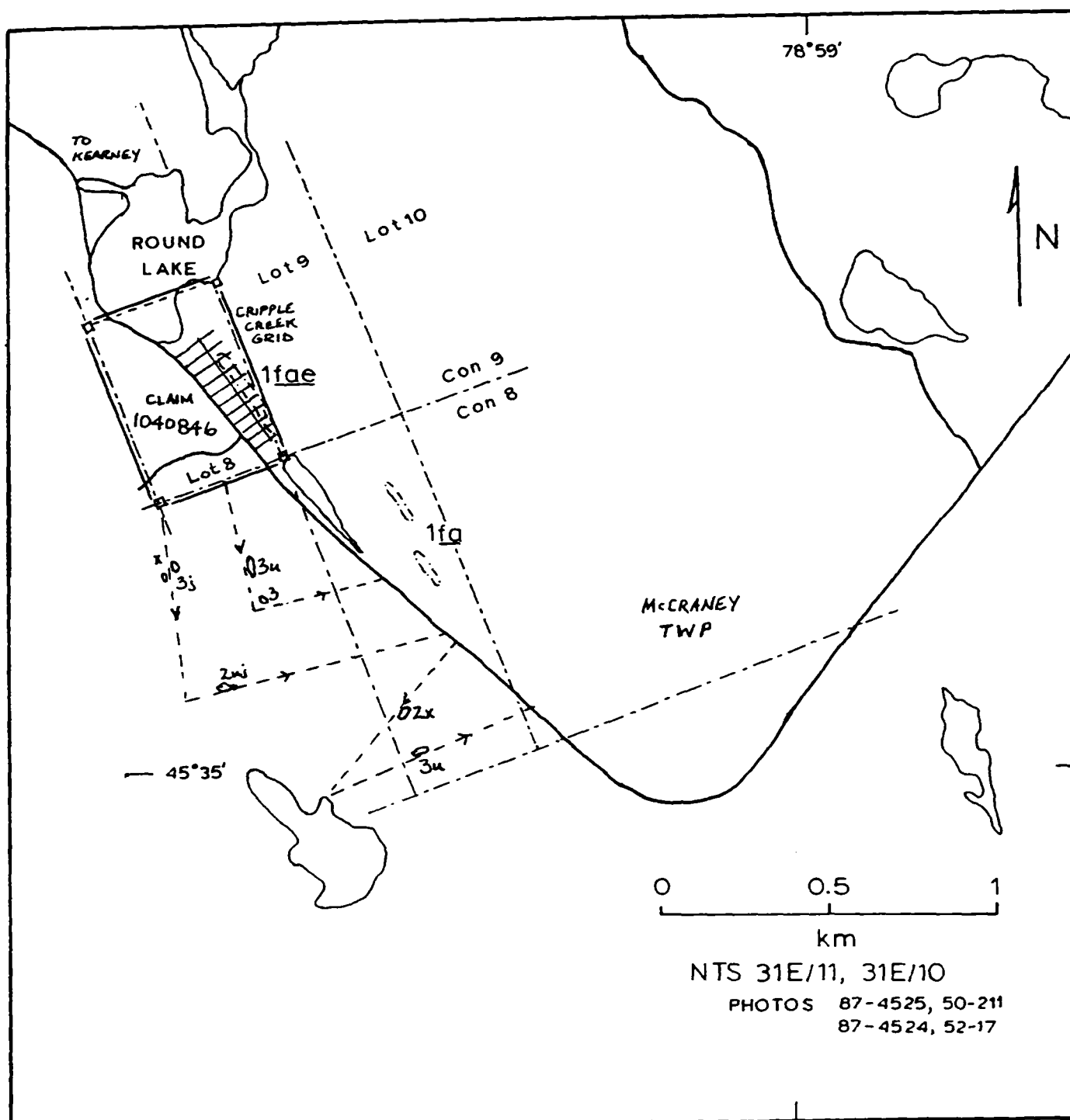

Figure 3. Location of the Cripple Creek prospect and regional prospecting traverses.

FIGURE 9.

Schematic section: Area 1, Sausage Lake prospect.

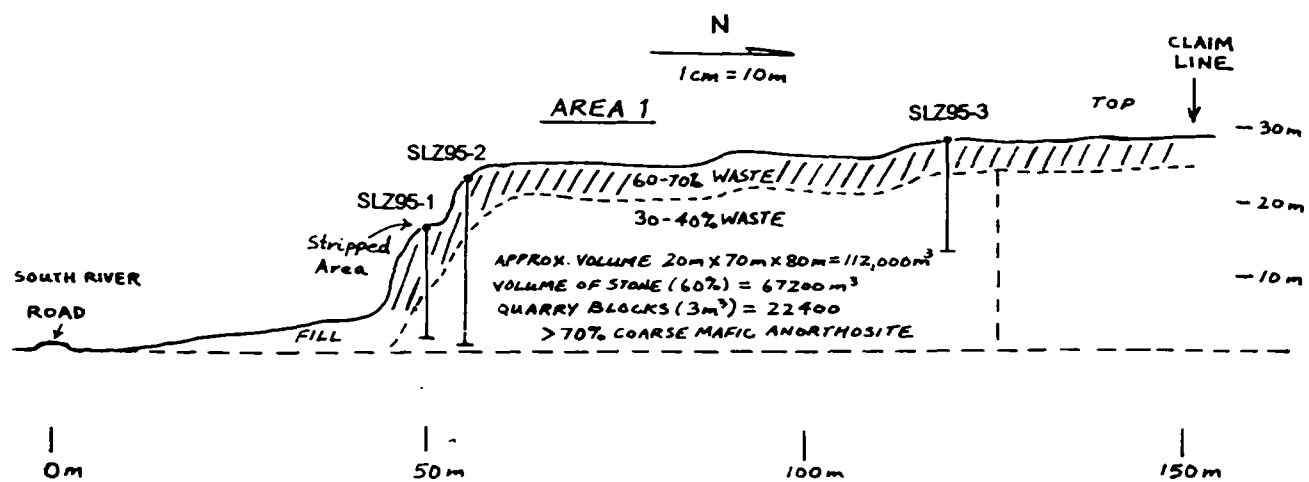

Photo 1

Cripple Creek Flagstone Prospect: Bedding, jointing and parting features near the base of the stripped area. Granitic gneiss layers of variable thickness dip at 37° with near vertical joints spaced about 1 metre apart penetrating orthogonally into the face. The surfaces weather into roughly rectilinear plates and slabs of various sizes and thickness. Iron oxide leaching along planes of parting penetrates up to a metre or more.

Photo 2

Cripple Creek Flagstone Prospect: Assorted size and thickness of flagstone pulled off from halfway up the rock face which rises to about 15 metres above the base of the area of stripping. The large slabs near the lower central part of the photo are about 1.5 to 2.0 metres across and 10 to 20 centimetres thick.

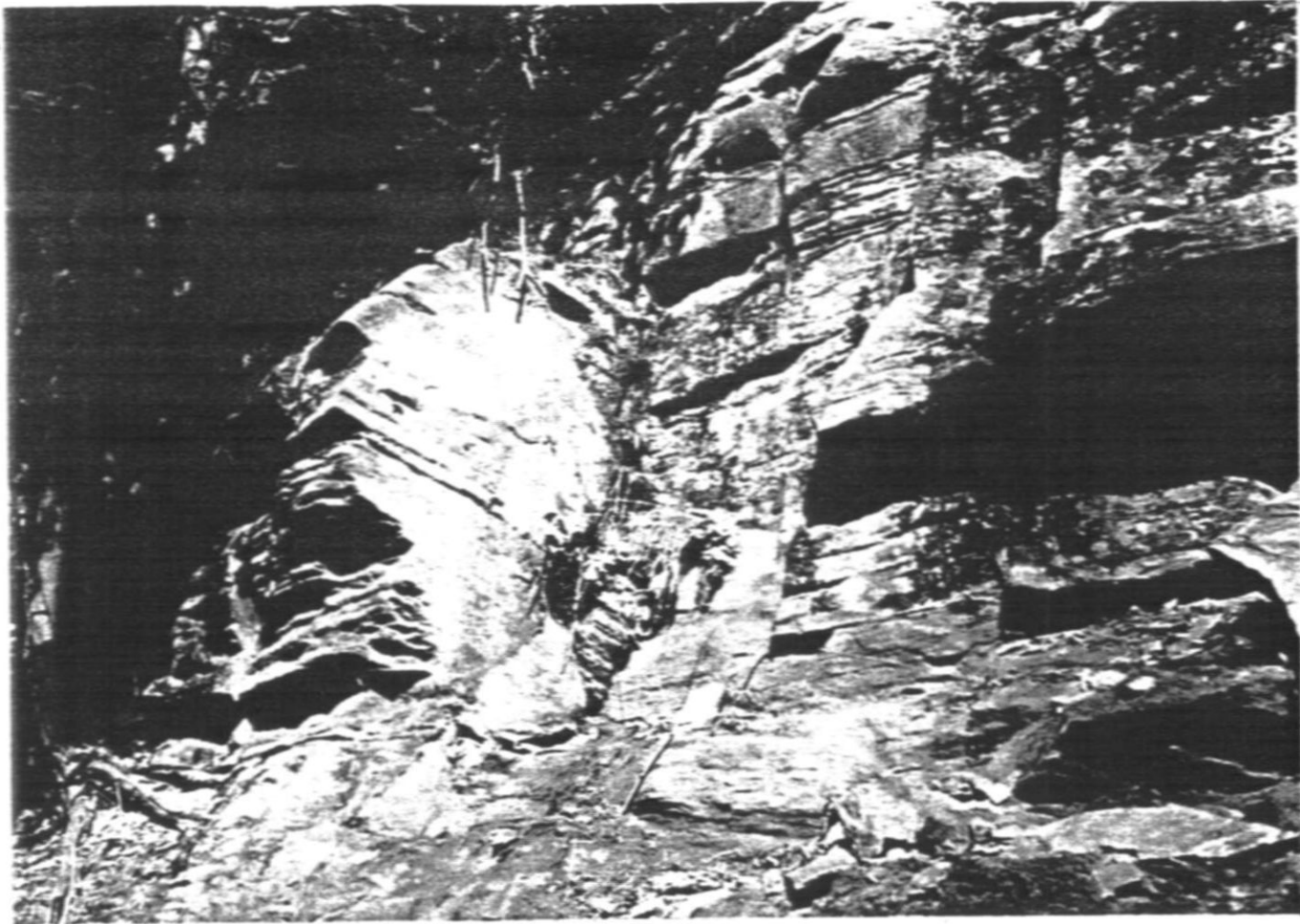

Photo 1



Photo 2

Photo 3

Sausage Lake Prospect: Distribution of fractures along the 3.5 metre high vertical side of the stripped outcrop into which drill hole SLZ95-1 was put down. Near-vertical fractures penetrating at right angles into the hill and spaced about 2 metres apart occur near the center of the photo, and a prominent horizontal sheeting fracture plane is visible near the base of the outcrop.

Photo 4

Sausage Lake Prospect: Stripped area around flagged drill hole SLZ95-1. The hole was drilled vertically to a depth of 14.76 metres, which corresponds to the elevation of the South River Road on which the truck is located 50 metres to the south. Prominent orthogonal jointing approximately parallel and perpendicular to the road is discernable on the outcrop surface.



Photo 3

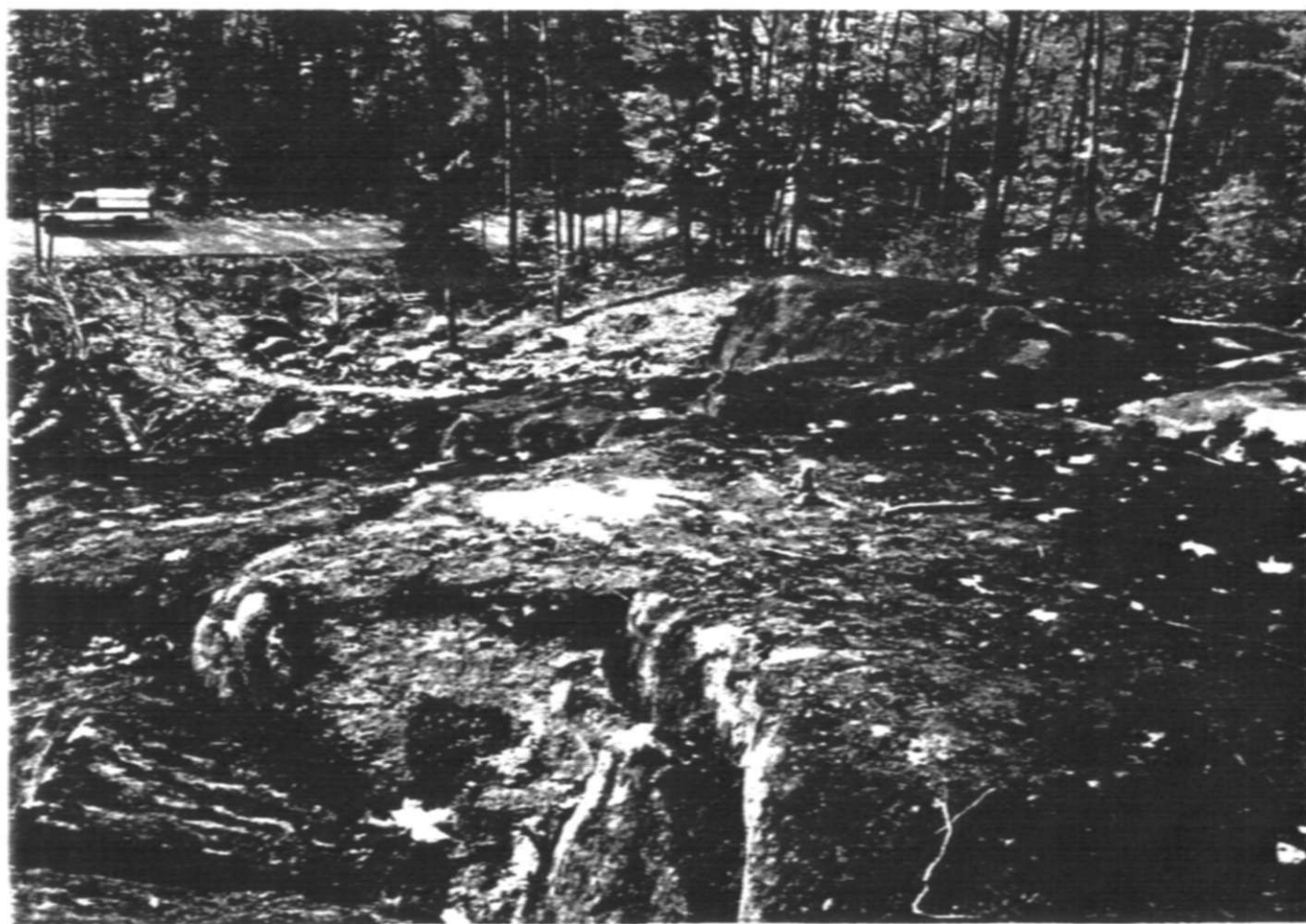
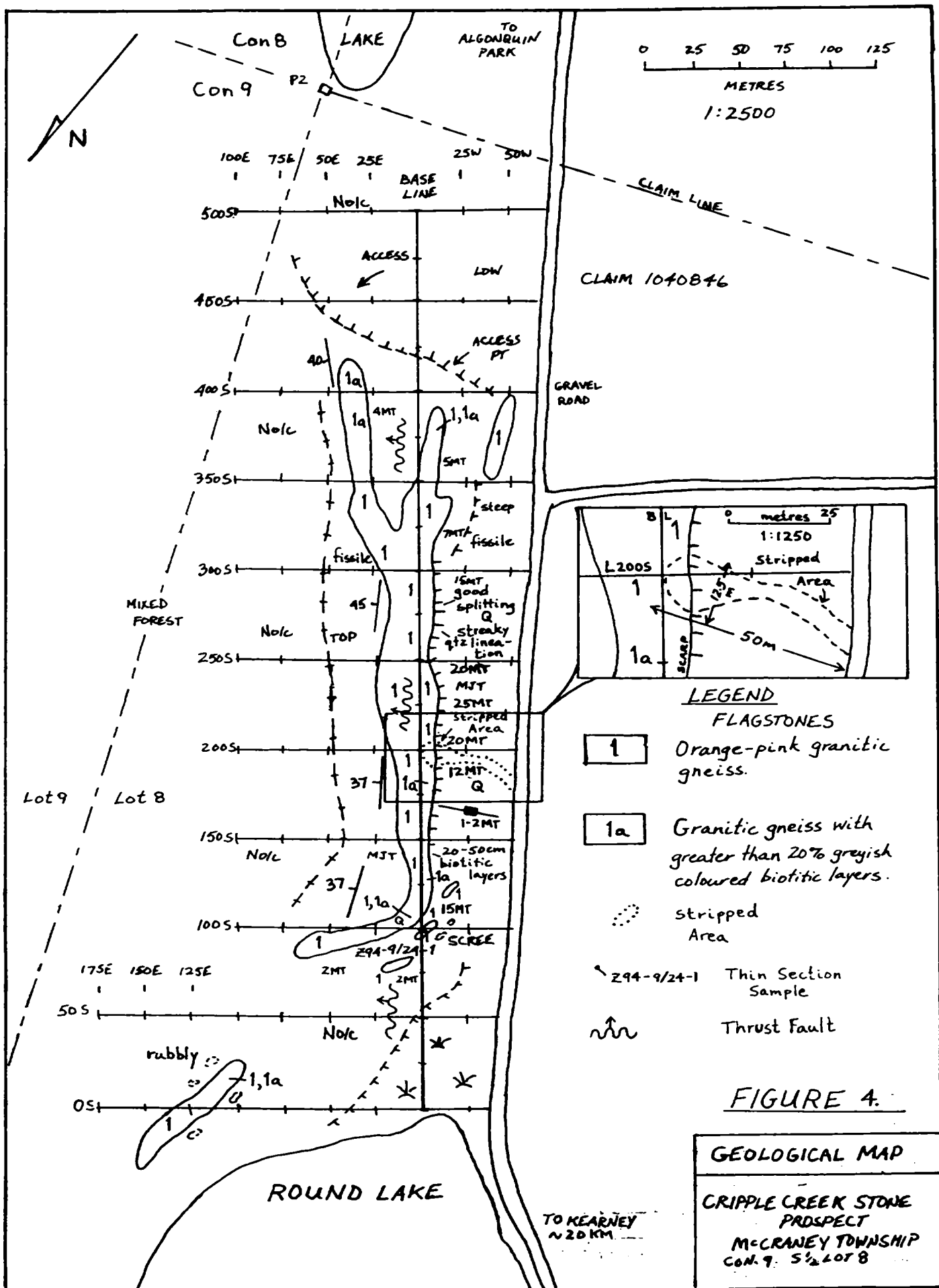

Photo 4

MAP

Sausage Lake Stone Prospect
Geology, Location of Drill Holes, Sampling, Stripping
Scale 1:1000



BETHUNE

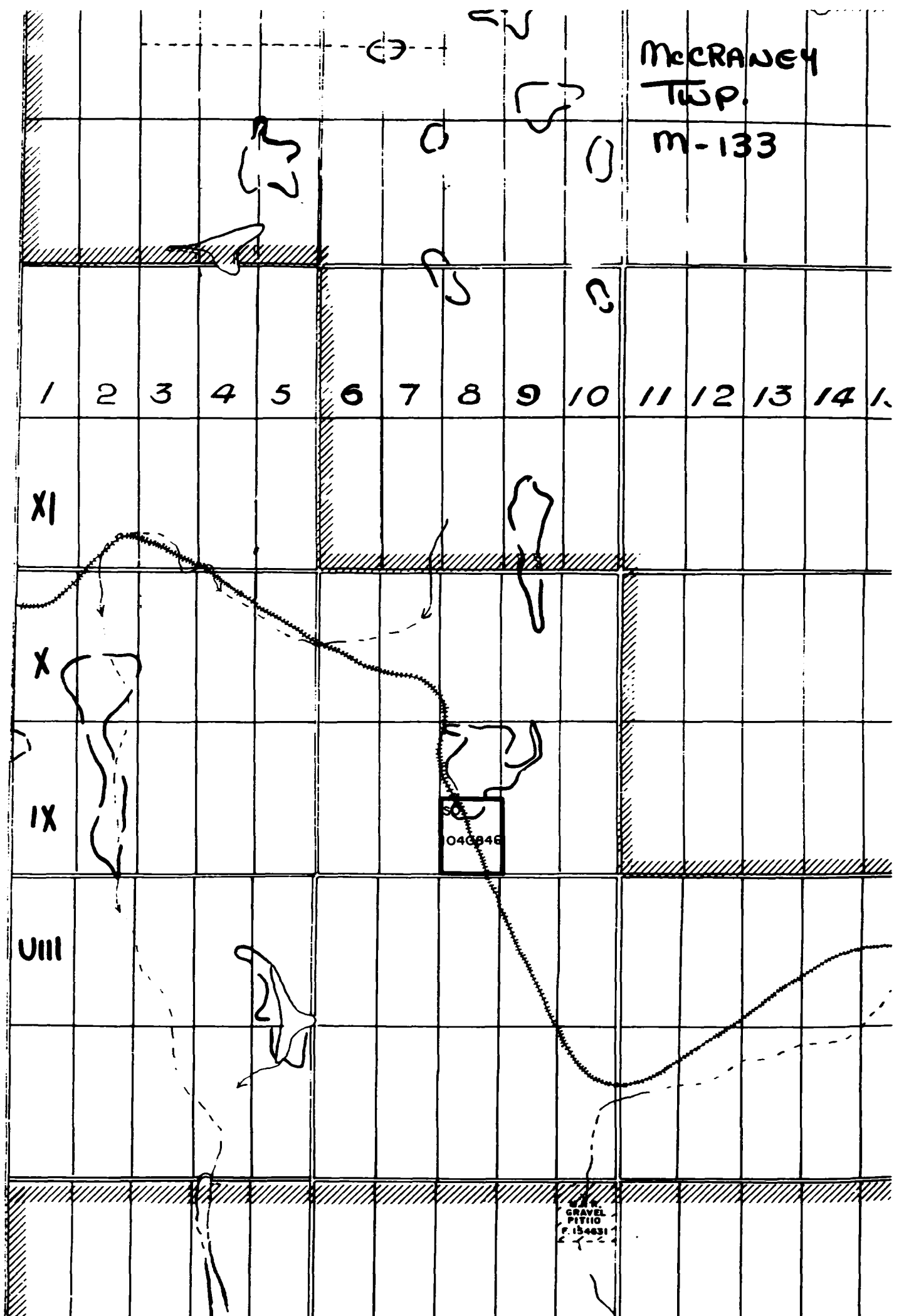



Ministry of Northern Development and Mines

Ontario

Report of Work Conducted After Recording Claim

Mining Act

Transaction Number
W9690.00030

Res. Rec. Sudbury

Personal information collected on this form is obtained under the authority of the Mining Act. This information will be used for correspondence. Questions about this collection should be directed to the Provincial Manager, Mining Lands, Ministry of Northern Development and Mines, Fourth Floor, 158 Cedar Street, Sudbury, Ontario, P2E 6A5, telephone (705) 670-7264.

- Instructions:
- Please type or print and submit in duplicate.
 - Refer to the Mining Act and Regulations for Recorder.
 - A separate copy of this form must be completed.
 - Technical reports and maps must accompany.
 - A sketch, showing the claims the work is on.



31E15NW0001 W9690-00030 WILKES

900

Recorded Holder(s) ZENON MANDZIUK		Client No. 295730
Address 31 NASSAU ST TORONTO M5T1M3		Telephone No. 416 593-9808
Mining Division S. ONT	Township/Area MCCRAVEY	M or Q Plan No. M133
Date Work Performed From: AUG 17/95		To: AUG 29/95

Work Performed (Check One Work Group Only)

Work Group	Type
<input type="checkbox"/> Geotechnical Survey	
<input checked="" type="checkbox"/> Physical Work, Including Drilling	BACKSIDE AND MANUAL STRIPPING 18 HRS BACKHOE + TRANSPORT AUG 27-29/95
<input type="checkbox"/> Rehabilitation	
<input type="checkbox"/> Other Authorized Work	
<input type="checkbox"/> Assays	
<input type="checkbox"/> Assignment from Reserve	

Total Assessment Work Claimed on the Attached Statement of Costs \$ 1377.00

Note: The Minister may reject for assessment work credit all or part of the assessment work submitted if the recorded holder cannot verify expenditures claimed in the statement of costs within 30 days of a request for verification.

Persons and Survey Company Who Performed the Work (Give Name and Address of Author of Report)

Name	Address
ZENON MANDZIUK	31 NASSAU ST TORONTO M5T1M3

(attach a schedule if necessary)

Certification of Beneficial Interest * See Note No. 1 on reverse side

I certify that at the time the work was performed, the claims covered in this work report were recorded in the current holder's name or held under a beneficial interest by the current recorded holder.	Date APR 15/96	Recorded Holder or Agent (Signature) <i>Z. Mandziuk</i>
--	--------------------------	--

Certification of Work Report

I certify that I have a personal knowledge of the facts set forth in this Work report, having performed the work or witnessed same during and/or after its completion and annexed report is true.		
Name and Address of Person Certifying ZENON MANDZIUK 31 NASSAU ST TORONTO M5T1M3		
Telephone No. 416 593-9808	Date APR 4/96	Certified By (Signature) <i>Z. Mandziuk</i>

For Office Use Only

Total Value Cr. Recorded \$1,377	Date Recorded April 15/96	Mining Recorder <i>[Signature]</i>	<table border="1"> <tr> <td colspan="2">ONTARIO MINING DIVISION</td> </tr> <tr> <td colspan="2">RECEIVED</td> </tr> <tr> <td colspan="2">APR 15 1996</td> </tr> <tr> <td>AM</td> <td>PM</td> </tr> <tr> <td>7,8,9,10,11,12,13,14,15,6</td> <td></td> </tr> </table>	ONTARIO MINING DIVISION		RECEIVED		APR 15 1996		AM	PM	7,8,9,10,11,12,13,14,15,6	
ONTARIO MINING DIVISION													
RECEIVED													
APR 15 1996													
AM	PM												
7,8,9,10,11,12,13,14,15,6													
		Date Approved June 7/96											
		Date Notice of Amendments Sent											



Mining Act/Loi sur les mines

Personal information collected on this form is obtained under the authority of the Mining Act. This information will be used to maintain a record and ongoing status of the mining claim(s). Questions about this collection should be directed to the Provincial Manager, Minings Lands, Ministry of Northern Development and Mines, 4th Floor, 159 Cedar Street, Sudbury, Ontario P3E 6A5, telephone (705) 670-7264.

Les renseignements personnels contenus dans la présente formule sont recueillis en vertu de la Loi sur les mines et serviront à tenir à jour un registre des concessions minières. Adresser toute question sur la collecte de ces renseignements au chef provincial des terrains miniers, ministère du Développement du Nord et des Mines, 159, rue Cedar, 4^e étage, Sudbury (Ontario) P3E 6A5, téléphone (705) 670-7264.

1. Direct Costs/Coûts directs

Table with 4 columns: Type, Description, Amount Montant, Totals Total global. Rows include Wages Salaires, Contractor's and Consultant's Fees, Supplies Used, and Equipment Rental.

2. Indirect Costs/Coûts indirects

Note: When claiming Rehabilitation work Indirect costs are not allowable as assessment work. Pour le remboursement des travaux de réhabilitation, les coûts indirects ne sont pas admissibles en tant que travaux d'évaluation.

Table with 4 columns: Type, Description, Amount Montant, Totals Total global. Rows include Transportation Transport, Food and Lodging, and Mobilization and Demobilization.

Note: The recorded holder will be required to verify expenditures claimed in this statement of costs within 30 days of a request for verification. If verification is not made, the Minister may reject for assessment work all or part of the assessment work submitted.

Note: Le titulaire enregistré sera tenu de vérifier les dépenses demandées dans le présent état des coûts dans les 30 jours suivant une demande à cet effet. Si la vérification n'est pas effectuée, le ministre peut rejeter tout ou une partie des travaux d'évaluation présentés.

Filing Discounts

- 1. Work filed within two years of completion is claimed at 100% of the above Total Value of Assessment Credit.
2. Work filed three, four or five years after completion is claimed at 50% of the above Total Value of Assessment Credit.

Table for Filing Discounts calculation: Total Value of Assessment Credit x 0.50 = Total Assessment Claimed

Remises pour dépôt

- 1. Les travaux déposés dans les deux ans suivant leur achèvement sont remboursés à 100 % de la valeur totale susmentionnée du crédit d'évaluation.
2. Les travaux déposés trois, quatre ou cinq ans après leur achèvement sont remboursés à 50 % de la valeur totale du crédit d'évaluation susmentionné.

Table for Remises pour dépôt calculation: Valeur totale du crédit d'évaluation x 0,50 = Évaluation totale demandée

Certification Verifying Statement of Costs

I hereby certify: that the amounts shown are as accurate as possible and these costs were incurred while conducting assessment work on the lands shown on the accompanying Report of Work form.

that as RECORDED HOLDER I am authorized (Recorded Holder, Agent, Position in Company)

to make this certification

Attestation de l'état des coûts

J'atteste par la présente : que les montants indiqués sont le plus exact possible et que ces dépenses ont été engagées pour effectuer les travaux d'évaluation sur les terrains indiqués dans la formule de rapport de travail ci-joint.

Et qu'à titre de je suis autorisé (titulaire enregistré, représentant, poste occupé dans la compagnie)

à faire cette attestation.

Signature: Z. Moulgat, Date: APR 4/96



Ministry of Northern Development and Mines

Ontario

Report of Work Conducted After Recording Claim

Mining Act

Transaction Number
W9690.00031

Res. Rec. Sudbury

Personal information collected on this form is obtained under the authority of the Mining Act. This information will be used for correspondence. Questions about this collection should be directed to the Provincial Manager, Mining Lands, Ministry of Northern Development and Mines, Fourth Floor, 159 Cedar Street, Sudbury, Ontario, PSE 6A5, telephone (705) 670-7264.

- Instructions:
- Please type or print and submit in duplicate.
 - Refer to the Mining Act and Regulations for requirements of filing assessment work or consult the Mining Recorder.
 - A separate copy of this form must be completed for each Work Group.
 - Technical reports and maps must accompany this form in duplicate.
 - A sketch, showing the claims the work is assigned to, must accompany this form.

Recorded Holder(s) ZENON MANDZIUK		Client No.
Address 31 NASSAU ST. TORONTO M5T1M3		Telephone No. (416) 593-9808
Mining Division SOUTHERN ONTARIO	Township/Area LAURIER	M or G Plan No. 62435
Dates Work Performed From: AUG 16/95		To: OCT. 3/95

Work Performed (Check One Work Group Only)

Work Group	Type
<input type="checkbox"/> Geotechnical Survey	
<input checked="" type="checkbox"/> Physical Work, Including Drilling	BACKHOE + MANUAL STRIPPING 22 HRS. BACKHOE + TRANSPORT SEPT 15-17/95
<input type="checkbox"/> Rehabilitation	
<input type="checkbox"/> Other Authorized Work	
<input type="checkbox"/> Assays	
<input type="checkbox"/> Assignment from Reserve	

Total Assessment Work Claimed on the Attached Statement of Costs \$ 3201.25

Note: The Minister may reject for assessment work credit all or part of the assessment work submitted if the recorded holder cannot verify expenditures claimed in the statement of costs within 30 days of a request for verification.

Persons and Survey Company Who Performed the Work (Give Name and Address of Author of Report)

Name	Address
ZENON MANDZIUK	31 NASSAU ST. TORONTO M5T1M3

(attach a schedule if necessary)

Certification of Beneficial Interest * See Note No. 1 on reverse side

I certify that at the time the work was performed, the claims covered in this work report were recorded in the current holder's name or held under a beneficial interest by the current recorded holder.	Date APR 15/96	Recorded Holder or Agent (Signature) <i>Z. Mandziuk</i>
--	--------------------------	--

Certification of Work Report

I certify that I have a personal knowledge of the facts set forth in this Work report, having performed the work or witnessed same during and/or after its completion and assigned report is true.		
Name and Address of Person Certifying ZENON MANDZIUK 31 NASSAU ST. TORONTO M5T1M3		
Telephone No. 416 593-9808	Date MARCH 10 1996	Certified By (Signature) <i>Z. Mandziuk</i>

For Office Use Only

Total Value Cr. Recorded	Date Recorded April 15/96	Mining Recorder <i>[Signature]</i>	RECEIVED APR 15 1996 AM 7.8.9.10.11.12.1.2.3.4.5.6 PM
Claimed Approval Date July 15/96	Date Approved June 7/96		
Date Noted for Amendments Sent			

Work Report Number for Applying Reserve	Claim Number (see Note 2)	Number of Claim Units	Value of Assessment of Work Done on this Claim	Value Applied to this Claim	Value Assigned from this Claim	Reserve: Work to be Claimed at a Future Date
	1040764	2	3201. 25	0	—	3201. 25
Total Number of Claims			3201. 25	3201. 25	—	3201. 25
Total Value Work Done						
Total Value Work Applied						
Total Assigned From						
Total Reserve						

RESERVE

Credits you are claiming in this report may be cut back. In order to minimize the adverse effects of such deletions, please indicate from which claims you wish to prioritize the deletion of credits. Please mark (✓) one of the following:

1. Credits are to be cut back starting with the claim listed last, working backwards.
2. Credits are to be cut back equally over all claims contained in this report of work.
3. Credits are to be cut back as prioritized on the attached appendix.

In the event that you have not specified your choice of priority, option one will be implemented.

Note 1: Examples of beneficial interest are unrecorded transfers, option agreements, memorandum of agreements, etc., with respect to the mining claims.

Note 2: If work has been performed on patented or leased land, please complete the following:

I certify that the recorded holder had a beneficial interest in the patented or leased land at the time the work was performed.	Signature	Date
---	-----------	------



Mining Act/Loi sur les mines

Personal information collected on this form is obtained under the authority of the Mining Act. This information will be used to maintain a record and ongoing status of the mining claim(s). Questions about this collection should be directed to the Provincial Manager, Minings Lands, Ministry of Northern Development and Mines, 4th Floor, 159 Cedar Street, Sudbury, Ontario P3E 6A5, telephone (705) 670-7264.

Les renseignements personnels contenus dans la présente formule sont recueillis en vertu de la Loi sur les mines et serviront à tenir à jour un registre des concessions minières. Adresser toute question sur la collecte de ces renseignements au chef provincial des terrains miniers, ministère du Développement du Nord et des Mines, 159, rue Cedar, 4^e étage, Sudbury (Ontario) P3E 6A5, téléphone (705) 670-7264.

1. Direct Costs/Coûts directs

Type	Description	Amount Montant	Totals Total global
Wages Salaires	Labour <i>MANUAL STR</i> Main-d'oeuvre	200.00	200.00
	Field Supervision Supervision sur le terrain	300.00	300.00
Contractor's and Consultant's Fees Droits de l'entrepreneur et de l'expert- conseil	Type <i>BACKHOE</i>	2568.00	
			2568.00
Supplies Used Fournitures utilisées	Type		
Equipment Rental Location de matériel	Type		
Total Direct Costs Total des coûts directs			3068.00 ✓

2. Indirect Costs/Coûts indirects

** Note: When claiming Rehabilitation work Indirect costs are not allowable as assessment work.
Pour le remboursement des travaux de réhabilitation, les coûts indirects ne sont pas admissibles en tant que travaux d'évaluation.

Type	Description	Amount Montant	Totals Total global
Transportation Transport	Type <i>ROAD</i>	37.50	
			37.50
Food and Lodging Nourriture et hébergement	<i>MEALS CABIN RENTAL</i>	95.15	95.15
Mobilization and Demobilization Mobilisation et démobilisation			
Sub Total of Indirect Costs Total partiel des coûts indirects			133.25
Amount Allowable (not greater than 20% of Direct Costs) Montant admissible (n'excédant pas 20 % des coûts directs)			613.60
Total Value of Assessment Credit (Total of Direct and Allowable Indirect costs)			3201.25 ✓
Valeur totale du crédit d'évaluation (Total des coûts directs et indirects admissibles)			

Note: The recorded holder will be required to verify expenditures claimed in this statement of costs within 30 days of a request for verification. If verification is not made, the Minister may reject for assessment work all or part of the assessment work submitted.

Note : Le titulaire enregistré sera tenu de vérifier les dépenses demandées dans le présent état des coûts dans les 30 jours suivant une demande à cet effet. Si la vérification n'est pas effectuée, le ministre peut rejeter tout ou une partie des travaux d'évaluation présentés.

Filing Discounts

1. Work filed within two years of completion is claimed at 100% of the above Total Value of Assessment Credit.
2. Work filed three, four or five years after completion is claimed at 50% of the above Total Value of Assessment Credit. See calculations below:

Total Value of Assessment Credit	Total Assessment Claimed
	x 0.50 =

Remises pour dépôt

1. Les travaux déposés dans les deux ans suivant leur achèvement sont remboursés à 100 % de la valeur totale susmentionnée du crédit d'évaluation.
2. Les travaux déposés trois, quatre ou cinq ans après leur achèvement sont remboursés à 50 % de la valeur totale du crédit d'évaluation susmentionné. Voir les calculs ci-dessous.

Valeur totale du crédit d'évaluation	Évaluation totale demandée
	x 0,50 =

Certification Verifying Statement of Costs

I hereby certify:
that the amounts shown are as accurate as possible and these costs were incurred while conducting assessment work on the lands shown on the accompanying Report of Work form.

that as RECORDED HOLDER I am authorized
(Recorded Holder, Agent, Position in Company)

to make this certification

Attestation de l'état des coûts

J'atteste par la présente :
que les montants indiqués sont le plus exact possible et que ces dépenses ont été engagées pour effectuer les travaux d'évaluation sur les terrains indiqués dans la formule de rapport de travail ci-joint.

Et qu'à titre de _____ je suis autorisé
(titulaire enregistré, représentant, poste occupé dans la compagnie)

à faire cette attestation.

Signature <i>J. Manly</i>	Date MARCH 10/96 ✓
------------------------------	-----------------------



Ministry of Northern Development and Mines
Ontario

Report of Work Conducted After Recording Claim

Mining Act

Transaction Number
W9690.00032

Res. Sec. Industry

Personal information collected on this form is obtained under the authority of the Mining Act. This information will be used for correspondence. Questions about this collection should be directed to the Provincial Manager, Mining Lands, Ministry of Northern Development and Mines, Fourth Floor, 159 Cedar Street, Sudbury, Ontario, P3E 8A5, telephone (705) 670-7254.

- Instructions:**
- Please type or print and submit in duplicate.
 - Refer to the Mining Act and Regulations for requirements of filing assessment work or consult the Mining Recorder.
 - A separate copy of this form must be completed for each Work Group.
 - Technical reports and maps must accompany this form in duplicate.
 - A sketch, showing the claims the work is assigned to, must accompany this form.

Recorded Holder(s) ZENON MANDZIUK		Client No.
Address 31 NASSAU ST TORONTO M5T1M3		Telephone No. (416) 593-9808
Mining Division SOUTHERN ONTARIO	Township/Area LAURIER	M or G Plan No. G2435
Dates Work Performed From: JULY 8/95		To: OCT. 4/95

Work Performed (Check One Work Group Only)

Work Group	Type
Geotechnical Survey	
<input checked="" type="checkbox"/> Physical Work, including Drilling	DIAMOND DRILLING 3 HOLES
Rehabilitation	
Other Authorized Work	
Assays	
Assignment from Reserve	

Total Assessment Work Claimed on the Attached Statement of Costs \$ **4525.00**

Note: The Minister may reject for assessment work credit all or part of the assessment work submitted if the recorded holder cannot verify expenditures claimed in the statement of costs within 30 days of a request for verification.

Persons and Survey Company Who Performed the Work (Give Name and Address of Author of Report)

Name	Address
ZENON MANDZIUK	31 NASSAU ST. TORONTO M5T1M3

(attach a schedule if necessary)

Certification of Beneficial Interest - See Note No. 1 on reverse side

I certify that at the time the work was performed, the claims covered in this work report were recorded in the current holder's name or held under a beneficial interest by the current recorded holder.	Date APR 16/96	Recorded Holder or Agent (Signature) <i>Z. Mandziuk</i>
--	--------------------------	--

Certification of Work Report

I certify that I have a personal knowledge of the facts set forth in this Work report, having performed the work or witnessed same during and/or after its completion and annexed report is true.		
Name and Address of Person Certifying ZENON MANDZIUK 31 NASSAU ST. TORONTO M5T 1M3		
Telephone No. (416) 593-9808	Date MARCH 10 1996	Certified By (Signature) <i>Z. Mandziuk</i>

For Office Use Only

Total Value Cr. Recorded \$4,525	Date Recorded April 15/96	Mining Recorder <i>[Signature]</i>	SOUTHERN ONTARIO MINING DIVISION RECEIVED APR 15 1996 AM 7,8,9,10,11,12,13,4,5,6 PM
Date Approved July 15/96	Date Approved June 7/96		
Date Notice of Amendment Is Sent			

Work Report Number for Applying Reserve	Claim Number (see Note 2)	Number of Claim Units
	1040764	2
Total Number of Claims		1

DRILL

Value of Assessment Work Done on this Claim	Value Applied to this Claim
4525.00	800.00
Total Value Work Done	
4525.00	800.00
Total Value Work Applied	

Value Assigned from this Claim	Reserve: Work to be Claimed at a Future Date
—	3725.00
Total Assigned From	
—	3725.00
Total Reserve	

Credits you are claiming in this report may be cut back. In order to minimize the adverse effects of such deletions, please indicate from which claims you wish to prioritize the deletion of credits. Please mark (✓) one of the following:

- Credits are to be cut back starting with the claim listed last, working backwards.
- Credits are to be cut back equally over all claims contained in this report of work.
- Credits are to be cut back as prioritized on the attached appendix.

In the event that you have not specified your choice of priority, option one will be implemented.

Note 1: Examples of beneficial interest are unrecorded transfers, option agreements, memorandum of agreements, etc., with respect to the mining claims.

Note 2: If work has been performed on patented or leased land, please complete the following:

I certify that the recorded holder had a beneficial interest in the patented or leased land at the time the work was performed.	Signature	Date
---	-----------	------



Mining Act/Loi sur les mines

Personal information collected on this form is obtained under the authority of the Mining Act. This information will be used to maintain a record and ongoing status of the mining claim(s). Questions about this collection should be directed to the Provincial Manager, Minings Lands, Ministry of Northern Development and Mines, 4th Floor, 159 Cedar Street, Sudbury, Ontario P3E 6A5, telephone (705) 670-7264.

Les renseignements personnels contenus dans la présente formule sont recueillis en vertu de la Loi sur les mines et serviront à tenir à jour un registre des concessions minières. Adresser toute question sur la collecte de ces renseignements au chef provincial des terrains miniers, ministère du Développement du Nord et des Mines, 159, rue Cedar, 4^e étage, Sudbury (Ontario) P3E 6A5, téléphone (705) 670-7264.

1. Direct Costs/Coûts directs

Type	Description	Amount Montant	Totals Total global
Wages Salaires <i>5 DAYS</i>	Labour Main-d'oeuvre		
	Field Supervision Supervision sur le terrain	500.00	500.00
Contractor's and Consultant's Fees Droits de l'entrepreneur et de l'expert-conseil	Type DIAMOND DRILLING	3500.00	
	4% ASST. CREDIT PER FETTER MINUM	123.00	
			3663.00
Supplies Used Fournitures utilisées	Type CHAINSAW FUELS	75.00	
	FILLD EQUIP., OFFICE		
			75.00
Equipment Rental Location de matériel	Type		
Total Direct Costs Total des coûts directs			4238.00

2. Indirect Costs/Coûts indirects

** Note: When claiming Rehabilitation work Indirect costs are not allowable as assessment work. Pour le remboursement des travaux de réhabilitation, les coûts indirects ne sont pas admissibles en tant que travaux d'évaluation.

Type	Description	Amount Montant	Totals Total global
Transportation Transport	Type ROAD	77.00	
			77.00
Food and Lodging Nourriture et hébergement	MEALS, CABIN RENTAL	210.00	210.00
Mobilization and Demobilization Mobilisation et démobilitation			
Sub Total of Indirect Costs Total partiel des coûts indirects			287.00
Amount Allowable (not greater than 20% of Direct Costs) Montant admissible (n'excédant pas 20 % des coûts directs)			847.60
Total Value of Assessment Credit (Total of Direct and Allowable Indirect costs) Valeur totale du crédit d'évaluation (Total des coûts directs et indirects admissibles)			4525.00

Note: The recorded holder will be required to verify expenditures claimed in this statement of costs within 30 days of a request for verification. If verification is not made, the Minister may reject for assessment work all or part of the assessment work submitted.

Note : Le titulaire enregistré sera tenu de vérifier les dépenses demandées dans le présent état des coûts dans les 30 jours suivant une demande à cet effet. Si la vérification n'est pas effectuée, le ministre peut rejeter tout ou une partie des travaux d'évaluation présentés.

Filing Discounts

1. Work filed within two years of completion is claimed at 100% of the above Total Value of Assessment Credit.
2. Work filed three, four or five years after completion is claimed at 50% of the above Total Value of Assessment Credit. See calculations below:

Total Value of Assessment Credit	Total Assessment Claimed
	x 0.50 =

Remises pour dépôt

1. Les travaux déposés dans les deux ans suivant leur achèvement sont remboursés à 100 % de la valeur totale susmentionnée du crédit d'évaluation.
2. Les travaux déposés trois, quatre ou cinq ans après leur achèvement sont remboursés à 50 % de la valeur totale du crédit d'évaluation susmentionné. Voir les calculs ci-dessous.

Valeur totale du crédit d'évaluation	Évaluation totale demandée
	x 0,50 =

Certification Verifying Statement of Costs

I hereby certify: that the amounts shown are as accurate as possible and these costs were incurred while conducting assessment work on the lands shown on the accompanying Report of Work form.

that as RECORDED HOLDER I am authorized (Recorded Holder, Agent, Position in Company)

to make this certification

Attestation de l'état des coûts

J'atteste par la présente : que les montants indiqués sont le plus exact possible et que ces dépenses ont été engagées pour effectuer les travaux d'évaluation sur les terrains indiqués dans la formule de rapport de travail ci-joint.

Et qu'à titre de _____ je suis autorisé (titulaire enregistré, représentant, poste occupé dans la compagnie)

à faire cette attestation.

Signature J. Mandzuch Date MARCH 10 1996

REFERENCES

AREAS WITHDRAWN FROM DISPOSITION

- M.R.O. - MINING RIGHTS ONLY
- S.R.O. - SURFACE RIGHTS ONLY
- M. + S. - MINING AND SURFACE RIGHTS

Description	Order No.	Date	Disposition	File
①	WA/81	16/11/81	S.R.O.	180707
②		27/10/72	S.R.O.	118334
③	WB/88	29/01/88	S.R.O.	186649

HIMSWORTH

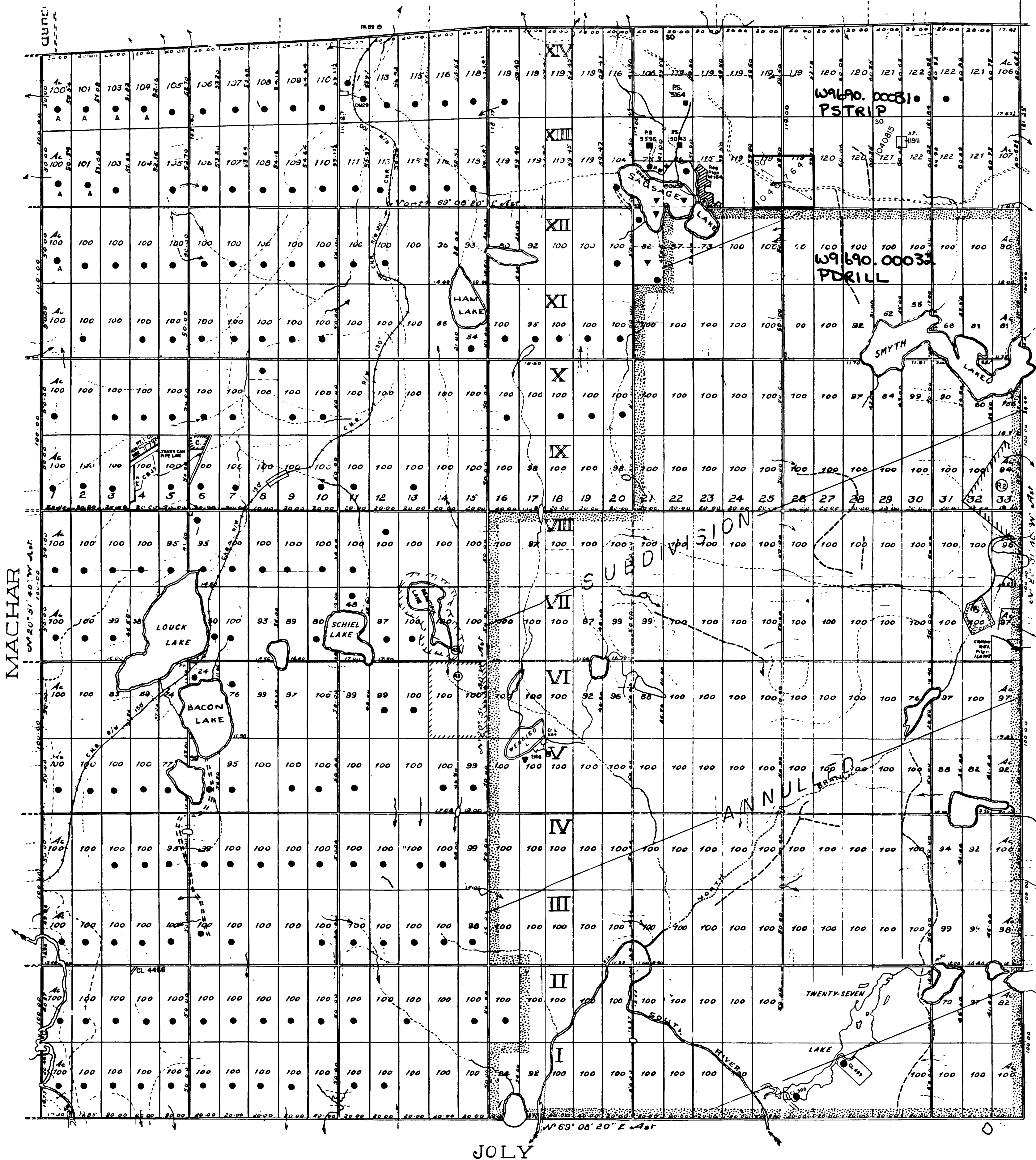

LEGEND

- HIGHWAY AND ROUTE No.
- TRAILS
- SURVEYED LINES
- TOWNSHIPS, BASE LINES, ETC.
- LOTS, MINING CLAIMS, PARCELS, ETC.
- UNSURVEYED LINES
- LOT LINES
- PARCEL BOUNDARY
- MINING CLAIMS ETC.
- RAILWAY AND RIGHT OF WAY
- UTILITY LINES
- NON-PERENNIAL STREAM
- FLOODING OR FLOODING RIGHTS
- SUBDIVISION OR COMPOSITE PLAN
- RESERVATIONS
- ORIGINAL SHORELINE
- MARSH OR MUSKEG
- MINES
- TRAVERSE MONUMENT

DISPOSITION OF CROWN LANDS

TYPE OF DOCUMENT	SYMBOL
PATENT, SURFACE & MINING RIGHTS	●
" SURFACE RIGHTS ONLY	○
" MINING RIGHTS ONLY	○
LEASE, SURFACE & MINING RIGHTS	■
" SURFACE RIGHTS ONLY	■
" MINING RIGHTS ONLY	■
LICENCE OF OCCUPATION	▽
ORDER-IN-COUNCIL	▽
RESERVATION	○
CANCELLED	○
SAND & GRAVEL	○

NOTE: MINING RIGHTS IN PARCELS PATENTED PRIOR TO MAY 6, 1963, VESTED IN ORIGINAL PATENTEE BY THE PUBLIC LANDS ACT, R.S.O. 1970, CHAP. 380, SEC. 63, SUBSEC. 1

THE INFORMATION THAT APPEARS ON THIS MAP HAS BEEN COMPILED FROM VARIOUS SOURCES, AND ACCURACY IS NOT GUARANTEED. THOSE WISHING TO STAKE MINING CLAIMS SHOULD CONSULT WITH THE MINING RECORDER, MINISTRY OF NORTHERN DEVELOPMENT AND MINES, FOR ADDITIONAL INFORMATION ON THE STATUS OF THE LANDS SHOWN HEREON.

DATE OF ISSUE
JUN - 5 1987
SOUTHERN ONTARIO
MINING DIVISION

NOTE: TOWNSHIP SUBDIVISION PARTIALLY ANNULLED APRIL 11/1963

SCALE: 1 INCH = 40 CHAINS

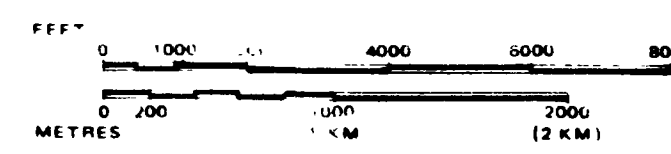

TOWNSHIP
LAURIER
M.N.R. ADMINISTRATIVE DISTRICT
BRACEBRIDGE
MINING DIVISION
SOUTHERN ONTARIO
LAND TITLES / REGISTRY DIVISION
PARRY SOUND

MINISTRY OF NATURAL RESOURCES
MINISTRY OF NORTHERN DEVELOPMENT AND MINES

DATE: FEBRUARY 1987 NUMBER: G-243F



200

RES. GEO. SUDBURY
M.N.R. DIST.
BRACEBRIDGE

JULY

McCRANEY

M.133

ONTARIO
MINISTRY OF NATURAL RESOURCES

LEGEND

- CANCELLED
- PATENTED LAND
- CROWN LAND SALE
- LEASES
- LOCATED LAND
- LICENSE OF OCCUPATION
- MINING RIGHTS ONLY
- SURFACE RIGHTS ONLY
- QUARRY PERMIT — (C)

- C
- C.S.
- (C)
- Loc.
- L.O.
- M.R.O.
- S.R.O.

THE INFORMATION THAT APPEARS ON THIS MAP HAS BEEN COMPILED FROM VARIOUS SOURCES, AND ACCURACY IS NOT GUARANTEED. THOSE WISHING TO STAKE MINING CLAIMS SHOULD CONSULT WITH THE MINING RECORDER, MINISTRY OF NORTHERN DEVELOPMENT AND MINES, FOR ADDITIONAL INFORMATION ON THE STATUS OF THE LANDS SHOWN HEREON.

District of Nipissing

Scale: 40 chains to an inch

SOUTHERN ONTARIO MINING DIVISION
BUTT

AREA WITHIN THE ALGONQUIN PROVINCIAL PARK SHOWN THUS:  WITHDRAWN FROM STAKING

100' Surface rights reservation around all lakes & rivers.

SUBDIVISION WITHIN THE HATCHED PORTION ANNULLED
MAY 28, 1953

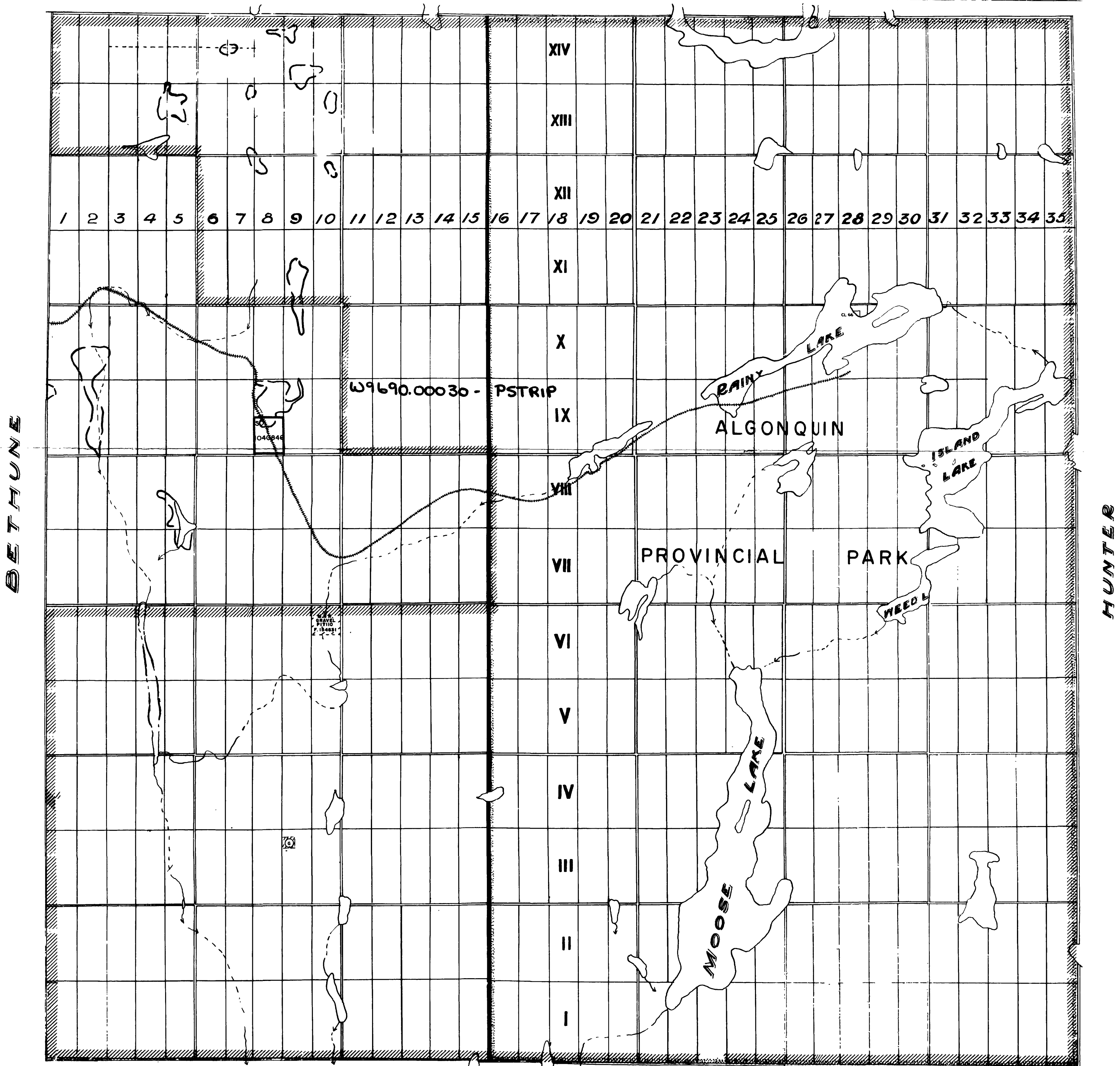

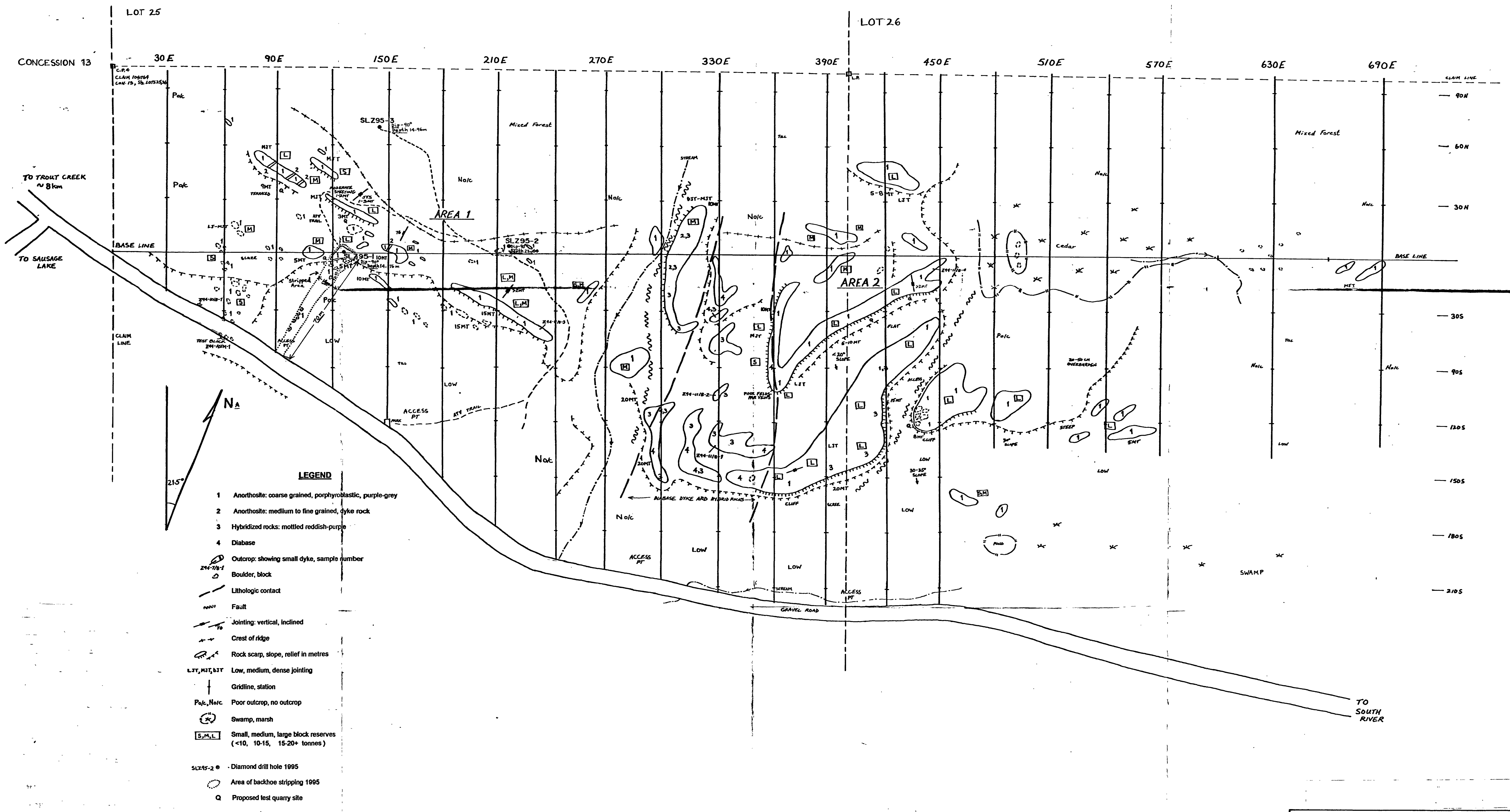

LOT 25

LOT 26

CONCESSION 13

30E

90E

150E

210E

270E

330E

390E

450E

510E

570E

630E

690E

CLAIM LINE

90N

60N

30N

30S

90S

120S

150S

180S

210S

BASE LINE

BASE LINE

CLAIM LINE

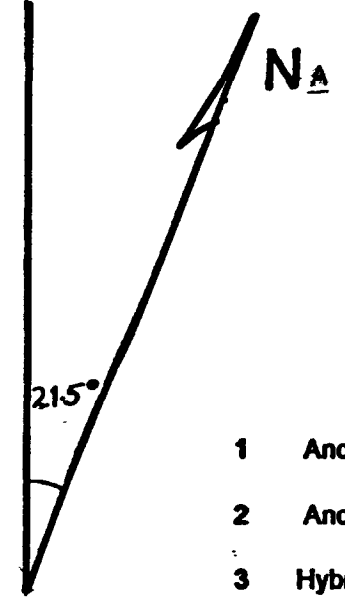

LEGEND

- 1 Anorthosite: coarse grained, porphyroblastic, purple-grey
- 2 Anorthosite: medium to fine grained, dyke rock
- 3 Hybridized rocks: mottled reddish-purple
- 4 Diabase
- Outcrop: showing small dyke, sample number
- Boulder, block
- Lithologic contact
- Fault
- Jointing: vertical, inclined
- Crest of ridge
- Rock scarp, slope, relief in metres
- Low, medium, dense jointing
- Gridline, station
- Poor outcrop, no outcrop
- Swamp, marsh
- Small, medium, large block reserves (<10, 10-15, 15-20+ tonnes)
- Diamond drill hole 1995
- Area of backhoe stripping 1995
- Proposed test quarry site
- Thin Section

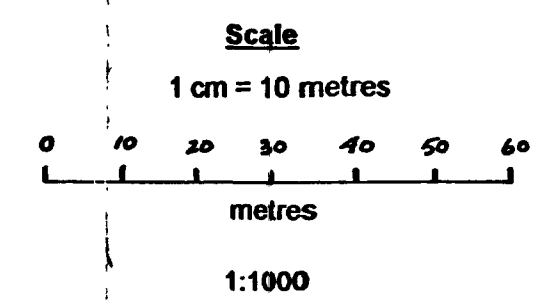

SAUSAGE LAKE STONE PROSPECT

GEOLOGY
Location of Drill Holes, Stripping

NTS 31E/14 Scale 1:1000 By: Z. Mandziuk Date: Dec. 1995

