



31F04NE9483 16 MONTEAGLE

010

Diamond Drilling

Township OF MONTEAGLE

Report NO: 16

Work performed by: G. POTTER EXPLORATIONS

Claim NO	Hole NO	Footage	Date	Note
EO 35600	# UM/68-1	105'	Oct/68	(1)
	# UM/68-2	102'	Oct/68	(1)
	# UM/68-3	104'	Oct/68	(1)
EO 35603	# UM/68-4	103.6'	Oct/68	(1)
	# UM/68-5	106'	Oct/68	(1)
EO 39790	# UM/68-6	102'	Oct/68	(1)
	# UM/68-7	102'	Oct/68	(1)

Notes: (1) 53/69

DIAMOND DRILL RECORD

Hole No. UM 68-1 Sheet No. 1

Property Union Montezuma
 Location 1392 S } of NE 1 Post
410' W } Claim EC 35600
Montezuma Twp
 Latitude _____
 Departure _____
 Bearing Az 301°

Dip _____
 Collar 45°
 Total Footage 105'

Elev. Collar _____
 Datum _____
 Date Started Oct 9/68
 Date Completed Oct 13/68
 Drilled by G. Potter Exploration
 Logged by L. Hobbs P. Eng

Footage		Formation	Sample Number	Sample Footage	Sample Width	Gold Sample	Gold Sludge	Remarks
From	To							
0	1	Casing						
1	60	Regmatite & Granite: Mostly salmon pink felds with gtz and minor ferruginous. Some sections are darker, coarser grained, have more biotite and peristerite. Considerable pyrite (up to 2%) seen along shear planes with biotite and with biotite blebs within massive rock. Can occur at Chalcopyrite @ 10'6". Higher peristerite after 27'						
		53-55 Section is better fractured with fine biotite along the planes. Peristerite present. (orthoclase (?) in rock)						53-55 Rock active 2x background
60	61'9"	Biotite Gneiss: fine grained, about 60% biotite, some fine pyrite. Gneissosity at 3 7' to core						
61'9"	68'6"	Regmatite & Pink & peristeritic types contacts, rel. sharp & conformable.						
68'6"	91'9"	Biotite Gneiss: As above, with narrow bands of granite and quartzose material.						
91'9"	104'	Regmatite: leached, light colored to 97' then (darker) and more fractured to 100' (but no peristerite)						
		103-104 Some Peristerite						
104	105	Biotite Gneiss: with minor regmatite						
	105	End of hole.						

Date of Examination Oct 15, 1968

L. G. Hobbs

DIAMOND DRILL RECORD

Hole No. UM682 Sheet No. 1

Property Union Montesa
 Location 136315 } N. 1. East
4851a } Cl. EC 356cc
Montesa Twp
 Latitude _____
 Departure _____
 Bearing AZ 279°

Collar _____ Dip 45°

 Total Footage 102'

Elev. Collar _____
 Datum _____
 Date Started Oct 14/68
 Date Completed Oct 20/68
 Drilled by G. P. Puffer Exploration
 Logged by L. G. Hebbes P. Eng

Footage		Formation	Sample Number	Sample Footage	Sample Width	Gold Sample	Gold Sludge	Remarks
From	To							
C	1	Casing Pegmatite and Granite: pink, leached appearance mainly. V. minor terrazins (Biotite) Locally minor peristerite 21-36'10" Darker & grayed with more peristerite. 24'6" - 33 More fractured, peristeritic						
1	42'6"							
42'6"	46'	Biotite Gneiss: Black, fine-medium grained						24'6" - 33 Radioactive up to 2x Background
46'	49'6"	Pegmatite: Pink Qtz veins cut						
49'6"	102'	Biotite Gneiss: As above mainly. Gneiss size of ± 70° to 90° but variable - Short Quartz and Pegmatite sections with rel. sharp contacts at 54'6" - 56'2" 81'10" - 83'6" 60' - 61' 90' - 91'10" 62'3" - 63'6" 99'6" - 100'4" 65'7" - 67'3" 61-62'3" is a Qtz section with biotite bands and considerable fine red mineral (Garnet probably)						
	102'	End of hole						

Date of Examination Oct 21/68

L. G. Hebbes

H. R. ...

UNCE-1, 2

Part 1
1900

1000 ft
C. ...



Scale: 1 in = 200 ft.

UNCE-2
UNCE-1

115'

1905
1908

1908

G. ...

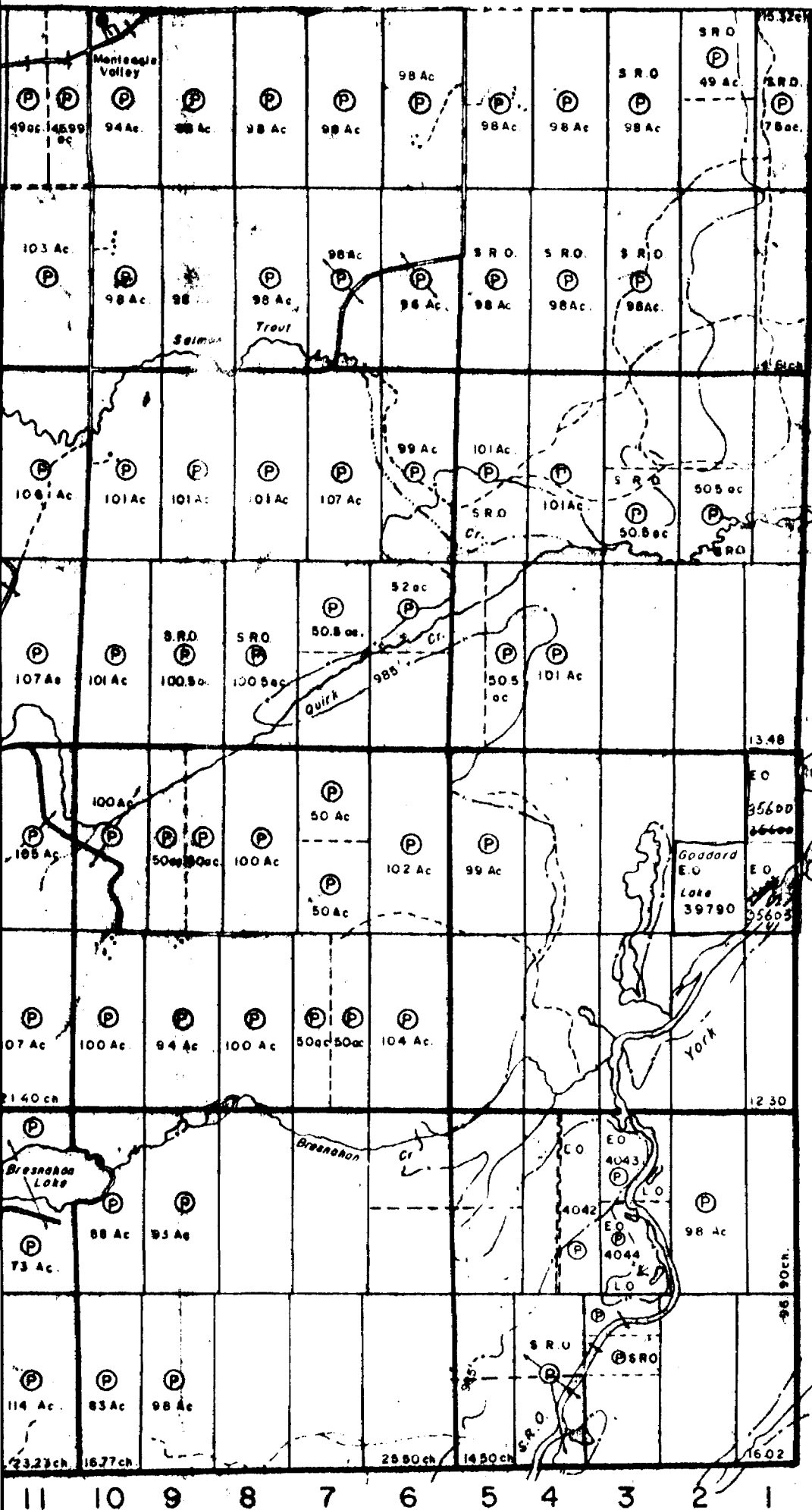

VIII
 VII
 VI
 V
 IV
 III
 II
 I



Nabt.

were re
 Represe
 Parcel.
 Parcels
 Flooding
 Elevatio
 File 22

PL
 DE
 AN



DIAMOND DRILLING LOG

Start a new page for every new hole, but fill in top portion of form only on first page for each hole.

FILL IN ON EVERY PAGE

HOLE NO.	PAGE NO.
UM/68-3	1

DRILLING COMPANY G. S. Potter Explorations		COLLAR ELEVATION	BEARING OF HOLE FROM TRUE NORTH 275°	TOTAL FOOTAGE 104	DIP OF HOLE AT collar 45	LOCATION OF HOLE IN RELATION TO A FIXED POINT ON THE CLAIM	MAP REFERENCE NO. M-128	CLAIM NO. EO 35600
DATE HOLE STARTED Oct. 21/68	DATE COMPLETED Oct. 24/68	DATE LOGGED	LOGGED BY L.G. Hobbs, P.Eng.		ft	LOCATION (Tp., Lot, Con. OR Lat. and Long.) 1565' S & 660' W of No. 1 post claim EO 35600 Monteagle Twp	PROPERTY NAME Union Monteagle	
EXPLORATION CO., OWNER OR OPTIONEE L. G. Hobbs		DATE SUBMITTED Dec. 16/68	SUBMITTED BY (Signature)		ft			
					ft			

FOOTAGE		ROCK TYPE	DESCRIPTION <small>Colour, grain size, texture, minerals, alteration, etc.</small>	PLANAR FEATURE ANGLE *	CORE SPECIMEN FOOTAGE +	YOUR SAMPLE NUMBER	SAMPLE FOOTAGE		SAMPLE LENGTH	ASSAYS +		
FROM	TO						FROM	TO				
0	8/1	Biotite gneiss	C.A. - 65-80° to core									
8/1	39/2	Pegmatite	Pink with perisderite - some biotite generally leached appearance.									
39/2	42/8	Bio. gneiss	C.A. 65°									
42/8	44	Siliceous Bio gn.										
44	46	Bio. gneiss										
46	62	Siliceous Bio. gn.	C.A. 60° at 56'									
62	65	Bio Gneiss	upper contact gradational lower contact sharp.									
65	72/3	Pegmatite	with peristisite - slightly leached appearance.									
72/3	102/5	Siliceous Hb Bio gneiss	Motted appearance. Heavy bio banding C.A. 55° at 84' Pegmatite sections at 84/3 - 85 87/8 - 91/4 92/10 - (6") 96/3 - 98/10									
102/5	104	Granite gn	Banded pink C.A. 55°									
	104		End of hole.									

* For features such as foliation, bedding, schistosity, measured from the long axis of the core.

+ Additional credit available. See Assessment Work Regulations.



THE MINING ACT - DEPARTMENT OF MINES
DIAMOND DRILLING LOG

Start a new page for every new hole, but fill in top portion of form only on first page for each hole.

FILL IN ON EVERY PAGE

HOLE NO. PAGE NO.
UM/68-4 1

DRILLING COMPANY G. S. POTTER EXPLORATIONS		COLLAR ELEVATION	BEARING OF HOLE FROM TRUE NORTH 280°	TOTAL FOOTAGE 103'6"	DIP OF HOLE AT collar 40°	LOCATION OF HOLE IN RELATION TO A FIXED POINT ON THE CLAIM	MAP REFERENCE NO. M-128	CLAIM NO. EO. 35603
DATE HOLE STARTED Oct. 25/68	DATE COMPLETED Oct 26/68	DATE LOGGED	LOGGED BY L G Hobbs, P. Eng.,		ft	LOCATION (Tp., Lot, Con. OR Lat. and Long.) 220'S & 486'W of No. 1 post claim 35603 Monteagle Township	PROPERTY NAME Union Monteagle.	
EXPLORATION CO., OWNER OR OPTIONEE L. G. Hobbs		DATE SUBMITTED Dec. 6/68	SUBMITTED BY (Signature)		ft			
					ft			
					ft			

FOOTAGE FROM TO		* ROCK TYPE	DESCRIPTION Colour, grain size, texture, minerals, alteration, etc.	PLANAR FEATURE ANGLE *	CORE SPECIMEN FOOTAGE †	YOUR SAMPLE NUMBER	SAMPLE FOOTAGE FROM TO		SAMPLE LENGTH	ASSAYS +		
0	1/9	Pegmatite	pink leached peristerite									
1/9	2/6	Dike (?)	massive biotite, fine grained, gray sharp contacts.									
2/6	6/4	Hb. Bio gneiss										
6/4	10	Marble	typical biotite									
10	23/7	Pegmatite	as above but with possibly more peristerite. Biotite exhibits a rough gneissosity.									
38/1	43/2	Hb. Bio gneiss	garnets present. A 6" marble section at 39/5									
43/2	47/8	Pegmatite	slightly leached and slightly gneissic.									
47/8	52/2	Marble										
52/2	63/8	Hb. Bio gneiss	black. Dissem. py. & pyrr. is higher in this section. Pyrr. especially at 59-60, 62'9", 61-62, Marble Section C.A. 65° at 59'.									
63/8	103/6	Marble	biotite throughout and short sections of bio. gneiss and silicious gneiss.									
	103/6		End of hole.									

* For features such as foliation, bedding, schistosity, measured from the long axis of the core.

† Additional credit available. See Assessment Work Regulations.



THE MINING ACT - DEPARTMENT OF MINES
DIAMOND DRILLING LOG

Start a new page for every new hole, but fill in top portion of form only on first page for each hole.

FILL IN ON EVERY PAGE

HOLE NO. **UM/68-5** PAGE NO. **1**

DRILLING COMPANY G. S. Potter Exploration		COLLAR ELEVATION	BEARING OF HOLE FROM TRUE NORTH 295°	TOTAL FOOTAGE 106	DIP OF HOLE AT collar 45°	LOCATION OF HOLE IN RELATION TO A FIXED POINT ON THE CLAIM	MAP REFERENCE NO. M-128	CLAIM NO. EO.35603
DATE HOLE STARTED Oct. 27/68	DATE COMPLETED Oct. 30/68	DATE LOGGED	LOGGED BY L.G. Hobbs, P. Eng.,		ft	LOCATION (Tp., Lot, Con. OR Lat. and Long.) 365'S & 520'W of No. 1 post claim 35603 Monteagle Township PROPERTY NAME Union Monteagle		
EXPLORATION CO., OWNER OR OPTIONEE L. G. Hobbs		DATE SUBMITTED Dec.16/68	SUBMITTED BY (Signature)		ft			
					ft			
					ft			

FOOTAGE FROM	TO	ROCK TYPE	DESCRIPTION Colour, grain size, texture, minerals, alteration, etc.	PLANAR FEATURE ANGLE *	CORE SPECIMEN FOOTAGE +	YOUR SAMPLE NUMBER	SAMPLE FOOTAGE		SAMPLE LENGTH	ASSAYS +		
							FROM	TO				
0	21	Pegmatite	pink and peristeritic with large black patches of hornblende or pyrox- no gneissosity									
21	35/5	Biotite gneiss	fine grained C.A. ≈ 80°									
35/5	37/4	Marble	inpure grayish with biotite graditional contacts.									
37/4	46/9	Pegmatite	salmon pink with biotite patches & plagioclase. Peristerite not noteable. This section somewhat radioactive (2x background) 42'4" - 42'11" Biotite gneiss and marble.									
46/9	63	Marble	as above. White to grayish. Some dark gneissic sections with biotite. 56/6 - 56/9½ Peristerite peg band.									
63	67/6	Bio gneiss	C.A variable 65° - 85°									
67/6	68/9	Marble										
68/9	72/9	Bio gneiss										
72/9	73/9	Marble										
73/9	75	Qtz. Bio gneiss	well banded with several percent pyrite									
75	80/6	Marble	with narrow bio gneiss bands									
80/6	85/2	gray siliceous gneiss	much gray quartzs & feldspar plus biotite ± chlorite a little fine py.									
85/2	106	marble										
			End of hole.									

* For features such as foliation, bedding, schistosity, measured from the long axis of the core.

+ Additional credit available. See Assessment Work Regulations.



DIAMOND DRILLING LOG

Start a new page for every new hole, but fill in top portion of form only on first page for each hole.

FILL IN ON EVERY PAGE

HOLE NO. **UM/68-6** PAGE NO. **1**

DRILLING COMPANY G. S. Potter Explorations		COLLAR ELEVATION	BEARING OF HOLE FROM TRUE NORTH 290°	TOTAL FOOTAGE 102	DIP OF HOLE AT collar 46	LOCATION OF HOLE IN RELATION TO A FIXED POINT ON THE CLAIM	MAP REFERENCE NO. M-128	CLAIM NO. EO.39790
DATE HOLE STARTED Oct. 31/68	DATE COMPLETED Nov. 1/68	DATE LOGGED	LOGGED BY L. G. Hobbs, P.Eng.,		ft °	LOCATION (Tp., Lot, Con. OR Lgt. and Long.) 1373'S & 242'W of No. 1 post Claim 39790 Monteagle Township		
EXPLORATION CO., OWNER OR OPTIONEE L. G. Hobbs		DATE SUBMITTED Dec. 16/69	SUBMITTED BY (Signature)		ft °			
					ft °			
					ft °			
						PROPERTY NAME Union Monteagle		

FOOTAGE FROM	TO	ROCK TYPE	DESCRIPTION Colour, grain size, texture, minerals, alteration, etc.	PLANAR FEATURE ANGLE *	CORE SPECIMEN FOOTAGE +	YOUR SAMPLE NUMBER	SAMPLE FOOTAGE		SAMPLE LENGTH	ASSAYS +	
							FROM	TO			
0	22/8	Pegmatite	both leached and darker red types. Not much peristerite								
22/8	27/8	Marble	impure biotite.								
27/8	38/10	Pegmatite	sycnitic with biotite some banding exhibited.								
38/10	39/10	Marble	impure. Sharp contacts.								
39/10	44/2	Biotite gneiss	as usual.								
44/2	55/4	Marble	variable colour texture etc. depending on mica and configuration.								
55/4	59	Siliceous gne.	gray fields and biotite, chlorite + quartz. Partly banded. 57' - 58' Pyrite section ≈ 5%								
59	61/6	Marble									
61/6	63/3	Siliceous gn.	impure.								
63/3	66/9	Marble									
66/9	69/10	Sil. gneiss	impure. Much biotite, hornblende, at 68/6 blebs of pyrr. for 2 inches.								
69/10	71/7	Bio. gneiss									
71/7	73/8	Sil. gneiss									
73/8	75	Bio gneiss.									
75	82	Sil. gneiss									
CONTINUED ON NEXT PAGE.....											

* For features such as foliation, bedding, schistosity, measured from the long axis of the core.

+ Additional credit available. See Assessment Work Regulations.



DIAMOND DRILLING LOG

Start a new page for every new hole, but fill in top portion of form only on first page for each hole.

FILL IN ON EVERY PAGE

HOLE NO. UM/68-7 PAGE NO. 1

DRILLING COMPANY G. S. Potter Explorations		COLLAR ELEVATION	BEARING OF HOLE FROM TRUE NORTH 320	TOTAL FOOTAGE 102	DIP OF HOLE AT collar 45	LOCATION OF HOLE IN RELATION TO A FIXED POINT ON THE CLAIM	MAP REFERENCE NO. M-128	CLAIM NO. EO. 39790
DATE HOLE STARTED Nov. 2/68	DATE COMPLETED Nov. 3/68	DATE LOGGED	LOGGED BY L. G. Hobbs, P.Eng.		ft		LOCATION (Tp., Lot, Con. OR Lat. and Long.) 1295'S & 65'W of No. 1 post claim EO. 39790	PROPERTY NAME Union Monteagle
EXPLORATION CO., OWNER OR OPTIONEE L. G. Hobbs		DATE SUBMITTED Dec. 16/68	SUBMITTED BY (Signature)		ft			
				ft				

FOOTAGE		ROCK TYPE	DESCRIPTION <small>Colour, grain size, texture, minerals, alteration, etc.</small>	PLANAR FEATURE ANGLE *	CORE SPECIMEN FOOTAGE +	YOUR SAMPLE NUMBER	SAMPLE FOOTAGE		SAMPLE LENGTH	ASSAYS +		
FROM	TO						FROM	TO				
0	24/10	Pegmatite	both salmon pink & grayish peristerite varieties grading into each other plus bio. quartz. Radioactive.									
24/10	29/3	Biotite gneiss										
29/3	34	Marble										
34	43	Bio. gneiss + marble										
43	101	Marble	white-gray with much biotite minor bio. gneiss. Sections. Py. locally.									
101	102	Biotite gneiss										
	102		End of hole.									

* For features such as foliation, bedding, schistosity, measured from the long axis of the core.

+ Additional credit available. See Assessment Work Regulations.

MONTEAGLE



5 3

900

type of work to be recorded.

THE MINING ACT REPORT OF WORK

To the Recorder of Easter Ontario Mining Division

I, Lawrence G. Hobbs name of Recorded Holder 135092 Miner's Licence

65 Westwood Lane Post Office Address

do hereby report the performance of 28 days of Drill core specimens type of work

not before reported to be applied on the following contiguous claims

Claim No.	Days	Claim No.	Days	Claim No.	Days
35998	5 1/2				
35600	22 1/2				

To accompany work report dated Dec 16/68 (attached)

All the work was performed on Mining Claim (s) EO 35600, EO 35599, EO 35603 (In the case of geological and/or geophysical survey (s) where more than 18 claims are involved attach a schedule)

READ CAREFULLY: THE FOLLOWING INFORMATION IS REQUIRED BY THE MINING RECORDER.

- For Manual Work, Stripping or Opening up of Mines, Sinking Shafts or Other Actual Mining Operations - Names and addresses of the men who performed the work and the dates and hours of their employment.
- For Diamond and other Core Drilling - Footage, No. and angle of holes and diameter of core. Name and address of owner or operator of drill. Dates when drilling was done. Signed core log and sketch in duplicate.
- For Compressed Air or Other Power Driven or Mechanical Equipment
- Type of drill or equipment. Names and addresses of men engaged in operating equipment and the dates and hours of their employment.
- For Power Stripping - Type of equipment. Name and address of owner or operator. Amount expended. Dates on which work was done. Proof of actual cost must be submitted within 30 days of recording.
- With each of the above types of work sketches are required to show the location and extent of the work in relation to the nearest claim post. In the case of diamond or other core drilling the sketch must be submitted in duplicate.
- For Geological and Geophysical Survey - The names and addresses of men employed as well as dates. Type of instrument used in the case of geophysical survey. Reports and maps in duplicate must be filed with the Minister within 60 days of recording.
- For Land Survey - the name and address of Ontario Land surveyor.

The Required Information is as Follows: (Attach a list if this space is insufficient)

3/4 in Drill core

Hole -> #	1	2	3	4	5	6	7	8
Specimens		26	25	25	26	246	25	
at:-	74/6	72	49	49/6	51	50	50/6	75
	104	101	75	74/6	76	74	74	
			104	103	105	99	101	99/6

Date July 17 1969

L. G. Hobbs Signature of Recorded Holder or Agent

The Mining Act Certificate Verifying Report of Work

I, Lawrence G. Hobbs 65 Westwood Lane Thornhill Ont. (Post Office Address)

hereby certify:

- That I have a personal and intimate knowledge of the facts set forth in the report of work annexed hereto, having performed the work or witnessed same at the time of its completion.
- That the annexed report is true.

RECEIVED

Dated July 17 1969 July 17 1969 L. G. Hobbs Signature

#53/69 Monteagle L.G. Hobbs. FILE # 39790

THE PENALTY FOR MAKING A FALSE STATEMENT IN THIS REPORT AND/OR CERTIFICATE IS \$500. OR SIX MONTHS IMPRISONMENT OR BOTH

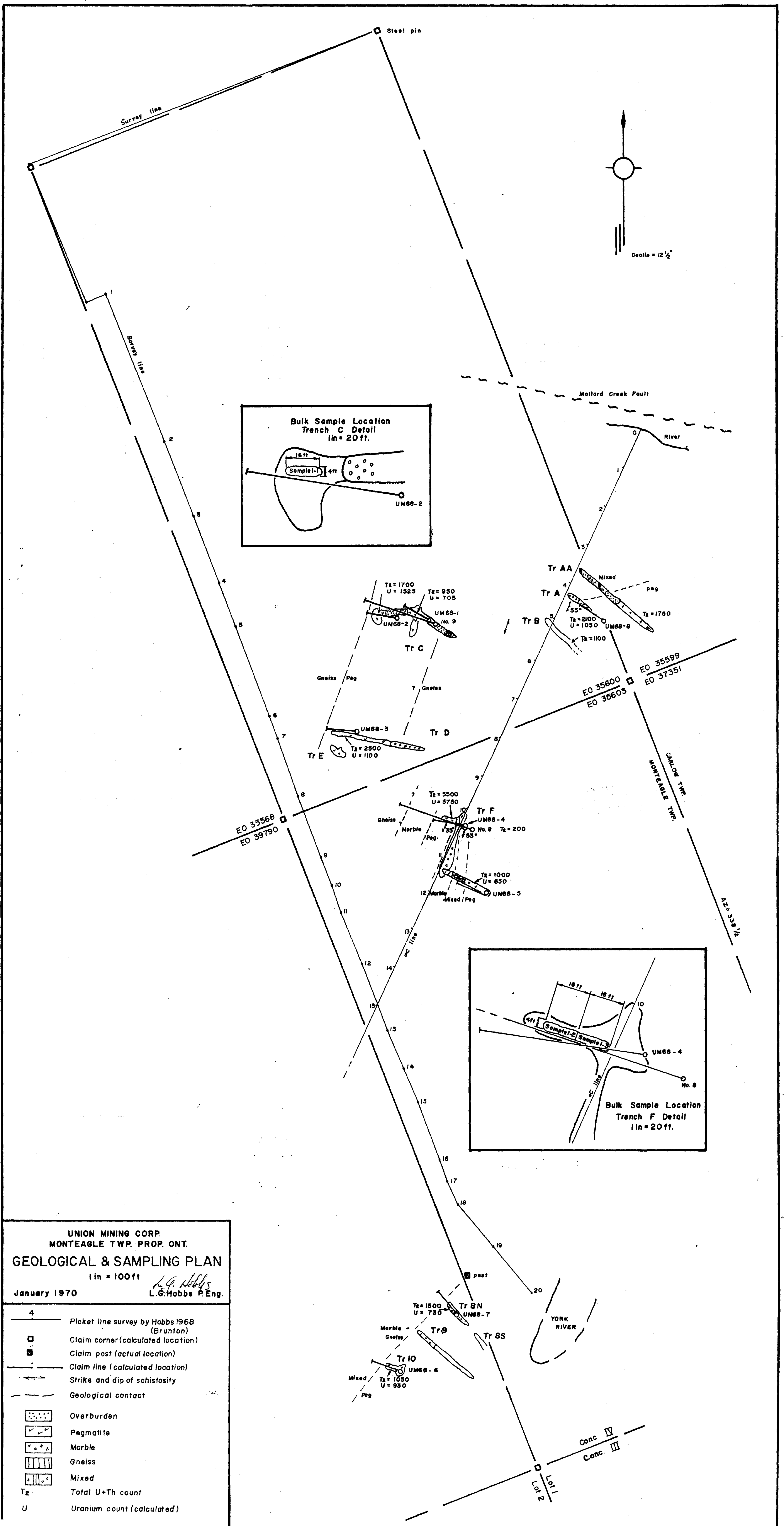

UNION MINING CORP.
 MONTEAGLE TWP. PROP. ONT.
GEOLOGICAL & SAMPLING PLAN
 1 in = 100 ft
 January 1970
L.G. Hobbs
 L.G. Hobbs P. Eng.

- 4 — Picket line survey by Hobbs 1968 (Brunton)
- Claim corner (calculated location)
- Claim post (actual location)
- Claim line (calculated location)
- ↔ Strike and dip of schistosity
- - - Geological contact
- Overburden
- Pegmatite
- Marble
- Gneiss
- Mixed
- T₂ Total U+Th count
- U Uranium count (calculated)