



31F06NE0001 2 16400 SEBASTOPOL

010

2-18400

**Analytical Results for Apatite Samples from Turner's Island, Island 'D', Mining Claim SO  
1150877, Sebastopol Township, Renfrew County, Southern Ontario Mining Division**

for  
**Sharpmin Developments Incorporated**

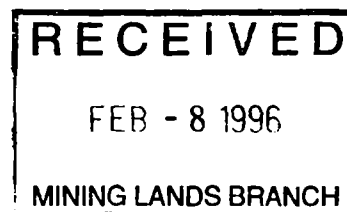

*S. Harper*  
**S. Harper,  
Geologist  
January 4, 1996  
Toronto, Ontario**

### **Background(ppm)**

Several apatite samples collected during past mapping and in storage were prepared and analyzed for Y concentrations.

### **Sample Preparation**

Double polished thin sections of 50 micron thickness were cut and polished to include the C crystallographic axis of 4 apatite samples. The apatite samples were from different calcite veins and were of different colors. The samples were analyzed by electron microprobe (EDS).

<b>Sample</b>	<b>Yttrium</b>
BB	4335
LC	495
MC	455
DC	2620

### **Assessment Work Value**

<b>Sample Preparation \$60/sample</b>	<b>240.00</b>
<b>Analyses</b>	<b>120.00</b>
<b>Subtotal</b>	<b>360.00</b>
<b>GST</b>	<b>25.20</b>
<b>TOTAL</b>	<b>385.20</b>

### **Address**

**Sharpmin Developments Incorporated**  
**Suite 407**  
**153 St. George Street**  
**Toronto, Ontario**  
**M5R 2L9**

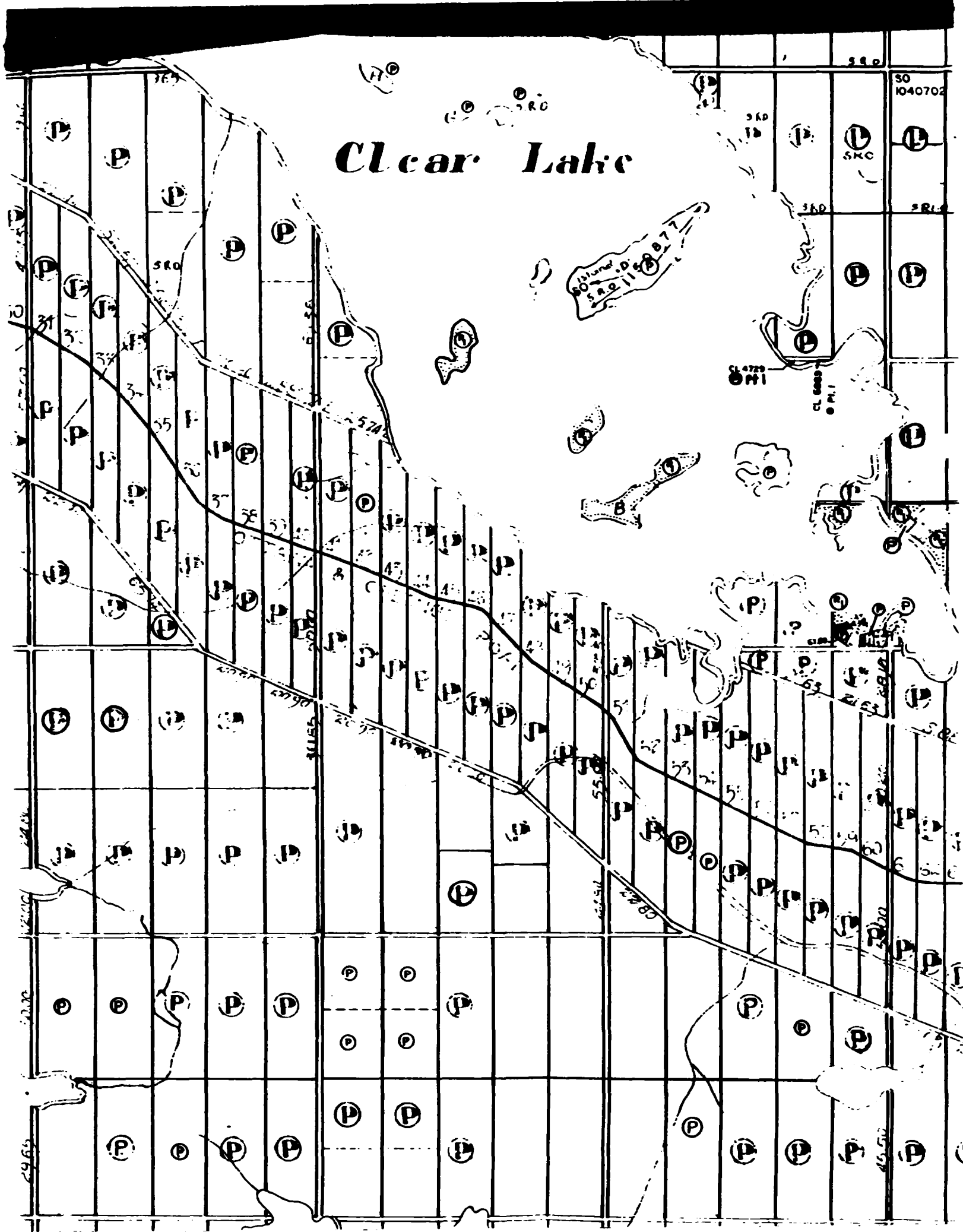

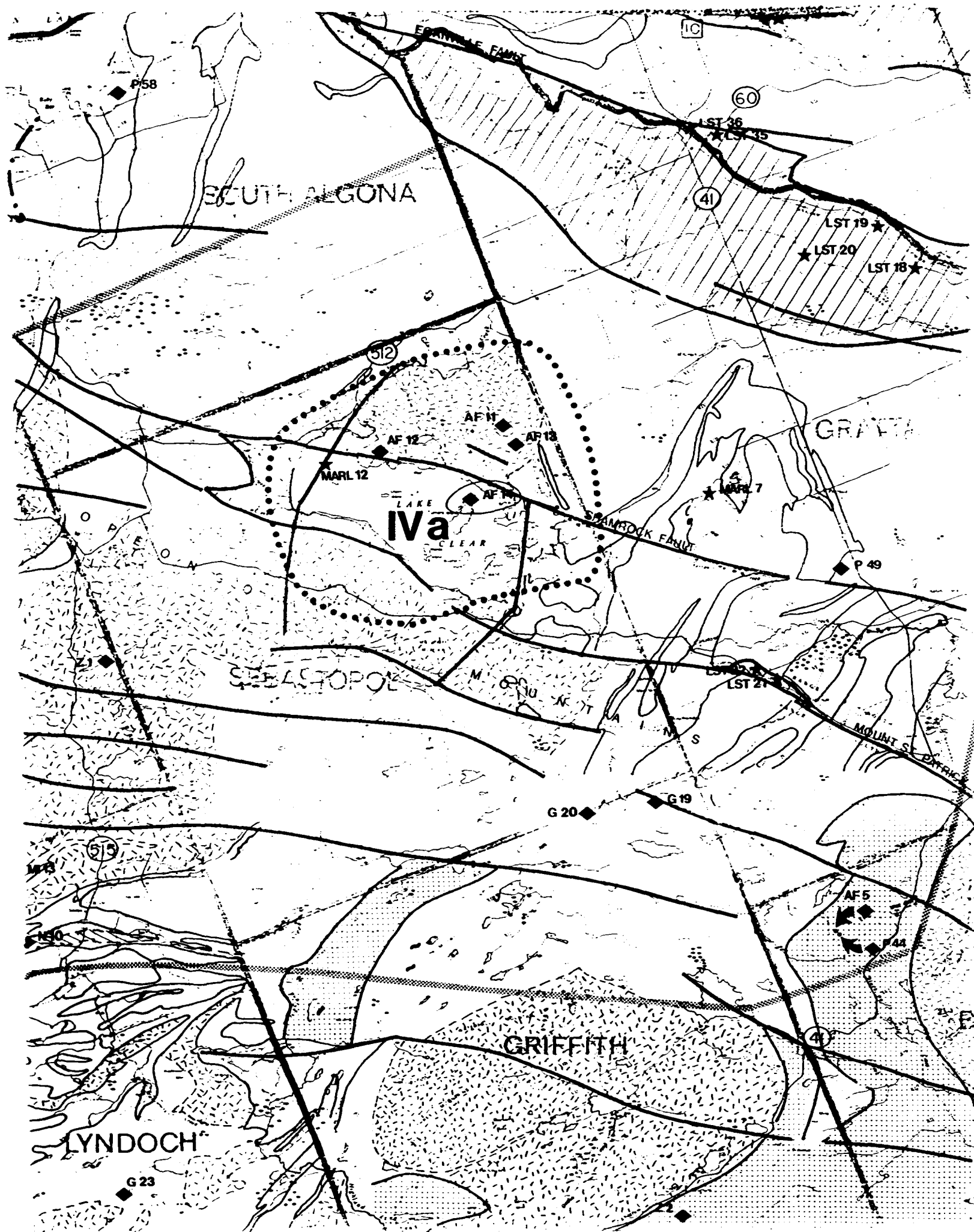

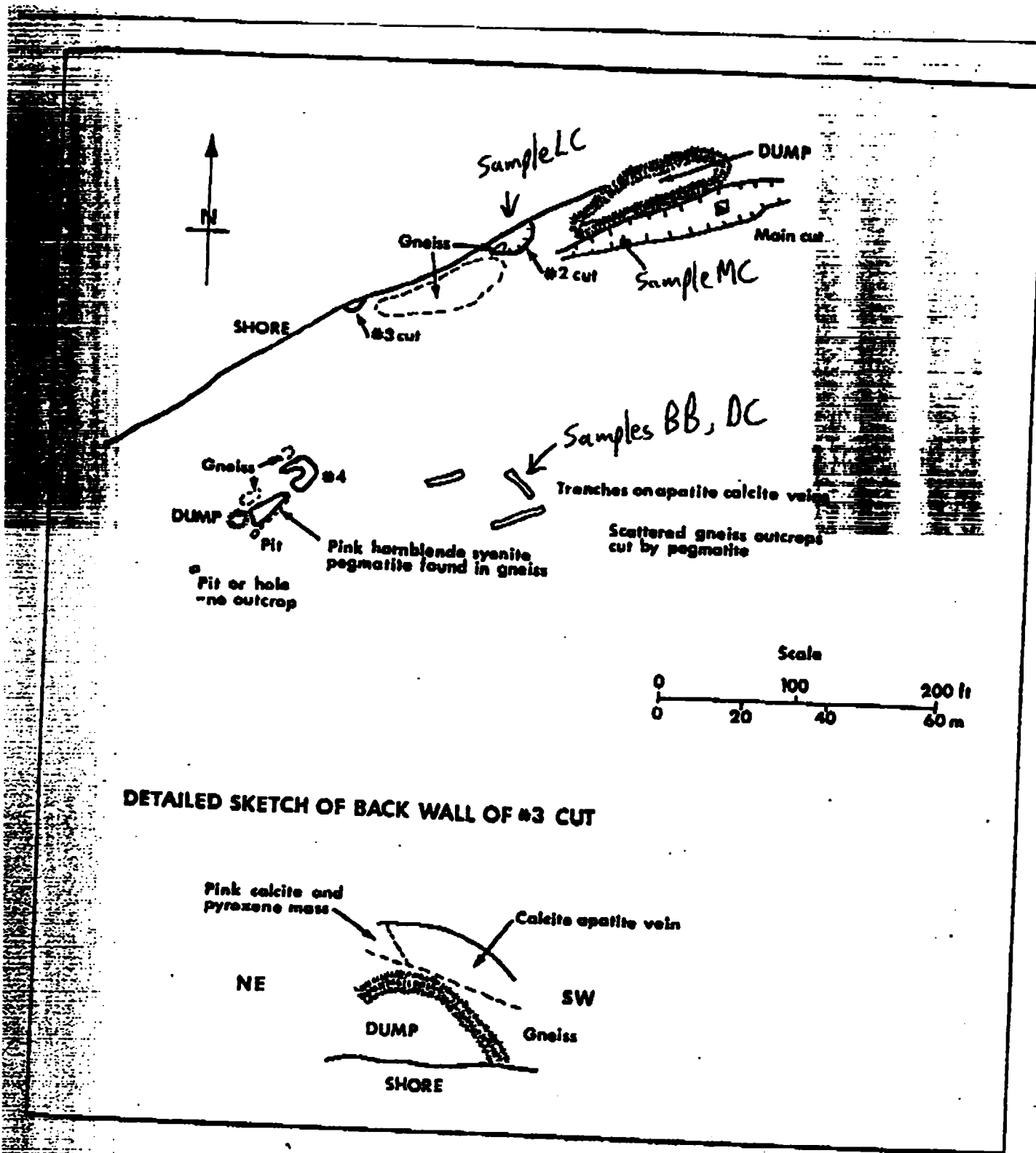

After:

Storey, C. C. and M. A. Vos (1981) Industrial Minerals of the Pembroke-Renfrew Area Part 2)  
Ontario Geological Survey mineral Deposits Circular 22, p. 15.

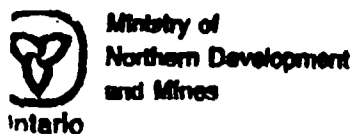

# Report of Work Conducted After Recording Claim

Mining Act

Res. No. Tweed  
Transaction Number  
**W9690.00003**

Personal information collected on this form is obtained under the authority of the Mining Act. This information will be used for correspondence. Questions about its collection should be directed to the Provincial Manager, Mining Lands, Ministry of Northern Development and Mines, Fourth Floor, 159 Cedar Street, Sudbury, Ontario, P3E 6A5, telephone (705) 670-7294.

- Instructions:
- Please type or print and submit in duplicate.
  - Refer to the Mining Act and Regulations for the Recorder.
  - A separate copy of this form must be complete.
  - Technical reports and maps must accompany.
  - A sketch, showing the claims the work is assessed on.

2.16400



31F06NE0001 2 16400 SEBASTOPOL

900

Recorded Holder(s) <b>Sharpin Developments Incorporated</b>	Claim No. <b>294139</b>
Address <b>Suite 407 - 153 St. George Street Toronto Ontario M5R 2L9</b>	Telephone No. <b>416-961-5041</b>
Mining Division <b>Southern Ontario</b>	M or G Plan No. <b>M148</b>
From: <b>June 30, 1995</b>	To: <b>January 15, 1996</b>

### Work Performed (Check One Work Group Only)

Work Group	Type
Geotechnical Survey	
Physical Work, Including Drilling	
Rehabilitation	
Other Authorized Work	
Assays	<b>EDS Electron Microprobe</b>
Assignment from Reserve	

**RECEIVED**  
FEB - 8 1996  
MINING LANDS BRANCH

Total Assessment Work Claimed on the Attached Statement of Costs \$ **385.20**

Note: The Minister may reject for assessment work credit all or part of the assessment work submitted if the recorded holder cannot verify expenditures claimed in the statement of costs within 30 days of a request for verification.

### Persons and Survey Company Who Performed the Work (Give Name and Address of Author of Report)

Name	Address
<b>S. Harper</b>	<b>above</b>

(Attach a schedule if necessary)

### Verification of Beneficial Interest - See Note No. 1 on reverse side

I certify that at the time the work was performed, the claims covered in this work were recorded in the current holder's name or held under a beneficial interest in the current recorded holder.

Date <b>16 Jun '96</b>	Recorded Holder or Agent (Signature) <b>S. Harper</b>
---------------------------	--

### Verification of Work Report

I certify that I have a personal knowledge of the facts set forth in this Work report, having performed the work or witnessed same during and/or after completion and annexed report is true.

Name and Address of Person Certifying  
**S. Harper**

Claim No. <b>as above</b>	Date <b>Jan '96</b>	Certified By (Signature) <b>S. Harper</b>
------------------------------	------------------------	--

### Office Use Only

Assessed Value Cr. Recorded <b>385</b>	Date Recorded <b>JAN. 16/96</b>	Mining Recorder 	<b>ONTARIO MINING DIVISION</b> <b>RECEIVED</b> <b>JAN 15 1996</b> AM 7,8,9,10,11,12,1,2,3,4,5,6 PM
Deemed Approval Date <b>APR. 15/96</b>	Date Approved		
Date Notice for Amendments Sent			





Ministry of  
Northern Development  
and Mines

Ministère du  
Développement du Nord  
et des mines

**Statement of Costs  
for Assessment Credit**

**État des coûts aux fins  
du crédit d'évaluation**

Mining Act/Loi sur les mines

Transaction No./N° de transaction

W9690.00003

2.16400

Personal information collected on this form is obtained under the authority of the Mining Act. This information will be used to maintain a record and ongoing status of the mining claim(s). Questions about this collection should be directed to the Provincial Manager, Minings Lands, Ministry of Northern Development and Mines, 4th Floor, 159 Cedar Street, Sudbury, Ontario P3E 6A5, telephone (705) 670-7264.

Les renseignements personnels contenus dans la présente formule sont recueillis en vertu de la Loi sur les mines et serviront à tenir à jour un registre des concessions minières. Adresser toute question sur la collecte de ces renseignements au chef provincial des terrains miniers, ministère du Développement du Nord et des Mines, 159, rue Cedar, 4<sup>e</sup> étage, Sudbury (Ontario) P3E 6A5. téléphone (705) 670-7264.

**1. Direct Costs/Coûts directs**

Type	Description	Amount Montant	Totals Total global
Wages Salaires	Labour Main-d'oeuvre		
	Field Supervision Supervision sur le terrain		
Contractor's and Consultant's Fees Droits de l'entrepreneur et de l'expert- conseil	Type Assays	385.20	
			385.20
Supplies Used Fournitures utilisées	Type		
Equipment Rental Location de matériel	Type		
<b>Total Direct Costs Total des coûts directs</b>			<b>385.20</b>

**2. Indirect Costs/Coûts indirects**

\*\* Note: When claiming Rehabilitation work Indirect costs are not allowable as assessment work.  
Pour le remboursement des travaux de réhabilitation, les coûts indirects ne sont pas admissibles en tant que travaux d'évaluation.

Type	Description	Amount Montant	Totals Total global
Transportation Transport	Type		
Food and Lodging Nourriture et hébergement			
Mobilization and Demobilization Mobilisation et démobilisation			
<b>Sub Total of Indirect Costs Total partiel des coûts indirects</b>			
<b>Amount Allowable (not greater than 20% of Direct Costs) Montant admissible (n'excedant pas 20 % des coûts directs)</b>			
<b>Total Value of Assessment Credit (Total of Direct and Allowable indirect costs)</b>		<b>Valeur totale du crédit d'évaluation (Total des coûts directs et indirects admissibles)</b>	

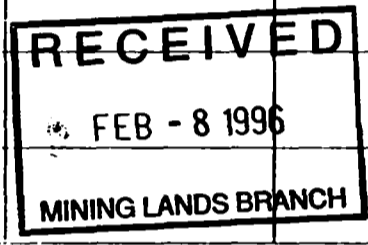

Note: The recorded holder will be required to verify expenditures claimed in this statement of costs within 30 days of a request for verification. If verification is not made, the Minister may reject for assessment work all or part of the assessment work submitted.

Note : Le titulaire enregistré sera tenu de vérifier les dépenses demandées dans le présent état des coûts dans les 30 jours suivant une demande à cet effet. Si la vérification n'est pas effectuée, le ministre peut rejeter tout ou une partie des travaux d'évaluation présentés.

**Filing Discounts**

1. Work filed within two years of completion is claimed at 100% of the above Total Value of Assessment Credit.
2. Work filed three, four or five years after completion is claimed at 50% of the above Total Value of Assessment Credit. See calculations below:

Total Value of Assessment Credit	Total Assessment Claimed
	× 0.50 =

**Remises pour dépôt**

1. Les travaux déposés dans les deux ans suivant leur achèvement sont remboursés à 100 % de la valeur totale susmentionnée du crédit d'évaluation.
2. Les travaux déposés trois, quatre ou cinq ans après leur achèvement sont remboursés à 50 % de la valeur totale du crédit d'évaluation susmentionné. Voir les calculs ci-dessous.

Valeur totale du crédit d'évaluation	Evaluation totale demandée
	× 0,50 =

**Certification Verifying Statement of Costs**

I hereby certify:  
that the amounts shown are as accurate as possible and these costs were incurred while conducting assessment work on the lands shown on the accompanying Report of Work form.

that as Agent I am authorized  
(Recorded Holder, Agent, Position in Company)

to make this certification

**Attestation de l'état des coûts**

J'atteste par la présente :  
que les montants indiqués sont le plus exact possible et que ces dépenses ont été engagées pour effectuer les travaux d'évaluation sur les terrains indiqués dans la formule de rapport de travail ci-joint.

Et qu'à titre de \_\_\_\_\_ je suis autorisé  
(Titulaire enregistré, représentant, poste occupé dans la compagnie)

à faire cette attestation.

Signature: J. Drapeau Date: Jan 15/96



Ministry of  
Northern Development  
and Mines

Ministère du  
Développement du Nord  
et des Mines

Geoscience Assessment Office  
933 Ramsey Lake Road  
6th Floor  
Sudbury, Ontario  
P3E 6B5

Telephone: (705) 670-5853  
Fax: (705) 670-5863

May 30, 1996

Our File: 2.16400  
Transaction #: W9690.00003

Mining Recorder  
Ministry of Northern Development & Mines  
MacDonald Block, Room M2-17  
900 Bay Street  
Toronto, Ontario  
M7A 1C3

Dear Mr Denomme:

**SUBJECT: APPROVAL OF ASSESSMENT WORK CREDIT ON MINING LAND, CLAIM  
SO1150877 IN SEBASTOPOL TOWNSHIP**

The revisions outlined in the Notice dated April 12, 1996, have been corrected. Accordingly, assessment work credit has been approved as outlined on the Declaration of Assessment Work Form accompanying this submission. The credit has been approved under Section 17, Assays, of the Assessment Work Regulation.

**The approval date is May 27, 1996.**

If you have any questions regarding this correspondence, please contact Lucille Jerome at (705) 670-5858.

Yours Sincerely,  
ORIGINAL SIGNED BY:

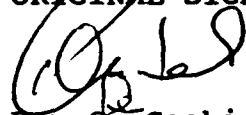

Ron C. Gashinski  
Senior Manager, Mining Lands Section  
Mines and Minerals Division

LBJ/jl  
Enclosure:

cc: Resident Geologist  
Tweed, Ontario

✓ Assessment Files Library  
Sudbury, Ontario

# SEBASTOPOL

LEGEND

CANCELLED	C
PATENTED LAND	⊙
CROWN LAND SALE	⊙
LEASES	⊙
LOCATED LAND	⊙
LICENSE OF OCCUPATION	LO
MINING RIGHTS ONLY	M.R.O.
SURFACE RIGHTS ONLY	S.R.O.

Areas withdrawn from staking under Section 43 of the Mining Act. (R.S.O.70)

Order no.	File	Date	Disposition
W 3 / 78	188534	JAN 11 '78	S.R.O.

DATE OF ISSUE  
 JAN 23 1996  
 SOUTHERN ONTARIO  
 MINING DIVISION

SOUTHERN ONTARIO  
 Scale — 10 Chains = 1 Inch

SOUTH ALGONQUIN 16400

THE INFORMATION THAT APPEARS ON THIS MAP HAS BEEN COMPILED FROM VARIOUS SOURCES, AND ACCURACY IS NOT GUARANTEED. THOSE WISHING TO STAKE MINING CLAIMS SHOULD CONSULT WITH THE MINING RECORDER, MINISTRY OF NORTHERN DEVELOPMENT AND MINES, FOR ADDITIONAL INFORMATION ON THE STATUS OF THE LANDS SHOWN HEREON.

BRUDENELL

GRATTAN

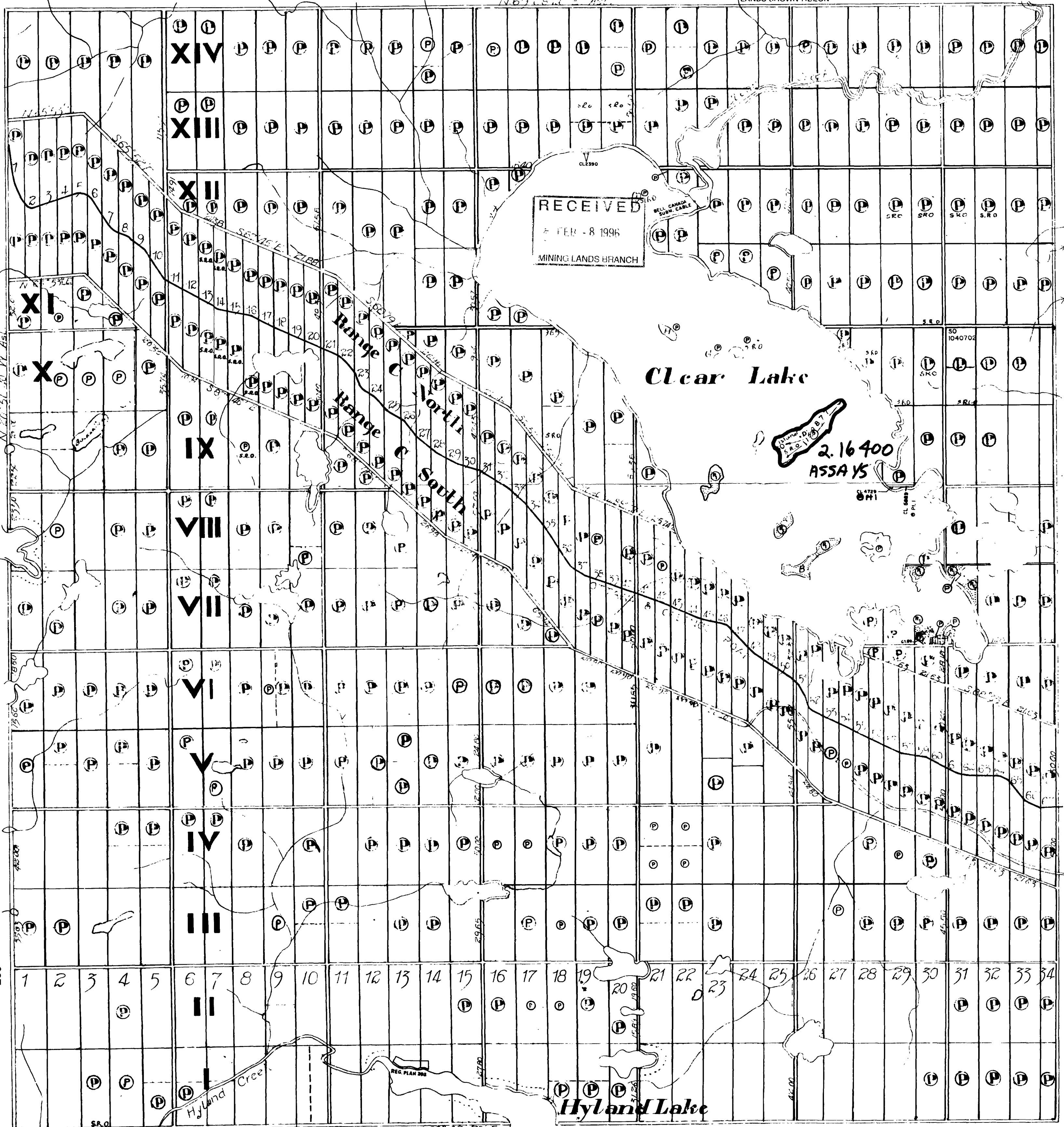

Surface reservation 400' wide around all lakes & rivers.

GRIFFITH

PLAN NO M.148

