

Diamond Drilling



31F07NE9655 10 BAGOT

010

Township of BAGOT

Report No: 10

Work performed by: Goldyke Mines Limited

Claim No	Hole No	Footage	Date	Note
EO 12430	#1	210.0'	May/55	
	#2	247.0'	June/55	
	#3	175.0'	June/55	
	#4	227.0'	June/55	
	#5	243.0'	June/55	

Notes:

# DIAMOND DRILL RECORD

PROPERTY GOLDFIE MINES LIMITED

E.O. 12470

HOLE NO. 1

Ad. 16968

SHEET NUMBER 1

SECTION FROM \_\_\_\_\_ TO \_\_\_\_\_

STARTED May 30th 4.00 p.m.

LATITUDE North end of Main

DATUM D. M. #20 Collar

Night shift May 31st.

DEPARTURE drift on 2nd level

BEARING Due East (Mag)

COMPLETED June 3rd 7.00 a.m.

ELEVATION Under ground 175 ft. level

DIP -40°

ULTIMATE DEPTH 210.0'

PROPOSED DEPTH 150.0'

DEPTH FEET	FORMATION	SAMPLE NO.	WIDTH OF SAMPLE	GOLD \$	SLUDGE GOLD \$	C.P.M.
00. - 0.3'	Paragneiss, considerable greenish and black mica (biotite)		BACKGROUND	-		60
0.3' - 4.1'	Coarse reddish pegmatite dike		FROM		TO	
4.1' - 11.0'	Paragneiss, thin threads of biotite		0.0		64.0	60 - 100
11.0' - 13.0'	Mostly quartzite		64.0		65.0	60 - 120
13.8' - 18.0'	Includes two pegmatite dikes 12" & 4" in hybrid gneiss.		65.0		68.0	60 - 80
18.0' - 42.0'	Hybrid gneiss with few bands quartz and feldspar.		68.0		69.0	60 - 140
	Disseminated biotite and pyrite.		69.0		75.0	60 - 100
42.0' - 57.0'	Gneiss with about 40% red feldspar and disseminated pyrite		75.0		77.3	60 - 120
57.0' - 72.0'	Same as above with series of narrow sections of pyroxenite		77.3		81.0	60 - 100
	from 1" to 4" wide		81.0		87.5	120 - 180
72.0 - 78.2	White quartz - pegmatite no mineralisation		87.5		91.0	120 & 140
78.2' - 79.3'	Hybrid gneiss		91.0		95.0	60 - 120
79.3' - 87.4'	Reddish pegmatite dike, 30% feldspar - 40% quartz		95.0		101.0	60 - 80
87.4' - 95.0'	Banded hybrid gneiss, few narrow stringers (2" max) of altered gneiss		101.0		101.5	200 - 240
			101.5		114.5	60 - 80
95.0' - 141.0'	Pyroxenite, coarse grained, dark greenish, narrow sections of black biotite-gneiss		114.5		116.0	100 - 140
			116.0		120.0	60 - 100
	93.0 - 109.0 2.0' ground		120.0		120.3	200 - 240
	123.0 - 124.0 gneiss		120.3		132.0	60 - 120
141.0' - 145.0'	Quartzite, fair pyrite and chalcocopyrite		132.0		133.5	100 - 180
145.0' - 147.0	Pyroxenite		133.5		137.0	60 - 100

N.M.P., TORONTO-STOCK FORM NO. 501 REV. 12/51

DRILLED BY Edm. Longyear Drilling Co. Ltd. SIGNED J. Williamson

# DIAMOND DRILL RECORD

PROPERTY GOLDYKE MINES LIMITED HOLE NO. L

SHEET NUMBER 2 SECTION FROM \_\_\_\_\_ TO \_\_\_\_\_ STARTED \_\_\_\_\_

LATITUDE \_\_\_\_\_ DATUM D.D.M. #20 COMPLETED \_\_\_\_\_

DEPARTURE \_\_\_\_\_ BEARING \_\_\_\_\_ ULTIMATE DEPTH \_\_\_\_\_

ELEVATION \_\_\_\_\_ DIP \_\_\_\_\_ PROPOSED DEPTH \_\_\_\_\_

DEPTH FEET	FORMATION	SAMPLE NO.	WIDTH OF SAMPLE	GOLD \$	SLUDGE GOLD \$	C.P.M.
<u>147.0 - 152.0</u>	<u>Quartzite - fair pyrite</u>		<u>FROM</u>		<u>TO</u>	
<u>152.0 - 165.0</u>	<u>Pyroxenite - quite coarse, several splashes of massive pyrite</u>		<u>137.0</u>		<u>138.5</u>	<u>60 - 140</u>
			<u>138.5</u>		<u>141.0</u>	<u>60 @ 100</u>
<u>165.0 - 175.8</u>	<u>Quartzite, fine disseminated pyrite, pentlandite? pyrrhotite (magnetic) and chalcopyrite</u>		<u>141.0</u>		<u>145.0</u>	<u>60 - 80</u>
			<u>145.0</u>		<u>158.0</u>	<u>60 - 80</u>
<u>175.8 - 210.0</u>	<u>Biotite gneiss - unaltered</u>		<u>158.0</u>		<u>175.0</u>	<u>60 - 100</u>
	<u>203.0 - 204.0 pegmatite</u>		<u>175.0</u>		<u>200.0</u>	<u>60 - 100</u>
<u>210.0</u>	<u>END OF HOLE</u>					
<u>Sample 473</u>	<u>79.3 - 87.4 (Pegmatite G = 60 - 240</u>					
<u>Sample 475</u>	<u>101.0 - 102.0 Pyroxenite G = 60 - 160</u>					
<u>Sample 476</u>	<u>119.5 - 120.5 Pyroxenite</u>					
<u>Sample 477</u>	<u>131.3 @ 132.9 Pyroxenite G = 60 - 160</u>					
<u>Sample 479</u>	<u>178.7 - 181.7 Biotite gneiss - strongly magnetic (magnetite) (May contain columbium) (Spectrograph analysis)</u>					
<u>Sample 478</u>	<u>172.0 - 175.0 Well mineralized quartz, pyrite, pyrrhotite chalcopyrite, and pentlandite (Nickel) (Spectrograph analysis)</u>					

# DIAMOND DRILL RECORD

PROPERTY GOLDENE MINES LIMITED HOLE NO. 2

SHEET NUMBER 1 SECTION FROM \_\_\_\_\_ TO \_\_\_\_\_ STARTED June 3rd 1955 10.30 p.m.  
 LATITUDE 70° East junction DATUM 7-cut to E. Drift COMPLETED June 6th 1955 2 p.m.  
Main x-cut and main drift  
 DEPARTURE 2nd level BEARING Due West (Mag) ULTIMATE DEPTH 247.0  
 ELEVATION Underground DIP -30° PROPOSED DEPTH 150.0

DEPTH FEET	FORMATION	SAMPLE NO.	WIDTH OF SAMPLE	GOLD \$	SLUDGE GOLD \$	G.P.M.
00 - 2.0	Casing			0 - 6.0		60 - 100
2.0' - 6.3'	Coarse granite gneiss 30% feldspar (2.0' ground)			6.0 - 9.0		60 - 140
6.3' - 9.5'	Reddish pegmatite			9.0 - 27.0		60 - 100
	15.2' - 17.5' few narrow pegmatite stringers (2" max)			27.0 - 34.0		60 - 80
9.5' - 134.4'	Coarse granite gneiss, about 30° to core. (Dip of bedding approximately 60° west.)			34.0 - 35.0		60 - 100
	38.6 - 38.9 3" pegmatite			35 - 38.6		60 - 80
134.4' - 138.8'	Pyroxenite, massive patches biotite			38.6 - 38.9		60 - 150
138.8 - 144.0	Black biotite gneiss, few narrow quartz stringers			38.9 - 43.0		60 - 100
	131.0 - 1.0' ground			43.0 - 44.3		200 - 600
144.0 - 154.0'	Densely quartzite with narrow quartz and pegmatite veins to 4" max. width.			44.3 - 53.0		60 - 100
154.0' - 174.5'	Limestones - light yellowish green			53.0 - 59.0		60 - 80
174.5 - 211.0'	Biotite gneiss, few narrow bands of limestone			65.0 - 66.6		60 - 100
211.0 - 217.5	Limestone			66.6 - 102.0		50 - 80
217.5 - 247.0	Biotite gneiss			102.0 - 148.0		60 - 100
247.0'	END OF HOLE	233.3 - 235.0	Pegmatite	148.0 - 154.0		60 - 120
		238.0 - 238.4	Pegmatite	154.0 - 220.0		60 - 120
SAMPLE #483	43.0 - 44.3 Pegmatite dike			220.0 - 234.5		100 - 160
	65.0 - 66.6 " "			234.5 - 235.0		100 - 200
	97.0 - 98.2 " "			235.0 - 247.0		60 - 80

N.M.P., TORONTO - STOCK FORM NO. 501 REV. 12/51

DRILLED BY Cdn. Longyear Drilling Co.

SIGNED J. F. Williamson

OLDYKE MINES LIMITED

SAMPLE LIST

2nd LEVEL - EAST DRIFT - CHANNELS

<u>SAMPLE NUMBER</u>	<u>LOCATION</u>	<u>WIDTH</u>	<u>DESCRIPTION</u>	<u>SEIGER C.P.M.</u>	<u>EST. U-308</u>
488	30' N of x-cut E Wall	3.0'	60% biotite-gneiss balance pyroxenite	60 - 120	
489	30' N of x-cut E-back	6.0'	20% biotite-gneiss	60 - 120	
490	30' N of x-cut W-wall	7.5'	Granite-gneiss	60 - 100	
491	40' N of x-cut E-wall	7.5'	60% biotite	60 - 120	
492	40' N of x-cut W-wall	6.9'	Granite gneiss	60 - 100	

1st LEVEL - N x-cut

493	Pyroxenite - limestone contact on nose of fold	2.0'	North x-cut	60 - 300	
494	50' N station	1.6'	Granite-gneiss & narrow pegmatite stringers. Massive pyrite	300 - 700	
495	50' N station (5' S.W. #494)	2.3'	Granite-gneiss	60 - 100	
496	50' N station (10' S.W. #494)	4.3'	Granite-gneiss & pegmatite	300 - 900	

"J. D. Williamson"

# DIAMOND DRILL RECORD

PROPERTY Galdyke Mines Limited - Renfrew Property HOLE NO. 3

SHEET NUMBER 1 SECTION FROM \_\_\_\_\_ TO \_\_\_\_\_ STARTED June 6th 1955 7.00 p.m.  
 LATITUDE 25° East junction DATUM X-cut to L. Drift COMPLETED June 6th, 1955 1.00 p.m.  
 DEPARTURE Nd in x-cut & Main drift BEARING N 65° W ULTIMATE DEPTH 175.0'  
 ELEVATION \_\_\_\_\_ DIP -30° PROPOSED DEPTH 150.0'

DEPTH FEET	FORMATION	SAMPLE NO.	WIDTH OF SAMPLE	GOLD \$	SLUDGE GOLD \$	C.P.M.
00 - 2.0	Casing			2.0 - 72.5		60 - 80
2.0 - 8.5	Reddish granite gneiss			72.5 - 74.0		60 - 120
8.5 - 63.0	Black biotite gneiss			74.0 - 93.0		60 - 80
	39.0 - 41.0 - Ground core			93.0 - 107.0		60 - 160
	46.2 - 46.8 White pegmatite			107.0 - 121.5		60 - 80
	42.6 - 43.0 Reddish pegmatite (bladder)			121.5 - 131.5		60 - 120
	Cutting bedding at 30° to core, some fragments, and few scattered threads of pyrite from 43.0' - 52.0'			131.5 - 161.0		60 - 80
				161.0 - 171.0		60 - 120
63.0 - 69.4	Coarse granite gneiss			171.0 - 175.0		60 - 80
	58.3 - 67.0 2" core round					
69.4 - 74.5	Yellowish green quartzite?					
74.5 - 80.0	Black biotite gneiss					
80.0 - 94.5	Limestone - Two narrow pegmatite dikes at 89.8 to 91.0' and 93.8 to 94.5'					
94.5 - 108.5	Quartzite - light green 107.0 to 116.5 - 2" ground core					
108.5 - 110.5	Biotite gneiss					
110.5 - 121.5	Dull grey quartzite					
121.5 - 122.8	Mostly pyroxenite, some large splashes of massive pyrite					
122.8 - 139.3	Mostly dull grey quartzite, some narrow stringers of limestone					
139.3 - 173.5	Biotite gneiss, few stringers & threads quartz and calcite					
173.5 - 175.0	Quartzite					

M.M.P. TORONTO-STOCK FORM NO. 504 REV. 12/51

DRILLED BY Ed Longyear Drilling Co.

SIGNED J. Williamson

# DIAMOND DRILL RECORD

PROPERTY Geddyke Mines Limited

HOLE NO. 4

SHEET NUMBER 1

SECTION FROM \_\_\_\_\_ TO \_\_\_\_\_

STARTED June 8th 1955 - 5.00 p.m.

LATITUDE Centre of raise

DATUM 20° E & 50° N station

COMPLETED June 11th - 3.00 p.m.

DEPARTURE \_\_\_\_\_

BEARING N 78° E (Mag)

ULTIMATE DEPTH 227.0

ELEVATION 2nd level

DIP - 00°

PROPOSED DEPTH 400'

DEPTH FEET	FORMATION	SAMPLE NO.	WIDTH OF SAMPLE	GOLD \$	SLUDGE GOLD \$	C.P.M.
00.0 - 2.0	Casing			00.0 - 89.0		60 - 100
2.0 - 4.5	Pegmatite			09.0 - 109.0		60 - 110
4.5 - 61.5	Granite gneiss. Few narrow (1") striations of pegmatite which are slightly higher in radioactivity. (60 - 120)			109.0 - 121.0		60 - 160
	More red feldspar in gneiss from 35.0 ft.			121.0 - 122.0		60 - 240
	52.0 - 58.0 Badly shattered			122.0 - 145.3		(60 - 210)
	59.7 - 60.8 Pegmatite			145.3 - 146.3		(60 - 180)
				146.3 - 147.0		60 - 120
61.5 - 76.0	Biotite-gneiss			147.0 - 157.0		60 - 80
76.0 - 109.0	Granite gneiss			157.0 - 172.4		60 - 100
	91.0 - 98.0 Badly shattered			172.4 - 179.4		60 - 100
109.0 - 121.0	Reddish pegmatite			179.4 - 191.0		60 - 120
121.0 - 147.0	Pyroxenite - considered biotite at contact, some pyrite			191.0 - 218.0		60 - 80
147.0 - 157.0	Biotite gneiss			218.0 - 222.0		60 - 110
157 - 172.4	Pyroxenite - few scattered patches massive pyrite from			222.0 - 227.0		60 - 80
	158.5 - 162.5					
	148.0 - 154.0 2' ground					
172.4 - 179.4	Quartzite and biotite gneiss					
179.4 - 191.0	Pyroxenite - few patches pyrite					
191.0 - 227.0	Biotite gneiss - at 70° to core					
	205.6 - 207.5 Pyroxenite					
	207.8 - 210.8 Quartzite & pegmatite					

N.M.P., TORONTO-STOCK FORM NO. 501 REV. 12/51

DRILLED BY Cdn. Longyear Drilling Co.

SIGNED J. W. Williamson





# DIAMOND DRILL RECORD

PROPERTY GOLDBECK MINES LIMITED

HOLE NO. 5

SHEET NUMBER 1

SECTION FROM \_\_\_\_\_ TO \_\_\_\_\_

STARTED June 11th 1955 7.00 p.m.

LATITUDE 70° North

DATUM 201 x-out

COMPLETED June 14th, 1955 7.00 p.m.

DEPARTURE 15° West (Raise)

BEARING N 76° E

ULTIMATE DEPTH 213.0'

ELEVATION 2nd level

DIP -80°

PROPOSED DEPTH 250.0'

DEPTH FEET	FORMATION	SAMPLE NO.	WIDTH OF SAMPLE	GOLD \$	SLUDGE GOLD \$	C.P.M.
0.0 - 2.0	Casing					
2.0 - 12.0	Biotite-gneiss			2.0 - 12.0		60 - 80
12.0 - 19.0	Reddish pegmatite			12.0 - 19.0		60 - 120
19.0 - 146.0	Granite gneiss - pegmatite stringers			19.0 - 46.8		60 - 120
	46.5 - 46.8 Red pegmatite			46.8 - 108.0		60 - 80
	104.5 - 106.0 " "			108.0 - 119.0		60 - 180
	108.0 - 112.4 " "			119.0 - 146.0		60 - 120
146.0 - 183.0	Pyroxenite. Considered biotite in first four feet, some pyrite			146.0 - 184.5		60 - 120
	149.5 - 151.0 Biotite gneiss			184.5 - 212.0		60 - 120
	165.6 - 169.0 Quartzite					
	169.0 - 178.0 Biotite gneiss					
	151.0 - 158.0 1.0' ground					
	158.0 - 169.0 3.0' ground					
	178.0 - 183.0 2.0' ground					
183.0 - 211.0	Pyroxenite - sparse biotite					
	193.0 - 199.0 includes 1 foot quartzite, granite gneiss.					
	200.0 - 204.0 Biotite gneiss					
	210.0 - 211.0 Quartzite					
211.0 - 221.0	Biotite gneiss					
221.0 - 237.4	Pyroxenite - few narrow sections of quartzite					

N.M.P. TORONTO-STOCK FORM NO. 501 REV. 12/51

DRILLED BY Edn. Longyear Drilling Co.

SIGNED J. D. Williamson

# DIAMOND DRILL RECORD

PROPERTY GOLDYKE MINES LIMITED

HOLE NO. 5

SHEET NUMBER 2 SECTION FROM \_\_\_\_\_ TO \_\_\_\_\_ STARTED \_\_\_\_\_

LATITUDE \_\_\_\_\_ DATUM \_\_\_\_\_ COMPLETED \_\_\_\_\_

DEPARTURE \_\_\_\_\_ BEARING \_\_\_\_\_ ULTIMATE DEPTH \_\_\_\_\_

ELEVATION \_\_\_\_\_ DIP \_\_\_\_\_ PROPOSED DEPTH \_\_\_\_\_

DEPTH FEET	FORMATION	SAMPLE NO.	WIDTH OF SAMPLE	GOLD \$	SLUDGE GOLD \$	C.P.M.
237.4 - 243.0	Biotite gneiss. Few quartzite stringers			212.0 - 213.0		60 - 120
243.0	END OF HOLE					

N.M.P. TORONTO-STOCK FORM No. 501 REV. 12/51

DRILLED BY ..... SIGNED .....

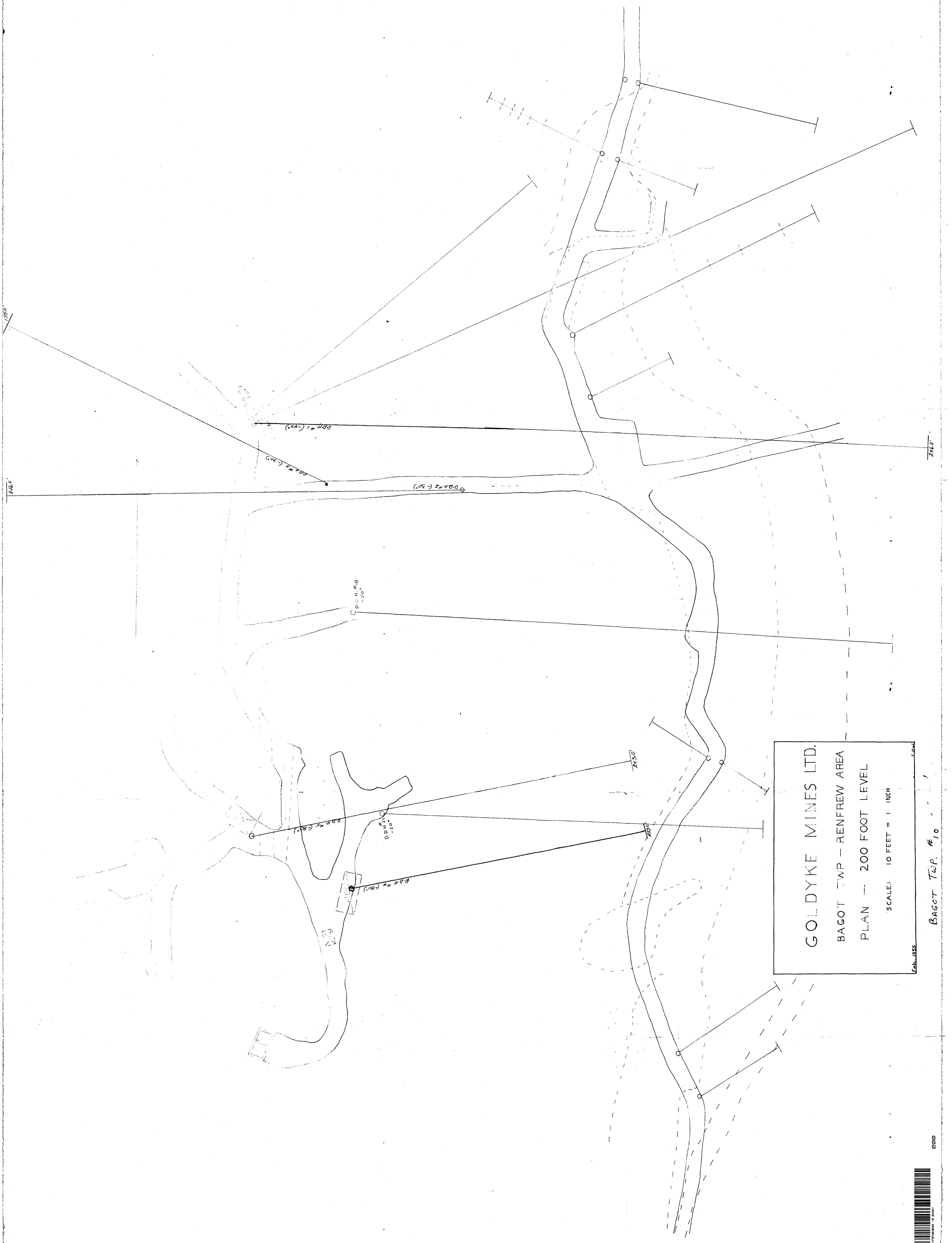

GOLDYKE MINES LTD.  
 BAGOT TWP - RENFREW AREA  
 PLAN -- 200 FOOT LEVEL  
 SCALE: 10 FEET = 1 INCH  
 Feb. 1955

Bagot Twp. # 10

