

PINEWOOD PARK DRIVE
P.O. BOX 237

NORTH BAY, ONTARIO
P1B 8H2

Office: 705-474-4110
Home: 705-474-4793

June 12, 1990

R



010

JUN 13 1990

MINING LANDS
880 Bay Street
3rd Floor
TORONTO, Ontario
M5S 1Z8

MINING LANDS SECTION

Attention: Jill Stewart, Geotechnical Assessor

RE: **Assessment Work Report - Assaying**
 North Coast Industries Ltd. - Graphic Property
 Marie Township - County of Renfrew
 Your File No. 2-13229

Dear Ms. Stewart:

Please find enclosed the following: (2 sets)

1. **Property Plan showing performed work**
2. **Location Plan showing Sampling Pit Location**
3. **Summary Assay Sheet**
4. **Certificate of Analysis**
5. **X-Sections (2 pages)**
6. **Detail Plan (Scale 1" = 10') showing Sample and Assay Locations and other details**

This work was performed during the period from December 27, 1989 to January 10, 1990.

Pit location was drilled and blasted. Samples were taken in pit area. (Assay results on above plans).

Four truck loads of materials were trucked and crushed. Sample results of truck ore are outlined in this report.

Samples were assayed for Graphitic Carbon C(g)% by the L.O.I. and LECO methods.

If you have any further questions please contact my office.

Yours very truly,
R.M. BLAIS & ASSOCIATES LTD.

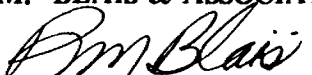
Ronald M. Blais, P. Eng.
President

SUMMARY ASSAY SHEET - 60 TON BULK SAMPLE
 JANUARY 1990

Sample	North Coast Lab		Lakefield LECO		Description
	L.O.I.	C(T)%	C(g)%		
A	3.82	3.52	3.06		Grab Sample Top End Plug Trench at Swamp
B	3.67	3.36	3.23		" " " " "
C	3.91	3.52	3.07		" " " " "
D	3.70	3.26	2.94		" " " " "
E	4.26	3.85	3.60		" " " " "
010	3.72	3.58	3.31		See Attached Sketch
011	3.56	3.39	2.97		
012	3.91	3.71	3.48		
013	3.46	3.17	2.61		
014	3.12	2.84	2.64		
015	3.70	3.25	2.87		See Attached Sketch
018	3.27	3.29	2.97		Truck #1 ROM from 60 Ton Bulk Sample (RMB Yard)
019	3.39	3.22	3.04		Truck #2 RO, from 60 Ton Bulk Sample (RMB Yard)
020	3.85	3.78	3.62		Truck #3 ROM from 60 Ton Bulk Sample (RMB Yard)
021	3.49	3.49	3.25		East Face - Jan 1990 Trench
022	3.60	3.58	3.41		West Face - Jan 1990 Trench
023	3.36	3.16	2.84		North Face - Jan 1990 Trench
024	3.77	3.74	3.60		South Face - Jan 1990 Trench
025	3.47	3.37	3.18		200 Lb. Mini Bulk Shipped by Purolator to ORTECH
028	3.51	3.75	3.51		Truck #4 ROM from 60 Ton Bulk Sample (RMB Yard)
029	3.68	3.61	3.54		Truck #1 Crushed - 4 1/2" Hauled to ORTECH (in bldg.)
030	3.61	3.48	3.31		Truck #2 Crushed - 4 1/2" Hauled to ORTECH (outside)
031		3.40	3.16		Truck #3 Crushed - 4 1/2" Hauled Back to RMB Yard
032		2.04	1.83		Remainder Truck Sample - Greco Pit now moved to Belanger Yard

C(T)% Carbon (Total)
 C(g)% Carbon (Graphitic)



LAKEFIELD RESEARCH

A DIVISION OF FALCONBRIDGE LIMITED

P.O. Box 430, 185 Concession St., LAKEFIELD, ON K0L 2H0

Phone: (705) 652-3341, Facsimile: (705) 652-4365, Telex: 0696-2842

No.: 5156

CERTIFICATE OF ANALYSIS

North Coast Industries
 1201 - 601 West Hastings
 Price Waterhouse Centre, Vancouver, BC V6B 5A6

Date: December 22, 1989
 Sample Received: November 20, 1989
 No. of Samples: 11
 Our Reference No.: 8933423
 Your P.O. No.:

Mr. Dave Copeland

LECO

Samples submitted to us show results as follows:

Sample	C(T) %	C(g) % <small>NO LEACH</small>
Dec. 13/89		
A	3.52	3.06
B	3.36	3.23
C	3.52	3.07
D	3.26	2.94
E	3.85	3.60
-		
Dec. 18/89		
010	3.58	3.31
011	3.39	2.97
012	3.71	3.48
015	3.17	2.61
014	2.84	2.64
015	3.25	2.87
Totals:	11	11

Additional Copies to R. M. Blais

Signed:

NOTE: Rejects will be discarded after 6 months
 Please, inquire about our long-term storage facilities

A. E. Carr, Manager - Assay Services

LAKEFIELD RESEARCH
 A DIVISION OF FALCONBRIDGE LIMITED
 P.O. Box 430, 185 Concession St., LAKEFIELD, ON K0L 2H0
 Phone: (705) 652-3341, Facsimile: (705) 652-6365, Telex: 0696-2842

No.: 5235

CERTIFICATE OF ANALYSIS

North Coast Industries Ltd.
 1201-501 West Hastings St., Price Waterhouse Centre
 Vancouver, B. C., V6B 5A6

Date: January 11, 1990
 Sample Received: January 8, 1990
 No. of Samples: 9
 Our Reference No.: 9033498
 Your P.O. No.:

Mr. Dave Coupland

Samples submitted to us show results as follows:

Sample	C(T) %	C(G) %
018	3.29	2.97
019	3.22	3.04
020	3.78	3.62
021	3.49	3.25
022	3.58	3.41
023	3.16	2.84
024	3.74	3.60
025	3.37	3.18
026	3.75	3.51
Totals:	9	9

Additional Copies to Mr. W. Moffat

Signed: 

NOTE: Rejects will be discarded after 6 months
 Please, inquire about our long-term storage facilities

LAKEFIELD RESEARCH
 A DIVISION OF FALCONBRIDGE LIMITED
 P.O. Box 430, 185 Concession St., LAKEFIELD, ON K0L 2H0
 Phone: (705) 652-3341, Facsimile: (705) 652-6365, Telex: 0696-2842

No.: 5308

CERTIFICATE OF ANALYSIS

North Coast Industries Ltd.
 1201-601 West Hastings St., Price Waterhouse Centre
 Vancouver, B. C., V6B 5A6

Date: January 24, 1990

Sample Received: January 18, 1990

No. of Samples: 6

Our Reference No.: 9033551

Your P.O. No.:

Mr. Dave Coupland

Samples submitted to us show results as follows:

Sample	C(T) %	C(g) %
029	3.61	3.54
030	3.48	3.31
031	3.40	3.16
032	2.04	1.83
033	2.04	1.92
034	2.32	2.15
Totals:	6	6

Additional Copies to Mr. W. Moffat

Signed: 

NOTE: Rejects will be discarded after 6 months
 Please inquire about our long-term storage facilities

A. F. Carr, Manager - Assay Services

INVOICE



LAKEFIELD RESEARCH

A DIVISION OF FALCONBRIDGE LIMITED

P.O. Box 430, 185 Concession St., Lakefield, Ontario K0L 2H0

Phone: (705) 652-3341

Telex No. 08 962842

Fax No. (705) 652-6365

No.: C 03235

DATE January 11, 1990

SENT TO: Mr. D. Coupland

North Coast Industries Ltd.
1201-601 West Hastings St., Price Waterhouse
Vancouver, B. C., V6B 5A6

Our Certificate Of Analysis Number(s): 5235

Our Reference Number: 9033488

Number of Samples: RE: 9 Samples for Carbon total and graphitic

Analytical Cost

Qty.	Symbol	Element	Unit Price	Assay Cost
9	C(T) %	1-Carbon Total	\$10.00	\$90.00
9	C(G) %	1-Carb. Graphitic	\$18.00	\$162.00
				\$252.00
Additional Costs:				
Sample Preparation:				
Pulverizing:				
Long Dist. Phone:				
Telex:				
Facsimile:				
Courier/Spec. Del.:				
Freight:				
Custom/Drekar:				
Storage:				
hrs: @ :				
Extras				
				\$0.00
% Discount				
Net Cost				\$252.00
Extras				\$252.00
Less Advance Payment:				
Invoice Amount				\$252.00

RMB Blas

INVOICE



LAKEFIELD RESEARCH

A DIVISION OF FALCONBRIDGE LIMITED

P.O. Box 430, 185 Concession St., Lakefield, Ontario K0L 2H0

Phone: (705) 652-3341

Telex No. 06 962842

Fax No. (705) 652-6365

No.: **C 03278**

DATE **January 24, 1990**

SENT TO: **Mr. D. Coupland**

North Coast Industries Ltd.
1201-601 West Hastings St., Price Waterhouse
Vancouver, B. C., V6B 5A6

Our Certificate Of Analysis Number(s): **5308**

Our Reference Number: **9033551**

Number of Samples:

Analytical Cost					Assay Cost		
Qty.	Symbol	Element	Unit Price				
6	C(T) %	1-Carbon(Total)	\$10.00		\$60.00		
6	C(g) %	1-Carb(Graphitic)	\$18.00		\$108.00		
Additional Costs.					\$168.00		
<div style="border: 1px solid black; padding: 5px;"> <p>Sample Preparation: Pulverizing: Long Dist. Phone: Telex: Facsimile: Courier/Spee. Del.: Freight: Custom/Broker: Storage: hrs: @ :</p> <p>Extras</p> </div>							
					% Discount	\$0.00	
					Net Cost	\$168.00	\$168.00
					Extras		\$168.00
					Less Advance Payment:		
Invoice Amount					\$168.00		

RMB

APR 02 '90 09:53 NORTH

INVOICE



LAKEFIELD RESEARCH

A DIVISION OF FALCONBRIDGE LIMITED
P.O. Box 430, 185 Concession St., Lakefield, Ontario K0L 2H0
Phone: (705) 652-3341

Telex No. 08 982842
Fax No. (705) 652-6366

No.: C 03166

DATE December 22, 1989

SENT TO: Mr. D. Copeland

North Coast Industries
1201 - 601 West Hastings
Price Waterhouse Centre, Vancouver, BC V6B 5A9

Our Certificate Of Analysis Number(s): 5166					
Our Reference Number: 8933421					
Number of Samples: RE: Dec. 13/89 A-E, Dec. 18/89 010-015					
Analytical Cost					Assay Cost
Qty.	Symbol	Element	Unit Price		
11	C(T) %	1-Carbon Total	\$10.00		\$110.00
11	C(G) %	1-Carb. Graphitic	\$18.00		\$198.00
					\$308.00
Additional Costs:					
Sample Preparation:					
Pulverizing:					
Long Dist. Phone:					
Telex:					
Facsimile:					
Courier / Spec. Del.:					
Freight:					
Custom / Broker:					
Storage:					
BFE: @ :					
Extras					
					\$0.00
					\$508.00
					\$508.00
Less Advance Payment:					
Invoice Amount					\$508.00

oh DJC
Correct
to early for flow then

Am Blas

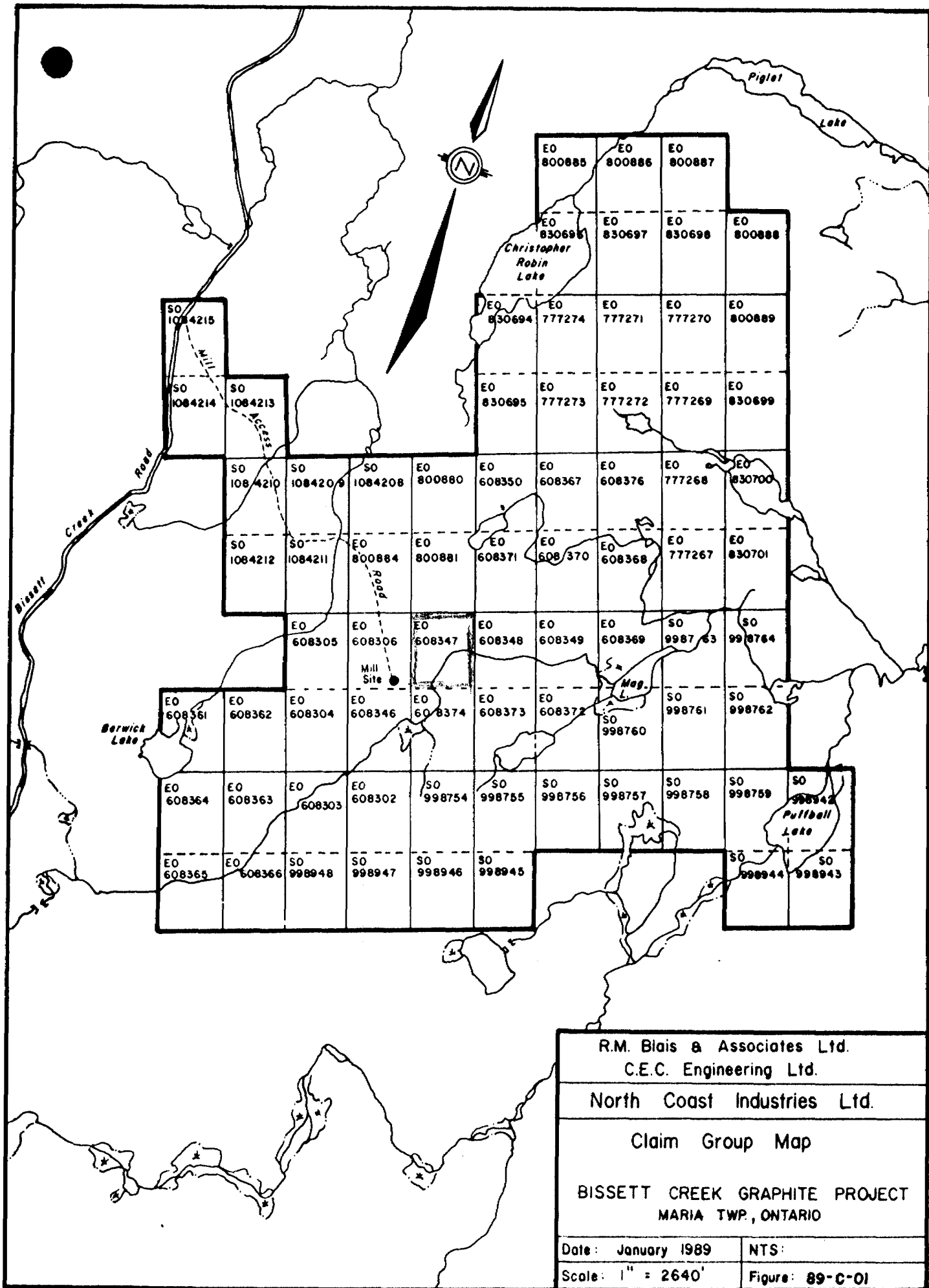

R.M. Blais & Associates Ltd.
C.E.C. Engineering Ltd.

North Coast Industries Ltd.

Claim Group Map

BISSETT CREEK GRAPHITE PROJECT
MARIA TWP., ONTARIO

Date: January 1989

NTS:

Scale: 1" = 2640'

Figure: 89-C-01

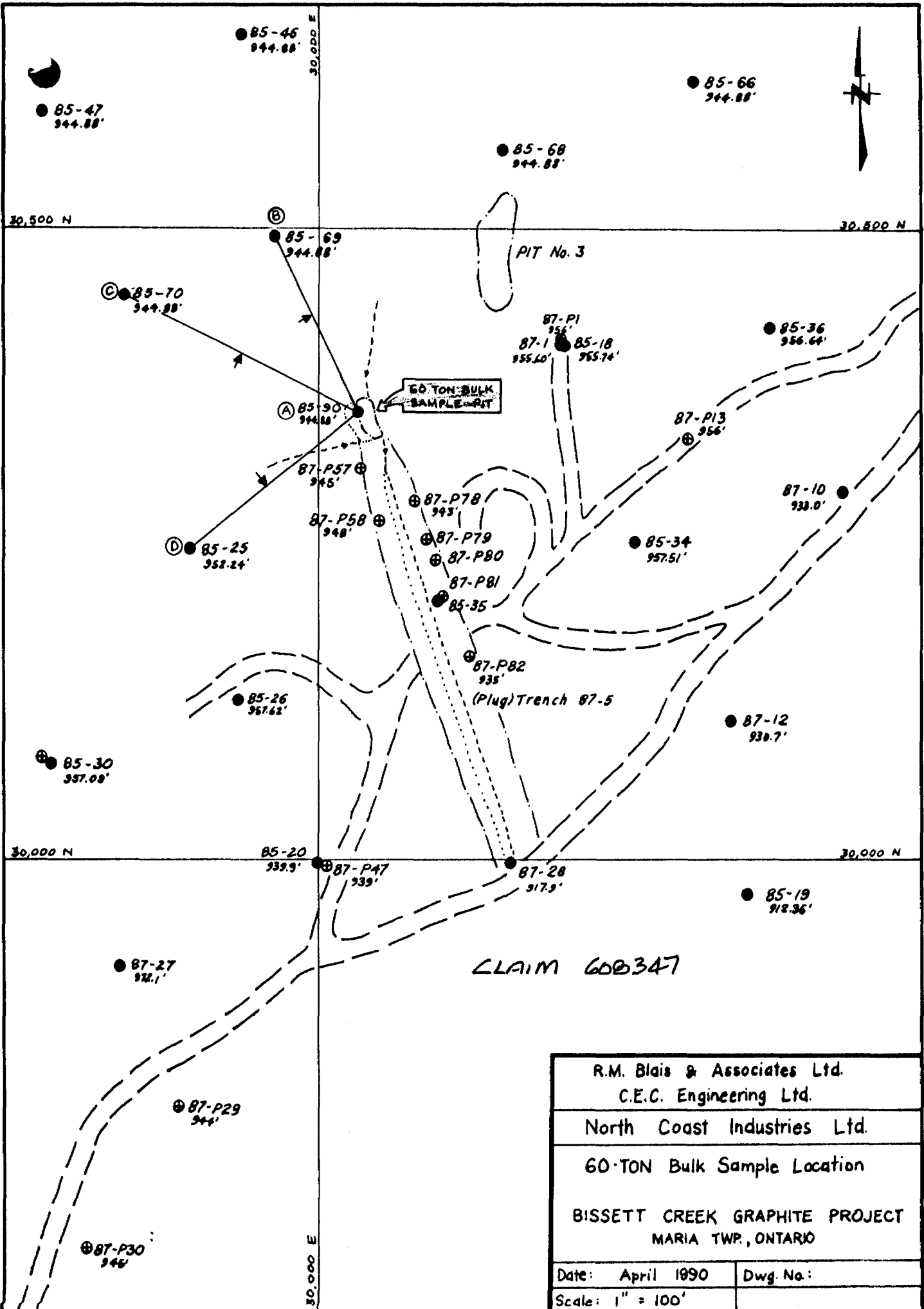

R.M. Blais & Associates Ltd. C.E.C. Engineering Ltd.	
North Coast Industries Ltd.	
60-TON Bulk Sample Location	
BISSETT CREEK GRAPHITE PROJECT MARIA TWP., ONTARIO	
Date: April 1990	Dwg. No:
Scale: 1" = 100'	

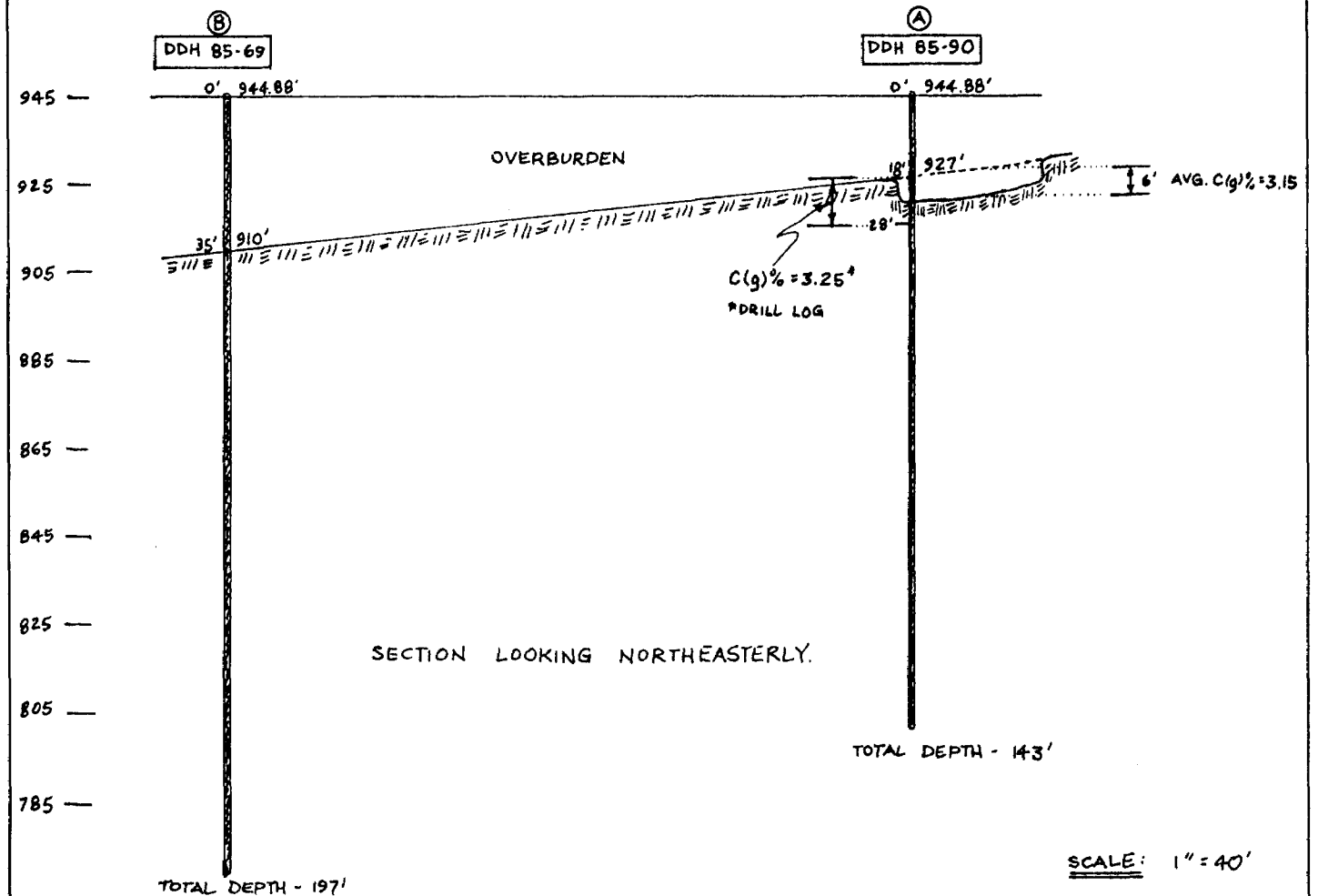
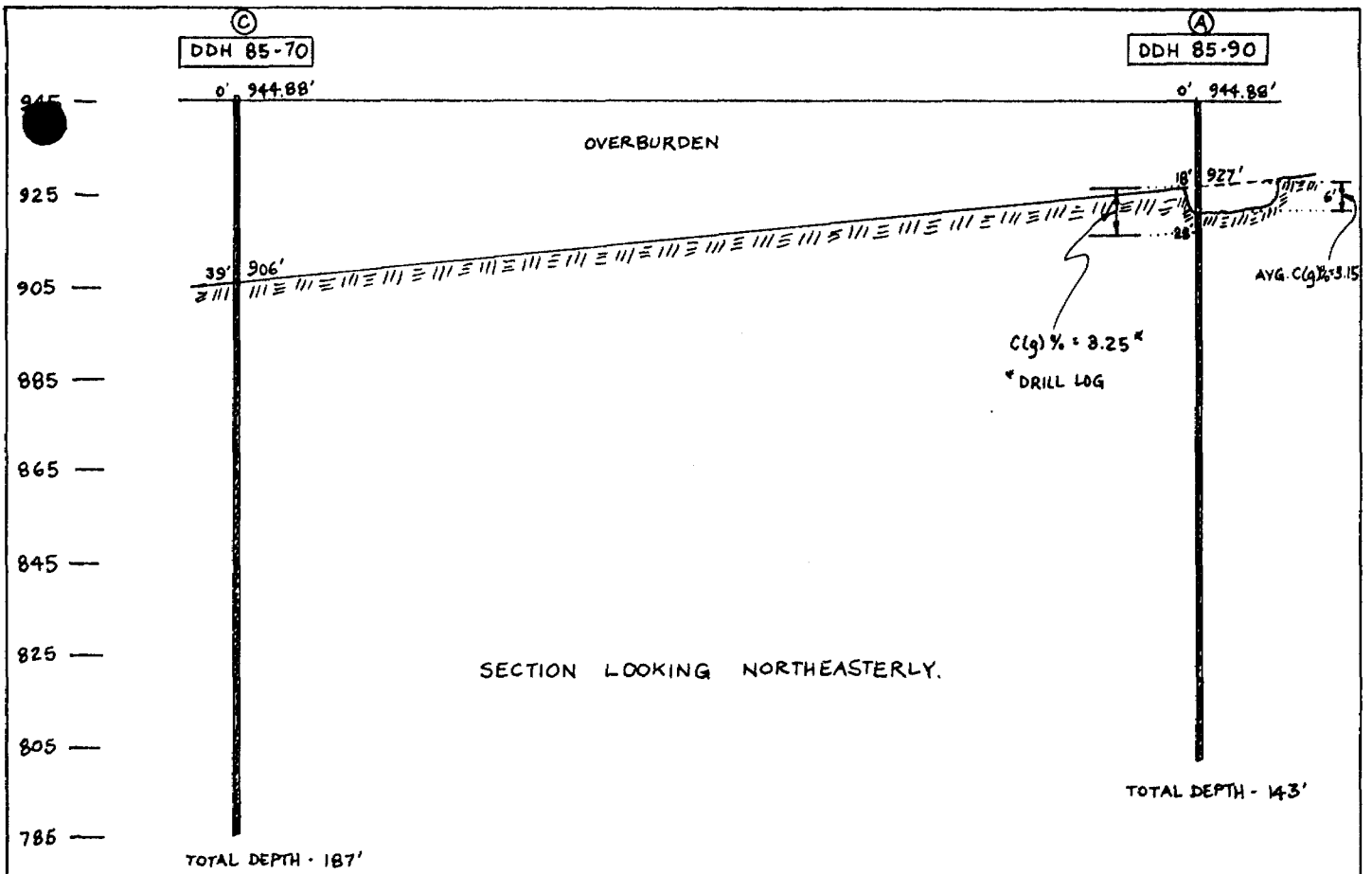

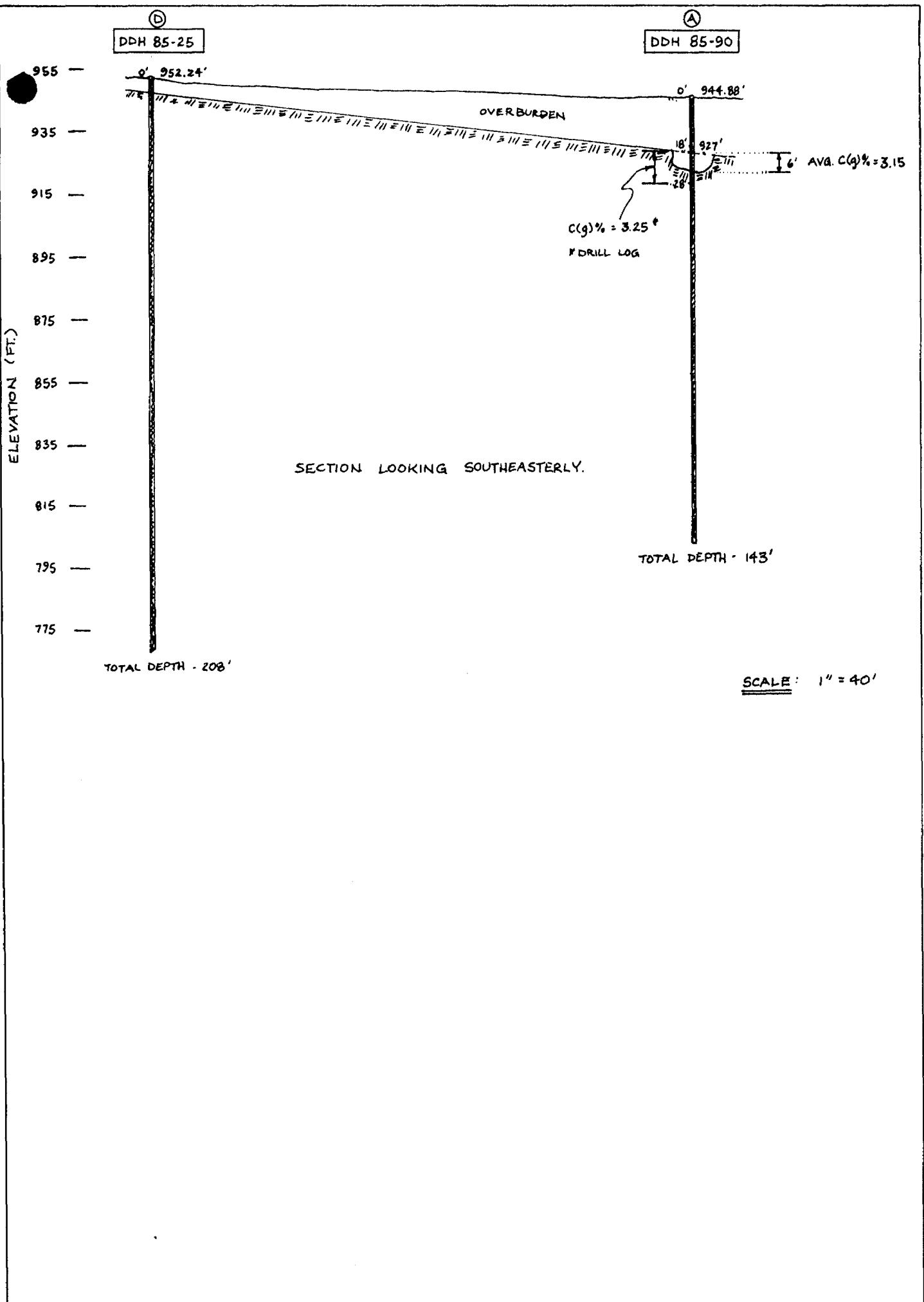



Ministry of Northern Development and Mines

Report of Work
(Geophysical, Geological, Geochemical and Expenditures)

DOCUM
W901



31L01NE0002 2.13229 MARI A

900

W 9009.019

Type of Survey(s) **ASSAYS** ✓ Township or Area **RECEIVED MARIA TWP.** ✓
 Claim Holder(s) **NORTH COAST INDUSTRIES LTD.** ✓ Prospector's Licence No. **4866** ✓
 Address **1270-601 WEST HASTINGS ST. VANCOUVER, BC V6B 5A6** MINING LANDS SECTION
 Survey Company **R.M. BLAIS & ASSOCIATES LTD.** ✓ Date of Survey (from & to) **22 12 89 3 1 90** ✓ Total Miles of line Cut
 Name and Address of Author (of Geo-Technical report) **RM BLAIS, P.O. BOX 237, NORTH BAY, ONT. P1B 8H2 705 477-9116**

Credits Requested per Each Claim in Columns at right

Mining Claims Traversed (List in numerical sequence)

Special Provisions	Geophysical		Days per Claim
	Electromagnetic	Magnetometer	
For first survey: Enter 40 days. (This includes line cutting)	·		
For each additional survey: using the same grid: Enter 20 days (for each)	·		
	· Radiometric		
	· Other		
	Geological		
	Geochemical		
Man Days Complete reverse side and enter total(s) here	·		
	· Electromagnetic		
	· Magnetometer		
	· Radiometric		
	· Other		
	Geological		
	Geochemical		
Airborne Credits Note: Special provisions credits do not apply to Airborne Surveys.	Electromagnetic		
	Magnetometer		
	Radiometric		

Mining Claim		Expend. Days Cr.	Mining Claim		Expend. Days Cr.
Prefix	Number		Prefix	Number	
50	998943	20			
	998947	28			

Expenditures (excludes power stripping)
 Type of Work Performed **ASSAYS**
 Performed on Claim(s) **EO 608347**
 Calculation of Expenditure Days Credits
 Total Expenditures \$ **728.00** ÷ **15** = **48** Total Days Credits
 Instructions
 Total Days Credits may be apportioned at the claim holder's choice. Enter number of days credits per claim selected in columns at right.

SOUTHERN ONTARIO MINING DIVISION RECEIVED
MINING GEOLOGICAL SURVEY ASSESSMENT FILES OFFICE
JUN 20 1990
RECEIVED
APR - 5 1990
 AM 7 8 9 10 11 12 1 2 3 4 5 6 PM

Date **APRIL 4 / 90** Recorded Holder or Agent (Signature) *R.M. Blais* ✓

Total number of mining claims covered by this report of work. **2** ✓
 For Office Use Only
 Total Days Cr. Recorded **48** Date Recorded **April 5/90** Mining Recorder *R.M. Blais*
 Date Approved as Recorded **18 June 90** Branch Director *J.S. Wilson*

Certification Verifying Report of Work
 I hereby certify that I have a personal and intimate knowledge of the facts set forth in the Report of Work annexed hereto, having performed the work or witnessed same during and/or after its completion and the annexed report is true.
 Name and Postal Address of Person Certifying
R.M. BLAIS
P.O. BOX 237
NORTH BAY, ONT. P1B 8H2
 Date Certified **APRIL 4/90** Certified by (Signature) *R.M. Blais* ✓

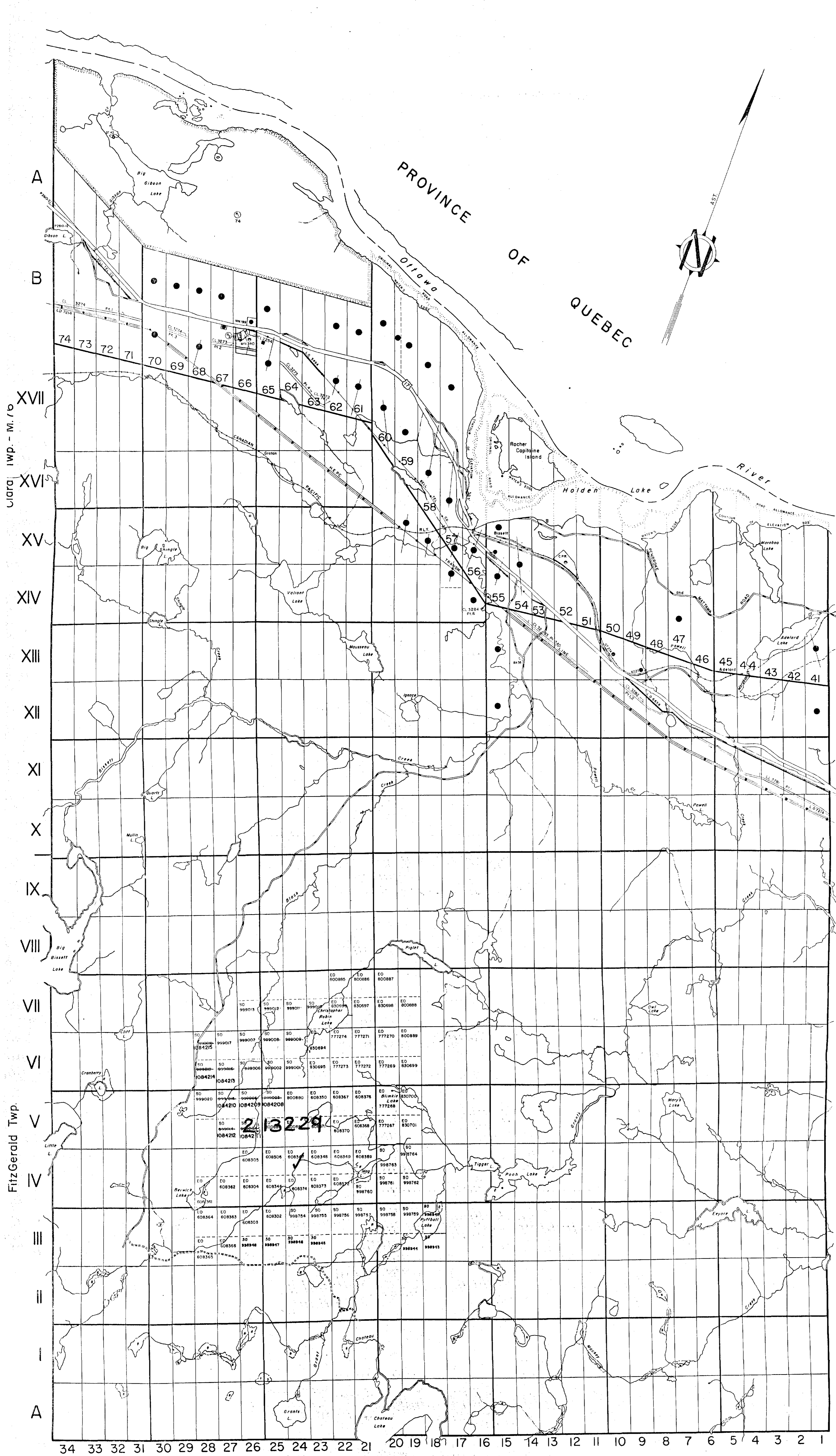

LEGEND

- HIGHWAY AND ROUTE No.
- OTHER ROADS
- TRAILS
- SURVEYED LINES:
 - TOWNSHIPS, BASE LINES, ETC.
 - LOTS, MINING CLAIMS, PARCELS, ETC.
- UNSURVEYED LINES:
 - LOT LINES
 - PARCEL BOUNDARY
 - MINING CLAIMS ETC.
- RAILWAY AND RIGHT OF WAY
- UTILITY LINES
- NON PERENNIAL STREAM
- FLOODING OR FLOODING RIGHTS
- SUBDIVISION OR COMPOSITE PLAN
- RESERVATIONS
- ORIGINAL SHORELINE
- MARSH OR MUSKEG
- MINES
- TRAVERSE MONUMENT

DISPOSITION OF CROWN LAND

TYPE OF DOCUMENT	SYM
PATENT, SURFACE & MINING RIGHTS
" SURFACE RIGHTS ONLY
" MINING RIGHTS ONLY
LEASE, SURFACE & MINING RIGHTS
" SURFACE RIGHTS ONLY
" MINING RIGHTS ONLY
LICENCE OF OCCUPATION
ORDER-IN-COUNCIL
RESERVATION
CANCELLED
SAND & GRAVEL

NOTE: MINING RIGHTS IN PARCELS REFERRED TO IN THIS MAP WERE VESTED IN ORIGINAL PATENTEE BY THE LANDS ACT, R.S.O. 1970, CHAP. 160, SECTION 10.

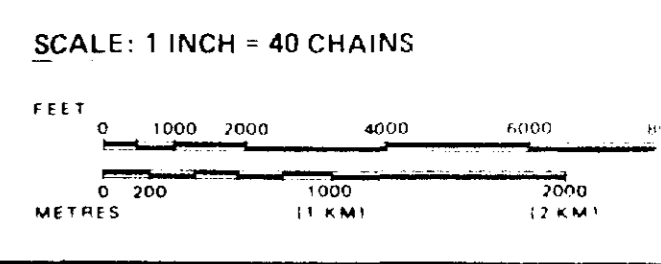

AREAS WITHDRAWN FROM DISPOSITION

Description	Order No.	Date	Disposition	RD	
M.R.O. - MINING RIGHTS ONLY					
S.R.O. - SURFACE RIGHTS ONLY					
M.+S. - MINING AND SURFACE RIGHTS					
①		MARCH 3/72	S.R.O.	1607	
②		MAY 11/82	JULY 23/82	S.R.O.	1660

NOTES

DES JOACHIMS DEVELOPMENT WATER POW
LEASE No. 102

ALL THE UNALIENATED PART OF THE BED OF THE OTTAWA (ONTARIO SIDE) IN THE TOWNSHIP OF MARIA INCLUDING UNALIENATED ISLANDS THEREIN TOGETHER WITH THE RIGHT TO RAISE WATER LEVEL AND FLOOD CROWN LANDS UP TO 505' ELEVATION FROM EAST BOUNDARY OF TOWNSHIP TO TRAVERSE STATION 1 IN 'CROWN RESERVE AND TO 500' CONTOUR FROM THIS POINT WESTERLY TO THE WEST BOUNDARY OF TOWNSHIP. GEODETIC SURVEY OF CANADA DATUM.

RES. GEO. DORSET
M.N.R. DIST. PEMBROKE

DATE OF ISSUE
MAY 11 1989
SOUTHERN ONTARIO
MINING DIVISION

TOWNSHIP
MARIA
M.N.R. ADMINISTRATIVE DISTRICT
PEMBROKE
MINING DIVISION
SOUTHERN ONTARIO
LAND TITLES / REGISTRY DIVISION
RENFREW

Ministry of Natural Resources Ontario
Ministry of Northern Development and Mines



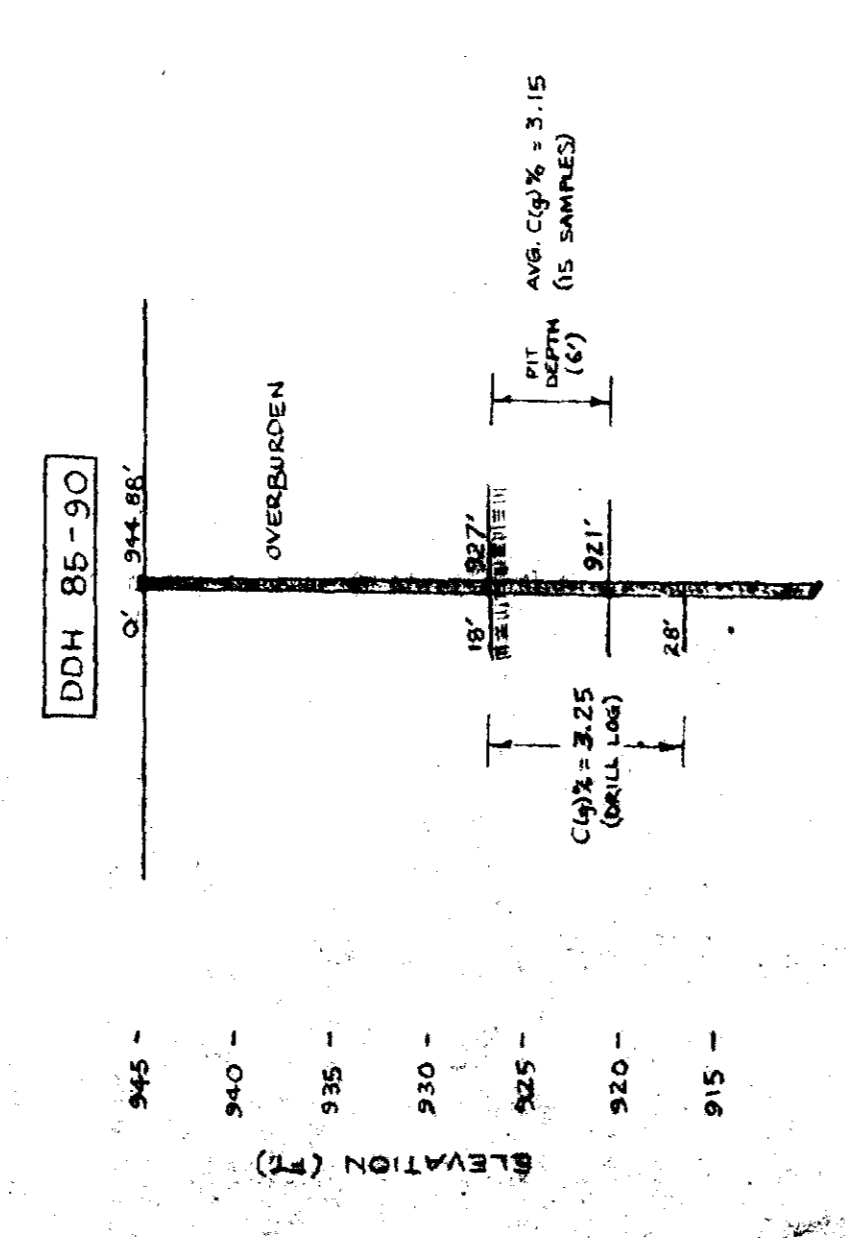
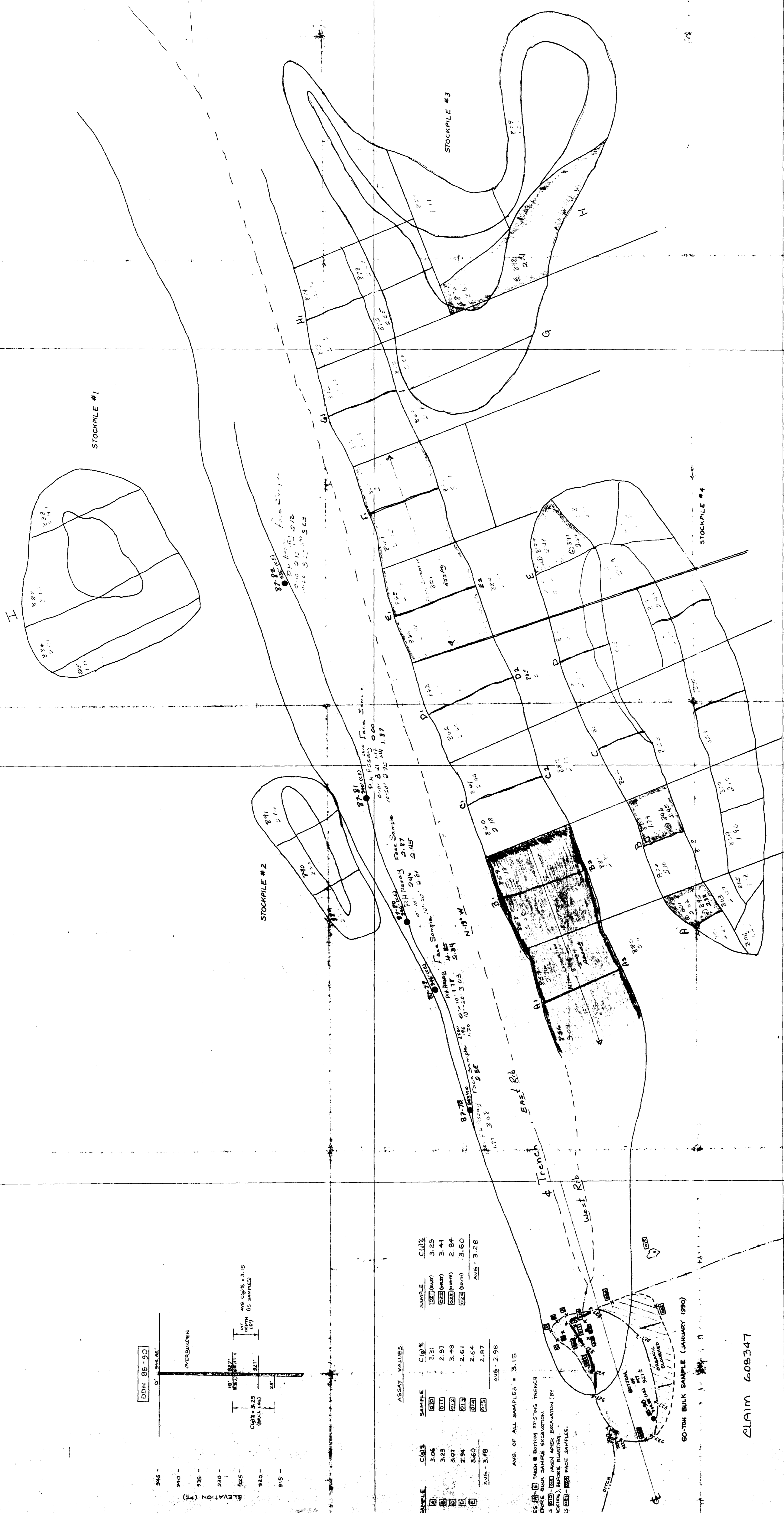
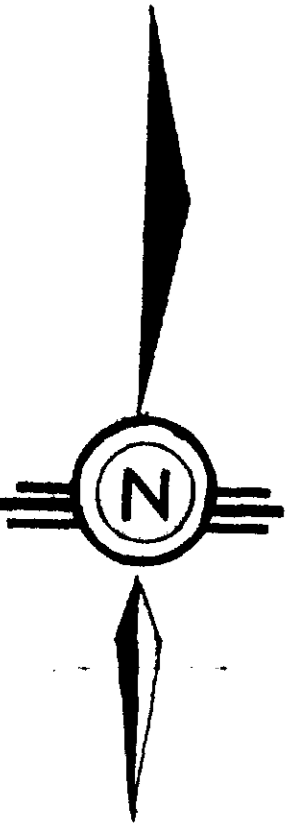

ASSAY VALUES

SAMPLE	C (%)	SAMPLE	C (%)
4	3.06	10	3.25
5	3.31	11	3.25
6	3.23	12	3.41
7	3.07	13	2.84
8	2.94	14	3.60
9	2.61	15	3.28
10	2.64		
11	2.60		
12	2.97		
13	3.18		
14	2.98		
15	3.15		

AVG. OF ALL SAMPLES = 3.15

NOTE:
 (X) SAMPLES (A) FROM BOTTOM EXCAVATION TRENCH
 (B) SAMPLES (B) FROM BULK SAMPLE EXCAVATION
 (C) SAMPLES (C) FROM FACE AFTER EXCAVATION (BY
 BUCKETS), BEFORE BLASTING
 (D) SAMPLES (D) FROM FACE SAMPLES

60-TON BULK SAMPLE (JANUARY 1990)

CLAIM 60B347

- Excavation Assay Truck 3+4
 - Excavation Assay Truck 1+2
 - Re-sample Stock Pile Assay Data
 - Recession Hole Assay Data
 - Face Sample Assay Data
 - Excavation Assay Data
 - Repeat Stock Pile Assay Data
 - Random Grab Sample Locations
- "1" = 10'

X (B) SAMPLE LOCATION, NUMBER
 C.E. COLLAR ELEVATION (FT)

2.13229	
R.M. Blais & Associates Ltd.	C.E.C. Engineering Ltd.
NORTH COAST INDUSTRIES LTD.	
Location Plan Showing Plug Trench 30-ton Bulk Sample (June 1986) 60-ton Bulk Sample (Jan 1990) BISSETT CREEK GRAPHITE PROJECT - MARIA TWP.	
Scale: 1" = 10'	Dwg. No.:
Date: April 1990	

