



31L01NE0007 63.4017 MARIA

010

# Erana Mines Limited

106 Fielding Rd., R.R. #2  
Lively, Ontario  
P0M 2E0

(705) 682-0649  
Telex 067-7261

PRINCETON RESOURCES CORPORATION  
c/o Mr. D. Copeland  
Suite 1440  
625 Howe St.  
VANCOUVER, B.C.  
V6C 2T6

PRC-01  
December 3, 1984  
DUE UPON RECEIPT

VIA COURIER

Re: Stripping, Trenching and Drilling (Plugger)  
Maria Township, November 8 - December 2, 1984

---

Stripping:

22 days @ 10 hrs. per day  
JD 450 Loader (operated)  
\$39,00 per hour

\$8,580.00

PAID DEC 06 1984  
*[Signature]*  
ERANA MINES LTD.

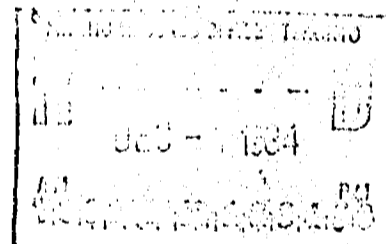

(705) 682-0649  
TELEX # 067-7261

**ERANA MINES LIMITED**

106 FIELDING ROAD  
R.R. #2, LIVELY, ONTARIO  
POM 2E0

TO: Donegal Resources Ltd.  
2000 - 609 Granville St.  
Pacific Centre  
VANCOUVER, B.C.

INVOICE NO. DR-9 (d)  
DATE: December 22/83

TERMS:

Re: Stripping work done in  
Maria Township, for assessment  
work.

Does not include actual report  
filing costs.

Work done between Dec. 3 - 20/82

\$9,000.

DUE UPON RECEIPT!

~~PAID JUN - 8 1983~~

Ed: Paid by cheque,  
& not by telephone  
transfer, as previously  
agreed. OK?

## DIMENSIONS OF TRENCHES

TRENCH	R	=	70' LONG	10' WIDE	10' DEEP			
"	"	Q	20'	"	10'	"	8'	"
"	"	P	18'	"	9'	"	7'	"
"	"	O	30'	"	7'	"	6'	"
"	"	N	15'	"	7'	"	6'	"
"	"	M	15'	"	7'	"	6'	"
"	"	L	22'	"	5'	"	6'	"
"	"	K	20'	"	6'	"	6'	"
"	"	J	15'	"	5'	"	5'	"
"	"	H	15'	"	6'	"	5'	"
"	"	G	9'	"	9'	"	5'	"
"	"	F	14'	"	6'	"	4'	"
"	"	E	10'	"	8'	"	6'	"
"	"	D	20'	"	10'	"	7'	"
"	"	C	6'	"	6'	"	9'	"
"	"	B	17'	"	5'	"	5'	"
"	"	A	17'	"	5'	"	9'	"
"	"	I	15'	"	6'	"	5'	"



Ministry of  
Natural  
Resources

Ontario

M1910

83-50  
#83-1  
file E0 608341



31L01NE0007 63.4017 MARIA

900

(M1910)

A separate form is required for each type of work to be recorded.

THE MINING ACT REPORT OF WORK

To the Recorder of... EASTERN ONTARIO ..... Mining Division

I, T. THOMAS R. SAVILLE ..... name of Recorded Holder  
Prospector's Licence T. 6219 ✓

607 GRAMMANTVILLE ROAD ..... Post Office Address POWER TRENCHING ✓

do hereby report the performance of 899 ..... days of ..... type of work

not before reported to be applied on the following contiguous claims

Claim No.	Days	Claim No.	Days	Claim No.	Days
E0 608302	21	E0 608347	14	E0 608363	36
E0 608303	36	E0 608348	36	E0 608364	36
E0 608304	36	E0 608349	36	E0 608365	36
E0 608305	36	E0 608350	36	E0 608366	36
E0 608306	36	E0 608361	36	E0 608367	36
E0 608345	36	E0 608362	36	E0 608368	36

All the work was performed on Mining Claim (s) 608368 608369 608348 608347 .....  
(In the case of geological and/or geophysical survey (s) where more than 18 claims are involved attach a schedule)

READ CAREFULLY: THE FOLLOWING INFORMATION IS REQUIRED BY THE MINING RECORDER.

- For Manual Work, Stripping or Opening up of Mines, Sinking Shafts or Other Actual Mining Operations - Names and addresses of the men who performed the work and the dates and hours of their employment.
- For Diamond and other Core Drilling - Footage, No. and angle of holes and diameter of core. Name and address of owner or operator of drill. Dates when drilling was done. Signed core log and sketch in duplicate.
- For Compressed Air or Other Power Driven or Mechanical Equipment  
Type of drill or equipment. Names and addresses of men engaged in operating equipment and the dates and hours of their employment.
- For Power Stripping - Type of equipment. Name and address of owner or operator. Amount expended. Dates on which work was done. Proof of actual cost must be submitted within 30 days of recording.
- With each of the above types of work sketches are required to show the location and extent of the work in relation to the nearest claim post. In the case of diamond or other core drilling the sketch must be submitted in duplicate.
- For Geophysical, Geological, Geochemical Surveys and Expenditure Credits - the name of author of report. Covering dates of survey (linecutting & office). Type of instrument used. Total amount of expenditure. Technical reports, maps, expenditure breakdown, receipts must be filed in duplicate with the Minister within 60 days of recording.
- For Land Survey - the name and address of Ontario Land surveyor.

The Required Information is as Follows: (Attach a list if this space is insufficient)

JD-440 LOADER BACK HOE OWNED BY ERANA MINES LTD ✓  
106 FIELDING RD LIVERY ONTARIO - \$9,000 EXPENDED ✓  
WORK CARRIED OUT FROM DEC 3 TO DEC 20 ✓  
250 HOURS AT \$36 PER HOUR ✓

MINING RECORDS OFFICE - TORONTO  
RECEIVED  
NOV 22 1983  
AM 7 8 9 10 11 12 1 2 3 4 5 6  
DEC 5 1983

Date NOV 19, 1983 ..... RECEIVED  
Signature of Recorded Holder or Agent [Signature] ✓

The Mining Act  
Certificate Verifying Report of Work

I, EDWARD BLANCHARD ..... SUPERVISED THIS WORK FOR DOMINGAL RESOURCES .....  
106 FIELDING RD LIVERY ONTARIO .....  
(Post Office Address)

- hereby certify:
- That I have a personal and intimate knowledge of the facts set forth in the report of work annexed hereto, having performed the work or witnessed same during and/or after its completion.
  - That the annexed report is true.

Dated NOV 13 ..... 19 83 .....  
[Signature] .....  
Signature

THE PENALTY FOR MAKING A FALSE STATEMENT IN THIS REPORT AND/OR CERTIFICATE IS \$500. OR SIX MONTHS IMPRISONMENT OR BOTH



Ministry of  
Natural  
Resources  
Ontario

A separate form is required for each type of work to be recorded.

THE MINING ACT REPORT OF WORK

To the Recorder of EASTERN ONTARIO Mining Division

I, J. HARRIS P. SAVILLE name of Recorded Holder 6219 Prospector's Licence

607 GORMANVILLE RD Post Office Address

do hereby report the performance of 899 days of POWER TRENCHING type of work

not before reported to be applied on the following contiguous claims

Claim No.	Days	Claim No.	Days	Claim No.	Days
Eo 608369	36	Eo 608374	36		
Eo 608370	36	Eo 608375	36		
Eo 608371	36	Eo 608376	36		
Eo 608372	36				
Eo 608373	36				

All the work was performed on Mining Claim (s) 608368 608369 ~~608377~~ 608348 608347  
(In the case of geological and/or geophysical survey (s) where more than 18 claims are involved attach a schedule)

READ CAREFULLY: THE FOLLOWING INFORMATION IS REQUIRED BY THE MINING RECORDER.

For Manual Work, Stripping or Opening up of Mines, Sinking Shafts or Other Actual Mining Operations - Names and addresses of the men who performed the work and the dates and hours of their employment.

For Diamond and other Core Drilling - Footage, No. and angle of holes and diameter of core. Name and address of owner or operator of drill. Dates when drilling was done. Signed core log and sketch in duplicate.

For Compressed Air or Other Power Driven or Mechanical Equipment  
Type of drill or equipment. Names and addresses of men engaged in operating equipment and the dates and hours of their employment.

For Power Stripping - Type of equipment. Name and address of owner or operator. Amount expended. Dates on which work was done. Proof of actual cost must be submitted within 30 days of recording.

With each of the above types of work sketches are required to show the location and extent of the work in relation to the nearest claim post. In the case of diamond or other core drilling the sketch must be submitted in duplicate.

For Geophysical, Geological, Geochemical Surveys and Expenditure Credits - the name of author of report. Covering dates of survey (linecutting & office). Type of instrument used. Total amount of expenditure. Technical reports, maps, expenditure breakdown, receipts must be filed in duplicate with the Minister within 60 days of recording.

For Land Survey - the name and address of Ontario Land surveyor.

The Required Information is as Follows: (Attach a list if this space is insufficient)

J-D 440 LOADER BACK HOE OWNED BY ERANA MINES LTD ✓  
106 FIELDING ROAD LIVELY ONTARIO - 91000 EXPENDED ✓  
WORK CARRIED OUT FROM DEC 3 TO DEC 20 1982  
250 HOURS AT 36 PER HOUR.  
SKETCH + PROOF OF EXPENSE ATTACHED.

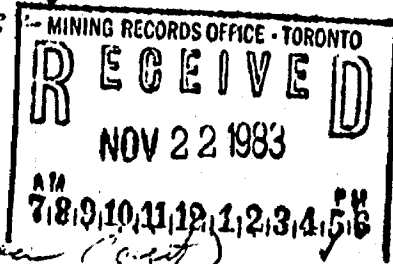

Date Nov. 14, 1983

J. Harris P. Saville Signature of Recorded Holder or Agent

The Mining Act  
Certificate Verifying Report of Work

I, EDWARD BLANCHARD SUPERVISED THIS WORK FOR DONIGAL RESOURCES

106 FIELDING RD - LIVELY ONTARIO  
(Post Office Address)

hereby certify:

1. That I have a personal and intimate knowledge of the facts set forth in the report of work annexed hereto, having performed the work or witnessed same during and/or after its completion.
2. That the annexed report is true.

Dated Nov. 13 19 83 E. Blanchard Signature

THE PENALTY FOR MAKING A FALSE STATEMENT IN THIS REPORT AND/OR CERTIFICATE IS \$500. OR SIX MONTHS IMPRISONMENT OR BOTH



Report of Work #84-59

MARIA Twp M-1910

The Mining Act

FILE #  
EO 608306

Instructions - Supply required data on a separate form for each type of work to be recorded (see table below).  
- For Geo-technical work use form no. 1362 "Report of Work (Geological, Geophysical, Geochemical and Expenditures)".

Name and Postal Address of Recorded Holder Thomas D. Saville 607 Gormanville Rd., North Bay, Ontario, P1B 8N9	Prospector's Licence No. J6219
---	-----------------------------------

Summary of Work Performance and Distribution of Credits

Total Work Days Cr. claimed 863.5 858	Mining Claim			Mining Claim			Mining Claim		
	Prefix	Number	Work Days Cr.	Prefix	Number	Work Days Cr.	Prefix	Number	Work Days Cr.
for Performance of the following work. (Check one only) <input type="checkbox"/> Manual Work <input type="checkbox"/> Shaft Sinking Drifting or other Lateral Work. <input type="checkbox"/> Compressed Air, other Power driven or mechanical equip. <input checked="" type="checkbox"/> Power Stripping <input type="checkbox"/> Diamond or other Core drilling <input type="checkbox"/> Land Survey	EO	608302	40	EO	608349	40	EO	608369	40
		608303	40		608361	40		608370	40
		608304	40		608362	40		608371	40
		608305	40		608363	40		608372	40
		608306	40		608364	40		608373	40
		608346	40		608365	40		608374	38
		608347	60		608366	40			
	608348	40							

All the work was performed on Mining Claim(s): <sup>500 DAYS</sup> EO 608306 <sup>200 DAYS</sup> 608346 <sup>163.5</sup> 608349 RECEIVED

Required Information eg: type of equipment, Names, Addresses, etc. (See Table Below)

Power Stripping - JD 450 Loader-Backhoe

22 days at 10 hrs. per day, at \$39/hr. Loader owned by Erana Mines Limited of 106 Fielding Rd., Lively, Ontario, POM 2EO. Operated by Mr. Robert Lafantaisie of 172 Larocque St., Field, Ontario, from November 08 to December 02, 1984.

220 hrs. x \$39./hr. = \$8,580 ÷ 10 = 858 days

Sketch and Proof of Expense Attached.

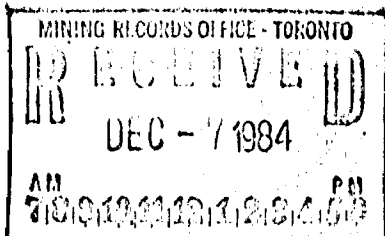

WORK ASSIGNMENT

608306 3999-460 = 3339 days balance  
608346 3617-160 = 3457 " "  
608347 3925-103.5 = 3821.5 " "

Date of Report December 6/84	Recorded Holder or Agent (Signature) E. Saville
---------------------------------	--

Certification Verifying Report of Work

I hereby certify that I have a personal and intimate knowledge of the facts set forth in the Report of Work annexed hereto, having performed the work or witnessed same during and/or after its completion and the annexed report is true.

Name and Postal Address of Person Certifying  
Edward J. Blanchard, 106 Fielding Rd., Lively, Ontario, POM 2EO

Date Certified December 6/84	Certified by (Signature) E. Blanchard
---------------------------------	--

Table of Information/Attachments Required by the Mining Recorder

Type of Work	Specific Information per type	Other information (Common to 2 or more types)	Attachments
Manual Work	Nil	Names and addresses of men who performed manual work/operated equipment, together with dates and hours of employment.	Work Sketch: these are required to show the location and extent of work in relation to the nearest claim post.
Shaft Sinking, Drifting or other Lateral Work			
Compressed air, other power driven or mechanical equip.	Type of equipment	Names and addresses of owner or operator together with dates when drilling/stripping done.	
Power Stripping	Type of equipment and amount expended. Note: Proof of actual cost must be submitted within 30 days of recording.		
Diamond or other core drilling	Signed core log showing; footage, diameter of core, number and angles of holes.		
Land Survey	Name and address of Ontario land surveyor.	Nil	Nil

# MARIA TWP. (M1910)

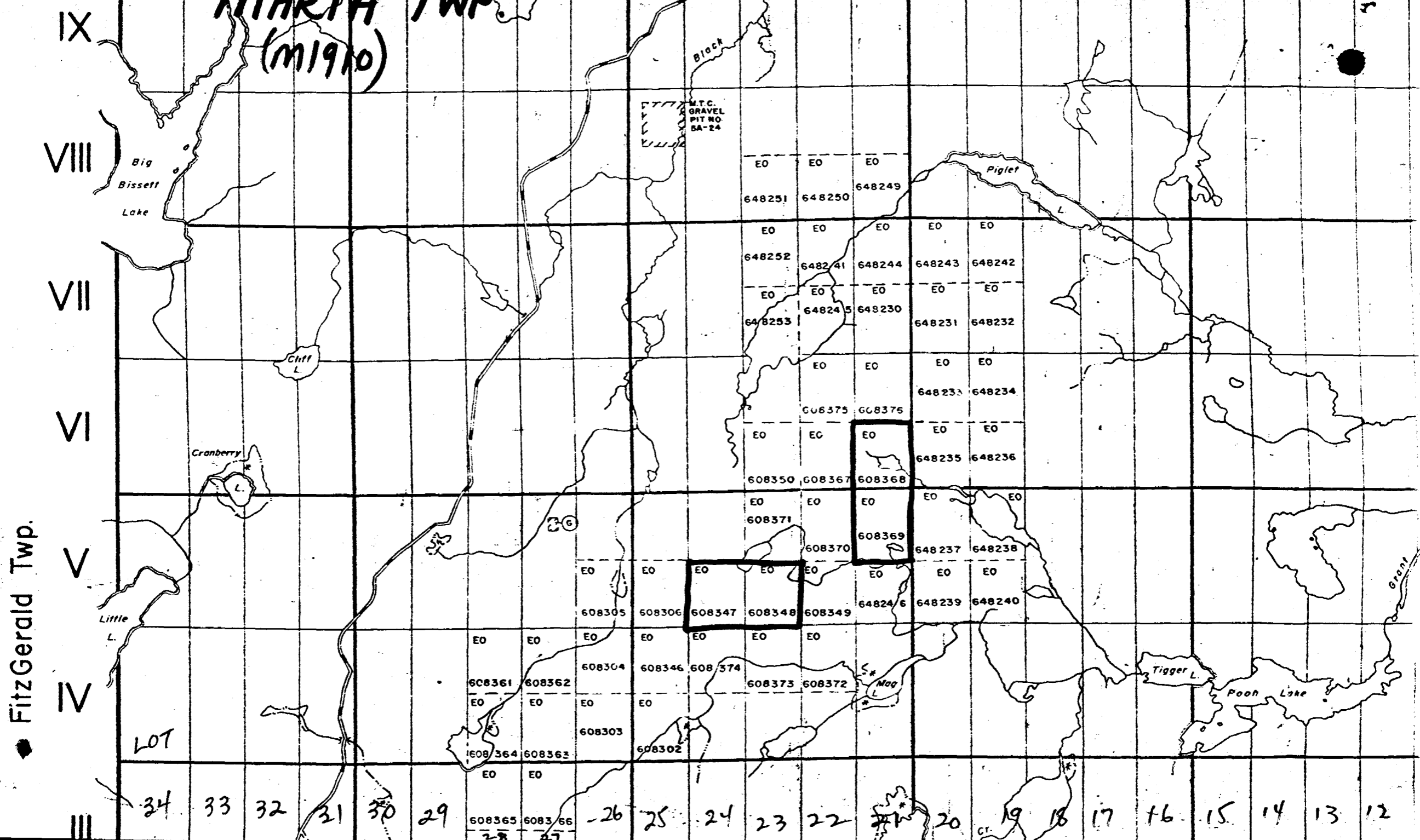

FitzGerald Twp.

34 33 32 31 30 29 28 27 26 25 24 23 22 21 20 19 18 17 16 15 14 13 12

LOT

M.T.C.  
GRAVEL  
PIT NO.  
SA-24

EO EO EO  
648251 648250 648249  
EO EO EO EO EO  
648252 648241 648244 648243 648242  
EO EO EO EO EO  
648253 648245 648230 648231 648232  
EO EO EO EO  
648233 648234  
608375 608376  
EO EC EO EO EO  
648235 648236  
608350 608367 608368  
EO EO EO EO EO  
608371 608369  
608370 648237 648238  
EO EO EO EO EO  
608305 608306 608347 608348 608349 648246 648239 648240  
EO EO EO EO EO  
608304 608346 608374  
608361 608362  
EO EO EO EO  
608303  
608364 608363 608302  
EO EO  
608365 608366  
28 27

**SOIL SAMPLES AND ROCK TRENCHES**

- TRENCH NO. 4 - T84-4 - 600' X 10' X 10'
- SOIL AND ROCK TRENCH
- TRENCH NO. 3 - T84-3 - 150' X 10' X 10'
- TRENCH NO. 2 - 200' X 10' X 6'
- TRENCH NO. 5 - 200' X 6' X 6'
- STRIPPED AREA 200' X 200' - 20 TON BULK SAMPLE TAKEN

**LEGEND**

- MAP SHEET BOUNDARIES
- PROPERTY BOUNDARIES
- ROADS
- RAILROADS
- POWER LINES
- WATER COURSES
- CONTOUR LINES
- ROCK TRENCHES
- SOIL SAMPLE LOCATIONS
- STRIPPED AREA
- 20 TON BULK SAMPLE TAKEN
- PROPERTY
- RAILROAD
- POWER LINE
- WATER COURSE
- CONTOUR
- ROCK TRENCH
- SOIL SAMPLE
- STRIPPED AREA
- 20 TON BULK SAMPLE TAKEN

SCALE 1:12500

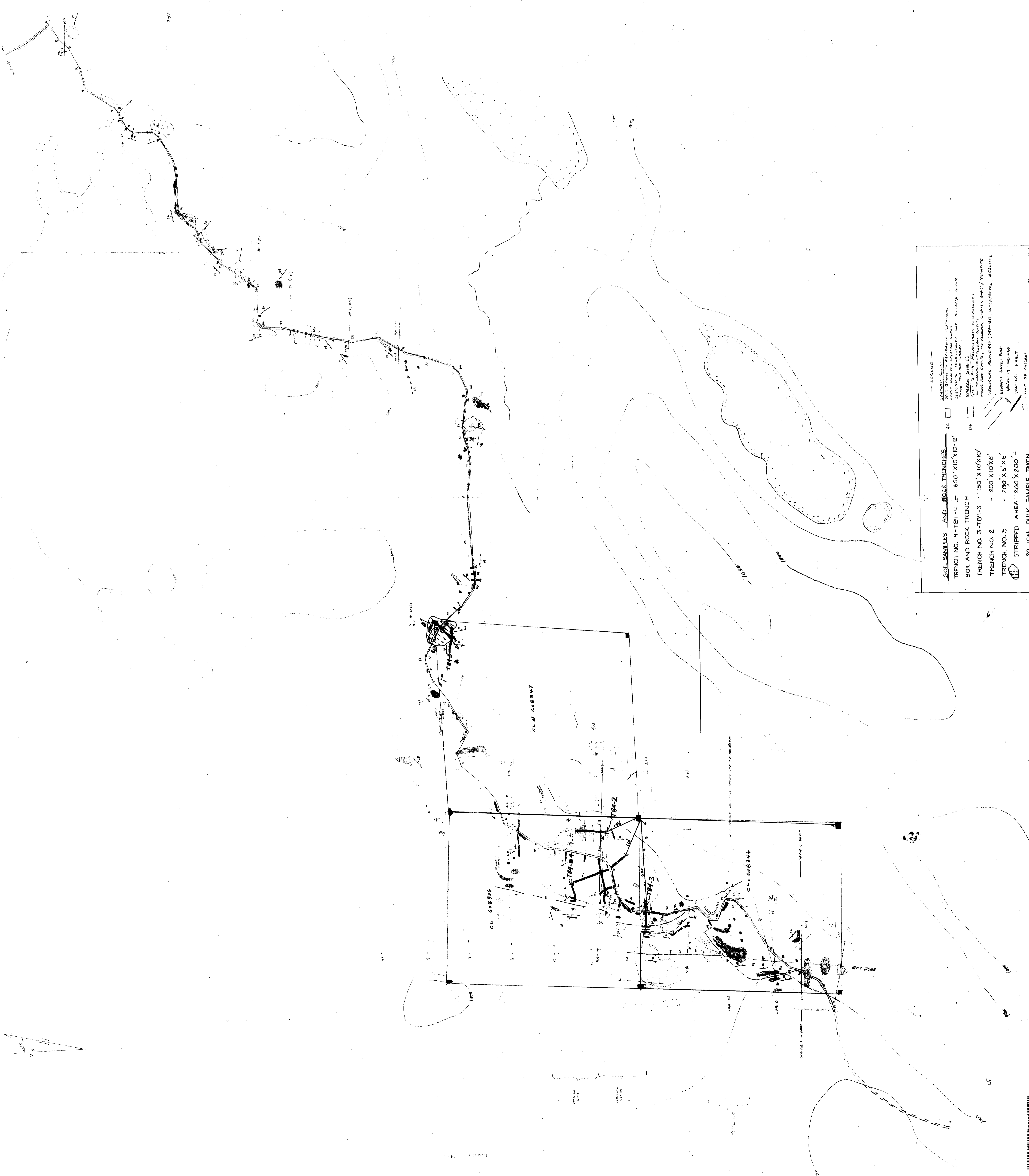



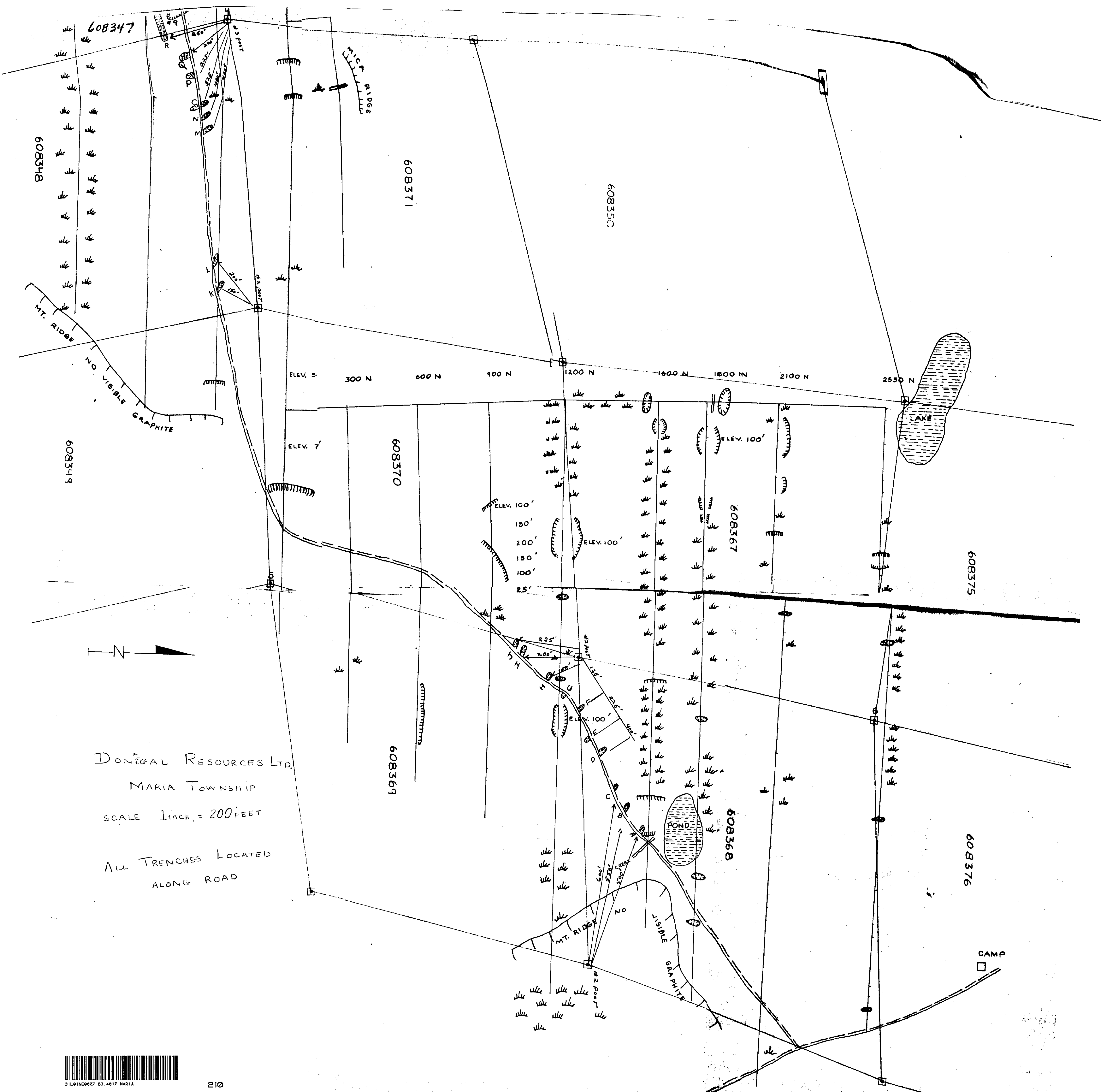

DONIGAL RESOURCES LTD.  
 MARIA TOWNSHIP  
 SCALE 1 INCH = 200 FEET  
 ALL TRENCHES LOCATED  
 ALONG ROAD



3101NE0007 63.4017 MARIA