



31L05SE9768 L. NIPIS 18A1 NIPISSING

010

*NOTE:*

*THIS FILE CONTAINS SHAFT AND  
LEVEL PLANS, AND AIRMAG MAP OF  
NEWMAN ISLAND ONLY, BEAUCAGE  
MINES LTD.*

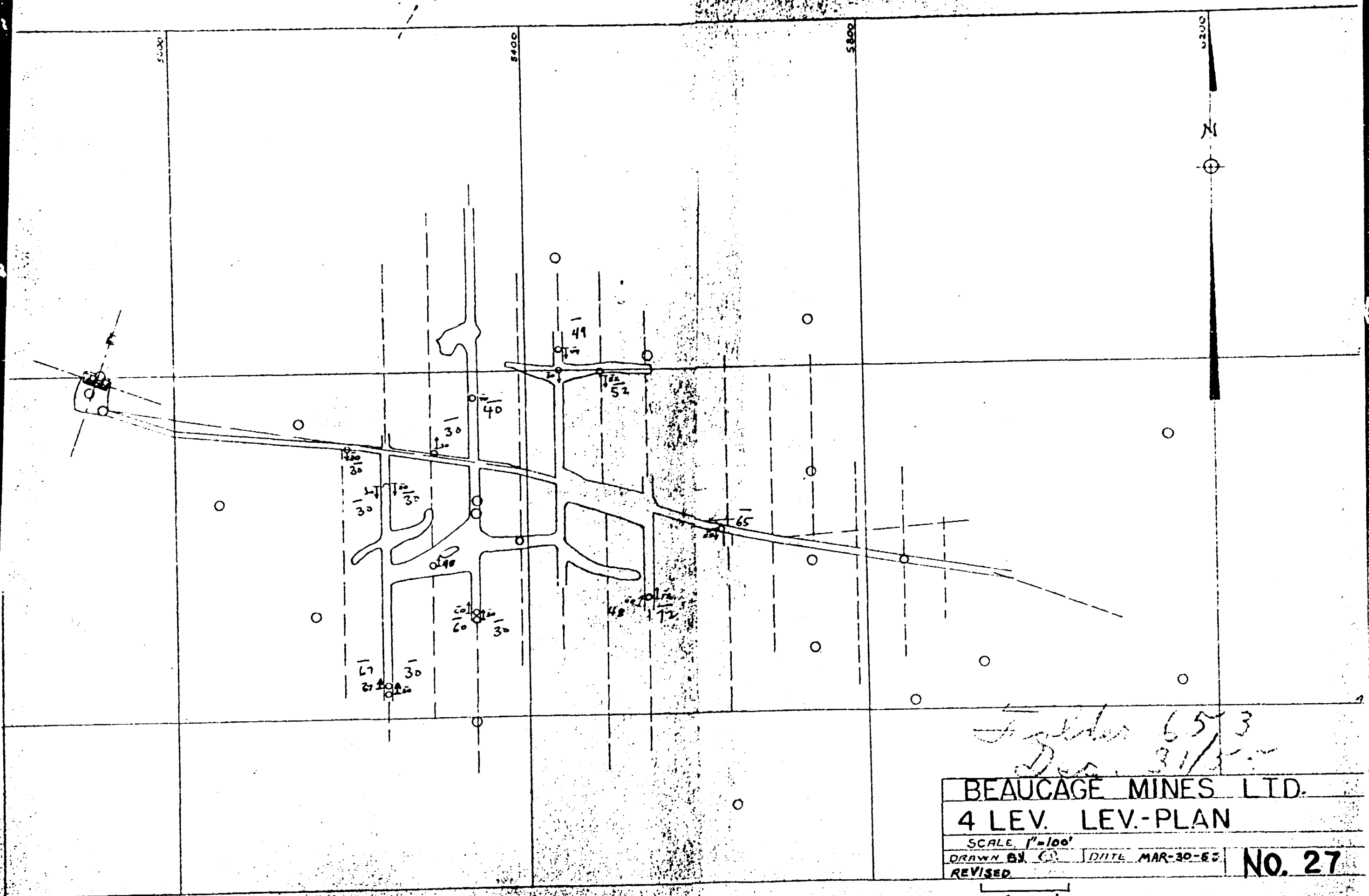

BEAUCAGE MINES LTD.  
 4 LEV. LEV.-PLAN  
 SCALE 1"=100'  
 DRAWN BY C.D. DATE MAR-30-53  
 REVISED  
 No. 27

Folder 653  
 Date 3/15/53

1" = 100'

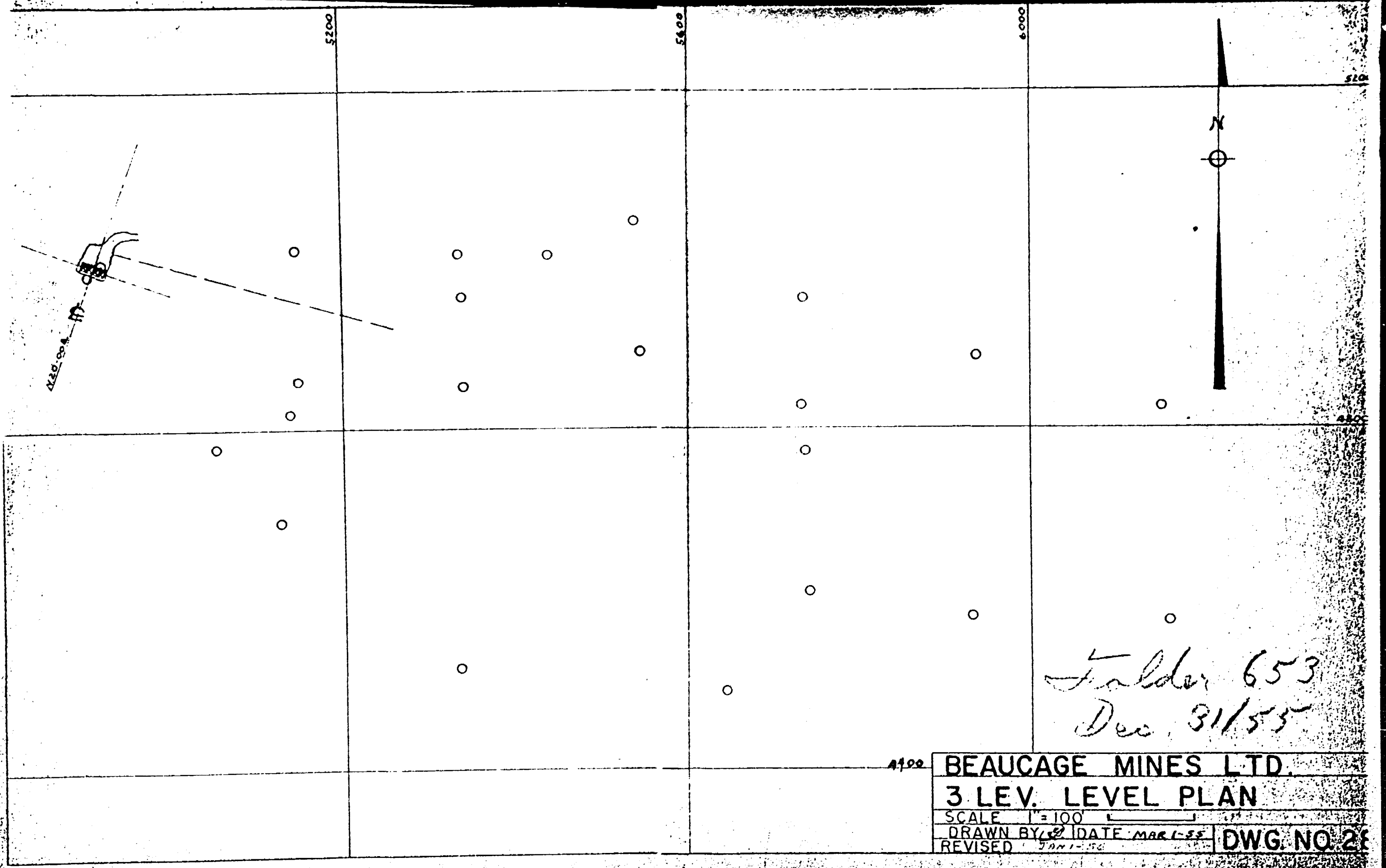

*Folder 653  
Dec. 31/53*

4900

BEAUCAGE MINES LTD.	
3 LEV. LEVEL PLAN	
SCALE 1" = 100'	
DRAWN BY <i>LD</i>	DATE MAR 1-55
REVISED <i>JAN 1-54</i>	DWG. NO. 28

DN DN

ELEV. 8000  
LAKE SURF  
CLAS. SURF  
BED ROCK

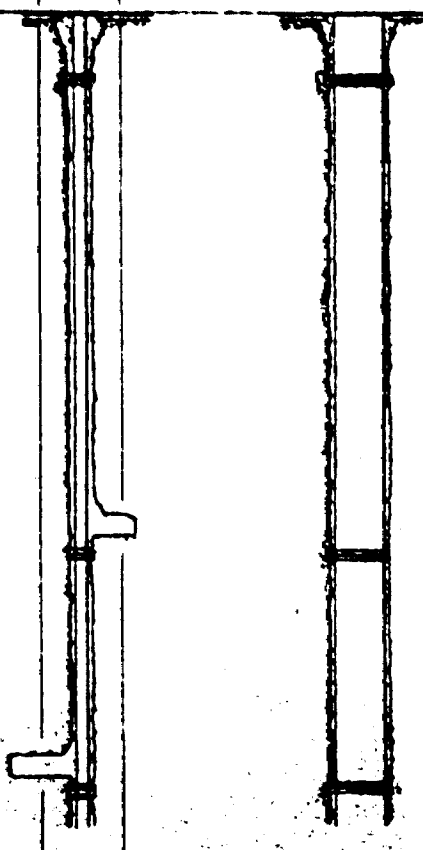

Folder 653  
Dec. 31/55

BEAUCAGE MINES LTD., NORTH BAY, ONT.

NO. 1 SHAFT

SCALE: 1" = 100'

DRAWN BY *[Signature]*

DATE FEBR. 25, 1955

DWG. NO. 22

REVISED TO

JAN 56



Folder 653  
Dec. 31/55

BEAUCAGE MINES LTD.			
SURF. LEVEL PLAN			
DR. G.S.	TR.	CH.	APPR. 1955
SCALE 1" = 100'		21	
DATE FEB 23-57			

SEE ACCOMPANYING  
MAP(S) IDENTIFIED AS

LAKE NIPISSING - 0018-A1, #1

---

---

LOCATED IN THE MAP  
CHANNEL IN THE FOLLOWING  
SEQUENCE (X)

