

31L06NE0004 W9570.00108 BUTLER

010

GEORGE KEALEY C37410 AND ARTHUR HOWDEN C37409

SUMMARY OF ASSESSEMENT WORK

CLAIM # 1197239 BUTTLER TWSP.

TRENCHING: 1,059 KILOMETERS 255 MHRS 50 MIN. @ \$16.00 per
hr = \$4080,00

TOTAL KILOMETERS:1,059

TOTAL MAN HRS. 255 and 50 MIN.

TYPE OF TRENCHING:MANUAL, PICKS, SHOVELS , HAMMERS , PRYBARS
ETC.

MINERALS FOUND:AMETHIST CRYSTALS ,SMOKEY QUARTZ CRYSTALS
,VERY SMALL CITRINE

CRYSTALS ,ROCK CRYSTALS ,AND SMALL GARNETS.

TYPES OF ROCK:GRANITIC AND MIGMATITIC BIOTITE GNEISS.

GEORGE KEALEY C37410 AND ARTHUR HOWDEN C37409

Assessment Work Eligible For Credit

Claim # 1197239 Butler Twsp.

29 MAR 95 65kls 0820-1530 Geo.Art. 14 Mhrs and 20 min.
Brought in supplies, cleared branches etc overhanging
trench area.

18 Apr 95 65kls 0730-1600. Geo Art. 17 Mhrs.
Went through tailings in trench and prospected on north
ridge.

23 Apr 95 65kls 0830-1600 Geo Art Myrna 22 Mhrs 30 min.
Art, Myrna and I dug in middle of trench and exposed some
veins of amethyst.

13 May 95 72kls 0930-1630 Geo.Art. 14 Mhrs.
Went through tailing on hillside to see what we may
have. Found amethyst,
clear and smokey quartz crystals.

21 June 95 72kls 0800-1230 Geo.Art. 9 Mhrs
Did some trenching.

28 June 95 72kls 0730-1500 Geo.Art. 15 Mhrs
Did some trenching.

02 Aug 95 72kls 0800-1400 Geo.Art. 12 Mhrs
Did some digging in ground fault just before north end of
trench.

30 Aug 95 72kls 0700-1500 Geo.Art. 16 Mhrs

FRENCH TWP

BUTLER TWP

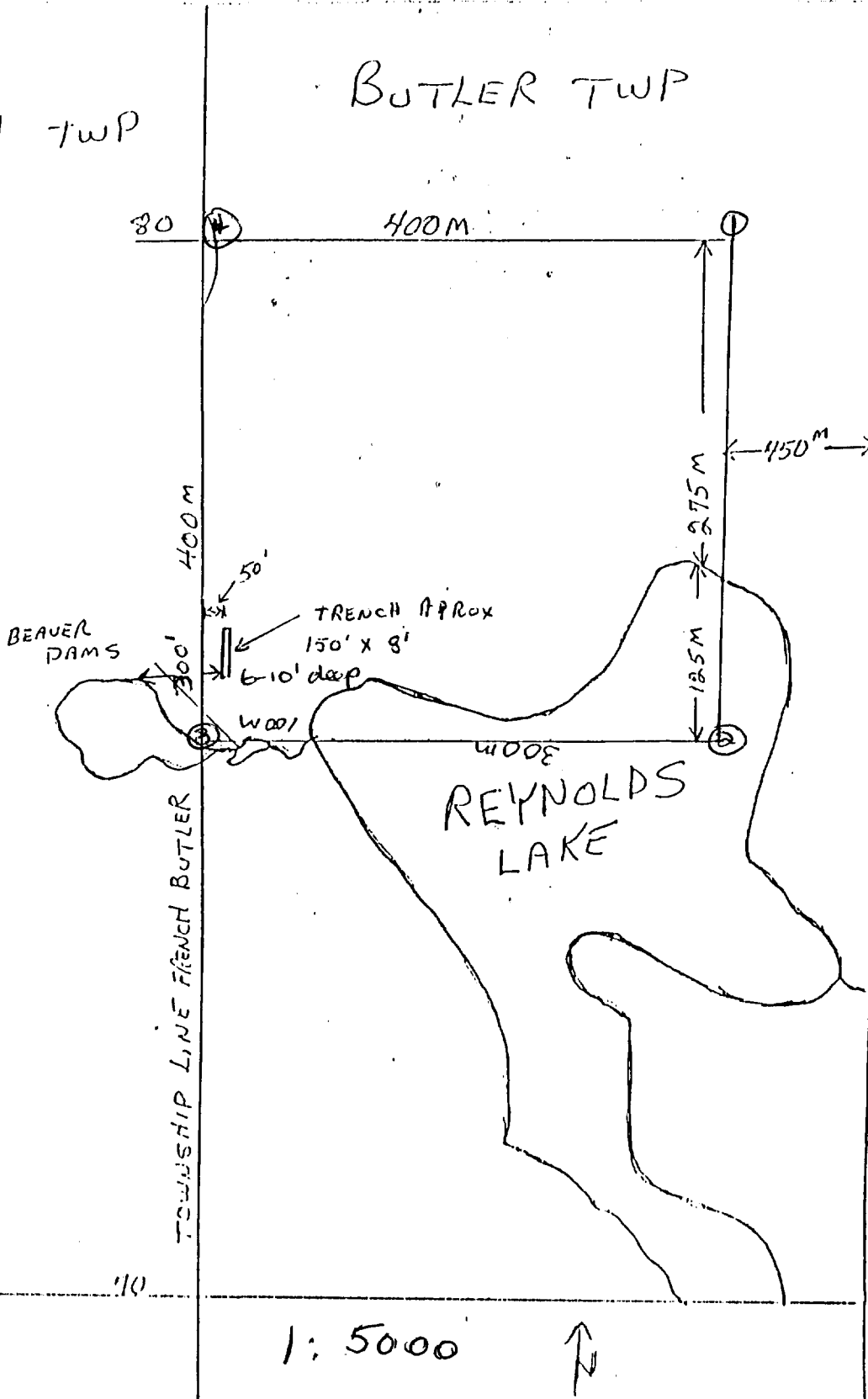

1:5000



40'

PROSPECTING 1995

12 JAN 95

Art and I found out that the Amethyst Claim in Buttler twsp has been canceled and have decided to go out one day this week and have a look around to see if it might be worth while restaking it. We looked over our maps to find easiest way in.

14 Jan 95 65kls 0730-1600

ART and I went out to the Indian lake road ,parked in parking area at hwy and walked skidoo trail part way in and snow shoed rest of the way in .we looked over the trench area ,it looks to be about 150 ft or so long and mabe 8ft across.the trench is full of snow and ice and there is lots of tailings down the side of the hill .some of the rocks have amethyst,smokey and clear quartz crystals in them.we have decided to look into it further.
we walked back out the hill on the other side of valley is a real killer

Art and I decided to call N.M.&D. and find out what information we could on cancelled claim in Butler township. I requested maps and abstract on property on 16 Jan. 95

18 Jan. 95.
Received info on Butler township claim. It is open for claiming. Art and I have decided to stake one claim now, file it then stake further claims North of claim.

19 JAN. 95 MILEAGE TOTAL 65 KMS

ART left house at 8:15 and arrived at 9am at parking spot French Township
Walked to claim at Reynolds lake in Butler township, found all four claim posts. returned to truck at 4:10pm arrived home at 5pm.

23 JAN. 95 MILEAGE TOTAL 65 KMS

ART left house at 8:20 drove to french township found 6" of fresh wet snow decided it was too dirty and returned home at 9:45. A lost day.

25 JAN. 95 MILEAGE TOTAL 65 KMS

ART walked from French Township parking lot to stake claim in butler township, at Reynolds lake . The tag #s are 1197239, Licence # is C37409.
Left truck at 9:15am Returned to truck at 8:15 , a tough day with lots of snow stuck to trees. After dark everything looked the same.
When Art was not home by 8:pm I was worried something might have happened so Gabe and I went to look for him , but he was out of bush before we arrived.

WEEK OF 25 JAN. 95

I worked on sketch of claim site and regulations to ensure we dont ##% UP.

30 JAN. 95

ART and I went to Sudbury to record our claim .
It is recorded in both our names as 50-50 owners

1 FEB.95

Abstract of claim was sent from Ministry of Northern Mines and Dev.

CLAIM # S 1197239.RECORDED 95-JAN-30 STAKED 95-JAN-25 17:15

23 FEB.95

ART and I met with Keith Craig the previous claim holder of the

amethyst mine at Reynolds lake.He said he would like to work with

us if he could and he would like to know if we decided to sell or

give it up.he also expressed concern about the work they did without

permits as they did not know they were required.There has been several

claim there and as far as we know there never was any permits issued.

17 MAR.95 0825-1410 65kls

ART and I walked from the parking lot at Indian lake road into the claim site at Reynolds lake.We were able to walk part way on the skidoo trail,about one half hours walk,the rest of the way we wore our snowshoes.It took us two hrs. to walk in and two hrs. to walk out.Arts pedometer says its seven and one half miles return.We put up three signs from the mining regs.around the area and looked the site over.The trench is about 150ft X 8ft wide and various depts.As soon as weather permits we will build a shelter and get serious.

24 MAR.95 0830 - 1445 65kls

ART and I went to claim site ,it was about -5 when we walked in ,we were able to pull the tobogans and walk on top of the snow.We brought in a wood stove some tools,fabreen for a shelter .On our way in Art had a trip down the steep hill the hard way and was run over by the tobogon with the stove in it to boot

We took some pictures of the diggings, looked around a bit,and had lunch.the trip out was a little harder as the snow was melting.

25 MAR.95 0815 -1530 65kls

Art and I went to claim site today, using a 50ft rope we measured the distance from the closest spot of amethyst dig to the pond,it is 250ft plus,so we are far enough from the pond and the creek into Reynolds lake.We then walked to the witness post on Reynolds lake and walked N/W back to the mine site checking rock ledges as we went.We did some checking of the rocks on site and headed home. We saw 1 Bard

owl and 1 partridge.

28 Mar.95 1115

Art and I went to MNR and talked to Glenda Barber about our new work permit required on 1 April 95. I gave her pictures of the amethyst dig at REYNOLDS lake and she said she would put them on our file. I also gave her a couple of pamphlets from NMD on claims and work required. We saw 1 Pileated woodpecker

29 Mar.95 0820 -1530 65kls

Art and I went back into the claim site to day and gave the emediate area a really good lookover. We brought some supplies in .We also cleared some of the dead branches hanging over the trench that were a accident waiting to happen we had a really great day and have a pretty good idea what we want to do in exploration. On our way in we saw a flock of canada geese and a partridge.

31 MAR.95 0930-1530 65kls

Art and I went in to claim site and gave the high ridge that runs north of the diggings a good check over, when all of the snow has gone we will give it another good look as we did find some quartz crystals on the ledge. We saw 1 woodpecker, 2 ravens, 1 red squirrel, 1 chipmunk and lots of small birds chickadees etc.

XXXXXXXXXX

6 APRIL 95 0745-1230 128kls

Art and I went prospecting off hwy 553 approx 5klm from the French, Butler township line. Art went down one old roadway and I started to walk along side the hwy about 200ft into the bush as I was looking around I saw a First alert saftey deposit suitcase in excelent condition laying on top of a fabreen bag

it was locked and felt pretty heavy so Art and I went to the fish hatchery and called the opp, we met them and showed them where it was. They took it with them and said they would let me know what they found.

Art and I went about 1klm farther down the road and looked around the bush till it really started to snow and came home.

9. APRIL.95 0730-1230 118kls

Art and I went prospecting off hwy 553 at the Butler, French township line

looked arround for about 2 hrs did not find what we were looking for .We shall approach from the south at another time. we did see a duck and 2 Canada Jays.

18.APRIL.95 0730-1600 65kms

Art and I went in to claim site and walked up valley past old cabin and looked for holes that are in ground around cabin area.still to much snow in area.we went to diggings and looked around trench for a while ,had a break and went to rock cut north of trench past cabin,found some quartz and amethyst in area.we have decided to give the old cabin a overhall and use it as our base camp.also found a rock with smokey quartz crystles.while we were there a flock of canada geese flew over with at least fifty bird.

20.APRIL 95 118kls

Art and I went prospecting off hwy 533,went looking for some old abandond claims in the area,we walked in as far as Butler lake but did not see anything of interest.we saw a blue heron,and a couple of canada geese.

23.APRIL 95 65kls 0830-1600

Myrna,Art and I went in to claim site for the day ,Art did some exploratory workup the valley along our north south boundry line.We all did some digging in the center part of the trench and found a few places which have good possibilities,we also found a few small pieces of rose,and smokey quartz.

02.May.95 72kls 0730-1630

Art and I went to Reynolds lake claim site and staked a new claim North of the one we have now.Starting at the south west corner using tag #1197258 we cut a tree and made our first claim post my name and licence # C377410 May 02-0950hrs.Our next claim post was at the south east corner,we cut a tree and made a claim post used tag #2,my licence,name and 11AM,}@ May 95.Our next post was the north east corner,we cut a tree, made a post, used tag #1 and put Arther Howden licence#C27409,May 02,1245PM.Our last post was in the north west corner ,We cut a tree made a post ,put tag #4 on it and Arts name and licence #.and May02-95 230 PM.We then headed south blazing our trail and much to our delight we came out not on one side or the other but directly on the south west post and I do mean right on.

4.May 95.

Art and I went to Northern Mines & Development and filed our new claim north of our present claim in Butler twp.We talked to the mining recorder who explained how to go about staking in a org.twp.where we are thinking about staking our next

claim.

7. May 95.

Art and I concluded our prospectors course with a field trip to the Temagami area, it was very informative, we got to see different types of rock and mineral formations and learned how to identify them.

08 May.95

Received abstract and new Butler maps from N.M.D. new claim north of our previous claim has been reg. in both our names 50-50.

claim #1197258 Work required 400 Date due 97/MAY/04

13. MAY. 95 72 kls 0930-1630

Art, Myrna and I went to claim site #1197239, I went over tailings in one area that had been thrown over the side to see what we have, found lots of stone with broken Quartz, Amethyst, Smokey and Citron crystals but nothing special. Art went through the trench looking things over and found a nice crystal sticking out of the side, further investigation and the removal of a few loose rocks revealed a really nice area of deep purple amethyst which we shall leave undisturbed for now. We also found a vein of amethyst running through the rock at the south end of the trench where trench ends near the surface.

25 May 95 72 kls 0730-1530

Art and I went into Reynolds lake area and staked a claim in French twsp next to our two claims in Butler twsp. all 3 claims are on the French, Butler twsp line. We started at 9am and finished at 2:30pm. The blackflies were really bad, Art looks like he got shot with a shotgun.

JUNE 21/95 72kls 0800-1230

Art and I went to Digs at Reynolds lake and dug around the trench for a little while. the flies were really bad so we left early.
On the way we saw 3 deer at the edge of the road by the fish hatchery,

JUNE 27/95 72kls 0730-2pm

Art and I went out to our claims in French and Butler twps. We spent 4 hrs looking over our north claim and part of our French twsp claims, it was pretty rough going as the day was really warm and the deer flies were really heavy.

JUNE 28/95 72kls 0730-1500

Art and I went out to the Amethyst dig at Reynolds lake for the day and did some digging in one of the trenches and found several holes in the rocks, one was big enough to put

the shelter hooked up stove etc.

SEPT 16/95 72k1s 0800-1500

Art and I went out to our claim in French twp and cut one line and part of a second line.

SEPT 17/95 72k1s 0830-1430

Myrna Art and I went to our amethyst claim and went through some of the rock piles from the blasting done over the years to see what we could find besides amethyst.

SEPT 25,26,27,28/95 72k1ms 0700/25-1800/28

Art and I went out to our claim sites in butler and french twps and camped over in our fabrene camp at the amethyst digs. during our stay we spent three half days cutting our lines on our butler twsp claims and the rest of our time digging through the rocks at the amethyst digs. we heard wolf howl during the night, and a flock of geese landed in the lake one night. I also saw a pitch black snake with a white ring around its neck and a white belly.

SEPT 30/95 72k1s 0730-1400

Art and I went out to our claim in French twsp. and partially cut two lines.

OCT>5/95 72k1s 0700-1400

Art and I went back to our claim in French twsp and finished off the two lines we started to cut Sept 30/95. I then helped Art carry some of his gear over to our camp at the amethyst digs, He is going to stay over till Tues 10/Oct. and do a bit of prospecting one our three claims,

OCT 07/95 72k1s 1000 1600

Jim came in with me to the amethyst digs and he, I, and Art did some digging at the first part of the trench. We uncovered a really large vein of large crystals the vein appears to run for a good distance and the crystals dont seem to be damaged.

Oct 10/95 72k1s 0900-1500

I went back to the amethyst digs and shoveled some of the gravel and small rocks out of the trench where we found the amethyst vein. It was hard shoveling but I want to clean out the loose stuff so We can get a better idea of what we have.

OCT 14/95 72kls 0800-1500

Myrna and I went to the Amethyst digs and did some digging to see if amethyst vein comes out to side of hill about half way up .It appears to do just that.

OCT 18/95 72 kls 0800-1400

Art and I went to amethyst digs and added some extra poles to fabreen cabin and did some other work to get ready for winter.

OCT 24/95 72kls 0700-1200

ART and I went to our claims in Buttler twsp and headed into bush N.E.of our claims to do some prospecting.ended up with heavy rain and decided to come out.

OCT 25/95 0700-1600 72kls Art and I went in to amethyst claim in Buttler twsp and worked around the site.First snow was on the ground but was gone by days end.

OCT 31/95 72klms 0730-1530

Art and I went in to amethyst digs and did some trenching on north end of trench.

NOV 12/95 72kls 0800-1530

Art and I went out to Amethyst digs ,cut some wood and did some trenching N/W end of trench.

17NOV95 65kls 0800-1600

Art and I went in to Reynolds lake amethyst digs,the road was covered with six to eight inches of snow so we had to walk in from the hwy.It took us about one and three quarter hrs each way.We brought some supplies in to our camp and decided if we want to do some work in there this winter other than the weekends we are going to have to buy a skidoo.



Ontario

Ministry of Northern Development and Mines

Report of Work Conducted After Recording Claim

Mining Act

Assessment Files

Transaction Number

W9570.00108

Personal information collected on this form is obtained under the authority of the Access to Information Act. This collection should be directed to the Provincial Manager, Mining Lands, Miramichi, Sudbury, Ontario, P3E 6A5, telephone (705) 670-7264.



31L06NE0004 W9570.00108 BUTLER

900

- Instructions:**
- Please type or print and submit in duplicate.
 - Refer to the Mining Act and Regulations for requirements of filing assessment work or consult the Mining Recorder.
 - A separate copy of this form must be completed for each Work Group.
 - Technical reports and maps must accompany this form in duplicate.
 - A sketch, showing the claims the work is assigned to, must accompany this form.

Recorded Holder(s) <i>GEORGE KEALEY ARTHUR HOWDEN</i>	Client No. <i>297042 297051</i>
Address <i>263 WESLEY AVE NORTH BAY ONT P1A2K9 1133 FRANKLIN AVE NORTH BAY ONT P1B2L9</i>	Telephone No. <i>472-4478 705 4729649</i>
Mining Division <i>SUDBURY</i>	Township/Area <i>BUTLER</i>
	M or G Plan No. <i>G-1722</i>
Dates Work Performed From: <i>MARCH 29/95</i> To: <i>NOV 12/95</i>	

Work Performed (Check One Work Group Only)

Work Group	Type
Geotechnical Survey	
Physical Work, Including Drilling	<i>TRENCHING</i>
Rehabilitation	
Other Authorized Work	<i>SECTION 18 ONLY</i>
Assays	
Assignment from Reserve	

Total Assessment Work Claimed on the Attached Statement of Costs \$ *7,397.70*

Note: The Minister may reject for assessment work credit all or part of the assessment work submitted if the recorded holder cannot verify expenditures claimed in the statement of costs within 30 days of a request for verification.

Persons and Survey Company Who Performed the Work (Give Name and Address of Author of Report)

Name	Address
<i>GEORGE KEALEY</i>	<i>263 WESLEY AVE NORTH BAY ONT P1A2K9</i>
<i>ARTHUR HOWDEN</i>	<i>1133 FRANKLIN AVE NORTH BAY ONT P1B2L9</i>

(attach a schedule if necessary)

Certification of Beneficial Interest * See Note No. 1 on reverse side

I certify that at the time the work was performed, the claims covered in this work report were recorded in the current holder's name or held under a beneficial interest by the current recorded holder.	Date <i>Dec 7/95</i>	Recorded Holder or Agent (Signature) <i>G Kealey</i>
--	-------------------------	---

Certification of Work Report

I certify that I have a personal knowledge of the facts set forth in this Work report, having performed the work or witnessed same during and/or after its completion and annexed report is true.

Name and Address of Person Certifying <i>GEORGE KEALEY 263 WESLEY AVE NORTH BAY ONT P1A2K9</i>		
Telephone No. <i>1-705-472-4478</i>	Date <i>Dec 7/95</i>	Certified By (Signature) <i>G Kealey</i>

For Office Use Only

Total Value Cr. Recorded <i>Applied \$2000.00 Reserved \$2348.00</i>	Date Recorded <i>Dec. 7/95</i>	Mining Recorder <i>[Signature]</i>	Received Stamp SUDBURY MINING DIV. RECEIVED DEC -7 1995 1 2 3 4 5 6 P.M.
	Deemed Approval Date <i>MAR. 06/96</i>	Date Approved <i>DEC. 8/95</i>	
	Date Notice for Amendments Sent		



Ministry of
Northern Development
and Mines

Ministère du
Développement du Nord
et des mines

Statement of Costs for Assessment Credit

État des coûts aux fins du crédit d'évaluation

Mining Act/Loi sur les mines

Transaction No./N° de transaction

W9570.00 108

Personal information collected on this form is obtained under the authority of the **Mining Act**. This information will be used to maintain a record and ongoing status of the mining claim(s). Questions about this collection should be directed to the Provincial Manager, Minings Lands, Ministry of Northern Development and Mines, 4th Floor, 159 Cedar Street, Sudbury, Ontario P3E 6A5, telephone (705) 670-7264.

Les renseignements personnels contenus dans la présente formule sont recueillis en vertu de la **Loi sur les mines** et serviront à tenir à jour un registre des concessions minières. Adresser toute question sur la collecte de ces renseignements au chef provincial des terrains miniers, ministère du Développement du Nord et des Mines, 159, rue Cedar, 4^e étage, Sudbury (Ontario) P3E 6A5, téléphone (705) 670-7264.

1. Direct Costs/Coûts directs

Type	Description	Amount Montant	Totals Total global
Wages Salaires	Labour Main-d'oeuvre	4,080 ⁰⁰	
	Field Supervision Supervision sur le terrain		4,080 ⁰⁰
Contractor's and Consultant's Fees Droits de l'entrepreneur et de l'expert- conseil	Type		
Supplies Used Fournitures utilisées	Type		
Equipment Rental Location de matériel	Type		
Total Direct Costs Total des coûts directs			4080 ⁰⁰

2. Indirect Costs/Coûts indirects

** Note: When claiming Rehabilitation work Indirect costs are not allowable as assessment work.
Pour le remboursement des travaux de réhabilitation, les coûts indirects ne sont pas admissibles en tant que travaux d'évaluation.

Type	Description	Amount Montant	Totals Total global
Transportation Transport	Type		
	1,059 KM @ .30	317.70	
Food and Lodging Nourriture et hébergement			
Mobilization and Demobilization Mobilisation et démobilisation			
Sub Total of Indirect Costs Total partiel des coûts indirects			317.70
Amount Allowable (not greater than 20% of Direct Costs) Montant admissible (n'excédant pas 20 % des coûts directs)			
Total Value of Assessment Credit (Total of Direct and Allowable Indirect costs)		Valeur totale du crédit d'évaluation (Total des coûts directs et indirects admissibles)	4397.70

Note: The recorded holder will be required to verify expenditures claimed in this statement of costs within 30 days of a request for verification. If verification is not made, the Minister may reject for assessment work all or part of the assessment work submitted.

Note : Le titulaire enregistré sera tenu de vérifier les dépenses demandées dans le présent état des coûts dans les 30 jours suivant une demande à cet effet. Si la vérification n'est pas effectuée, le ministre peut rejeter tout ou une partie des travaux d'évaluation présentés.

Filing Discounts

1. Work filed within two years of completion is claimed at 100% of the above Total Value of Assessment Credit.
2. Work filed three, four or five years after completion is claimed at 50% of the above Total Value of Assessment Credit. See calculations below:

Total Value of Assessment Credit	Total Assessment Claimed
	× 0.50 =

Remises pour dépôt

1. Les travaux déposés dans les deux ans suivant leur achèvement sont remboursés à 100 % de la valeur totale susmentionnée du crédit d'évaluation.
2. Les travaux déposés trois, quatre ou cinq ans après leur achèvement sont remboursés à 50 % de la valeur totale du crédit d'évaluation susmentionné. Voir les calculs ci-dessous.

Valeur totale du crédit d'évaluation	Evaluation totale demandée
	× 0,50 =

Certification Verifying Statement of Costs

I hereby certify:
that the amounts shown are as accurate as possible and these costs were incurred while conducting assessment work on the lands shown on the accompanying Report of Work form.

that as RECORDED HOLDER I am authorized
(Recorded Holder, Agent, Position in Company)

to make this certification

Attestation de l'état des coûts

J'atteste par la présente :
que les montants indiqués sont le plus exact possible et que ces dépenses ont été engagées pour effectuer les travaux d'évaluation sur les terrains indiqués dans la formule de rapport de travail ci-joint.

Et qu'à titre de _____ je suis autorisé
(titulaire enregistré, représentant, poste occupé dans la compagnie)

à faire cette attestation.

Signature E. Kealey Date Dec 17/95

MAP SYMBOLOLOGY

Aerial Cableway	Pipeline (above ground)
Boundary	Railroad
Interpretation	Single Track
Interpretation -	Double Track
District, Township	Abandoned
Indian Reserve	Turbine
Approximate	Road
Lot, Concession	Wayne County Township
Approximate	Access (road of doubtful maintenance, seasonal driveway)
Park Boundary	Trail, Back Road (surface, utility)
Bridge	Rapids
Road, Railroad	Double line river with multiple rapids
Building	Double line river with multiple rapids
Chimney	Reservoir
Cliff, Pit, Pile	River, Stream, Canal
Contours	Approximate seasonal stream of flow
Interpretation	Fork
Approximate	hoop
Depression	Spot Elevation (lake elevations)
Control Points	Tower
Horizontal	Transmission Line
Vertical	Pole
Culvert	Pylon
Falls	Tunnel
Double line river	Utility Poles
Fence, Hedge, Wall	Wharf, Dock, Pier
Feature Outline (Construction features, etc.)	Wooded Area
Flooded Land	
Lock	
Marsh or Swamp	
Mast	
Mine Head Frame	
Outcrop	

AREAS WITHDRAWN FROM DISPOSITION

- M.R.O. - MINING RIGHTS ONLY
- S.R.O. - SURFACE RIGHTS ONLY
- M.+S. - MINING AND SURFACE RIGHTS

Description	Order No.	Date	Disposition	File

Ptrench
W 9510-00108

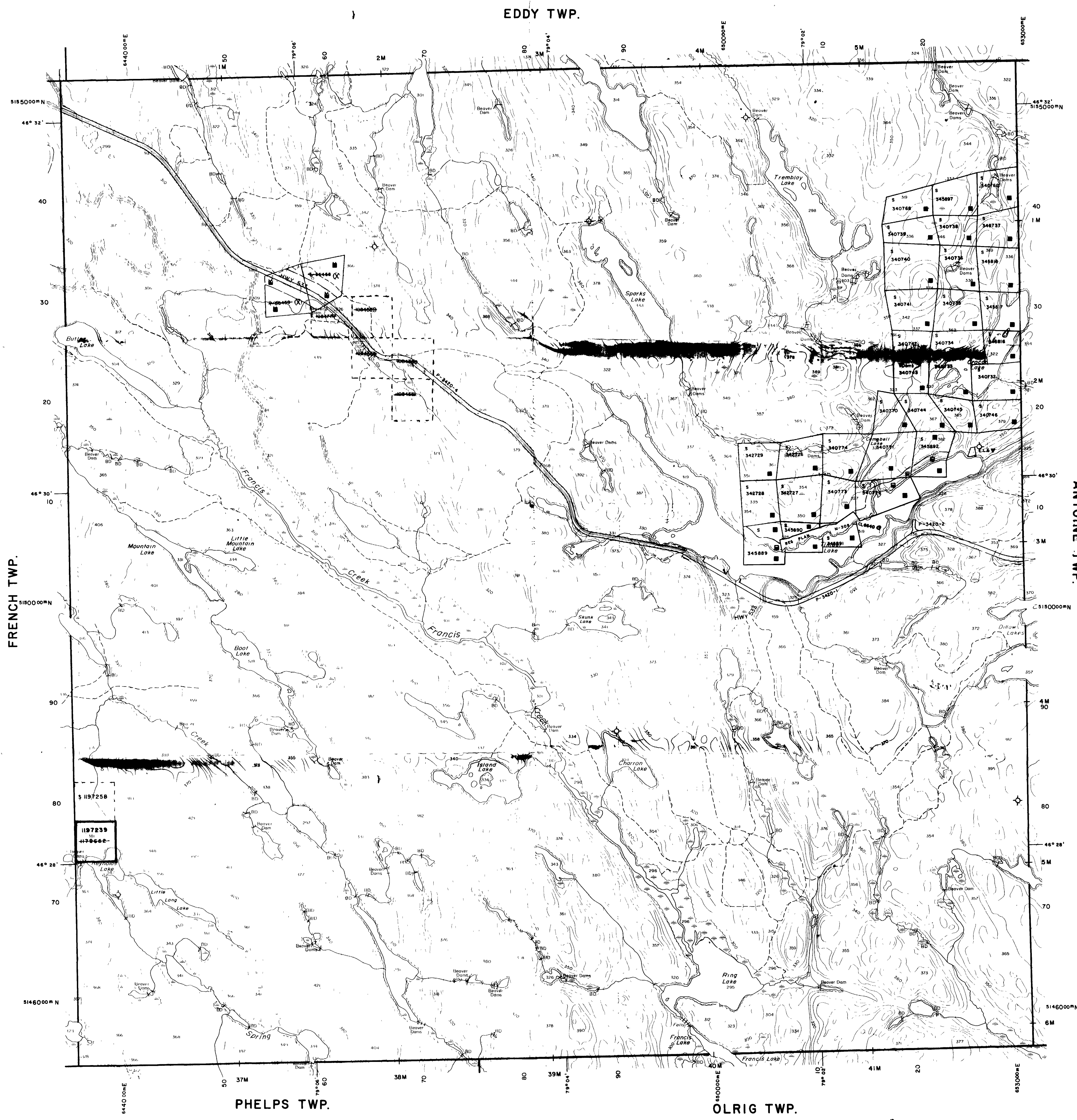

LEGEND

HIGHWAY AND ROUTE No	
OTHER ROADS	
TRAILS	
SURVEYED LINES	
TOWNSHIPS, BASE LINES, ETC	
LOTS, MINING CLAIMS, PARCELS, ETC	
UNSURVEYED LINES	
LOT LINES	
PARCEL BOUNDARY	
MINING CLAIMS ETC	
RAILWAY AND RIGHT OF WAY	
UTILITY LINES	
NON-PERENNIAL STREAM	
FLOODING OR FLOODING RIGHTS	
SUBDIVISION OR COMPOSITE PLAN	
RESERVATIONS	
ORIGINAL SHORELINE	
MARSH OR MUSKEG	
MINES	
TRAVERSE MONUMENT	

DISPOSITION OF CROWN LANDS

TYPE OF DOCUMENT	SYMBOL
PATENT, SURFACE & MINING RIGHTS	
" SURFACE RIGHTS ONLY	
" MINING RIGHTS ONLY	
LEASE, SURFACE & MINING RIGHTS	
" SURFACE RIGHTS ONLY	
" MINING RIGHTS ONLY	
LICENCE OF OCCUPATION	
ORDER-IN-COUNCIL	
RESERVATION	
CANCELLED	
SAND & GRAVEL	

LAND USE PERMIT
NOTE: MINING RIGHTS IN PARCELS PATENTED PRIOR TO MAY 1, 1913, VESTED IN ORIGINAL PATENTEE BY THE PUBLIC LANDS ACT, R.S.O. 1970, CHAP. 380, SEC. 43, SUBSEC. 1.

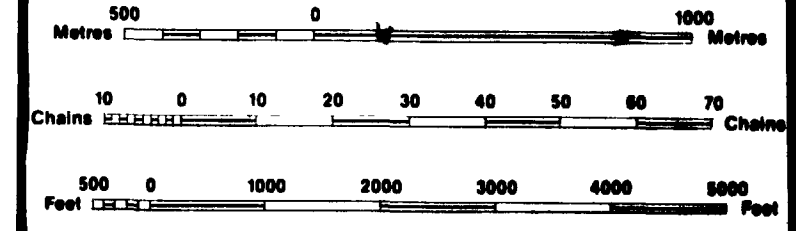

SCALE 1:20 000

DATE OF ISSUE
DEC 7 1985
SUBBURY
MINING RECORDER'S OFFICE

THE INFORMATION THAT APPEARS ON THIS MAP HAS BEEN COMPILED FROM VARIOUS SOURCES, AND ACCURACY IS NOT GUARANTEED. THOSE WISHING TO STAKE MINING CLAIMS SHOULD CONSULT WITH THE MINING RECORDER, MINISTRY OF NORTHERN DEVELOPMENT AND MINES, FOR ADDITIONAL INFORMATION ON THE STATUS OF THE LANDS SHOWN HEREON.

TOWNSHIP
BUTLER
M.N.R. ADMINISTRATIVE DISTRICT
NORTH BAY
MINING DIVISION
SUBBURY
LAND TITLES / REGISTRY DIVISION
NIPISSING



Date NOVEMBER, 1984
Number **G-1722**

