



31L06NE2001 2.18403 BUTLER

010

2.18403

ASSESSMENT WORK SUMMARY 1997

GEORGE KEALEY C37410 AND ARTHUR HOWDEN C37409

CLAIM # 1197239 BUTLER TWSP.

TRENCHING:176 MHRS @ \$16.00 PR.HR.=\$2,816.00

378 KLMS @\$0.30 PER.KLM.=\$113.40

TYPE OF TRENCHING:MANUAL WITH PICKS, SHOVELS, HAMMERS, PRYBARS, ETC

MINERALS FOUND:AMETHYST, ROCK, AND SMOKEY QUARTZ CRYSTALS

TYPE OF ROCK:GRANITIC AND MIGMATITIC BIOTITE

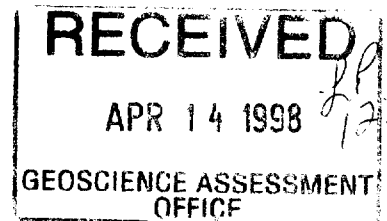

2.18403

RECEIVED

APR 14 1993

GEOSCIENCE ASSESSMENT OFFICE

FRENCH TWP

BUTLER TWP

80

400M

400M

450M

275M

125M

TRENCH APPROX 150' X 8'

BEAVER DAMS

FRENCH BUTLER

REYNOLDS LAKE

WOOD 300M

WOOD

300'

80'

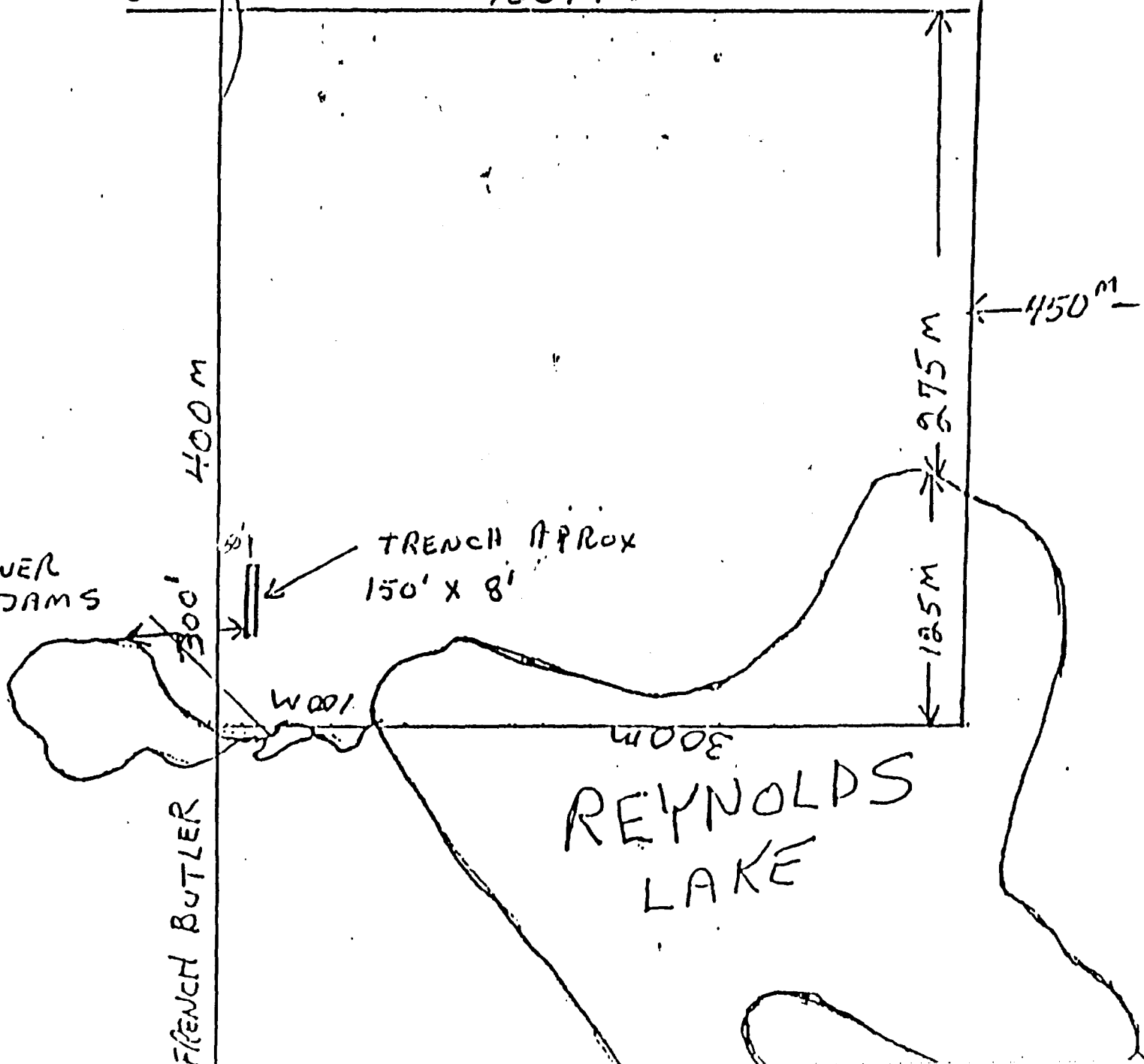
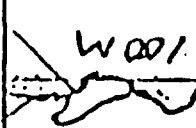
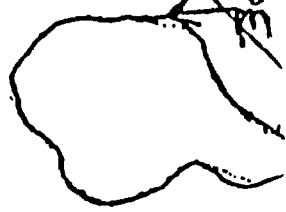

2013

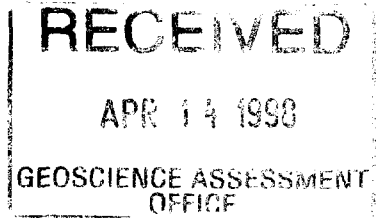

ASSESSMENT WORK 1997

21 MAY 97 0900-1430

ART AND I WENT IN TO AMETHIST DIGS AT REYNOLDS LAKE. WE WERE ABLE TO DRIVE MOST OF THE WAY IN. THERE WAS STILL SOME SNOW IN THE BUSH. ART DID SOME DIGGING IN THE TRENCH AND I DID SOME SCREENING ON WEST SIDE OF TRENCH.

28 MAY 97 0830-1530

ART AND I WENT INTO AMETHIST DIGS AT REYNOLDS LAKE, WE BOTH DID SOME HAND DIGGING IN THE TRENCH. WE DID NOT FIND MUCH IN THE AREA WE WERE DIGGING. ON OUR WAY TO THE DIGGINGS WE SAW THREE DEER. WE ALSO FOUND SOMEONE HAD PUT RED FLAG TAPE AT TOP OF HILL AND ALONG TRAIL TO DIGGS. MAYBE BEAR HUNTERS.

3 JUNE 97 0830 -1400

ART AND I WENT TO AMETHIST DIGS AT REYNOLDS LAKE. WE DID SOME DIGGING IN MAIN TRENCH. THE FLIES WERE REALY BAD EVEN GOT THROUGH THE NETS.

19 JUNE 97 0830-1500

ART AND I WENT TO REYNOLDS LAKE AMETHIST DIGS AND DID SOME DIGGING AT BOTH ENDS OF TRENCH. ON THE DRIVE OUT WE RAN INTO A KILLER PARTRIDGE IT WOULD NOT GET OFF THE ROAD SO ART GOT OUT TO CHASE IT AND IT CHASED HIM.

16 JULY 97 0830-1330

ART AND I WENT TO AMETHIST DIGS AT REYNOLDS LAKE. CHECKED CAMP OUT AFTER YESTERDAYS STORM, EVERYTHING WAS OK. I DID SOME DIGGING ON SOUTH WEST SIDE OF TRENCH ART DID SOME DIGGING IN SOUTH TRENCH. I FOUND A FEW SMALL ROCKS WITH SMALL AMETHIST CRYSTALS.

29 JULY 97 0830-1530

ART AND I WENT TO THE AMETHIST DIGS AT REYNOLDS LAKE. ART DUG IN SHALLOW SECTION OF TRENCH IN THE BUS, DID FIND ANYTHING WORTHWHILE. I DID SOME DIGGING OFF THE S/E CORNER OF MAIN TRENCH NO LUCK.

12 AUG 97 0800-1600

ART AND I WENT TO AMETHIST DIGS AT REYNOLDS LAKE. I DID SOME DIGGING ON WEST SIDE OF TRENCH ART DID SOME DIGGING AT SOUTH END OF TRENCH.

04 SEPT 97 0830-1530

ART AND I WENT TO AMETHIST DIGS AT REYNOLDS LAKE I MOVED A PILE OF ROCKS AT S/W END OF TRENCH WHILE ART DID SOME DIGGING AT FAR END OF TRENCH SOUTH SIDE.

10 SEPT 97 0830-1500

ART AND I WENT TO AMETHIST DIGS AT REYNOLDS LAKE .ART CONTIUED DIGGING AT SOUTH END OF TRENCH AND I WORKED ON WEST SIDE.

6 OCT 97 0900-1600

ART AND I WENT TO AMETHIST DIGS AT REYNOLDS LAKE.DID SOME DIGGING AND SCREENING ON SOUTH AND WEST SIDE OF TRENCH.

11 OCT 97 1030-1430

JIM AND I WENT IN TO AMETHIST DIGS AT REYNOLDS LAKE ART HAS BEEN OUT THERE FOR SEVERAL DAYS AND IS STAYING TILL NEXT THURSDAY.I DID A BIT OF SCREENING WEST SIDE OF TRENCH.

13 OCT 97 0900-1500

I WENT IN TO AMETHIST DIGS AT REYNOLDS LAKE .ART WAS ALREADY IN DIGING AT N/E END OF TRENCH .I DID SOME SCREENING AT CENTER OF TRENCH .AND S/W END.

5 NOV 97 0900-1530

ART AND I WENT TO REYNOLDS LAKE CLAIM ,ART DID SOME DIGGING AT N/W END OF TRENCH I DUG S/W END.

6 NOV 97 0900-1500

ART AND I WENT TO REYNOLDS LAKE AMETHIST DIGS,ART DID MORE DIGGING AT NORTH WEST END OF TRENCH AND I WENT DID SOME DIGGING AT CENTER OF TRENCH WEST SIDE.



31L06NE2001 2.18403 BUTLER 900

the Mining Act. This information will be used for correspondence. Questions about
Ministry of Northern Development and Mines, Fourth Floor, 159 Cedar Street,

- Refer to the Mining Act and Regulations for requirements of filing assessment work or consult the Mining Recorder.
- A separate copy of this form must be completed for each Work Group.
- Technical reports and maps must accompany this form in duplicate.
- A sketch, showing the claims the work is assigned to, must accompany this form.

2.18403

Recorded Holder(s) GEORGE KEALEY ARTHUR HOWDEN	Client No. 297042 295051
Address 263 WESLEY AVE NORTH BAY ONT. P1A2K9 1113 FRANKLIN AVE NORTH BAY ONT P1B2L9	Telephone No. 705 472-4478 705 472-9644
Mining Division SUDBURY	Township/Area BUTLER
M or G Plan No.	
Dates Work Performed From: 21 MAY 97 To: 6 NOV 97 ✓	

Work Performed (Check One Work Group Only)

Work Group	Type
Geotechnical Survey	
Physical Work, Including Drilling	TRENCHING SCREENING
Rehabilitation	
Other Authorized Work	SEWERAGE INSTALLATION
Assays	
Assignment from Reserve	

Total Assessment Work Claimed on the Attached Statement of Costs \$ 2,929

Note: The Minister may reject for assessment work credit all or part of the assessment work submitted if the recorded holder cannot verify expenditures claimed in the statement of costs within 30 days of a request for verification.

Persons and Survey Company Who Performed the Work (Give Name and Address of Author of Report)

Name	Address
GEORGE KEALEY	263 WESLEY AVE NORTH BAY ONT P1A2K9
ARTHUR HOWDEN	1133 FRANKLIN AVE NORTH BAY ONT P1B2L9

(attach a schedule if necessary)

Certification of Beneficial Interest * See Note No. 1 on reverse side

I certify that at the time the work was performed, the claims covered in this work report were recorded in the current holder's name or held under a beneficial interest by the current recorded holder.	Date 1 April 98	Recorded Holder or Agent (Signature) <i>G Kealey</i>
----------------------------------------------------------------------------------------------------------------------------------------------------------------------------------------------------------	---------------------------	---------------------------------------------------------

Certification of Work Report

I certify that I have a personal knowledge of the facts set forth in this Work report, having performed the work or witnessed same during and/or after its completion and annexed report is true.		
Name and Address of Person Certifying GEORGE KEALEY 263 WESLEY AVE NORTH BAY ONT P1A2K9		
Telephone No. 705-472-4478	Date 1 April 98	Certified By (Signature) <i>G Kealey</i>

For Office Use Only

Total Value Cr. Recorded	Date Recorded	Mining Recorder	Received Stamp RECEIVED APR 14 1998 12:30 GEOSCIENCE ASSESSMENT OFFICE
	Deemed Approval Date July 13/98	Date Approved	
	Date Notice of Amendments Sent		



Ministry of
Northern Development
and Mines

Ministère du
Développement du Nord
et des mines

**Statement of Costs
for Assessment Credit**

**État des coûts aux fins
du crédit d'évaluation**

Mining Act/Loi sur les mines

Transaction No./N° de transaction

W9870.00062

2.18403

Personal information collected on this form is obtained under the authority of the Mining Act. This information will be used to maintain a record and ongoing status of the mining claim(s). Questions about this collection should be directed to the Provincial Manager, Minings Lands, Ministry of Northern Development and Mines, 4th Floor, 159 Cedar Street, Sudbury, Ontario P3E 6A5, telephone (705) 670-7264.

Les renseignements personnels contenus dans la présente formule sont recueillis en vertu de la Loi sur les mines et serviront à tenir à jour un registre des concessions minières. Adresser toute question sur la collecte de ces renseignements au chef provincial des terrains miniers, ministère du Développement du Nord et des Mines, 159, rue Cedar, 4^e étage, Sudbury (Ontario) P3E 6A5, téléphone (705) 670-7264.

1. Direct Costs/Coûts directs

Type	Description	Amount Montant	Totals Total global
Wages Salaires	Labour Main-d'oeuvre	2,816.00	2,816.00
	Field Supervision Supervision sur le terrain		
Contractor's and Consultant's Fees Droits de l'entrepreneur et de l'expert- conseil	Type		
Supplies Used Fournitures utilisées	Type		
Equipment Rental Location de matériel	Type		
Total Direct Costs Total des coûts directs			2,816.00

2. Indirect Costs/Coûts indirects

** Note: When claiming Rehabilitation work Indirect costs are not allowable as assessment work.
Pour le remboursement des travaux de réhabilitation, les coûts indirects ne sont pas admissibles en tant que travaux d'évaluation.

Type	Description	Amount Montant	Totals Total global
Transportation Transport	Type		
	378 KLS @ .30	113.40	
Food and Lodging Nourriture et hébergement			
Mobilization and Demobilization Mobilisation et démobilisation			
Sub Total of Indirect Costs Total partiel des coûts indirects			113.40
Amount Allowable (not greater than 20% of Direct Costs) Montant admissible (n'excédant pas 20 % des coûts directs)			
Total Value of Assessment Credit (Total of Direct and Allowable indirect costs)		Valeur totale du crédit d'évaluation (Total des coûts directs et indirects admissibles)	2,929.40

Note: The recorded holder will be required to verify expenditures claimed in this statement of costs within 30 days of a request for verification. If verification is not made, the Minister may reject for assessment work all or part of the assessment work submitted.

Note : Le titulaire enregistré sera tenu de vérifier les dépenses demandées dans le présent état des coûts dans les 30 jours suivant une demande à cet effet. Si la vérification n'est pas effectuée, le ministre peut rejeter tout ou une partie des travaux d'évaluation présentés.

Filing Discounts

1. Work filed within two years of completion is claimed at 100% of the above Total Value of Assessment Credit.
2. Work filed three, four or five years after completion is claimed at 50% of the above Total Value of Assessment Credit. See calculations below:

Total Value of Assessment Credit	Total Assessment Claimed
	x 0.50 =

Remises pour dépôt

1. Les travaux déposés dans les deux ans suivant leur achèvement sont remboursés à 100 % de la valeur totale susmentionnée du crédit d'évaluation.
2. Les travaux déposés trois, quatre ou cinq ans après leur achèvement sont remboursés à 50 % de la valeur totale du crédit d'évaluation susmentionné. Voir les calculs ci-dessous.

Valeur totale du crédit d'évaluation	Evaluation totale demandée
	x 0,50 =

Certification Verifying Statement of Costs

I hereby certify:
that the amounts shown are as accurate as possible and these costs were incurred while conducting assessment work on the lands shown on the accompanying Report of Work form.

that as RECORDED HOLDER I am authorized
(Recorded Holder, Agent, Position in Company)

to make this certification

Attestation de l'état des coûts

J'atteste par la présente :
que les montants indiqués sont le plus exact possible et que ces dépenses ont été engagées pour effectuer les travaux d'évaluation sur les terrains indiqués dans la formule de rapport de travail ci-joint.

Et qu'à titre de _____ je suis autorisé
(titulaire enregistré, représentant, poste occupé dans la compagnie)

à faire cette attestation.

RECEIVED
APR 14 1998
GEOSCIENCE ASSESSMENT

Signature Y Kealey Date 14 April 98

Nota : Dans cette formule, lorsqu'il désigne des personnes, le masculin est utilisé au sens neutre.

2.18403

Work Report Number for Applying Reserve	Claim Number (see Note 2)	Number of Claim Units
	51197239	1
Total Number of Claims		

Value of Assessment Work Done on this Claim	Value Applied to this Claim
2929.40	0
Total Value Work Done	
Total Value Work Applied	

Value Assigned from this Claim	Reserve: Work to be Claimed at a Future Date
0	2929.40
Total Assigned From	
Total Reserve	

24840.00062

Credits you are claiming in this report may be cut back. In order to minimize the adverse effects of such deletions, please indicate from which claims you wish to prioritize the deletion of credits. Please mark (✓) one of the following:

- Credits are to be cut back starting with the claim listed last, working backwards.
- Credits are to be cut back equally over all claims contained in this report of work.
- Credits are to be cut back as prioritized on the attached appendix.

TAKE FROM RESERVE.
 In the event that you have not specified your choice of priority, option one will be implemented.

RECEIVED
 APR 14 1998 12:30
 GEOSCIENCE ASSESSMENT OFFICE

Note 1: Examples of beneficial interest are unrecorded transfers, option agreements, memorandum of agreements, etc., with respect to the mining claims.

Note 2: If work has been performed on patented or leased land, please complete the following:

I certify that the recorded holder had a beneficial interest in the patented or leased land at the time the work was performed.	Signature	Date
---------------------------------------------------------------------------------------------------------------------------------	-----------	------

Geoscience Assessment Office
933 Ramsey Lake Road
6th Floor
Sudbury, Ontario
P3E 6B5

Telephone: (888) 415-9846
Fax: (705) 670-5881

July 7, 1998

GEORGE GORDON KEALEY
263 WESLEY AVENUE
NORTH BAY, ONTARIO
P1A-2K9

Visit our website at:
www.gov.on.ca/MNDM/MINES/LANDS/mlsmnpge.htm

Dear Sir or Madam:

Submission Number: 2.18403

Status

Subject: Transaction Number(s): W9870.00062 Deemed Approval

We have reviewed your Assessment Work submission with the above noted Transaction Number(s). The attached summary page(s) indicate the results of the review. **WE RECOMMEND YOU READ THIS SUMMARY FOR THE DETAILS PERTAINING TO YOUR ASSESSMENT WORK.**

If the status for a transaction is a 45 Day Notice, the summary will outline the reasons for the notice, and any steps you can take to remedy deficiencies. The 90-day deemed approval provision, subsection 6(7) of the Assessment Work Regulation, will no longer be in effect for assessment work which has received a 45 Day Notice. Allowable changes to your credit distribution can be made by contacting the Geoscience Assessment Office within this 45 Day period, otherwise assessment credit will be cut back and distributed as outlined in Section #6 of the Declaration of Assessment work form.

Please note any revisions must be submitted in **DUPLICATE** to the Geoscience Assessment Office, by the response date on the summary.

If you have any questions regarding this correspondence, please contact Steve Beneteau by e-mail at benetest@epo.gov.on.ca or by telephone at (705) 670-5855.

Yours sincerely,



ORIGINAL SIGNED BY
Blair Kite
Supervisor, Geoscience Assessment Office
Mining Lands Section

Work Report Assessment Results

Submission Number: 2.18403

Date Correspondence Sent: July 07, 1998

Assessor: Steve Beneteau

Transaction Number	First Claim Number	Township(s) / Area(s)	Status	Approval Date
W9870.00062	1197239	BUTLER	Deemed Approval	July 06, 1998

Section:
10 Physical PMAN

Correspondence to:
Resident Geologist
Sudbury, ON

Recorded Holder(s) and/or Agent(s):
GEORGE GORDON KEALEY
NORTH BAY, ONTARIO

Assessment Files Library
Sudbury, ON

ARTHUR HOWDEN
NORTH BAY, ONTARIO

MAP SYMBOLOLOGY

AREAS WITHDRAWN FROM DISPOSITION

- M.R.O. - MINING RIGHTS ONLY
- S.R.O. - SURFACE RIGHTS ONLY
- M.+S. - MINING AND SURFACE RIGHTS

Description	Order No.	Date	Disposition	File

LEGEND

DISPOSITION OF CROWN LANDS

TYPE OF DOCUMENT	SYMBOL
PATENT, SURFACE & MINING RIGHTS	
" SURFACE RIGHTS ONLY	
" MINING RIGHTS ONLY	
LEASE, SURFACE & MINING RIGHTS	
" SURFACE RIGHTS ONLY	
" MINING RIGHTS ONLY	
LICENCE OF OCCUPATION	
ORDER-IN-COUNCIL	
RESERVATION	
CANCELLED	
SAND & GRAVEL	
LAND USE PERMIT	

NOTE: MINING RIGHTS IN PARCELS PATENTED PRIOR TO MAY 6, 1912, VESTED IN ORIGINAL PATENTEE BY THE PUBLIC LANDS ACT, R.S.O. 1970, CHAP. 390, SEC. 63, SUBSEC. 1.

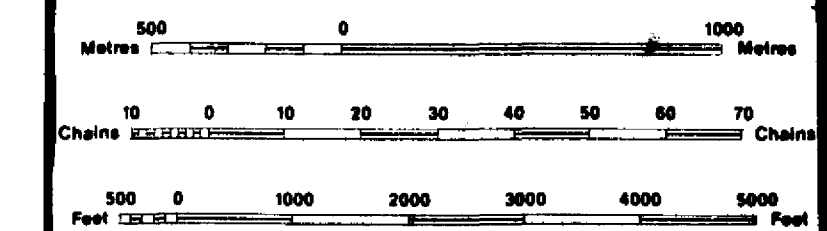

SCALE 1:20 000

DATE OF ISSUE
JUN 22 1984
PROVINCIAL RECORDS
OFFICE - SUDBURY

THE INFORMATION THAT APPEARS ON THIS MAP HAS BEEN COMPILED FROM VARIOUS SOURCES AND ACCURACY IS NOT GUARANTEED. THOSE WISHING TO STAKE MINING CLAIMS SHOULD CONSULT WITH THE MINING RECORDER, MINISTRY OF NORTHERN DEVELOPMENT AND MINES, FOR ADDITIONAL INFORMATION ON THE STATUS OF THE LANDS SHOWN HEREON.

TOWNSHIP
BUTLER
M.N.R. ADMINISTRATIVE DISTRICT
NORTH BAY
MINING DIVISION
SUDBURY
LAND TITLES / REGISTRY DIVISION
NIPISSING

Ministry of Natural Resources
Land Management Branch
Ontario

Date NOVEMBER, 1984
Number
G-1722

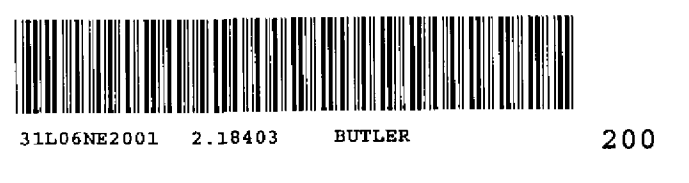
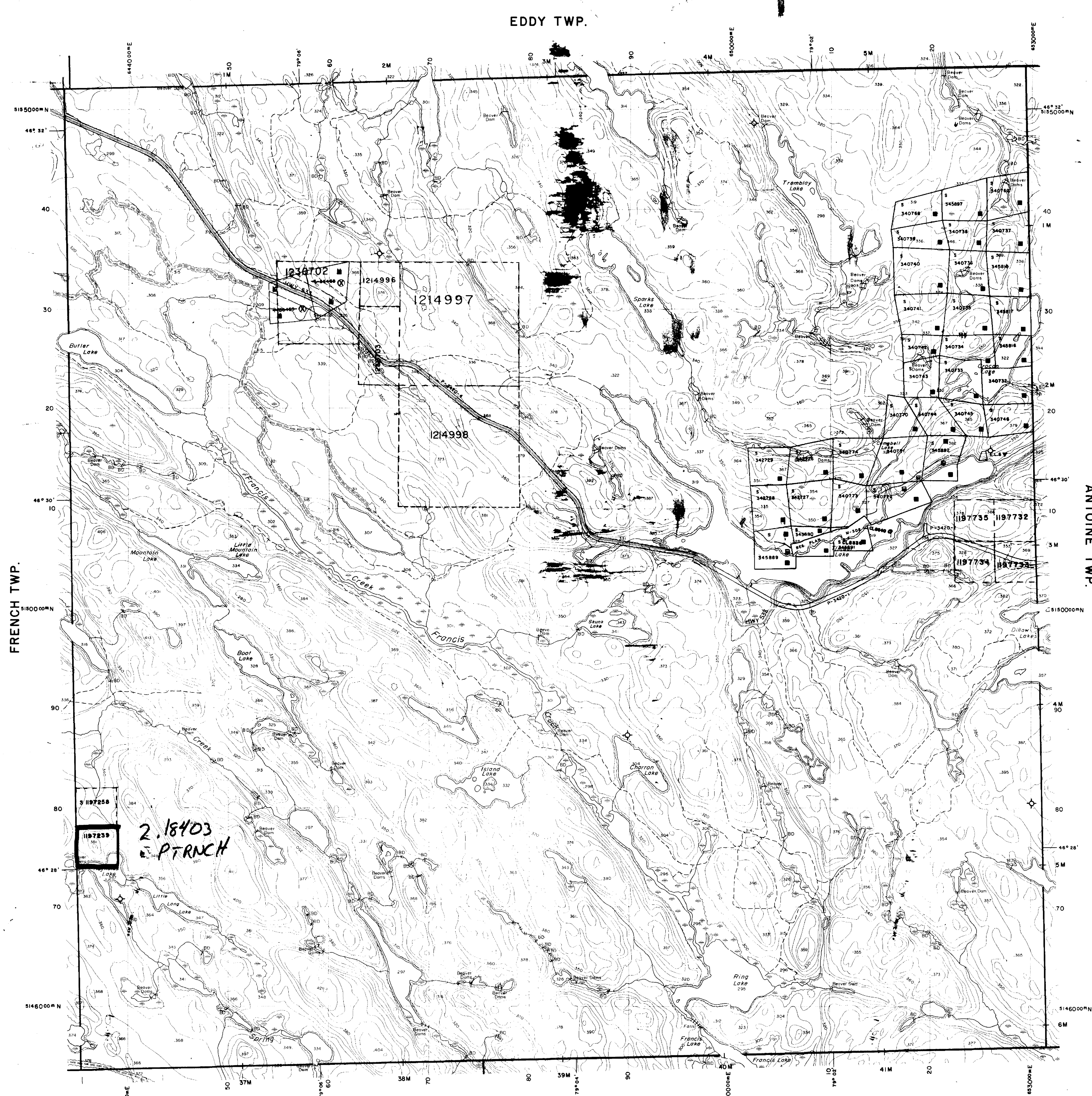

G-1555

BUTLER TWP.

G-1555

G-1555

BUTLER TWP.

G-1555