

Aug. 26, 1986

L.D. SNODDON

D. ROGERS

135 Balsam Cr

North Bay, Ont.

PIB 6m2



31L06NE9751 63.4940 BUTLER

010

ATTN Edward Solonyka OMEP OFFICE

Dear Sir:

Please find enclosed, the supporting data requested in your Aug. 8 th letter.

#1 Reason for trenching is to determine quantity & quality.

#2 Prospecting, trenching & blasting exposed a number of parallel narrow amethyst bearing veins which cut Grenville - age granitic gneisses.

#3 Main vein was exposed & explored by trenching, a length of approx 100 feet was examined. Width of trenching varies from 4 ft to 1 ft, depth from 5 ft to 1 ft. Numerous other veins were exposed on surface

#4 As far as favourable results, we believe main vein has some potential for facing stone & quality gem stones.

#5 Conclusion. Not enough quantity at this time, unless vein widens substantially to justify commercial operations under a quarry permit. At present cost of extracting product doesn't make operation profitable

#6 The deposit will be very favourable for a gem stone collecting site & will be of great interest to lapidary interests or tourist interests as the deposit is unique to this area. Therefore our future explorations on this property will be with this in mind.

We want to thank your office for your assistance with this program & trust the above meets your request.

Yours Truly

Group Sketch of claims listed on page 1

Scale: 1 inch = 1320 feet  
(20 chains)

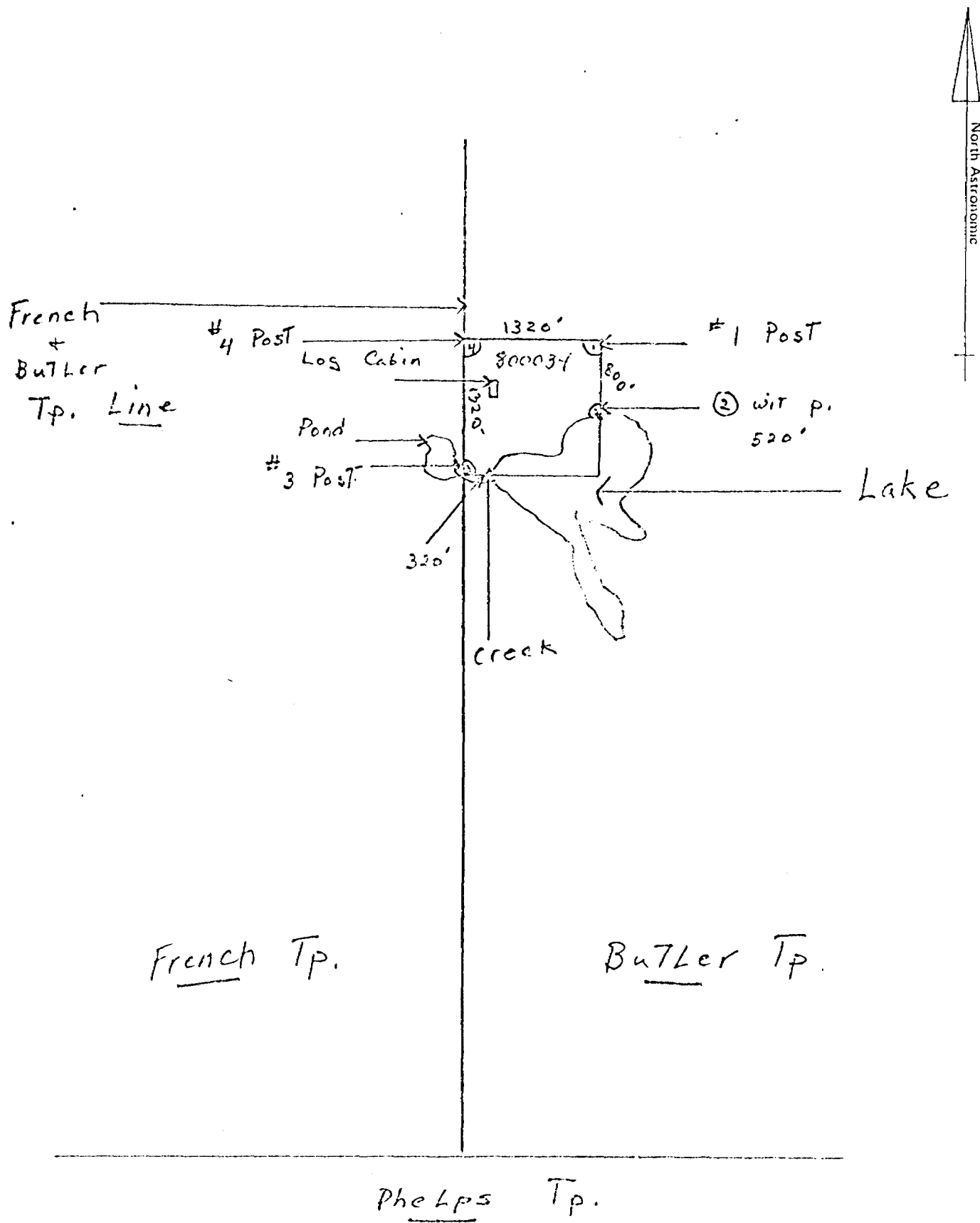

JUNE 1986

BUTLER TWP,  
# S - 800034  
(GAIN #)

