

OP 89-261



010

HOGG SILICA PROSPECT

REPORT ON WORK PERFORMED UNDER OPAP GRANT

LOCATION

The Hogg Silica Prospect is on claims S 1017435-40, inclusive, in the east central part of McAuslan Twp., Sudbury Mining Division, Ontario. The property lies about 50 kilometers north of the city of North Bay. Figure I shows the general location of the property. Figure II shows the location of the claims.

ACCESS

The claims are easily reached by a 0.4 kilometer trail from Threetrails Lake road, off the McLelland forest access road. The McLelland forest access road joins provincial Highway #63 at a point about 50 kilometers northeast of North Bay.

GENERAL GEOLOGY

The property is underlain by Grenville orthoquartzite, part of a sequence of clastic siliceous metasediments of Middle Precambrian age. Loosely packed quartz pebble beds up to 0.5 meter thick form part of the quartzite unit. The quartzite strikes slightly west of north, and dips about 40° to the west.

WORK PERFORMED

Prospecting: The first day of prospecting under the OPAP Grant, December 3, 1989, was spent reviewing and finalizing the overall-planned program with the contractor, Bryan Belanger, of Belatech Industries Ltd. The next two days, Dec. 4 and 5, were spent prospecting the area of Claims S 1017436 and 38. Potential sites were selected for stripping of the overburden to expose bedrock. Dec. 6 and 7 were spent probing the stripped areas and other potential stripping sites with a sounding bar to locate near-surface bedrock.

Following completion of the rock trenches, Dec. 19, 20, 21, and 22 were spent examining and mapping the 5 trenched areas, and tying them and the stripped areas in to the Base Line.

A subsequent day, Dec. 23, was spent drafting a sketch of the work area.

Linecutting: A Base Line was cut at Az. 348° from the centre of the south property boundary, i.e., from the #3 post of Claim S 1017435 and the #2 post of Claim S 1017436. The Base Line was cut to the north property boundary, a distance of almost 1,400 meters. The Base Line was chained, and pickets were erected and marked at each 25-meter station. The Base Line was cut by Rick Scanlon, Rick Lavoy, and Wayne McLeod, employees of Belatech Industries, between Dec. 4-6/89.

Stripping: Bryan Belanger and Allan Waldriff of Belatech Industries transported a John Deere JD 450 Bulldozer to the site on Dec. 4, 1989. The following day, Waldriff plowed a road to the first stripping site on Claim S 1017436. Three sites were stripped and probed with a sounding bar on Dec. 6, but no bedrock was located. The JD 450 experienced a break-down, and arrangements were made to obtain a replacement dozer so that work could continue uninterrupted. The replacement dozer, a John Deere 450D, was trucked to the site by Belanger the following day, and stripping resumed on Claim S 1017436 by Waldriff. Two additional sites were stripped, and bedrock was located at one of the two sites. Stripping was completed on Claim S 1017436 by Waldriff on Dec. 8, 1989.

Stripping then commenced on Claim S 1017438 on Dec. 11, and Waldriff completed it the following day. Twelve sites were stripped, and bedrock was found at four of them.

The two Dozers were moved off the property by Belanger and Waldriff on December 22.

Figure III shows the locations of the stripped areas.

Trenching: A LeRoi 185 Air Compressor, with two hand rock drills and all ancillary drilling equipment were brought on site by Belanger on Dec. 12. The next 3 days, Dec. 13, 14, and 15, Belanger and Waldriff drilled and blasted Trenches A, B, C, and D on Claim S 1017438, and Trench E on Claim S 1017436. Waldriff mucked the five trenches out between Dec. 18-20, and on Dec. 21, he and Belanger returned the equipment to North Bay.

Figure III shows the locations of the five trenches.

CONCLUSIONS

A program of prospecting, stripping, and rock trenching was completed on Claims S 1017436 and 1017438, in McAuslan Twp., Sudbury Mining Division. A Base Line was also cut on the property, in order to tie

in the stripping and trenching sites. Reconnaissance samples were collected from all five trenches. Detailed sampling of the trenches was not performed because of a subsequent heavy fall of snow. This detailed sampling will be performed, however it must now be deferred until the spring after the snow has melted. Visual examination of the reconnaissance samples confirms the widespread occurrence of a high-silica quartzite (+95% SiO₂), and suggests that additional trenching and sampling is warranted to the east, on Claims S 1017435 and 1017437.

January 29, 1990

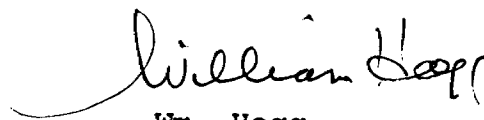
Wm. Hogg

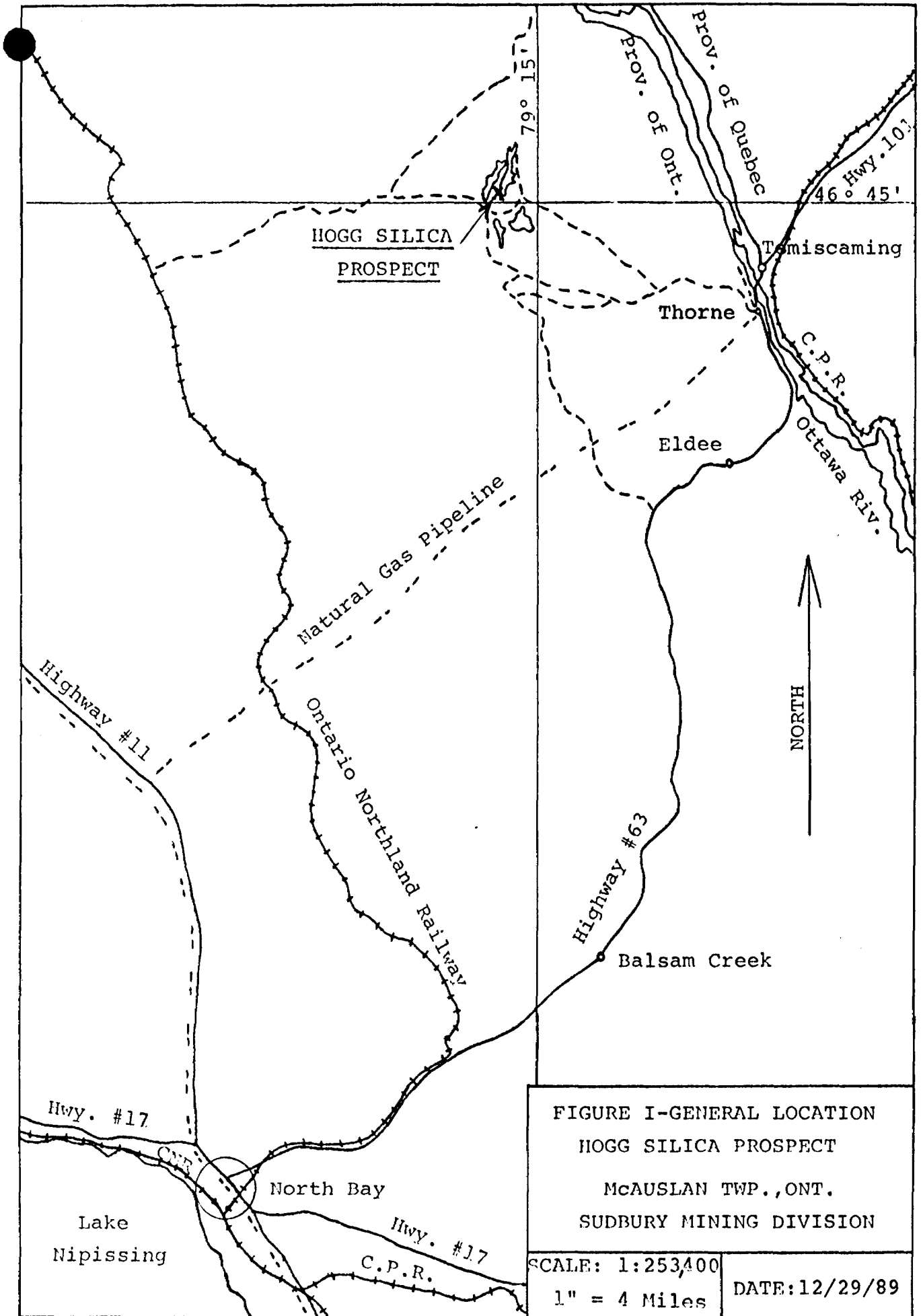

FIGURE I-GENERAL LOCATION
 HOGG SILICA PROSPECT
 MCAUSLAN TWP., ONT.
 SUDBURY MINING DIVISION

SCALE: 1:253,400
 1" = 4 Miles

DATE: 12/29/89

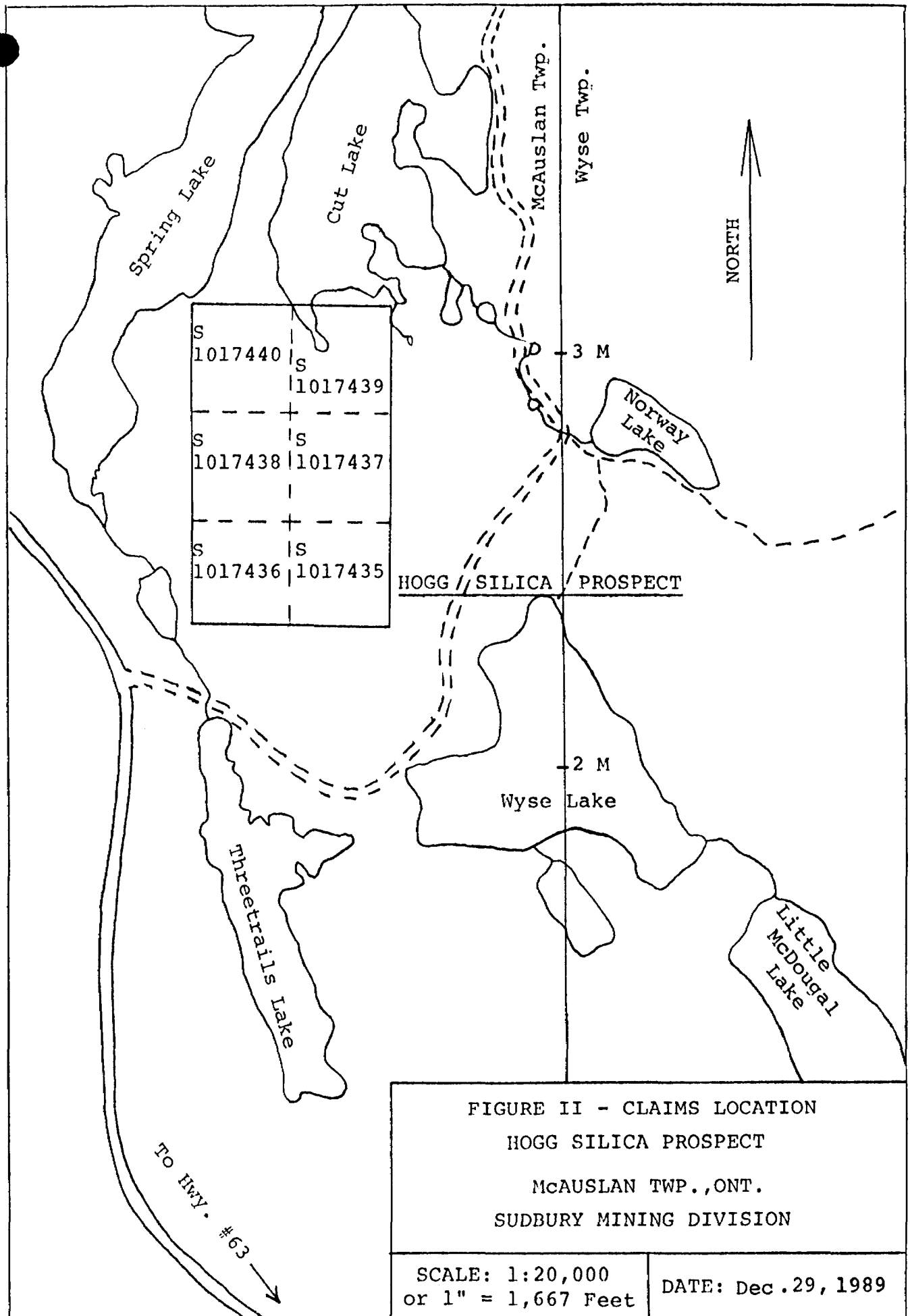

FIGURE II - CLAIMS LOCATION

HOGG SILICA PROSPECT

McAUSLAN TWP., ONT.

SUDBURY MINING DIVISION

SCALE: 1:20,000
or 1" = 1,667 Feet

DATE: Dec. 29, 1989

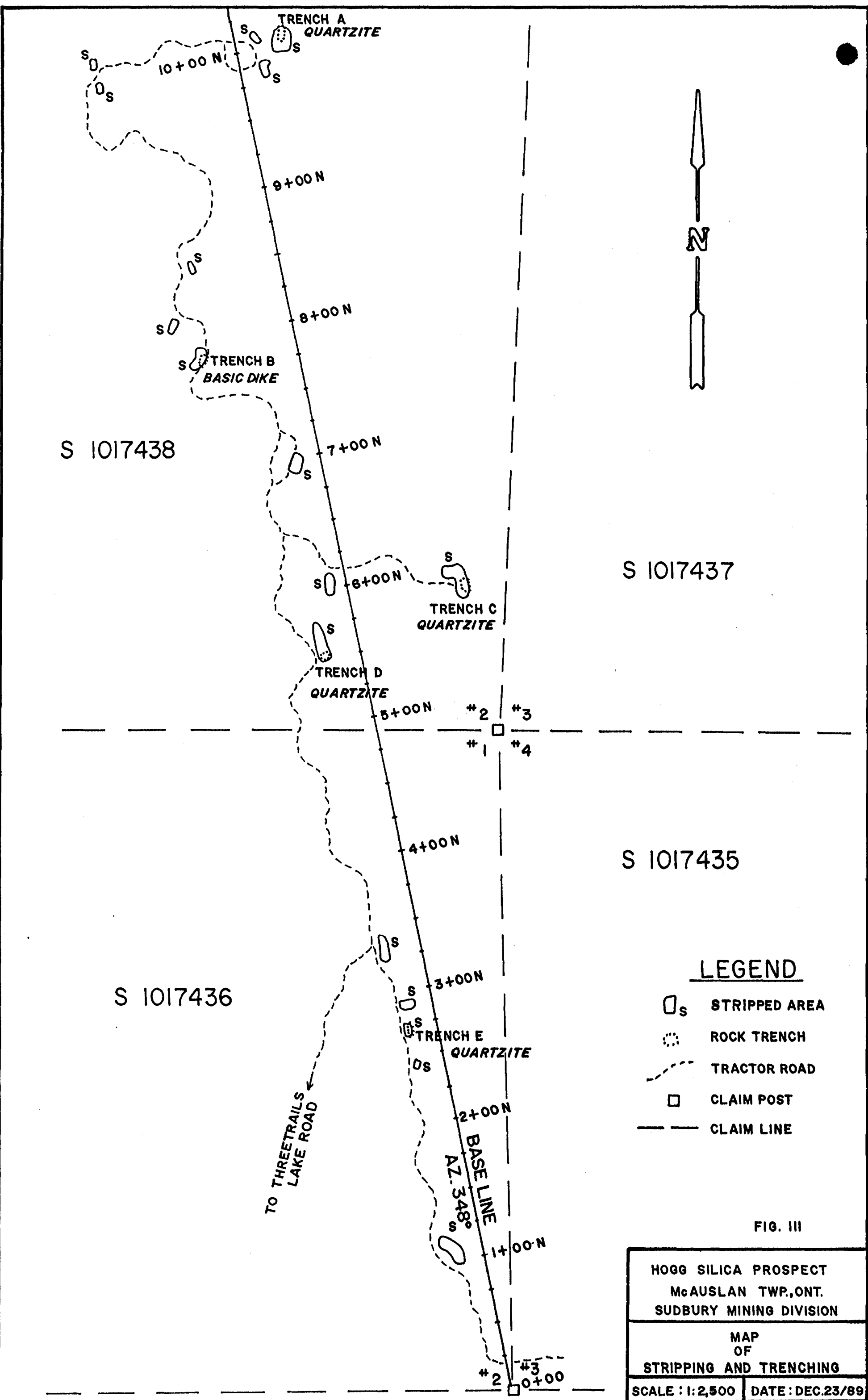

S 1017438

S 1017437

S 1017435

S 1017436

LEGEND





-  STRIPPED AREA
-  ROCK TRENCH
-  TRACTOR ROAD
-  CLAIM POST
-  CLAIM LINE

FIG. III

HOGG SILICA PROSPECT
 McAUSLAN TWP., ONT.
 SUDBURY MINING DIVISION

MAP
 OF
 STRIPPING AND TRENCHING

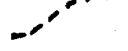
SCALE: 1:2,500 | DATE: DEC. 23/89