



31L11SE0002 14 ANTOINE

010

Diamond Drilling

Township of ANTOINE

Report N<sup>o</sup> 14

Work performed by: Kyanite Mining Corporation

Claim N <sup>o</sup>	Hole N <sup>o</sup>	Footage	Date	Note
S 340766	6-75	445.0'	Oct/75	(1)
S 323926	1-76	144.0'	Apr/76	(2)
S 323928	2-76	558.0'	May/76	(3)

Notes:

- (1) #75-76
- (2) #76-76
- (3) #77-76

KYANITE MINING CORP.

Eddy Twp.-M. 778

Antoine Sup.  
(M 630)

Butler Twp.-M. 693

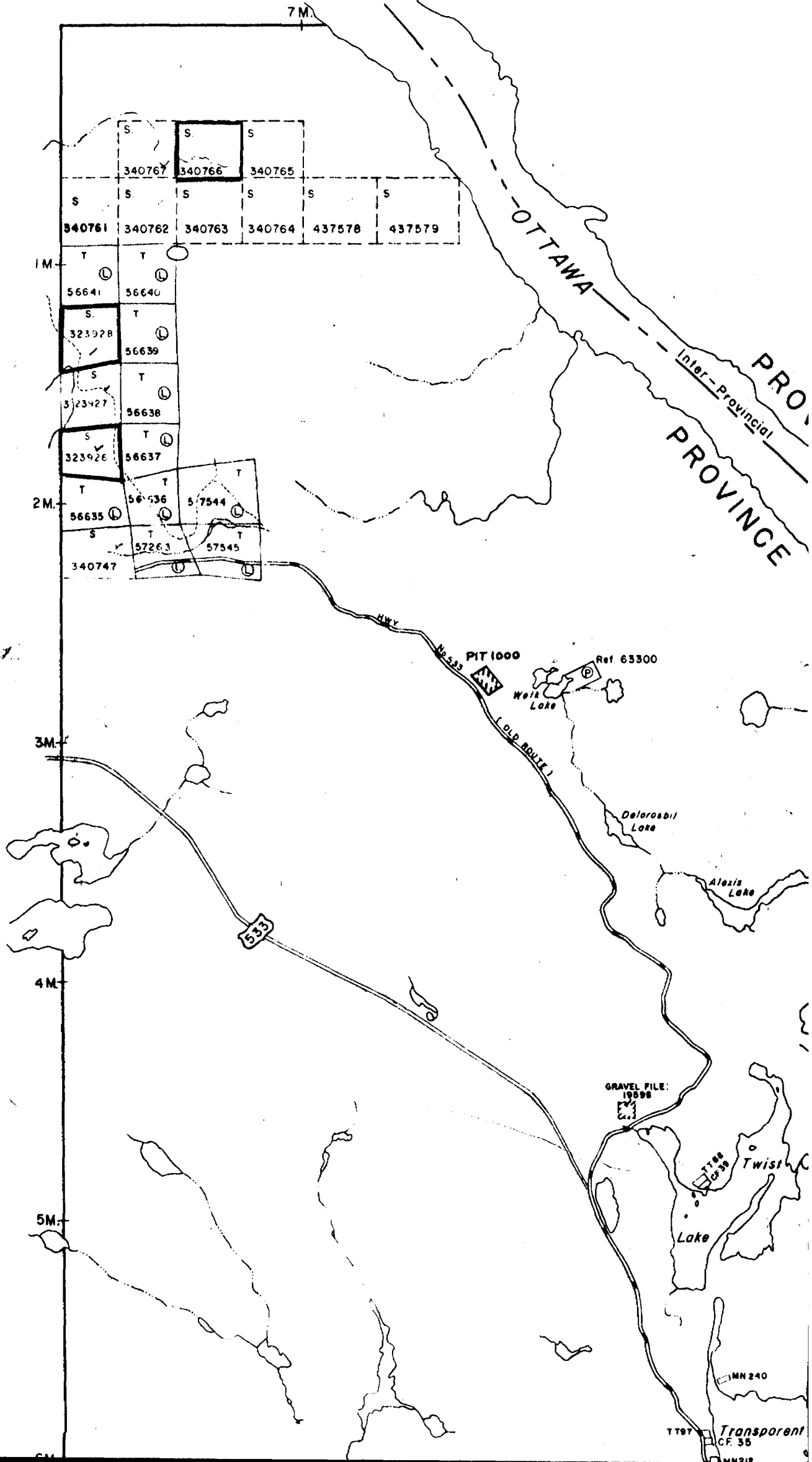

75

DIAMOND DRILL LOG

AN 0110 700  
5340766

COMPANY KYANITE MINING CORPORATION Page # one of four

PROPERTY Crocac Lake, Ontario ~~XXXXXX~~ Claim # 340766

PURPOSE OF HOLE Assessment Work and Structural Data

Start Oct. 14/75 Hole 6-75 Az. 125° Dip -45°

Finish Oct. 22/75 Lat. 53+30E Dep. 4+50N El.

Tests  Length 445

Footage		Description	Sample No.	Assays.
From	To			
0	37	Casino		
37	107.5	Sericite gneiss foliation 60-80° to CA. grey, greenish grey. Rare trace subhedral Py. 102-107.5 1-3% Py, rare CPY		
107.5	118.7	Garnetiferous Kyanite gneiss overall foliation 60-80° to CA. Details follow.		
		107.5-115 Two 2" Qtz, 80° to CA Est. 20-25% Ky.		
		115-125 Four 2" Qtz 80° to CA Est. 20-25% Ky		
		125-135 One 6", one 4" Qtz. 80° to CA. Est. 15%-20% Ky		
		135-145 One 9" Qtz 80° to CA One 4", Two 1" Qtz, 80° to CA Est. 15-20% Ky.		
		145-148.7 Three 1" Qtz.		
148.7	151	Biotite gneiss - Chloritic 5-8% Py. Conformable to preceding, contacts abrupt		
151	445	Garnetiferous kyanite gneiss foliation 60-80° to CA Details follow:		
		151-155 Est. 20-25% Ky.		
		155-165 One 4", four 2" Qtz, 70°-80° to CA, Est 15-20% Ky		

DRILLED BY: A. Lagrave LOGGED BY: Amblus

## DIAMOND DRILL LOG

COMPANY KYANITE MINING CORPORATION Page # two of four

PROPERTY Crocac Lake, Ontario ~~XXXXXX~~ Claim 340766

PURPOSE OF HOLE Assessment Work and Structural Data

Start Oct. 14/75 Hole 6-75 Az. 125° Dip -45°

Finish Oct. 22/75 Lat. 53+30 E Dep. 4+50 N El. \_\_\_\_\_

Tests \_\_\_\_\_ Length 445'

Footage		Description	Sample No.	Assays.	
From	To				
		165-175 One 4", three 1" Qtz 70° to CA Est. 12-15% fine KY			
		175-185 Three 1" Qtz. 80° to CA N.B. Kaolinized fault seam 5-0° to CA. at 178.2 Est. 12-15% Ky.			
		185-195 Est 12-15% Ky (fine)			
		195-205 Two 2", one 1" Qtz 80° to CA Est. 12-15% Ky (fine)			
		205-215 Two 6", three 2" Qtz 80° to CA. Est. 12-15% fine KY			
		215-225 One 3", two 1" Qtz. 80° to CA. Est. 8-12% Ky (fine)			
		225-235 Four 1" Qtz 80° to CA Est. 8-12% Ky (fine)			
		235-245 One 2" Qtz 70° to CA Est. 8-12% Ky (fine)			
		245-255 Two 1" Qtz N.B. at 254.5 Kaolinitic fault seam parallel to core axis Est. 8-12% fine KY.			
		255-265 Two 2" Qtz 60-80° to CA Est. 8-12% fine Ky. 20° fault seam at 257'.			
		265-275 Three 1" Qtz 70° to CA Est. 8-12% Ky.			
		275-285 One 2" Qtz. 80° to CA Est. 10-15% Ky			

DRILLED BY: A. Lagrave

LOGGED BY: AmBluis

COMPANY KYANITE MINING CORPORATION Page # THREE OF FOUR

PROPERTY Crocan Lake, Ontario ~~NXXXXXX~~ Claim # 340766

PURPOSE OF HOLE Assessment Work and Structural Data

Start Oct. 14/75 Hole 6-75 Az. 125° Dip -45°

Finish Oct. 22/75 Lat. 53+30 E Dep. 4+50 N El. \_\_\_\_\_

Tests \_\_\_\_\_ Length 445

Footage		Description	Sample No.	Assays.		
From	To					
		285-295 Two 1" Qtz 80° to CA Est. 10-15% Ky.				
		295-305 Est. 12-15% Ky.				
		305-315 One 8" Qtz, 80° to CA Est. 12-15% Ky.				
		315-325 Three 2" Qtz. 60-80° to CA. Est. 12-15% Ky.				
		325-335 One 12" three 2" Qtz 80° to CA Est. 12-15% Ky.				
		335-345 Three 2" Qtz 80° to CA Est. 8-12% Ky.				
		345-355 Two 1" Qtz, 80° to CA N.B. Intense fault zone and shearing from 247.8-251.2 80° to CA. Est. 8-12% Ky.				
		355-365 One 1" Qtz. 80° to CA Est. 8-12% Ky.				
		365-375 One 4", one 1" Qtz. 80° to CA Est. 8-12% Ky (locally coarse)				
		375-385 Est. 8-12% Ky.				
		385-395 One 4", two 1" Qtz. 80° to CA. Est. 8-12% Ky.				
		395-405 One 3", one 1" Qtz 80° to CA. Est. 8-12% Ky.				

DRILLED BY: A Lagrave LOGGED BY: Am Blain



76

ANTOINE TWR  
5323926

COMPANY KYANITE MINING CORPORATION Page # ONE

PROPERTY CROCAN LAKE N. T. S. # \_\_\_\_\_

PURPOSE OF HOLE ASSESSMENT WORK AND STRUCTURAL DATA

Start April 30/76 Hole 1-76 Az. --- Dip -90°

Finish May 5/76 Lat. \_\_\_\_\_ Dep. \_\_\_\_\_ El. \_\_\_\_\_

Tests \_\_\_\_\_ Length 144'

Footage		Description	Sample No.	Assays.	
From	To				
0	119	Kyanite gneiss, numerous garnets throughout.			
		0-10 foliation 60° to C.A. one 5" ankeritic str, est 12-15% Ky 0-10			
		10-20 as above one 2" ankeritic stringer 30° to CA est 12-15% Ky 10-20			
		20-30 as above, est 12-15% Ky			
		30-40 as above, est 12-15% Ky			
		40-50 as above, est 44-45 probable			
		fault zone considerable limonite and sericite. Est 12-15% Ky overall			
		50-60 as above, fault slip 40° to CA at 55. Est 12-15% Ky			
		60-70 as above, but 65-70 intensely sheared 40° to CA overall estimate 10-12% KY			
		70-80 as above, three 6" Qtz str contacts broken, three 1" Qtz str also 74-74.8 probable fault seam, only portley sericite recovered Est. 12-15% Ky			
		80-90 Two 6" Qtz str 70° to CA Est. 12-15% Ky			
		90-100 as above, est 12-15% Ky			

DRILLED BY: Jim Taylor

LOGGED BY: Ronald Elais *RMB*





77

ANTOINE TWP.  
S 323928

COMPANY KYANITE MINING CORPORATION Page # ONE

PROPERTY CROCAN LAKE N. T. S. # \_\_\_\_\_

PURPOSE OF HOLE ASSESSMENT WORK AND STRUCTURAL DATA

Start May 10/76 Hole 2-76 Az. 125° Dip -45°

Finish June 1/76 Lat. \_\_\_\_\_ Dep. \_\_\_\_\_ El. \_\_\_\_\_

Tests \_\_\_\_\_ Length 558'

Footage		Description	Sample No.	Assays.
From	To			
0	15	casing		
15	32.2	Pyritized biotite gneiss, foliation 60-80° to CA. Local concentrations of subhedral py to 10%. Considerable Chlorite from 19-32.2. 26.2-27 Ankeritic fault breccia 90°? to CA		
32.2	528.3	Garnetiferous Kyanite gneiss contact sharp 80° to CA		
		32.2 - 40 est. 8-12% Ky		
		40-50 est 8-12% Ky ±80° to CA		
		50-60 one 2" Qtz str 80° to CA Est. 8-12% Ky		
		60-70 Three 2" Qtz Strs. 80° to CA. Est 12-15% Ky		
		70-80 Est 12-15% Ky. Local coarse Ky laths		
		80-90 Est 12-15% Ky		
		90-100 One 2" Qtz Str rolling along core, also limonitic 30° fault at 97'. Est 8-12% Ky		
		100-110-110.5-101 Haematized fault zone 40° to CA. One 2" Qtz Str. 80° to CA. Est 10-12% Ky		
		110-120 Two 4", one 2" Qtz Strs 80° to CA. Est 12-15% Ky		

DRILLED BY: Jim Taylor LOGGED BY: Ronald Blais

*Ronald Blais*

DRILL LOG

COMPANY KYANITE MINING CORPORATION Page # TWO

PROPERTY CROCAN LAKE N. T. S. # \_\_\_\_\_

PURPOSE OF HOLE ASSESSMENT WORK AND STRUCTURAL DATA

Start May 10/76 Hole 2-76 Az. 125° Dip -45°

Finish June 1/76 Lat. \_\_\_\_\_ Dep. \_\_\_\_\_ El. \_\_\_\_\_

Tests \_\_\_\_\_ Length 558'

Footage		Description	Sample No.	Assays.
From	To			
		120-130 three 2" Qtz strs 80° to CA. Est 12-15% Ky		
		130-140 One 7", three 1" Qtz strs 80° to CA Est 12-15% Ky		
		140-150 Est 12-15% Ky 80° foliation		
		150-160 One 2" Qtz Str. 80° to CA. Est 12-15% Ky		
		160-170 Two 2" Qtz str. 80° to CA. Est 12-15% Ky		
		170-180 Est 12-15% Ky, 80° foliation		
		180-190 two 1" Qtz Strs. 80° to CA. Est 12-15% Ky		
		190-200 One 12", four 1" Qtz 60-80° to CA. Est 12-15% Ky		
		200-210 One 12" stringer section and two 2" Qtz strs, 80° to CA at 205 strong haematized fault seam 40°? to CA. Est 8-10% Ky		
		210-220 One 4", two 2" Qtz strs 80° to CA. Est 8-10% Ky		
		220-230 Est 10-12% Ky. Three 2" Qtz stringers. 80° to CA		
		230-240 One 4", three 1" Qtz 80° to CA. Est 12-15% Ky		
		240-250 Est 12-15% Ky. 80° foliation		

DRILLED BY: Jim Taylor LOGGED BY: Ronald Blais

## DIAMOND DRILL LOG

COMPANY KYANITE MINING CORPORATION Page # three

PROPERTY CROCAN LAKE N. T. S. # \_\_\_\_\_

PURPOSE OF HOLE ASSESSMENT WORK AND STRUCTURAL DATA

Start May 10/76 Hole 2-76 Az. 125° Dip -45°

Finish June 1/76 Lat. \_\_\_\_\_ Dep. \_\_\_\_\_ El. \_\_\_\_\_

Tests \_\_\_\_\_ Length 558'

Footage		Description	Sample No.	Assays.	
From	To				
		250-260 Est 12-15% Ky			
		260-270 One 4", two 2" Qtz Strs 80° to CA. Est 10-12% Ky			
		270-280 Est 8-10% Ky			
		280-290 Est 8-10% Ky			
		290-300 One 8" str. 80° to CA Est 8-10% Ky			
		300-310 Est 8-10% Ky			
		310-320 Est 12-15% Ky. 80-30° to CA			
		320-330 Est 10-12% Ky			
		330-340 One 12", three 1" Qtz strs. Est 8-10% Ky			
		340-350 One 3", two 1" Qtz Strs Est 12-15% Ky-Locally very coarse laths			
		350-360 Est 15-18% Ky, locally very coarse laths			
		360-370 One 3" Qtz. str. 80° to CA. Est 12-15% Ky			
		370-380 One 1" Qtz str. Est 10-12% Ky			
		380-390 Three 2" Qtz strs 90° to CA. Est 12-15% Ky			

DRILLED BY: Jim Taylor LOGGED BY: Ronald Blais

COMPANY KYANITE MINING CORPORATION

Page # four

PROPERTY CROCAN LAKE

N. T. S. #

PURPOSE OF HOLE ASSESSMENT WORK AND STRUCTURAL DATA

Start May 10/76

Hole 2-76

Az. 125° Dip -45°

Finish June 1/76

Lat.

Dep.

El.

Tests

Length 558'

Footage		Description	Sample No.	Assays.	
From	To				
		390-400 Two 2" Qtz strs. 90° to CA. Est 10-12% Ky			
		400-410 One 4", one 1" Qtz strs. ±80° to CA. Est 12-15% Ky			
		410-420 Est 12-15% Ky, 80° foliation			
		420-430 One 9" Qtz Str, 80° to CA. Est 12-15% Ky. locally coarsely bladed			
		430-440 Est 8-10% Ky			
		440-450 Two 2" Qtz strs. 80° to CA. Est 8-10% Ky			
		450-460 Est 8-10% Ky			
		460-462.5 Est 8-10% Ky			
		462.5-466.5 Highly sericitic, locally very silicious. Est 5% Ky. Locally Pyritic			
		466.5-470 as 460-462.5, est 8-10% Ky			
		470-475 Highly sericitic, intensely sheared ±80°? to CA. Est 5% Ky			
		475-485 Est 10-12% Ky			
		485-495 Est 8-10% Ky, One 4" Qtz Str 80° to CA			
		495-505 Est 8-10% Ky, foliation 70-80° to CA			

DRILLED BY: Jim Taylor

LOGGED BY: Ronald Blais

