



Township of ANTOINE

Report NO: 13

Work performed by: Kyanite Mining Corporation (Gene Dixon)

Claim NO	Hole NO	Footage	Date	Note
S 323928	1-75	400'	July/75	(1)
	2-75	702.2'	Aug/75	(1)
S 340762	3-75	362'	Sept/75	(1)
	4-75	561'	Sept/75	(2)
S 340766	5-75	117'	Oct/75	(2)

2 - Autositives enclosed

Notes:

(1) #82-75

(2) #107-75 Eddy and Butler Twps.

#75-82
GENE DIXON

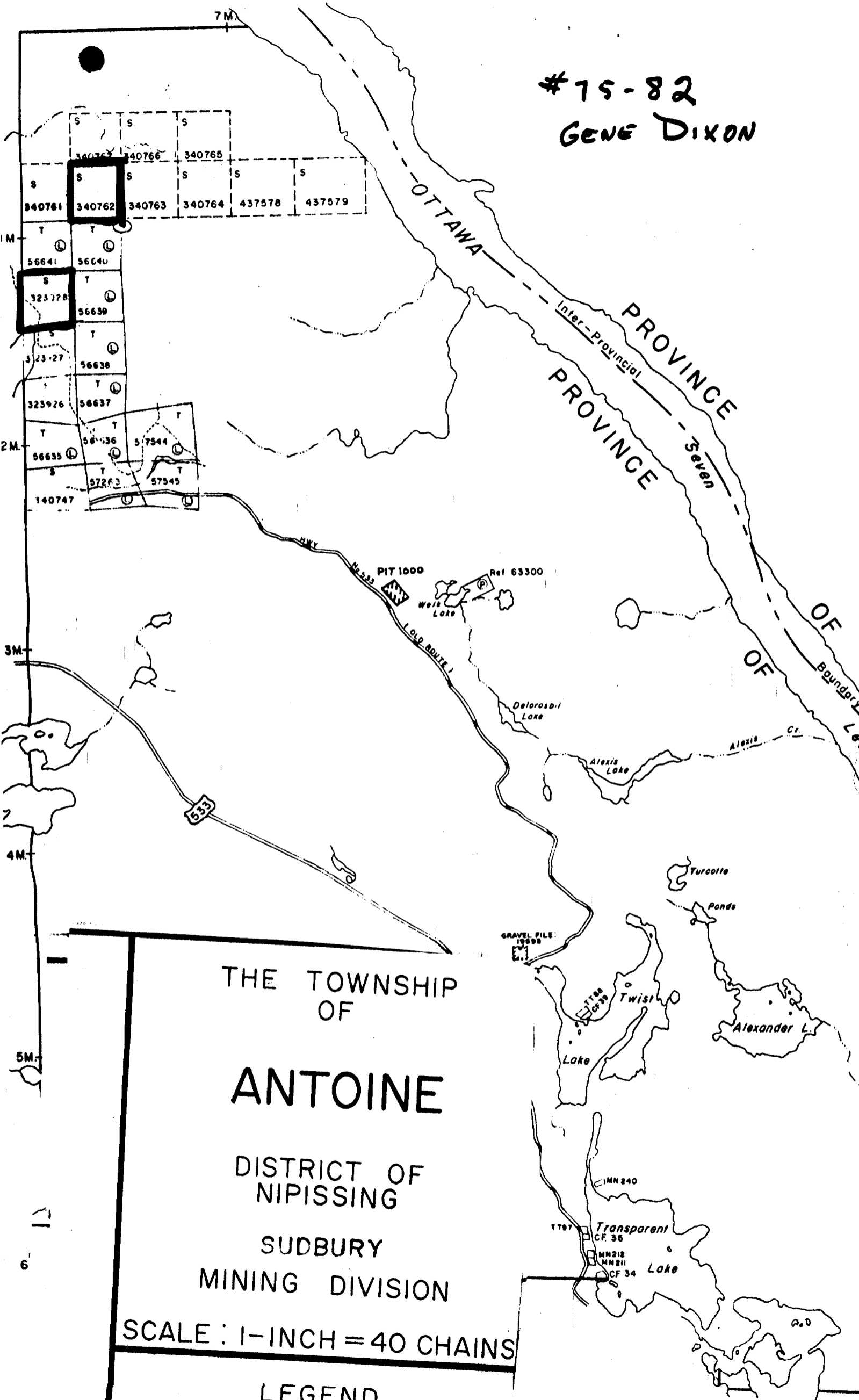

COMPANY KYANITE MINING CORPORATION

Page # one of four

PROPERTY Crocan Lake

Claim
~~XXXX~~ # 340762

PURPOSE OF HOLE Assessment Work and Structural Data

Start September 17, 1975 Hole 3-75 Az. --- Dip -90°

Finish September 24, 1975 Lat. 38+30 E Dep. 16+00 N El.

Tests AQ Wire Line Length 362

Footage		Description	Sample No.	Assays.	
From	To				
0	26	Casing			
26	66.3	Sericite gneiss, brownish grey moderately well bedded 70° to core axis (CA). Local minor subhedral to anhedral pyrite in rare quartz rich stringers to 2" conformable to bedding At 51' core shattered some calcite, probably fault zone ± 35° to CA 60.8-61.8 numerous conformable quartz rich stringers to 1" with minor fine garnets.			
66.3	74.3	Sericite gneiss, chloritic, with 3-5% pyrite-Subhedral to anhedral. Bedding ±70° to CA at 69 and 69.5 2" quartz carbonate stringers ±70° to CA with local coarse blebs of Py.			
74.3	121.2	Garnetiferous biotite gneiss 45° to CA details follow. 74.3-84 Intensely sericitized Est. 8-12% Ky 84-95 one 6", one 4" qtz. 70° to CA, Est. 12-15% Ky 95-105 two 6", one 4" qtz 50° to 80° to CA. Est. 15-20% Ky (locally very coarse blades)			

DRILLED BY: A. Lagrave

LOGGED BY: AmBlair

COMPANY KYANITE MINING CORPORATION

Page # two of four

PROPERTY Crocán Lake

Claim
XXXX # 340762

PURPOSE OF HOLE Assessment Work and Structural Data

Start September 17, 1975 Hole 3-75 Az. --- Dip -90°

Finish September 24, 1975 Lat. 38+30 E Dep. 16+00 N El.

Tests Length 362'

Footage		Description	Sample No.	Assays.	
From	To				
		105-121.2 Six 3" qtz. 45-80° to CA. Est. 8-12% Ky.			
121.2	132.5	Biotite gneiss-Chloritic, contact sharp 45° to CA. Fine subhedral Py throughout est 3-5% pyrite.			
132.5	362	Garnetiferous biotite gneiss with Kyanite- details follow			
		132.5-145, four 2" qtz 45-80° to CA Est 12-15% Ky			
		145-155 One 6" qtz, 70° to CA Est 12-15% Ky			
		155-165 Two 3" qtz, 45° to CA Est. 8-12% Ky			
		165-175 one 4", one 2" qtz. 45° to CA, Est. 8-12% Ky.			
		175-185 One 8", three 1" qtz. 60-80° to CA. Est. 15-20% Ky.			
		185-195 Two 10", one 7" qtz. 60-80° to CA. Est. 12-15% Ky			
		195-205 Two 5", one 3" qtz. 45-60° to CA. Est. 12-15% (fine) kyanite			
		205-215 One 4", two 2" qtz. 45-60° to CA. Est. 12-15% (fine) kyanite			

DRILLED BY: A. Lagrave

LOGGED BY: Amblain

COMPANY KYANITE MINING CORPORATION Page # THREE OF FOUR
 PROPERTY Crocán Lake /claim ~~XXXXX~~ # 340762

PURPOSE OF HOLE Assessment Work and Structural Data

Start September 17, 1975 Hole 3-75 Az. ---- Dip -90°
 Finish September 24, 1975 Lat. 38+30 E Dep. 16+00 N El.
 Tests Length 362

Footage		Description	Sample No.	Assays.		
From	To					
		215-225 One 2" qtz 35° to CA Est. 12-15% fine Ky				
		225-235 three 2" qtz. 45-60° to CA. Est. 12-15% fine Ky.				
		235-245 Two 3" qtz-irregular Est. 12-15% fine Ky				
		245-255 Minor qtz stringers Est. 12-15% fine Ky, 45° to CA				
		255-265 Minor qtz stringers Est. 12-15% fine Ky, 45° to CA				
		265-275 Minor qtz stringers Est. 12-15% fine Ky, 45° to CA				
		275-285 Minor qtz stringers Est. 12-15% fine Ky, 45° to CA				
		285-295 Minor qtz stringers Est. 12-15% fine Ky, 45° to CA				
		295-305 Est. 12-15% Ky. N.B. from 298-300.3 matrix is very coarse biotite with garnets				
		305-315 two 6", one 4", one 3" qtz 45° to CA. Est 12-15% fine ky				
		315-325 one 6", four 2", qtz 45-60° to CA. Est. 12-15% fine Ky.				

DRILLED BY: A. Lagrave LOGGED BY: Amblair

COMPANY KYANITE MINING CORPORATION

Page # FOUR OF FOUR

PROPERTY Crocan Lake

Claim
NXXS# # 340762

PURPOSE OF HOLE Assessment Work and Structural Data

Start September 17, 1975

Hole 3-75

Az. ---

Dip -90°

Finish September 24, 1975

Lat. 38+30 E

Dep. 16+00 N

El.

Tests

Length 362

Footage		Description	Sample No.	Assays.		
From	To					
		325-335 three 2" qtz 45-60° to CA. Est. ±15% Ky, locally coarse				
		335-345 one 5", one 4", two 2" qtz, 45-60° to CA. Est 15-20% fine Ky.				
		345-355 One 2" qtz, 60° to CA Est. 18-25% Ky locally very coarse.				
		355-362 one 6", one 2", one 1" qtz, ±60° to CA. Est. 15-20% fine Ky.				
		END OF HOLE 362'				

DRILLED BY: A. Lagrave

LOGGED BY: Am Blair

COMPANY KYANITE MINING CORPORATION Page # one of five

PROPERTY Crocan Lake Claim XXXXX. # 323928

PURPOSE OF HOLE Assessment Work and Structural Data

Start July 23, 1975 Hole 1-75 Az. --- Dip -90°

Finish August 23, 1975 Lat. 10+00 E Dep. 12+00 N El.

Tests AQ Wire Line Length 400'

Footage		Description	Sample No.	Assays.	
From	To				
0	7	AQ Casing			
7	29.5	Sericite gneiss, brownish grey well bedded 70° to core axis (CA) local minor anhedral pyrite streaks & patches to 1/2" in quartz rich bands to 2" conformable to shearing at 17.5' weak open fault seam, 20° to CA trace marcasite 17'-24' moderately chloritic.			
29.5	52.9	Sharp contact 70° to CA sericite gneiss, massive, distinctly brown colour (biotite?) 37.7-38.5 pegmatite dyke - salmon coloured feldspar, quartz, muscovite and minor iron rich garnets to 1/8". Contacts irregular but appears to be about 70° to CA. 39.2'-52.9' 70% quartz "breccia" material in brownish sericite. The quartz is in subangular to well rounded "areas" throughout the core, and is milk white.			

DRILLED BY: B. Laporte & A. Lagrave LOGGED BY: AM Blais

COMPANY KYANITE MINING CORPORATION Page # two of five

PROPERTY Crocan Lake Claim ~~XXXX~~ # 323928

PURPOSE OF HOLE Assessment Work and Structural Data

Start July 23, 1975 Hole 1-75 Az. --- Dip -90°

Finish August 23, 1975 Lat. 10+00 E Dep. 12+00 N El.

Tests Length 400'

Footage		Description	Sample No.	Assays.	
From	To				
52.9	91.4	Abrupt change - sericite gneiss, pale/dark grey well banded at 70° to CA.			
		87.5-90 strong open fault seam 5° to CA Coated with marcasite			
		90.8-91.4 "quartz breccia" as 39.2-52.9			
91.4	122	Sericite gneiss, massive, no banding, as 29.5-52.9, 115-122 40% quartz breccia			
122	171.8	Abrupt colour change to dark grey sericite gneiss, massive foliation 80° to CA 149.3' strong open fault 20° to CA lined with calcite.			
171.8	179.5	Sharp contact 50° to CA slight colour change to paler grey. Local minor fine pyrite 172.8-173.5 10% anhedral pyrite in massive irregular blebs.			
179.5	184.7	Abrupt increase in chlorite with accompanying local minor anhedral PY, (< 1% PY overall) local subhedral pyrrhotite and rare traces of chalcopyrite (CPY) Foliation at ± 80° to CA			

DRILLED BY: B. Laporte & A. Lagrave LOGGED BY: AMBla

COMPANY KYANITE MINING CORPORATION Page # THREE OF FIVE

PROPERTY Corcan Lake Claim XXX.XXX.XX # 323928

PURPOSE OF HOLE Assessment Work and Structural Data

Start July 23, 1975 Hole 1-75 Az. --- Dip -90°

Finish August 23, 1975 Lat. 10+00 E Dep. 12+00 N El.

Tests Length 400'

Footage		Description	Sample No.	Assays.	
From	To				
184.7	195	Sericite gneiss, grey as 171.8-179.5 Foliation $\pm 80^\circ$ to CA			
195	197.5	Siliceous breccia zone 60° to CA			
197.5	203.4	Massive grey sericite gneiss to 199, then gradual increase in pale grey to cream carbonate bands, not well defined, but $\pm 80^\circ$ to CA			
203.4	207	Abundant fine to coarsely anhedral PY, estimated 5-8% disseminated throughout orientation $\pm 70^\circ$ to CA chloritic			
207	217	Grey sericite schist as 197.5-203.4 Fault seam 30° CA at 213.6			
217	218.6	Becoming banded with chlorite and local incipient PY 70° to 80° to CA			
218.6	221.2	Major fault 30° to CA no clay gouge, but 18" of grey roft material may be indur- ated gouge, or possible a dyke.			
221.2	225	Well banded (chlorite) at 80° to CA with local streaky PY			

DRILLED BY: B. Laporte & A. Lagrave LOGGED BY: Amblin

COMPANY KYANITE MINING CORPORATION

Page # Four of Five

PROPERTY Crocan Lake

Claim
~~XXXX~~ # 323928

PURPOSE OF HOLE Assessment Work and Structural Data

Start July 23, 1975 Hole 1-75 Az. --- Dip -90°

Finish August 23, 1975 Lat. 10+00 E Dep. 12+00 N El.

Tests Length 400'

Footage		Description	Sample No.	Assays.
From	To			
225	244.4	Dark grey sericite gneiss, weakly banded 70-90° to CA		
244.4	255.2	Becoming abruptly chloritic with locally abundant PY at 297.2 strong open fault seam 20° to CA		
255.2	261.9	Major fault 30°? to CA 255.2-256.3 strong intensely haematized carbonate vein considerably brecciated. 256.3-261.9 core shattered and intensely haematized. Probably a dyke fault, local sections of carbonate breccia.		
261.9	265	Well banded 80° to CA with chlorite and local subhedral PY		
265	328	Above is gradational over 2" with grey, weakly banded sericite gneiss. 80° to CA Rare intensely sericitic sections and occasional conformable quartz carbonate stringers to 1/2".		
328	337	Abruptly more chloritic and darker, with fine subhedral PY and local streaks and segregations est. 3-5% PY		

DRILLED BY: B. Laporte & A. Lagrave

LOGGED BY: Ann Blais

COMPANY KYANITE MINING CORPORATION

Page # FIVE OF FIVE

PROPERTY Crocan Lake

Claim
XXXXXX# 323928

PURPOSE OF HOLE Assessment Work and Structural Data

Start July 23, 1975 Hole 1-75 Az. --- Dip -90°

Finish August 23, 1975 Lat. 10+00 E Dep. 12+00 N El. ---

Tests --- Length 400'

Footage		Description	Sample No.	Assays.	
From	To				
337	342.1	Intense major fault, considerable grey gouge, angle appears to be $\pm 70^\circ$ to CA but core is badly shattered overall foliation $70-80^\circ$ to CA			
342.1	400	Garnetiferous biotite gneiss with fine to coarse blady kyanite $70-80^\circ$ to CA and numerous garnets to $\frac{1}{2}$ "			
		342.1-345 Minor Ky 80% sericite			
		345-355 8-10% Ky one 4", two 1" Qtz stringers, 70° to CA loc PY			
		355-365 10-12% Ky, one 6", three $\frac{1}{2}$ " Qtz stringers, 60° to CA			
		365-375 8-10% KY, two $\frac{1}{2}$ " Qtz. stringers, 60° to 80° to CA			
		375-385 10-12% Ky three 2" Qtz Stringers $60-80^\circ$ to CA			
		385-395 12-15% Ky two 2", two 1" Qtz Stringers 40° fault 393.8			
		395-400 10-12% Ky			
		End of Hole 400'			

DRILLED BY: B. Laporte & A. Lagrave

LOGGED BY: AmBlair

COMPANY KYANITE MINING CORPORATIONPage # one of sevenPROPERTY Crocan LakeClaim
NXXS. # 323928PURPOSE OF HOLE Assessment Work and Structural DataStart August 23, 1975Hole 2-75Az. 125° Dip -45°Finish September 12, 1975Lat. 10+00 EDep. 12+00 NEl. 1131.4

Tests

AQ Wire Line

Length 702.2

Footage		Description	Sample No.	Assays.
From	To			
0	8	Casing		
8	88.5	Sericite gneiss, brownish grey well bedded $\pm 70^\circ$ to core axis (CA). Local minor streaky PY, conformable to bedding planes ($< \frac{1}{2}\%$ PY) 33.7-38 Pegmatitic dyke material, in bands to 12". Pink feldspar, sericite, quartz, minor marcasite on slips. Contacts irregular, est. $\pm 70^\circ$ to CA. 38-47 two 12", four 2" quartz rich stringers, milk white to smokey brown, $\pm 70^\circ$ to CA. 47-63 Well bedded 70° to CA, paler brown, with streaky quartz rich bands, and "breccia" zones, 48.7-49.5, 53.2-55. 63-88.5 Grey-brown sericite gneiss, weakly bedded $70-80^\circ$ to CA rare subhedral Pyrrhotite (PO) blebs to 1/8". Quartz rich sections 77-78, 85.3-87 $\pm 70^\circ$ to CA. Open fault at 81.5, plated with PY, marcasite, 30° to CA.		
88.5	99.7	Major fault zone. Intense brecciation, haematization 89.6-90.5 and 96.5-96.7 intensely haematized carbonate breccia veins contacts irregular. (N.B. This is the same Fault intersected by 1-75 from 255.2-261.9) $\frac{1}{2}$ " of indurated gouge at 99.7 ($\pm 35^\circ$ to CA)		

DRILLED BY: A. LagraveLOGGED BY: Jim Blum

COMPANY KYANITE MINING CORPORATION

Page # two of seven

PROPERTY Crocan Lake

Claim ~~XXXX~~ # 323928

PURPOSE OF HOLE Assessment Work and Structural Data

Start August 23, 1975 Hole 2-75 Az. 125° Dip -45°
 Finish September 12, 1975 Lat. 10+00 E Dep. 12+00 N El. 1131.4

Tests _____ Length 702.2

Footage		Description	Sample No.	Assays.	
From	To				
99.7	127	Grey, weakly banded sericite gneiss, 70-80° to CA. Relatively quartz rich, with patchy stringers to 2" locally weakly mineralized with sparse subhedral PY.			
127	138	Less siliceous than previous unit, but gradational contacts, much more chloritic, with local streaks of PY and marcasite (<½% PY overall)			
138	158	Grey-brown, poorly bedded ± 70° to CA At 156, open fault slip parallel to core axis. Lined with marcasite.			
158	199	Much paler grey-brown, becoming locally pyritic from 177 with finely disseminated to anhedral streaky massive ½" 70-80° to CA. -locally to 3-5% Py over 1'			
199	212.5	Major fault zone, highly haematized, with numerous fault slips 30-60° to CA.			
212.5	220	Chloritic, with local highly pyritic sections 213-214 and 218-219 up to 20% as fine subhedral segregations. N.B. at 216.5 strong fault 45° to CA with ½" grey gouge.			

DRILLED BY: A. Lagrave

LOGGED BY: Am. Blaw

COMPANY KYANITE MINING CORPORATION Page # three of seven

PROPERTY Crocan Lake Claim ~~XX.XX.XX~~ # 323928

PURPOSE OF HOLE Assessment Work and Structural DATA

Start August 23, 1975 Hole 2-75 Az. 125° Dip -45°

Finish September 12, 1975 Lat. 10+00 E Dep. 12+00 N El. 1131.4

Tests _____ Length 702.2

Footage		Description	Sample No.	Assays.	
From	To				
220	258	as 158-199, pale grey brown with local quartz stringers to 1" at 70-80° to CA, and sparse streaky anhedral PY.			
258	258.4	Major fault seam - carbonate breccia, ±70° ? to CA			
258.4	276.5	Much more chloritic - (N.B. this appears to be the same as 328-337 in 1-75) with 3-5% PY disseminations locally. Weakly bedded, 70-80° to CA			
276.5	331	Garnetiferous biotite gneiss with fine to coarse blady kyanite-contact 70° to CA			
		276.5-280 80% sericite minor Ky. One 4" Qtz stringer contacts irregular several quartz blebs to 1". Est <3% Ky.			
		280-290 One 12" five 3" Qtz veinlets 60-80° to CA Est. 10% Kyanite.			
		290-300 Garnets much more numerous no quartz stringers Est. 10% Ky			
		300-310 One 8", one 6", one 2", Qtz stringers, 80° to CA Est. 10-15% Ky.			
		310-320 One 7", One 5", two 1" qtz stringers 80-40° to CA Est 12-15% Ky- locally very coarse, to ½" blades.			

DRILLED BY: A. Lagrave

LOGGED BY: AmBlair

COMPANY KYANITE MINING CORPORATIONPage # four of sevenPROPERTY Crocan LakeClaim
~~XXXXX~~ # 323928PURPOSE OF HOLE Assessment Work and Structural DataStart August 23, 1975Hole 2-75Az. 125° Dip -45°Finish September 12, 1975Lat. 10+00 EDep. 12+00 N El. 1131.4

Tests

Length 702.2

Footage		Description	Sample No.	Assays.	
From	To				
		320-330 One 1" qtz stringer Est. 12-15% Ky.			
		330-331 Est. 8% Ky			
331	335.1	Dark grey biotite gneiss con- tacts broken, $\pm 70^\circ$ to CA. Finely pyritic, with local concentrations to 20% over 4"			
335.1	702.2	Garnetiferous biotite gneiss with varying amounts of Ky as 276.5-331			
		335.1-345 One 5", two 2" qtz stringers $\pm 70^\circ$ to CA N.B. at 336.6 slickensided fault plane 60° to CA. Est. 10-15% Ky.			
		345-355 two 3", one 2"? qtz in fault breccia 350-351.5. Fault angle obscure, may be 30° to CA. Local minor chalc- pyrite and PY in the fault BX. Est 10-15% Ky			
		355-365 Five 2" qtz stringers $\pm 80^\circ$ to CA. Est 15-20% Ky			
		365-375 One 5", four 2" qtz stringers, $60-80^\circ$ to CA. Est. 15-20% Ky.			
		375-385 two 2" qtz stringers 80° to CA Est. 20-25% Ky			

DRILLED BY: A. LagraveLOGGED BY: Amblair

COMPANY KYANITE MINING CORPORATION

Page # five of seven

PROPERTY Crocan Lake

Claim
XXXXXX# 323928

PURPOSE OF HOLE Assessment Work and Structural Data

Start August 23, 1975

Hole 2-75

Az. 125° Dip -45°

Finish September 12, 1975

Lat. 10+00 E

Dep. 12+00 N El. 1131.4

Tests

Length 702.2

Footage		Description	Sample No.	Assays.	
From	To				
		385-395 Four ½" qtz stringers Est. 20-25% Ky.			
		395-405 One 9", two 1" Qtz stringers. Est 20% Ky.			
		405-415 Local patchy qtz. Est 15-20% Ky.			
		415-425 Six 1" qtz. stringer Est. 15-20% Ky.			
		425-435 Three 1" qtz. stringers Est. 15-20% Ky.			
		435-445 Two 2", two 1" qtz. stringers. Est 15-20% Ky			
		445-455 one 4" Est. 20-25% Ky.			
		455-465 Six 1" qtz. stringers ± 80° to CA. Est 15-20% Ky			
		465-475 one 6", two 4" qtz. stringers Est. 15% Ky			
		475-485 one 4" qtz. stringers two 3" Est. 10-15% Ky			
		485-495 One 4", two 2" qtz stringers Est. 10-15% Ky			
		495-505 Siliceous! Est 10-15% Ky.			
		505-515 One 4", three 1" qtz stringers Est. 10-15% Ky			

DRILLED BY: A. Lagrave

LOGGED BY: AmBlair

COMPANY KYANITE MINING CORPORATION

Page # six of seven

PROPERTY Crocan Lake

Claim
NXXRX# 323928

PURPOSE OF HOLE Assessment Work and Structural Data

Start August 23, 1975

Hole 2-75

Az. 125° Dip -45°

Finish September 12, 1975

Lat. 10+00 E

Dep. 12+00 N El. 1131.

Tests

Length 702.2

Footage		Description	Sample No.	Assays.	
From	To				
		515-525 Est. 10-15% Ky			
		525-535 two 4", one 1" qtz. stringers Est. 10-15% Ky.			
		535-545 one 4", one 2" qtz. stringers 80° to CA Est. 15-20% Ky.			
		545-555 one 2", seven ½" qtz. stringers ± 80° to CA. Est. 15-20% Ky.			
		555-565 One 10", one 4" qtz stringer, ± 80° to CA. Est ± 15% Ky			
		565-575 two 4", three 1" qtz. stringers, 80° to CA, Est. 12-15% Ky.			
		575-585 Seven 1" qtz. stringers. Est. 15-20% Ky.			
		585-595 One 6", two 2" qtz. stringers. Est 15-20% Ky.			
		595-605 Seven 1", one 2" qtz stringers. Est 15-20% Ky.			
		605-615 One 6", two 1" qtz stringers. Est. 15-20% Ky			
		615-625 One 2", four 1" qtz stringers. Est. 15-20% Ky.			
		625-635 Three 1" qtz stringers 80° to CA. Est. 15-20% Ky.			

DRILLED BY: A. Lagrave

LOGGED BY: Am Blas

COMPANY KYANITE MINING CORPORATION Page # seven of seven

PROPERTY Crocac Lake ~~XXXXXX~~ # Claim #323928

PURPOSE OF HOLE Assessment Work and Structural Data

Start August 23, 1975 Hole 2-75 Az. 125° Dip -45°

Finish September 12, 1975 Lat. 10+00 E Dep. 12+00 N El. 1131.4

Tests _____ Length 702.2

Footage		Description	Sample No.	Assays.	
From	To				
		635-645 Four 1" qtz. stringers 80° to CA Est. 15-20% Ky.			
		645-655 - 645-646 core shattered, pass fault zone. One 7", one 3" Qtz. 80° to CA. Est. 15-20% Ky.			
		655-665 One 4", three 1" qtz. stringers 90° to CA. Est. 15-20% Ky.			
		665-675 One 4" qtz. 80° to CA Est. 15-20% Ky.			
		675-685 One 4", two 1" qtz. stringers, 90° to CA. Est. 25% Ky.			
		685-695 One 12" qtz carb. 30° to CA Est. 25% Ky.			
		695-697.5 One 4" irregular qtz. carb. est. 15-20% Ky.			
		697.5 - 700 Marked decrease in Ky traces subhedral Py. 2" qtz. 90° to CA with Ky. blades within it. (uncommon) Est. 10-15% Ky.			
		700-702.2 ± 10% Ky. Fault slip with gouge 702.2 at 80° to CA.			
		END OF HOLE 702.2'			

DRILLED BY: A. Lagrave

LOGGED BY: DM Blair

THE TOWNSHIP
OF

ANTOINE

DISTRICT OF
NIPISSING

SUDBURY

MINING DIVISION

SCALE : 1-INCH = 40 CHAINS

Eddy Twp.-M. 778

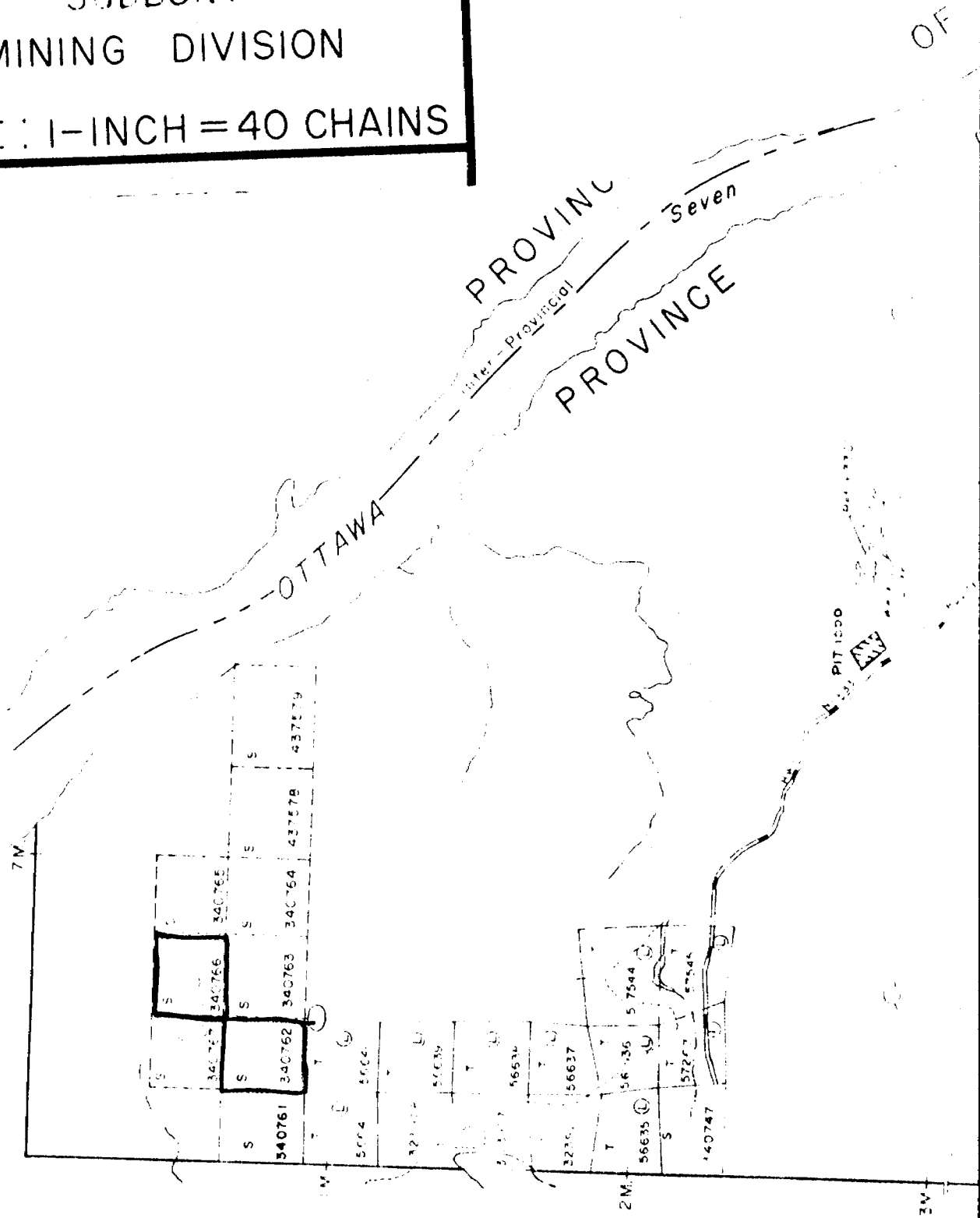

ler Twp.-M. 693

EDDY + BUTLER TWP'S.

107 - 75

GENE DIXON

COMPANY KYANITE MINING CORPORATION

Page # one of five

PROPERTY Crocan Lake

~~XXXXXXX~~ Claim #340762

PURPOSE OF HOLE ASSESSMENT WORK AND STRUCTURAL DATA

Start Sept. 24, 1975

Hole 4-75

Az. 125° Dip -45°

Finish Oct. 3, 1975

Lat. 38+30E

Dep. 16+00 N El.

Tests

Length 561'

Footage		Description	Sample No.	Assays.	
From	To				
0	35	Casing			
35	50.4	Sericite/biotite gneiss, grey green, locally well bedded 90° to CA. Sparce anhedral streaks of pyrite to 1/8" usually at the contacts of occasional Qtz. carb. sts to 2". 43-50.4 highly chloritic with 3-5% Py.			
50.4	79.4	Garnetiferous biotite gneiss 80-90° to CA. Kyanite throughout. details follow. 50.4-60 Est. 12-15% Ky. N.B. 50.4-53.5 intensely sericitic with local streaks of anhedral pyrite to 1/8" 60-70 Two 1" Qtz. 80° to CA Est. 12-15% Ky. 70-79.4 One 2" Qtz 80° to CA Est. 8%-12%Ky (fine)			
79.4	86	Intensely chloritic, 10-25% anhedral pyrite no Ky seen. Contacts sharp, 85° to CA			
86		Garnetiferous biotite gneiss as 50.4-79. 80-90° bedding Ky throughout, details follow			

DRILLED BY: A. Lagrave

LOGGED BY: AmBluz

COMPANY KYANITE MINING CORPORATION Page # two of five

PROPERTY Crocán Lake ~~XXXXXXXXXX~~ Claim #340762

PURPOSE OF HOLE Assessment Work and Structural Data

Start Sept. 24/75 Hole 4-75 Az. 125° Dip -45°

Finish Oct. 3/75 Lat. 38+30 E Dep. 16+00 N El. _____

Tests _____ Length 561'

Footage		Description	Sample No.	Assays.	
From	To				
		86-95 Four 2" Qtz. $\pm 80^\circ$ to CA Est. $\pm 15\%$ Ky locally coarse			
		95-105 Est 12-15% Ky (fine)			
		105-115 Est 12-15% Ky (fine)			
		115-125 Est. 12-15% Ky (fine)			
		125-135 Est. 12-15% Ky (fine)			
		135-145 One 12" two 2" Qtz 85° to Ca. Est. 12-15% Ky (fine- med grain)			
		145-155 One 7" three 2" Qtz. 85° to Ca Est. 12-15% Ky (fine)			
		155-165 Three 1" Qtz. 90° to CA. Est. 12-15% Ky. (fine)			
		165-175 Four 2" Qtz 90° to Ca Est. 12-15% Ky (fine)			
		175-185 One 3" two 1" Qtz 85° to CA Est. 12-15% Ky - fine N.B. at 177 strong limonitic fault parallel to core axis.			
		185-195 four 1" Qtz, 90° to CA Est. 12-15% Ky - (fine)			
		195-205 One 2" one 5" Qtz 80° to CA Est. 12-15% Ky (fine)			
		205-215 One 2" Qtz, Est. 12-15% Ky - fine.			

DRILLED BY: A. Lagrave

LOGGED BY: AMBlus

COMPANY KYANITE MINING CORPORATION

Page # three of five

PROPERTY Crocan Lake

~~XXXXXX~~ Claim #340762

PURPOSE OF HOLE Assessment Work and Structural Data

Start Sept. 24/75

Hole 4-75

Az. 125° Dip -45°

Finish Oct. 3/75

Lat. 38+30 E

Dep. 16+00 N El.

Tests

Length 561'

Footage		Description	Sample No.	Assays.	
From	To				
		215-225 Five 1", one 6" Qtz ±80° to CA. Est. 12-15% Ky fine			
		225-235 Three 2" Qtz. ±80° to CA Est. 12-15% Ky - Fine			
		235-245 One 9", three 1" Qtz. ±90° to CA Est 12-15% Ky fine			
		245-255 One 3" Qtz 90° to CA Est. 12-15% Ky (fine)			
		255-265 One 2", one 1" Qtz. 90° to CA. Est 12-15% Ky (fine)			
		265-275 One 2" Qtz. ±50° to CA Est. 12-15% Ky (locally coarse)			
		275-285 One 3", Five 2" Qtz. 80° to CA Est. 12-15% Ky.			
		285-295 Est. 12-15% Ky.			
		295-305 One 2" Qtz. 80° to CA Est. 8-12% Ky.			
		305-315 one 1" Qtz; 80° to CA One 12" Qtz 90° to CA. Est. 8-12% Ky.			
		315-325 One 4" Qtz. 80° to CA Est. 8-12% Ky. N.B. Limonitic Fault seam at 322 ±10° to CA			
		325-335 One 6", one 3" Qtz, ±90° to CA. Est 8-12% Ky.			

DRILLED BY: A. Lagrave

LOGGED BY: Am Blas

COMPANY KYANITE MINING CORPORATION Page # four of five

PROPERTY Crocan Lake ~~XXXXXX~~ Claim #340762

PURPOSE OF HOLE Assessment Work and Structural Data

Start Sept. 24/75 Hole 4-75 Az. 125° Dip -45°

Finish Oct. 3/75 Lat. 38+30 E Dep. 16+00 N El. _____

Tests _____ Length 561'

Footage		Description	Sample No.	Assays.	
From	To				
		335-345 Four 3", one 2" Qtz 80° to CA. Est 8-12% Ky.			
		345-355 One 4", three 2", two 1" Qtz. 80-90° to CA. Est. 8-12% Ky.			
		355-365 Two 2", two 1" Qtz. 90° to CA Est. 8-12% Ky.			
		365-375 Two 3", one 2", one 1" Qtz 90° to CA. Est 8-12% Ky			
		375-385 One 4", two 1" Qtz. 80° to CA, Est. 8-12% Ky.			
		385-395 One 6", four 3", one 1" Qtz. 80-90° to CA. Est. 8-12% Ky.			
		395-405 One 12", two 3", two 1", 80-90° to CA. Est. 12-15% Ky. (locally coarse) N.B. some Ky in the Qtz, which is uncommon)			
		405-415 Two 3" Qtz 80° to CA Est. 12-15% Ky (locally coarse)			
		415-425 Est ±15% Ky. (locally coarse) Foliation +90° to CA			
		425-435 Two 3" Qtz ±80° to CA Est. 15-20% Ky (locally coarse)			
		435-445 Est 20-25% Ky. (locally coarse) traces Py locally			
		445-455 Est 20-25% Ky locally coarse. Two 2" Qtz. 80-90° to CA			

DRILLED BY: A. Lagrave

LOGGED BY: AmBlus

COMPANY KYANITE MINING CORPORATION Page # five of five

PROPERTY Crocac Lake ~~XXXXXX~~ Claim #340762

PURPOSE OF HOLE Assessment Work and Structural Data

Start Sept. 24/75 Hole 4-75 Az. 125° Dip -45°

Finish Oct. 3/75 Lat. 38+30 E Dep. 16+00 N El. _____

Tests _____ Length 561'

Footage		Description	Sample No.	Assays.	
From	To				
		455-465 Est. 20-25% Ky (locally coarse)			
		465-475 One 4" Qtz ±80° to CA Est. 20-25% Ky (locally coarse)			
		475-485 Est. 20-25% Ky.			
		485-495 Est 20-25% Ky			
		495-505 One 2" Qtz. 80° to CA Est. 20-25° Ky (locally coarse)			
		505-515 One 4" Qtz. (±Ky) Est. 25-30% Ky (locally coarse)			
		515-525 Marked increase in biotite two seams of anhedral Py ± 90° to CA. Est. 20-25% Ky.			
		525-535 Est. 20-25% Ky. (locally coarse) N.B. 525-526 strong sericitic fault shear ±80°? to CA.			
		535-545 Est 15-20% Ky. locally sericitic			
		545-555 Three 1" Qtz. ±80° to CA. Est. 15-20% Ky.			
		555-561.3 Est. 15-20% Ky.			
		END OF HOLE 561.3			

DRILLED BY: A. Lagrave

LOGGED BY: Am Blas

DIAMOND DRILL LOG

COMPANY KYANITE MINING CORPORATION Page # one of one
 PROPERTY Crocac Lake, Ontario ~~XXXXXX~~ Claim # 340766
 PURPOSE OF HOLE Assessment Work and Structural Data

Start Oct. 8/75 Hole 5-75 Az. Dip -90°
 Finish Oct. 10/75 Lat. 55+20 E Dep. 6+80 N El.
 Tests Length 117 ft.







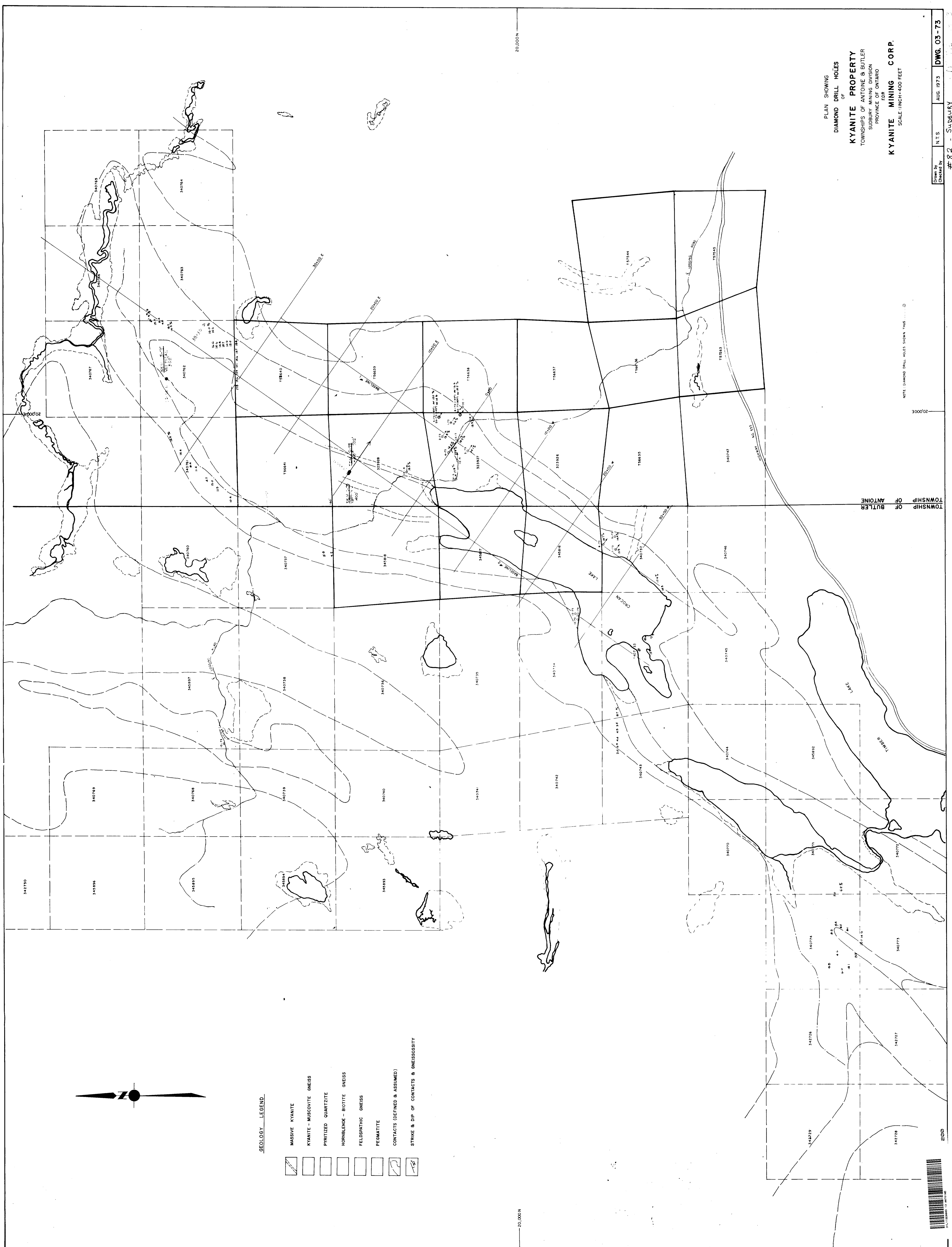

Footage		Description	Sample No.	Assays.
From	To			
0	8	Casing		
8	117	Biotite gneiss 50° to CA Locally sericitic, with some local PY. 59.5-62.0 Pink Pegmatitic vein dyke 80°? to CA		
		99-117 Intensely broken up core Probable fault zone.		
		Hole abandoned at 117'		
		END		

DRILLED BY: A. Lagrave LOGGED BY: AmBlais

PLAN SHOWING
 DIAMOND DRILL HOLES
 OF
KYANITE PROPERTY
 TOWNSHIPS OF ANTOINE & BUTLER
 SUBURB MINING DIVISION
 PROVINCE OF ONTARIO
KYANITE MINING CORP.
 SCALE 1/4"=400 FEET

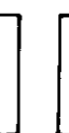

GEOLOGY LEGEND

-  MASSIVE KYANITE
-  KYANITE - MUSCOVITE GNEISS
-  PYRITIZED QUARTZITE
-  HORNBLende - BIOTITE GNEISS
-  FELDSPATHIC GNEISS
-  PEGMATITE
-  CONTACTS (DEFINED & ASSUMED)
-  STRIKE & DIP OF CONTACTS & GNEISSOSITY

NOTE: DIAMOND DRILL HOLES SHOWN THUS: ○



PLAN SHOWING
DIAMOND DRILL HOLES
OF
KYANITE PROPERTY
TOWNSHIPS OF ANTOINE & BUTLER
SUBBURY MINING DIVISION
PROVINCE OF ONTARIO
FOR
KYANITE MINING CORP.
SCALE: 1 INCH = 400 FEET

Drawn by
Checked by
N.T.S.
AUG. 1973
DWG. 03-73
#107 - Suburban

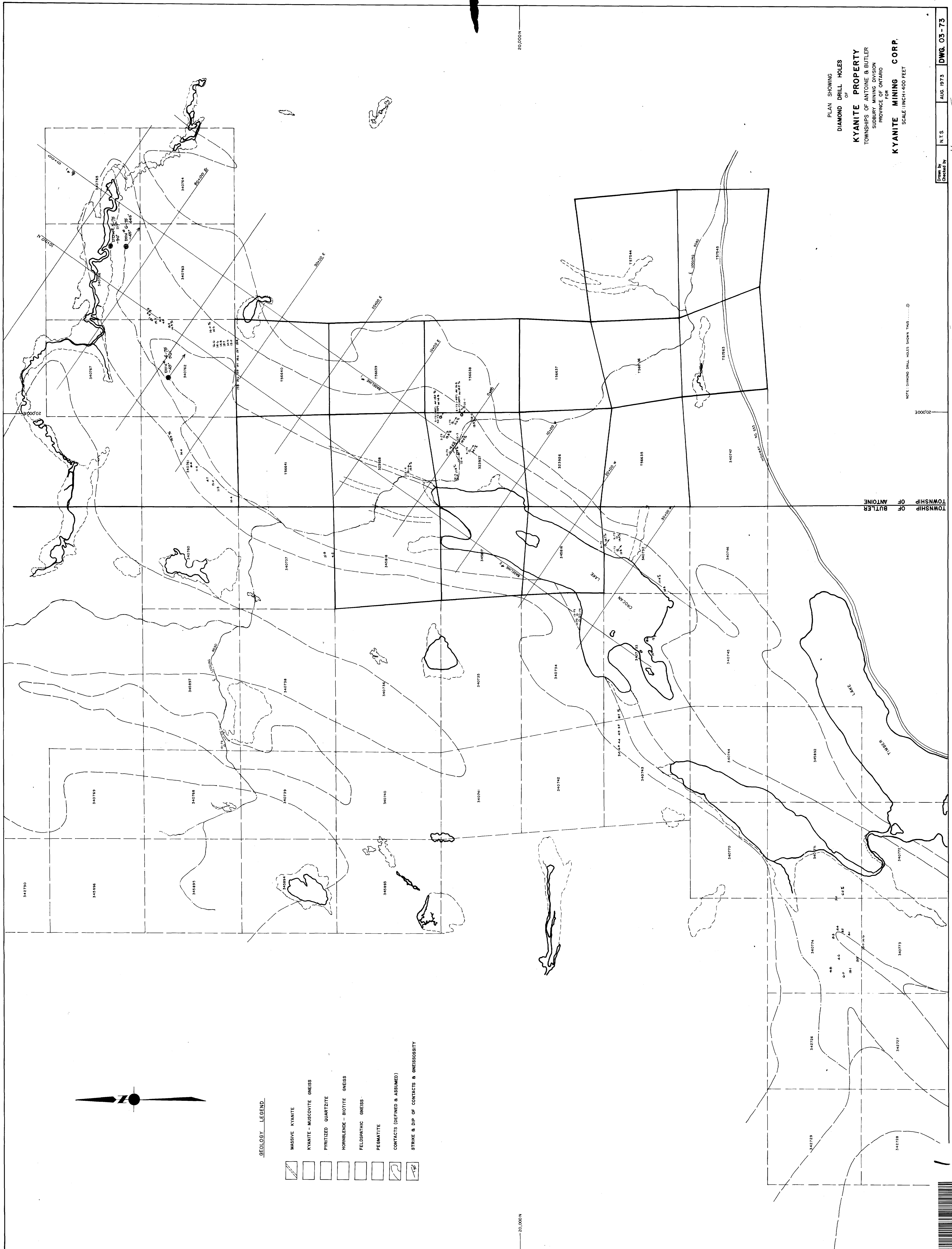

TOWNSHIP OF BUTLER
TOWNSHIP OF ANTOINE

NOTE: DIAMOND DRILL HOLES SHOWN THIS WAY

GEOLOGY LEGEND

- MASSIVE KYANITE
- KYANITE - MUSCOVITE GNEISS
- PYRITIZED QUARTZITE
- HORNBLende - BIOTITE GNEISS
- FELDSPATHIC GNEISS
- PEGMATITE
- CONTACTS (DEFINED & ASSUMED)
- STRIKE & DIP OF CONTACTS & ONEISOBSSITY

