



31L11SE0010 19 BUTLER

010

Diamond Drilling

Township of BUTLER

Report NO 19

Work performed by: Kyanite Mining Corporation

| Claim NO | Hole NO | Footage | Date | Note |
|----------|---------|---------|---------|------|
| S 340746 | 3-76 | 238.0' | June/76 | (1) |
| S 340737 | 3B-76 | 789.0' | June/76 | (2) |
| | 5-76 | 408.0' | Aug/76 | (4) |
| S 345817 | 4-76 | 248.0' | June/76 | (3) |
| S 340744 | 6-76 | 687.0' | Aug/76 | (5) |
| S 342726 | 7-76 | 118.0' | Sept/76 | (6) |
| S 342726 | 8-76 | 227.0' | Oct/76 | (7) |

7/2715'

Notes:

- (1) #78-76 (5) #82-76
- (2) #79-76 (6) #83-76
- (3) #80-76 (7) #99-76
- (4) #81-76

78

BUTLER Twp.
5340746

COMPANY KYANITE MINING CORPORATION Page # one

PROPERTY CROCAN LAKE N. T. S. # _____

PURPOSE OF HOLE ASSESSMENT WORK AND STRUCTURAL DATA

Start June 4/76 Hole 3-76 Az. 125° Dip -45°

Finish June 8/76 Lat. _____ Dep. _____ El. _____

Tests _____ Length 238'

| Footage | | Description | Sample No. | Assays. |
|---------|-----|---|------------|---------|
| From | To | | | |
| 0 | 2 | Casing | | |
| 2 | 110 | Garnetiferous kyanite gneiss overall foliation 80° to CA | | |
| | | 2-12 Two 2" Quartz strcs. one 4" quartz stringer. 60-80° to CA. Est 8-10% Ky (fine) | | |
| | | 12-22 One 3" Quartz stringer 80° to CA. Est 8-10% Ky (fine) | | |
| | | 22-32 Est 8-10% Ky (fine) | | |
| | | 32-42 Est 8-10% Ky (fine) | | |
| | | 42-52 Two 1" Quartz strcs. 80° to CA. Est 8-10% Ky (fine) | | |
| | | 52-62 One 1" Quartz Str. 80° to CA. Est 8-10% Ky (fine) | | |
| | | 62-72 Est 10-12% Ky (becoming coarser and more garnets) | | |
| | | 72-82 Est 8-10% Ky (fine) numerous garnets. | | |
| | | 82-92 Est 8-10% Ky. numerous garnets to 1/2" diameter | | |
| | | 92-102 Sericitic ±80° to CA Est 8-10% Ky | | |
| | | 102-110 Est 5-8% Ky. Highly sericitic from 108-110, ±80-90° to CA | | |

DRILLED BY: Jim Taylor LOGGED BY: Ronald Blais

RMB

79

BUTLER TWP.
S 340737

COMPANY KYANITE MINING CORPORATION Page # one
 PROPERTY CROCAN LAKE N. T. S. # _____
 PURPOSE OF HOLE ASSESSMENT WORK AND STRUCTURAL DATA
 Start June 9/76 Hole 3B-76 Az. --- Dip -90°
 Finish June 25/76 Lat. _____ Dep. _____ El. _____
 Tests _____ Length 789 ft.

| Footage | | Description | Sample No. | Assays. |
|---------|-------|--|------------|---------|
| From | To | | | |
| 0 | 2 | Casing | | |
| 2 | 136.2 | Garnetiferous biotite gneiss | | |
| | | 2-12 One 14" highly feldspathic section, limonitic. Est 5-8% Ky (fine) | | |
| | | 12-22 Foliation $\pm 40^\circ$ to CA Est 8-10% Ky (fine) | | |
| | | 22-32 Highly sericitic $\pm 40^\circ$ to CA. Est 8-10% Ky (fine) | | |
| | | 32-42 Est 8-10% Ky (fine) | | |
| | | 42-52 One 6" Quartz Stringer $\pm 80^\circ$ to CA. Est 5-8% Ky (fine) | | |
| | | 52-62 $\pm 45^\circ$ to CA, Est 5-8% Ky (fine) | | |
| | | 62-72 Becoming rich in Ky and coarse blades. Est 10-12% Ky | | |
| | | 72-82 One 18" Quartz Stringer 45° to CA. Coarse Ky, Est 12-15% Ky | | |
| | | 82-92 Est 10-12% Ky | | |
| | | 92-102 Est 10-12% Ky | | |
| | | 102-112 Est 8-10% Ky. $\pm 40^\circ$ to CA | | |
| | | 112-122 Est 8-10% Ky | | |

DRILLED BY: Jim Taylor LOGGED BY: Ronald Blais

COMPANY KYANITE MINING CORPORATION Page # TWO

PROPERTY CROCAN LAKE N. T. S. # _____

PURPOSE OF HOLE ASSESSMENT WORK AND STRUCTURAL DATA

Start June 9/76 Hole 3B-76 Az. --- Dip -90°

Finish June 25/76 Lat. _____ Dep. _____ El. _____

Tests _____ Length 789 ft.

| Footage | | Description | Sample No. | Assays. | |
|---------|-----|---|------------|---------|--|
| From | To | | | | |
| | | 122-132 Est 10-12% Ky (fairly coarse) | | | |
| | | 132-136.2 Est 5-8% Ky (fine) sericitic, 60-80° to CA | | | |
| 136.2 | 719 | Metasediments No Kyanite | | | |
| | | 136.2-169 Chloritic, 8-15% blebby pyrite. Weak overall foliation ± 40° to CA. Green occasional minor quartz stringer | | | |
| | | 169-204 Highly sericitic, grey, soft, sparse Py locally. Becoming much harder from 179 | | | |
| | | 204-208 Chloritic, 5-10% fine Pyrite | | | |
| | | 208-247 Grey, sericitic ± 50° to CA. Local fine Py | | | |
| | | 247-271 Chloritic 3-8% Py | | | |
| | | 271-274 10-15% Coarse blebby Pyrite | | | |
| | | 274-290 Grey sericitic 281.5 to 282.5 glassy quartz | | | |
| | | 290-354 Chloritic with up to 5% fine Py locally. 329-330 calcite vein, 30° to CA (Haematized) at 334 possible fault seam core broken up. Highly chloritic | | | |

DRILLED BY: Jim Taylor LOGGED BY: Ronald Blais

80

COMPANY KYANITE MINING CORPORATION

Page # one *Butler Lwp. 3458i*

PROPERTY CROGAN LAKE

N. T. S. # _____

PURPOSE OF HOLE ASSESSMENT WORK AND STRUCTURAL DATA

Start June 29/76 Hole 4-76 Az. 125° Dip -45°

Finish July 2/76 Lat. _____ Dep. _____ El. _____

Tests _____ Length 248 ft.

| Footage | | Description | Sample No. | Assays. | |
|---------|-------|---|------------|---------|--|
| From | To | | | | |
| 0 | 6 | Casing | | | |
| 6 | 27.6 | Dark green highly chloritic Meta volcanics, locally dioritic and occasionally with abundant epidote. Overall foliation 60° to CA. | | | |
| 27.6 | 170.7 | Garnetiferous kyanite gneiss Foliation 60-80° to CA. Highly Sericitic | | | |
| | | 27.6-30 Est 5-8% Ky (fine) | | | |
| | | 30-40 Est 5-8% Ky (fine) | | | |
| | | 40-50 Est 5-8% Ky (fine) | | | |
| | | 50-60 Est 5-8% Ky (fine) | | | |
| | | 60-70 Est 5-8% Ky (fine) | | | |
| | | 70-80 Est 5-8% Ky (fine) | | | |
| | | 80-90 Est 5-8% Ky (fine) | | | |
| | | 90-100 Est 5-8% Ky (fine) | | | |
| | | 100-110 Est 5-8% Ky (fine) | | | |
| | | 110-120 Est 5-8% Ky (fine) | | | |
| | | 120-130 Est 5-8% Ky (fine) | | | |
| | | 130-140 Est 5-8% Ky (fine) | | | |
| | | 140-150 Est 5-8% Ky (fine) | | | |

DRILLED BY: JIM TAYLOR

LOGGED BY: Ronald Blais *Rm Blais*

81

BUTLER TW-534073

COMPANY KYANITE MINING CORPORATION Page # one of two

PROPERTY Crocan Lake N. T. S. # _____

PURPOSE OF HOLE ASSESSMENT WORK AND STRUCTURAL DATA

Start Aug. 4/76 Hole 5-76 Az. 125° Dip -45°

Finish Aug. 11/76 Lat. _____ Dep. _____ El. _____

Tests _____ Length 408'

| Footage | | Description | Sample No. | Assays. | |
|---------|-------|--|------------|---------|--|
| From | To | | | | |
| 0 | 8 | Casino | | | |
| 8 | 35 | Quartz and siliceous metasedaments with local short chloritic sections to 6" overall weak foliation 40-60° to core axis (CA). Local pale green epidote in the chlorite | | | |
| 35 | 227 | Metavolcanics - dark green soft highly chloritic locally dioritic, with abundant fine grained hornblende overall. foliation 45-60° to CA. Local patchy epidote. Foliation becoming much more obtuse with angles approaching 80° towards 150' | | | |
| | | 216-218 TWO 2" Quartz stringer 70° tp CA with local anhedral blebby pyrite to 1/2". | | | |
| 227 | 290.5 | Garnetiferous Kyanite gneiss, contact abrupt, 70° to CA. | | | |
| | | 227-237 Estimate 3-5% fine Ky 70° to CA | | | |
| | | 237-247 Estimate 5-8% fine Ky 70° to CA | | | |
| | | 247-257 Estimate 5-8% fine Ky 70° to CA | | | |
| | | 257-267 Estimate 5-8% fine Ky 70° to CA | | | |
| | | 267-277 Estimate 5-8% fine Ky 70° to CA | | | |
| | | 277-290.5 Estimate 5-8% Ky 70° to CA. One 2" Quartz Str. | | | |
| 290.5 | | Metasediments dark green highly chloritic contact sharp 70° to CA. 290.5-300.5 8-50% Sulphides blebby pyrrhotite, minor chalcopyrite and pyrite est. 2% copper. | | | |

DRILLED BY: Jim Taylor LOGGED BY: Ronald Blais *RMB*

82

BUTLER TWP. 5340744

COMPANY KYANITE MINING CORPORATION Page # one of five

PROPERTY CROCAN LAKE N. T. S. # _____

PURPOSE OF HOLE ASSESSMENT WORK AND STRUCTURAL DATA

Start Aug. 20/76 Hole 6-76 Az. 125° Dip -45°

Finish Sept. 3/76 Lat. _____ Dep. _____ El. _____

Tests _____ Length 687'

| Footage | | Description | Sample No. | Assays. | |
|---------|------|--|------------|---------|--|
| From | To | | | | |
| 0 | 8 | Casing | | | |
| 8 | 36.5 | Meta-Volcanics-pale grey to dark green depending on degree of chloritization overall foliation 60° to core axis. local minor blebby pyrite and occasional disseminations of fine pyrihotite. | | | |
| 36.5 | 687 | Garnetiferous kyanite gneiss 60-80° to the core axis. | | | |
| | | 36.5-45 Four 2", one 6" Qtz. stringers. 60-80° to CA. Estimate 12-15% Ky. | | | |
| | | 45-55 Two 3" Qtz. Str. Est. 12-15% Ky. | | | |
| | | 55-65 One 14" Qtz veinlet Est. 8-12% Ky. | | | |
| | | 65-75 Three 4" Qtz. Strgs. Est. 8-12% Ky. | | | |
| | | 75-85 Two 2" Qtz Strs. Est. 12-15% Ky. | | | |
| | | 85-95 Two 12", two 2" Qtz strgs. Est. 8-10% Ky. | | | |
| | | 95-105 Est. 8-10% Kv | | | |
| | | 105-115 Four 4" Qtz Strs. Est. 8-10% Kv. | | | |

DRILLED BY: Jim Taylor LOGGED BY: Ronald Blais

RMB

DIAMOND DRILL LOG

COMPANY KYANITE MINING CORPORATION Page # TWO OF FIVE

PROPERTY CROCAN LAKE N. T. S. # _____

PURPOSE OF HOLE ASSESSMENT WORK AND STRUCTURAL DATA

Start Aug. 20/76 Hole 6-76 Az. 125⁰ Dip -45⁰

Finish Sept. 3/76 Lat. _____ Dep. _____ El. _____

Tests _____ Length 687'

| Footage | | Description | Sample No. | Assays. | |
|---------|----|--|------------|---------|--|
| From | To | | | | |
| | | 115-125 Four 1" Qtz. Strs. Est. 8-12% Kv. | | | |
| | | 125-135 One 5", one 1" Qtz Strs. Est. 8-10% Ky. | | | |
| | | 135-145 Four 1" Qtz. Strs. Est. 8-10% Ky. | | | |
| | | 145-155 Three 2" Qtz. Strs. Est. 8-10% Ky. | | | |
| | | 155-165 One 2" Qtz. Strs. Est. 5-8% Kv. (fine) | | | |
| | | 165-175 Highly Chloritic from 171-175 Est. 2-5% Kv. | | | |
| | | 175-185 Highly chloritic 175-176 Est. 5-8% Ky. one 6" Qtz. Str. | | | |
| | | 185-195 Two 1" Qtz. Strs. Est. 5-8% Kv. | | | |
| | | 195-205 Est. 8-12% Kv. | | | |
| | | 205-215 Est. 12-15% Ky (coarser) | | | |
| | | 215-225 Est. 12-15% Ky. | | | |
| | | 225-235 Est. 12-15% Ky. one 2" Qtz. Str. | | | |
| | | 235-245 Est. 8-12% Ky. (fine) | | | |
| | | 245-255 Est. 8-12% Ky | | | |
| | | 255-265 Two 2" Qtz. Str. Est. 8-12% Ky. | | | |

DRILLED BY: Jim Taylor LOGGED BY: Ronald Blais

DIAMOND DRILL LOG

COMPANY KYANITE MINING CORPORATION Page # THREE OF FIVE

PROPERTY CROCAN LAKE N. T. S. # _____

PURPOSE OF HOLE ASSESSMENT WORK AND STRUCTURAL DATA

Start Aug. 20/76 Hole 6-76 Az. 125° Dip -45°

Finish Sept. 3/76 Lat. _____ Dep. _____ El. _____

Tests _____ Length 687'

| Footage | | Description | Sample No. | Assays. | |
|---------|----|--|------------|---------|--|
| From | To | | | | |
| | | 265-275 Est. 8-12% Ky. | | | |
| | | 275-285 One 4" Qtz. Str. Est. 8-10% Ky (fine) | | | |
| | | 285-295 Est. 5-8% Ky (fine) | | | |
| | | 295-305 295-296 intense shear core shattered probable fault zone ± 70° to core axis. Est. 5-8% Ky (fine) | | | |
| | | 305-315 Est. 5-8% Ky (fine) | | | |
| | | 315-325 Est. 8-12% Ky (Coarse) | | | |
| | | 325-335 Est. 12-15% Ky | | | |
| | | 335-345 Est. 12-15% Ky | | | |
| | | 345-355 Est. 12-15% Ky | | | |
| | | 355-365 Est. 12-15% Ky | | | |
| | | 365-375 Est. 12-15% Ky | | | |
| | | 375-385 Est. 12-15% Ky | | | |
| | | 385-395 Est. 15-20% Ky | | | |
| | | 395-405 Est. 15-20% Ky | | | |
| | | 405-415 One 2" Qtz Str., locally limonitic Est. 12-15% Ky | | | |
| | | 415-425 Est. 15-20% Ky | | | |

DRILLED BY: Jim Taylor LOGGED BY: Ronald Blais

DIAMOND LOG

COMPANY KYANITE MINING CORPORATION Page # FIVE OF FIVE
 PROPERTY CROCAN LAKE N. T. S. # _____
 PURPOSE OF HOLE ASSESSMENT WORK AND STRUCTURAL DATA
 Start Aug. 20/76 Hole 6-76 Az. 125° Dip -45°
 Finish Sept. 3/76 Lat. _____ Dep. _____ El. _____
 Tests _____ Length 687'

| Footage | | Description | Sample No. | Assays. | |
|---------|----|---|------------|---------|--|
| From | To | | | | |
| | | 545-555 Est. 8-10% Kv (fine) | | | |
| | | 555-565 Two 9", one 2" Qtz. strs. Est. 8-10% Ky | | | |
| | | 565-575 Est. 12-15% Ky | | | |
| | | 575-585 Est. 15-20% Ky | | | |
| | | 585-595 One 4" Qtz. Str. Est. 12-15% Ky. | | | |
| | | 595-605 One 36", one 4" Est. 8-12% Kv. | | | |
| | | 605-615 Est. 8-12% Ky (fine) | | | |
| | | 615-625 One 4", two 2" Qtz. strs. Est. 12-15% Ky. | | | |
| | | 625-635 Est. 12-15% Ky | | | |
| | | 635-645 Est. 15-20% Ky. locally coarse. | | | |
| | | 645-655 One 29", one 12" Qtz. Est. 3-5% Ky overall | | | |
| | | 655-665 Est. 8-10% Ky | | | |
| | | 665-675 One 9" Qtz Str. Est. 8-10% Ky | | | |
| | | 675-687 Est. 8-10% Ky | | | |
| | | End of #6 Hole 687 ft. | | | |

DRILLED BY: Jim Taylor LOGGED BY: Ronald Blais

83

DIAMOND DRILL LOG

Butler Prop. S. 342726

COMPANY KYANITE MINING CORPORATION Page # One of Two

PROPERTY CROCAN LAKE N. T. S. # _____

PURPOSE OF HOLE ASSESSMENT WORK AND STRUCTURAL DATA

Start Sept. 21/76 Hole 7-76 Az. 20° Dip -45°

Finish Sept. 22/76 Lat. _____ Dep. _____ El. _____

Tests _____ Length 118 ft.

| Footage | | Description | Sample No. | Assays. | |
|---------|----|---|------------|---------|--|
| From | To | | | | |
| 0 | 3 | Casing | | | |
| 3 | 72 | Garnetiferous kyanite gneiss overall foliation 80° to CA | | | |
| | | 3-5 Est. 8-12% Ky | | | |
| | | 5-15 Two 1" Qtz strs est. 12-15% Ky. Possible fault at 8' (core broken up and sericitic) | | | |
| | | 15-25 Two 4" Ore 3" Qtz Str. Est. 15-20% Ky. | | | |
| | | 25-35 Three 1" Qtz strs. Est 12-15% Ky | | | |
| | | 35-45 Five 1" Qtz Strs. Est. 12-15% Ky | | | |
| | | 45-55 Four 2" Qtz Strs. Est. 15-20% Ky | | | |
| | | 55-65 Est. 15-20% Ky locally coarse | | | |
| | | 65-67 Est. 15-20% Ky | | | |
| | | 67-69.2 Very Fine grained, no Ky seen, possible a variety of meta-volcanic. | | | |
| | | 69.2-72 Garnetiferous Kyanite gneiss Probable fault zone at 69.2 Intense shearing and sericitization. Local blebby pyrite. Est. 10-12% coarse Ky. | | | |

RMB

DRILLED BY: Jim Taylor LOGGED BY: Ronald Blais

DIAMOND DRILL LOG

5342726

COMPANY KYANITE MINING CORPORATION Page # one of three

PROPERTY Crecan Lake N. T. S. # _____

PURPOSE OF HOLE ASSESSMENT AND STRUCTURAL DATA

Start October 4, 1976 Hole 8-76 Az. --- Dip -90°

Finish October 6, 1976 Lat. ---- Dep. ---- El. ----

Tests _____ Length 227'

| Footage | | Description | Sample No. | Assays. | |
|---------|-------|---|------------|---------|--|
| From | To | | | | |
| 0 | 3 | Casing | | | |
| 3 | 219.8 | Garnetiferous kyanite gneiss overall foliation 80° to core axis (CA) | | | |
| | | 3-10 Two 1" Qtz Strs. Sericitic Est. 5-8% KY | | | |
| | | 10-20 One 18" Qtz veinlet 40° to CA one 3" qtz str. Est. 8-10% Ky | | | |
| | | 20-30 Est 8-10% Ky | | | |
| | | 30-40 One 9" Qtz veinlet 60° to CA Est 10-12% Ky | | | |
| | | 40-50 Est 12-15% Ky locally coarse | | | |
| | | 50-60 One 2" Qtz str. Est. 12-15% Ky | | | |
| | | 60-70 One 6" Two 1" Qtz Strs Est 10-12% Ky Locally coarse | | | |
| | | 70-80 Est 10-12% Ky Locally coarse | | | |
| | | 80-90 Three 1" Qtz Strs. Est 10-12% Ky locally very coarse near Qtz. Strs. | | | |
| | | 90-100 At 94' Highly sericitic and haematized, probable fault zone. Two 1" Qtz Strs. Est 5-8% Ky. | | | |

DRILLED BY: Jim Taylor

LOGGED BY: R.M. BLAIS

DIAMOND DRILL LOG

S 342726

COMPANY KYANITE MINING CORPORATION Page # two of three

PROPERTY Crocan Lake N. T. S. # -----

PURPOSE OF HOLE ASSESSMENT AND STRUCTURAL DATA

Start October 4, 1976 Hole 8-76 Az. --- Dip -90°

Finish October 6, 1976 Lat. ----- Dep. ----- El. ---

Tests _____ Length 227'

| Footage | | Description | Sample No. | Assays. | |
|---------|----|---|------------|---------|--|
| From | To | | | | |
| | | 100-110 Two 3" Qtz Strs. Est 10-12% Ky | | | |
| | | 110-120 One 6" Qtz Strs Est. 10-12% Ky fine | | | |
| | | 120-130 Est 8-10% Ky (fine) | | | |
| | | 130-140 Two 3" Qtz Strs Est 8-10% Ky (fine) | | | |
| | | 140-150 Two 2" Qtz Strs Est 8-10% fine ky | | | |
| | | 150-160 Three 2" Qtz Strs. est 5-8% Ky (fine) | | | |
| | | 160-170 Six 1" Qtz Strs Est 8-10% Ky - locally coarse | | | |
| | | 170-180 One 12", one 2" Qtz Est 8-10% Ky-locally coarse | | | |
| | | 180-190 One 12" one 2" Qtz str. Est 8-10% Ky | | | |
| | | 190-200 One 6" one 4" two 1" Qtz Strs. Est 8-10% Ky (fine) | | | |
| | | 200-210 One 3" one 2" Qtz Strs Est 5-8% Ky (fine) | | | |
| | | 210-218 Est 5-8% fine Ky. Becoming intensely sericitic | | | |

DRILLED BY: Jim Taylor LOGGED BY: R.M. BLAIS

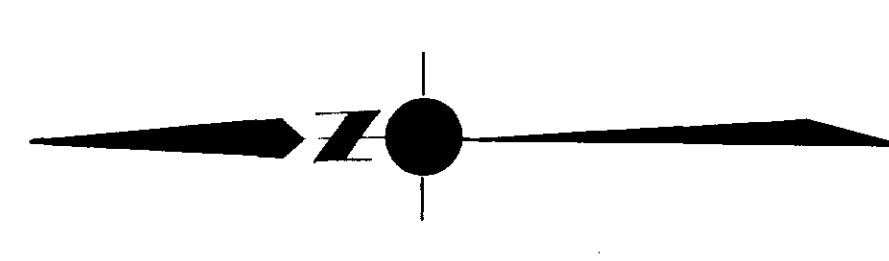

GEOLOGY LEGEND

- MASSIVE KYANITE
- KYANITE - MUSCOVITE GNEISS
- PYRITIZED QUARTZITE
- HORNBLENDE - BIOTITE GNEISS
- FELDSPATHIC GNEISS
- PEGMATITE
- CONTACTS (DEFINED & ASSUMED)
- STRIKE & DIP OF CONTACTS & UNCONSOIDITY

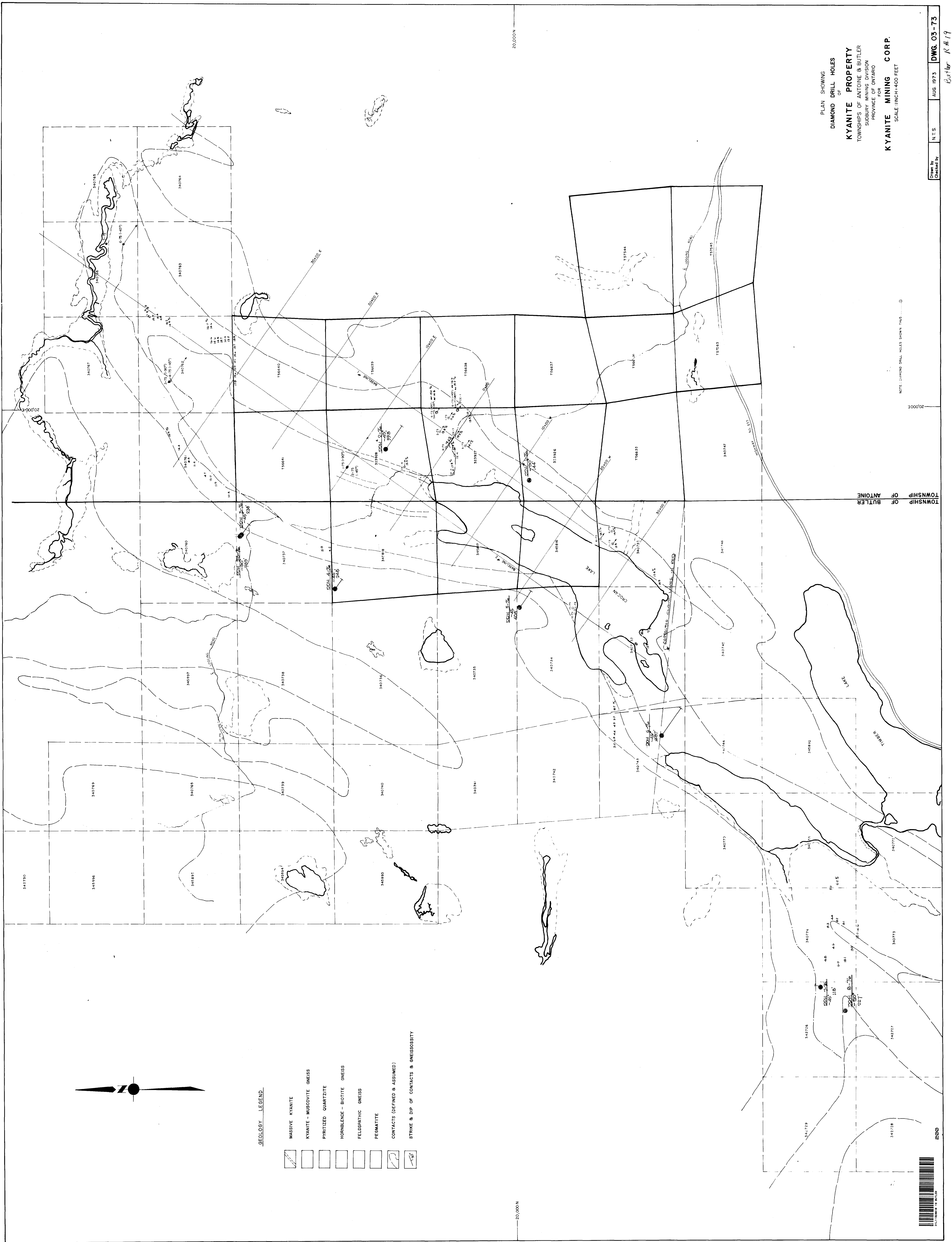

PLAN SHOWING
DIAMOND DRILL HOLES
OF
KYANITE PROPERTY
TOWNSHIPS OF ANTOINE & BUTLER
SUBURBARY MINING DIVISION
PROVINCE OF ONTARIO
KYANITE MINING CORP.
SCALE: 1/4"=1000 FEET

NOTE: DIAMOND DRILL HOLES SHOWN THIS DATE

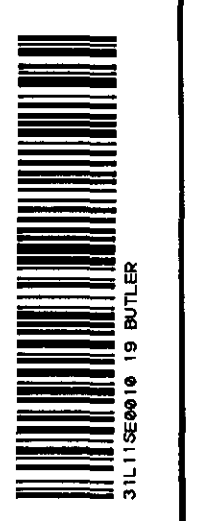

2000