



31L11SE0051 15 BUTLER

010

Diamond Drilling

Township of BUTLER

Report N^o 15

Work performed by: Morris Macwilliam

Claim N ^o	Hole N ^o	Footage	Date	Note
L 212149	1	32.0'	Sept/71	
	2	106.0'	Sept/71	
	3	103.0'	Sept/71	
		$\frac{3}{241'}$		

Notes:

107/71

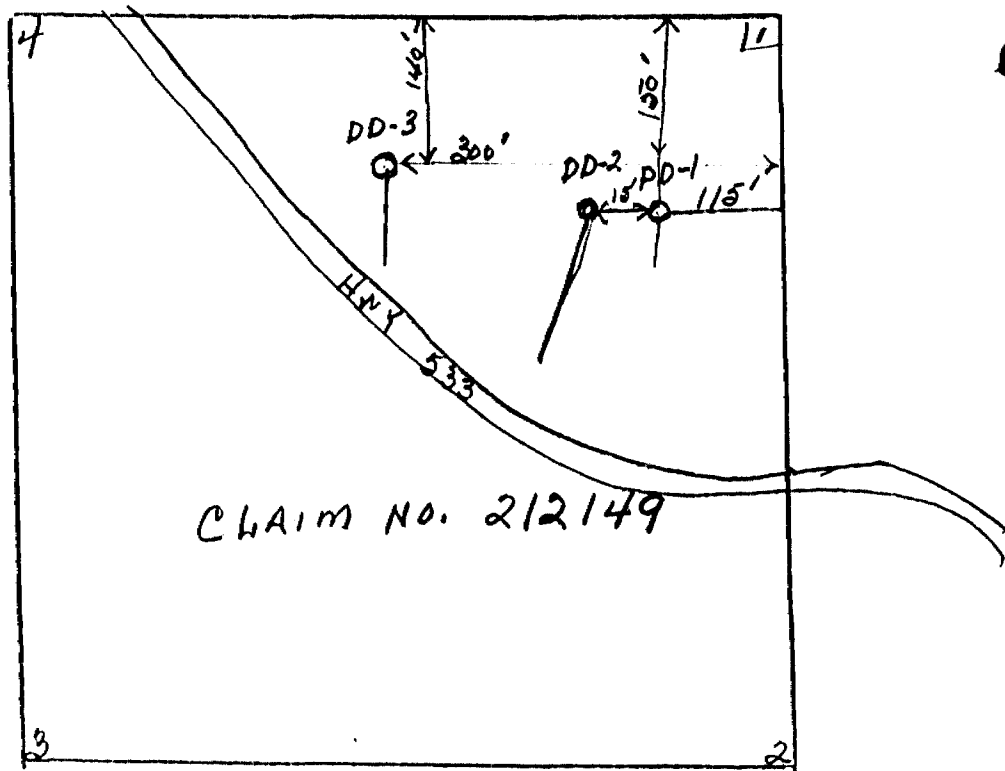



THE MINING ACT - DEPARTMENT OF MINES
DIAMOND DRILLING LOG

Start a new page for every new hole, but fill in top portion of form only on first page for each hole.

FILL IN ON EVERY PAGE

HOLE NO. 1 PAGE NO. 1

DRILLING COMPANY		COLLAR ELEVATION	BEARING OF HOLE FROM TRUE NORTH	TOTAL FOOTAGE	DIP OF HOLE AT	LOCATION OF HOLE IN RELATION TO A FIXED POINT ON THE CLAIM	MAP REFERENCE NO.	CLAIM NO.	
DATE HOLE STARTED	DATE COMPLETED	DATE LOGGED	LOGGED BY		collar		100' WEST 150' SOUTH OF #1 POST CLAIM # 21249	1	212149
EXPLORATION CO., OWNER OR OPTIONEE		DATE SUBMITTED	SUBMITTED BY (Signature)						
Morris Macwilliam		Sept 24/71	J. Miron						

LOCATION (Tp., Lot, Con. OR Lat. and Long.)
BUTLER TWP.
PROPERTY NAME
VERMICULITE PROPERTY

FOOTAGE		ROCK TYPE	DESCRIPTION Colour, grain size, texture, minerals, alteration, etc.	PLANAR FEATURE ANGLE *	CORE SPECIMEN FOOTAGE +	YOUR SAMPLE NUMBER	SAMPLE FOOTAGE		SAMPLE LENGTH	ASSAYS +	
FROM	TO						FROM	TO			
0'	24'	BIOTITE	COARSE GRAIN BLACK WITH MICA + VERMICULITE								
24	32.	GNEISS	PINK FELDSPATHIC FINER GRAINS OF MICA								
			ENCOUNTERED BROKEN ROCK AT 32' DRILL CORE BROKEN IN SMALL PEICES LOST OUR WATER STOPPED DRILLING.								

SEP 25 1971

* For features such as foliation, bedding, schistosity, measured from the long axis of the core.

+ Additional credit available. See Assessment Work Regulations.



THE MINING ACT - DEPARTMENT OF MINES
DIAMOND DRILLING LOG

Start a new page for every new hole, but fill in top portion of form only on first page for each hole.

FILL IN ON EVERY PAGE

HOLE NO. **2** PAGE NO. **2**

DRILLING COMPANY Rented drill		COLLAR ELEVATION	BEARING OF HOLE FROM TRUE NORTH	TOTAL FOOTAGE 106'	DIP OF HOLE AT 10° collar	LOCATION OF HOLE IN RELATION TO A FIXED POINT ON THE CLAIM 115' WEST 150' SOUTH #1 POST CLAIM # 212149	MAP REFERENCE NO. HOLE # 2	CLAIM NO. 212149
DATE HOLE STARTED Sept. 11th / 71	DATE COMPLETED Sept 13th / 71	DATE LOGGED Sept. 15th	LOGGED BY Morris Macwilliam		ft		LOCATION (Tp., Lot, Con. OR Lat. and Long.) BUTLER TWP. VERMICULITE PROPERTY	
EXPLORATION CO., OWNER OR OPTIONEE Morris Macwilliam Saulte St. Marie		DATE SUBMITTED Sept 24th	SUBMITTED BY (Signature) J. Miron		ft			
					ft			

FOOTAGE		ROCK TYPE	DESCRIPTION	PLANAR FEATURE ANGLE *	CORE SPECIMEN FOOTAGE +	YOUR SAMPLE NUMBER	SAMPLE FOOTAGE		SAMPLE LENGTH	ASSAYS +	
FROM	TO		Colour, grain size, texture, minerals, alteration, etc.				FROM	TO			
0	22	BIOTITE	BLACK GRAINS 1/4 inch GOLD COLOURED VERMICULITE								
22	48	GNEISS	PINK FINE GRAIN FELDSPAR MICA + QUARTZ								
48	50	VERMICULITE	SOFT FINE GRAIN NO CORE GRAINS OF VERMICULITE FLOATED TO SURFACE IN DRILL SLUDGE								
50	73	BIOTITE	BLACK WITH FINE GRAIN MICA								
73	78	HORNBLENDE	GRAY + BLACK WITH MICA FLAKES								
78	97	BIOTITE	BLACK WITH PINK STRINGS OF FELDSPAR AND FLAKES OF MICA								
97	105	CLAY + MICA	BLACK + GOLD COLOURED FLAKES MICA + CLAY								
105	106	GNEISS	PINK + GREY GRANITE GNEISS.								

* For features such as foliation, bedding, schistosity, measured from the long axis of the core.

+ Additional credit available. See Assessment Work Regulations.

