



31L13NW9725 37 BRIGGS

010

Diamond Drilling

Township of BRIGGS

Report N^o: 37

Work performed by: H. Niemetz

Claim N ^o	Hole N ^o	Footage	Date	Note
L 398724	1	124'	Aug/74	
	HN-3	118'	Sept/74	
	HN-4	102'	Sept/74	
	5	104'	Sept/74	
L 398723	HN-2	152'	Aug/74	

Notes:

DIAMOND DRILL LOG

Fella

COMPANY H. Niemetz, Briggs Township

Page # 1

PROPERTY Testing, Showing and Assessment

N. T. S. # _____

PURPOSE OF HOLE _____

Start Aug. 6/74

Hole 1

Az. 290° Dip -45°

Finish Aug. 10/74

Lat. _____

Dep. _____ El. _____

Tests 201'E, 14'S Post 4 Claim 398724

Length 100'

Footage		Description	Sample No.	Assays.		
From	To					
0	75	Dacitic flows, pale to dark green, locally amygdular and becoming finely pyroclastic near the end of the hole with subangular fragments to 1/2". Overall schistosity 25° to core axis. Weak to moderately magnetic throughout and considerable epidote in seams and blebs. <u>N.B.:</u> 1 - 36' local blebs and seams of chalcopyrite, with some fine disseminations, trace pyrite. Overall average estimated less than 1/2% Cu. All mineralized sections were sampled and assayed for gold and copper.				
<u>Sampling</u>				<u>Ft.</u>	<u>Cu.</u>	<u>Au.</u>
1.0	2.0	Local blebs and disseminations of cpy.	10109	1.0	.65	.12
3.6	6.6	Local blebs and disseminations of cpy.	10110	3.0	.29	.06
7.8	10.0	Local blebs and disseminations of cpy.	10111	2.2	.06	.005
12.9	15.0	Local blebs and disseminations of cpy.	10112	2.1	.45	.03
19.5	23.6	Local blebs and disseminations of cpy.	10113	4.1	.23	.04
29.5	35.8	Local blebs and disseminations of cpy.	10114	6.3	.76	.19
75	77	Pale pink granitic dyke, 60° to core axis.				
77	100	Dacitic flows as 0-75 unmineralized and finely pyroclastic. <u>N.B.:</u> This hole was drilled under a 4' north striking, 80° west dipping shear at a dacite interflow contact on claim 398724. Grab samples of the best mineralization from the shear assayed 3.74% Cu., 1.91 oz/ton Au. and 1.07 oz/ton Ag. but the average mineralization is much lower grade. <i>NB. See additional sampling and deepening to 126'</i>				

RJG

R.J. Graham

DRILLED BY: H. Niemetz

LOGGED BY: R.J. Graham

WEST

EAST

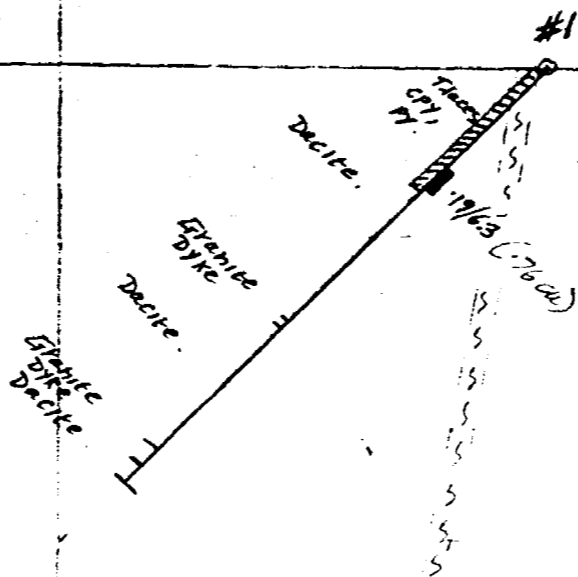

SECTION
0+00

H. NIEMETZ
BRIGGS TO JNSHIP

1"=40'

8/26/76

DIAMOND DRILL LOG

COMPANY _____ Page # 1

PROPERTY H. Niemetz, Briggs Township N. T. S. # _____

PURPOSE OF HOLE Assessment Work

Start September 1, 1974 Hole HN 3 Az. 90° Dip -45°

Finish September 20, 1974 Lat. _____ Dep. _____ El. _____

Tests 106'E, 14'S Post 4 Claim 398724 Length 118.0

Footage		Description	Sample No.	Assays.	
From	To			Au.	
		(No Casing)			
0	118.0	Dacitic flows, pale to dark green, massive, locally porphyritic with gradational contacts and occasionally with local clusters of lapillae. Considerable epidote locally, with marked increase from 75' to end at 118'			
		18 - 19.6 Core ground, stick in box,			
		23 - 24.6 Core ground, stick in box,			
		28.0 - 33.0 Weak fine dissemination of Py and local Cpy (< 1/4%Cu)	10123	.02	
		33.0 - 38 as 28-33	10124	Tr.	
		38 - 43 as 28 - 33	10125	.02	
		43 - 50 as 28 - 33	10126	.02	
		86 - 86.5 Core ground, stick in box,			
		116 - 117 Core ground, stick in box			
		END OF HOLE 118'			

DRILLED BY: H. Niemetz LOGGED BY: R. J. Graham

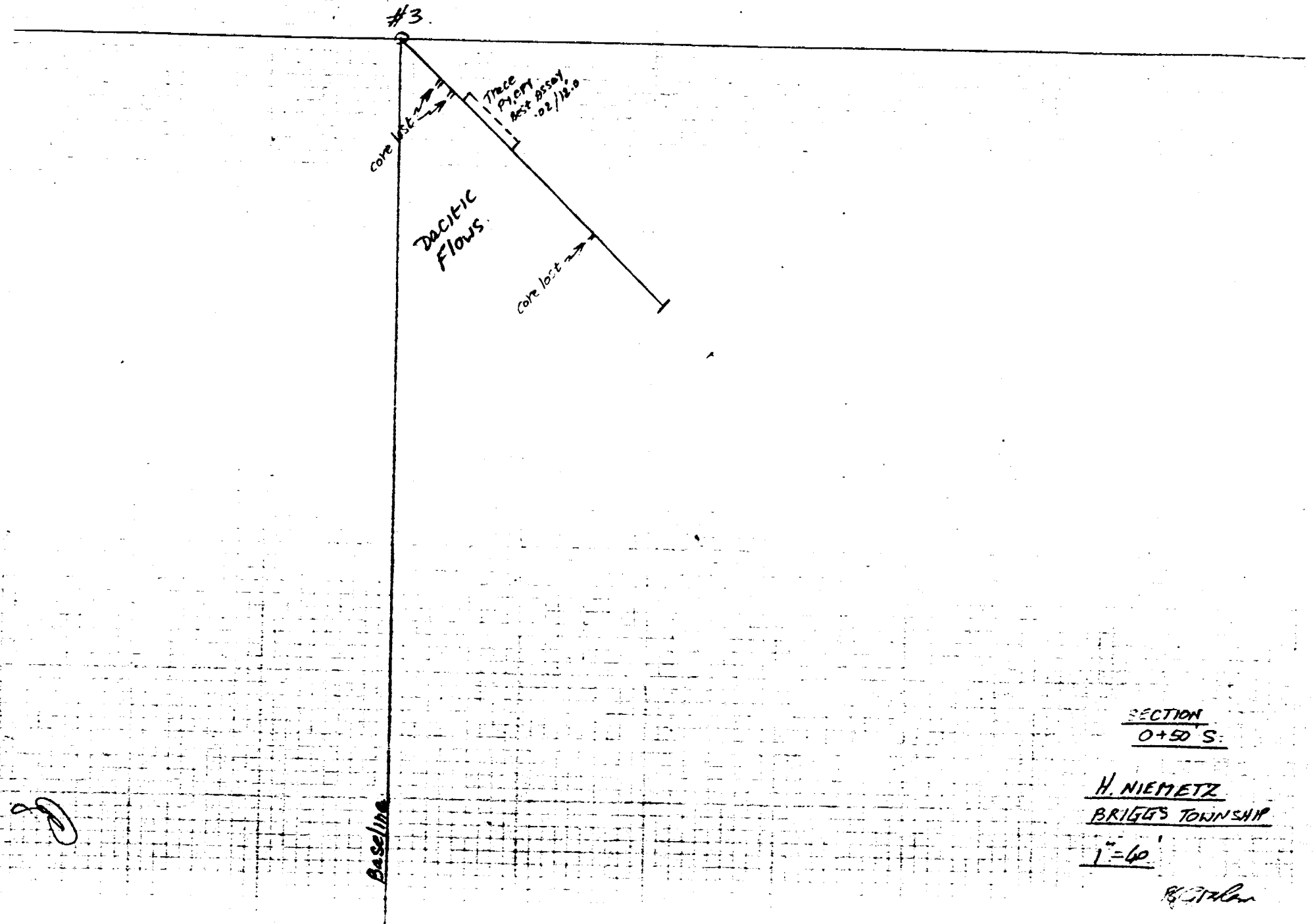

SECTION
0+50 S.

H. NIEMETZ
BRIGGS TOWNSHIP

1"=60'

R. J. Talan

DIAMOND DRILL LOG

COMPANY _____ Page # 1

PROPERTY H. Niemetz, Briggs Township N. T. S. # _____

PURPOSE OF HOLE Assessment Work

Start September, 21 1974 Hole H. N #4 Az. 125° Dip -60°

Finish September, 25 1974 Lat. _____ Dep. _____ El. _____

Tests 70'S, 140'E Post 4 claim 398724 Length 102'

Footage		Description	Sample No.	Assays.	
From	To			Au	
0	10	Diorite dyke - innumerable tiny white feldspars in dark green chloritic groundmass. Soft, unmineralized.			
10	13	Andesite or chloritic dacite. Contact with preceding broken. Dark green, weak 45° foliation.			
13	14	Core ground			
14	41.1	Diorite dyke as 0 - 10 14-15 highly chloritic 15 - 41.1 Typical dyke			
41.1	102	Dacite - 41.1 - 46.7 Core shattered, carbonatized, brecciated, unmineralized 46.7 - Locally weakly porphyritic with vague white feldspars to 1/8" Sparse amygdules.			
		61-65 Minor traces Py < 1/2% Py	8900	.02	
		65 - 70 Trace Py, Cpy, < 1/4% Cu.	8901	Tr	
		70 - 75	8902	.02	
		75 - 80	8903	Tr.	
		80 - 85	8904	Tr.	
		85 - 90	8905	Tr.	
		90 - 97	8906	.02	
		From 65' considerable epidote			
		END OF HOLE 102'			

DRILLED BY: H. Niemetz LOGGED BY: R. J. Graham

WEST

HOLE
(AZIMUTH 125°)

EAST

#4

Diorite
Andesite

Diorite

Dacite

Trace
P1, C1
BEST Au = .02/5.0

Baseline

Q

SECTION
ON #4

H. NIEMETZ
BRIGGS TOWNSHIP

1"=40'

R. C. Cram 76

WEST

#5

(HOLE AZIMUTH 115°)

EAST

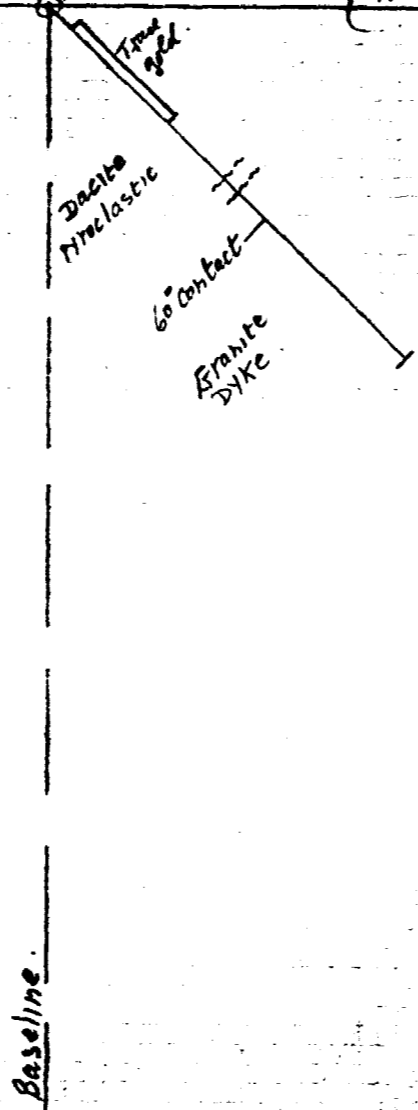

Q

SECTION
ON # 5

H. NIEMETZ
BRIGGS TOWNSHIP

1:40'

9/20/76

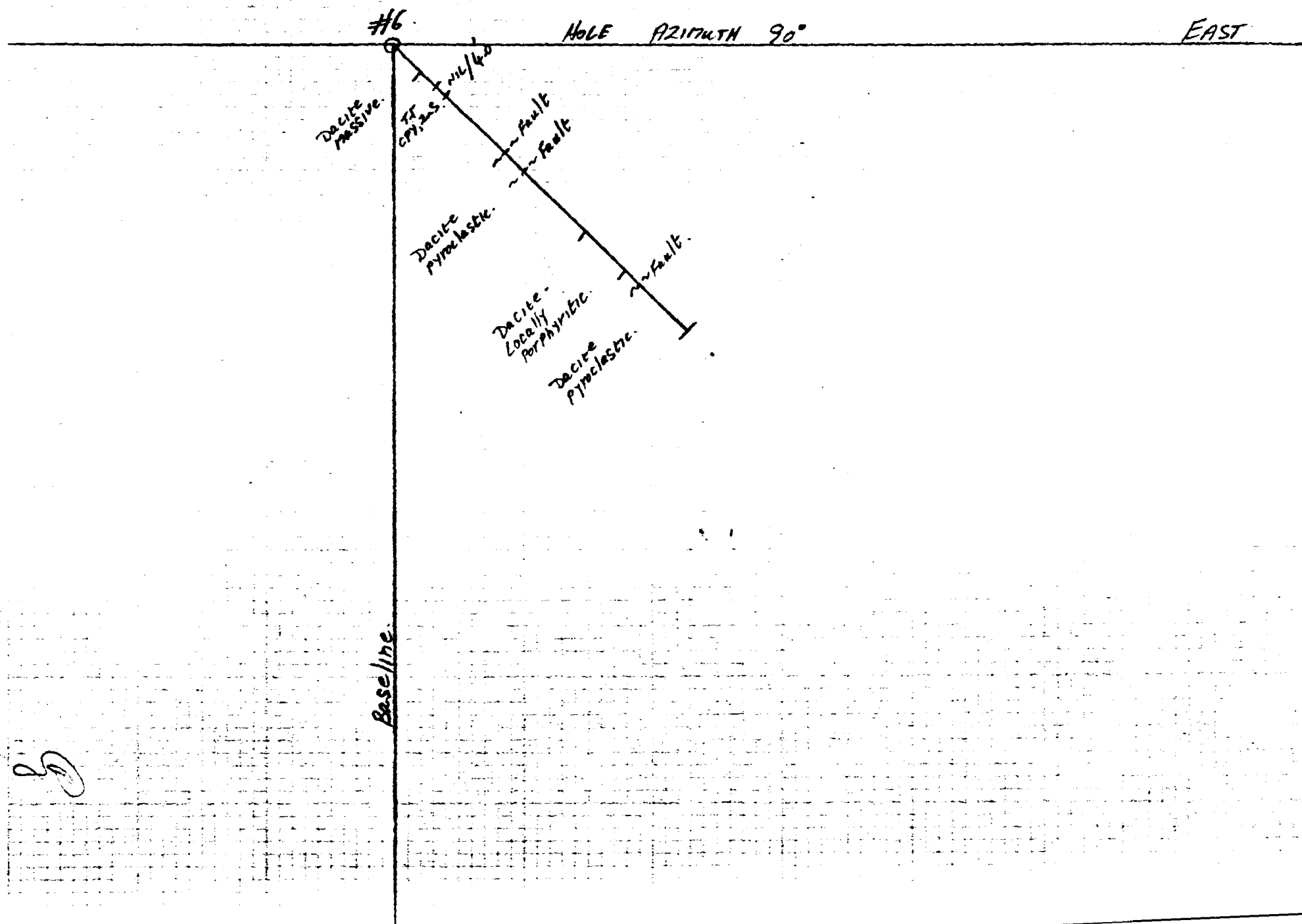

#6

HOLE AZIMUTH 90°

EAST

Dacite massive.

TF CR. Z.S.

Dacite pyroclastic.

Dacite -
Locally
porphyritic.

Dacite
pyroclastic.

Fault

Fault

Fault.

1 mi/400

Baseline.

2

Claim No
398739

Claim No
398723

Briggs Twp. Temagami Area.
H. Niemetz. Prospectors Lic. C 24368
Dia. Drill Hole sketch & Locations

Scale 1" = 50 feet

MAG. NORTH

Base Line

DDH # 60 45° Depth 129 FT. → drilled Oct 5-10-74
100° E on ASWITH

DDH # 2 50° Depth 152' FT. → drilled Aug 11 to 31/74
100° E on ASWITH
Approx Location B & W NO 4 D.D.H. 310' E of Claim Posts drilled 1965.
USE depth 150' approx 270° W. on ASWITH

23 106 FT

DDH # 3 45° Depth 118' FT. → drilled Sept 1 to 20/74
100° E on ASWITH
drilled Aug 6-10/74
D.D.H # I = 201 FT E. of Claim Posts
deepened to 124' Oct 1. to 4/74

E & W. Claim Line

Claim No
398740

Claim No
398724

DDH # 4 60° 102 FT. depth. → drilled Sept 21-26 Sept 25/74
125° E. on ASWITH

DDH # 5 45° 104 FT depth → drilled Sept 26 to 30/74
115° E on ASWITH

Signed H. Niemetz

DIAMOND DRILL LOG

COMPANY _____ Page # 1

PROPERTY H. Niemetz, Briggs Township N. T. S. # _____

PURPOSE OF HOLE Assessment work

Start Aug. 11/1974 Hole HN 2 Az ~~100~~ 100° Dip -50°

Finish August 31/1974 Lat. _____ Dep. _____ El. _____

Tests 106'E, 42'N Post 3 Claim 398723 Length 152'

Footage		Description	Sample No.	Assays.	
From	To			Au	
0	1	Casing			
1	152	Dacitic flows, pale to dark green, locally epidotized and or chloritic, weakly magnetic. Occasional clusters of pale cream/green lapilli to 1/4". Rare local seams of Py to 1/8" and sparse local chalcopyrite as noted.			
		38 - 35' Intense shear 20° to CA			
		35 - 43 as above, weak local fine dissemination of Cpy. in locally pyroclastic sections, estimated < 1/4% Cu.	10116	.02	
		43 - 47 Weak traces Cpy.	10117	Tr.	
		47 - 48.4 Core lost stick in box			
		48.4 - 51.5 as 43-47 (6' ground)	10118	.04	
		69.8 - 76 as 43-47	10119	Tr.	
		78.5 - 83.5 as 43-47	10120	.02	
		93.5 - 94.2 Est. 1/2% Cu, weak streaks of Cpy to 1/8", 60° to CA, parallel to interflow contact at	10121	.04	
		94.1 (Base of porphyritic dacite flow, tops away from collar of hole (very distinct). Top of this flow is frozen and semi gradational/brecciated slightly towards 100'			
		119.9 - 124.9 Weakly pyroclastic, probably flow top area, sparse Py and fine Cpy.	10122	Tr.	
		N.B.			
		144 - 152 Pale, felsitic flow top material.			
		END OF HOLE 152'			

DRILLED BY: H. Niemetz LOGGED BY: R. J. Graham

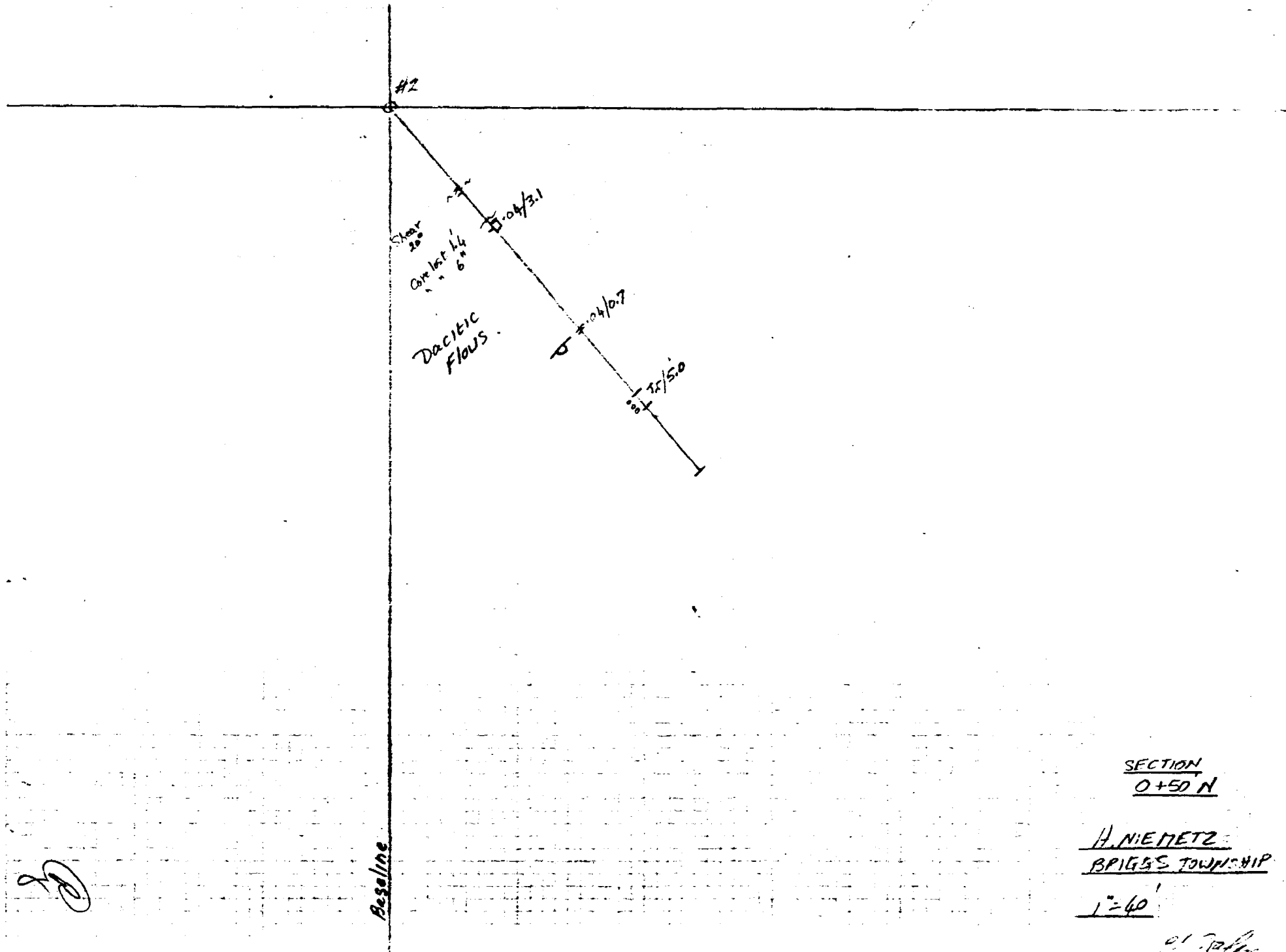

SECTION
0+50 N

H. NIEMETZ
BRIGGS TOWNSHIP

1"=40'

01/20/20

THE TOWNSHIP
OF

BRIGGS

DISTRICT OF
NIPISSING

LARLER LAKE
MINING DIVISION

SCALE: 1-INCH = 40 CHAINS

LEGEND

UNPATENTED LAND	(P)
BROWN LAND SALE	C.S.
LEASES	(L)
LOCATED LAND	Loc.
LICENSE OF OCCUPATION	L.O.
MINING RIGHTS ONLY	M.R.O.
SURFACE RIGHTS ONLY	S.R.O.
ROADS	=====
IMPROVED ROADS	=====
ENGINEER'S HIGHWAYS	=====
RAILWAYS	=====
POWER LINES	=====
WATERSHED OR MUSKEG	=====

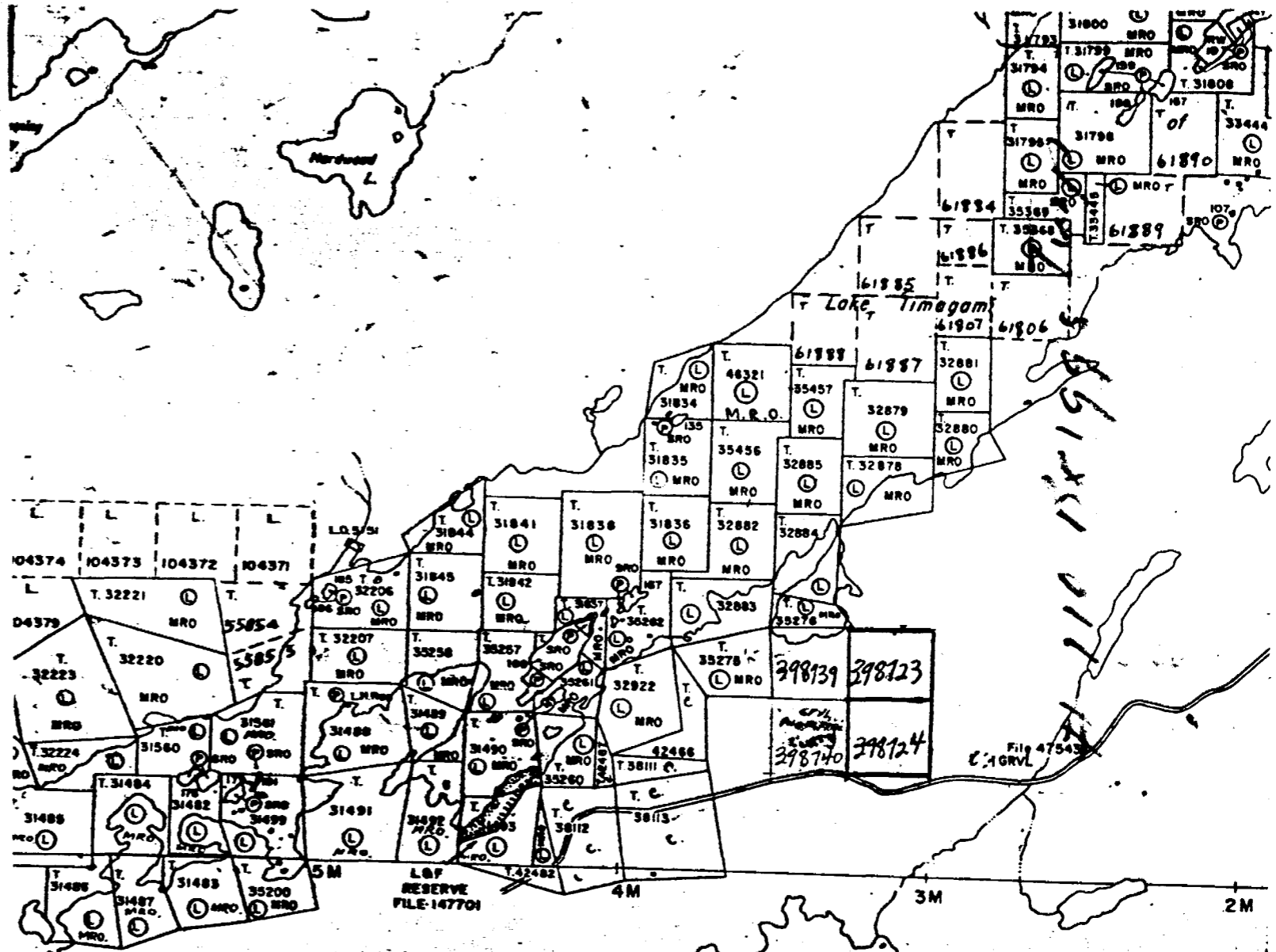

YATES TWP. M.616