



31L14SW2001 2.19647 MCAUSLAN

010

Fluxor Inc

Assessment Work Report

For

2.19647

Line cutting, Prospecting,

Geochemical Sampling and Assaying

And

Geological Mapping

on

Mining Claim S1212144

in

McAuslan Township

Ontario

August 1999

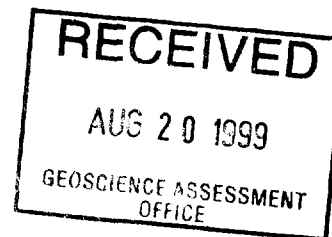

By Dr. William A. Hogg and Reginald H. Tays

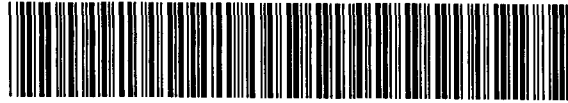

31L14SW2001 2.19647 McAUSLAN

010C

Table Of Contents

Introduction	2.19647	Page 1
Location and access		1
Line Cutting		2
Prospecting		2
Geochemistry		2
Geology		3
Structure		3
Conclusions and Recommendations		4

List Of Attachments

- Figure 1 Abstract of Title**
- Figure 2 Claim Location Sketch** 2 100 47 1
- Figure 3 Location Map**
- Figure 4 Schedule of Rock sample locations**
- Appendix 1 Geochemical Assay Results of current Work**
- Appendix 2 Geochemical Assay Reports of Previous Work**
- Appendix 3 Personnel who Performed the Work**
- Appendix 4 Photographs of Quartzite Deposits**
- Appendix 5 Statement of expenditures and Supporting Documents**
- Appendix 6 Statement of Qualifications by Dr. William A Hogg**
- Appendix 7 Statement of Qualifications by Mr. Reginald H Tays**
- Survey Plan # 1 Topographic Contour Map in Pocket 1**
- Survey Plan # 2 Geochemical Sample Location Map in pocket 2**
- Survey Plan # 3 Geology Map in pocket 3**

REPORT OF WORK

INTRODUCTION

The property was staked and recorded in the name of William A Hogg, client number 145307, on August 26, 1997 and subsequently transferred into the name of Fluxor Inc, Client number 392371.

The claim is recorded as number S1212144, comprises 6, 16 hectare units covering a total area of 96 hectares. The Abstract of title is enclosed as Figure 1. The property location in McAuslan Township is shown on Figures 2 and 3 of this report. The property is heavily forested with stands of pine, other coniferous and various deciduous species. In the northerly part heavy undergrowth is prevalent. The property is underlain by fine glacial sand, boulders and high ridges of orthoquartzite

Prospecting, geochemical sampling and geological work was carried out during July and August of 1999. The purpose was to establish a line grid on the property to tie in the orthoquartzite outcrops, coordinate the geochemical sampling program, geological work and to coordinate the foregoing with work previously reported on the property and to determine the property's potential for an economic industrial mineral extraction operation.

Several stripped areas and trenched sites resulting from previous work were found during the prospecting work. The geological map included in this report shows the locations of those sites. A small bulk sample was taken from one of the sites and sent to Lakefield Research Ltd. for examination. The work performed during the current program is described in this report.

LOCATION AND ACCESS

The property is situated approximately 68 kilometers northeast of the city of North Bay, accessed via Provincial Highway 63 for 48 kilometers easterly to the MacConnell Lakes forest road then 20 kilometers northerly along that road to a bush trail for approximately 1 kilometer.

The forest road and the bush trails are mainly on high ground underlain with glacial sand material. A grid of forest and provincial roads connect the property to Diver Station on the Ontario Northland Railway 20 kilometers to the west and the Canadian Pacific Railway 15 kilometers to the east. The most practical route to service the property would appear to be via the MacConnell Lakes road to Provincial Highway 63 as shown on Figure 3.

LINE CUTTING

The line cutting program consisted of cutting and chaining 1240 meters of Base Line laid out in a magnetic north-south direction, 1350 meters of picket line cut and chained and 2500 meters of line was blazed and flagged. This work was done to create a grid to coordinate the current work and tie it in to the Quartzite outcrops and previous work done on the property.

PROSPECTING

This work was done to identify the boundaries of the quartzite outcrops, other rock formation and to assist the geology work and to identify other topographic features. This work extend previously identified quartzite deposits and confirms the locations of previously reported stripped areas, trenches and identify sites for rock samples to be taken. This work also served to identify other topographic features shown on the enclosed Geology map. This work together with other information was used to prepare a Topographic Contour Map of the property enclosed in Pocket 1

GEOCHEMISTRY

The geochemical sampling was done mainly on extensions of Quartzite outcrops identified by the prospecting work. In all 33 samples were taken as listed on Figure 4. Nineteen of the samples together with a 48 kg. sample described as a mini bulk sample were sent to Lakefield Research Ltd. for assaying. The assay laboratory report is enclosed as Appendix 1. Some of the unassayed samples were found to be near sites previously assayed and others were non-quartzite samples however, those samples served to support the Geology work. The assay locations are shown on a Rock Sample and Outcrop Location Map enclosed in Pocket 2.

Some information previously reported on the lands concerned, including 140 rock sample locations, are included on this map for reference information only. The assay laboratory results of those samples are shown on Appendix 2

GEOLOGY

A re-examination of the Quartzite outcrops in July, 1999 included a visit to a number of newly discovered outcrops during a sampling on the new grid pattern.

Bulk sample trenches were opened and sampled in an effort to determine the best uniform grade location for a potential economic deposit. The exposed outcrops on claim S1212144 are essentially all highly metamorphosed clastic quartzite. Other minor outcrops include a narrow diabase dyke and a underlying outcrop of felspathic and muscovite gneiss derived from subarkose and aluminous claystone.

The orthoquartzite is silica rich rock comprising silica sand including large rounded quartz rich boulders and pebbles. In place the silica sand is banded. Underlying the orthoquartzite are beds of muscovite gneiss. The orthoquartzite dips westerly at 40 to 45 degrees and probably has a true thickness of 150 meters.

This orthoquartzite rises prominently above the present landscape due in part to its resistance to weather and partly due to its folded and thrust nature

Estimates of nearly 40 meters above the sand plain may occur at its highest part. Several high grade silica zones occur along strike of the deposit. A narrow diabase dyke strikes northwesterly across the central part of property and appears to dip near vertical. The dyke is dark colored and is composed of hornblende, minor biotite and silica

STRUCTURE

A close tight folding has taken place and the clastic nature of the deposit has been highly metamorphosed. Remnants of rounder boulders and bedding still persist.

The bedding in the outcrops have a north strike with dips of 40 to 45 degrees.

Fault escarpments can be recognized along the east flank of the major outcrops and cross trending features are believed to be now occupied by diabase dykes.

CONCLUSIONS AND RECOMMENDATIONS

A review of the geological and structural study, the prospecting, the grid sampling and assays indicate the presence of a viable industrial mineral deposit .

Sites have been defined where the silica is considered to be of industrial value and has potential for various industry uses.

Access is not difficult for a quarry operation or large bulk sample if required. A firm gravel road currently used by gravel and lumbering operation is accessible to the property

Using the geochemical data as a guide extensive zones of higher than average silica can be outlined and selected for quarrying above ground level.

Respectfully submitted August 18, 1999

Fluxor Inc.

William A Hogg, Secretary-Treasurer

Reginald H Tays , President

Mining Lands - Mining Claims Summary**Sudbury - Division 70**

CLAIM NUMBER:	S 1212144 (Click Claim Number for Details)
Unit Size:	6
Township/Area:	MCAUSLAN (G-1630)
Lot Description:	
Staker:	POLSON DARREN RICHARD (K22370)
Recorded Holder:	FLUXOR INC. (100.00 %)
Recording Date:	1997-Aug-26
Due Date:	1999-Aug-26
Work Required:	2400
Total Applied:	0
Work Performed:	0
Total Reserve:	<u>0</u> (Click Reserve for Details)
Present Work Assignment:	0
Claim Bank:	0
Claim Status:	ACTIVE

| [Back](#) | [Main Menu](#) | [Mining Lands](#) |

© Copyright 1998 [Queen's Printer for Ontario](#)

This information is provided as a public service, but we cannot guarantee that the information is current or accurate.
Readers should verify the information before acting on it.

FIGURE 1.

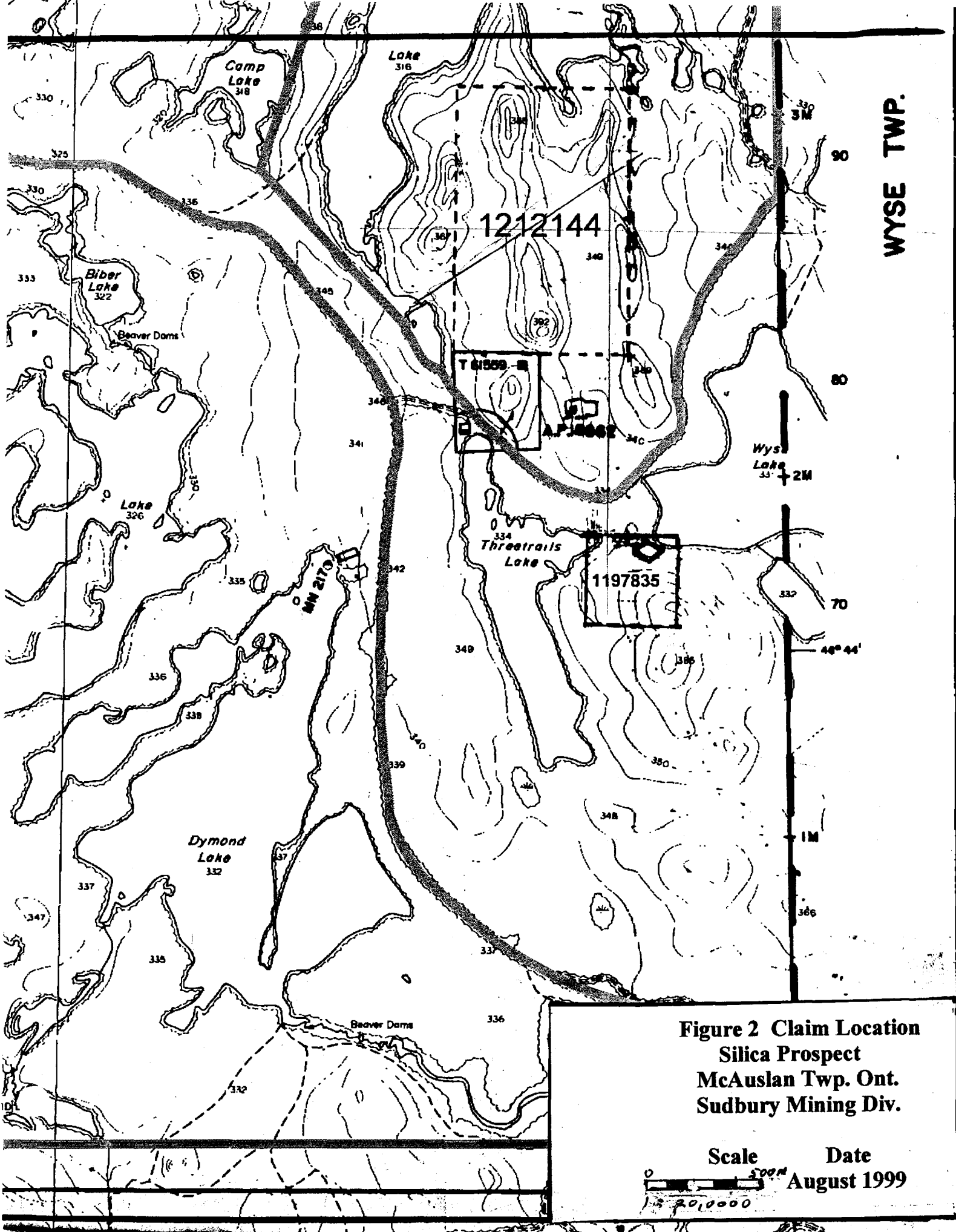

**Figure 2 Claim Location
Silica Prospect
McAuslan Twp. Ont.
Sudbury Mining Div.**

Scale **Date**
 0 500m August 1999
 1:20,000

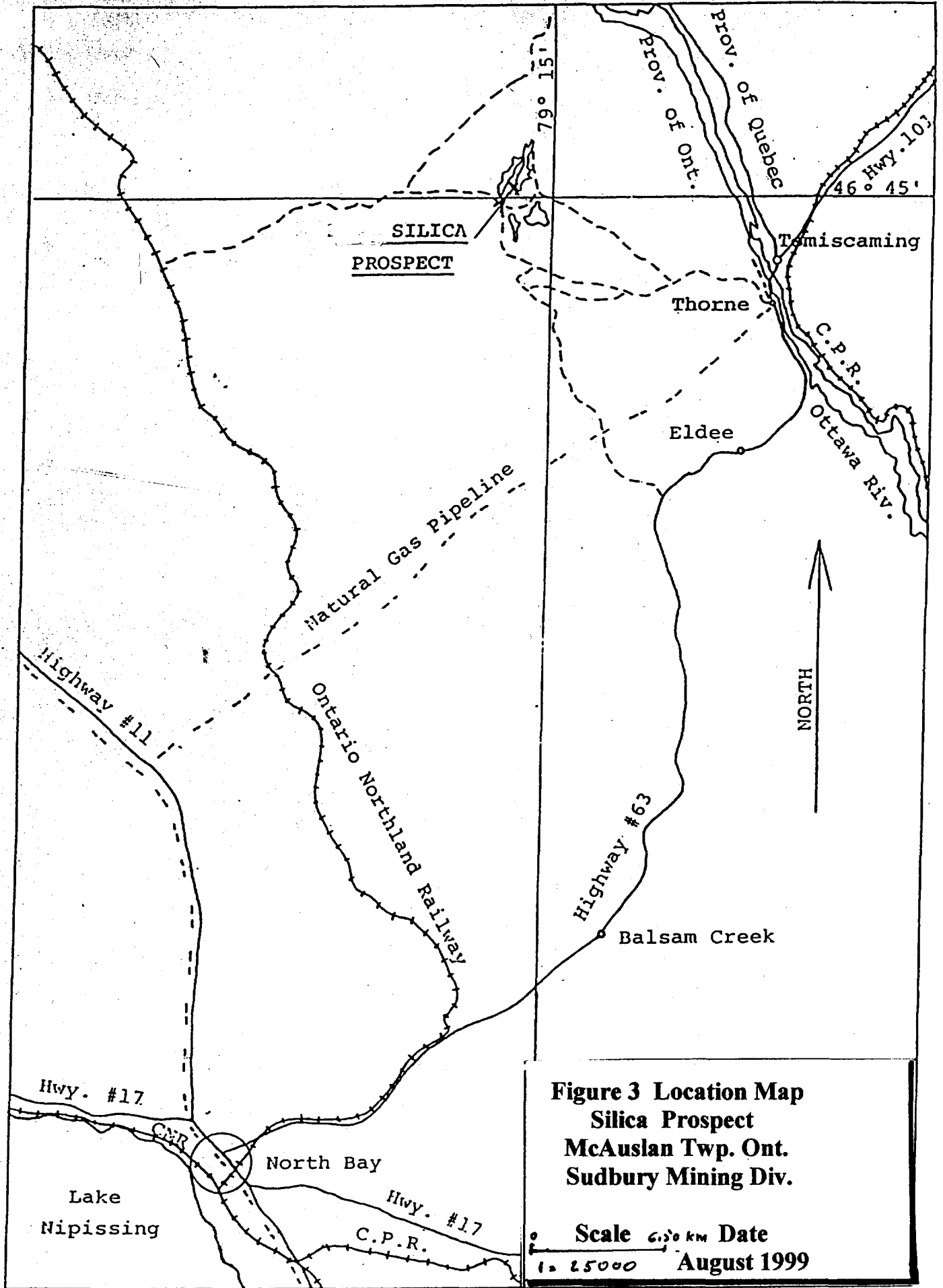

**Figure 3 Location Map
Silica Prospect
McAuslan Twp. Ont.
Sudbury Mining Div.**

Scale 1:25000 **Date** August 1999

Schedule of Rock Samples for the Geochemistry Work

Field sample number	Sample record number	Description of sample	Grid coordinate location where sample taken
S 1	801	E. side of Quartzite Zone 1	25 m north 290 m east
S 2	802	as above	60 m north 290 m east
S 3	803	as above	100 m north 290 m east
S 4	804	as above	100 m north 285 m east
S 5	901	W side of Quartzite Zone 1	200 m north 68 m east
S 6	902	as above	275 m north 90 m east
S 7	903	as above	400 m north 100 m east
S 8	904	as above	400 m north 180 m east
S 9	905	as above	500 m north 156 m east
S 10	906	as above	500 m north 181 m east
S 11	907	as above	560 m north 160 m east
S 12	908	as above	540 m north 90 m east
S 13	909	on Quartzite Zone 1	700 m north 208 m east
S 14	910	as above	670 m north 180 m east
S 15	911	E side of Quartzite Zone 3	900 m north 37 m west
S 16	912	on Quartzite Zone 2	900 m north 120 m east
S 17	913	As above	900 m north 180 m east
S 18	805	on quartzite Zone 3	950 m north 75 m west
S 19	914	on Quartzite Zone 1	600 m north 210 m east
S 20	915	on Quartzite Zone 4	600 m north 173 m west
S 21	916	as above	600 m north 223 m west
S 22	917	as above	600 m north 123 m west
S 23	918	as above	500 m north 227 m west
S 24	919	as above	500 m north 180 m west
S 25	807	E side of Quartzite Zone 4	650 m north 70 m west
S 26	920	on Quartzite Zone 4	550 m north 90 m west
S 27	808	Diabase material	700 m north 100 m east
S 28	921	on Quartzite Zone 4	800 m north 70 m west
S 29	809	E side Quartzite Zone 4	750 m north 30 m west
S 30	810	as above	700 m north 30 m west
S 31	922	Diabase material	850 m north 0+00 west
S 32	806	Quartzite in trench Zone 4	500 m north 150 m west
S 33	923	Mini bulk sample Zone 1	67 m north 60 m east

Legend = 800 series not assayed. 900 series assayed at Lakefield.

Figure 4

LAKEFIELD RESEARCH LIMITED

Postal Bag 4300, 185 Concession St., Lakefield, Ontario, K0L 2H0
Phone : 705-652-2038 FAX : 705-652-6441

Mineral Processing

Lakefield, August 18, 1999

Attn : TB

Date Rec. : August 11, 1999
LR. Ref. : AUG0075.R99
Reference : Fluxor Inc.
Project : 5530

CERTIFICATE OF ANALYSIS

No.	Sample ID	SiO2 %	Al2O3 %	Fe2O3 %	MgO %	CaO %	Na2O %	K2O %	TiO2 %	P2O5 %	MnO %	Cr2O3 %	V2O5 %	LOI %	SUM %
1	F901	91.2	--	--	--	--	--	--	--	--	--	--	--	--	--
2	F902	93.9	--	--	--	--	--	--	--	--	--	--	--	--	--
3	F903	94.8	--	--	--	--	--	--	--	--	--	--	--	--	--
4	F904	94.5	--	--	--	--	--	--	--	--	--	--	--	--	--
5	F905	95.2	--	--	--	--	--	--	--	--	--	--	--	--	--
6	F906	88.2	--	--	--	--	--	--	--	--	--	--	--	--	--
7	F907	95.4	--	--	--	--	--	--	--	--	--	--	--	--	--
8	F908	93.6	--	--	--	--	--	--	--	--	--	--	--	--	--
9	F909	96.6	--	--	--	--	--	--	--	--	--	--	--	--	--
10	F910	88.1	--	--	--	--	--	--	--	--	--	--	--	--	--
11	F911	92.8	--	--	--	--	--	--	--	--	--	--	--	--	--
12	F912	95.1	--	--	--	--	--	--	--	--	--	--	--	--	--
13	F913	96.2	--	--	--	--	--	--	--	--	--	--	--	--	--
14	F914	92.2	--	--	--	--	--	--	--	--	--	--	--	--	--
15	F915	99.5	--	--	--	--	--	--	--	--	--	--	--	--	--
16	F916	99.7	--	--	--	--	--	--	--	--	--	--	--	--	--

page 1/2

Appendix 1 - 1

FROM : LAKEFIELD RESEARCH

FAX NO. : 7056525213

08-18-99 08:57A P.03

LAKEFIELD RESEARCH LIMITED

Postal Bag 4300, 185 Concession St., Lakefield, Ontario, K0L 2H0

Phone : 705-652-2038

FAX : 705-652-6441

AUG0075.R99

No.	Sample ID	SiO2 %	Al2O3 %	Fe2O3 %	MgO %	CaO %	Na2O %	K2O %	TiO2 %	P2O5 %	MnO %	Cr2O3 %	V2O5 %	LOI %	SUM %
17	F917	97.6	--	--	--	--	--	--	--	--	--	--	--	--	--
18	F918	98.6	--	--	--	--	--	--	--	--	--	--	--	--	--
19	F919	98.6	--	--	--	--	--	--	--	--	--	--	--	--	--
20	F920	96.4	--	--	--	--	--	--	--	--	--	--	--	--	--
21	F921	88.4	--	--	--	--	--	--	--	--	--	--	--	--	--
22	F922	57.3	14.5	9.72	6.34	4.85	6.12	0.55	0.50	0.16	0.23	0.02	0.03	1.11	101.4
--	Check --														
23	F910	88.8	--	--	--	--	--	--	--	--	--	--	--	--	--
24	F919	99.7	--	--	--	--	--	--	--	--	--	--	--	--	--

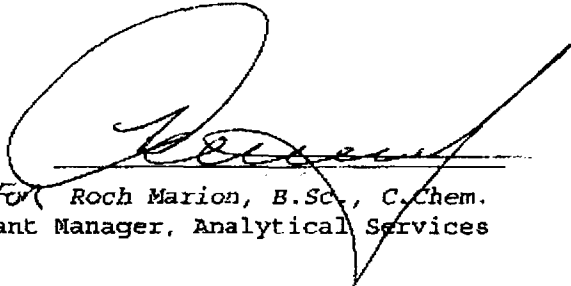

For Roch Marion, B.Sc., C.Chem.
Assistant Manager, Analytical Services

A MEMBER OF IAETL CANADA

Accredited by the Standards Council of Canada in partnership with CAEAL to the ISO/IEC Guide 25 standard for specific registered tests.

The analytical results reported herein refer to the samples as received. Reproduction of this analytical report in full or in part is prohibited without prior written approval.

Appendix 1 - 2

FROM : LAKEFIELD RESEARCH

FAX NO. : 7056525213

08-18-99 08:57A P.04

LAKEFIELD RESEARCH LIMITED

P.O. Box 4300, 185 Concession St., Lakefield, Ontario, K0L 2H0

Phone : 705-652-2038 FAX : 705-652-6441

Mineral Processing

Attn : TB

Lakefield, August 18, 1999

Date Rec. : July 16, 1999
LR. Ref. : JUL0191.R99
Reference : N/A
Project : 5530

CERTIFICATE OF ANALYSIS

No.	Sample ID	SiO2 %	Al2O3 %	Fe2O3 %	MgO %	CaO %	Na2O %	K2O %	TiO2 %	P2O5 %	MnO %	Cr2O3 %	V2O5 %	LOI %	SUM %
1	Bulk Sample	93.1	3.39	1.04	0.05	0.03	0.28	0.32	0.10	0.02	< 0.01	0.03	< 0.01	0.32	98.7

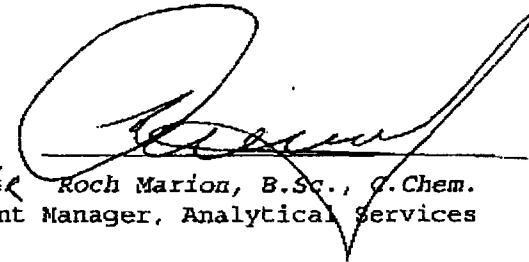

Roch Marion, B.Sc., C.Chem.
Assistant Manager, Analytical Services

A MEMBER OF IAETL CANADA

Accredited by the Standards Council of Canada in partnership with CAEAL to the ISO/IEC Guide 25 standard for specific registered tests.

The analytical results reported herein refer to the samples as received. Reproduction of this analytical report in full or in part is prohibited without prior written approval.

Appendix 1 - 3

FROM : LAKEFIELD RESEARCH

FAX NO. : 7056525213

08-18-99 08:56A P.02

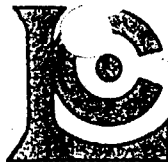

Chemex Labs Ltd.

Analytical Chemists * Geochemists * Registered Assayers
 5175 Timberlea Blvd., Mississauga,
 Ontario, Canada L4W 2S3
 PHONE: 416-624-2806

HOGG, WILLIAM A.

22 MAXOME AVE.
 WILLOWDALE, ON
 M2M 3J9

Page Number: 1-A
 Total Pages: 3
 Invoice Date: 27-SEP-90
 Invoice No.: I-9022592
 P.O. Number:

Project:
 Comments:

CERTIFICATE OF ANALYSIS A9022592

SAMPLE DESCRIPTION	PREP CODE	SiO2 % fusion	Ag ppm AAS	Al % (ICP)	Ba ppm (ICP)	Be ppm (ICP)	Bi ppm (ICP)	Ca % (ICP)	Cd ppm (ICP)	Co ppm (ICP)	Cr ppm (ICP)	Cu ppm (ICP)	Fe % (ICP)	K % (ICP)	Mg % (ICP)
294501	208 294	92.23	< 0.5	0.79	50	< 0.5	< 2	0.26	< 0.5	1	192	8	0.71	0.24	0.09
294502	208 294	90.46	< 0.5	0.57	10	< 0.5	< 2	0.07	< 0.5	1	169	9	0.48	0.15	0.03
294503	208 294	93.57	< 0.5	0.29	< 10	< 0.5	< 2	0.01	< 0.5	< 1	135	1	0.37	0.07	< 0.01
294504	208 294	94.28	< 0.5	0.38	10	< 0.5	< 2	0.01	< 0.5	< 1	108	1	0.46	0.11	< 0.01
294505	208 294	92.82	< 0.5	0.41	< 10	< 0.5	< 2	< 0.01	< 0.5	< 1	127	2	0.40	0.07	< 0.01
294506	208 294	94.12	< 0.5	0.34	< 10	< 0.5	< 2	0.02	< 0.5	2	164	5	0.34	0.06	< 0.01
294507	208 294	93.08	< 0.5	0.37	10	< 0.5	< 2	< 0.01	< 0.5	< 1	140	2	0.30	0.08	< 0.01
294508	208 294	92.66	< 0.5	1.73	90	< 0.5	< 2	0.01	< 0.5	2	318	2	0.55	0.70	0.02
294509	208 294	92.41	< 0.5	0.83	20	< 0.5	< 2	< 0.01	< 0.5	< 1	276	1	0.45	0.24	< 0.01
294510	208 294	92.28	< 0.5	0.89	80	< 0.5	< 2	< 0.01	< 0.5	< 1	193	1	0.59	0.30	< 0.01
294511	208 294	92.41	< 0.5	2.00	140	< 0.5	< 2	< 0.01	< 0.5	3	263	2	0.52	0.84	0.01
294512	208 294	71.91	< 0.5	6.95	1310	2.0	2	0.04	< 0.5	16	239	1	2.36	3.63	0.87
294513	208 294	93.75	< 0.5	1.25	180	< 0.5	< 2	< 0.01	< 0.5	1	272	3	0.57	0.51	0.01
294514	208 294	91.21	< 0.5	1.19	110	< 0.5	< 2	< 0.01	< 0.5	1	258	3	0.57	0.45	0.01
294515	208 294	94.06	< 0.5	0.56	20	< 0.5	< 2	< 0.01	< 0.5	< 1	155	1	0.32	0.20	< 0.01
294516	208 294	93.58	< 0.5	0.53	40	< 0.5	< 2	< 0.01	< 0.5	1	187	1	0.37	0.18	< 0.01
294517	208 294	94.91	< 0.5	0.34	< 10	< 0.5	< 2	< 0.01	< 0.5	< 1	178	1	0.30	0.10	< 0.01
294518	208 294	89.68	< 0.5	0.75	80	< 0.5	< 2	< 0.01	< 0.5	< 1	345	2	0.64	0.21	< 0.01
294519	208 294	92.43	< 0.5	0.43	20	< 0.5	< 2	< 0.01	< 0.5	< 1	281	1	0.77	0.12	< 0.01
294520	208 294	88.97	< 0.5	0.46	< 10	< 0.5	< 2	< 0.01	< 0.5	< 1	306	4	0.40	0.09	< 0.01
294521	208 294	93.98	< 0.5	0.49	10	< 0.5	< 2	< 0.01	< 0.5	< 1	194	4	0.37	0.13	< 0.01
294522	208 294	94.58	< 0.5	0.79	40	< 0.5	< 2	< 0.01	< 0.5	1	229	2	0.39	0.26	< 0.01
294523	208 294	94.15	< 0.5	1.50	120	< 0.5	< 2	< 0.01	< 0.5	1	222	1	0.42	0.63	0.01
294524	208 294	96.33	< 0.5	0.93	110	< 0.5	< 2	< 0.01	< 0.5	< 1	252	1	0.47	0.41	< 0.01
294525	208 294	91.66	< 0.5	0.66	60	< 0.5	< 2	< 0.01	< 0.5	1	270	2	0.61	0.23	< 0.01
294526	208 294	96.54	< 0.5	0.18	< 10	< 0.5	< 2	< 0.01	< 0.5	< 1	264	1	0.36	0.04	< 0.01
294527	208 294	91.76	< 0.5	0.49	50	< 0.5	< 2	< 0.01	< 0.5	< 1	282	3	0.53	0.14	< 0.01
294528	208 294	96.52	< 0.5	0.11	< 10	< 0.5	< 2	< 0.01	< 0.5	< 1	261	1	0.34	< 0.01	< 0.01
294529	208 294	93.89	< 0.5	0.40	60	< 0.5	< 2	< 0.01	< 0.5	< 1	221	1	0.50	0.12	< 0.01
294530	208 294	94.49	< 0.5	0.55	50	0.5	< 2	< 0.01	< 0.5	1	417	1	0.64	0.16	< 0.01
294531	208 294	92.45	< 0.5	0.27	< 10	< 0.5	< 2	< 0.01	< 0.5	< 1	264	3	0.47	0.02	< 0.01
294532	208 294	93.95	< 0.5	0.58	10	< 0.5	< 2	< 0.01	< 0.5	< 1	177	1	0.40	0.17	< 0.01
294533	208 294	97.05	< 0.5	0.83	40	< 0.5	< 2	< 0.01	< 0.5	< 1	302	2	0.42	0.34	< 0.01
294534	208 294	90.80	< 0.5	2.38	140	0.5	< 2	< 0.01	< 0.5	2	299	1	0.65	0.97	0.02
294535	208 294	92.97	< 0.5	0.86	60	< 0.5	< 2	< 0.01	< 0.5	1	230	1	0.42	0.32	< 0.01
294536	208 294	91.34	< 0.5	1.03	50	< 0.5	< 2	< 0.01	< 0.5	2	278	1	0.67	0.38	0.01
294537	208 294	93.94	< 0.5	0.36	40	< 0.5	< 2	< 0.01	< 0.5	< 1	269	2	0.38	0.09	< 0.01
294538	208 294	95.04	< 0.5	0.17	< 10	< 0.5	< 2	< 0.01	< 0.5	< 1	226	< 1	0.31	0.02	< 0.01
294539	208 294	90.93	< 0.5	0.37	20	< 0.5	< 2	< 0.01	< 0.5	< 1	222	1	0.42	0.08	< 0.01
294540	208 294	92.21	< 0.5	0.35	10	< 0.5	< 2	< 0.01	< 0.5	1	217	2	0.51	0.07	< 0.01

CERTIFICATION:

B. Coughlin
 A-APPENDIX 2-1



Chemex Labs Ltd.

Analytical Chemists * Geochemists * Registered Assayers
 5175 Timberlea Blvd., Mississauga,
 Ontario, Canada L4W 2S3
 PHONE: 416-624-2806

HOGG, WILLIAM A.

22 MAXOME AVE.
 WILLOWDALE, ON
 M2M 3J9

Page Number: 1-B
 Total Pages: 3
 Invoice Date: 27-SEP-90
 Invoice No.: 1-9022592
 P.O. Number:

Project:
 Comments:

CERTIFICATE OF ANALYSIS

A9022592

SAMPLE DESCRIPTION	PREP CODE	Mn ppm (ICP)	Mo ppm (ICP)	Na % (ICP)	Ni ppm (ICP)	P ppm (ICP)	Pb ppm (ICP)	Sr ppm (ICP)	Ti % (ICP)	V ppm (ICP)	W ppm (ICP)	Zn ppm (ICP)			
294501	208 294	95	< 1	0.05	6	40*	2	26	0.03	.14	< 10	14			
294502	208 294	55	< 1	0.02	5	30	8	16	0.01	5	< 10	10			
294503	208 294	20	< 1	0.01	3	30	8	20	0.01	2	< 10	6			
294504	208 294	25	< 1	0.01	3	20	4	13	0.01	2	< 10	2			
294505	208 294	20	< 1	0.01	2	30	4	24	0.01	2	< 10	4			
294506	208 294	25	< 1	0.01	4	70	4	17	< 0.01	2	< 10	2			
294507	208 294	75	< 1	0.01	3	20	4	17	< 0.01	2	< 10	2			
294508	208 294	30	< 1	0.08	7	40	4	52	0.04	6	< 10	12			
294509	208 294	25	< 1	0.02	4	20	< 2	16	0.02	2	< 10	6			
294510	208 294	40	< 1	0.03	4	20	2	21	0.02	2	< 10	4			
294511	208 294	25	< 1	0.09	6	30	2	34	0.03	4	< 10	6			
294512	208 294	1775	< 1	0.28	24	180	2	33	0.28	57	< 10	122			
294513	208 294	170	< 1	0.05	5	50	< 2	25	0.03	8	< 10	2			
294514	208 294	20	< 1	0.05	4	50	< 2	26	0.03	6	< 10	4			
294515	208 294	15	< 1	0.02	4	20	< 2	18	0.01	3	< 10	2			
294516	208 294	20	< 1	0.02	3	30	< 2	16	0.01	4	< 10	2			
294517	208 294	15	< 1	0.01	3	30	< 2	29	0.01	2	< 10	10			
294518	208 294	25	< 1	0.03	4	50	< 2	33	0.02	4	< 10	6			
294519	208 294	50	< 1	0.01	6	40	< 2	25	0.02	3	< 10	4			
294520	208 294	30	< 1	0.01	4	30	< 2	18	0.01	2	< 10	6			
294521	208 294	30	< 1	0.02	4	30	< 2	21	0.01	2	< 10	6			
294522	208 294	30	< 1	0.03	3	50	2	22	0.01	2	< 10	6			
294523	208 294	20	< 1	0.07	5	20	4	29	0.02	3	< 10	4			
294524	208 294	15	< 1	0.04	3	30	< 2	11	0.02	6	< 10	4			
294525	208 294	20	< 1	0.02	4	40	< 2	16	0.02	6	< 10	6			
294526	208 294	15	< 1	0.01	4	30	< 2	23	< 0.01	2	< 10	6			
294527	208 294	30	< 1	0.01	4	70	< 2	36	0.01	3	< 10	6			
294528	208 294	20	< 1	< 0.01	3	10	4	11	< 0.01	1	< 10	14			
294529	208 294	20	< 1	0.01	4	50	2	26	0.01	2	< 10	6			
294530	208 294	30	< 1	0.02	5	30	2	18	0.01	4	< 10	10			
294531	208 294	35	< 1	0.01	5	40	4	24	0.01	2	< 10	6			
294532	208 294	30	< 1	0.02	3	30	< 2	30	0.01	2	< 10	6			
294533	208 294	25	< 1	0.04	5	20	< 2	25	0.01	4	< 10	8			
294534	208 294	20	< 1	0.12	6	30	< 2	41	0.05	4	< 10	4			
294535	208 294	20	< 1	0.04	3	40	< 2	29	0.02	2	< 10	4			
294536	208 294	30	< 1	0.05	4	40	< 2	27	0.03	4	< 10	4			
294537	208 294	25	< 1	0.01	3	30	< 2	19	0.01	1	< 10	6			
294538	208 294	20	< 1	< 0.01	3	20	< 2	15	< 0.01	1	< 10	4			
294539	208 294	20	< 1	0.01	5	40	< 2	19	0.01	2	< 10	4			
294540	208 294	25	< 1	0.01	4	40	< 2	19	0.01	3	< 10	4			

CERTIFICATION:

B. Conklin
 APPENDIX 2-2



Chemex Labs Ltd.

Analytical Chemists * Geochemists * Registered Assayers
 5175 Timberlea Blvd., Mississauga,
 Ontario, Canada L4W 2S3
 PHONE: 416-624-2806

HOGG, WILLIAM A.

22 MAXOME AVE.
 WILLOWDALE, ON
 M2M 3J9

Page No.: 2-A
 Total Pages: 3
 Invoice Date: 27-SEP-90
 Invoice No.: I-9022592
 P.O. Number:

Project:
 Comments:

CERTIFICATE OF ANALYSIS

A9022592

SAMPLE DESCRIPTION	PREP CODE	SiO2 % fusion	Ag ppm AAS	Al % (ICP)	Ba ppm (ICP)	Be ppm (ICP)	Bi ppm (ICP)	Ca % (ICP)	Cd ppm (ICP)	Co ppm (ICP)	Cr ppm (ICP)	Cu ppm (ICP)	Fe % (ICP)	K % (ICP)	Mg % (ICP)
294541	208 294	94.89	< 0.5	0.35	40	< 0.5	< 2	< 0.01	< 0.5	< 1	156	2	0.33	0.10	< 0.01
294542	208 294	92.74	< 0.5	0.73	40	< 0.5	< 2	< 0.01	< 0.5	< 1	246	2	0.39	0.26	< 0.01
294543	208 294	94.71	< 0.5	0.60	70	< 0.5	< 2	< 0.01	< 0.5	1	182	2	0.42	0.24	< 0.01
294544	208 294	95.39	< 0.5	0.36	170	< 0.5	< 2	< 0.01	< 0.5	< 1	214	1	0.39	0.12	< 0.01
294545	208 294	95.25	< 0.5	1.37	50	< 0.5	< 2	< 0.01	< 0.5	1	197	< 1	0.38	0.62	< 0.01
294546	208 294	90.88	< 0.5	2.60	210	< 0.5	< 2	0.01	< 0.5	4	252	< 1	0.87	1.27	0.01
294547	208 294	92.15	< 0.5	2.14	300	< 0.5	< 2	< 0.01	< 0.5	< 1	209	1	0.58	0.93	0.01
294548	208 294	93.77	< 0.5	0.57	40	< 0.5	< 2	< 0.01	< 0.5	< 1	191	1	0.82	0.20	< 0.01
294549	208 294	94.57	< 0.5	0.50	50	< 0.5	< 2	< 0.01	< 0.5	< 1	163	2	0.44	0.16	< 0.01
294550	208 294	93.10	< 0.5	0.31	10	< 0.5	< 2	< 0.01	< 0.5	< 1	179	< 1	0.38	0.09	< 0.01
294601	208 294	93.84	< 0.5	0.47	10	< 0.5	< 2	< 0.01	< 0.5	< 1	156	2	0.39	0.12	< 0.01
294602	208 294	92.56	< 0.5	0.51	40	< 0.5	< 2	< 0.01	< 0.5	1	150	1	0.52	0.15	< 0.01
294603	208 294	93.22	< 0.5	0.48	10	< 0.5	< 2	< 0.01	< 0.5	< 1	162	1	0.62	0.17	< 0.01
294604	208 294	93.82	< 0.5	0.42	20	< 0.5	< 2	< 0.01	< 0.5	< 1	260	1	0.60	0.12	< 0.01
294605	208 294	95.43	< 0.5	1.42	40	< 0.5	< 2	< 0.01	< 0.5	< 1	227	1	0.45	0.63	< 0.01
294606	208 294	98.58	< 0.5	0.20	50	< 0.5	< 2	< 0.01	< 0.5	< 1	293	< 1	0.29	0.08	< 0.01
294651	208 294	92.40	< 0.5	0.49	10	< 0.5	< 2	< 0.01	< 0.5	< 1	286	1	0.67	0.17	< 0.01
294652	208 294	96.14	< 0.5	0.36	10	< 0.5	< 2	< 0.01	< 0.5	< 1	200	1	0.30	0.11	< 0.01
294653	208 294	94.13	< 0.5	0.33	20	< 0.5	< 2	< 0.01	< 0.5	< 1	200	1	0.36	0.08	< 0.01
294654	208 294	92.15	< 0.5	0.59	30	< 0.5	< 2	< 0.01	< 0.5	1	107	2	0.38	0.19	< 0.01
294655	208 294	95.79	< 0.5	0.57	30	< 0.5	< 2	0.01	< 0.5	1	199	1	0.44	0.13	< 0.01
294656	208 294	93.62	< 0.5	1.77	100	0.5	< 2	< 0.01	< 0.5	2	174	4	0.59	0.78	0.01
294657	208 294	86.69	< 0.5	4.05	260	1.0	< 2	0.03	< 0.5	5	274	< 1	1.38	1.74	0.04
294658	208 294	89.21	< 0.5	3.26	160	1.0	< 2	< 0.01	< 0.5	3	237	< 1	0.66	1.40	0.02
294659	208 294	96.47	< 0.5	0.48	10	< 0.5	< 2	< 0.01	< 0.5	1	206	1	0.36	0.17	< 0.01
294660	208 294	91.86	< 0.5	0.84	50	< 0.5	< 2	< 0.01	< 0.5	< 1	161	< 1	0.51	0.28	< 0.01
294661	208 294	88.73	< 0.5	0.98	70	0.5	< 2	< 0.01	< 0.5	1	183	1	0.72	0.35	0.01
294662	208 294	94.80	< 0.5	0.16	< 10	< 0.5	< 2	< 0.01	< 0.5	1	184	1	0.36	< 0.01	< 0.01
294663	208 294	94.17	< 0.5	0.29	< 10	< 0.5	< 2	< 0.01	< 0.5	1	167	2	0.50	0.06	< 0.01
294664	208 294	96.00	< 0.5	0.32	10	< 0.5	< 2	< 0.01	< 0.5	2	183	2	0.36	0.08	< 0.01
294665	208 294	95.93	< 0.5	0.44	30	< 0.5	< 2	< 0.01	< 0.5	1	213	3	0.38	0.14	< 0.01
294666	208 294	96.20	< 0.5	0.28	10	< 0.5	< 2	< 0.01	< 0.5	1	190	2	0.34	0.08	< 0.01
294667	208 294	94.99	< 0.5	0.67	70	< 0.5	< 2	< 0.01	< 0.5	1	272	2	0.50	0.25	< 0.01
294668	208 294	97.81	< 0.5	0.38	20	< 0.5	< 2	0.01	< 0.5	2	337	4	0.40	0.12	< 0.01
294669	208 294	98.20	< 0.5	0.25	20	< 0.5	< 2	0.01	< 0.5	1	165	3	0.22	0.10	< 0.01
294670	208 294	92.00	< 0.5	0.69	40	< 0.5	< 2	0.01	< 0.5	2	342	4	0.60	0.18	< 0.01
294671	208 294	92.35	< 0.5	0.58	40	< 0.5	< 2	0.01	< 0.5	3	376	4	0.73	0.14	< 0.01
294672	208 294	78.11	< 0.5	1.13	50	< 0.5	< 2	0.01	< 0.5	9	499	1	3.12	0.24	0.01
294673	208 294	93.67	< 0.5	0.43	30	< 0.5	< 2	< 0.01	< 0.5	1	165	3	0.40	0.12	< 0.01
294674	208 294	98.39	< 0.5	0.06	< 10	< 0.5	< 2	0.02	< 0.5	1	344	5	0.41	< 0.01	< 0.01

CERTIFICATION:

B. Coughlin
 APPENDIX 2-3



Chemex Labs Ltd.

Analytical Chemists * Geochemists * Registered Assayers
 5175 Timberlea Blvd., Mississauga,
 Ontario, Canada L4W 2S3
 PHONE: 416-624-2806

HOGG, WILLIAM A.

22 MAXOME AVE.
 WILLOWDALE, ON
 M2M 3J9

Page 1 of 3
 Total Pages : 3
 Invoice Date: 27-SEP-90
 Invoice No. : I-9022592
 P.O. Number :

Project :
 Comments :

CERTIFICATE OF ANALYSIS

A9022592

SAMPLE DESCRIPTION	PREP CODE	Mn ppm (ICP)	Mo ppm (ICP)	Na % (ICP)	Ni ppm (ICP)	P ppm (ICP)	Pb ppm (ICP)	Sr ppm (ICP)	Ti % (ICP)	V ppm (ICP)	W ppm (ICP)	Zn ppm (ICP)			
294541	208 294	20	< 1	0.01	4	40	< 2	22	0.01	2	< 10	6			
294542	208 294	30	< 1	0.03	4	50	< 2	14	0.01	3	< 10	4			
294543	208 294	15	< 1	0.02	4	30	< 2	8	0.02	6	< 10	2			
294544	208 294	10	< 1	0.01	3	20	< 2	9	0.01	4	< 10	4			
294545	208 294	10	< 1	0.06	3	20	< 2	14	0.02	8	< 10	2			
294546	208 294	20	< 1	0.11	6	50	< 2	22	0.09	12	< 10	4			
294547	208 294	15	< 1	0.10	4	80	< 2	25	0.05	25	< 10	4			
294548	208 294	15	< 1	0.02	3	50	< 2	29	0.02	6	< 10	2			
294549	208 294	15	< 1	0.01	4	20	< 2	9	0.02	5	< 10	4			
294550	208 294	15	< 1	0.01	1	20	< 2	9	0.01	1	< 10	4			
294601	208 294	15	< 1	0.02	3	30	< 2	21	0.01	3	< 10	6			
294602	208 294	20	< 1	0.01	3	40	< 2	16	0.01	10	< 10	8			
294603	208 294	60	< 1	0.01	5	30	< 2	22	0.02	6	< 10	4			
294604	208 294	15	< 1	0.01	4	50	< 2	33	0.02	4	< 10	6			
294605	208 294	20	< 1	0.06	4	20	< 2	25	0.03	5	< 10	4			
294606	208 294	20	< 1	0.01	4	10	< 2	2	< 0.01	2	< 10	4			
294651	208 294	25	< 1	0.01	5	20	< 2	14	0.02	3	< 10	6			
294652	208 294	20	< 1	0.01	3	10	< 2	9	< 0.01	2	< 10	< 2			
294653	208 294	25	< 1	0.01	4	20	< 2	15	0.01	2	< 10	6			
294654	208 294	35	< 1	0.02	4	40	< 2	23	0.01	2	< 10	2			
294655	208 294	25	< 1	0.02	5	40	< 2	25	0.01	2	< 10	6			
294656	208 294	20	< 1	0.08	3	50	< 2	38	0.04	4	< 10	4			
294657	208 294	30	< 1	0.22	9	90	< 2	73	0.14	17	< 10	8			
294658	208 294	15	< 1	0.17	6	40	< 2	48	0.05	10	< 10	2			
294659	208 294	30	< 1	0.02	4	50	< 2	25	0.01	2	< 10	2			
294660	208 294	25	< 1	0.03	3	40	< 2	29	0.03	2	< 10	2			
294661	208 294	105	< 1	0.03	7	60	< 2	50	0.03	4	< 10	4			
294662	208 294	25	< 1	< 0.01	4	30	< 2	10	< 0.01	< 1	< 10	6			
294663	208 294	25	< 1	0.01	4	30	< 2	12	0.01	2	< 10	2			
294664	208 294	20	< 1	0.01	3	40	< 2	7	0.01	2	< 10	4			
294665	208 294	20	< 1	0.01	5	30	< 2	6	0.01	5	< 10	4			
294666	208 294	15	< 1	0.01	3	30	< 2	6	0.01	3	< 10	6			
294667	208 294	20	< 1	0.02	5	40	< 2	17	0.02	6	< 10	8			
294668	208 294	20	< 1	0.01	3	60	< 2	35	< 0.01	4	< 10	6			
294669	208 294	40	< 1	0.01	3	30	< 2	10	< 0.01	2	< 10	8			
294670	208 294	30	< 1	0.02	7	60	< 2	28	0.02	4	< 10	6			
294671	208 294	40	< 1	0.02	10	50	< 2	20	0.02	4	< 10	4			
294672	208 294	150	< 1	0.03	17	100	< 2	31	0.22	10	< 10	14			
294673	208 294	30	< 1	0.02	3	40	< 2	11	0.01	1	< 10	2			
294674	208 294	60	< 1	< 0.01	8	90	< 2	14	< 0.01	2	< 10	10			

CERTIFICATION:

B. Coughlin
 APPENDIX 2-4c



Chemex Labs Ltd.

Analytical Chemists * Geochemists * Registered Assayers
 5175 Timberlea Blvd., Mississauga,
 Ontario, Canada L4W 2S3
 PHONE: 416-624-2806

HOGG, WILLIAM A.

22 MAXOME AVE.
 WILLOWDALE, ON
 M2M 3J9

Page No. : 3-A
 Total Pages: 3
 Invoice Date: 27-SEP-90
 Invoice No.: I-9022592
 P.O. Number:

Project :
 Comments:

CERTIFICATE OF ANALYSIS A9022592

SAMPLE DESCRIPTION	PREP CODE	SiO2 % fusion	Ag ppm AAS	Al % (ICP)	Ba ppm (ICP)	Be ppm (ICP)	Bi ppm (ICP)	Ca % (ICP)	Cd ppm (ICP)	Co ppm (ICP)	Cr ppm (ICP)	Cu ppm (ICP)	Fe % (ICP)	K % (ICP)	Mg % (ICP)
294675	208 294	91.17	< 0.5	2.31	130	1.0*	< 2	0.01	< 0.5	4	392	3	0.82	0.82	0.02
294676	208 294	96.66	< 0.5	0.76	80	< 0.5	< 2	0.01	< 0.5	2	428	3	0.45	0.31	0.01
294677	208 294	91.65	< 0.5	0.86	40	< 0.5	< 2	< 0.01	< 0.5	2	133	1	0.61	0.32	< 0.01
294678	208 294	91.42	< 0.5	1.09	50	< 0.5	< 2	< 0.01	< 0.5	3	384	2	1.05	0.35	< 0.01
294679	208 294	95.29	< 0.5	0.39	10	< 0.5	< 2	< 0.01	< 0.5	1	158	2	0.30	0.11	< 0.01
294680	208 294	96.35	< 0.5	0.54	< 10	< 0.5	< 2	< 0.01	< 0.5	1	307	3	0.39	0.03	< 0.01
294681	208 294	92.97	< 0.5	0.43	30	< 0.5	< 2	< 0.01	< 0.5	1	150	3	0.68	0.09	< 0.01
294682	208 294	94.69	< 0.5	0.42	20	< 0.5	< 2	0.01	< 0.5	3	190	3	0.41	0.10	< 0.01
294683	208 294	92.38	< 0.5	0.45	60	< 0.5	< 2	< 0.01	< 0.5	1	130	4	0.28	0.14	< 0.01
294684	208 294	93.57	< 0.5	0.93	100	< 0.5	< 2	0.01	< 0.5	2	400	4	0.52	0.32	0.01
294685	208 294	97.57	< 0.5	0.57	20	< 0.5	< 2	0.02	< 0.5	1	158	11	0.21	0.07	0.02
294686	208 294	94.99	< 0.5	0.77	40	< 0.5	< 2	0.02	< 0.5	2	426	8	0.49	0.20	0.01
294687	208 294	94.90	< 0.5	0.69	10	< 0.5	< 2	< 0.01	< 0.5	< 1	137	2	0.35	0.27	< 0.01
294688	208 294	95.62	< 0.5	0.34	< 10	< 0.5	< 2	< 0.01	< 0.5	2	310	3	0.53	0.09	< 0.01
294689	208 294	93.90	< 0.5	0.47	10	< 0.5	< 2	< 0.01	< 0.5	2	113	3	0.33	0.16	< 0.01
294690	208 294	95.43	< 0.5	0.31	30	< 0.5	< 2	< 0.01	< 0.5	1	278	4	0.44	0.06	< 0.01
294691	208 294	93.78	< 0.5	0.44	50	< 0.5	< 2	< 0.01	< 0.5	1	117	5	0.27	0.13	< 0.01
294692	208 294	90.32	< 0.5	0.51	20	< 0.5	< 2	0.01	< 0.5	3	338	4	0.94	0.07	< 0.01
294693	208 294	91.03	< 0.5	1.24	30	< 0.5	< 2	0.01	< 0.5	3	584	7	0.85	0.26	0.01
294694	208 294	95.59	< 0.5	0.32	10	< 0.5	< 2	< 0.01	< 0.5	1	225	3	0.51	0.06	< 0.01
294695	208 294	95.00	< 0.5	1.01	130	< 0.5	< 2	< 0.01	< 0.5	1	140	2	0.29	0.40	0.01
294696	208 294	79.52	< 0.5	1.84	170	0.5	< 2	0.01	< 0.5	5	234	2	1.39	0.61	0.01
294697	208 294	90.33	< 0.5	1.35	110	0.5	< 2	0.01	0.5	3	268	3	0.78	0.50	0.01
294698	208 294	92.34	< 0.5	0.61	40	< 0.5	< 2	0.01	< 0.5	3	382	4	0.71	0.12	< 0.01
294699	208 294	94.30	< 0.5	0.39	20	< 0.5	< 2	< 0.01	< 0.5	2	250	4	0.55	0.08	< 0.01
294700	208 294	94.17	< 0.5	0.92	60	0.5	< 2	< 0.01	< 0.5	2	233	5	0.50	0.29	< 0.01

CERTIFICATION:

B. Coughlin
 APPENDIX 2-5

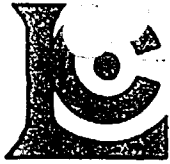

Chemex Labs Ltd.

Analytical Chemists * Geochemists * Registered Assayers
 5175 Timberlea Blvd., Mississauga,
 Ontario, Canada L4W 2S3
 PHONE: 416-624-2806

HOGG, WILLIAM A.

22 MAXOME AVE.
 WILLOWDALE, ON
 M2M 3J9

Page Number: 3-B
 Total Pages: 3
 Invoice Date: 27-SEP-90
 Invoice No.: I-9022592
 P.O. Number:

Project:
 Comments:

CERTIFICATE OF ANALYSIS

A9022592

SAMPLE DESCRIPTION	PREP CODE	Mn ppm (ICP)	Mo ppm (ICP)	Na % (ICP)	Ni ppm (ICP)	P ppm (ICP)	Pb ppm (ICP)	Sr ppm (ICP)	Ti % (ICP)	V ppm (ICP)	W ppm (ICP)	Zn ppm (ICP)			
294675	208 294	40	< 1	0.11	9	80	< 2	57	0.06	8	< 10	6			
294676	208 294	25	< 1	0.03	8	30	< 2	21	0.01	8	< 10	10			
294677	208 294	20	< 1	0.03	5	60	< 2	25	0.04	5	< 10	6			
294678	208 294	30	< 1	0.04	7	60	< 2	28	0.07	8	< 10	6			
294679	208 294	25	< 1	0.01	4	30	< 4	17	0.01	3	< 10	2			
294680	208 294	20	< 1	0.01	5	40	< 2	36	< 0.01	2	< 10	4			
294681	208 294	30	< 1	0.01	4	30	< 2	12	0.01	2	< 10	10			
294682	208 294	20	< 1	0.01	3	40	< 2	12	0.01	3	< 10	2			
294683	208 294	25	< 1	0.02	2	50	< 2	24	0.01	2	< 10	2			
294684	208 294	30	< 1	0.04	7	50	< 2	14	0.02	5	< 10	4			
294685	208 294	10	< 1	0.02	4	30	< 2	16	< 0.01	1	< 10	4			
294686	208 294	30	< 1	0.03	7	80	< 2	33	0.01	4	< 10	12			
294687	208 294	15	< 1	0.02	3	40	< 2	18	0.01	5	< 10	< 2			
294688	208 294	20	< 1	0.01	4	60	< 2	26	0.01	4	< 10	4			
294689	208 294	15	< 1	0.02	4	60	< 2	25	0.01	4	< 10	< 2			
294690	208 294	20	< 1	0.01	5	60	< 2	34	< 0.01	3	< 10	4			
294691	208 294	10	< 1	0.01	3	50	< 2	17	0.01	4	< 10	2			
294692	208 294	40	< 1	0.01	7	80	< 2	37	0.02	3	< 10	6			
294693	208 294	65	< 1	0.05	10	70	< 2	41	0.03	5	< 10	10			
294694	208 294	40	< 1	0.01	6	30	< 2	9	0.01	3	< 10	4			
294695	208 294	15	< 1	0.05	3	40	< 2	30	0.02	3	< 10	4			
294696	208 294	35	< 1	0.07	12	90	< 2	63	0.07	7	< 10	6			
294697	208 294	20	< 1	0.05	8	80	< 2	34	0.04	6	< 10	6			
294698	208 294	45	< 1	0.02	9	50	< 2	19	0.02	4	< 10	10			
294699	208 294	30	< 1	0.01	6	30	< 2	16	0.01	5	< 10	6			
294700	208 294	25	< 1	0.04	6	50	< 2	17	0.02	13	< 10	8			

CERTIFICATION:

B. Coughlin
 APPENDIX 2-10

Personnel Employed

**R H Tays 93 Weir Crescent, West Hill
Ontario M1E 3B2**

Prospecting and sample collection	July 5 , and 6	2 days
Line Cutting	July 28, 29 and 30	3 days
Sample collection	August 4 and 5	2 days
Report Preparation	August 11, 12 and 16	3 days

**W A Hogg , 22 Maxhome Ave. ,Willowdale
Ontario M2M 3J9**

Prospecting and sample collection	July 5 and 6th.	2 days
Geology	July 28, 29 and 30	3 days
Report Preparation	August 16	1 day

**Robert Etches 2 Percy street,
North Bay, Ontario.**

Line Cutting and Sample Collection - July 29, 30, August 4 and 5th. 4 days



**This is an example of the steep rise of the Quartzite deposit in zone 1
Which is representative of the topography of the other zones.**

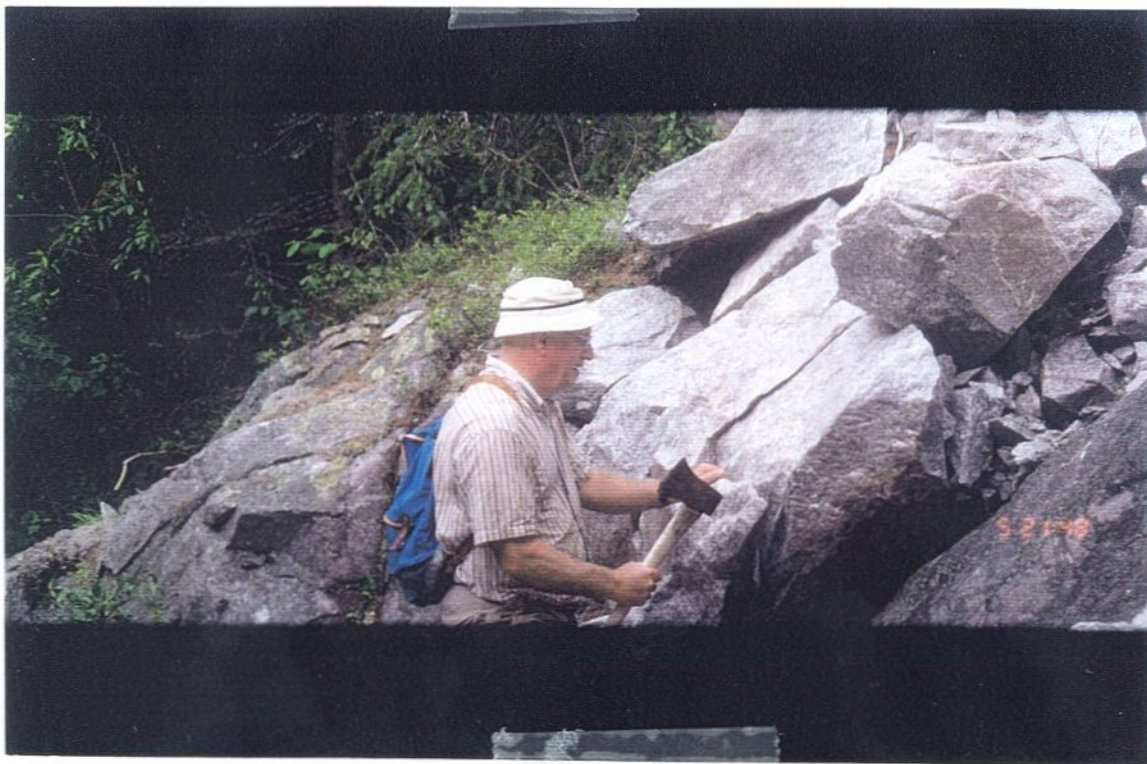

**This is the site where a mini bulk sample was taken at grid coordinate 67
meters north---60 meters east**



This picture is representative of the minimal amount of overburden prevalent on the quartzite outcrops.



This picture is close up view of the massive quartzite found in zone 1.

Statement Of Expenditures

Salaries and Wages

R H Tays	Prospecting and sample collection 2 days @ \$150	= \$ 300.00
	Line Cutting 3 days @ \$200	= \$ 600.00
	Sample Collection 2 days @ \$200	= \$ 400.00
	Report Preparation 3 days @ \$200	= \$ 600.00
		\$ 1900.00

W A Hogg	Prospecting and sample collection 2 days @ 150	= \$ 300.00
	Geology 3 days @ \$ 300	= \$ 900.00
	Report Preparation 1day @ \$ 300	= \$ 300.00
		\$ 1500.00

Robert Etches	Line cutting and sample collection 4 days	
	(re Lashex Ltd. / Fluxor contract)	= \$ 856.00

Total salaries and wages = \$ 4256.00

Accommodation, Meals and Transportation Expenses

R H Tays expenses. (see expense sheet)	670.15
--	---------------

W A Hogg expenses (see expense sheet)	445.97
Total Field and office expenses	\$ 1116.12

Lakefield Research Sample Preparation and Assaying	\$ 1400.10
---	-------------------

Total Cost Of the Work = \$ 6772.22

Expense Accounts

R H Tays Expenses

July 5 th . and 6 th . Car expenses 392 km. at 35 cent	= \$ 137.00
July 6 th . Breakfast and lunch Hogg & Tays	20.94
July 6 th . Dinner -Swiss chalet	20.12
July 28 th . to 30 th . Travelodge Motel Hogg & Tays	150.90
July 28 th . Eastside Marios Hogg & Tays	48.49
July 29 th . Swiss Chalet Hogg & Tays	28.04
July 29 th . Staples Field supplies	4.12
August 4 th .and 5 th . Travelodge Motel	77.29
August 4 th .and 5 th . Car expenses 236 km. at 35 cents	82.60
August 4 th . Eastside Marios	17.97
August 11 th . to 17 th . Office supplies and printing of maps	82.68
Total Expenses	670.15

R.H.Tays Certified correct, August 18,1999

W.A.Hogg Expenses

July 5 th . Accommodations Tays & Hogg	\$ 82.50
July 5 th . Meals Tays & Hogg	116.47
July 28 th to 30 th . Car Expenses 420 km at 35 cents	147.00
August 16 th . Report Preparation Use of office and equipment	100.00
Total Expenses	445.97

W.A.Hogg Certified Correct, August 18, 1999

Lashex Ltd.

973 Pine Creek Road, R.R.#1 Callander, Ontario P0H 1H0

Phone: (705) 752-3957
Fax: (705) 752-1932
Cell: (705) 499-2047
Email : rlashbrk@onlink.net

Aug. 06, 1999

Mr. Reg Tays
Fluxore Inc.
93 Weir Crescent
Westhill, ON
M1E 3B2

RE: McAuslan Township

Sorry I missed you last night. I didn't remember that you were finishing until we were in town so I left the note at Bobs place.

The following is an invoice for Robert Etches for your McAuslan Township Project.

1 Man for 4 days(July 29, 30 & Aug. 4,5 1999) @ \$200.00/day	=	\$800.00
7% G.S.T.	=	<u>\$ 56.00</u>
Total		\$856.00

Should you require any more assistance for work such as you mentioned about taking a bulk sample, please call.

Thank you.

Yours truly,



Raymond L. Lashbrook

Lakefield Research

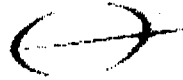

P.O. Box 4300
 185 Concession Street
 Lakefield, ON
 Canada K0L 2H0
 Phone: 705-652-7000
 Fax: 705-652-8133

INVOICE

NO: 9000

August 18 99

FLUXOR INC.
 93 WEIR CRESCENT
 WEST HILL, ONTARIO
 M1E 3B2
 Attn: REG TAYS

G.S.T. Number 89921 6352RT
 Terms: Net 30 days. 2% service charge
 per month on overdue accounts.

Our Project L.R. 5530 - : Charges for ^{July} August
 P.O. Number : Manager : BIGG, TONY 1-380
 A/R Code: FLU100

RE: QUARTZ UPGRADING - GRINDING

TO Testwork Charges

13.00 hours at	\$ 60.00	780.00
1.00 hours at	\$ 130.00	130.00

		910.00

TO Analytical Charges

21 SI1	- ROUTINE PULP	@ \$ 16.50	346.50
2 WRA1	- PULP-MAJ.OXIDES&LO1	@ \$ 26.00	52.00

			398.50

			1,308.50
		GST @ 7%	91.60

		CANADIAN FUNDS \$	1,400.10
			=====

**CERTIFICATE TO ACCOMPANY REPORT DATED AUGUST 1999
ON McAUSLAN TOWNSHIP CLAIM S1212144 ,SUDBURY MINING
DIVISION, ONTARIO**

I William A Hogg of Willowdale Ontario, Certify That

**I am a Professional Engineer and Consulting Geologist and reside at 22
Maxhome Avenue, Willowdale, in the province of Ontario.**

**I am a graduate of Acadia University , Dalhousie University and McGill
University and hold the degree of B.Sc. (1950), M.Sc. (1954) and Ph. D. (
1959), respectively.**

**I am a Member of the Association of Professional Engineers of the Province
of Ontario.**

**I have been practising my profession in Canada, and occasionally in the
United States since 1950**

**The accompanying report is based on a knowledge gained from a review of
published geological reports ,maps and technical data on file in the
Assessment Branch of the Ontario Geological Survey, Toronto and a
number of property examinations on the silica deposit in McAuslan
Township.**

This report covers mining claim S1212144.

All inclusive, being the claim referred to in the accompanying report.

**Willowdale, Ontario
August 18 1999**

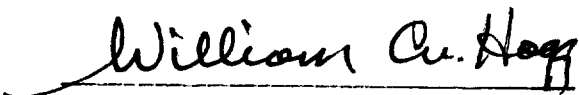
William A Hogg, Ph. D. ,P. Eng.

**CERTIFICATE TO ACCOMPANY REPORT DATED AUGUST 1999
ON McAUSLAN TOWNSHIP CLAIM S1212144, SUDBURY MINING
DIVISION, ONTARIO**

I Reginald H Tays of West Hill, Ontario, Certify that:

I am a resident of the City of Toronto, residing at 93 weir Crescent, West Hill in the Province of Ontario.

I have been employed in the mining industry since 1953 as a Geophysical Technician, Prospector, Exploration Project Manager and Property Manager. I have been employed in various aspects of this work throughout Canada, The United States Africa and Latin America.

I hold lifetime Prospectors Licence number K15434 in the Province of Ontario,

I have knowledge and experience of the field work techniques and methods used as described in the accompanying report.

I was in management and control of the field work performed on mining claim S121214 and hereby certify that to the best of my knowledge and belief the facts concerning the work as presented in the accompanying report are accurate and correct.

**West Hill, Ontario
August 18, 1999**

Reginald H Tays



Ministry of Northern Development and Mines

Declaration of Assessment Work Performed on Mining Land

Mining Act, Subsection 65(2) and 66(3), R.S.O. 1990

Transaction Number (office use) W9970.00259 Assessment Files Research Imaging



31L14SW2001 2.19647 McAUSLAN 900

if subsection 65(2) and 66(3) of the Mining Act. Under section 8 of the Mining Act, the assessment work and correspond with the mining land holder. Questions should be directed to the Ministry of Northern Development and Mines, 3rd Floor, 933 Ramsey Lake Road,

Instructions: - For work performed on Crown Lands before recording a claim, use form 0210 - Please type or print in ink.

2.19647

1. Recorded holder(s) (Attach a list if necessary)

Name Fluxor Inc. Client Number 392371 Address 93 Weir Crescent West Hill Ontario M1E 3B2 Telephone Number 416 282 5067

2. Type of work performed: Check (✓) and report on only ONE of the following groups for this declaration.

Geotechnical: prospecting, surveys, assays and work under section 18 (regs) Physical: drilling stripping, trenching and associated assays Rehabilitation

Work Type Line Cutting, Prospecting, Geochemical sampling and Assaying and Geological Mapping Office Use Commodity Total \$ Value of Work Claimed 6772 Date From 5th July 1999 To 17th August 1999 NTS Reference Mining Division Sudbury Resident Geologist District Sudbury

RECORDED AUG 20 1999 TW

Please remember to: - obtain a work permit from the Ministry of Natural Resources as required; - provide proper notice to surface rights holders before starting work; - complete and attach a Statement of Costs, form 0212; - provide a map showing contiguous mining lands that are linked for assigning work; - include two copies of your technical report.

3. Person or companies who prepared the technical report (Attach a list if necessary)

Name Dr. William A Hogg Telephone Number 416 221 7428 Address 22 Maxhome Avenue, Willowdale, Ontario M2M 3J9 Fax Number 416 221 7428 Name Reginald H Tays Telephone Number 416 282 5067 Address 93 Weir Crescent, West Hill, Ontario M1E 3B2 Fax Number 416 282 4905

RECEIVED AUG 20 1999 GEOSCIENCE ASSESSMENT OFFICE

4. Certification by Recorded Holder or Agent

I, Reginald H Tays, President of Fluxor Inc. do hereby certify that I have personal knowledge of the facts set forth in this Declaration of Assessment Work having caused the work to be performed or witnessed the same during or after its completion and, to the best of my knowledge, the annexed report is true.

Signature of Recorded Holder or Agent Date August 18 1999 Agent's Address 93 Weir Crescent, West Hill Ont. M1E 3B2 Telephone Number 416 282 5067 Fax Number 416 282 4905

Handwritten signature and date August 18 1999

5. Work to be recorded and distributed. Work can only be assigned to claims that are contiguous (adjoining) to the mining land where work was performed, at the time work was performed. A map showing the contiguous link must accompany this form.

W9970.00259

Mining Claim Number. Or if work was done on other eligible mining land, show in this column the location number indicated on the claim map.	Number of Claim Units. For other mining land, list hectares.	Value of work performed on this claim or other mining land.	Value of work applied to this claim.	Value of work assigned to other mining claims.	Bank. Value of work to be distributed at a future date
eg TB 7827	16 ha	\$26,825	N/A	\$24,000	\$2,825
eg 1234567	12	0	\$24,000	0	0
eg 1234568	2	\$ 8,892	\$ 4,000	0	\$4,892
1 S 1212144	6	\$ 6772.22	\$ 4800	0	\$1972.22
2					
3					
4					
5					
6					
7					
8					
9					
10					
11					
12					
13					
14					
15					
Column Totals					

I, Reginald H Tays, do hereby certify that the above work credits are eligible under (Print Full Name) subsection 7 (1) of the Assessment Work Regulation 6/96 for assignment to contiguous claims or for application to the claim where the work was done.

Signature of Recorded Holder or Agent Authorized in Writing 	Date August 18, 1999
--	-------------------------

6. Instruction for cutting back credits that are not approved.

Some of the credits claimed in this declaration may be cut back. Please check (✓) in the boxes below to show how you wish to prioritize the deletion of credits:

- 1. Credits are to be cut back from the Bank first, followed by option 2 or 3 or 4 as indicated.
- 2. Credits are to be cut back starting with the claims listed last, working backwards; or
- 3. Credits are to be cut back equally over all claims listed in this declaration; or
- 4. Credits are to be cut back as prioritized on the attached appendix or as follows (describe):

Note: If you have not indicated how your credits are to be deleted, credits will be cut back from the Bank first, followed by option number 2 if necessary.

For Office Use Only

Received Stamp

RECEIVED
 AUG 20 1999
 GEOSCIENCE ASSESSMENT
 OFFICE

0241 (03/97)

Deemed Approved Date	Date Notification Sent
Date Approved	Total Value of Credit Approved
Approved for Recording by Mining Recorder (Signature)	

W9970.00259

2.19647

Statement Of Expenditures

Salaries and Wages

R H Tays	Prospecting and sample collection 2 days @ \$150	= \$ 300.00
	Line Cutting 3 days @ \$200	= \$ 600.00
	Sample Collection 2 days @ \$200	= \$ 400.00
	Report Preparation 3 days @ \$200	= \$ 600.00
		\$ 1900.00

W A Hogg	Prospecting and sample collection 2 days @ 150	= \$ 300.00
	Geology 3 days @ \$ 300	= \$ 900.00
	Report Preparation 1day @ \$ 300	= \$ 300.00
		\$ 1500.00

Robert Etches	Line cutting and sample collection 4 days	
	(re Lashex Ltd. / Fluxor contract)	= \$ 856.00

Total salaries and wages = \$ 4256.00

Accommodation, Meals and Transportation Expenses

R H Tays expenses. (see expense sheet) 670.15

W A Hogg expenses (see expense sheet) 445.97

Total Field and office expenses \$ 1116.12

Lakefield Research Sample Preparation and Assaying \$ 1400.10

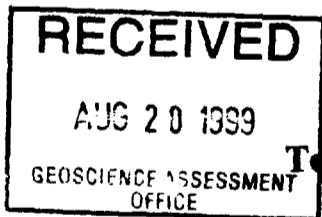

Total Cost Of the Work = \$ 6772.22

R H Tays, Certified Correct

Appendix 5

[Signature] August 18, 1999

2.19647

Expense Accounts

R H Tays Expenses

July 5 th . and 6 th . Car expenses 392 km. at 35 cent	= \$ 137.00
July 6 th . Breakfast and lunch Hogg & Tays	20.94
July 6 th . Dinner -Swiss chalet	20.12
July 28 th . to 30 th . Travelodge Motel Hogg & Tays	150.90
July 28 th . Eastside Marios Hogg & Tays	48.49
July 29 th . Swiss Chalet Hogg & Tays	28.04
July 29 th . Staples Field supplies	4.12
August 4 th .and 5 th . Travelodge Motel	77.29
August 4 th .and 5 th . Car expenses 236 km. at 35 cents	82.60
August 4 th . Eastside Marios	17.97
August 11 th . to 17 th . Office supplies and printing of maps	82.68
Total Expenses	670.15

R.H.Tays Certified correct, August 18,1999

W.A.Hogg Expenses

July 5 th . Accommodations Tays & Hogg	\$ 82.50
July 5 th . Meals Tays & Hogg	116.47
July 28 th to 30 th . Car Expenses 420 km at 35 cents	147.00
August 16 th . Report Preparation Use of office and equipment	100.00
Total Expenses	445.97

W.A.Hogg Certified Correct, August 18, 1999

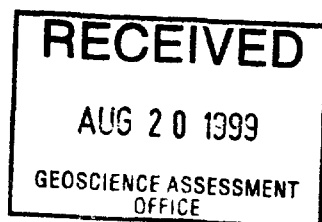

Appendix 5 - 2

August 25, 1999

REGINALD H. TAYS
FLUXOR INC.
93 WEIR CR.
WEST HILL, ONTARIO
M1E-3B2

Geoscience Assessment Office
933 Ramsey Lake Road
6th Floor
Sudbury, Ontario
P3E 6B5

Telephone: (888) 415-9846
Fax: (877) 670-1555

Visit our website at:
www.gov.on.ca/MNDM/MINES/LANDS/mlsmnpge.htm

Dear Sir or Madam:

Submission Number: 2.19647

Status

Subject: Transaction Number(s): W9940.00259 Deemed Approval

We have reviewed your Assessment Work submission with the above noted Transaction Number(s). The attached summary page(s) indicate the results of the review. **WE RECOMMEND YOU READ THIS SUMMARY FOR THE DETAILS PERTAINING TO YOUR ASSESSMENT WORK.**

If the status for a transaction is a 45 Day Notice, the summary will outline the reasons for the notice, and any steps you can take to remedy deficiencies. The 90-day deemed approval provision, subsection 6(7) of the Assessment Work Regulation, will no longer be in effect for assessment work which has received a 45 Day Notice. Allowable changes to your credit distribution can be made by contacting the Geoscience Assessment Office within this 45 Day period, otherwise assessment credit will be cut back and distributed as outlined in Section #6 of the Declaration of Assessment work form.

Please note any revisions must be submitted in DUPLICATE to the Geoscience Assessment Office, by the response date on the summary.

If you have any questions regarding this correspondence, please contact Bruce Gates by e-mail at bruce.gates@ndm.gov.on.ca or by telephone at (705) 670-5856.

Yours sincerely,



ORIGINAL SIGNED BY
Blair Kite
Supervisor, Geoscience Assessment Office
Mining Lands Section

Work Report Assessment Results

Submission Number: 2.19647

Date Correspondence Sent: August 25, 1999

Assessor: Bruce Gates

Transaction Number	First Claim Number	Township(s) / Area(s)	Status	Approval Date
W9940.00259	1212144	MCAUSLAN	Deemed Approval	August 25, 1999

Section:

12 Geological GEOL
9 Prospecting PROSP

Correspondence to:

Resident Geologist
Sudbury, ON

Recorded Holder(s) and/or Agent(s):

REGINALD H. TAYS
FLUXOR INC.
WEST HILL, ONTARIO

Assessment Files Library
Sudbury, ON

MAP SYMBOLOLOGY

Aerial Cableway	Pipeline
Boundary	Railroad
International	Single Track
Interprovincial	Double Track
Strait, Beaches	Abandoned
National Reserve	Turntable
Approach	Road
Lot, Concession	Highway, County
Approach	Traverse
Dark Boundary	Access (road of doubtful usefulness or significant driveway)
Bridge	Trail, Back Road (unimproved, etc.)
Beam, Outlined	Rapids
Building	Double line river with multiple rapids
Chimney	Double line river with multiple rapids
Cliff, Pit, Pile	Reservoir
Contours	River, Stream, Canal
Intersected	Approach
Approximate	Approximate
Separation	Direction of flow
Control Points	Rock
Horizontal	Spot Elevation
Vertical	Spot Elevation
Culvert	Tower
Falls	Transmission Line
Double line river	Patrol
Fence, Hedge, Wall	Tunnel
Feature Outline (Construction features, etc.)	Utility Poles
Flooded Land	Wharf, Dock, Pier
Lock	Wooded Area
Marsh or Swamp	
Mast	
Mine Head Frame	
Outcrop	

AREAS WITHDRAWN FROM DISPOSITION

- M.R.O. - MINING RIGHTS ONLY
- S.R.O. - SURFACE RIGHTS ONLY
- M.+S. - MINING AND SURFACE RIGHTS

Description	Order No.	Date	Disposition	File
Sec. 48 (R.S.O. '70)	W-18/74	22/04/74	ENTIRE TWP & R.D.	M00704-4
Sec. 35/50	W-2-3/95	19/01/95	M.R.O.	195150
Sec. 35 W-LL-C	134/99	11/05/99	M+S	
SEC. 35 W-LL-C	138/99	MAY 12/99	M+S	
SEC. 35 W-LL-C	136/99	ONT MAY 12/99	M+S	
SEC35 W-LL-P14C/99	ONT MAY 14/99	N/S		

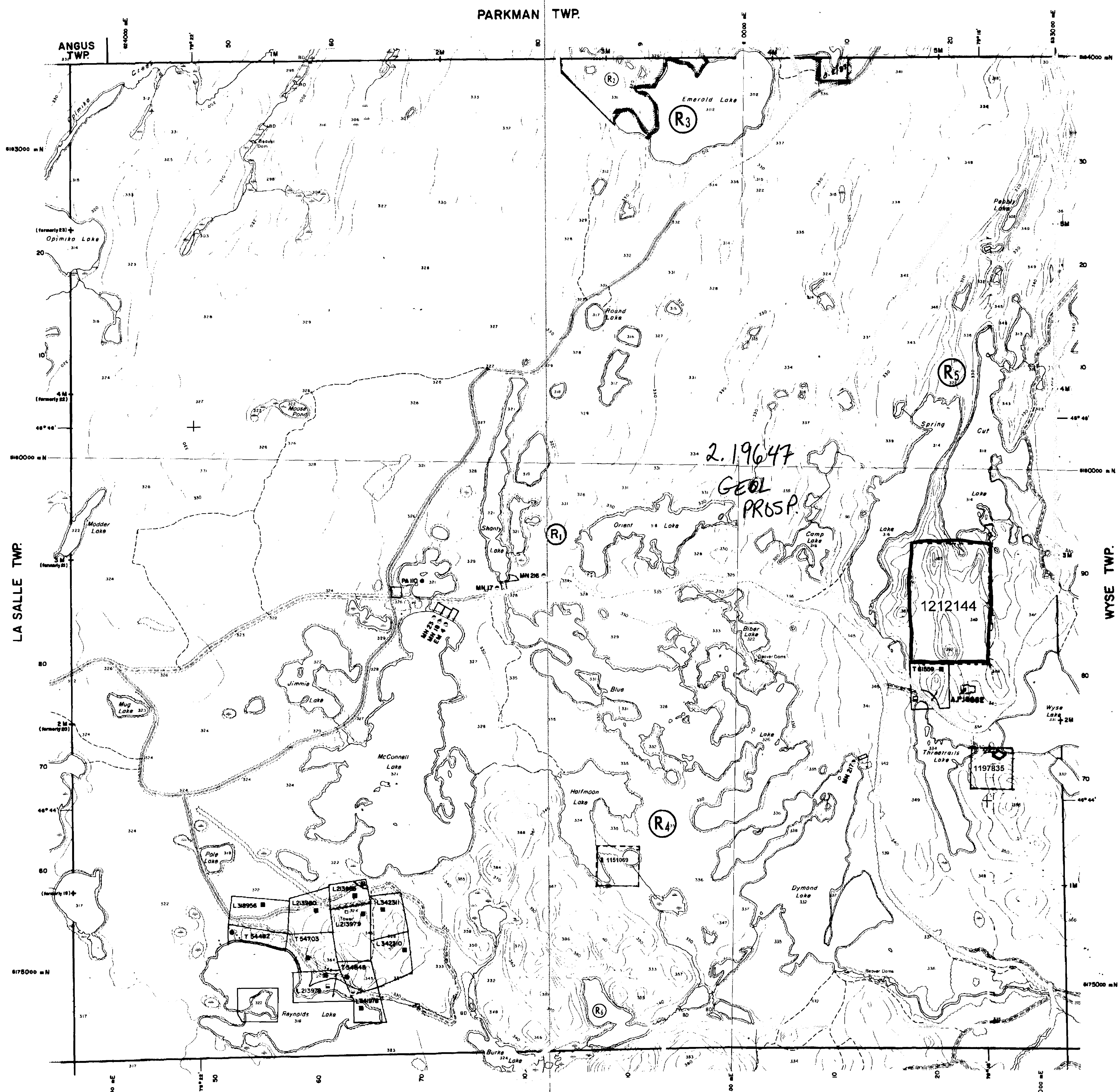

LEGEND

HIGHWAY AND ROUTE No.	
OTHER ROADS	
TRAILS	
SURVEYED LINES	
TOWNSHIPS, BASE LINES, ETC.	
LOTS, MINING CLAIMS, PARCELS, ETC.	
UNSURVEYED LINES	
LOT LINES	
PARCEL BOUNDARY	
MINING CLAIMS ETC.	
RAILWAY AND RIGHT OF WAY	
UTILITY LINES	
NON-PERENNIAL STREAM	
FLOODING OR FLOODING RIGHTS	
SUBDIVISION OR COMPOSITE PLAN	
RESERVATIONS	
ORIGINAL SHORELINE	
MARSH OR MUSKEG	
MINES	
TRAVERSE MONUMENT	

DISPOSITION OF CROWN LANDS

TYPE OF DOCUMENT	SYMBOL
PATENT SURFACE & MINING RIGHTS	
" SURFACE RIGHTS ONLY	
" MINING RIGHTS ONLY	
LEASE, SURFACE & MINING RIGHTS	
" SURFACE RIGHTS ONLY	
" MINING RIGHTS ONLY	
LICENCE OF OCCUPATION	
ORDER-IN-COUNCIL	
RESERVATION	
CANCELLED	
SAND & GRAVEL	
LAND USE PERMITS FOR COMMERCIAL TOURISM, OUTPOST CAMPS	

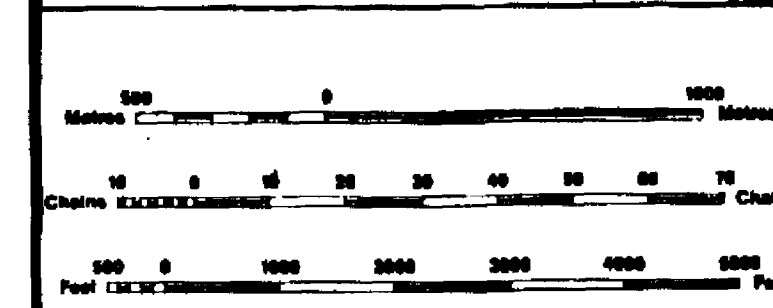

SCALE 1:20 000
GRID ZONE: 17

0.2/83 RESUMED FOR STAKING
83-08-03

A.P.18662 EXP24SEP1997

THE INFORMATION THAT APPEARS ON THIS MAP HAS BEEN COMPILED FROM VARIOUS SOURCES AND ACCURACY IS NOT GUARANTEED.

OCT 06 1999

THOSE WISHING TO STAKE MINING CLAIMS SHOULD CONSULT WITH THE MINING RECORDER, MINES, FOR ADDITIONAL INFORMATION ON THE STATUS OF THE LANDS SHOWN HEREON.

TOWNSHIP
MCAUSLAN
M.N.R. ADMINISTRATIVE DISTRICT
NORTH BAY
MINING DIVISION
SUDBURY
LAND TITLES / REGISTRY DIVISION
NIPISSING



Original Compilation: **NOV. 1984**
Number: **G-1630**

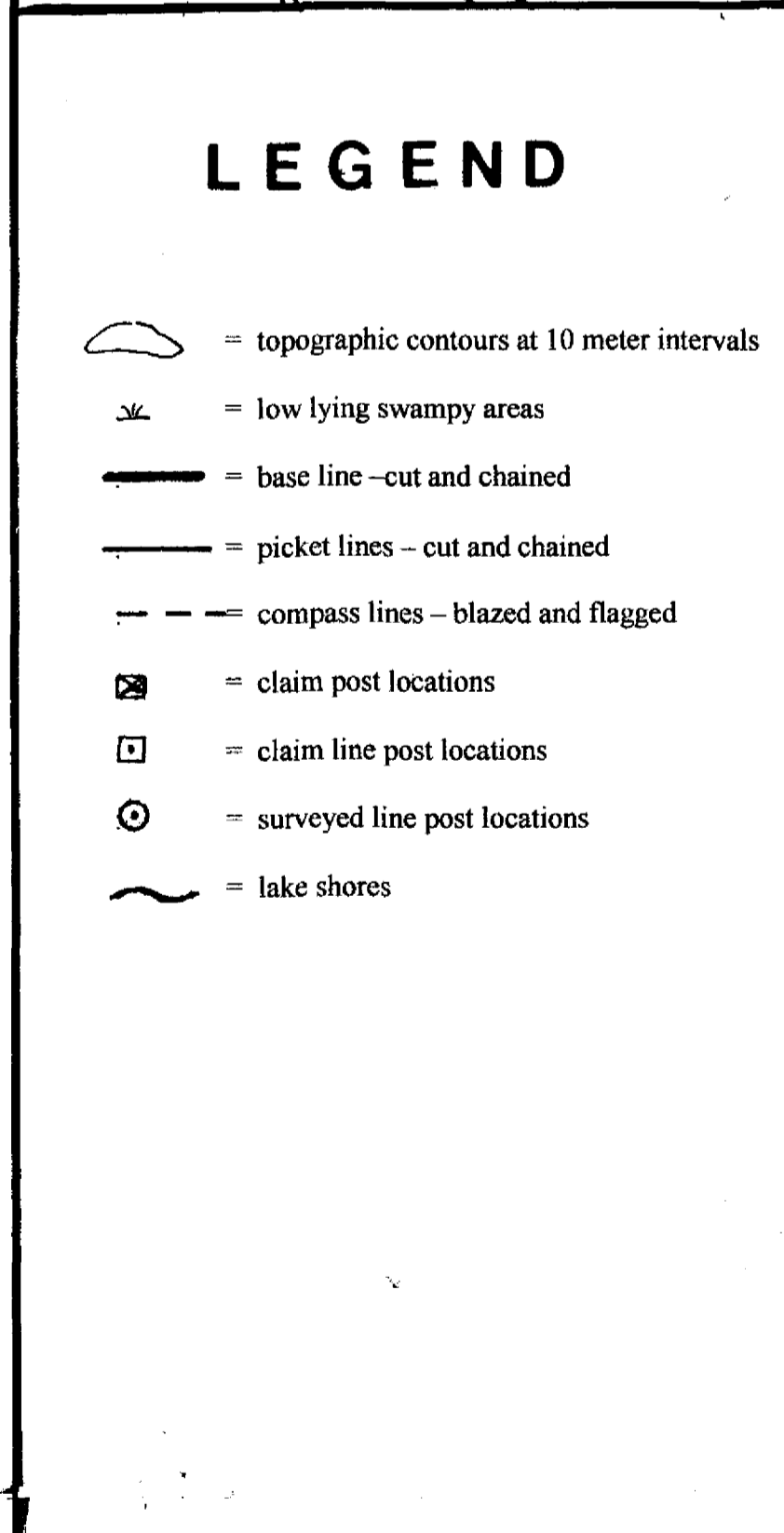
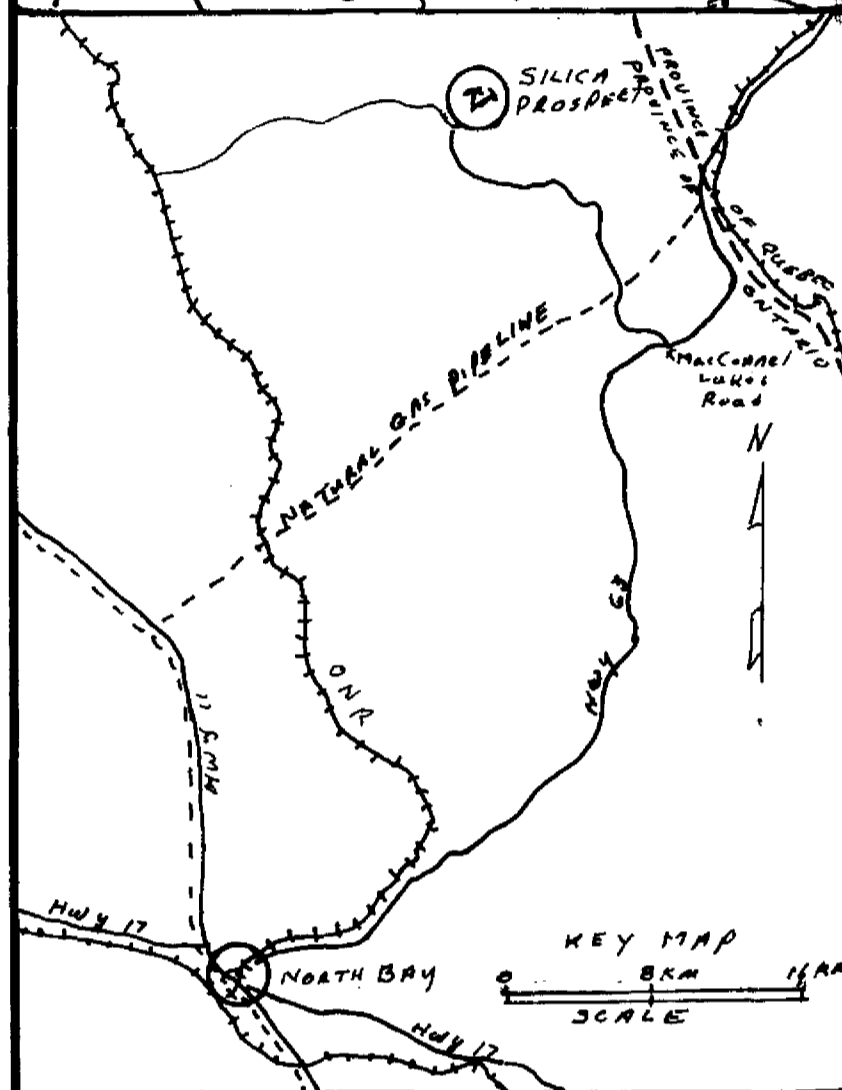
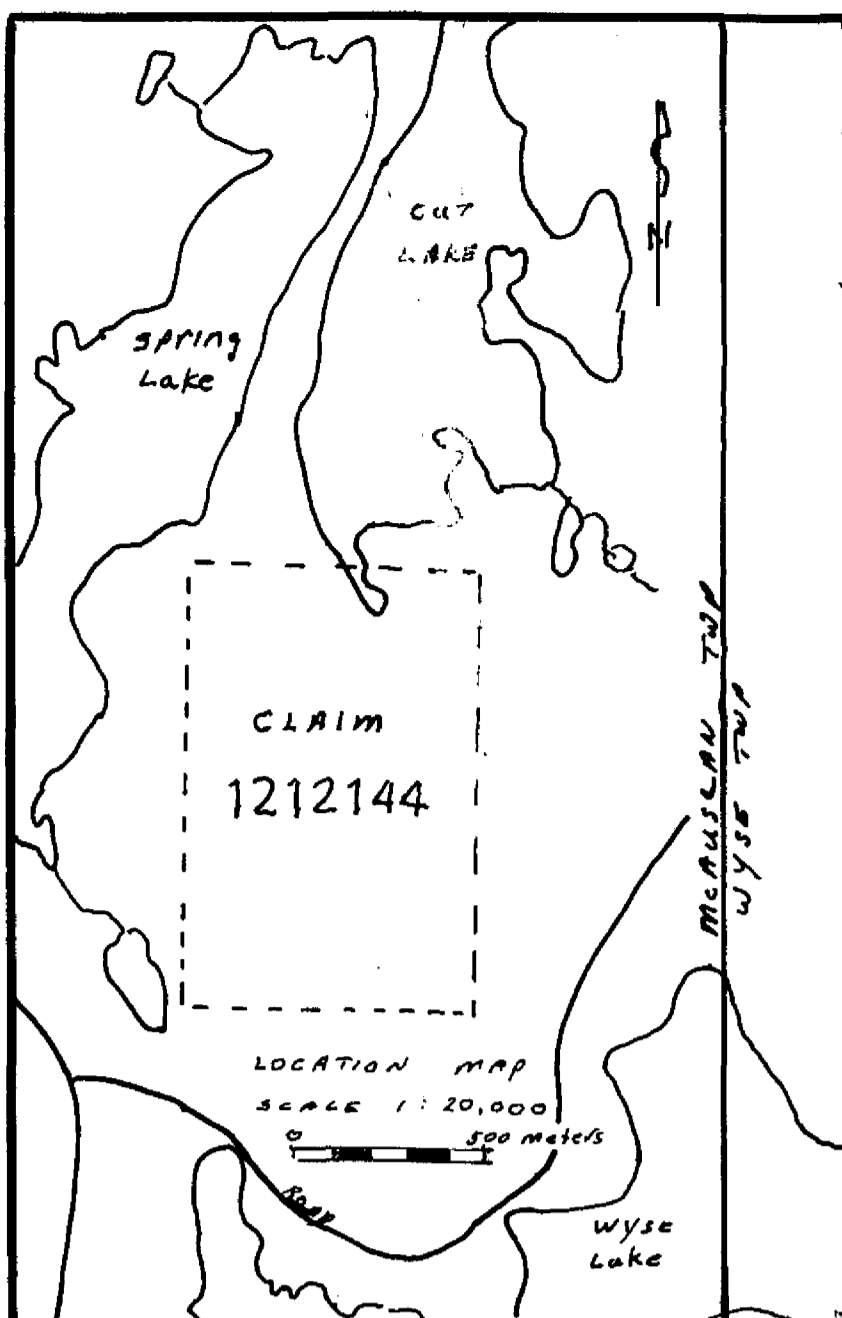

LEGEND

- = topographic contours at 10 meter intervals
- = low lying swampy areas
- = base line - cut and chained
- = picket lines - cut and chained
- = compass lines - blazed and flagged
- = claim post locations
- = claim line post locations
- = surveyed line post locations
- = lake shores

FLUXOR INC.
SILICA PROSPECT
 TOPOGRAPHIC CONTOUR MAP
 McAuslan Township
 Sudbury Mining Division, Ontario
 Scale 1: 25000
 0 50 100 Meters
 Drafted By R.H. Tays August 1999
 SURVEY PLAN # 1

August 17, 1999
William C. Hoag August 17, 1999

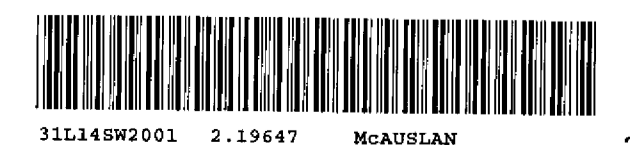

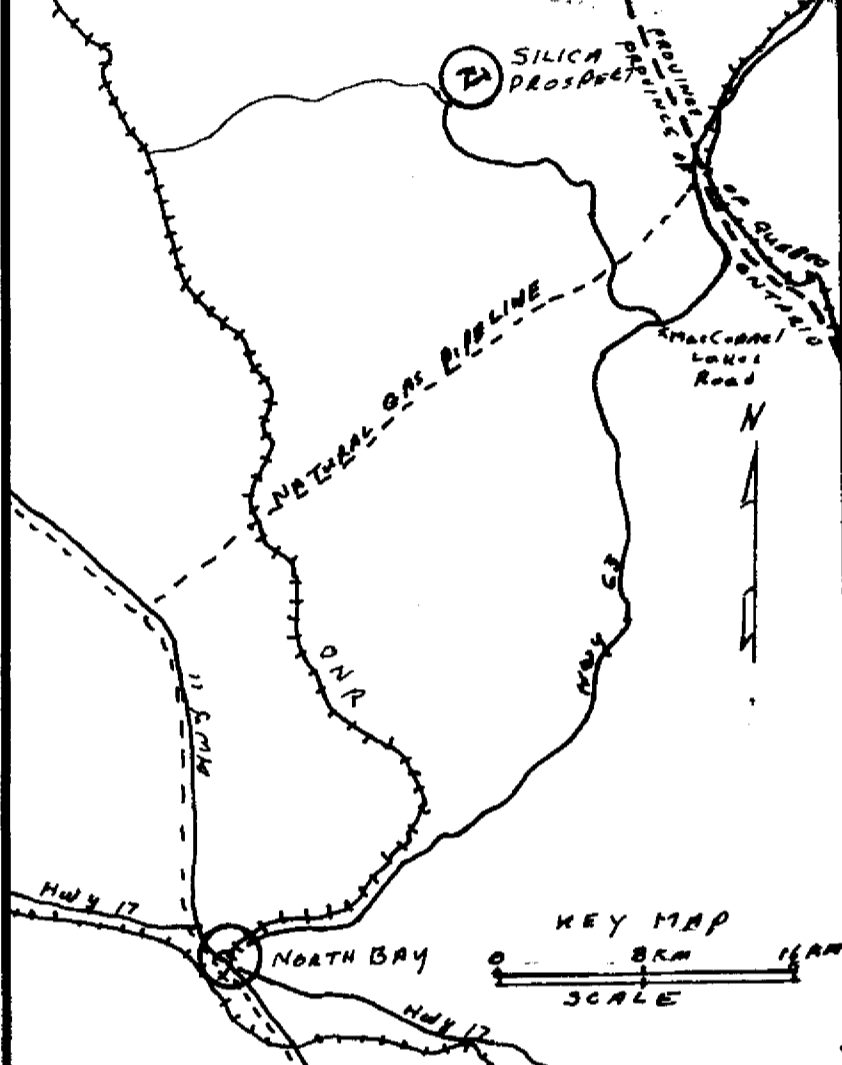
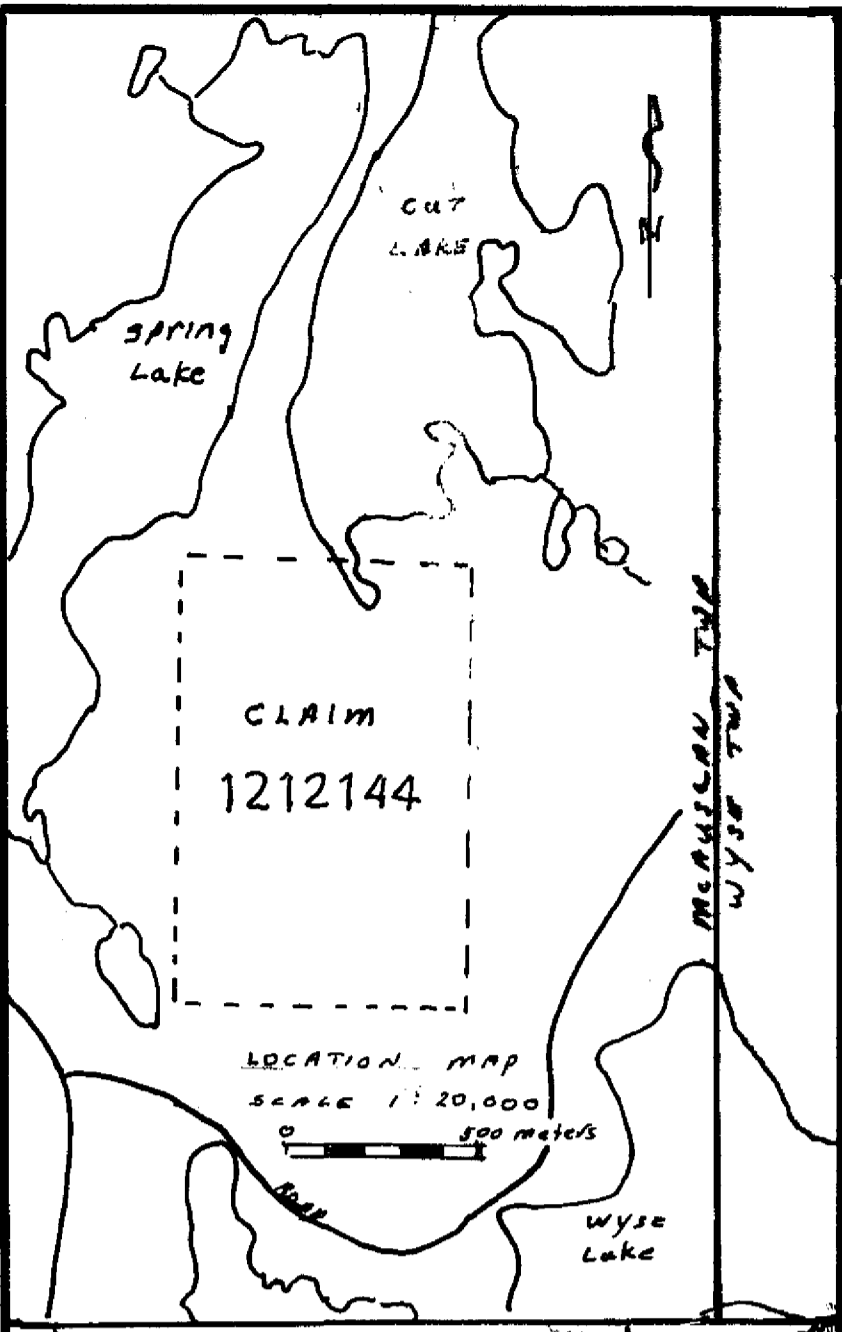

- LEGEND**
- - - = outcrop boundaries
 - 901 = current rock sample locations - assayed
 - 501 = previous survey rock sample locations - assayed
 - ✕ 801 = current rock sample locations - not assayed
 - ✕ = swampy areas
 - = base line - cut and chained
 - = picket lines - cut and chained
 - - - = compass lines - blazed and flagged
 - ⊠ = claim post locations
 - = claim line post locations
 - ⊙ = surveyed line post locations
 - ~ = lake shores

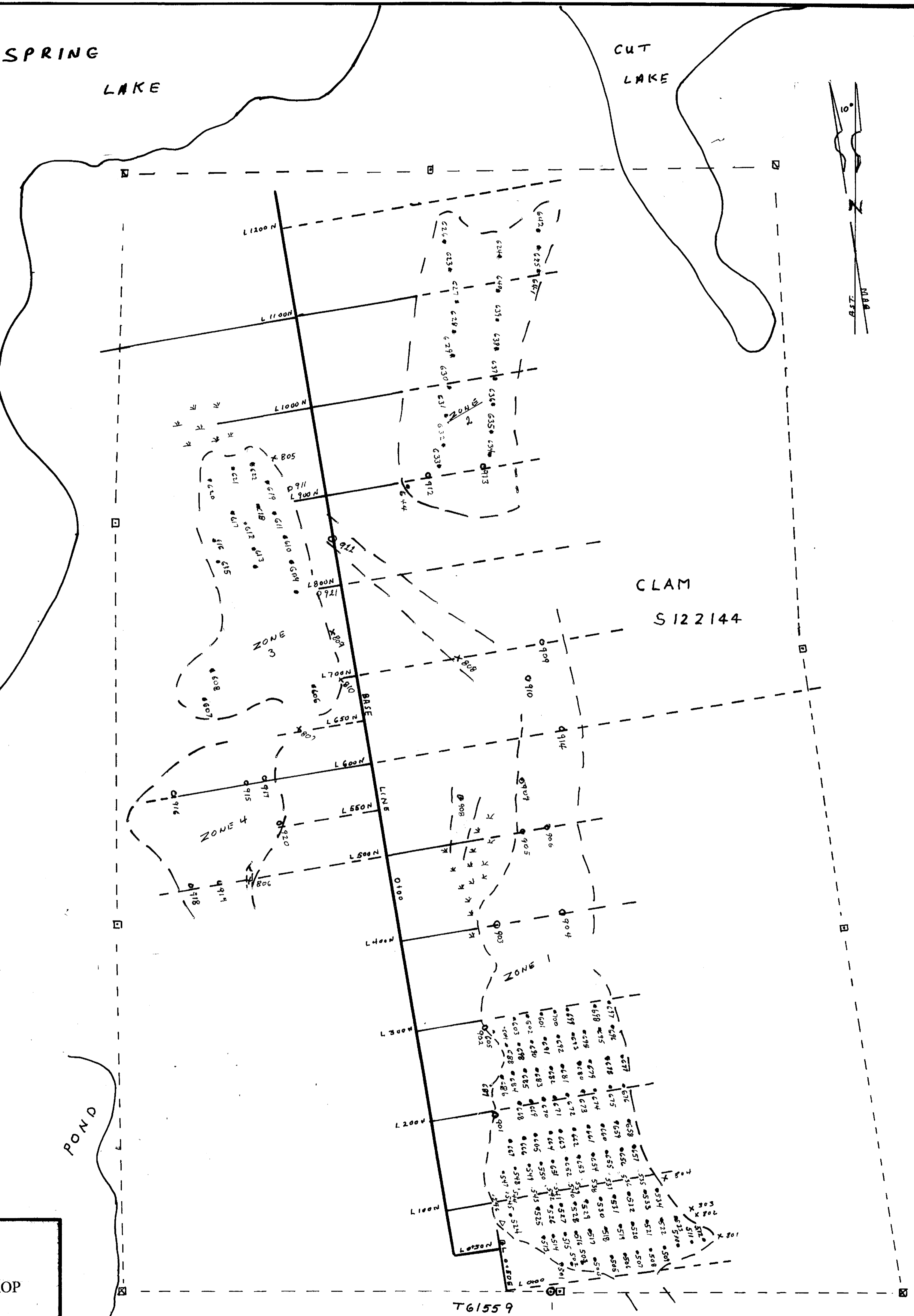

FLUXOR INC.
SILICA PROSPECT
 ROCK SAMPLE AND OUTCROP
 LOCATION MAP
 McAuslan Township
 Sudbury Mining Division, Ontario

Scale 1: 25000
 0 50 100 Meters
 Drafted By R.H.Tays August 1999
 PLAN 5

August 17, 1999
William C. Hoag Aug 17th 1999



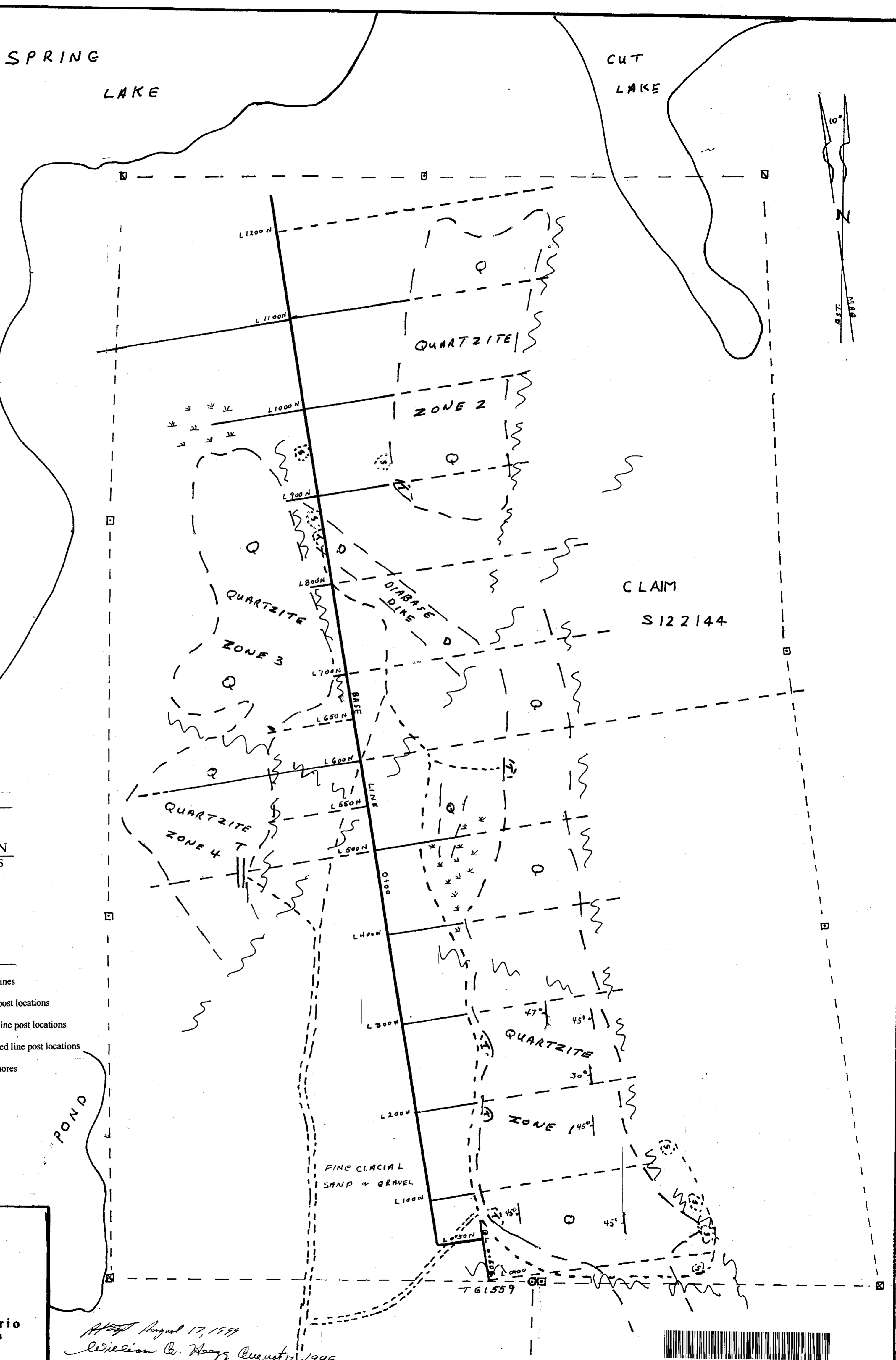
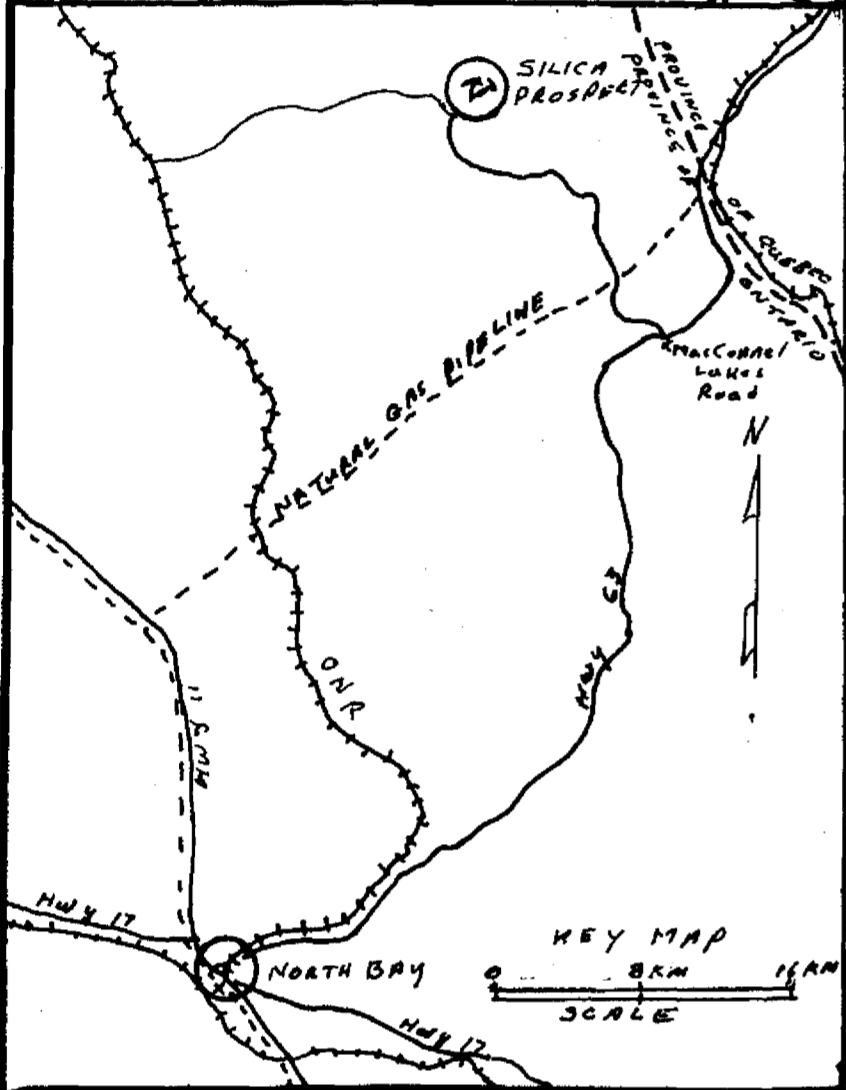
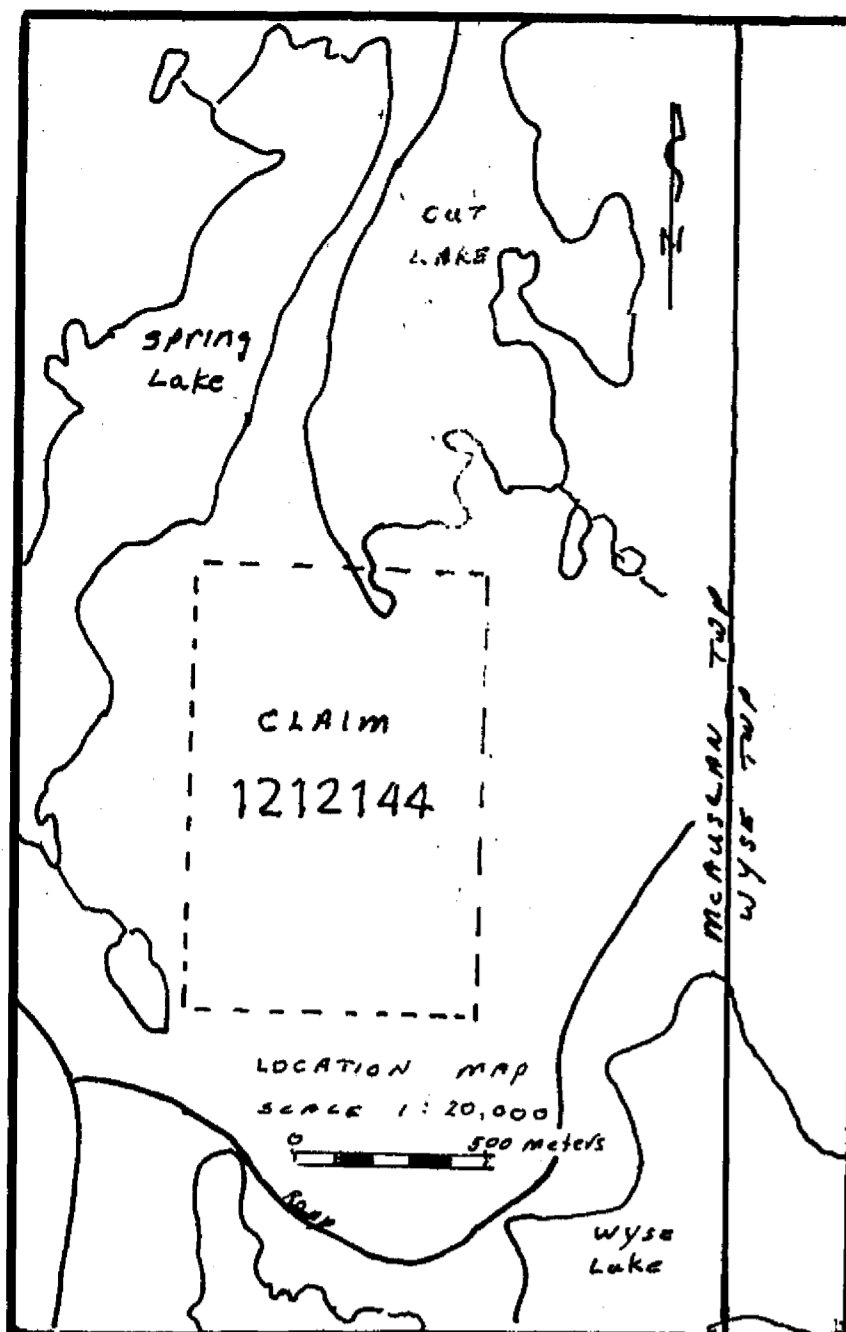

LEGEND

CENOZOIC

[] = Pleistocene and recent

**MIDDLE TO LATE PRECAMBRIAN
CLASTIC SILICEOUS METASEDIMENTS**

[Q] = orthoquartzite with minor muscovite

DIABASE DIKES

[D] = quartz diabase intrusive contact

GENERAL DESCRIPTIONS

- [S] = stripped area
- [T] = rock trench
- [W] = fault escarpment
- [S] = glacial striae
- [-] = rock outcrop boundary
- [K] = low lying swampy areas
- [-] = base line - cut and chained
- [-] = picket lines - cut and chained
- [-] = compass lines - blazed and flagged
- [-] = claim lines
- [X] = claim post locations
- [X] = claim line post locations
- [O] = surveyed line post locations
- [-] = lake shores

**FLUXOR INC.
SILICA PROSPECT**

GEOLOGY MAP

**McAuslan Township
Sudbury Mining Division, Ontario**

Scale 1: 25000
Drafted By R.H. Tays August 1999
PLAN 3

August 17, 1999
Revision C. Hoag August 17, 1999

