



Ministry of Natural Resources

Ontario

LA SALLE T.O.

# 75-10



31L14SW5005 W7507-00040 LA SALLE

010

W7507-40

THE MINING ACT REPORT OF WORK

TYPE OF WORK TO BE RECORDED.

To the Recorder of Sudbury Mining Division

I, G. M. McTe name of Recorded Holder K17544 Prospector's Licence

Box 238, Callander, Ont. Post Office Address

do hereby report the performance of 7 days of stripping (manual) type of work

not before reported to be applied on the following contiguous claims

Claim No.	Days	Claim No.	Days	Claim No.	Days
<u>L. 3737.23</u>	<u>7</u>				

Geological Branch ODM  
ASSESSMENT FILES  
RESEARCH OFFICE  
JUN 25 1975  
RECEIVED

All the work was performed on Mining Claim (s) L. 3737.23  
(In the case of geological and/or geophysical survey (s) where more than 18 claims are involved attach a schedule)

READ CAREFULLY: THE FOLLOWING INFORMATION IS REQUIRED BY THE MINING RECORDER.

- For Manual Work, Stripping or Opening up of Mines, Sinking Shafts or Other Actual Mining Operations - Names and addresses of the men who performed the work and the dates and hours of their employment.
- For Diamond and other Core Drilling - Footage, No. and angle of holes and diameter of core. Name and address of owner or operator of drill. Dates when drilling was done. Signed core log and sketch in duplicate.
- For Compressed Air or Other Power Driven or Mechanical Equipment
- Type of drill or equipment. Names and addresses of men engaged in operating equipment and the dates and hours of their employment.
- For Power Stripping - Type of equipment. Name and address of owner or operator. Amount expended. Dates on which work was done. Proof of actual cost must be submitted within 30 days of recording.
- With each of the above types of work sketches are required to show the location and extent of the work in relation to the nearest claim post. In the case of diamond or other core drilling the sketch must be submitted in duplicate.
- For Geophysical, Geological, Geochemical Surveys and Expenditure Credits - the name of author of report. Covering dates of survey (linecutting & office). Type of instrument used. Total amount of expenditure. Technical reports, maps, expenditure breakdown, receipts must be filed in duplicate with the Minister within 60 days of recording.
- For Land Survey - the name and address of Ontario Land surveyor.

The Required Information is as Follows: (Attach a list if this space is insufficient)

Bill Dimoline; Callander, Ont.  
G.M. McTe; Callander, Ont.

Date June 19/75 H.M. McTe  
Signature of Recorded Holder or Agent

The Mining Act  
Certificate Verifying Report of Work

I, H.M. McTe  
Box 238, Callander, Ont.  
(Post Office Address)

hereby certify:

- That I have a personal and intimate knowledge of the facts set forth in the report of work annexed hereto, having performed the work or witnessed same during and/or after its completion.
- That the annexed report is true.

Dated June 19 19 75 H.M. McTe  
Signature

THE PENALTY FOR MAKING A FALSE STATEMENT IN THIS REPORT AND/OR CERTIFICATE IS \$500. OR SIX MONTHS IMPRISONMENT OR BOTH

# LA SALLE

DATE OF ISSUE  
MAY 20 1974

LA S  
873723  
Granite  
File -  
174856

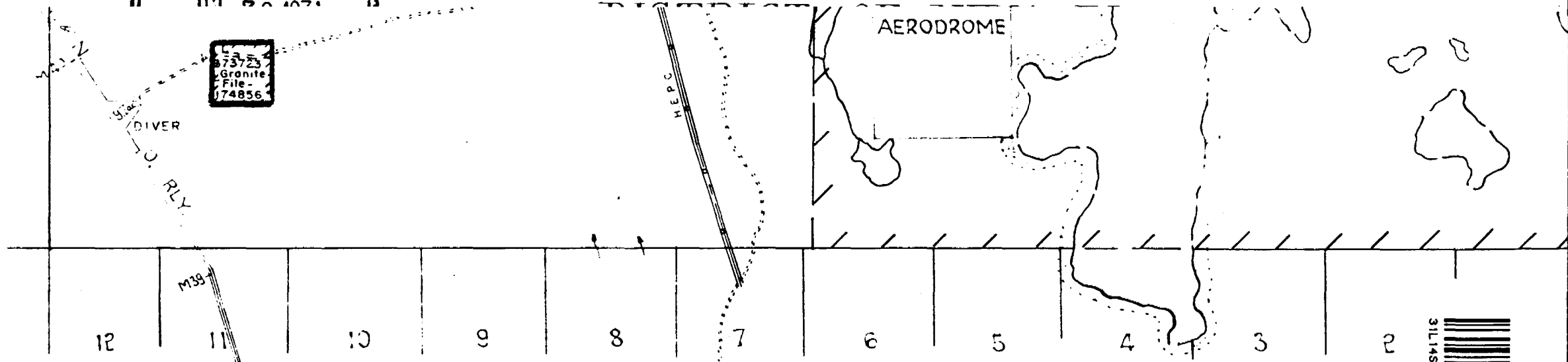

## OSBORNE

Bdy. by PLS A. Niven 1861  
1883  
- OLS E.W. Neelands 1928  
- PLS. W.R. Burke 1889

Lakes and Rivers from Aerial Survey.



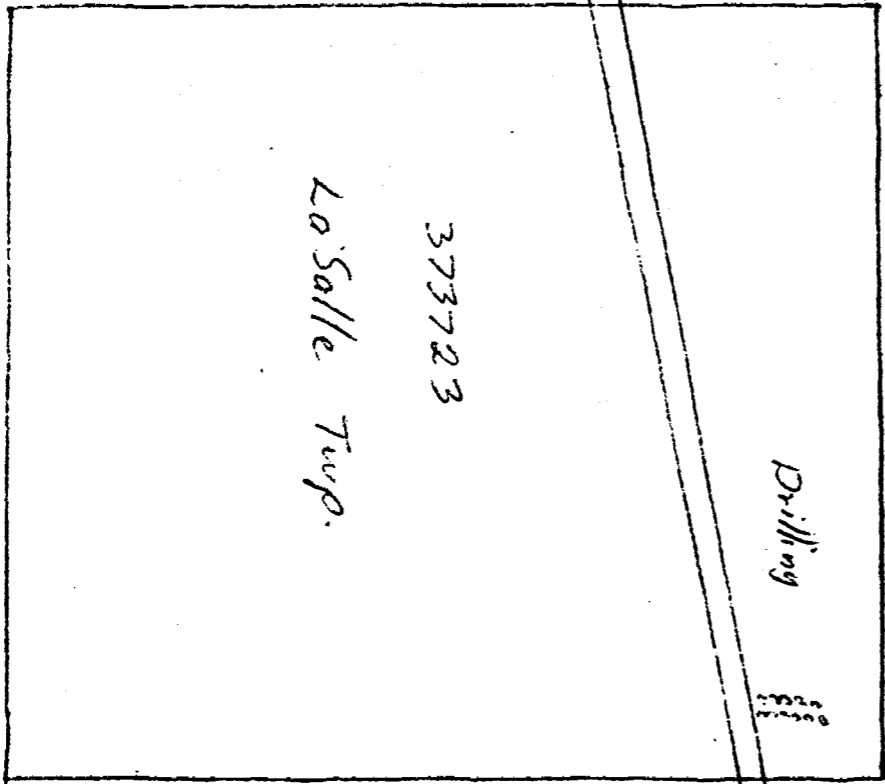

June	Bill Dimoline	Garf Mote	
5	9	9	} brushing stripping (manual)
6	9	9	
7	3	3	
8	—	—	} Drilling (mechanical) plugger
9	7	7	
10	9	9	
11	8	8	
12	1	1	
13	4	4	
14	—	—	
15	—	—	
16	9	9	
17	0	0	
18	4	4	
19	9	9	
20	—	—	