



Ministry of Natural Resources

MCAUSL. 79



31L14SW5058 W7807-00005 MCAUSLAN

#78-5

010

THE MINING ACT REPORT OF WORK

recorded.

To the Recorder of Sudbury Mining Division

I, JOSEPH HABERER name of Recorded Holder A 36234 Prospector's Licence

19 Farster St. St. Catharines Ont L2K-2A1 Post Office Address

do hereby report the performance of 200 days of Drilling and Blasting type of work

not before reported to be applied on the following contiguous claims

Table with columns: Claim No., Days, Claim No., Days, Claim No., Days. Includes handwritten entries for claims 840.2276 and 840.2277.

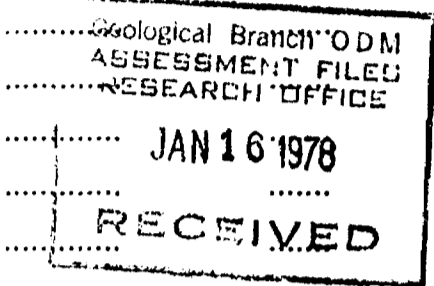

All the work was performed on Mining Claim (s) 840.2277 (In the case of geological and/or geophysical survey (s) where more than 18 claims are involved attach a schedule)

READ CAREFULLY: THE FOLLOWING INFORMATION IS REQUIRED BY THE MINING RECORDER.

- For Manual Work, Stripping or Opening up of Mines, Sinking Shafts or Other Actual Mining Operations - Names and addresses of the men who performed the work and the dates and hours of their employment.
For Diamond and other Core Drilling - Footage, No. and angle of holes and diameter of core. Name and address of owner or operator of drill. Dates when drilling was done. Signed core log and sketch in duplicate.
For Compressed Air or Other Power Driven or Mechanical Equipment
Type of drill or equipment. Names and addresses of men engaged in operating equipment and the dates and hours of their employment.
For Power Stripping - Type of equipment. Name and address of owner or operator. Amount expended. Dates on which work was done. Proof of actual cost must be submitted within 30 days of recording.
With each of the above types of work sketches are required to show the location and extent of the work in relation to the nearest claim post. In the case of diamond or other core drilling the sketch must be submitted in duplicate.
For Geophysical, Geological, Geochemical Surveys and Expenditure Credits - the name of author of report. Covering dates of survey (linecutting & office). Type of instrument used. Total amount of expenditure. Technical reports, maps, expenditure breakdown, receipts must be filed in duplicate with the Minister within 60 days of recording.
For Land Survey - the name and address of Ontario Land surveyor.

The Required Information is as Follows: (Attach a list if this space is insufficient)

Work was performed by Joseph Haberer 19 Farster St. St. Catharines Ont and Harold Wilkinson St. Catharines Ont 23 Rodman St. Work was performed with a Brownwade Air Compressor and Ron Gill.

Work was performed from Oct 24 - Nov 4, 77 and from Nov. 17 to Nov 30, 77, @ 12 hrs @ day

Date Dec 28 77

Signature of Recorded Holder

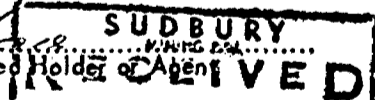

The Mining Act Certificate Verifying Report of Work

I, Joseph Haberer 19 Farster St. St. Catharines Ont L2K-2A1 (Post Office Address)

hereby certify:

- 1. That I have a personal and intimate knowledge of the facts set forth in the report of work and there to, having performed the work or witnessed same during and/or after its completion.
2. That the annexed report is true.

Dated Dec 2 19 77

Signature

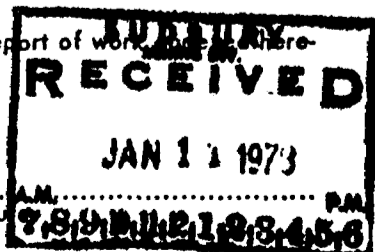

THE PENALTY FOR MAKING A FALSE STATEMENT IN THIS REPORT AND/OR CERTIFICATE IS \$500. OR SIX MONTHS IMPRISONMENT OR BOTH

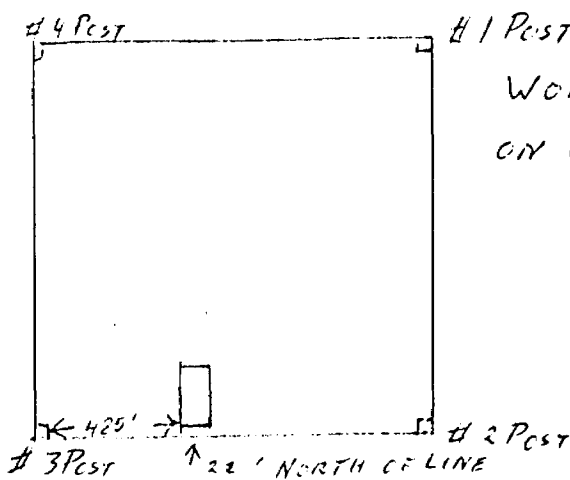
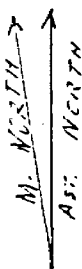

WORK WAS PERFORMED
ON CLAIM # 402277

Dec 8, 77