

McAUSLAN  
 (M-1)



THE MINING ACT REPORT OF WORK

recorded.

To the Recorder of SUDBURY Mining Division  
 I, (JOSEPH HABERER) DAVID L. CAMPBELL LTD.  
 name of Recorded Holder Prospector's Licence A 36834 T. 1197

Box 433 COMMERCIAL UNION TOWER, Post Office Address ST. B. ST. CATHARINES, ONT.  
P.O. BOX 2247 do hereby report the performance of 224 days of DRILLED + BLAST type of work MECHANICAL

not before reported to be applied on the following contiguous claims

Claim No.	Days	Claim No.	Days	Claim No.	Days
52.78.53	37.33				
52.78.54	37.33				
52.78.55	37.33				
52.78.58	37.33				
52.78.59	37.33				
52.78.60	37.33				

ONTARIO GEOLOGICAL SURVEY  
 ASSESSMENT FILES  
 RESEARCH OFFICE  
 NOV 4 1982  
 RECEIVED

RECEIVED  
 JUN 28 1982

SUDBURY  
 RECEIVED  
 SEP 27 1982

All the work was performed on Mining Claim (s) 52.78.53  
 (In the case of geological and/or geophysical survey (s) where more than 18 claims are involved attach a schedule)

READ CAREFULLY: THE FOLLOWING INFORMATION IS REQUIRED BY THE MINING RECORDER.

- WORK ASSIGN. } S. 527853 = 186.67 ; BAL. 3433.3
- For Manual Work, Stripping or Opening up of Mines, Sinking Shafts or Other Actual Mining Operations - Names and addresses of the men who performed the work and the dates and hours of their employment.
  - For Diamond and other Core Drilling - Footage, No. and angle of holes and diameter of core. Name and address of owner or operator of drill. Dates when drilling was done. Signed core log and sketch in duplicate.
  - For Compressed Air or Other Power Driven or Mechanical Equipment  
 Type of drill or equipment. Names and addresses of men engaged in operating equipment and the dates and hours of their employment.
  - For Power Stripping - Type of equipment. Name and address of owner or operator. Amount expended. Dates on which work was done. Proof of actual cost must be submitted within 30 days of recording.
  - With each of the above types of work sketches are required to show the location and extent of the work in relation to the nearest claim post. In the case of diamond or other core drilling the sketch must be submitted in duplicate.
  - For Geophysical, Geological, Geochemical Surveys and Expenditure Credits - the name of author of report. Covering dates of survey (linecutting & office). Type of instrument used. Total amount of expenditure. Technical reports, maps, expenditure breakdown, receipts must be filed in duplicate with the Minister within 60 days of recording.
  - For Land Survey - the name and address of Ontario Land surveyor.

The Required Information is as Follows: (Attach a list if this space is insufficient)

Work was performed by Jo. Haberer from April 1st 1982 to April 28 and Jeff Ray of Niagara Falls Drilled and Blast with a Brown-wade Aircompressor worked 12 hours per day  $28 \times 2 = 56 \times 4 = 224$  work days

Date June 2, 1982

Joseph Haberer  
 Signature of Recorded Holder or Agent

The Mining Act  
 Certificate Verifying Report of Work

I, Joseph Haberer  
P.O. BOX 2247 ST. B. ST. CATHARINES, ONT.  
 (Post Office Address)

hereby certify:

- That I have a personal and intimate knowledge of the facts set forth in the report of work annexed hereto, having performed the work or witnessed same during and/or after its completion.
- That the annexed report is true.

Dated June 2, 1982

Joseph Haberer  
 Signature

THE PENALTY FOR MAKING A FALSE STATEMENT IN THIS REPORT AND/OR CERTIFICATE IS \$500. OR SIX MONTHS IMPRISONMENT OR BOTH



31L14SW5064 W8207-00117 MCAUSLAN

900

- LICENSE OF OCCUPATION
- MINING RIGHTS ONLY
- SURFACE RIGHTS ONLY
- ROADS
- IMPROVED ROADS
- KING'S HIGHWAYS
- RAILWAYS
- POWER LINES
- MARSH OR MUSKEG
- MINES
- CANCELLED
- PATENTED FOR S. R. O.

Wyse Twp. - M.1187

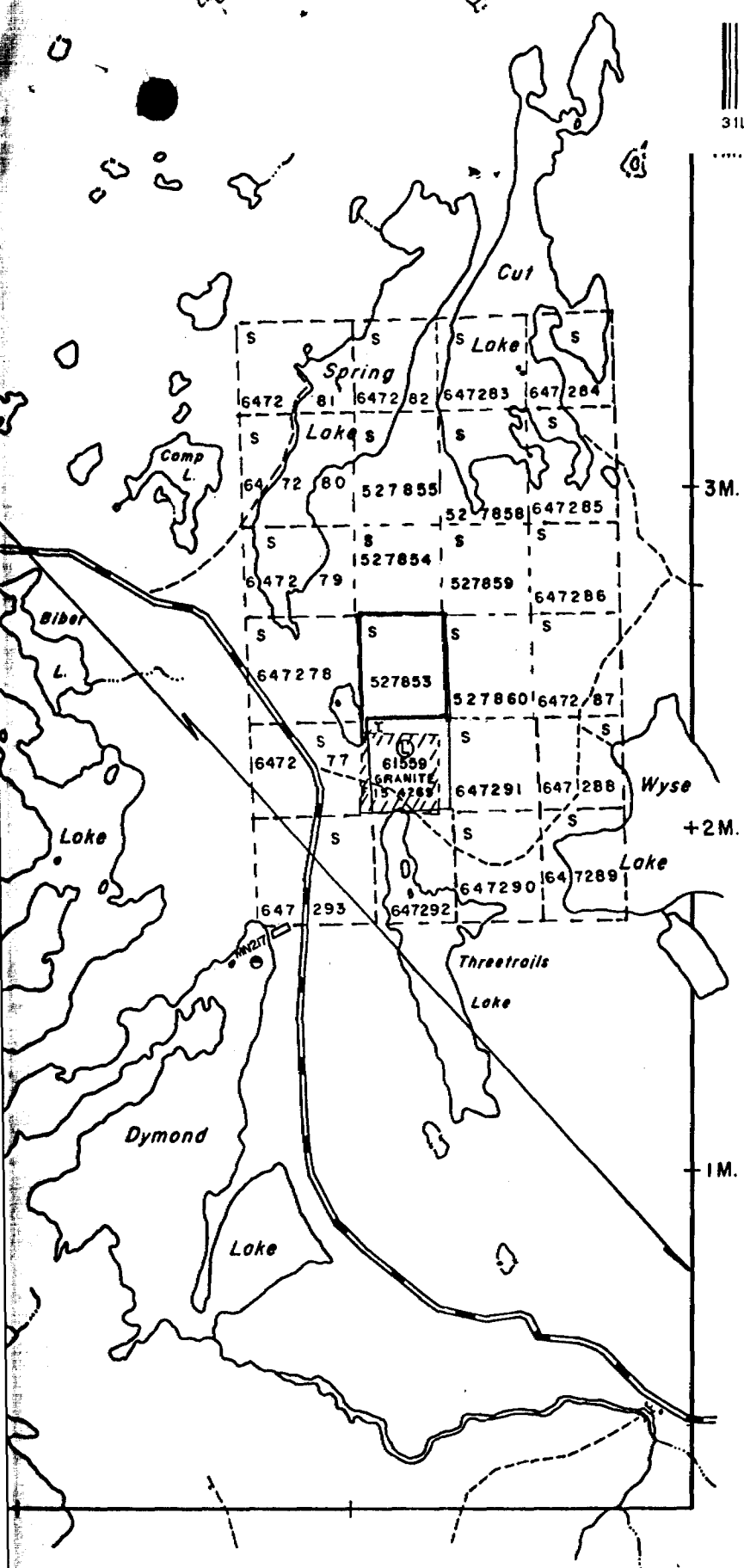

NOTES

400' surface rights reserved  
the shores of all lakes

AREAS WITHDRAWN FROM

Section	Date	Disposal
	DATE OF ISSUE	
	JUL 27 19	
Ministry of Natural Resources TORONTO		

R. 43 (R.S.O.'70) 26/4/74 ALL of Twp.

PLAN NO. - M

ONTARIO  
MINISTRY OF NATURAL RESOURCES  
SURVEYS AND MAPPING

A !!  
|

LOCATION OF WORK.  
CLAIM # 527853

