



31M03NW001B 25 SOUTH LORRAIN

010

Diamond Drilling

Township Of So. Lorrain

Report NO: 25

Work performed by: Geo-Scientific Prospectors

| Claim NO | Hole NO | Footage | Date | Note |
|----------|---------|---------|--------|------|
| T 44061 | 1 | 1492' | Aug/59 | |
| T 44059 | M2 | 1018' | Mar/60 | |

Notes:

DIAMOND DRILL RECORD

PROPERTY Geo-Scientific Prospectors Ltd.

HOLE NO. 1

Maidens Lake, South Lorrain Twp. Ontario

SHEET NUMBER 3 SECTION FROM _____ TO _____ STARTED _____

LATITUDE _____ DATUM _____ COMPLETED _____

DEPARTURE _____ BEARING _____ ULTIMATE DEPTH _____

ELEVATION _____ DIP _____ PROPOSED DEPTH _____

| DEPTH FEET | FORMATION | SAMPLE NO. | WGSN OR MAGN | XXX% | GOLDBL GOLDBL | | |
|-----------------|----------------------------------------------------------------------------------------------------------------------------------------------------------------------------------------------------------------------------------------------------------------------------------------------------------------------------------------------------|------------|--------------------|---------|------------------|---------|------|
| 1029.0' | Contact:- Sharp @ 50° | | | | | | |
| 1029.0'-1052.0' | <u>Keewatin Volcanics: Altered basalt (slightly carbonatized and chloritized) Medium to lighter green-grey colour. Fine grained. Medium hardness. In places slightly schistose effect at about 45° to core. 5-10% irregular quartz-calcite veinlets and stringers, generally barren but in places containing a little pyrite and chalcopyrite.</u> | | | | | | |
| | | | From | To | Width | Ag. oz. | Co% |
| 1052.0'-1053.5' | <u>Vein Zone:- Sheared, brecciated, chloritized and carbonatized. 1" breccia cemented with calcite, several striated shears at 15°, some fine cobalt arsenides. Consid. fine pyrite throughout. One grain chalcopyrite in 1" breccia with calcite</u> | 1 M.L. | 1052.0' | 1053.5 | 1.5 | Trace | 0.01 |
| 1053.5'-1212.5' | <u>Keewatin Volcanics: - as before</u> | | | | | | |
| 1212.5'-1213.0' | <u>Quartz-Calcite Vein: @ 60° to core. Grey-white crushed fractured calcite with small partly digested chloritic inclusions. Some fine pyrite and (fine cobalt arsenides?). Some yellowish sericitic alteration for an inch or so in both walls of vein</u> | 2 M.L. | 1212.5' | 1213.0' | 0.5 | 0.76 | |
| 1213.0'-1275.0' | <u>Keewatin Volcanics:- as before</u> | | | | | | |

DRILLED BY

SIGNED

DIAMOND DRILL RECORD

PROPERTY Geo-Scientific Prospectors Ltd.

Maidens Lake South Lorrain Tw p. Ontario

HOLE NO. 1

SHEET NUMBER 4 SECTION FROM _____ TO _____ STARTED _____

LATITUDE _____ DATUM _____ COMPLETED _____

DEPARTURE _____ BEARING _____ ULTIMATE DEPTH _____

ELEVATION _____ DIP _____ PROPOSED DEPTH _____

| DEPTH FEET | FORMATION | SAMPLE No. | From | To | Width | Ag. Oz. | |
|-----------------|---------------------------------------------------------------------------------------------------------------------------------------------------------------------------------------------------------------|------------|----------------------|---------|-------------------|---------|--|
| | | | WOODEN SIX FOOTER | XXXXX | XXXXX SIX FOOT | | |
| 1275.0'-1300.0' | <u>Fault Structure:- 5-10% irregular pink calcite veinlets with chlorite rims. Locally a little pyrite and chalcopryrite @1292'-1293', core of this fault structure, fractured and considerably oxidized.</u> | | | | | | |
| 1300.0'-1482.0' | <u>Keewatin Volcanics: As before</u> | | | | | | |
| 1482.0'-1485.0' | <u>Fault Vein Structure: - Sheared and brecciated at 35°. Shearing and brecciation cemented with calcite. Some fine pyrite. Later fault movement @ 1482.5'-1483.0', brecciated sheared and minor gouge.</u> | 3 M.L. | 1482.0' | 1484.0' | 2.0' | 0.38 | |
| 1485.0'-1492.0' | <u>Keewatin Volcanics: As before</u> | | | | | | |
| 1492.0' | <u>End of hole</u> | | | | | | |
| | Contractor: N. Morissette | | | | | | |
| | Core Size: A.X.T. 1-1/4 diameter | | | | | | |
| | Core Recovery: Excellent (about 4' lost core for narrow sections throughout hole) | | | | | | |
| | Results: Possibly important veins intersected at | | | | | | |
| | (1) 1052'-1053.5' | | | | | | |
| | (2) 1212.5' - 1213.0' | | | | | | |
| | (3) 1482.0'-1485.0' | | | | | | |

DRILLED BY

SIGNED

12-1-325

South Lorrain

DIAMOND DRILL RECORD

PROPERTY HAIDENS LAKE, SOUTH LORRAIN TOWNSHIP, ONTARIO HOLE NO. # 2



SHEET NUMBER 1 SECTION FROM _____ TO _____ STARTED 4-3-60
 LATITUDE Line 440 DATUM Claim # 744359 COMPLETED 24-3-60
 DEPARTURE 650m BEARING 209° ULTIMATE DEPTH 1016
 ELEVATION Lake Level DIP -45° (525° -53°) (925° -54°) PROPOSED DEPTH 1000

| DEPTH FEET | FORMATION | SAMPLE NO. | WIDTH OF SAMPLE | PERCENT SILICEOUS | PERCENT CARBONATE |
|------------|-----------------------------------------------------------------------------------------------------------------------------------------------------------------------------------------------------------------------|------------|-----------------|-------------------|-------------------|
| 0 - 25 | Coarse (10' H2O. Med. Gravel, Boulders) | | | | |
| 25 - 134.4 | <u>Nipissing Diabase</u> | | | | |
| | Medium grained grayish-black in colour except from (50.8 - 52.2) (60.4 - 62.1) (132.1 - 134.4) which is fine grained nip. diabase. grey in colour. with several veinlets and erratic stringers of qtz. carb. present. | | | | |
| | <u>50.8 - 52.2</u> | | | | |
| | Fine grained nip. diabase. gradational contacts. and bearing a 5/8" qtz-carb vein (51.4 - 51.6) at 30° to core. Cpy. speck in vein. | A | 2" | 0.06 | Trace |
| | <u>60.4 - 62.1</u> | | | | |
| | As from 50.8 - 52.2 with a 1/4" qtz-carb. vein (speck cpy) at 30° to core (61.4 - 61.6). | B | 2" | 0.16 | .01 |

N.M.P., TORONTO-STOCK FORM NO. 501 REV. 12/51

DRILLED BY N. Korissette D.D. Co. Ltd.

SIGNED G. Ross

DIAMOND DRILL RECORD

PROPERTY _____

HOLE NO. _____

SHEET NUMBER 2

SECTION FROM _____ TO _____

STARTED _____

LATITUDE _____

DATUM _____

COMPLETED _____

DEPARTURE _____

BEARING _____

ULTIMATE DEPTH _____

ELEVATION _____

DIP _____

PROPOSED DEPTH _____

| DEPTH FEET | FORMATION | SAMPLE NO. | WIDTH OF SAMPLE | GOLD% silver | COPPER% cobalt | | |
|---------------|----------------------------------------------------------------------------------|------------|-----------------|----------------------------|------------------------------|--|--|
| 77.4 | | | | silver | cobalt | | |
| | 1 multi gauge with soft greenish sericite schist at 30° to core. | | | | | | |
| 78.0 and 78.1 | | | | | | | |
| | 2 - 1/4" qtz-carb. veins (speck epy) at 50° to core. sampled together. | C | 1" | 0.10 | nil | | |
| 83.0 | | | | | | | |
| | irregular qtz-carb. veining (speck epy.) (83.0 - 84.2) | D | 4" | 0.00 | Trace | | |
| 128.1 - 128.2 | | | | | | | |
| | qs iron (50.0 - 52.2) (60.4 - 62.1) abrupt contact with cobalt series sediments. | | | | | | |

DRILLED BY

SIGNED

DIAMOND DRILL RECORD

PROPERTY _____

HOLE NO. _____

SHEET NUMBER 3

SECTION FROM _____ TO _____

STARTED _____

LATITUDE _____

DATUM _____

COMPLETED _____

DEPARTURE _____

BEARING _____

ULTIMATE DEPTH _____

ELEVATION _____

DIP _____

PROPOSED DEPTH _____

| DEPTH FEET | FORMATION | SAMPLE NO. | WIDTH OF SAMPLE | GROSS SILVER | SLURGE SILVER | | |
|----------------------|-------------------------------------------------------------------------------------------------------------------------------------------------|------------|-----------------|--------------|---------------|--|--|
| | <u>134.2 - 134.9</u> | | | | | | |
| | <u>Erratic qtz-carb. stringers</u> | <u>H</u> | <u>2"</u> | <u>0.15</u> | <u>Nil</u> | | |
| <u>134.4 - 434.5</u> | <u>Local erica sediments</u> | | | | | | |
| | <u>Gradational sedimentary deposits (gravel to fine silt), banded slates generally gray, fine grained graywacke, conglomerate, and breccia.</u> | | | | | | |
| | <u>Sediments banding at 40° - 50° to core. Continuation of qtz-carb. veining from 30° - 60° to core with halo appearance and specks of epy.</u> | | | | | | |
| <u>134.4 - 145.7</u> | <u>alteration of sed. by Rip. disease</u> | | | | | | |
| <u>137.5 - 139</u> | <u>Water passage evident. Some red oxidation stains in stringers also.</u> | | | | | | |
| <u>143.5 - 143.6</u> | <u>qtz-carb. veining (halo effect)</u> | <u>F</u> | <u>3"</u> | <u>0.03</u> | <u>H</u> | | |
| <u>373.2 - 373.5</u> | <u>Erratic qtz-carb. veining</u> | <u>G</u> | <u>3"</u> | <u>1.02</u> | <u>0.01</u> | | |
| <u>362.2 - 362.5</u> | <u>Erratic qtz-carb. veining</u> | <u>H</u> | <u>3"</u> | <u>0.36</u> | <u>I</u> | | |
| <u>400 - 475</u> | <u>Excellent grain gradation and banding of slates.</u> | | | | | | |

DRILLED BY _____

SIGNED _____

DIAMOND DRILL RECORD

PROPERTY _____

HOLE NO. _____

 SHEET NUMBER 4

SECTION FROM _____ TO _____

STARTED _____

LATITUDE _____

DATUM _____

COMPLETED _____

DEPARTURE _____

BEARING _____

ULTIMATE DEPTH _____

ELEVATION _____

DIP _____

PROPOSED DEPTH _____

| DEPTH FEET | FORMATION | SAMPLE NO. | WIDTH OF SAMPLE | SILVER | SLUDGE | | |
|---------------|--------------------------------------------------------------------------------------------------------------------------------------------------------------------------------------------------------------------------------------------------------------------------------------------------------------------------------------------------------------------------------------------------|------------|-----------------|--------|--------|--|--|
| 494.5 - 501.5 | <p>Fine conglomerate (to 1/8") in schist series sand matrix. This is a type section which penetrates and follows the forthcoming breccia zone description from 501.5 to 627.</p> | | | | | | |
| 501.5 - 627 | <p>Fault Breccia Zone (125.5')</p> <p>Zone of intense brecciation composed of schist series sediments, algal conglomerate fragments, strong concentrations of qtz-carbonate veining. Contact is approximately 50° to core.</p> <p>This zone was sampled for silver and schist. However, from 540 - 597 there was 4% core recovery (2% blocky) and 5% negative recovery.</p> | | | | | | |
| 501.5 - 507 | | I | 5.5 | 0.12 | 0.01 | | |
| 507 - 513 | | J | 6.0 | 0.05 | 0.01 | | |
| 513 - 518 | | K | 5.0 | 0.07 | T | | |
| 518 - 523 | | L | 5.0 | 0.04 | 0.01 | | |
| 523 - 530 | | M | 5.0 | T | N | | |
| 530 - 532.5 | | N | 3.5 | T | N | | |

DIAMOND DRILL RECORD

PROPERTY _____

HOLE NO. _____

SHEET NUMBER 5 SECTION FROM _____ TO _____ STARTED _____

LATITUDE _____ DATUM _____ COMPLETED _____

DEPARTURE _____ BEARING _____ ULTIMATE DEPTH _____

ELEVATION _____ DIP _____ PROPOSED DEPTH _____

| DEPTH FEET | FORMATION | SAMPLE NO. | WIDTH OF SAMPLE | PERCENT Grit | PERCENT Grit | | |
|---------------|------------------------------------------------------------------------------------------------------------|------------|-----------------|--------------|--------------|--|--|
| 535 - 540 | | O | 5.0 | 0.04 | N | | |
| 542 - 544 | | P | 4.0 | T | N | | |
| 567 - 572 | | Q | 5.0 | N | N | | |
| 597 - 604 | | R | 7.0 | 0.05 | N | | |
| 604 - 609 | | S | 5.0 | T | T | | |
| 609 - 616.5 | | T | 6.5 | N | T | | |
| 619.5 - 623.5 | | U | 4.0 | N | T | | |
| 623.5 - 627 | | V | 3.5 | N | T | | |
| 516.5 - 519.5 | Arkose grit band, | | | | | | |
| 549 - 550 | Fault gouge. | | | | | | |
| 627 - 629 | <u>Arkose grit band</u> as from (516.5 - 519.5) maybe 50° to core - no qtz-carb veining. | | | | | | |
| 629 - 705 | Conglomerate zone similar to 404.5 - 501.5 | | | | | | |
| 705 - 820 | Fine grained graywacke, block. Sparse qtz-carb. veining. | | | | | | |
| 820 - 1016 | Beginning of dike system which prevented entry into the Kooztin volcanics. Dikes range in composition from | | | | | | |

DIAMOND DRILL RECORD

PROPERTY _____

HOLE NO. _____

SHEET NUMBER _____

SECTION FROM _____ TO _____

STARTED _____

LATITUDE _____

DATUM _____

COMPLETED _____

DEPARTURE _____

BEARING _____

ULTIMATE DEPTH _____

ELEVATION _____

DIP _____

PROPOSED DEPTH _____

| DEPTH FEET | FORMATION | SAMPLE No. | WIDTH OF SAMPLE | GRAVE | BLUDGE |
|------------|---------------------------------------------------------------|------------|-----------------|-------|--------|
| | granodiorite to leucophyre including several aplite dikes. | | | | |
| | 881.0 - 882.0 graywacke at 50° to core. | | | | |
| | 885.2 3/8" graywacke band with erratic qtz-carb | | | | |
| | 914 - 919 Aplite with cgl. vein (1") at 25° to core at 915.2. | 8 | 1" | 0.20 | 0.01 |
| | 927.7 - 929.5 Aplite at 50° to core. | | | | |
| | 934 - 935 1/2" qtz-carb veinlets. | | | | |
| 1010 | 1010 to 1000 | | | | |
| | 1000 CORE | | | | |
| | 525 - 526 (2) 533.5 - 535 (1.5) 540 - 543 (3) 545 - 546 | | | | |
| | (1) 547 - 549 (2) 550 - 551 (1) 552 - 553 (1) | | | | |
| | 554 - 556 (2) 557 - 558 (1) 559 - 562 (3) 566 - 567 (1) | | | | |
| | 570 - 572.5 (0.5) 572 - 573.5 (1.5) 574 - 575 (1) | | | | |
| | 576 - 581 (5) 581 - 587 (5) 588 - 589 (1) 590 - 591 (1) | | | | |
| | 591.5 - 592.5 (1) 593.5 - 595 (1.5) 596 - 597 (1) | | | | |
| | 606.5 - 607 (0.5) 613.5 - 617 (1.5) 617 - 619.5 (2.5) | | | | |

19-1-324

744059

729490

Maidens
Lake

744060

731854

729489

DDH#1

290' @ S 62 1/2° W
of Post #1, 744061

745241

744061

744062

GEO SCIENTIFIC
PROSPECTORS ASSN
MAIDENS LAKE
DRILLING
SOUTH LORRAINE Twp

Scale 1" = 400'

Sept 30/59

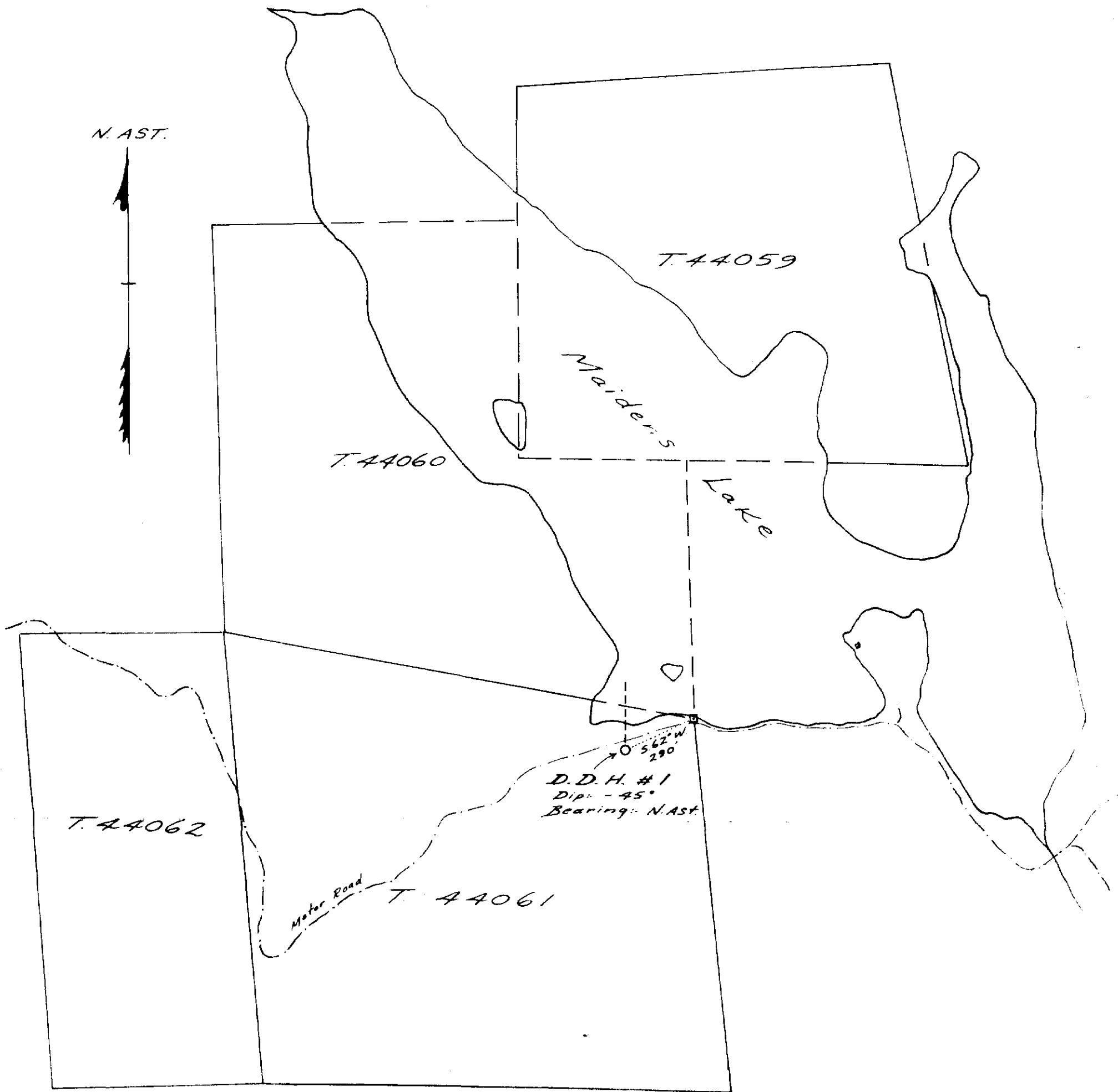

SKETCH TO SHOW LOCATION
OF
D. D. H. N° 1

GEO-SCIENTIFIC PROSPECTORS LTD

MAIDENS LAKE CLAIMS

SOUTH LORRAIN TWP - ONT.

Scale: 1 inch = 400 feet



31M03NW0018 25 SOUTH LORRAIN

T44059

W 000.1 2

Fd W Posts
4-31854 etc.

T44060

Maidens

T31854

Lake

Baseline Dwg. 1487

7100W

Fd Cl Posts
3-31854 etc.

HIGHWAY 567

W

260'

130'

0004

T44061

T45241

Sketch Showing
Location

D.D.H.

MAIDENS LAKE

TOWNSHIP OF SOUTH LORRAIN

Scale: 1 inch = 100 feet



31M03NW0018 25 SOUTH LORRAIN