



31M03NW0022 2.15553 SOUTH LORRAIN

010

**RECEIVED**  
SEP 02 1994  
MINING LANDS BRANCH

**PROSPECTING REPORT**  
**TO**  
**ACCOMPANY REPORT of WORK**  
**AFTER RECORDING CLAIMS**  
**FOR**  
**ASSESSMENT CREDITS**  
  
**J.A.GORE PROPERTIES**  
**SOUTH LORRAIN TOWNSHIP**  
**MINING CLAIMS #1179630 and #1179631**

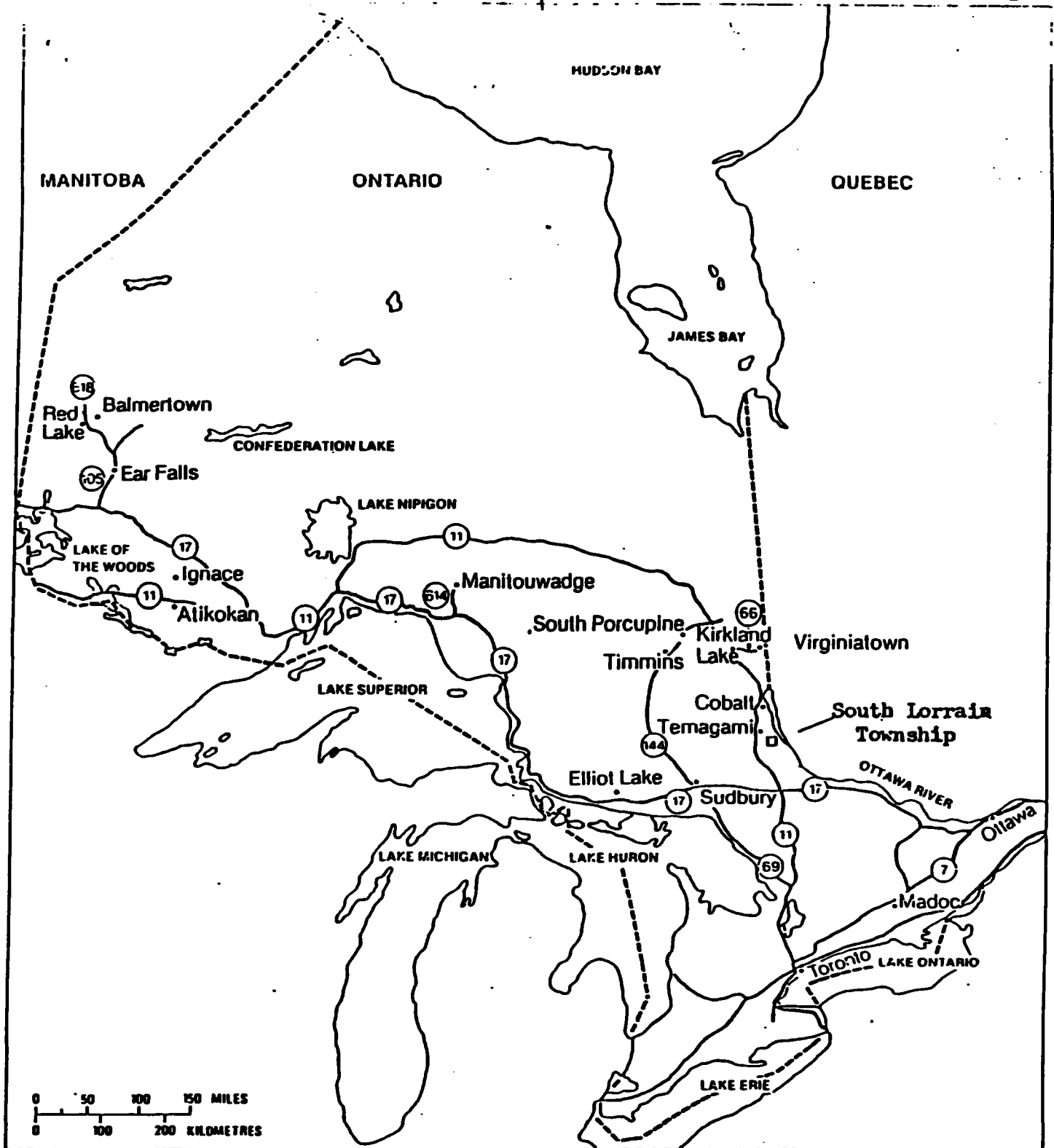

LOCATION MAP

FIGURE 1

REPORT TO ACCOMPANY  
REPORT of WORK  
AFTER RECORDING CLAIMS  
FOR ASSESSMENT CREDITS  
JOHN GORE PROPERTIES  
SOUTH LORRAIN TOWNSHIP  
DISTRICT of TEMISKAMING, ONTARIO  
LARDER LAKE MINING DIVISION

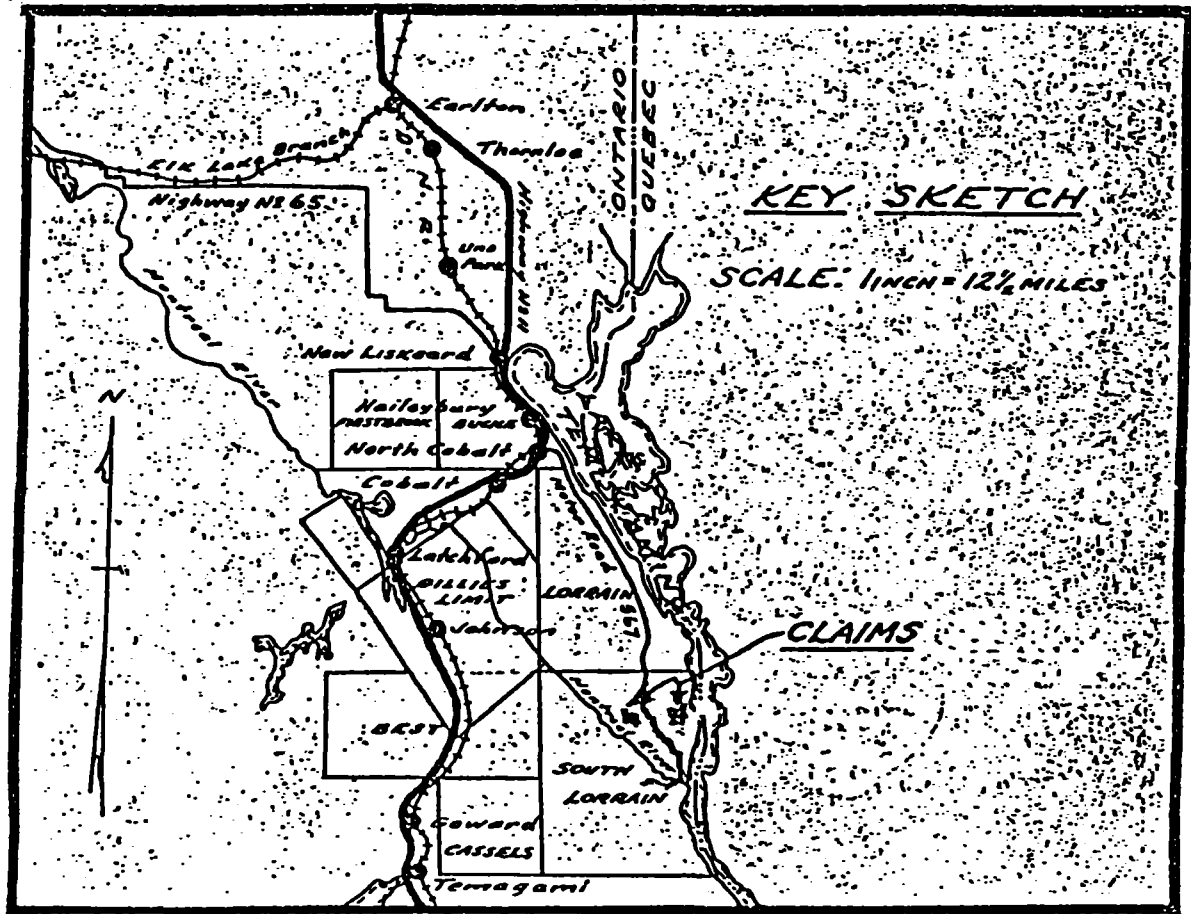

PROSPECTING REPORT  
of  
JOHN GORE PROPERTIES  
SOUTH LORRAIN TOWNSHIP

On May 18/93, I went down to South Lorrain and started to systematically search for the pit mentioned in the report of Dr. Thomson former Resident Geologist at Cobalt, in regards to a conversation with a Mr. Ralph Benner, (copy of this report included). As it is not clear exactly where this pit is located, except it is stated " in Keewatin some distance from the Diabase". I started on Mining Claim # 1179630 going Easterly, checking outcrops as I went, there is considerable outcrop of Keewatin, intermediate to Basic, and along the Hydro line, pillow lavas with their tops to the North. In the Southeast corner of this Claim, along the Eastern boundary is some minor rock trenching, no sign of mineralization however. The Diabase, Keewatin contact here lies along the East facing side halfway up the hill from the road, and by intermittent stripping I followed the Diabase, Keewatin contact Southwesterly to the vicinity of the steel survey pin at the Northeast corner of the former Patented claim #ER113, and now the site of #3 post for the present claim #1179630. It is worth noting here that the Geological map, #2194 for South Lorrain shows the assumed location of the road to the East, but it is actually along the Diabase Keewatin contact at this site. May 19/93 I continued my prospecting from this survey pin, which is also the location of the line post for Claim #1179631. I went Eastward along the claim line until I came to the Huronian overlying the Keewatin, I then turned South approximately 100 paces where I then turned Westward crossing a few old surface trenches, I did not reach bedrock in them, and there are not too many outcrops until one reaches the base of the Keewatin hill. On June 1/93 I continued traversing at about 100 paces apart in an East West direction there were no signs of any pits, rock or surface trenching, the overburden is apparently deep in the depression that trends Northeasterly, with Huronian on the East side, and Keewatin on the West. By June second, I am beginning to wonder if the pit mentioned in the report really exists, I am doing minor stripping as I go, checking all outcrops that I see, when I find Huronian I turn West until Diabase, in this area the Keewatin appears to be mostly drift covered, later this afternoon I am finding my East-West traverses becoming shorter that is between the Diabase and the Huronian and there is more outcrops of Keewatin. June 3/93 continued searching and at noon when crossing the Oxbow Lake road some 500 paces South of the survey pin I noticed a hump with a lot of small Balsam about 25' South of me. I found a pit about 5'x5' with a mud seam. Flies are terrible, pit appears to be about 8' to 10' deep by the size of the waste dump. I cleared some brush and trees and examined the dump, there is Hematite staining and the fracture containing a mud seam is interesting looking but unfortunately whoever did the work apparently concentrated on the pit and threw the waste on the surface above the fracture. Once I had located the pit which appears to be some distance from the Diabase as referred to in the report, I returned to the Eastern site (Portion #1) to try and define a drill target based on the information from the Airborne Magnetic and V L F Electromagnetic Survey by H. Ferderber Geophysics Ltd. of Sept. 8/92 of Chitroni properties in South Lorrain which also covered my claims. This report indicated 2 VLF conductors in the area of my proposed drilling.

After discussing this with the staff of the local Resident Geologist's Office, it is assumed that one indicated conductor is in all likelihood the swamp and creek, the other appeared to warrant further examination I decided to cut a grid and do a VLF ground survey. This occupied some two weeks, having borrowed an EM16 from the Resident Geologist's Office, and with their assistance the data was compiled in the accompanying report included in Part #1 (Eastern Portion) the dates are listed in the daily reports, 1993 with the final submission form accompanying this report.

On June 27/93 I returned to the Western portion (Part #2) and started to strip and trench the pit area. In my ongoing research I found that there apparently was five pits in this group so for the purpose of convenience I will number them in the sequence that I find them through my prospecting efforts. On June 29/93 I borrowed the "Beep Mat" from the local Resident Geologist's Office and did a preliminary survey on the Western group. There were numerous indications of Magnetite in Diabase boulders, there were two interesting sites in the Keewatin series, one directly behind my table some 50' East of Pit #1 and again a further 25' East of this apparently of a magnetite composition, later stripping and trenching produced nothing of economic interest. I continued stripping and trenching as listed in the daily report sheet and on July 3/93 as I was trenching 75' North of pit #1, I located a contact between the Diabase and the Keewatin, this does not necessarily correspond with the reference in the report "some distance from the Diabase". On July 4/93 I returned to the Eastern claims to further prospect and sample last year's work-site, as in researching a report on the Chitroni properties adjoining mine, by a Mr. Doug Robinson P.E. on Nov. 30/92, he mentioned that any Sulphide or Oxide concentrations in the Nipissing Diabase not directly associated with calcite veins, should be assayed for Platinum group metals as this is a differentiated mafic intrusive. The resultant assay results (included with Part #1 Eastern Portion) of this report were negative however. July 5/93 while stripping in the area of the Beep Mat indication, East of my table I uncovered a small area of Rhyolite, (Photo attached) however there was no sign of any mineralization. On July 8/93 Mr. Jim Ireland and his assistant Mr. Ray Zalnierunas, contract Geologist came down to the Eastern claims (Part #1) of this report. They examined the Grid, and later we went to examine the contact between the overlying Keewatin and the Diabase. They photographed this and further examined the area and suggested that I extend my Grid by doing a North South station line 150' East of Tie Line East. On July 9/93 I extended Tie Line East South up to the #3 post for Mining claim #1118861. On July 13/93 I borrowed the EM16, and after finishing Tie Line East +150' I attempted to take a reading, however I was unable to get Cutler station it must have been off the air. July 17/93 I trenched at pit #1, and on July 18/93 trenched in a Westerly direction towards The Oxbow Lake road Keewatin here is still fractured, no sign of mineralization except for Hematite staining. On July 20/93 I prospected in an Easterly direction I found another pit, #2. On examining the waste dump I find Keewatin, and I noticed a small malachite stain, and considerable Quartz, I decided to explore this further. After bringing over tools, and equipment I cut the brush, and started to remove debris, fallen trees etc. The Keewatin is here but no further sign of malachite staining. On July 23/93 while mucking out I realized there was something odd about the Geology, it appears to me as if the Keewatin was overlying the Huronian. On July 24/93 while mucking out, I find another type of rock, I had previously noticed some of this rock in the waste dump, I thought it might be a Lamphophyre and in place in the pit it appears to be a horizontal lying intrusive, with the Keewatin above and it butts up against a fine grained rock with a lot of Quartz veining again with no sign of mineralization. On July 25/93 I trenched some more and sampled the rocks, I am taking them to the Resident Geologist's Office to-morrow for identification. On July 26/93 I showed the rocks to the staff at the office of the local Resident Geologist, and discussed the situation with them, I proceeded to trench some more and to prospect the immediate area in the vicinity of the pit. I found more Keewatin, and on the South side Huronian, conglomerates, but in the pit itself it only gets more puzzling.

On July 27/93 I talked to the Resident Geologist about this, they are interested but cannot express an opinion without a close inspection. On July 28/93 I returned to pit #1 and continued stripping and trenching to examine contacts, I went Westerly looking for outcrops of Diabase, so as to determine the contact, about 180' West of #1 pit across the Oxbow Lake road I stripped off a Diabase outcrop and started to work back Easterly I dug a hole 30" deep through overburden I hit Diabase but I was not sure it was bedrock, I broke off a sample and used my bar to test it felt like bedrock. On July 29/93 while still prospecting Easterly I came to Keewatin that is slate like in appearance in vertical position, there is considerable overburden, contact again appears to be in the side of the small hill.

On August 3/93 I again went to the #2 pit washed off the sidewall trenched some more and did some measuring to get a line on the location. The Geology gets more puzzling to me, where the horizontal intrusive meets the flat lying, fine grained rock with the Quartz veining, is a peculiar shape sort of like a pitched roof effect. On Aug. 4/93 I started to prospect South from the line post for Mining claim #1179631. Approximately 400 M South of this post I found another old pit, as this is the third pit I have found, I will refer to it as Pit #3. South of this pit I crossed a swamp at the base of a prominent hill, by stripping I determined that it is conglomerate of the Huronian series. Continuing Southwesterly I came out at the Northwest corner of the swamp, there is considerable chlorite spotting in the conglomerates in this area. From this exploration it became apparent that #2 pit was approximately halfway between Pit #1 and Pit #3 in an East West direction. I went to #3 Pit, it is hard to estimate the depth of this pit, as the area is overgrown and the pit is full of debris, with 6" cedar tree and some maple growing on the edge, indications from the probable size waste dump indicate a depth of 8' to 10'. I will get someone to come down with me to hold a safety rope, in the event that the debris is not solid.

Borrowed the EM16 on Aug. 5/93 to finish the VLF ground survey on the Eastern portion and finished to-day, Cutler came in real clear this time. Arranged to hire M. Conlin, for one day Aug. 7/93, we went down to #3 Pit taking in safety belt, rope etc. the debris is solid and safe to work on. We examined a showing of fault gouge along the south side with an East West strike with a vertical dip, approximately 10" wide. We crossed the swamp and prospected South up the hill, did not see anything of interest.

Aug. 9/93 I went back to Pit #2 did some stripping South of the Pit, there was nothing of interest, again Conglomerate with minor chlorite spotting, the swamp apparently is the topographical expression of a fault in my opinion. Aug. 12/93 went to Pit #2 and dug down through the hardpan I then went out to the Oxbow Lake road and to the beaver pond for water to wash off the contacts so that Mr. Ray Zalnierunas the contract Geologist from the Cobalt Office of the Resident Geologist, I took in a sample of the fine grained material on the possibility that it might be a Kimberlite on examination by the Resident Geologist it was determined that it was a sediment of the Huronian. Aug. 13/93 Ray came down, he did a thorough job of examining Pit #1, the structure and the mud seam, at the site of my stripping about 80' North of the Pit, and 25' East of the line I had run from the Pit there appears to be a minor fold in the Keewatin, and to be able to determine whether it is pre ore or post I need to extend my stripping and trenching. He examined the 30" hole I had dug across the road West of the Pit and the outcrop of Diabase, in his opinion the rock I had chipped the sample from is a boulder, my bar I used for testing probably passed beside it to bedrock. We then proceeded Easterly to the site of where the Rhyolite showing

is ,he examined this and the more mafic structure on each side of it,we then proceeded to Pit #2,after some length of time and a very thorough examination,he said it is a Non-conformity,and very interesting from a Geological standpoint but of little economic significance at present and indicated where I should do some more trenching and stripping, he examined the area South of the pit where I had stripped the Huronian, we then proceeded Eastward,about halfway between Pit #2 and Pit#3 to where I had stripped off an area of Keewatin,which he examined and then we proceeded East to the site of Pit#3,here he recommended that I clean out more of the pit,as the bedding appears to be at right angles in the pit wall,and to check the fault gouge.We then crossed the swamp South of the pit, and he looked at the Conglomerates where it was stripped off, the further West we went the more Chlorite spotting there appeared to be,Ray also thinks this swamp is a fault,on leaving the swamp and following the Conglomerate outcrop along the Northwest corner Ray located a fairly large pit in the conglomerates,there did not appear to be anything of interest here.On Aug.14/93 I continued working in the #2 pit,obviously the previous work had not gone to bedrock because of the presence of hardpan along the bottom of what evidently was a pre Huronian cliff,as Ray Zalnierunas had shown me yesterday how the Huronian had been laid down on the step like irregular edge of the Keewatin,that had given me the impression that The Keewatin was overlying the Huronian,as I had mistakenly thought.On Aug.17/93 I continued to strip above the edge on the Eastern side where Ray had suggested,it had rained pretty heavy the night before so I was able to get water on the site to wash off the rock,and exposing the contact between the Keewatin and the Conglomerate,still not too clear in my mind about the intrusive and the fine grained sediment,but as it is not of any significant economic interest I decided to concentrate my prospecting efforts further East at Pit#3.As I was mucking out the pit the North wall which up to now was covered by debris became visible and I noticed Malachite staining,I broke some chunks off they were chunks of massive Sulphides of primary origin,I took the samples in to the Resident Geologist's Office,the opinion being that this possibly could be significant, and I am going to concentrate all my efforts on this site.

On Aug.18/93,I borrowed the Beep Mat from the local Resident Geologist's office,on the trail from Pit#2 to Pit #3 the numerical indicator on the instrument,varied from a low of 2 to a high of 60 however in the pit near the Malachite staining it went to a high of 7000+ I then proceeded to traverse the area in the vicinity of the pit, but there is considerable overburden in this area,and there was nothing more at this time.On Aug.19/93 I returned the Beep Mat,went down and started to muck up onto a ledge so as to be able to muck from the ledge far enough back so it would not fall back into the pit.The water began to show up,and the Malachite staining still shows on the wall,there are several large boulders in the pit also.Aug.20/93 I constructed an overhead beam so as to be able to use block and tackle to remove these boulders, the more muck I remove the more water there appears to be.The Sulphides here do not appear to have been altered during the Hydro thermal activity if that was what brought the Ag. ,Co. veins in the area.Aug.28/93 contined mucking out slimy,smelly debris and roots,I managed to remove some of the boulders,but I will have to make a bigger carrier for the largest one.Aug 29/93 took in chains,and expanded steel mat,this worked okay but now my homemade ladder is too heavy and cumbersome,I will bring in an aluminum ladder to-morrow,I notice metallics right up to the top of the pit on the North wall. Sept.2/93 I moved 30' North of pit and

started to trench to bedrock to see if I find any further signs of mineralization that will determine which direction I will trench. At this site there is 36" to 40" of overburden, with more of the famous South Lorrain hardpan. Sept. 16/93, Mr. James Cechetto, senior project Geologist, for Falconbridge Ltd. came down and looked over some of my stripping and trenches on his way to examine Pit#3 where the Sulphide Showing is. (see accompanying letter) After examining site, and taking samples of rock, and mineral, (see accompanying assay results) he suggested that I strip the area to see if the deposit is of any size and to get a better idea of the Geology. Sept. 21/93 I went to Sudbury to explain further to my previous phone call regarding a change from the Diamond Drilling on the Eastern Portion Part#1, to a mechanical stripping on the Western Portion Part#2, I spoke with Mr. Gary Grabowski and showed him some samples from Pit#3 with Malachite staining. On Sept. 26 I went down with Mr. James Lathem to show him the site of the proposed stripping, I had received work permit #(N)46-286-93 from the Ministry of Natural Resources for this work. Oct. 8/93 went down and removed the overhead beam, took all tools, fire fighting equipment, ladder etc. out of the way. Oct. 12/93 I hired Mike Conlin again for a day while bulldozer was stripping, to scrape where we could. Oct. 13/93 I worked at scraping behind the machine, until I terminated the bulldozer work as the area is close to what my work permit called for. Had I known that the Huronian contact was close to the pit as it was I would have had him clean more on the North side. Oct. 15/93 I had Resident Geologist, Mr. Jim Ireland and the Contract Geologist Mr. Ray Zalnierunas down to examine site, they recommended that I continue scraping and washing off more of the area. I wish to at this time, express my thanks and appreciation for the assistance and courtesies extended to me by the Staff of the office of the Resident Geologist here in Cobalt, The services provided are invaluable, and in my opinion essential to the carrying out of exploration projects, from their assistance in the field to the files for research in the Office. Due to the fact that there is apparently no known reference to copper mineralization of primary occurrence on this site, and following the mechanized stripping, and to be able to get a proper perspective of the significance of this showing I decided to have Mr. A.W. Beecham M.Sc. F.G.A.C. Exploration and Mining Geologist, to examine the site and make a report, of which I am including, with the data of this submission.



JOHN GORE PROPERTY - SOUTH LORRAIN

X-RAY ASSAY LABORATORIES 08-Oct-93 REPORT REF. 16274 PAGE 1

SAMPLE	AU PPM FAAA	NA2O % XRF-F	MGO % XRF-F	AL2O3 % XRF-F	SiO2 % XRF-F	P2O5 % XRF-F	K2O % XRF-F	CaO % XRF-F	TiO2 % XRF-F	CR2O3 % XRF-F	MNO % XRF-F
SA-31158	82	0.71	61	18.0	72.9	1.07	1.18	3.00	1.81	1.03	0.03
SA-31159	5	4.24	2.44	17.0	60.9	.11	2.23	.36	.456	<.01	.06
SA-31160	37	--	--	--	--	--	--	--	--	--	--
SA-31161	27	--	--	--	--	--	--	--	--	--	--
SA-31158	82	0.71	61	18.0	72.9	1.07	1.18	3.00	1.81	1.03	0.03

SAMPLE	FE2O3 % XRF-F	CU PPM ICP	SI PPM ICP	CV PPM ICP	ZN PPM ICP	RB PPM XRF-F	T PPM XRF-F	ZR PPM XRF-F	AG PPM ICP	BA PPM XRF-F	PD PPM ICP
SA-31158	1.20	7	5	15.0	13.1	48	10	71	2.1	1020	--
SA-31159	7.55	36	36	94.6	28.0	86	10	140	.1	488	--
SA-31160	--	--	173	26600	61.6	--	--	--	15.6	--	96
SA-31161	--	--	173	87100	114	--	--	--	33.0	--	45
SA-31158	1.20	7	5	15.0	13.1	48	10	71	2.1	1020	--

SAMPLE	LOI % XRF-F	SUM % XRF-F
SA-31158	1.12	99.9
SA-31159	2.96	98.3
SA-31160	--	--
SA-31161	--	--
SA-31158	1.12	99.9

- SA-31158 : FELSIC INTRUSIVE, FROM ROADWAY, EAST OF PROPERTY.
- SA-31159 : HOST ROCK ADJACENT TO COPPER SHOWING, LOOKS LIKE A SHEARED/ALTERED MAFIC VOLCANIC - DEFINATE PILLOWS IN AREA THAT HAVE A SIMILAR APPEARANCE.
- SA-31160 : \* SHOWING, 5% CHALCOPYRITE, 15-20% PYRITE.
- SA-31161 : \* AS ABOVE.

\* COPPER ASSAYS CAME OUT ±25% HIGHER THAN VISUAL ESTIMATIONS.

J.K. Cecchetto  
 SENIOR PROJECT GEOLOGIST  
 FALCONBRIDGE LIMITED.  
 OCTOBER 14, 1993.



# Swastika Laboratories

A Division of TSL / ASSAYERS INC.

Assaying - Consulting - Representation

Established 1928

## Assay Certificate

3W-2519-RA1

Company: **J A GORE**

Date: **SEP-22-93**

Project:

Attn:

We hereby certify the following Assay of 3 ROCK samples submitted SEP-20-93 by .

Sample Number	Au oz/ton	Au oz/ton	Ag oz/ton	Co %	Cu %	Ni %	Zn %
15701	0.002	0.002			2.77		0.005
15702				0.020	4.89	0.02	
15703	0.001		0.06		0.23		

RECEIVED  
 NOV 8 1994  
 MINING LANDS BRANCH

Certified by

P.O. Box 10, Swastika, Ontario P0K 1T0

Telephone (705) 649-2944

FAX (705) 649-2922



Established 1928

# Swastika Laboratories

A Division of TSL / ASSAYERS INC.

Assaying - Consulting - Representation

## Assay Certificate

3W-2572-RA1

Company: **JOHN GORE**

Date: SEP-28-93

Project:

Attn:

We hereby certify the following Assay of 3 ROCK samples submitted SEP-27-93 by .

Sample Number	Au oz/ton	Au Ck oz/ton	Ag oz/ton	Cu %	Ni %
15704	NIL			0.005	
15705	NIL			0.01	
15706	0.001	0.001	0.08	0.04	0.01

RECEIVED  
 NOV 8 1994  
 MINING LANDS BRANCH

Certified by 



# Swastika Laboratories

A Division of TSL / ASSAYERS INC.

Assaying - Consulting - Representation

Established 1928

## Geochemical Analysis Certificate

3W-2734-RG1

Company: **JOHN A GORE**

Date: OCT-29-93

Project:

Attn:

We hereby certify the following Geochemical Analysis of 1 ROCK samples submitted OCT-28-93 by .

Sample Number	Au PPB	Ag PPM	Cu PPM	Pb PPM	Zn PPM
P#3	69	19.0	25400	201	61
	check-62				

1507

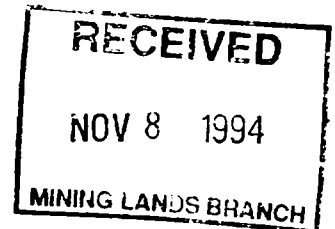

Certified by *G. Libby*



# Swastika Laboratories

A Division of TSL / ASSAYERS INC.

Assaying - Consulting - Representation

Established 1928

## Geochemical Analysis Certificate

3W-2876-RG1

Company: **J A GORE**

Date: NOV-29-93

Project:

Atta:

We hereby certify the following Geochemical Analysis of 1 ROCK samples submitted NOV-25-93 by .

Sample Number	Au PPB	Au PPB	Ag PPM	Co PPM	Cu PPM	Pb PPM	Zn PPM
15708	21	27	1.0	15	614	120	193

RECEIVED  
 NOV 8 1994  
 MINING LANDS BRANCH

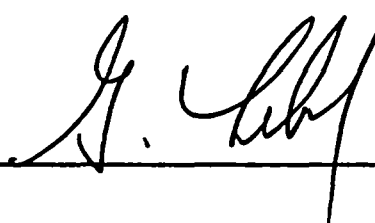
Certified by 



Established 1928

# Swastika Laboratories

A Division of TSL / ASSAYERS INC.

Assaying - Consulting - Representation

3W-2965-RA1

Date: DEC-17-93

## Assay Certificate

Company: **J. A. GORE**

Project:

Attn:

We hereby certify the following Assay of 2 FINE MATERIAL samples submitted DEC-14-93 by .

Sample Number	Ag oz / ton	Co %
15709	0.01	0.002
15710	0.01	0.003

RECEIVED  
NOV 8 1994  
MINING LANDS BRANCH

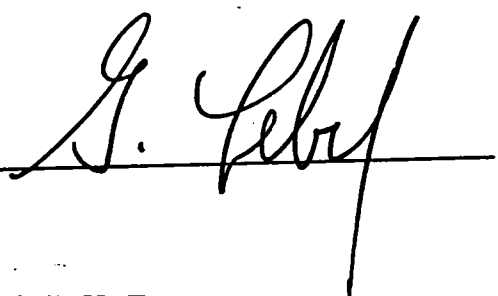
Certified by 

(10) Sample Sites

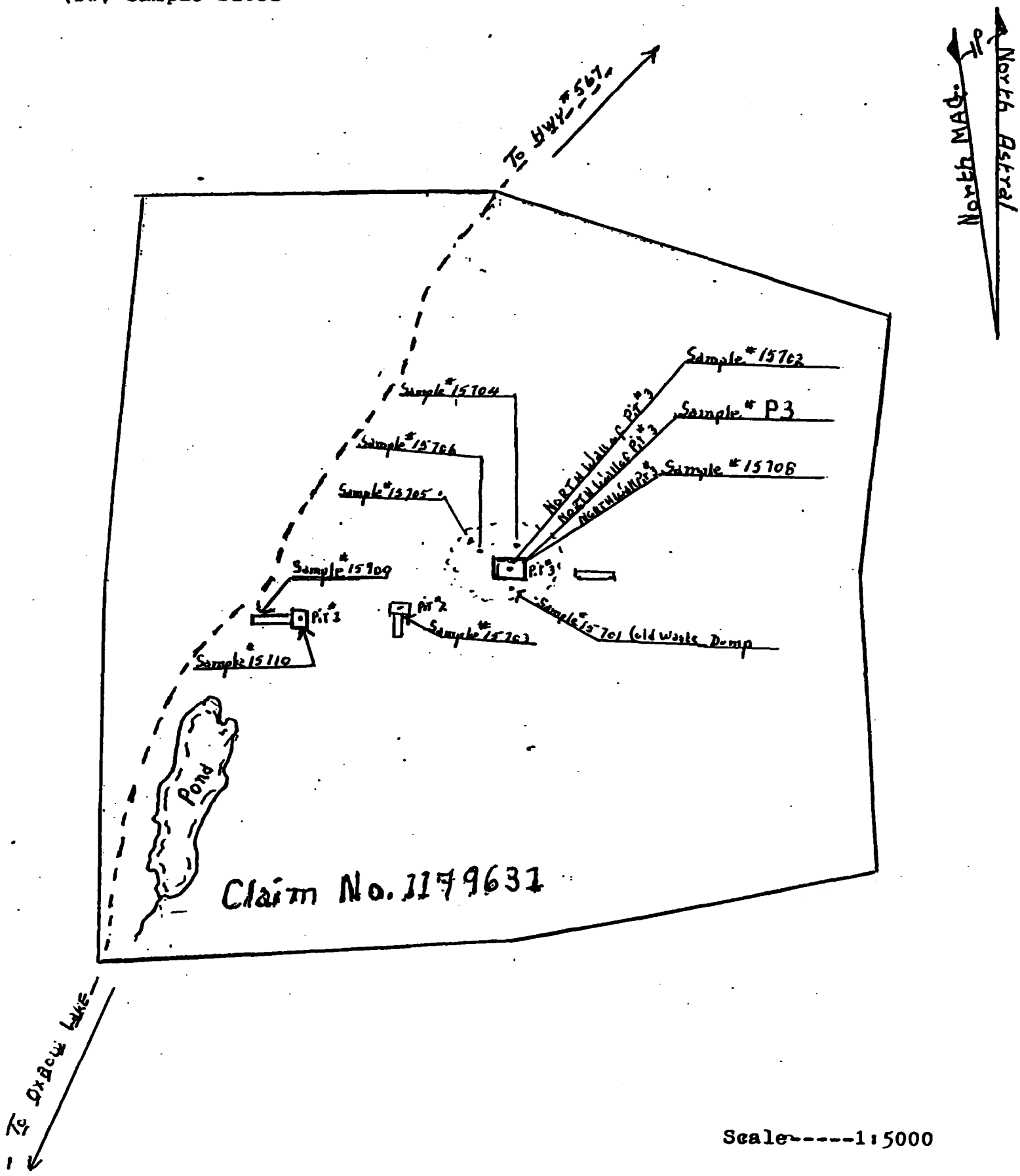

Scale-----1:5000

REGISTRATION # OP93-019

Worksites John Gore Properties

South Lorrain Township

Western Portion Part #2

North East  
of  
DAN HANON

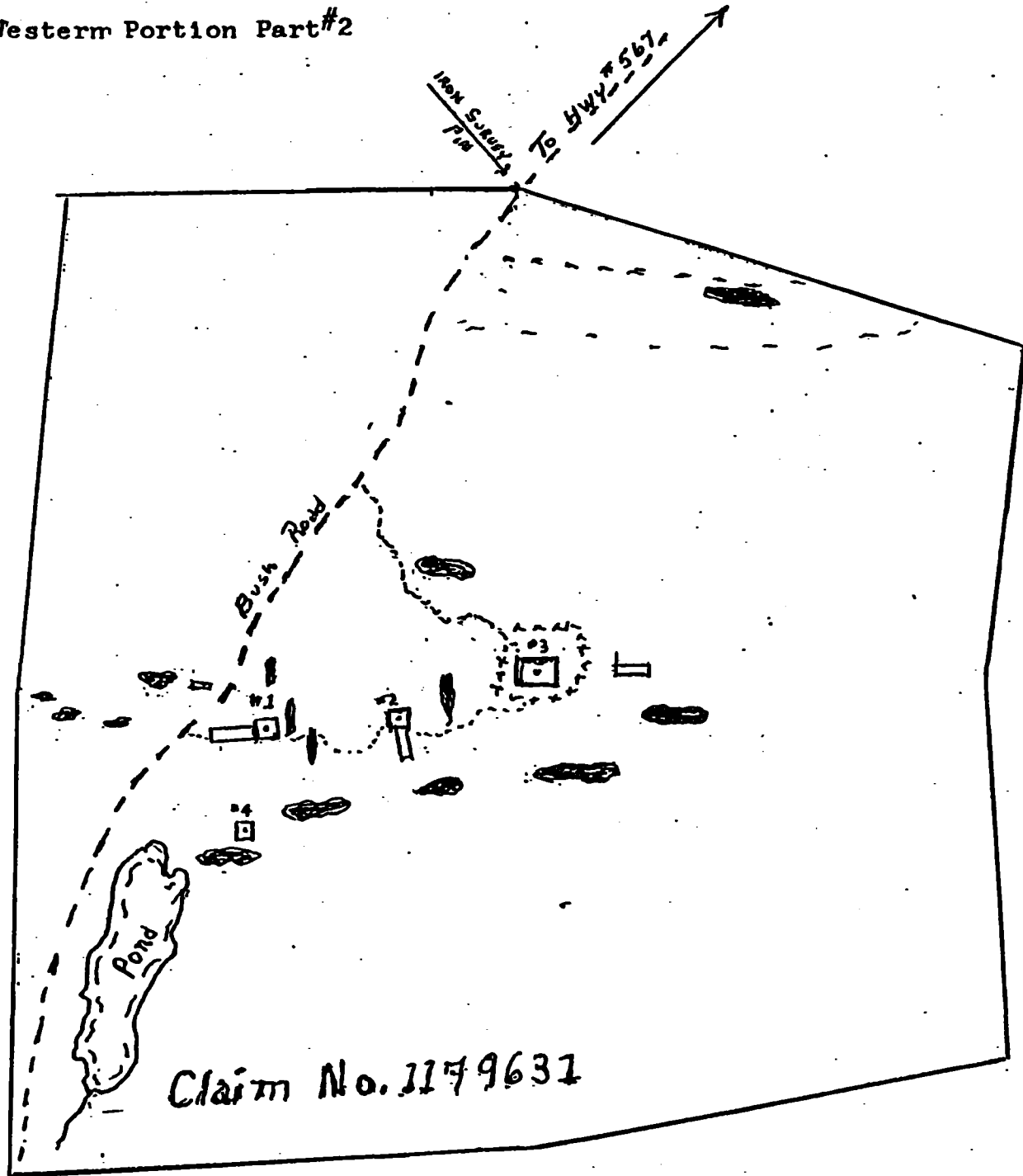

Claim No. 1179631

- Traverse--(looking for Pit#1, described in old Report--
- Pits -----
- Trenching-----
- Stripping --(Manual)-----
- Stripping---(Mechanical)-----

Scale-----1:5000

To Ox Bow Lake



REGISTRATION # OP93-019

Worksites John Gore Properties

South Lorrain Township

Western Portion Part #2

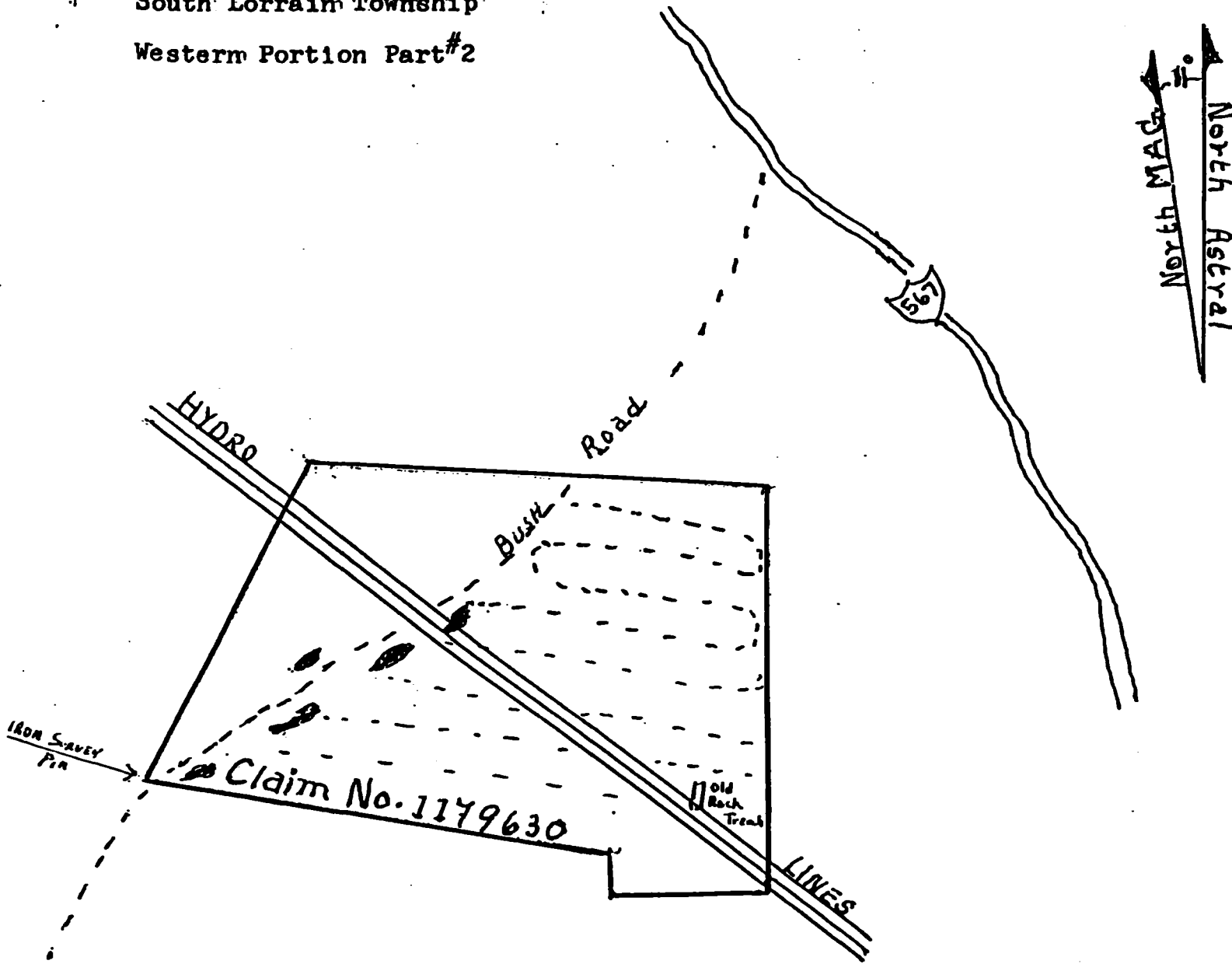

Traverse----(looking for Pit #1 described in old report)-----

Stripped areas-----

Scale---- 1:5000

South Lorrain

45

Sept. 29, 1961

Williamo 45-8E  
Group

8E

In conversation with Ralph  
Bennet, he said he had a  
report stating that a pit on this  
group - in Keewatin some  
distance from the diabase  
contact. The pit on vein  
showing a one inch width of  
cobalt and giving silver  
assays to 46 g./ton.  
Said to be mud seam



# Report of Work Conducted After Recording Claim

Mining Act

Transaction Number  
**DOCUMENT No. 00424**

~~0.P.A.H. 0993 019~~

Personal information collected on this form is obtained under the authority of the Mining Act. This information will be used for correspondence. Questions about this collection should be directed to the Provincial Manager, Mining Lands, Ministry of Northern Development and Mines, Fourth Floor, 150 Cedar Street, Sudbury, Ontario, P3E 6A5, telephone (705) 670-7264.

**2.15553**

- Instructions:
- Please type or print and submit in duplicate.
  - Refer to the Mining Act and Regulations for a Recorder.
  - A separate copy of this form must be completed.
  - Technical reports and maps must accompany.
  - A sketch, showing the claims the work is assessed on.



31M03NW0022 2.15553 SOUTH LORRAIN

900

Recorded Holder(s) <b>JOHN A. GORE</b>		Client No. <b>138273</b>
Address <b>31 Ruby St. Box #212 COBALT Ont. POKICO</b>		Telephone No. <b>(705) 679-5710</b>
Mining Division <b>LARDER LAKE</b>	Township/Area <b>SOUTH LORRAIN</b>	M or G Plan No. <b>G-3448</b>
Date Work Performed From: <b>MAY 18/93</b>	To: <b>Oct. 18/93</b>	

Work Performed (Check One Work Group Only)

Work Group	Type
<input checked="" type="checkbox"/> Geotechnical Survey	
<input checked="" type="checkbox"/> Physical Work, including Drilling	<del>MANUAL LABOUR</del> <b>Prospecting, Stripping, Trenching</b>
Rehabilitation	
Other Authorized Work	
<input checked="" type="checkbox"/> Assays	<b>ASSAYS (10) 5 INVOICES</b>
Assignment from Reserve	

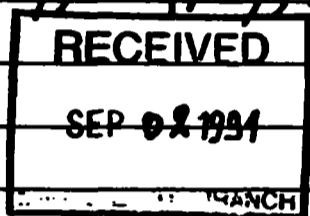

Total Assessment Work Claimed on the Attached Statement of Costs \$ **7231.00**

Note: The Minister may reject for assessment work credit all or part of the assessment work submitted if the recorded holder cannot verify expenditures claimed in the statement of costs within 30 days of a request for verification.

Persons and Survey Company Who Performed the Work (Give Name and Address of Author of Report)

Name	Address
<b>JOHN A. GORE</b>	<b>31 Ruby St. Box #212 COBALT Ont. POKICO</b>
<b>M. CONLIN</b>	<b>87 Russell St. N. Arnprior Ont. K75 2J5</b>
<b>Swastika Laboratories</b>	<b>1 CAMERON Ave. Swastika Ont. POKITO</b>

(attach a schedule if necessary)

Certification of Beneficial Interest \* See Note No. 1 on reverse side

I certify that at the time the work was performed, the claims covered in this work report were recorded in the current holder's name or held under a beneficial interest by the current recorded holder.	Date <b>Aug. 25/94</b>	Recorded Holder or Agent (Signature) <b>John A. Gore</b>
--	---------------------------	---

Certification of Work Report

I certify that I have a personal knowledge of the facts set forth in this Work report, having performed the work or witnessed same during and/or after its completion and annexed report is true.		
Name and Address of Person Certifying <b>JOHN A. GORE Box #212 Cobalt Ont. POKICO</b>		
Telephone No. <b>(705) 679-5710</b>	Date <b>August 25/94</b>	Certified By (Signature) <b>John A. Gore</b>

For Office Use Only

Total Value Cr. Recorded <b>\$ 7231.</b>	Date Recorded <b>August 29/94</b>	Mining Recorder <b>[Signature]</b>	Received Stamp <b>SEP 02 1994</b>
	Deemed Approval Date <b>775-27/94</b>	Date Approved <b>[Signature]</b>	
	Date Notice for Amendments Sent		

Work Report Number for Applying Reserve	Claim Number (see Note 2)	Number of Claim Units
	1179630	1
	1179631	4
<b>Total Number of Claims</b>		

Value of Assessment Work Done on this Claim	Value Applied to this Claim
\$ 225.00	\$ 1,446.00
\$ 7,006.00	\$ 5,785.00
<b>Total Value Work Done</b>	<b>Total Value Work Applied</b>
\$ 7,231.00	\$ 7,231.00

Value Assigned from this Claim	Reserve: Work to be Claimed at a Future Date
<b>Total Assigned From</b>	<b>Total Reserve</b>

Credits you are claiming in this report may be cut back. In order to minimize the adverse effects of such deletions, please indicate from which claims you wish to prioritize the deletion of credits. Please mark (✓) one of the following:

- Credits are to be cut back starting with the claim listed last, working backwards.
- Credits are to be cut back equally over all claims contained in this report of work.
- Credits are to be cut back as prioritized on the attached appendix.

In the event that you have not specified your choice of priority, option one will be implemented.

**Note 1:** Examples of beneficial interest are unrecorded transfers, option agreements, memorandum of agreements, etc., with respect to the mining claims.

**Note 2:** If work has been performed on patented or leased land, please complete the following:

I certify that the recorded holder had a beneficial interest in the patented or leased land at the time the work was performed.	Signature <i>John A. Gore</i>	Date August 25/94
---	----------------------------------	----------------------



Ministry of  
Northern Development  
and Mines

Ministère du  
Développement du Nord  
et des mines

**Statement of Costs  
for Assessment Credit**

**État des coûts aux fins  
du crédit d'évaluation**

Mining Act/Loi sur les mines

DOCUMENT No.  
Transaction No. / Consaction  
9480 • 00424

O.P.A.P. # O.P. 93-019

**2.15553**

Personal information collected on this form is obtained under the authority of the Mining Act. This information will be used to maintain a record and ongoing status of the mining claim(s). Questions about this collection should be directed to the Provincial Manager, Minings Lands, Ministry of Northern Development and Mines, 4th Floor, 159 Cedar Street, Sudbury, Ontario P3E 6A5, telephone (705) 670-7264.

Les renseignements personnels contenus dans la présente formule sont recueillis en vertu de la Loi sur les mines et serviront à tenir à jour un registre des concessions minières. Adresser toute question sur la collecte de ces renseignements au chef provincial des terrains miniers, ministère du Développement du Nord et des Mines, 159, rue Cedar, 4<sup>e</sup> étage, Sudbury (Ontario) P3E 6A5, téléphone (705) 670-7264.

**1. Direct Costs/Coûts directs**

Type	Description	Amount Montant	Totals Total global
Wages Salaires	40 days MANUAL Main-d'oeuvre	\$6000.00	\$6000.00
	Field Supervision Supervision sur le terrain		
Contractor's and Consultant's Fees Droits de l'entrepreneur et de l'expert- conseil	Type Assaying	\$211.00	211.00
Supplies Used Fournitures utilisées	Type		
Equipment Rental Location de matériel	Type		
		\$6211.00	
<b>Total Direct Costs</b>		<b>\$6211.00</b>	
<b>Total des coûts directs</b>		<b>\$6211.00</b>	

**2. Indirect Costs/Coûts indirects**

Note: When claiming Rehabilitation work indirect costs are not allowable as assessment work.  
Pour le remboursement des travaux de réhabilitation, les coûts indirects ne sont pas admissibles en tant que travaux d'évaluation.

Type	Description	Amount Montant	Totals Total global
Transportation Transport	75 km. @ .30¢		
1/2 Ton Truck	km. x 40 days	\$900.00	
			\$900.00
Food and Lodging Nourriture et hébergement	40 Lunches @ \$3.00 =	\$120.00	\$120.00
Mobilization and Demobilization Mobilisation et démobilisation			
<b>Sub Total of Indirect Costs</b>		<b>\$1020.00</b>	
<b>Total partiel des coûts indirects</b>		<b>\$1020.00</b>	
<b>Amount Allowable (not greater than 20% of Direct Costs)</b>		<b>\$1020.00</b>	
<b>Montant admissible (n'excedant pas 20 % des coûts directs)</b>		<b>\$1020.00</b>	
<b>Total Value of Assessment Credit (Total of Direct and Allowable Indirect costs)</b>		<b>\$7231.00</b>	
<b> Valeur totale du crédit d'évaluation (Total des coûts directs et indirects admissibles)</b>		<b>\$7231.00</b>	

RECEIVED  
SEP 02 1994  
MINING LANDS BRANCH

Note: The recorded holder will be required to verify expenditures claimed in this statement of costs within 30 days of a request for verification. If verification is not made, the Minister may reject for assessment work all or part of the assessment work submitted.

Note: Le titulaire enregistré sera tenu de vérifier les dépenses demandées dans le présent état des coûts dans les 30 jours suivant une demande à cet effet. Si la vérification n'est pas effectuée, le ministre peut rejeter tout ou une partie des travaux d'évaluation présentés.

**Filing Discounts**

1. Work filed within two years of completion is claimed at 100% of the above Total Value of Assessment Credit.
2. Work filed three, four or five years after completion is claimed at 50% of the above Total Value of Assessment Credit. See calculations below:

Total Value of Assessment Credit	Total Assessment Claimed
	x 0.50 =

**Remises pour dépôt**

1. Les travaux déposés dans les deux ans suivant leur achèvement sont remboursés à 100 % de la valeur totale susmentionnée du crédit d'évaluation.
2. Les travaux déposés trois, quatre ou cinq ans après leur achèvement sont remboursés à 50 % de la valeur totale du crédit d'évaluation susmentionné. Voir les calculs ci-dessous.

Valeur totale du crédit d'évaluation	Évaluation totale demandée
	x 0.50 =

**Certification Verifying Statement of Costs**

I hereby certify:  
that the amounts shown are as accurate as possible and these costs were incurred while conducting assessment work on the lands shown on the accompanying Report of Work form.

that as (Recorded Holder, Agent, Position in Company) I am authorized

to make this certification

**Attestation de l'état des coûts**

J'atteste par la présente:  
que les montants indiqués sont le plus exact possible et que ces dépenses ont été engagées pour effectuer les travaux d'évaluation sur les terrains indiqués dans la formule de rapport de travail ci-joint.

Et qu'à titre de \_\_\_\_\_ je suis autorisé  
(titulaire enregistré, représentant, poste occupé dans la compagnie)

à faire cette attestation.

Signature: John A. Gore Date: Aug. 25/94



**Report of Work Conducted  
After Recording Claim**

Mining Act

Transaction Number  
W/ 00428

O.P.A.P. # 0P93-019

Personal information collected on this form is obtained under the authority of the Mining Act. This information will be used for correspondence. Questions about this collection should be directed to the Provincial Manager, Mining Lands, Ministry of Northern Development and Mines, Fourth Floor, 159 Cedar Street, Sudbury, Ontario, P3E 6A5, telephone (705) 670-7264.

- Instructions:**
- Please type or print and submit in duplicate.
  - Refer to the Mining Act and Regulations for requirements of filing assessment work or consult the Mining Recorder.
  - A separate copy of this form must be completed for each Work Group.
  - Technical reports and maps must accompany this form in duplicate.
  - A sketch, showing the claims the work is assigned to, must accompany this form.

Recorded Holder(s) <b>JOHN A. GORE</b>		Client No. <b>138273</b>
Address <b>31 Ruby St. Box #212 COBALT Ont. P0J 1C0</b>		Telephone No. <b>(705) 679-5710</b>
Mining Division <b>LARDER LAKE</b>	Township/Area <b>SOUTH LORRAIN</b>	M or G Plan No. <b>G-3448</b>
Dates Work Performed	From: <b>Oct. 14/93</b>	To: <b>Oct. 18/93.</b>

**Work Performed (Check One Work Group Only)**

Work Group	Type
<input type="checkbox"/> Geotechnical Survey	
<input checked="" type="checkbox"/> Physical Work, Including Drilling	<b>Mechanical Stripping</b>
<input type="checkbox"/> Rehabilitation	
<input type="checkbox"/> Other Authorized Work	<del><b>Geological Observations</b></del>
<input type="checkbox"/> Assays	
<input type="checkbox"/> Assignment from Reserve	

Total Assessment Work Claimed on the Attached Statement of Costs \$ ~~1946.00~~ **1458.**

**Note:** The Minister may reject for assessment work credit all or part of the assessment work submitted if the recorded holder cannot verify expenditures claimed in the statement of costs within 30 days of a request for verification.

**Persons and Survey Company Who Performed the Work (Give Name and Address of Author of Report)**

Name	Address
<b>JAMES LATHAM Excavating</b>	<b>183 STATION ST. HAILEYBURY Ont. P0J 1K0</b>
<b>A.W. Beecham Consulting Geol.</b>	<b>540 RORKE AVE HAILEYBURY Box #867 P0J 1K0</b>

(attach a schedule if necessary)

**Certification of Beneficial Interest \* See Note No. 1 on reverse side**

I certify that at the time the work was performed, the claims covered in this work report were recorded in the current holder's name or held under a beneficial interest by the current recorded holder.	Date <b>Aug. 25/94</b>	Recorded Holder or Agent (Signature) <b>John A. Gore</b>
--	---------------------------	---

**Certification of Work Report**

I certify that I have a personal knowledge of the facts set forth in this Work report, having performed the work or witnessed same during and/or after its completion and annexed report is true.

Name and Address of Person Certifying <b>JOHN A. GORE Box #212 COBALT Ont. P0J 1C0</b>	
Telephone No. <b>(705) 679-5710</b>	Date <b>August 25/94</b>
Certified By (Signature) <b>John A. Gore</b>	

**For Office Use Only**

Total Value Cr. Recorded <b># 1458</b>	Date Recorded <b>August 29/94</b>	Mining Recorder <b>[Signature]</b>	Received Stamp
	Deemed Approval Date	Date Approved <b>Sept 19/94</b>	
	Date Notice for Amendments Sent <b>September 6/94</b>		

#	WARD	CLAIM NUMBER (see Note 2)	Number of Claim Units	Value of Assessment Work Done on this Claim	Value Applied to this Claim	Value Assigned from this Claim	Reserve: Work to be Claimed at a Future Date
1087		1179631	4	\$ 1458.00 <del>1946.00</del>	\$ 1458.00 <del>1946.00</del>		
Total Number of Claims				Total Value Work Done	Total Value Work Applied	Total Assigned From	Total Reserve
				1458. <del>1946.</del>	1458. <del>1946.</del>		

Credits you are claiming in this report may be cut back. In order to minimize the adverse effects of such deletions, please indicate from which claims you wish to prioritize the deletion of credits. Please mark (✓) one of the following:

- 1.  Credits are to be cut back starting with the claim listed last, working backwards.
- 2.  Credits are to be cut back equally over all claims contained in this report of work.
- 3.  Credits are to be cut back as prioritized on the attached appendix.

In the event that you have not specified your choice of priority, option one will be implemented.

Note 1: Examples of beneficial interest are unrecorded transfers, option agreements, memorandum of agreements, etc., with respect to the mining claims.

Note 2: If work has been performed on patented or leased land, please complete the following:

I certify that the recorded holder had a beneficial interest in the patented or leased land at the time the work was performed.	Signature John A. Gore	Date Aug. 25 / 94
---	---------------------------	----------------------

Statement of Costs  
for Assessment Credit

État des coûts aux fins  
du crédit d'évaluation

Mining Act/Loi sur les mines

Transaction No./N° de transaction  
**DOCUMENT No.**  
9480-00428

Personal information collected on this form is obtained under the authority of the Mining Act. This information will be used to maintain a record and to determine the status of the mining claim(s). Questions about this collection should be directed to the Provincial Manager, Mining Lands, Ministry of Northern Development and Mines, 4th Floor, 159 Cedar Street, Sudbury, Ontario E6A5, telephone (705) 670-7264.

Les renseignements personnels contenus dans la présente formule sont recueillis en vertu de la Loi sur les mines et serviront à tenir à jour un registre des concessions minières. Adresser toute question sur la collecte de ces renseignements au chef provincial des terrains miniers, ministère du Développement du Nord et des Mines, 159, rue Cedar, 4<sup>e</sup> étage, Sudbury (Ontario) P3E 6A5, téléphone (705) 670-7264.

Direct Costs/Coûts directs

Type	Description	Amount Montant	Totals Total global
Wages salaires	Labour Main-d'oeuvre 18hr @ 14.00	\$ 252.00	252.00
	Field Supervision Supervision sur le terrain		
Contractor's and Consultant's fees droits de l'entrepreneur et de l'expert- technicien	Type		
Supplies Used matériaux utilisés	Type		
Equipment Rental Location de matériel	Type 1977-1450B		
	Case Bulldozer @ 54.50	\$ 981.00	981.00
	7% GST		86.31
<b>Total Direct Costs Total des coûts directs</b>			<b>1319.90</b>

2. Indirect Costs/Coûts indirects

\*\* Note: When claiming Rehabilitation work Indirect costs are not allowable as assessment work.  
Pour le remboursement des travaux de réhabilitation, les coûts indirects ne sont pas admissibles en tant que travaux d'évaluation.

Type	Description	Amount Montant	Totals Total global
Transportation Transport	Type		
	Float \$200 2 hrs.	\$ 51.00	\$ 102.00
	Tractor - 1982 General 2 hrs.	per hr.	
Operator	2 hrs.	\$ 28.00	28.00
Food and Lodging Nourriture et hébergement	7% GST		9.10
Mobilization and Demobilization Mobilisation et démobilisation			139.00
<b>Sub Total of Indirect Costs Total partiel des coûts indirects</b>			<b>139.00</b>
<b>Amount Allowable (not greater than 20% of Direct Costs) Montant admissible (n'excédant pas 20 % des coûts directs)</b>			<b>139.00</b>
<b>Total Value of Assessment Credit (Total of Direct and Allowable indirect costs)</b>			<b>1458.90</b>

Note: The recorded holder will be required to verify expenditures claimed in this statement of costs within 30 days of a request for verification. If verification is not made, the Minister may reject for assessment work all or part of the assessment work submitted.

Note: Le titulaire enregistré sera tenu de vérifier les dépenses demandées dans le présent état des coûts dans les 30 jours suivant une demande à cet effet. Si la vérification n'est pas effectuée, le ministre peut rejeter tout ou une partie des travaux d'évaluation présentés.

Filing Discounts

- Work filed within two years of completion is claimed at 100% of the above Total Value of Assessment Credit.
- Work filed three, four or five years after completion is claimed at 50% of the above Total Value of Assessment Credit. See calculations below:

Total Value of Assessment Credit	Total Assessment Claimed
	x 0.50 =

Remises pour dépôt

- Les travaux déposés dans les deux ans suivant leur achèvement sont remboursés à 100 % de la valeur totale susmentionnée du crédit d'évaluation.
- Les travaux déposés trois, quatre ou cinq ans après leur achèvement sont remboursés à 50 % de la valeur totale du crédit d'évaluation susmentionné. Voir les calculs ci-dessous.

Valeur totale du crédit d'évaluation	Evaluation totale demandée
	x 0,50 =

Certification Verifying Statement of Costs

I hereby certify:  
that the amounts shown are as accurate as possible and these costs were incurred while conducting assessment work on the lands shown on the accompanying Report of Work form.

that as Recorded Holder I am authorized  
(Recorded Holder, Agent, Position in Company)

to make this certification

Attestation de l'état des coûts

J'atteste par la présente :  
que les montants indiqués sont le plus exact possible et que ces dépenses ont été engagées pour effectuer les travaux d'évaluation sur les terrains indiqués dans la formule de rapport de travail ci-joint.

Et qu'à titre de \_\_\_\_\_ je suis autorisé  
(titulaire enregistré, représentant, poste occupé dans la compagnie)

à faire cette attestation.

Signature John C. Gore Date Sept. 19 / 94



2.155 53

DAILY REPORTS

Day	Project Area	Date	Work Performed
1	MINING CLAIM #1179630	May.18/93	Prospecting for Mud Seam
2	" #1179631	May.19/93	" " " "
3	" #1179631	June1st./93	" " " "
4	" #1179631	June2nd/93	" " " "
5	" #1179631	June3rd./93	" " " "
6	" #1179631	June27/93	TRENCHING
7	" #1179630-1	June29/93	Reconosance with Deep Mat
8	" #1179631	June30/93	Trenching
9	" #1179631	July1st./93	"
10	" #1179631	July3rd./93	"
11	" #1179631	July5th./93	Stripping
12	" #1179631	July 16/93	Trenching
13	" #1179631	July17/93	"
14	" #1179631	July18/93	"
15	" #1179631	July20/93	Prospecting for more Pits
16	" #1179631	July21/93	Mucking out Pit#2
17	" #1179631	July23/93	" " " "
18	" #1179631	July24/93	" " " "
19	" #1179631	July25/93	" " " "
20	" #1179631	July26/93	" " " "
21	" #1179631	July27/94	" " " "
22	" #1179631	July28/93	Stripping
23	" #1179631	July29/93	"
24	" #1179631	Aug. 3/93	Trenching
25	" #1179631	Aug. 4/93	Prospecting found Pit#3
26	" #1179631	Aug. 7/93	Working at Pit# 3(with asst.)
27	" #1179631	Aug.9/93	Stripping
28	" #1179631	Aug.12/93	Trenching
29	" #1179631	Aug.14/93	Stripping
30	" #1179631	Aug.17/93	"
31	" #1179631	Aug.19	Mucking out Pit#3
32	" #1179631	Aug.20/93	" " " "
33	" #1179631	Aug.28/93	" " " "
34	" #1179631	Aug.29/93	" " " "
35	" #1179631	Sept. 2/93	" " " "
36	" #1179631	Oct. 8/93	Trenching
37	" #1179631	Oct.12/93	Stripping (with asst.)
38	" #1179631	Oct.13/94	Stripping
39	" #1179631	Oct.15/93	Stripping
40	" #1179631	Oct.18/93	Stripping
41			

Attach additional sheets as required.

RECEIVED  
SEP 9 9 1994

MINING CLAIM #1179630



Ontario

Ministry of  
Northern Development  
and Mines

Ministère du  
Développement du Nord  
et des Mines

Geoscience Approvals Office  
933 Ramsey Lake Road  
6th Floor  
Sudbury, Ontario  
P3E 6B5

Telephone: (705) 670-5853

Fax: (705) 670-5863

Our File: 2.15553

Transaction #: W9480.00424

November 10, 1994

Mining Recorder  
Ministry of Northern Development  
and Mines  
4 Government Road East  
Kirkland Lake, Ontario  
P2N 1A2

Dear Mr. Spooner:

**RE: APPROVAL OF ASSESSMENT WORK ON MINING CLAIMS 1179630 ET. AL. IN  
SOUTH LORRAIN TOWNSHIP.**

The assessment credits for Prospecting, section 9 of the Mining Act Regulations, as listed on the original Report of Work, have been approved as of November 9, 1994.

Please indicate this approval on the claim record sheets.

If you have any questions concerning this submission please contact Bruce Gates at (705) 670-5856.

ORIGINAL SIGNED BY:

Ron C. Gashinski  
Senior Manager, Mining Lands Section  
Mining and Land Management Branch  
Mines and Minerals Division

*BIG* BIG/jl  
Enclosures:

cc: Assessment Files Office  
Sudbury, Ontario

Resident Geologist  
Cobalt, Ontario



**Action  
Memo**

Time

Date  
Year Month Day  
94 | Sep | 19

To *Alex Sudbury*  
From (Name and City)

*Mining Recorder, Kirkland Lake*

IC N No	Area Code	Telephone No	Ext	Message Taken By
	705	567-9241		
<input type="checkbox"/> Phoned On Hold	<input type="checkbox"/> Please Call Returned	<input type="checkbox"/> Will Call Back	<input type="checkbox"/> Wishes Appointment	<input type="checkbox"/> Waiting in Person
	<input type="checkbox"/> Your Call			<input type="checkbox"/> Will Return
				<input type="checkbox"/> Was Here

- File
- Draft Reply For My Signature
- Provide More Details
- For Your information
- Type Draft
- For Your Approval and Signature
- Keep Me Informed
- Per Discussion
- Type Final
- Circulate Initial and Return
- Take Appropriate Action
- Per Your Request
- Make Copies
- Return With Comments
- Note and See Me
- Returned With Thanks
- Please Answer
- Investigate and Report
- Note and Return
- 

Comments

*You will be receiving  
Technical report from  
GAS, Sudbury.*

**DAILY REPORTS**

Day	Project Area	Date	Work Performed
1	MINING CLAIM #1179630	May, 18/93	Prospecting for Mud Seam
2	" " #1179631	May, 19/93	" " " "
3	" " #1179631	June 1st./93	" " " "
4	" " #1179631	June 2nd./93	" " " "
5	" " #1179631	June 3rd./93	" " " "
6	" " #1179631	June 27/93	TRENCHING
7	" " #1179630-1	June 29/93	Reconosance with Beep Mat
8	" " #1179631	June 30/93	Trenching
9	" " #1179631	July 1st./93	"
10	" " #1179631	July 3rd./93	"
11	" " #1179631	July 5th./93	Stripping
12	" " #1179631	July 16/93	Trenching
13	" " #1179631	July 17/93	"
14	" " #1179631	July 18/93	"
15	" " #1179631	July 20/93	Prospecting for more Pits
16	" " #1179631	July 21/93	Mucking out Pit#2
17	" " #1179631	July 23/93	" " " "
18	" " #1179631	July 24/93	" " " "
19	" " #1179631	July 25/93	" " " "
20	" " #1179631	July 26/93	" " " "
21	" " #1179631	July 27/94	" " " "
22	" " #1179631	July 28/93	Stripping
23	" " #1179631	July 29/93	"
24	" " #1179631	Aug. 3/93	Trenching
25	" " #1179631	Aug. 4/93	Prospecting found Pit#3
26	" " #1179631	Aug. 7/93	Working at Pit# 3(with asst.)
27	" " #1179631	Aug. 9/93	Stripping
28	" " #1179631	Aug. 12/93	Trenching
29	" " #1179631	Aug. 14/93	Stripping
30	" " #1179631	Aug. 17/93	"
31	" " #1179631	Aug. 19	Mucking out Pit#3
32	" " #1179631	Aug. 20/93	" " " "
33	" " #1179631	Aug. 28/93	" " " "
34	" " #1179631	Aug. 29/93	" " " "
35	" " #1179631	Sept. 2/93	" " " "
36	" " #1179631	Oct. 8/93	Trenching
37	" " #1179631	Oct. 12/93	Stripping (with asst.)
38	" " #1179631	Oct. 13/94	Stripping
39	" " #1179631	Oct. 15/93	Stripping
40	" " #1179631	Oct. 18/93	Stripping
41			

Attach additional sheets as required.



# Company Prospecting Report for Assessment Credits.

Re: Mechanical Stripping on Mining Claim # 1179631  
as to times, dates and Types of Machines used:

On Oct. 12/93 using a 1982 General tractor hauling a 50 ton Eager Beaved float, delivered a 1977, 1450 B Case Bulldozer to South Tarrant Twp. This machine then did 9 hours of bulldozing, at \$54.50 per hour plus 9 hrs for the operator at \$14.00 per hour.

On Oct. 13/93 after 9 hrs of bulldozing with 9 hrs for Operator the machine was then loaded on float for return to James Latt Excavating Limited in North Colville.

Oct. 12/93

1982 General Tractor and 50 ton float # 200 @ \$51.00 per hr. Oct. 12/93 =	
Operator @ \$14.00 per hr. Oct. 12/93 =	
9 hrs Bulldozing 1977, 1450 B Case Bulldozer @ \$54.50 per hr. Oct. 12/93 = 491	
9 hrs Operator @ \$14.00 per hr. Oct. 12/93 = 126	

Oct. 13/93

1982 General Tractor and 50 ton float # 200 @ \$51.00 per hr. Oct. 13/93 = 459	
Operator @ \$14.00 per hr. Oct. 13/93 = 126	
9 hrs Bulldozing 1977, 1450 B Case Bulldozer @ \$54.50 per hr. Oct. 13/93 = 491	
9 hrs Operator @ \$14.00 per hr. Oct. 13/93 = 126	

G.S.T. @ 7% =

\$ 95.

Total

\$ 1458.71

COBALT RESIDENT GEOLOGIST DISTRICT

LEGEND

- HIGHWAY AND ROUTE No
- OTHER ROADS
- TRAILS
- SURVEYED LINES
- TOWNSHIPS, BASE LINES, ETC
- LOTS, MINING CLAIMS PARCELS, ETC
- UNSURVEYED LINES
- LOT LINES
- PARCEL BOUNDARY
- MINING CLAIMS ETC
- RAILWAY AND RIGHT OF WAY
- UTILITY LINES
- NON-PERENNIAL STREAM
- FLOODING OR FLOODING RIGHTS
- SUBDIVISION OR COMPOSITE PLAN
- RESERVATIONS
- ORIGINAL SHORELINE
- MARSH OR MUSKEG
- MINES
- TRAVERSE MONUMENT

DISPOSITION OF CROWN LANDS

- | TYPE OF DOCUMENT                | SYMBOL    |
|---------------------------------|-----------|
| PATENT, SURFACE & MINING RIGHTS | ⊙ or ○    |
| " SURFACE RIGHTS ONLY           | ○         |
| " MINING RIGHTS ONLY            | ⊙         |
| LEASE, SURFACE & MINING RIGHTS  | ⊙ or ○    |
| " SURFACE RIGHTS ONLY           | ○         |
| " MINING RIGHTS ONLY            | M.R.O. or |
| LICENCE OF OCCUPATION           | L.O. or   |

CANCELLED  
SAND & GRAVEL  
400 FOOT (APPROX. 122 METER) SURFACE RIGHTS RESERVATION ALONG THE SHORES OF ALL LAKES AND RIVERS.

SCALE 1 INCH = 40 CHAINS

AREAS WITHDRAWN FROM STAKING

- Ⓡ SURFACE AND MINING RIGHTS WITHDRAWN FROM PROSPECTING, STAKING, SALE OR LEASE, SECTION 36 OF THE MINING ACT, RSO 1990 ORDER W-3-82 NER DATED NOV. 5, 1982 AT 1:50 PM
- PART OF ORDER W-3-82 NER REOPENED ORDER O-MLO-90 NER EFFECTIVE APRIL 3, 1990 AT 7:00 AM EST.
- Ⓡ SURFACE AND MINING RIGHTS WITHDRAWN FROM PROSPECTING, STAKING, SALE OR LEASE, SECTION 36 OF THE MINING ACT RSO 1990 ORDER W-4-90 NER EFFECTIVE APR. 3, 1990 AT 7:01 AM EST
- PART OF ORDER W-4-90 NER REOPENED ORDER O-ONT-06/92 NER/CR EFFECTIVE MAR. 16, 1992 AT 4:45 PM EST.
- PART OF ORDER W-4-90 NER REOPENED ORDER O-ONT-07/92 NER/CR EFFECTIVE JUNE 1, 1992 AT 7:00 AM EST.

Ⓡ SURFACE RIGHTS ONLY WITHDRAWN - 4 / 2 / 72 FILE 134327

Ⓡ SURFACE RIGHTS ONLY WITHDRAWN - 2 / 2 / 79 ORDER W-2/79 NER 19840

NOTES

WE DO FLOODING ABOVE "UPPER NOTCH" TO ELEV. 782' UNDER L.O. 7088.

RESERVE FLOODING RIGHTS TO H.E.P.C. CONTOUR 782' ALONG SHORES OF MONTREAL RIVER

RESERVE FLOODING RIGHTS TO H.E.P.C. CONTOUR 782' ALONG SHORES OF THE MONTREAL RIVER (PROPOSED)

2. 163 53

THE INFORMATION THAT APPEARS ON THIS MAP HAS BEEN COMPILED FROM VARIOUS SOURCES AND ACCURACY IS NOT GUARANTEED. THOSE WISHING TO STAKE MINING CLAIMS SHOULD CONSULT WITH THE MINING RECORDER, MINISTRY OF NORTHERN DEVELOPMENT AND MINES FOR ADDITIONAL INFORMATION ON THE STATUS OF THE LANDS SHOWN HEREON

DATE OF ISSUE  
SEP 1 1994  
LARDER LAKE MINING RECORDERS OFFICE

TOWNSHIP  
**SOUTH LORRAIN**

M.N.R. ADMINISTRATIVE DISTRICT  
TEMAGAMI

MINING DIVISION  
LARDER LAKE

LAND TITLES / REGISTRY DIVISION  
TIMISKAMING

Ministry of Natural Resources Ontario

Ministry of Northern Development and Mines

Date: \_\_\_\_\_ Number: **G-3448**

CIRCULATED DEC. 3, 1993.

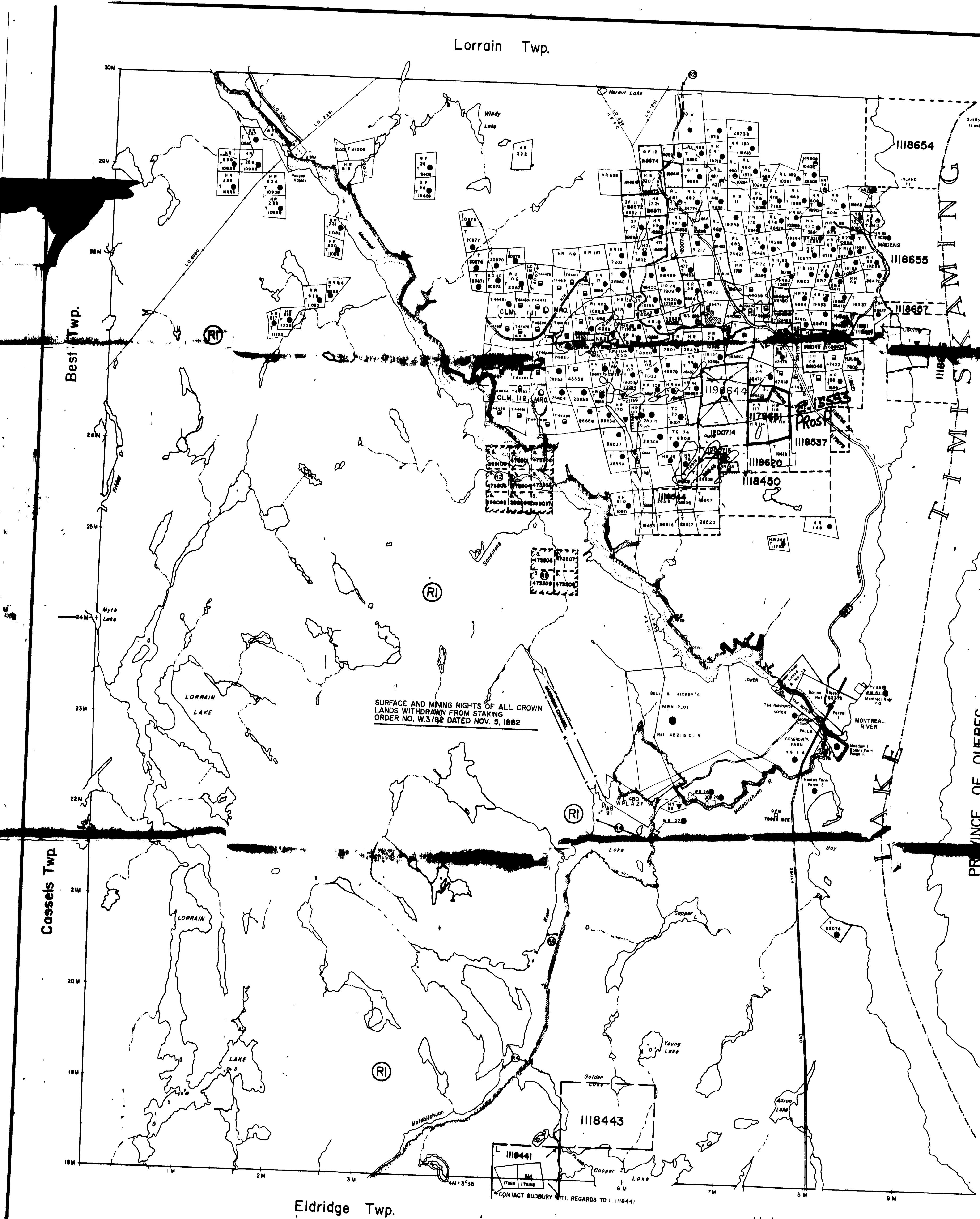

SURFACE AND MINING RIGHTS OF ALL CROWN LANDS WITHDRAWN FROM STAKING ORDER NO. W.3/82 DATED NOV. 5, 1982

CONTACT SUBURBY WITH REGARDS TO L 1118441

THIS MAP SHOWS THE APPROXIMATE LOCATION OF THE BOUNDARIES OF THE TENT

LITIGATION. THE EXACT LOCATION WILL BE SHOWN FOLLOWING CONFIRMATION BY THE PARTIES TO THE ACTION.

