

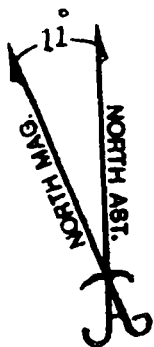

31M03NW0031 W9680-00001 SOUTH LORRAIN



REPORT to ACCOMPANY PROSPECTING WORK
 AFTER RECORDING MINING CLAIMS
 FOR ASSESSMENT CREDITS/94
 JOHN GORE PROPERTIES
 SOUTH LORRAIN TOWNSHIP
 LARDER LAKE MINING DIVISION
 DISTRICT of TEMISKAMING
 PROVINCE of ONTARIO

By John A. Gore
 December, 31, 1995

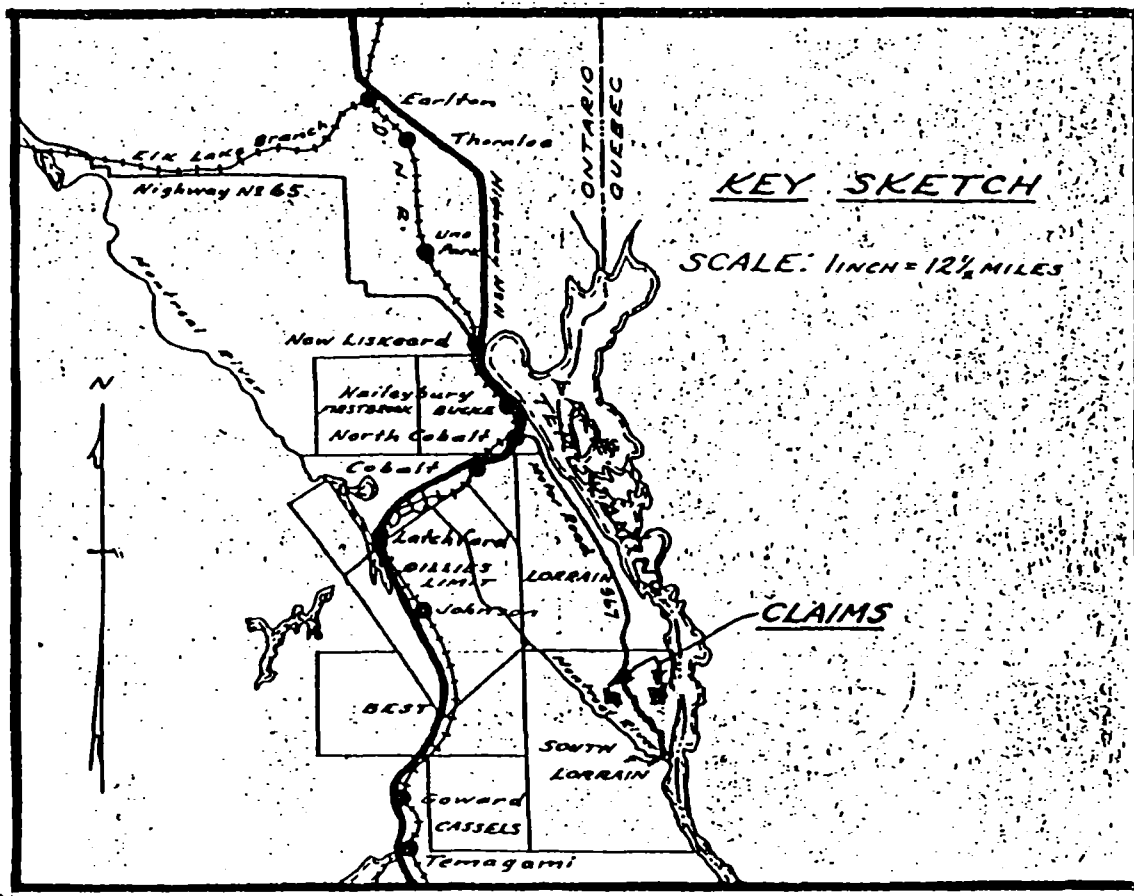

JOHN A. GORE
 CLIENT # 138273
 LICENCE # B-23436

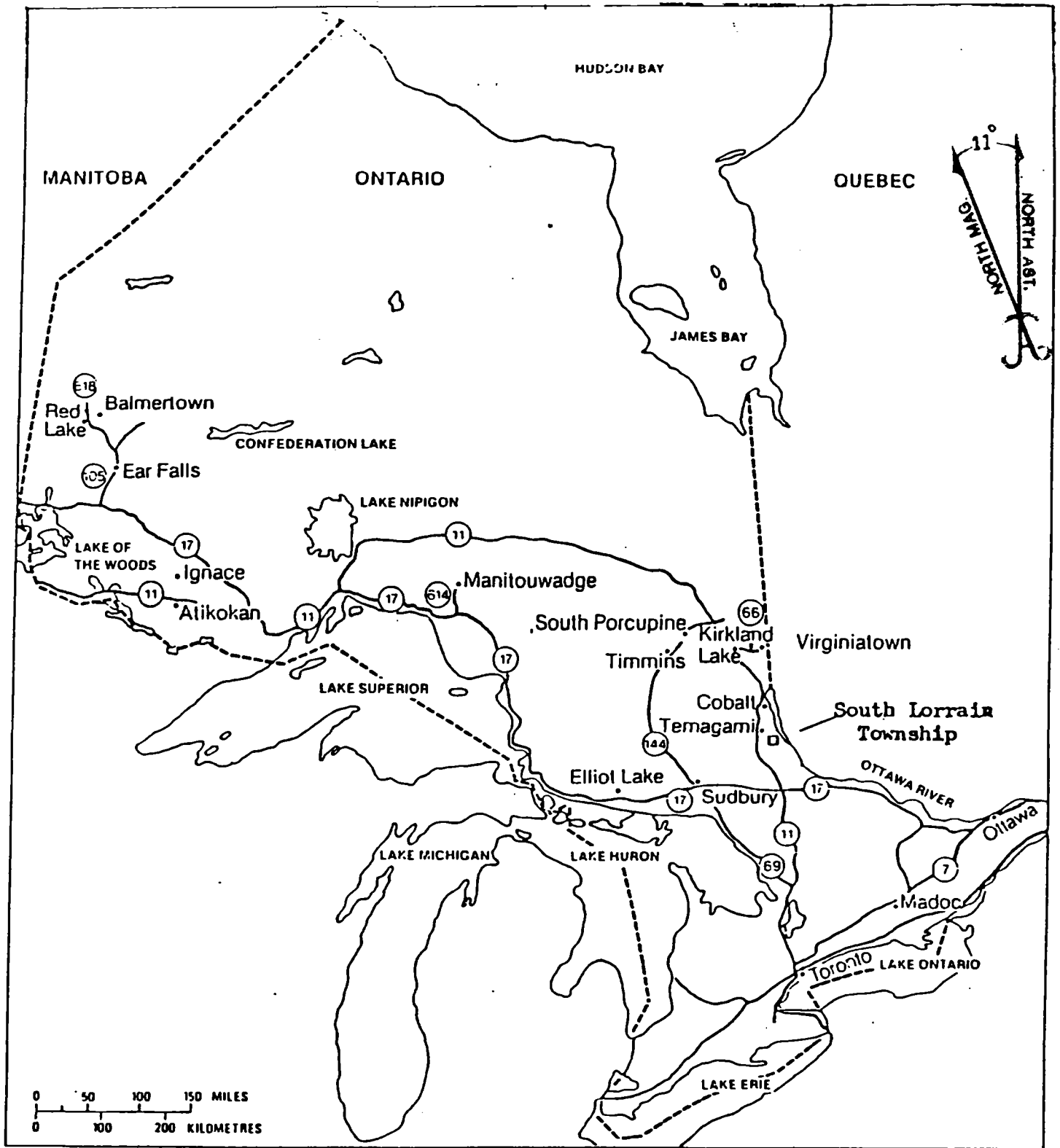

LOCATION MAP

FIGURE 1



31M03NW0031 W9680-00001 SOUTH LORRAIN

010C

TABLE OF CONTENTS

PAGE

1.0 INTRODUCTION.....	1
2.0 GENERAL GEOLOGY OF PROPERTIES.....	2-3
3.0 PROSPECTING REPORT.....	4-5-6
4.0 SUMMARY OF DAILY REPORTS.....	7
5.0 MAP OF CLAIM # 1118450.....	8
6.0 MAP OF CLAIM # 1179631.....	9
7.0 MAP OF CLAIMS #1118621 & #1118546.....	10

This report is the balance of physical work, for the year 1994. Sixteen days, (16) and the report and maps and expenses have been previously been submitted for Assessment Credits, along with the complete data and results of an Induced Polarization Survey, a Magnetic Survey, a V.L.F. Survey, and the Maps of sampling sites, the Assay results, and costs etc. These were submitted, and your file numbers are, 2-15635, transaction #W9480-00497, and file number 2-16115, transaction #W-9580-00508, file number 2-16115, with 2 transaction numbers, W-9580-0056, and W-9580-0057, file number 2-15595, transaction #9480-00463.

The property now consists of twenty one (21) unpatented mining claims totaling fortyseven units. These claims are now contiguous, and for the most part are situated along the same structure, that for identification purposes I refer to as the "OXBOW LAKE STRUCTURE".

These Claims are shown on the South Lorrain Township White Print Map number, G-3448, Larder Lake Mining Division.

Access to the area is a half hour drive, on Highway #567, from Highway, # 11-B at North Cobalt, South to Maidens Lake, some thirty seven kilometres. There is a large gravel pit, located on the East side of the road just past the end of the Lake. One can drive a standard $\frac{1}{2}$ ton vehicle a little over a kilometre, to the shaft located on Mining Claim #961205, this being the central part of the North Eastern portion of the properties.

Access to the Southwestern portion of the properties, is by going South approximately one kilometre, from the end of Maidens Lake, to where a Hydro Line service access road, suitable for all terrain vehicles, goes West to the Hydro Power Line, and one can continue Southwest through the central portion of the properties to the extreme Southwest claims.

South Lorrain is one of the outlying camps of the Temiskaming Silver Belt, and to the end of 1965, has produced 23,338,906 ozs. of Silver, 3,490,377 lbs. of Cobalt, 63,450 lbs. of Nickel, 10,292 lbs. of Copper. These figures are taken from Geological Report #83 by W.H. McIlwaine, Geology of South Lorrain 1970, Table #4, Page #26.

For many years, most of the Mining Claims in this unsurveyed Township were held by individuals who held title to one, some as many as two or, three claims, exploration was confined strictly to the search for Silver, and the funds were directed to areas of the known productive zone, the felsic Volcanics beyond four hundred feet from the Nippissing Diabase sill were of little interest, and the difficulty of assembling a large land base with so many owners was almost insurmountable, even in the latter years of the Camp, with indications, and rumors of potential Base metal deposits.

The Geological Map of South Lorrain Township is #2194, at a scale of 1:31,680, or 1" = $\frac{1}{2}$ mile.

The National Topographic Map for this area is, Fabre, Quebec-Ontario 31M/3

The Aeromagnetic Series Map for this area is Map #1481-g, Fabre, Quebec Ontario, M

- (1) THE GENERAL GEOLOGY OF THIS AREA IS ARCHEAN BASEMENT ROCKS, WHICH ARE DEFORMED METAVOLCANICS, ASSOCIATED WITH MAFIC INTRUSIONS CUT BY FELSIC INTRUSIONS.
- (2) THE FLAT LYING COBALT GROUP SEDIMENTARY ROCKS UNCOMFORMABLY OVERLYING THE ARCHEAN ROCKS.
- (3) DIABASE SHEETS OR SILLS, WHICH CUT ALL OLDER ROCKS.

THIS ABOVE GEOLOGICAL INFORMATION IS FROM THE "GEOLOGY OF SOUTH LORRAIN" BY W.H.M^CILWAINE, 1970, ONTARIO DEPARTMENT OF MINES AND NORTHERN AFFAIRS.

THE INTRUSION OF NIPISSING DIABASE, IS THOUGHT TO HAVE BEEN ONE OF THE IMPORTANT FACTORS, ASSOCIATED WITH THE SILVER-COBALT VEINS OF THE AREA. IT IS THE CONSENSUS OF OPINION, AMONG QUALIFIED AUTHORITIES, THAT THE SILVER COBALT DEPOSITS ARE GENETICALLY RELATED TO THE DIABASE SILL, AND EXPERIENCE AT MINING OPERATIONS IN THE GENERAL AREA, SUGGESTS THAT ORE DEPOSITS DO NOT EXTEND BEYOND FOUR HUNDRED FEET FROM THE DIABASE CONTACT.

PAST EXPERIENCE HAS SHOWN THAT THE "FAVOURABLE HORIZON", IN SOUTH LORRAIN IS THE UPPER CONTACT, AND WHILE THIS IS TRUE, THERE HAS HOWEVER BEEN EXCELLENT GRADE MATERIAL TAKEN FROM THE LOWER CONTACT ZONE WHICH INDICATES THAT ECONOMIC CONCENTRATIONS OF COBALT AND SILVER COULD BE FOUND IN THIS SETTING.

THE MAIN STRUCTURE OF THE DIABASE INTRUSION, IS THE SO-CALLED SOUTH LORRAIN ARCH, OR DOME, THE SOUTHEAST FLANK OF WHICH ON THESE CLAIMS DIPS TO THE SOUTHEAST, CREATING AN UPPER DIABASE-KEEWATIN CONTACT, AND OVERLIES THE FLAT LYING COBALT CONGLOMERATES CREATING A LOWER CONTACT ZONE.

THE EAST WEST TRENDING TROUGH, FILLED WITH HURONIAN SEDIMENTS OF THE COBALT GROUP, WHICH WERE SANDWICHED BETWEEN TWO GREAT IGNEOUS MASSES, IS THE CLASSIC SITE OF THE RICHEST ORE DEPOSITS OF THE COBALT CAMP.

IT IS ACCEPTED THAT THE FAULTS IN THE GENERAL AREA ARE PRE-ORE AND HAVE THE POTENTIAL OF BEING IMPORTANT ORE CARRIERS. MANY SILVER DEPOSITS IN THE GENERAL AREA OCCUR IN THE SMALL FRACTURES SUBSIDIARY TO FAULTS AND IN THE VICINITY OF THE SILL CONTACTS.

IT IS THESE POTENTIAL FRACTURES, AND THEIR CONTAINED VEINING WHICH WAS THE TARGET FOR LAST YEARS PROGRAM, AND ARE THE MAIN OBJECTIVE FOR THE PROPOSED PROGRAM, THAT IS IN PART, A CONTINUATION OF THE EXPLORATION OF THESE ELEMENTS OF GEOLOGY, THAT HAVE IN THE PAST, PROVEN SO PRODUCTIVE.

THERE ARE THREE CONTACTS ALONG WHICH SILVER, AND COBALT ORE SHOOTS HAVE BEEN FOUND. THE MOST IMPORTANT IS THE KEEWATIN, COBALT SERIES CONTACT. THE SECOND IS THE BOTTOM OF THE DIABASE SILL. THE THIRD, ALONG THE TOP OF THE SILL.

FROM INFORMATION FROM THE FILES IN THE RESIDENT GEOLOGISTS OFFICE IN COBALT, OF Dr. ROBERT THOMSON'S NOTES, AND FROM THE MARGINAL NOTES ON PRELIMINARY GEOLOGICAL MAP # P -289, REFERRING TO A FELSIC FACIES OF THE METAVOLCANICS TO THE SOUTH AND EAST OF OXBOW LAKE.

THESE ROCKS, INTERBEDDED WITH THE INTERMEDIATE TO MAFIC ROCKS AND QUARTZITE ARE SCHISTOSE IN APPEARANCE, CHLORITE SCHISTS, INDICATIVE OF SHEARING ARE FOUND IN THIS AREA, AND ON THE SHORE OF LAKE TEMISKAMING TO THE EAST.

THE NUMEROUS FAULTS IN THE AREA HAVE A DOMINANT NORTHWEST DIRECTION AND APPEAR TO BE BRANCHES OF THE LAKE TEMISKAMING FAULT. THERE ARE A NUMBER OF NORTH, AND NORTHEAST TRENDING FAULTS ALSO. SHEARING THAT CAN BE SEEN ON THE SHORE OF LAKE TEMISKAMING APPARENTLY EXTENDS IN A SOUTHWESTERLY DIRECTION FOR SOME DISTANCE, AS IT SHOWS IN SOME OUTCROPS ON THE EASTERN PORTION OF THE CLAIMS OF THIS PROJECT. FOLDING IN THE SEDIMENTARY ROCKS APPEARS TO BE MINOR, THE DIPS IN THIS SERIES BEING OF A SOMEWHAT GRADUAL OCCURENCE.

THE CONTACTS BETWEEN THE NIPISSING DIABASE, AND THE METAVOLCANICS IN THIS AREA, ARE FOR THE MOST PART IN THE SIDES OF HILLS AND NOT WHERE ONE WOULD EXPECT IN THE VALLEYS OR TOPOGRAPHICAL DEPRESSIONS.

IT IS APPARENT, FOLLOWING LAST SEASONS WORK, (APRIL, 1994 to NOV. 1994) THAT THERE IS MORE FELSIC ROCK IN THE AREA THAN INDICATED ON GEOLOGICAL MAP #2194, AND THERE ARE A NUMBER OF LINEAR TOPOGRAPHIC FEATURES WITH OVERBURDEN, POSSIBLY RELATED TO STRUCTURAL MOVEMENT IN THE BASEMENT ROCKS, WITH A GENERALLY NORTH EASTERLY DIRECTION.

On Tuesday, April, 26/94 I went down to South Lorrain Township to Mining Claim #1118546, located approximately three quarters of a mile, or some twelve hundred metres South of Maidens Lake, along Highway # 567, and approximately four hundred metres East, to the site of #3 post for this Claim. There was still a considerable amount of snow in the low lying areas, however high ground, and particularly rock outcrops, were clear. Starting North along the West boundary from my #3 post approximately fifty metres or so, there is a ledge of about one and a half metres before dropping down into a wet swampy area, this outcrop is of a Basaltic Keewatin, showing some pyrite mineralization, it forms the Western side of an Easterly, Westerly topographical depression.

There is a considerable amount of overburden, in this low swampy area, gradually rising to the North, and in the vicinity of the #4 post for Mining Claim #1118546, there is some slight outcropping of a Mafic Keewatin, it also showed some minor pyrites, following minor stripping of moss. On turning Easterly along the North Boundary, at intervals of twenty five metres approximately, as this was a pace and compass traverse, I proceeded South Easterly, varying from fifteen to twenty metres, then turning North Easterly, to the vicinity of the North boundary, continuing in this pattern and examining some outcrops, there did not appear to be any particularly anomalous mineralization of interest. As snow conditions were making it increasingly difficult, I decided to concentrate my prospecting efforts next day, on the high ground in the vicinity of the South boundary of Mining Claim #991048, where late last fall I had observed an old pit in a small shear zone with a considerable amount of pyrite mineralization, in a Mafic outcrop, however there did not appear to be much of economic interest. I decided to assemble, the pipe, pump, hose etc. and to concentrate my efforts on washing, and scraping the area that I had mechanically stripped late last fall, and had been advised by, Mr. A. Beecham, Consulting Geologist to wash and scrape the area prior to any further observations to be undertaken. It was necessary to dig a sump hole in the swampy area some fifty metres west of the bulldozed area, and using a Briggs and Stratton, 1 1/2" forestry pump, and hiring Mr. Jason Gore, Prospectors Lic. #K-22678 Client #300788, to assist when necessary, I was able to pump for a few hours each day, and eventually clean the site.

While waiting for water to accumulate sufficiently to pump, we scraped some areas of hardpan that the bulldozer was unable to remove, and the water pressure from the pump had little or no effect upon, and I did some manual stripping approximately fifty metres West of the #3 Pit located in the central area of the mechanically stripped area, and in doing so I noticed that the strike, was at right angles to the strike at the Pit, apparently there was a fold in this area, and after some trenching I saw some minor Malachite staining, along with considerable pyrites.

As it appears from some of the literature I have read, on Base Metal deposits, that the Nose of a fold is a favourable site for a deposit, I decided to consider, Geophysics, and as my personal evaluation of the area in general leads me to believe that a three scenario potential exists at this site, that is, a possible V.M.S. deposit, a possible large tonnage low grade disseminated Base Metal deposit, and the traditional Cobalt Silver producing deposits of the South Lorrain Mining Camp.

Further prospecting of the area, during this period resulted in locating some extensive surface trenching, and where the trenches intersected, there was another rock pit, full of water and the debris accumulated over

(Continued on Page 2)

many years, I pumped it out down to a thick sludge, the wall rock appeared to be a dark massive Keewatin, strongly magnetic, apparently Magnetite, and there were some cross fractures with some Quartz and minor pyrites, that appeared to be the reason for the Pit, I cleaned out parts of the trenches, to get a reasonable evaluation, however there did not appear to be much of an economic interest in the trenches or in the muck pile, there was however a few minor showings of Galena in the vicinity of the rock pit, in a trench.

On May 30/94 I finished the washing and scraping of the previously mechanically stripped area, and by June 3rd, having finished with the pump I, started to decide on the location of a Base line for a Grid, and after considering the results of my prospecting, I started to cut an East, West line that would intersect the central part of the Mechanically stripped, and manually washed and scraped area, using the #3 Pit containing the Malachite and anomalous mineralization, as the main reference point, and the intersection of Base line 0, and cross line 0.

Having decided on using Geophysics, I then contacted Meerwitsch of Temagami Ont. to finish cutting a three kilometre Grid, and do a Magnetic Survey, and had J.V.X. of Toronto Ont. do an Induced Polarization Survey, while at the same time I borrowed an E.M.16, from the local Resident Geologists Office and performed a V.L.F. Survey, the subsequent profiling of this V.L.F. Survey also being done by J.V.X. who were also provided with the Maps of the Magnetic data. As the results of this work, and its costs, excepting my personal labour, have been previously submitted for Assessment credits, along with a report of Physical work, following the completion of these Geophysical surveys, and included at that time my daily reports of sixteen days, from and including Sept. 9/94 to Oct. 6/94. As this information is on file, it would be redundant to comment further on this period of my field work in 1994, suffice it to say that as a result of this work and the information resulting from the surveys, I purchased adjoining claims, belonging to a Mr. A. Chitaroni as it was obvious from the stripping and trenching, (previously submitted) that the structure continued Easterly past line 200E, which was the Eastern boundary of the Grid for the Geophysical Survey into Mining claim #1118537. Further prospecting work along a prominent hill, Eastwardly on this claim, proved to show that as the Geological Map of the area #2194, that accompanies Geological Report #83 by W.H. McILWAIN 1970, indicates Huronian sediments of the Coleman formation, it is only three to four metres thick, and overlies the structure I have been working on, so that it indicates more Felsic Volcanics than shown, are visible for examination.

At the base of the hill, along the boundary of Mining Claim #1179631 there is considerable overburden, but an outcropping in the middle area of the East, West trending topographical depression was of a massive Mafic Volcanic, and it appears to me there is a possibility of faulting, and a contact between the Felsic structure on the side of the hill and the more Mafic Keewatin protruding through the overburden.

I had through the years, heard many references to a so called "Galena Pit", and I decided to investigate the area, it being located on Mining claim #1118450. I started from the #3 post for #1118450, situated on an outcrop of massive, Mafic Volcanics, and proceeded East along the claim line that being the South boundary, and using the Compass and pacing, traversed East along the claim line, using it as the South boundary of the traverse.

Approximately 200 metres from the post, there is a prominent hill of Huronian sediments (Conglomerate) rising about six or seven metres. At the top it flattens out, continuing the traverse it became apparent from the old trenches that this area had been prospected extensively many years ago, for Silver veins.

Three days later, I picked up where I had left off, and approximately some 800 metres East of the #3 Post I came across a blazed line in a North South direction, I followed this North, down over a steep escarpment of the Huronian, to a prominent Easterly trending topographical depression about 25 metres wide, the North side rises gradually, there are outcrops of Keewatin Basalts, this indicates that the contact between the Archean and the Huronian, is located in this depression, the South side rising abruptly 7 or 8 metres.

On the North side there is a rock pit, about 1½m. x 1½m. x 1½m. deep filled with water and debris, a vein of Quartz and feldspar containing Chalcopyrite Pyrites, and a mineral that I could not identify in the hand specimen, I took from the muck pile. I had read in the files of the Resident Geologists Office in Cobalt, a report of Dr. Robert Thomson, a former Resident Geologist, of a one day trip to the so called "Galena Pit" where he had mentioned that the Galena at the site was very difficult to determine in a hand specimen, because of the Geology, the size of the Pit, the description of the topographical features, I assumed I had located the Galena Pit, however the distances given in the old report did not co-incide, and on showing the sample to the Resident Geologist, he immediately identified the mineral as Zinc, along with some Chalcopyrite, and pyrites. there was no visible Galena, further examination of the area by compass and pacing, I reached the conclusion this was not the Galena pit, absence of any indication of the shear zone mentioned in the old report seemed to confirm this, as it is late in the season I decided to leave the locating of the Galena Pit until next spring, that is 1995.

IV. DAILY REPORTS (Summarize work activity in Section I)

Day	Project Area	Date	Work Performed
1	Mining Claim#1118621	April, 26/94	Prospecting (for trenches)
2	" " "1118546	" 27/94	" on Traverse
3	" " "1179631	May, 4/94	Taking in Pump, Pipe, etc.
4	" " "1179631	" 13/94	Setting up Pump, Piping, & Well
5	" " "1179631	" 14/94	Washing, and Scraping
6	" " "1179631	" 19/94	" " "
7	" " "1179631	" 21/94	" " "
8	" " "1179631	" 24/94	" " "
9	" " "1179631	" 26/94	" " "
10	" " "1179631	" 27/94	" " Prospecting
11	" " "1179631	" 30/94	" " Scraping
12	" " "1179631	June 2/94	Trenching new pit area
13	" " "1179631	" 3/94	" " " "
14	" " "1118546	" 8/94	Prospecting
15	" " "1118621	" 10/94	" " " "
16	" " "1179631	" 12/94	Stripping West of #3 Pit
17	" " "1179631	" 14/94	" " " " "
18	" " "1118546	" 15/94	Prospecting
19	" " "1118621	" 20/94	Stripping
20	" " "1118546	" 23/94	Cleaning out old Trench
21	" " "1118546	" 24/94	" " " "
22	" " "1118621	" 27/94	Stripping
23	" " "1118621	" 28/94	Examining old Trenches
24	" " "1179631	July 3/94	Trenching West of #3 Pit
25	" " "1179631	" 8/94	Examining Site, Falc. Reps.
26	" " "1179631	" 10/94	With A. Beecham Cons. Geolog
27	" " "1179631	" 13/94	Brought out Pump, Pipe, etc.
28	" " "1179631	" 22/94	Stripping & Trenching West #3
29	" " "1179631	" 23/94	Prospecting, Laying out Grid
30	" " "1179631	" 25/94	With D. Laronde-Meegwitch
31	" " "1179631	" 26/94	Assisting with Grid
32	" " "1179631	" 29/94	" " "
33	" " "1179631	Aug. 7/94	V.L.F. E.M. Survey
34	" " "1179631	" 16/94	Assisting with I.P. Survey
35	" " "1179631	" 17/94	" " " " "
36	" " "1179631	" 18/94	" " " " "
37	" " "1118450	Nov. 7/94	Prospecting along Claim Line
38	" " "1118450	" 10/94	" " " "
39	" " "1118450	" 16/94	" old Pit Site
40			
41			

Attach additional sheets as required.

JOHN GORE PROPERTY

SOUTH LORRAIN TOWNSHIP

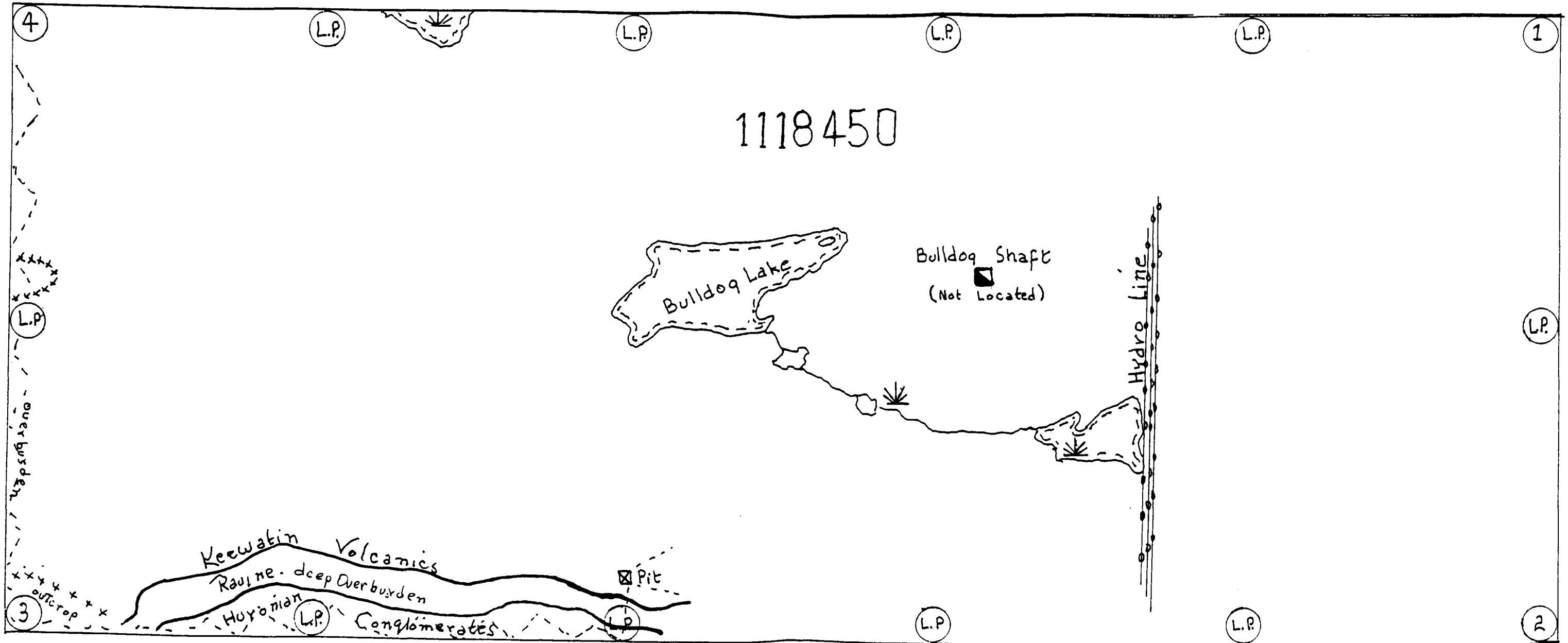
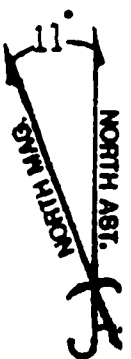

Legend:

- ☒ - Pit
- - - - - Traverse - Pace & Compass
- ~~~~~ - Assumed Contact Not defined
- xx ~ Outcrop



JOHN A. GORE
CLIENT # 138273
LICENCE # B-23438

JOHN GORE PROPERTY SOUTH LORRAIN TOWNSHIP



Legend:

- Assumed Contact Not defined
- Trenching
- Pit (cleaned + pumped out)
- Stripping
- Washed and Scraped
- Outcrop
- TRAVERSE (Pace + Compass)
- Swamp
- Line cut To determine Grid Location

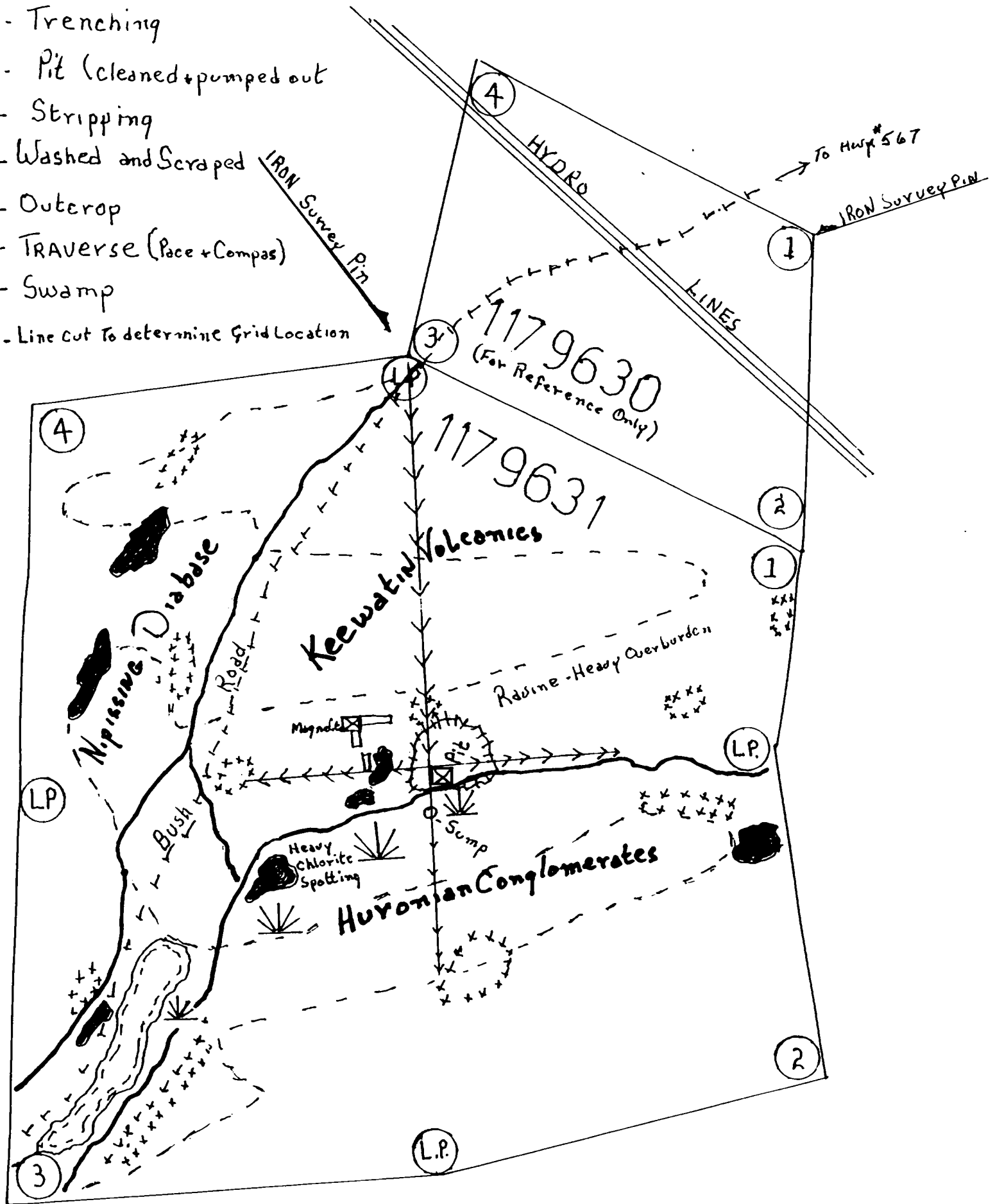

JOHN A. GORE
CLIENT # 138273
LICENCE # B-23438

JOHN GORE PROPERTIES SOUTH LORRAIN TOWNSHIP



Legend

- xx - Outcrop
- - Stripped Areas
- - - - Assumed Contact Not defined
- ⊠ - Cleaned out old Pit
- ▭ - Cleaned out old Trench
- - - - Traverse Pace + Compass

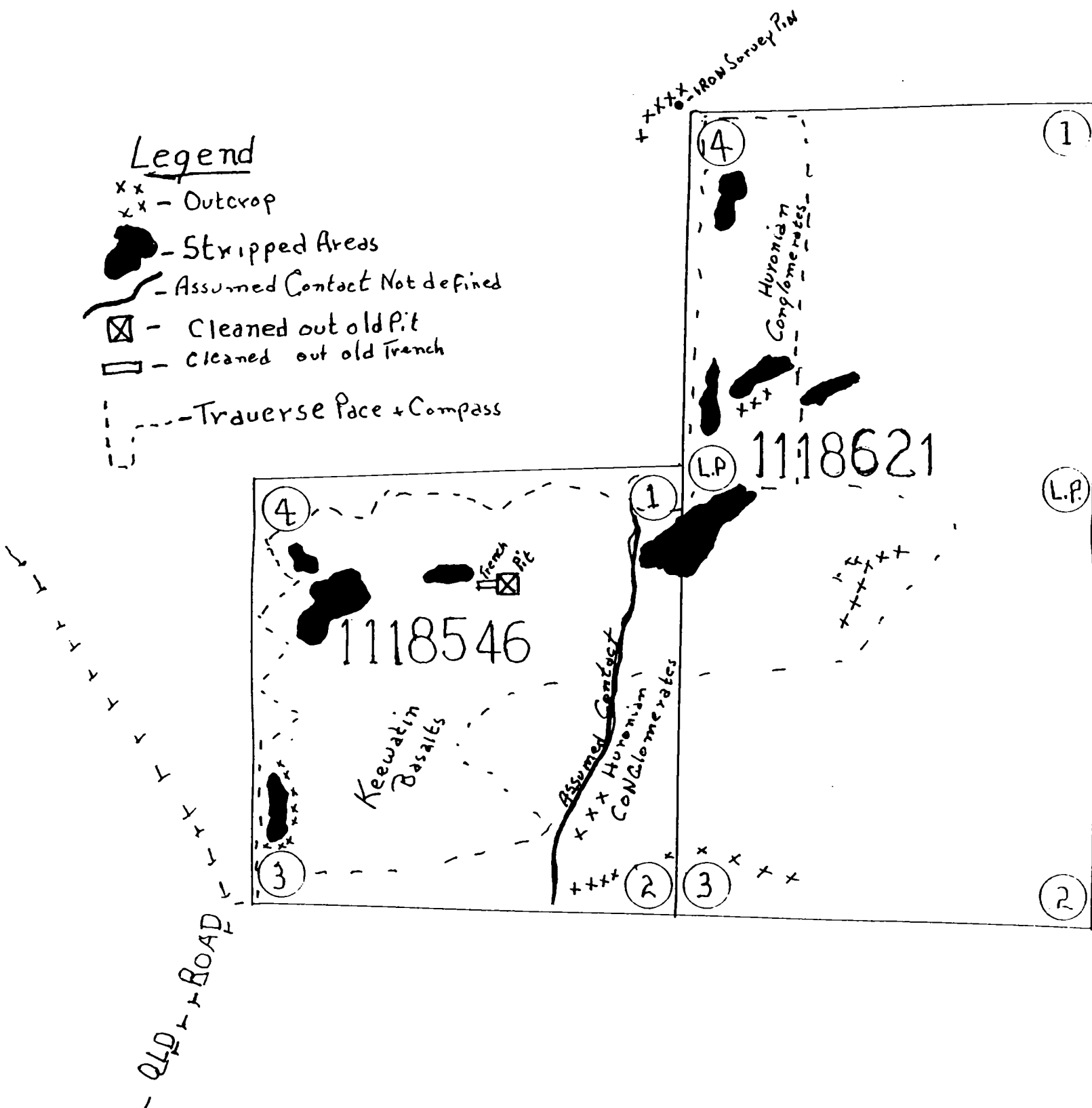

100m 100m 100m 100m — 1:5000



Report of Work Conducted After Recording Claim

Mining Act

Transaction Number
DOCUMENT No.
W9680
(O.P.A.P. - F11576 - P. 04-1-92)

Personal information collected on this form is obtained under the authority of the Mining Act. This information will be used for correspondence. Questions about this collection should be directed to the Provincial Manager, Mining Lands, Ministry of Northern Development and Mines, Fourth Floor, 159 Cedar Street Sudbury, Ontario, P3E 6A5, telephone (705) 670-7264.

- Instructions:**
- Please type or print and submit in duplicate.
 - Refer to the Mining Act and Regulations for the Recorder.
 - A separate copy of this form must be completed.
 - Technical reports and maps must accompany this form in duplicate.
 - A sketch, showing the claims the work is assigned to, must accompany this form.



31M03NW0031 W9680-00001 SOUTH LORRAIN

900

Recorded Holder(s) JOHN A. GORE		Client No. 138273
Address 31 RUBY STREET P.O. BOX #212 COBALT, Ont. P.O. J.1C0		Telephone No. (705)679-5710
Mining Division LARDER LAKE	Township/Area SOUTH LORRAIN	M or G Plan No. G-3448
Dates Work Performed From: APRIL 26/94		To: NOVEMBER 16/94

Work Performed (Check One Work Group Only)

Work Group	Type
Geotechnical Survey	
Physical Work, Including Drilling	MANUAL LABOUR, WASHING, STRIPPING, SCRAPING, TRENCHING, Asst. SURVEYS
Rehabilitation	& SAMPLING
Other Authorized Work	
Assays	
Assignment from Reserve	

Total Assessment Work Claimed on the Attached Statement of Costs \$ 6844

Note: The Minister may reject for assessment work credit all or part of the assessment work submitted if the recorded holder cannot verify expenditures claimed in the statement of costs within 30 days of a request for verification.

Persons and Survey Company Who Performed the Work (Give Name and Address of Author of Report)

Name	Address
JOHN A. GORE	31 RUBY STREET BOX#212, COBALT, ONT. POJ 1C0

(attach a schedule if necessary)

Certification of Beneficial Interest * See Note No. 1 on reverse side

I certify that at the time the work was performed, the claims covered in this work report were recorded in the current holder's name or held under a beneficial interest by the current recorded holder.	Date 31/12/95	Recorded Holder or Agent (Signature) <i>John A. Gore</i>
--	-------------------------	---

Certification of Work Report

I certify that I have a personal knowledge of the facts set forth in this Work report, having performed the work or witnessed same during and/or after its completion and annexed report is true.		
Name and Address of Person Certifying JOHN A. GORE 31 RUBY STREET BOX#212 COBALT, ONTARIO, POJ 1C0		
Telephone No. (705)679-5710	Date DECEMBER, 31/95	Certified By (Signature) <i>John A. Gore</i>

For Office Use Only

Total Value Cr. Recorded \$6844.	Date Recorded <i>Jan 3/96</i>	Mining Recorder <i>[Signature]</i>	Received Stamp
	Deemed Approval Date <i>Apr 2/96</i>	Date Approved <i>May 16/96</i>	
	Date Notice for Amendments Sent <i>[Signature]</i>		



Ministry of
Northern Development
and Mines
Ontario

Ministère du
Développement du Nord
et des mines

**Statement of Costs
for Assessment Credit**

**État des coûts aux fins
du crédit d'évaluation**

Transaction No. / Numéro de transaction
W: 80.00001

(O.P.A.P. File # O.P. 94-132)

Mining Act/Loi sur les mines

Personal information collected on this form is obtained under the authority of the Mining Act. This information will be used to maintain a record and ongoing status of the mining claim(s). Questions about this collection should be directed to the Provincial Manager, Minings Lands, Ministry of Northern Development and Mines, 4th Floor, 159 Cedar Street, Sudbury, Ontario P3E 6A5, telephone (705) 670-7264.

Les renseignements personnels contenus dans la présente formule so recueillis en vertu de la Loi sur les mines et serviront à tenir à jour un registre des concessions minières. Adresser toute question sur la collecte de ce renseignements au chef provincial des terrains miniers, ministère c Développement du Nord et des Mines, 159, rue Cedar, 4^e étage, Sudbur (Ontario) P3E 6A5, téléphone (705) 670-7264.

1. Direct Costs/Coûts directs

Type	Description	Amount Montant	Totals Total global
Wages Salaires	Labour 39 days @ 150. ⁰⁰ Main-d'oeuvre 150. ⁰⁰	\$ 5850. ⁰⁰	
	Field Supervision Supervision sur le terrain	\$	5850. ⁰⁰
Contractor's and Consultant's Fees Droits de l'entrepreneur et de l'expert- consell	Type		
Supplies Used Fournitures utilisées	Type		
Equipment Rental Location de matériel	Type		
Total Direct Costs Total des coûts directs		\$ 5850. ⁰⁰	\$ 5850. ⁰⁰

2. Indirect Costs/Coûts indirects

** Note: When claiming Rehabilitation work Indirect costs are not allowable as assessment work.
Pour le remboursement des travaux de réhabilitation, les coûts indirects ne sont pas admissibles en tant que travaux d'évaluation.

Type	Description	Amount Montant	Totals Total global
Transportation Transport	2925 km. x 30¢ = by 1/2 Ton Truck 79 km. x 39	\$ 877.00	
Food and Lodging Nourriture et hébergement	39 meals @ 3.00	117.00	
Mobilization and Demobilization Mobilisation et démobilisation			
Sub Total of Indirect Costs Total partiel des coûts indirects			\$ 994.00
Amount Allowable (not greater than 20% of Direct Costs) Montant admissible (n'excedant pas 20 % des coûts directs)			994.00
Total Value of Assessment Credit (Total of Direct and Allowable Indirect costs)			\$ 6844.00
Valeur totale du crédit d'évaluation (Total des coûts directs et indirects admissibles)			\$ 6844.00

Note: The recorded holder will be required to verify expenditures claimed in this statement of costs within 30 days of a request for verification. If verification is not made, the Minister may reject for assessment work all or part of the assessment work submitted.

Note: Le titulaire enregistré sera tenu de vérifier les dépenses demandées dans le présent état des coûts dans les 30 jours suivant une demande à cet effet. Si la vérification n'est pas effectuée, le ministre peut rejeter tout ou une partie des travaux d'évaluation présentés.

Filing Discounts

1. Work filed within two years of completion is claimed at 100% of the above Total Value of Assessment Credit.
2. Work filed three, four or five years after completion is claimed at 50% of the above Total Value of Assessment Credit. See calculations below:

Total Value of Assessment Credit	Total Assessment Claimed
	x 0.50 =

Remises pour dépôt

1. Les travaux déposés dans les deux ans suivant leur achèvement sont remboursés à 100 % de la valeur totale susmentionnée du crédit d'évaluation
2. Les travaux déposés trois, quatre ou cinq ans après leur achèvement sont remboursés à 50 % de la valeur totale du crédit d'évaluation susmentionné. Voir les calculs ci-dessous

Valeur totale du crédit d'évaluation	Évaluation totale demandée
	x 0,50 =

Certification Verifying Statement of Costs

I hereby certify:
that the amounts shown are as accurate as possible and these costs were incurred while conducting assessment work on the lands shown in the accompanying Report of Work form.

That as _____ I am authorized
(Recorded Holder, Agent, Position in Company)

I make this certification

Attestation de l'état des coûts

J'atteste par la présente :
que les montants indiqués sont le plus exact possible et que ces dépenses ont été engagées pour effectuer les travaux d'évaluation sur les terrains indiqués dans la formule de rapport de travail ci-joint.

Et qu'à titre de _____ je suis autorisé
(Titulaire enregistré, représentant, poste occupé dans la compagnie)

à faire cette attestation.

Signature John T. Gore	Date December 31/95
---------------------------	------------------------



Ministry of
Northern Development
and Mines

Ministère du
Développement du Nord
et des Mines

Recording Office

4 Government Road East
KIRKLAND LAKE, Ontario
P2N 1A2

Our File: W9680.00001

May 16, 1996

Mr. John Gore
31 Ruby Street
COBALT, Ontario
POJ 1C0

Dear Sir

SUBJECT: Report of Work #W9680.00001
Manual Labour, Stripping et al
L 1118546 et al, South Lorrain Township

The above mentioned report of work was filed in this office January 3, 1996. According to subsection 6(7) of the assessment work regulations under The Mining Act, eligible assessment work shall be deemed to be approved for credit if this Ministry does not identify a deficiency within 90 days of filing.

The 90 day period has expired and therefore the work submitted in your report is to be considered automatically approved and recorded as you had indicated on the reverse side of your report of work form (attached).

If you have any questions please call us.

Yours truly

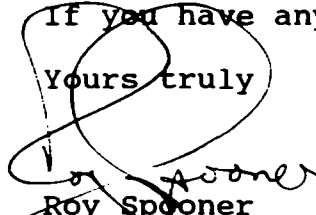

Roy Spooner
Mining Recorder
Larder Lake Mining Division
Telephone (7050 567-9241)

RS/lp

encl.

c.c.: Resident Geologist, Cobalt
Assessment File Office

W9680.00001

PMAN
PSTRP
PTAPK#

MAY 16 1996

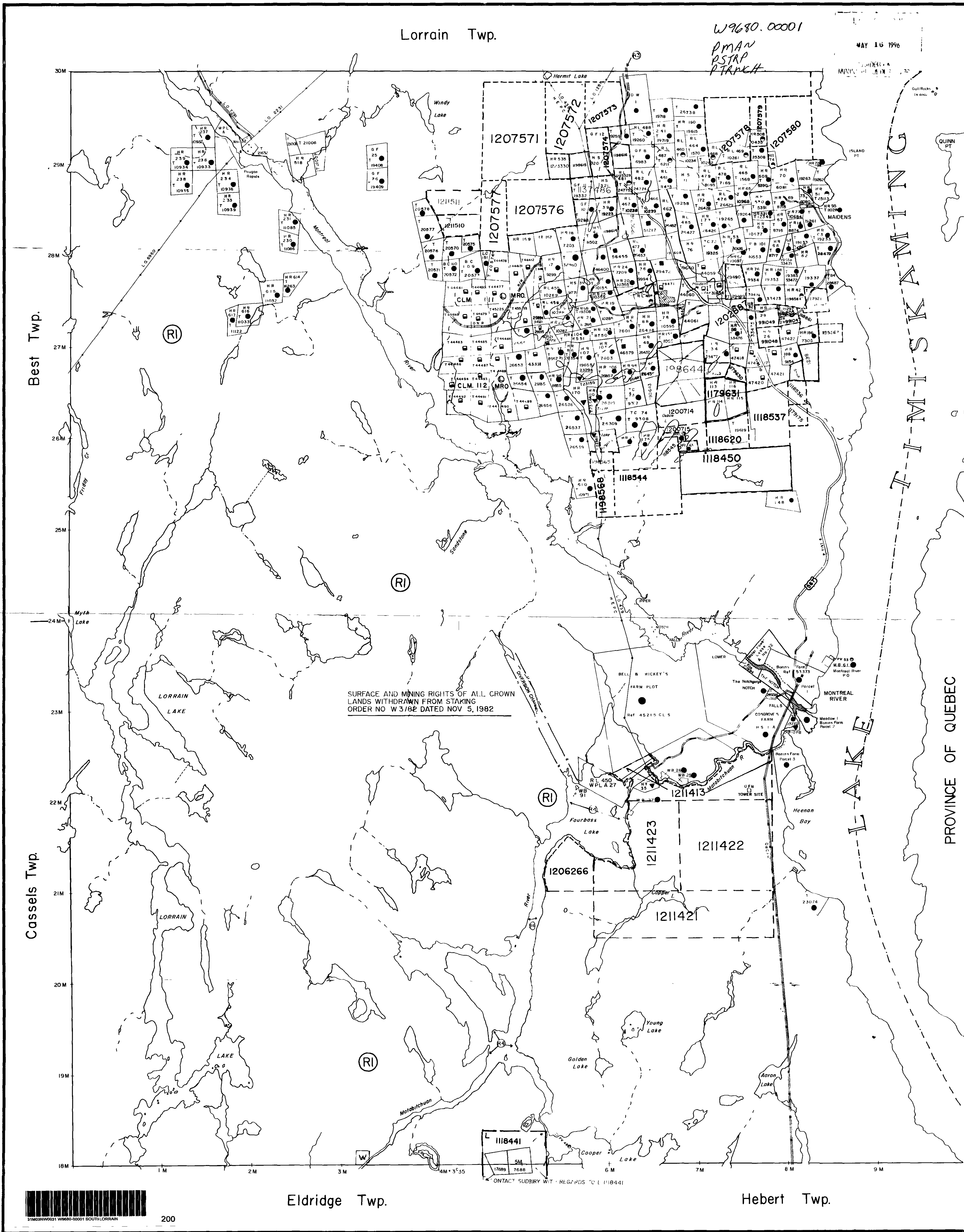

- DISPOS...
- RI AS WITHDRAWN FROM STAKING
- RI SURFACE AND MINING RIGHTS WITHDRAWN FROM PROSPECTING STAKING SALE OR LEASE SECTION 36 OF THE MINING ACT RSO 1980 ORDER W-3-82 NER DATED NOV 5, 1982 AT 1:50 PM
- PART OF ORDER W-3-82 NER REOPENED ORDER Q-M-10-90 NER EFFECTIVE APRIL 3, 1990 AT 7:00 AM EST
- RI SURFACE AND MINING RIGHTS WITHDRAWN FROM PROSPECTING, STAKING, SALE OR LEASE SECTION 36 OF THE MINING ACT RSO 1980 ORDER W-2-90 NER EFFECTIVE APR 5, 1990 AT 7:01 AM EST
- PART OF ORDER W-2-90 NER REOPENED ORDER O-C-1-92 NER EFFECTIVE MAR 16, 1992 AT 1:15 PM EST
- PART OF ORDER W-2-90 NER REOPENED ORDER O-C-1-92 NER EFFECTIVE JUNE 1, 1992 AT 7:00 AM EST
- RI SURFACE RIGHTS ONLY WITHDRAWN - 4 / 2 / 72 FILE 134327
- RI SURFACE RIGHTS ONLY WITHDRAWN - 2 / 2 / 79 ORDER W 2/79 FILE 188540

NOTES

- HE PC FLOODING ABOVE UPPER NOTCH TO ELEV 782' UNDER L.O. 7088
- RESERVE FLOODING RIGHTS TO HE PC CONTOUR 782' ALONG SHOES OF MONTREAL RIVER
- RESERVE FLOODING RIGHTS TO HE PC CONTOUR 905' G.S.C. ALONG THE SHOES OF THE MONTREAL RIVER (PROPOSED)

W ARE A DRAINAGE DITCH OR FLOOD CONTROL DITCH AND WILL BE MARKED WITH BROWN LINE IN FIELD

THE INFORMATION THAT APPEARS ON THIS MAP HAS BEEN COMPILED FROM VARIOUS SOURCES AND ACCURACY IS NOT GUARANTEED. THOSE WISHING TO TAKE MINING CLAIMS SHOULD CONSULT WITH THE MINING RECORDER, MINISTRY OF NORTHERN DEVELOPMENT AND MINING, FOR ADDITIONAL INFORMATION ON THE MAP.

SOUTH LORRAIN

TEMAGAMI
LARDER LAKE
TIMISKAMING

G-3448

"THIS MAP SHOWS THE APPROXIMATE LOCATION OF THE BOUNDARIES OF THE AREA WHICH IS THE SUBJECT OF CURRENT LITIGATION. THE EXACT LOCATION WILL BE SHOWN FOLLOWING CONFIRMATION BY THE PARTIES TO THE ACTION."

ARCHIVE COPY