



31M04NE0040 19 SOUTH LORRAIN

010

Diamond Drilling

Township of So. Lorrain

Report NO: 19

Work performed by: Macfie Expl.

Claim NO	Hole NO	Footage	Date	Note
T 32960	2		Sept/52	

Notes:

LOCATION: South Lorrain

Hole No. 2

DIP 60°

STRIKE S. 76° W.

LOGGED BY Ralph I. Benner

FOOTAGE	DESCRIPTION	SAMPLE NO.	AG	CO.	NI.
0 - 3.0	Casing				
3.0 - 39.0	Keewatin lavas At 16.5 - Fractured over 1", pyr. min..				
39.0 - 45.5	Feldspar Porphyry				
45.5 - 155.0	Keewatin lavas 3.0 - 75.0, Numerous light fractures with rust on faces at 75.2 - 1/2" qtz, calcite, feldspar, - ZnS and IbS min.				
155.0 - 176.0	Feldspar Porphyry				
176.0 - 266.5	Keewatin Lavas at 207.0 - 1/4" calcite, pyr. min. at 210.4 - 3 calcite stringers in 2" core length at 213.0 - 1/4" calcite, cpy & pyr. min. at 215.4 - 1" calcite, qtz and breccia, cpy min.				
266.5	END OF HOLE				
	Drilled by Bradville Diamond Drilling Co. Sept. 1952. Core stored at property.				

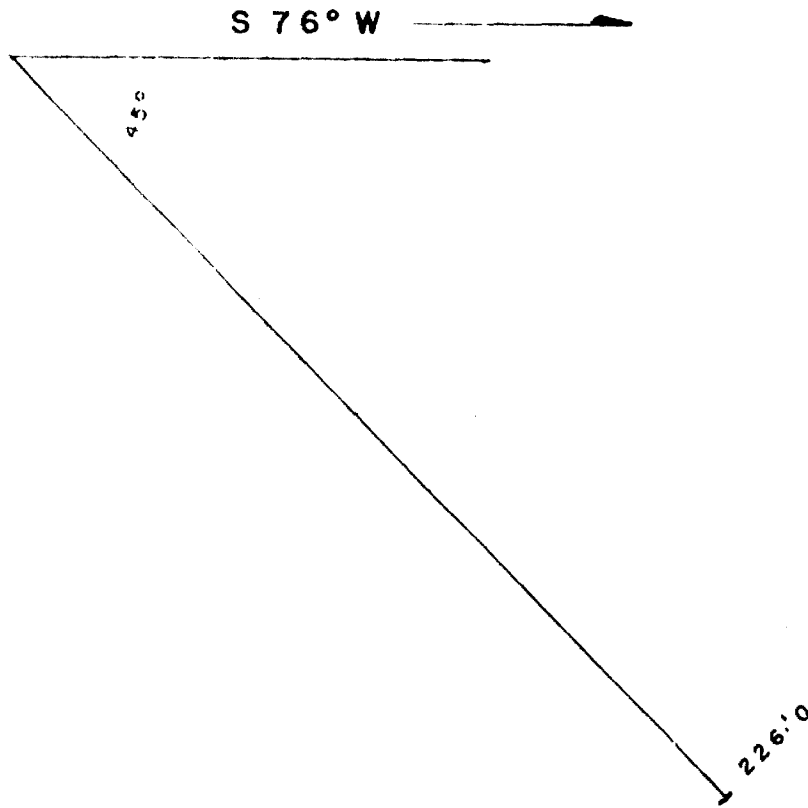

DIAMOND DRILL HOLE NO. 2

CLAIM NS 41
732960

MACFIE OPTION

SOUTH LORRAIN TOWNSHIP
DISTRICT OF TEMISKAMING

- | | |
|--|----------------|
| | PORPHYRY |
| | KEEWATIN LAVAS |
| | " " SEDIMENTS |
| | LAMPROPHYRE |
| | LEACHED ZONE |

SCALE 1" = 50'

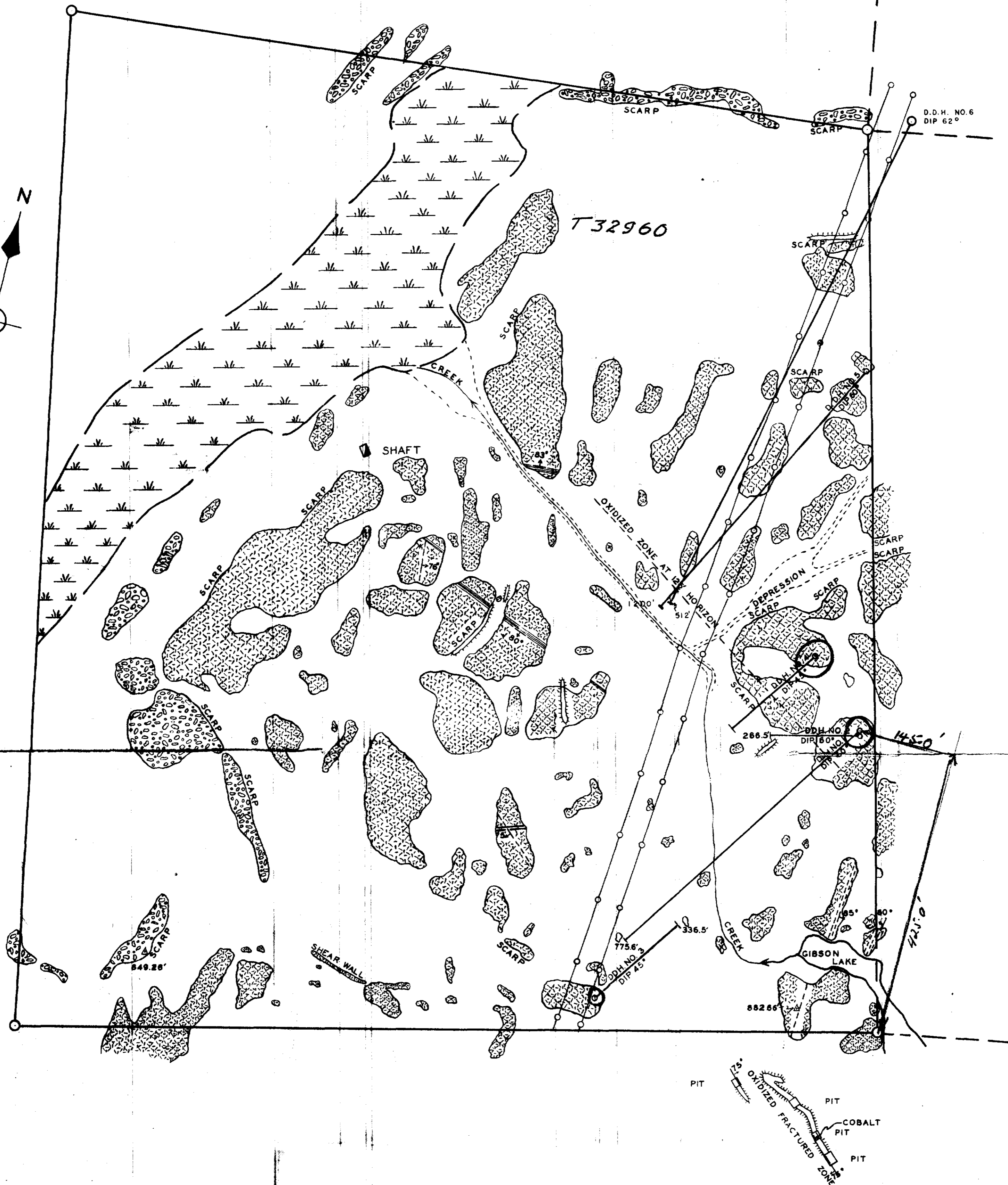

SURFACE GEOLOGICAL PLAN

OF

CLAIM NO. - H.S. 41

OPTIONED BY MACFIE EXPLORATIONS LIMITED

SOUTH LORRAIN TOWNSHIP

DISTRICT OF TEMISKAMING

SCALE 1" = 100'

LEGEND

- | | | | |
|--|--------------------|--|-------------------|
| | CONGLOMERATE | | VALLEY |
| | PORPHYRY | | FRACTURE |
| | KEEWATIN LAVA | | TRENCH |
| | KEEWATIN SEDS. | | SWAMP |
| | OUTCROP | | TRANSMISSION LINE |
| | DIAMOND DRILL HOLE | | ELEVATION MARK |

*12-1-326
South Lorrain
Twp.*

