

Claim 1197377



31M04NW0007 W9670-00102 STRATHY

010

1 Block  
4 Claims

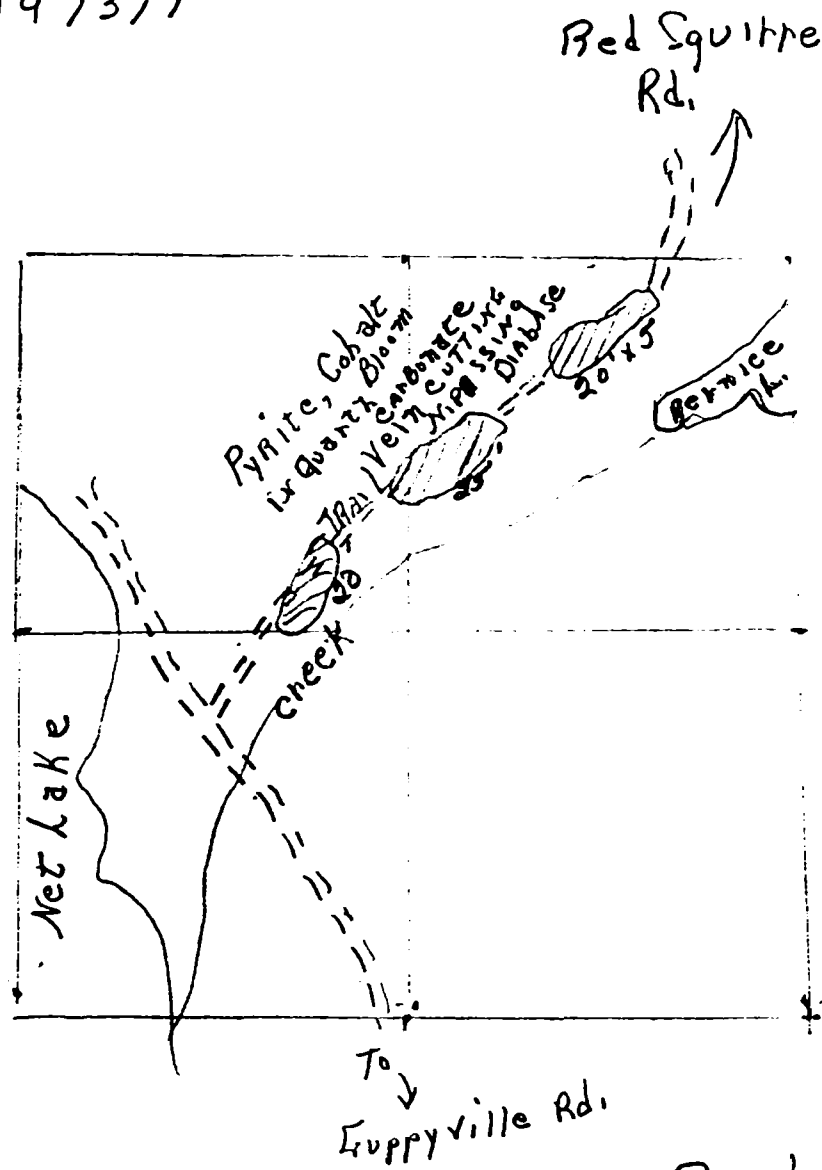

Legend

 stripped Areas

 Trails

Scale - 2" =  $\frac{1}{4}$  mi.





MINISTRY OF  
Northern Development  
and Mines

Ontario

# Report of Work Conducted After Recording Claim

Mining Act

Transaction Number

W 91670.CC.10.2

Personal information collected on this form is obtained under the authority of the Access to Information Act. This collection should be directed to the Provincial Manager, Mining Subsidy, Ontario, PSE 6A5, telephone (705) 670-7254.

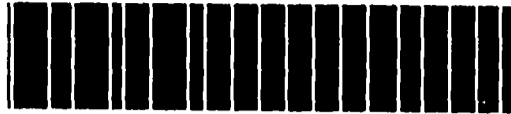

31M04NW0007 W9670-00102 STRATHY

900

- Instructions:
- Please type or print and submit in dup
  - Refer to the Mining Act and Regulator Recorder.
  - A separate copy of this form must be completed for each Work Group.
  - Technical reports and maps must accompany this form in duplicate.
  - A sketch, showing the claims the work is assigned to, must accompany this form.

Recorded Holder(s) <i>Cliff Guppy</i>	Client No.
Address <i>Box 306 Temagami, Ont.</i>	Telephone No.
Mining Division <i>Sudbury</i>	M or G Plan No.
Work Performed From <i>May 9/96</i>	To <i>May 21/96</i>

Work Performed (Check One Work Group Only)

Work Group	Type
Geotechnical Survey	
Physical Work, including Drilling	<i>Mechanical Striping D-6 Cat 19 hrs @ 90. per hr</i>
Rehabilitation	
Other Authorized Work	<b>SECTION 18 ONLY</b>
Assays	
Assignment from Reserve	

Total Assessment Work Claimed on the Attached Statement of Costs \$ 1820

Notes: The Minister may reject for assessment work credit all or part of the assessment work submitted if the recorded holder cannot verify expenditures claimed in the statement of costs within 30 days of a request for verification.

Persons and Survey Company Who Performed the Work (Give Name and Address of Author of Report)

Name	Address

(attach a schedule if necessary)

Certification of Beneficial Interest \* See Note No. 1 on reverse side

I certify that at the time the work was performed, the claims covered in this work report were recorded in the current holder's name or held under a beneficial interest by the current recorded holder.	Date <i>May 23/96</i>	Recorded Holder or Agent (Signature) <i>Cliff Guppy</i>
--	--------------------------	--

Certification of Work Report

I certify that I have a personal knowledge of the facts set forth in this Work report, having performed the work or witnessed same during and/or after its completion and assessed report is true.		
Name and Address of Person Certifying <i>Cliff Guppy</i>		
Telephone No. <i>569-3324</i>	Date <i>May 23/96</i>	Certified by (Signature) <i>Cliff Guppy</i>

For Office Use Only

Total Value of Recorded  \$ 1820.00	Date Recorded <i>May 24, 1996</i>	Mining Subsidy <i>[Signature]</i>	 MAY 24 1996 A.M. P.M. 1 2 3 4 5 6
	Date of Approval <i>August 22/96</i>		

2011 9879





Ministry of  
Northern Development  
and Mines

Ministère du  
Développement du Nord  
et des mines

**Statement of Costs  
for Assessment Credit**

**État des coûts aux fins  
du crédit d'évaluation**

**Mining Act/Loi sur les mines**

Transaction No./N° de transaction

L 91670.CC10.2

Personal information collected on this form is obtained under the authority of the **Mining Act**. This information will be used to maintain a record and ongoing status of the mining claim(s). Questions about this collection should be directed to the Provincial Manager, Minings Lands, Ministry of Northern Development and Mines, 4th Floor, 159 Cedar Street, Sudbury, Ontario P3E 6A5, telephone (705) 670-7264.

Les renseignements personnels contenus dans la présente formule sont recueillis en vertu de la **Loi sur les mines** et serviront à tenir à jour un registre des concessions minières. Adresser toute question sur la collecte de ces renseignements au chef provincial des terrains miniers, ministère du Développement du Nord et des Mines, 159, rue Cedar, 4<sup>e</sup> étage, Sudbury (Ontario) P3E 6A5, téléphone (705) 670-7264.

**1. Direct Costs/Coûts directs**

Type	Description	Amount Montant	Totals Total global
<b>Wages Salaires</b>	Labour Main-d'oeuvre		300.00
	Field Supervision Supervision sur le terrain	300.00	
<b>Contractor's and Consultant's Fees Droits de l'entrepreneur et de l'expert- conseil</b>	Type		
<b>Supplies Used Fournitures utilisées</b>	Type		
<b>Equipment Rental Location de matériel</b>	Type		
	D6 Tractor		1520.00
	St. ...		
<b>Total Direct Costs Total des coûts directs</b>			<b>1820.00</b>

**2. Indirect Costs/Coûts indirects**

\*\* Note: When claiming Rehabilitation work Indirect costs are not allowable as assessment work.  
Pour le remboursement des travaux de réhabilitation, les coûts indirects ne sont pas admissibles en tant que travaux d'évaluation.

Type	Description	Amount Montant	Totals Total global
<b>Transportation Transport</b>	Type		
<b>Food and Lodging Nourriture et hébergement</b>			
<b>Mobilization and Demobilization Mobilisation et démobilisation</b>			
<b>Sub Total of Indirect Costs Total partiel des coûts indirects</b>			
<b>Amount Allowable (not greater than 20% of Direct Costs) Montant admissible (n'excédant pas 20 % des coûts directs)</b>			
<b>Total Value of Assessment Credit (Total of Direct and Allowable indirect costs)</b>		<b>Valeur totale du crédit d'évaluation (Total des coûts directs et indirects admissibles)</b>	

Note: The recorded holder will be required to verify expenditures claimed in this statement of costs within 30 days of a request for verification. If verification is not made, the Minister may reject for assessment work all or part of the assessment work submitted.

Note : Le titulaire enregistré sera tenu de vérifier les dépenses demandées dans le présent état des coûts dans les 30 jours suivant une demande à cet effet. Si la vérification n'est pas effectuée, le ministre peut rejeter tout ou une partie des travaux d'évaluation présentés.

**Filing Discounts**

1. Work filed within two years of completion is claimed at 100% of the above Total Value of Assessment Credit.
2. Work filed three, four or five years after completion is claimed at 50% of the above Total Value of Assessment Credit. See calculations below:

Total Value of Assessment Credit	Total Assessment Claimed
	× 0.50 =

**Remises pour dépôt**

1. Les travaux déposés dans les deux ans suivant leur achèvement sont remboursés à 100 % de la valeur totale susmentionnée du crédit d'évaluation.
2. Les travaux déposés trois, quatre ou cinq ans après leur achèvement sont remboursés à 50 % de la valeur totale du crédit d'évaluation susmentionné. Voir les calculs ci-dessous.

Valeur totale du crédit d'évaluation	Évaluation totale demandée
	× 0,50 =

**Certification Verifying Statement of Costs**

I hereby certify:  
that the amounts shown are as accurate as possible and these costs were incurred while conducting assessment work on the lands shown on the accompanying Report of Work form.

that as [Signature] I am authorized  
(Recorded Holder, Agent, Position in Company)

to make this certification

**Attestation de l'état des coûts**

J'atteste par la présente :  
que les montants indiqués sont le plus exact possible et que ces dépenses ont été engagées pour effectuer les travaux d'évaluation sur les terrains indiqués dans la formule de rapport de travail ci-joint.

Et qu'à titre de [Signature] je suis autorisé  
(titulaire enregistré, représentant, poste occupé dans la compagnie)

à faire cette attestation.

Signature	Date
[Signature]	July 23/96



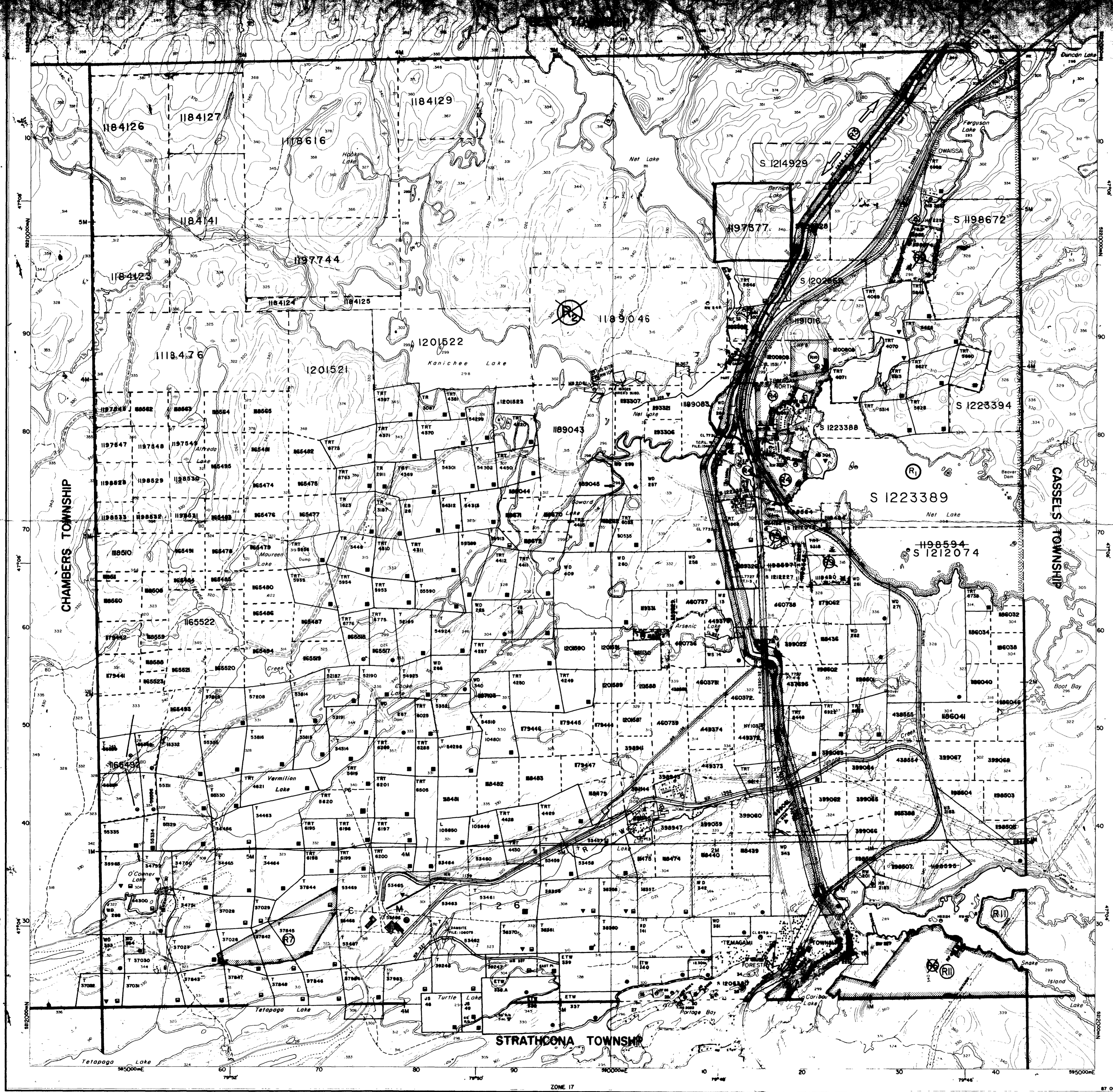

**INDEX TO LAND DISPOSITION**

PLAN  
**G-3451**  
 TOWNSHIP  
**STRATHY**

M.N.R. ADMINISTRATIVE DISTRICT  
**TEMAGAMI**  
 MINING DIVISION  
**SUDBURY**  
 LAND TITLES/REGISTRY DIVISION  
**NIPISSING**

DATE OF ISSUE  
**JUL 09 1996**  
 SUDBURY  
 MINING RECORDER'S OFFICE

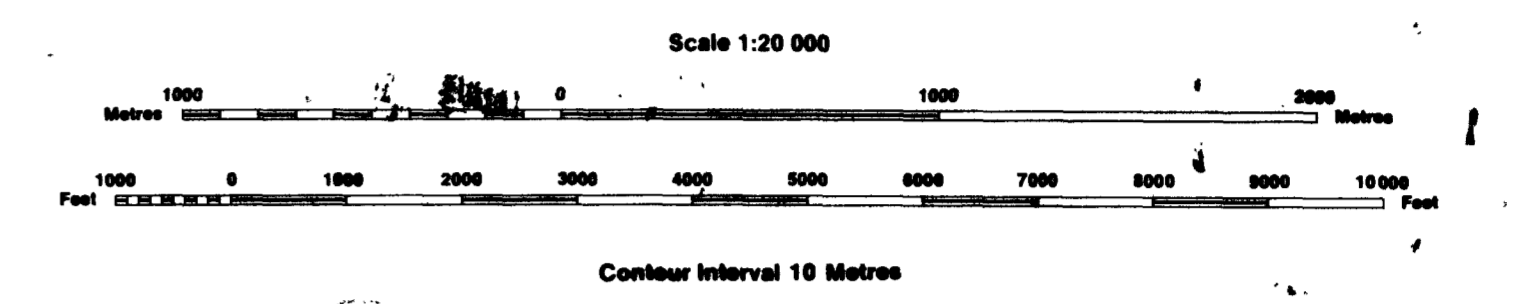

W9670.00102  
 PSTRIP

**AREAS WITHDRAWN FROM DISPOSITION**

MRO - Mining Rights Only  
 SRO - Surface Rights Only  
 M+S - Mining and Surface Rights

**SYMBOLS**

- Boundary
- Township, Meridian, Baseline
- Road allowance: surveyed
- shoreline
- Lot/Concession: surveyed
- unsurveyed
- Parcel: surveyed
- unsurveyed
- Right-of-way: road
- railway
- utility
- Reservation
- Cliff, Pit, Pile
- Contour
- Interpolated
- Approximate
- Depression
- Control point (horizontal)
- Flooded land
- Mine head frame
- Pipeline (above ground)
- Railway: single track
- double track
- abandoned
- Road: highway, county, township
- access
- trail, bush
- Shoreline (original)
- Transmission line
- Wooded area

Description	Order No.	Date	Disposition	File
34(1)R.30/1960	OC 6922/66		SRO	3998
460-66-60	7-17-67	14-06-67	M+S	10884-6
W-01/R/ONT	SEP/20/M		S.R.O.	LAND ROLL
SEC.34/90	W-5-05/M NER		M+S	19660
* MINING DISPOSITION UNDER THE PUBLIC LANDS ACT LAND NOT OPEN FOR STAKING SUB-SECTION 30(1) OF THE MINING ACT R.A.O. 1990 NOTICE RECEIVED 08/11/95				
* MINING DISPOSITION UNDER THE PUBLIC LANDS ACT LAND NOT OPEN FOR STAKING SUB-SECTION 30(1) OF THE MINING ACT R.A.O. 1990 NOTICE RECEIVED 08/11/95				
SEC.35/90	W-5-32/94	AUG/1/94	M+S	19922
SEC.35/90	0-5-18/95	AUG/1/95	M+S	199180
SEC.35/90	W-5-70/94	MAY-27-94	M+S	19960
SEC.35/90	0-5-31/94	AUG/1/94	M+S	19950
SEC.35/90	W-5-32/95	JUNE/1/95	M+S	19950
SEC.35/90	W-5-15/96	APR/16/96	M+S	19910

**DISPOSITION OF CROWN LANDS**

- Patent
- Surface & Mining Rights
- Surface Rights Only
- Mining Rights Only
- Lease
- Surface & Mining Rights
- Surface Rights Only
- Mining Rights Only
- Licence of Occupation
- Order-in-Council
- Cancelled
- Reservation
- Sand & Gravel

**NOTES**

ISLAND 27 BELONGS WITH STRATHCONA TWP.  
 ISLANDS IN LAKE TEMAGAMI - NOT OPEN FOR STAKING  
 \* JUNE 1, 1994 OPENINGS  
 ONTARIO GAZETTE-VOL.127-20  
 MAY 14, 1994 PAGE 1679

THE INFORMATION THAT APPEARS ON THIS MAP HAS BEEN COMPILED FROM VARIOUS SOURCES, AND ACCURACY IS NOT GUARANTEED. THOSE WISHING TO STAKE MINING CLAIMS SHOULD CONSULT WITH THE MINING RECORDER, MINISTRY OF NORTHERN DEVELOPMENT AND MINES, FOR ADDITIONAL INFORMATION ON THE STATUS OF THE LANDS SHOWN HEREON.

Map base and land disposition drafting by Surveys and Mapping Branch, Ministry of Natural Resources.

The disposition of land, location of lot fabric and parcel boundaries on this index was compiled for administrative purposes only.

STRATHY TOWNSHIP

G-3451