

Mineral + Rock Formations on  
Lalain Block # 1214 928

While driving my jeep up the pipeline looking for an access into my claims I saw an interesting formation on a hill + pulled over to have a look.

I saw copper in some of the rocks that was blasted up from the pipeline.

I sent samples for an assay found they contained copper, silver, nickel, gold + platinum.

I stripped some hill approx 1 35 M. from the blasted mineral + found strings of copper on top + south + east side of hill, small amounts.

The rock types were light + dark granite, mafic dike  
Quartz veins mineralized with copper + iron sulfides

I want to do a lot more prospecting + possibly do some drilling

G. H. H. H. H.



# 1996 Assessment Work Report

Assessment Work Report done by  
Cliff Guppy stripping with a D6 Tractor  
on claim Block # 1214928

Prospector's License # K22413

Work done by D.6. Model 408 crawler Bulldozer

Aug. 12 - 4 hrs - stripping with D6 tractor  
Aug 13 - 4 hrs. - stripping with D6 tractor  
Aug. 15 - 4 hrs. - stripping with D6 tractor  
Aug. 16 - 3 hrs. - stripping with D6 tractor  
Aug. 19 - 6 hrs - stripping with D6 tractor  
Aug - 21 - 5 hrs. - stripping with D6 tractor  
Aug - 23 - 6 hrs - stripping with D6 tractor  
Sept. - 8 - 5 hrs. - stripping with D6 tractor

The hours of assessment work  
listed above were done by me.

Clifford Guppy



# Swastika Laboratories

A Division of TSL/Assayers Inc.

Assaying - Consulting - Representation

Established 1928

## Assay Certificate

6W-2868-RA1

Company: **C.GUPPY**

Date: AUG-12-96

Project:

Attn: C.Guppy

We hereby certify the following Assay of 1 Rock samples submitted AUG-07-96 by .

Sample Number	Au oz/ton	Ag oz/ton	Cu %	Ni %
#2	0.005	0.43	1.22	0.03

One assay ton portion used.

Certified by

P.O. Box 10, Swastika, Ontario P0K 1T0

Telephone (705) 642-3244

FAX (705) 642-3300



# Swastika Laboratories

A Division of TSL/Assayers Inc.

Assaying - Consulting - Representation

Established 1928

## Assay Certificate

6W-1885-RA1

Company: **C. GUPPY**

Date: MAY-31-96

Project:

Attn: C. Guppy

We hereby certify the following Assay of 1 Rock samples submitted MAY-29-96 by C. Guppy.

Sample Number	Au oz/ton	Au Check oz/ton	Ag oz/ton	Cu %	Ni %	Pd oz/ton
201	0.005	0.006	0.15	1.18	0.01	<0.001

One assay ton portion used.

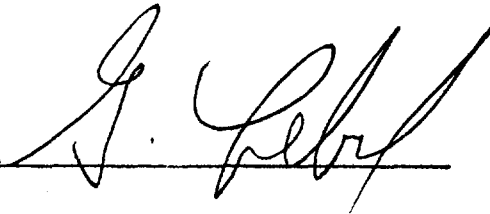
Certified by 

Strathy  
Twp.

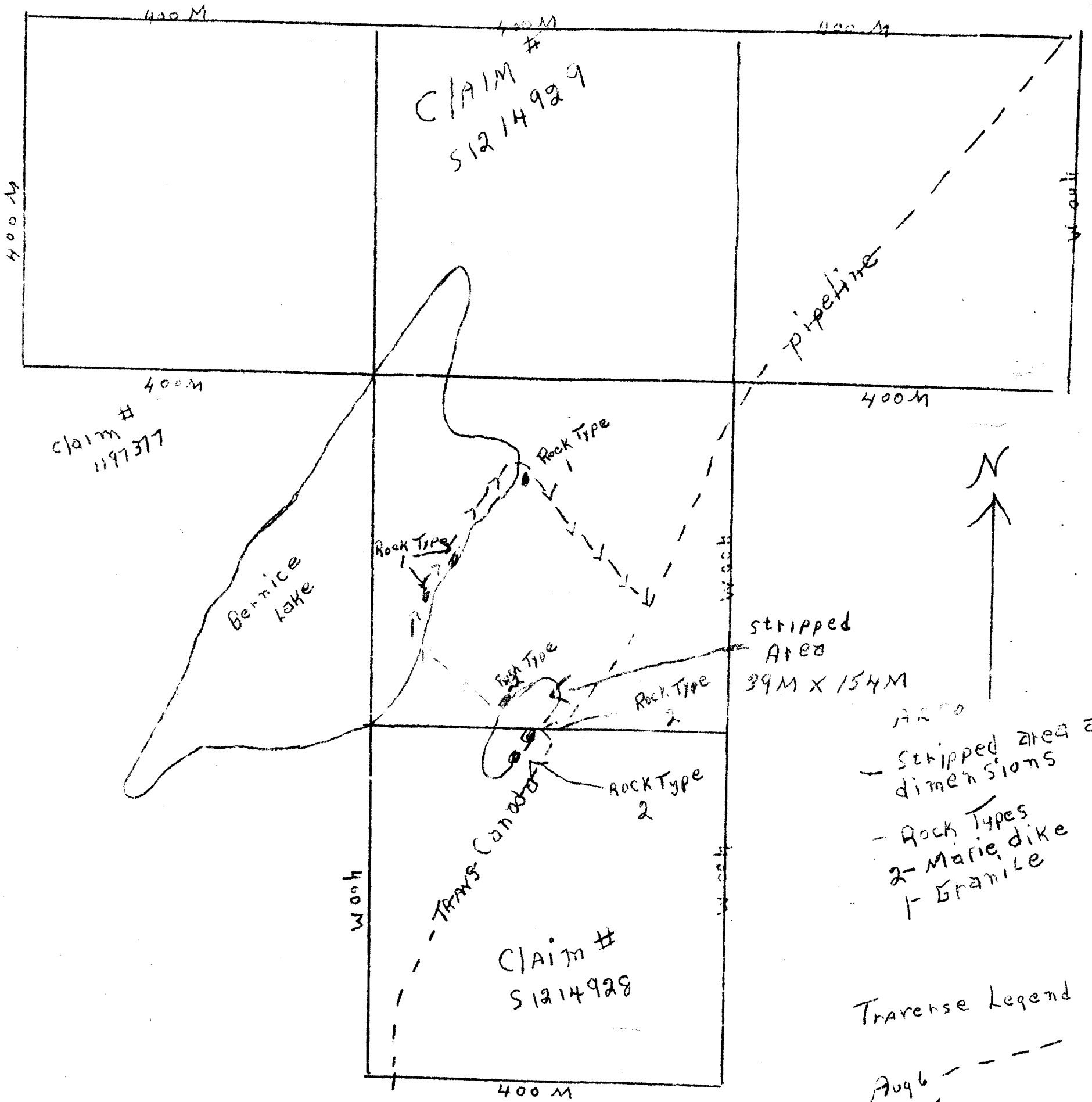

- Stipped area and dimensions
- Rock Types
- 2- Marie dike
- 1- Granite

Transverse Legend

Aug 6 - - - - -  
Aug 17

Sample Sites

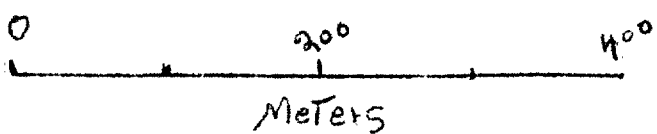
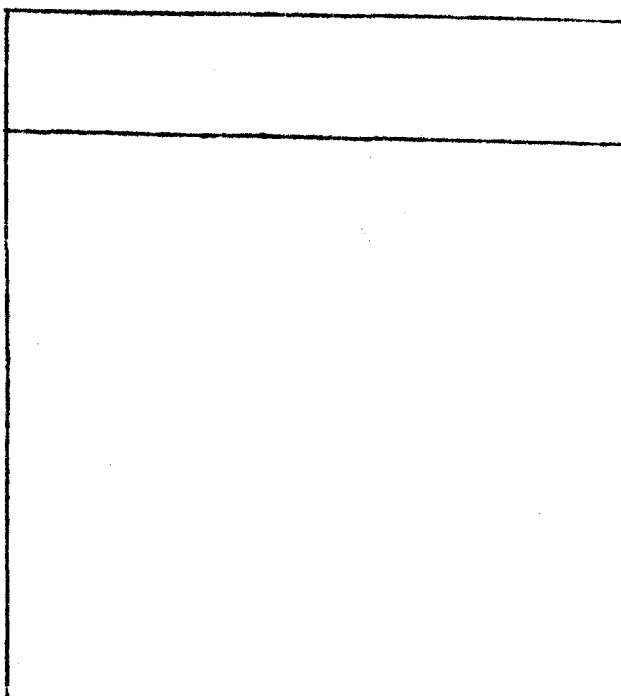

(1:5000 scale)

Guppy Claim  
Strathy Township  
Sudbury Mining Division  
1996 Power Stripping  
Program  
Dec. /96



Ministry of Northern Development and Mines

# Declaration of Assessment Work Performed on Mining Land

Mining Act, Subsection 65(2) and 66(3), R.S.O. 1990

Transaction Number (office use)  
**W9670.00201**  
Assessment Files Research Imaging

Personal information collected on this form is obtained under the Access to Information Act. This information is a public record. This information is a public record. This information is a public record. Questions about this collection should be directed to 11 933 Ramsey Lake Road, Sudbury, Ontario, P3E 6B5.



31M04NW0018 W9670.00201 STRATHY

900

Instructions: - For work performed on Crown Land  
- Please type or print in ink.

### 1. Recorded holder(s) (Attach a list if necessary)

Name <b>Clifford Guppy</b>	Client Number
Address <b>Box 306 Temagami, Ont. p042H0</b>	Telephone Number <b>705-569-3324</b>
	Fax Number
Name	Client Number
Address	Telephone Number
	Fax Number

### 2. Type of work performed: Check (✓) and report on only ONE of the following groups for this declaration.

Geotechnical: prospecting, surveys, assays and work under section 18 (regs)
  Physical: drilling, stripping, trenching and associated assays
  Rehabilitation

Work Type <b>Mechanical stripping with D-6 cat.</b>	Office Use
	Commodity
	Total \$ Value of Work Claimed
Dates Work Performed From <b>12</b> Day <b>Aug</b> Month <b>96</b> Year To <b>2</b> Day <b>Oct</b> Month <b>96</b> Year	NTS Reference
Global Positioning System Data (if available)	Mining Division
Township/Area <b>Strathy</b>	Resident Geologist District
M or G-Plan Number	

Please remember to: - obtain a work permit from the Ministry of Natural Resources as required;  
- provide proper notice to surface rights holders before starting work;  
- complete and attach a Statement of Costs, form 0212;  
- provide a map showing contiguous mining lands that are linked for assigning work;  
- include two copies of your technical report.

### 3. Person or companies who prepared the technical report (Attach a list if necessary)

Name	Telephone Number
Address	Fax Number
Name	Telephone Number
Address	Fax Number
Name	Telephone Number
Address	Fax Number

### 4. Certification by Recorded Holder or Agent

I, **Clifford Guppy** (Print Name), do hereby certify that I have personal knowledge of the facts set forth in this Declaration of Assessment Work having caused the work to be performed or witnessed the same during or after its completion and, to the best of my knowledge, the annexed report is true.

Signature of Recorded Holder or Agent <b>Clifford Guppy</b>	Date <b>Nov. 19/96</b>
Agent's Address <b>Box 306 Temagami Ont p042H0</b>	Telephone Number <b>705-569-3324</b>
	Fax Number

5. **Work to be recorded and distributed.** Work can only be assigned to claims that are contiguous (adjoining) to the mining land where work was performed, at the time work was performed. A map showing the contiguous link must accompany this form.

Mining Claim Number. Or if work was done on other eligible mining land, show in this column the location number indicated on the claim map.	Number of Claim Units. For other mining land, list hectares.	Value of work performed on this claim or other mining land.	Value of work applied to this claim.	Value of work assigned to other mining claims.	Bank. Value of work to be distributed at a future date.
eg TB 7827	16 ha	\$26,825	N/A	\$24,000	\$2,825
eg 1234567	12	0	\$24,000	0	0
eg 1234568	2	\$8,892	\$4,000	0	\$4,892
1 1214929	3	0	1,200	0	0
2 51214928	2	\$2,960. <sup>00</sup>	800	1,200	\$960. <sup>00</sup>
3					
4					
5					
6					
7					
8					
9					
10					
11					
12					
13					
14					
15					
<b>Column Totals</b>		2,960. <sup>00</sup>	2,000	1,200	960. <sup>00</sup>

I, Clifford Geo. Guppy (Print Full Name), do hereby certify that the above work credits are eligible under subsection 7 (1) of the Assessment Work Regulation 6/96 for assignment to contiguous claims or for application to the claim where the work was done.

Signature of Recorded Holder or Agent Authorized in Writing

Date

*Cliff Guppy*

Feb 19 / 96

**6. Instructions for cutting back credits that are not approved.**

Some of the credits claimed in this declaration may be cut back. Please check (✓) in the boxes below to show how you wish to prioritize the deletion of credits:

- 1. Credits are to be cut back from the Bank first, followed by option 2 or 3 or 4 as indicated.
- 2. Credits are to be cut back starting with the claims listed last, working backwards; or
- 3. Credits are to be cut back equally over all claims listed in this declaration; or
- 4. Credits are to be cut back as prioritized on the attached appendix or as follows (describe):

Note: If you have not indicated how your credits are to be deleted, credits will be cut back from the Bank first, followed by option number 2 if necessary.

**For Office Use Only**

Received Stamp SUDBURY MINING DIV. <b>RECEIVED</b> DEC 23 1996	Deemed Approved Date	Date Notification Sent February 5/97
	Date Approved February 27/97	Total Value of Credit Approved
Approved for Recording by Mining Recorder (Signature)		

Personal information collected on this form is obtained under the authority of subsection 6(1) of the Assessment Work Regulation 6/96. Under section 8 of the Mining Act, the information is a public record. This information will be used to review the assessment work and correspond with the mining land holder. Questions about this collection should be directed to the Chief Mining Recorder, Ministry of Northern Development and Mines, 6th Floor, 833 Ramsey Lake Road, Sudbury, Ontario, P3E 6B5.

Work Type	Units of Work <small>Depending on the type of work, list the number of hours/days worked, metres of drilling, kilometres of grid line, number of samples, etc.</small>	Cost Per Unit	Total Cost
Stripping	37 hrs.	HR. \$ 80. <sup>xx</sup> / <sub>00</sub>	\$ 2,960. <sup>xx</sup> / <sub>00</sub>
Associated Costs (e.g. supplies, mobilization and demobilization).			
Transportation Costs			
Food and Lodging Costs			
Total Value of Assessment Work			\$ 2,960. <sup>xx</sup> / <sub>00</sub>

Calculations of Filing Discounts:

- Work filed within two years of performance is claimed at 100% of the above Total Value of Assessment Work.
- If work is filed after two years and up to five years after performance, it can only be claimed at 50% of the Total Value of Assessment Work. If this situation applies to your claims, use the calculation below:

TOTAL VALUE OF ASSESSMENT WORK                      x 0.50 =                      Total \$ value of worked claimed.

Note:

- Work older than 5 years is not eligible for credit.
- A recorded holder may be required to verify expenditures claimed in this statement of costs within 45 days of a request for verification and/or correction/clarification. If verification and/or correction/clarification is not made, the Minister may reject all or part of the assessment work submitted.

Certification verifying costs:

I, Clifford Guppy (please print full name), do hereby certify, that the amounts shown are as accurate as may reasonably be determined and the costs were incurred while conducting assessment work on the lands indicated on the accompanying Declaration of Work form as Clifford Guppy (recorded holder, agent, or state company position with signing authority) I am authorized to make this certification.

Signature <u>Cliff G. Guppy</u>	Date Dec. 19 / 96
------------------------------------	----------------------



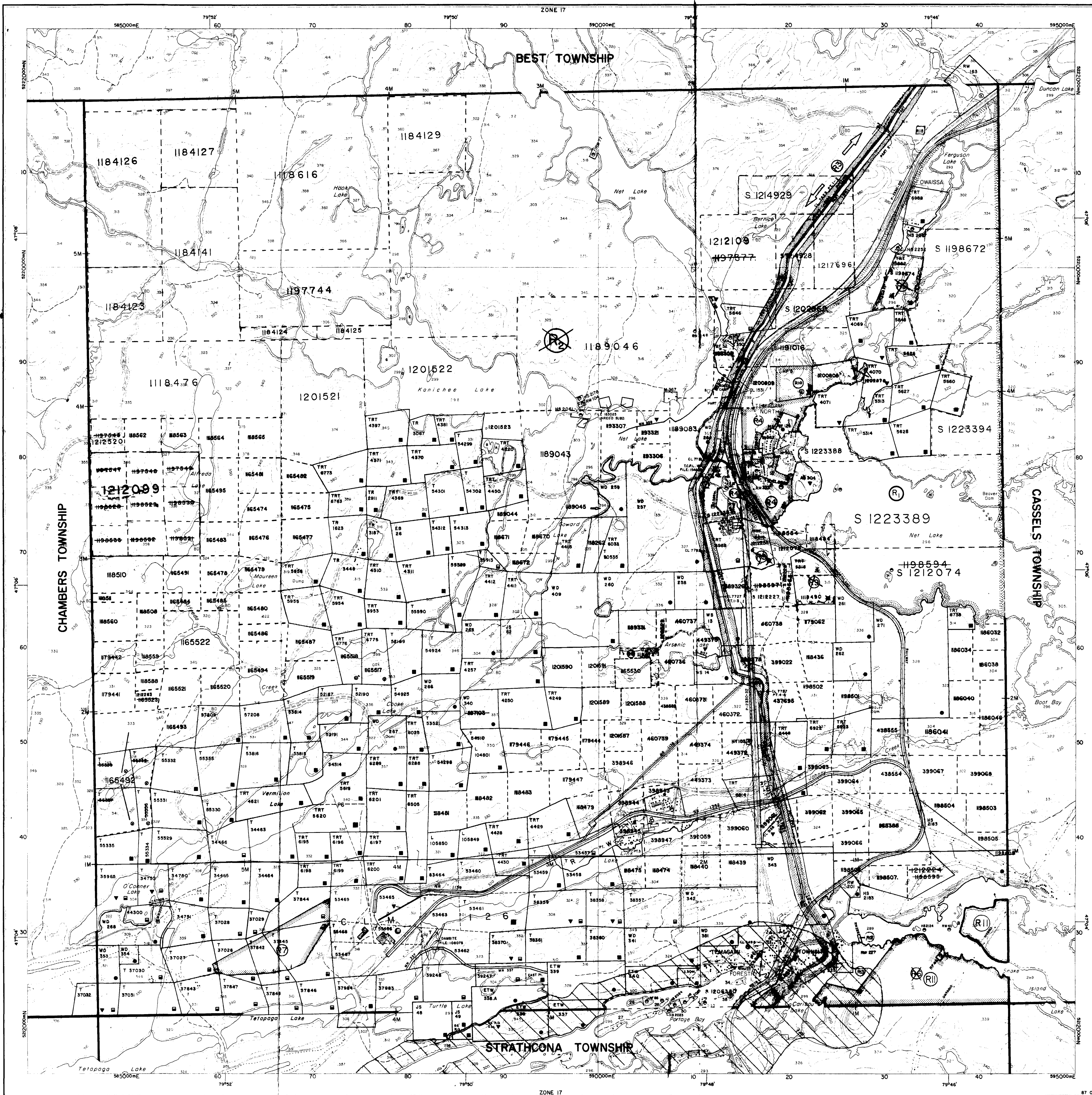

Ministry of Natural Resources Ontario  
 Ministry of Northern Development and Mines

PUT INTO SERVICE MARCH 23 1994

## INDEX TO LAND DISPOSITION

PLN  
 G 3451  
 TOWNSHIP  
**STRATHONY**

M.N.R. ADMINISTRATIVE DISTRICT  
**TEMAGAMI**  
 MINING DIVISION  
**SUDBURY**  
 LAND TITLES/REGISTRY DIVISION  
**NIPISSING**

Scale 1:20 000

Contour Interval 10 Metres

200

### AREAS WITHDRAWN FROM DISPOSITION

MRO - Mining Rights Only  
 SRO - Surface Rights Only  
 M+S - Mining and Surface Rights

Description	Order No.	Date	Disposition	File
(1) 36(1)R.S.O.1960	OC 2022/66		S.R.O.	3996
(2) 36(1)R.S.O.1960	W-3/81/94T	SEP.20/94	S.R.O.	LAND ROLL
(3) 36(1)R.S.O.1960	W-3-02/N MER		M & S	19880
(4) PENDING DISPOSITION UNDER THE PUBLIC LANDS ACT - LAND NOT OPEN FOR STAKING SUB-SECTION 30(2) OF THE MINING ACT R.S.O.1990 - NOTICE RECEIVED 28/JAN/95				
(5) PENDING DISPOSITION UNDER THE PUBLIC LANDS ACT - LAND NOT OPEN FOR STAKING SUB-SECTION 30(2) OF THE MINING ACT R.S.O.1990 - NOTICE RECEIVED 28/JAN/95				
(6) 36(1)R.S.O.1960	W-3-30/94	APR.18/94	M & S	19860
(7) 36(1)R.S.O.1960	0-5-18/95	AUG.11/95	M & S	19510
(8) 36(1)R.S.O.1960	W-3-76/94	APR.27/94	M & S	19860
(9) 36(1)R.S.O.1960	0-5-31/94	AUG.19/94	M & S	19550
(10) 36(1)R.S.O.1960	W-3-32/95	JUNE.1/95	M & S	19550
(11) 36(1)R.S.O.1960	W-3-77/94	SEP.13/94	M & S	19510
(12) 36(1)R.S.O.1960	W-3-10/95	APR.16/95	M & S	19550
(13) PENDING DISPOSITION - SEC.30(2)				

THIS TOWNSHIP FALLS WITHIN THE TEMAGAMI COMPREHENSIVE PLANNING AREA. SPECIAL WORKING CONDITIONS MAY APPLY TO EXPLORATION ACTIVITIES. FOR MORE DETAILS PLEASE CONTACT:  
 DISTRICT MANAGER,  
 NORTH BAY DISTRICT  
 MINISTRY, NATURAL RESOURCES

### SYMBOLS

Boundary	.....
Township, Meridian, Baseline	.....
Road allowance; surveyed	.....
shoreline	.....
Lot/Concession; surveyed	.....
unsurveyed	.....
Parcel; surveyed	.....
unsurveyed	.....
Right-of-way; road	.....
railway	.....
utility	.....
Reservation	.....
Cliff, Pit, Pile	.....
Contour	.....
Interpolated	.....
Approximate	.....
Depression	.....
Control point (horizontal)	.....
Flooded land	.....
Mine head frame	.....
Pipeline (above ground)	.....
Railway; single track	.....
double track	.....
abandoned	.....
Road; highway, county, township	.....
access	.....
trail, bush	.....
Shoreline (original)	.....
Transmission line	.....
Wooded area	.....

### DISPOSITION OF CROWN LANDS

Patent	.....
Surface & Mining Rights	.....
Surface Rights Only	.....
Mining Rights Only	.....
Lease	.....
Surface & Mining Rights	.....
Surface Rights Only	.....
Mining Rights Only	.....
Licence of Occupation	.....
Order-in-Council	.....
Cancelled	.....
Reservation	.....
Sand & Gravel	.....

### NOTES

ISLAND 27 BELONGS WITH STRATHONY TWP.  
 ISLANDS IN LAKE TEMAGAMI - NOT OPEN FOR STAKING  
 SEC.34/90 W-3-12/95 JAN.22/95 M & S 19860  
 \* JUNE 1, 1994 OPENINGS  
 ONTARIO GAZETTE-VOL.127-20  
 MAY 14, 1994 PAGE 1679

SKYLINE RESERVE (R14)  
 AREA DEEMED IN NEED OF PROTECTION BY THE CROWN AND WILL REMAIN WITHDRAWN

LAKE TEMAGAMI (R14)  
 LAND COVERED BY THE WATERS OF LAKE TEMAGAMI IS WITHDRAWN FROM PROSPECTING AND STAKING OUT

THE INFORMATION THAT APPEARS ON THIS MAP HAS BEEN COMPILED FROM VARIOUS SOURCES, AND ACCURACY IS NOT GUARANTEED. THOSE WISHING TO STAKE MINING CLAIMS SHOULD CONSULT WITH THE MINING REFORMER, MINISTRY OF NORTHERN DEVELOPMENT AND MINES, FOR ADDITIONAL INFORMATION ON THE STATUS OF THE LANDS SHOWN HEREON.

**DATE OF ISSUE**  
 MAR 04 1997  
 SUDBURY  
 MINING RECORDER'S OFFICE

Map base and land disposition drafting by Surveys and Mapping Branch, Ministry of Natural Resources.  
 The disposition of land, location of lot fabric and parcel boundaries on this index was compiled for administrative purposes only.