

31M04NW2007 2.19060 STRATHY

010

2.19060

Power Stripping and Trenching Report

Guppy Claims - Bernice Lake
Strathy Twp. Sudbury Mining Division

December 1998.

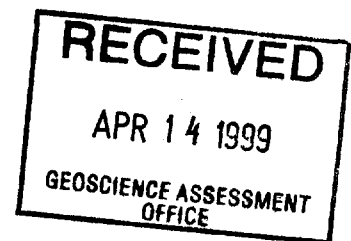

NTS: 31 M/4



31M04NW2007 2.19060 STRATHY

010C

Table of Contents

Work and equipment schedule	1
Stripping and trenching report	2,3
Location of Work	4
Plan Map of Stripping and Trenching	5
Claim Map	6
Assay Certificates	7,8,9

- * All hours were worked with D.6. Tractor and a D.5. Skidder Tree Farmer.
- * Rates for machinery were charged at a rate of \$80/hr.

1997

• Oct. 1	-removed overburden.....	6 hrs
• Oct. 6	-trenching	3 hrs
• Oct. 16	-removed trees and overburden	6 hrs
• Oct. 17	-trenching and clearing	4 hrs

1998

• April 11	-pulled trees from Mt. with skidder	6 hrs
• April 12	-stripping	3 hrs
• April 13	-stripping	5 hrs
• April 14	-stripping	4 hrs
• April 15	-stripping and skidding	3 hrs
• April 20	-cleared logs and dug overburden	6 hrs
• April 26	-stripping	6 hrs
• May 10	-stripping South of Bernice Lake	4 hrs
• May 16	-stripping South of Bernice Lake	2 hrs
• May 24	-clearing overburden	5 hrs
• May 26	-clearing and stripping	3 hrs
• June 5	-stripping South of Bernice Lake	1 hr
• June 14	-stripped on road South of Bernice Lake	2 hrs
• July 30	-stripped overburden and removed trees	5 hrs
• Aug. 8	-stripped area South of Bernice Lake	2 hrs
• Sept. 10	-removed boulders from side of Mt.	4 hrs
• Oct. 1	-removed overburden	6 hrs
• Oct. 6	-trenched.....	3 hrs
• Oct. 16	-removed trees and overburden	6 hrs
	TOTAL	107 hrs

*** 107 hrs @ \$80.00/hr = \$8560.00 ***

Guppy Claims- Bernice Lake Property Claim 1212109

Stripping and Trenching Report

1997 and 1998

Work was done by Clifford Guppy.

Area No. 1

Stripping and Trenching:

An area 125 meters long by 10 meters wide was stripped off using a D-6 bulldozer and a skidder. This was accomplished by first cutting and hauling the trees with the skidder and then blading away 3-4 feet of overburden cover with the dozer. The stripped area runs east-west across the face of a small mountain. We kept working down the incline removing trees and overburden until we came to a 5 or 6 foot drop off at the end of the slope.

Trenching was accomplished by drilling (plugger) a series of holes about 18-24 inches deep in a grid pattern. The holes were loaded with explosives and detonated. Typical dimensions of the trenches were about 1 meter wide by 2-3 meters long.

Geology encountered: The work followed a narrow (a few inches to 2 feet) mafic sill (green) that pinched in and out along the side of the mountain. The sill dips into the mountain at 50-60 degrees. The sill can be described as a mafic breccia with cherty clasts with quartz eyes and carbonate veinlets. It is fine grained and is mineralized with minor sulphides (<2%), namely pyrite and chalcopyrite. Chlorite and hematite are found along quartz veinlets as well. The felsic host rock was differentiated appearing reddish on the weathered surface and pink where freshly exposed with varying amounts of quartz. Three grab samples were taken for assay (certificates attached).

Area No. 2

Stripping and Trenching:

Same methodology as area No. 1 on an area 10x10 meters.

Geology encountered: An area of malachite staining was trenched and minor sulphides were noted along seams of a differentiated intermediate felsic intrusive.

Area No. 3

Stripping and Trenching:

Same methodology as Area No. 1 over an area 10x8 meters.

Geology encountered: same as Area No. 2

Area No. 4

Stripping and Trenching:

Same methodology as No. 1 over an area of 8 x 8 meters.

Geology encountered: Olivine diabase with minor sulphides.

1214929

1212109

Bennice Lake

Power Stripping Areas

Pipeline Right of Way

N

1214928

Net Lake

Road



Meters
1:5000

- No 1 - 125M x 10M.
- No 2 - 10M x 10M.
- No 3 - 10M x 8M.
- No 4 - 8M x 8M.

X showing Samples
 Trenching

Lumpy Claims.
 Power Stripping.

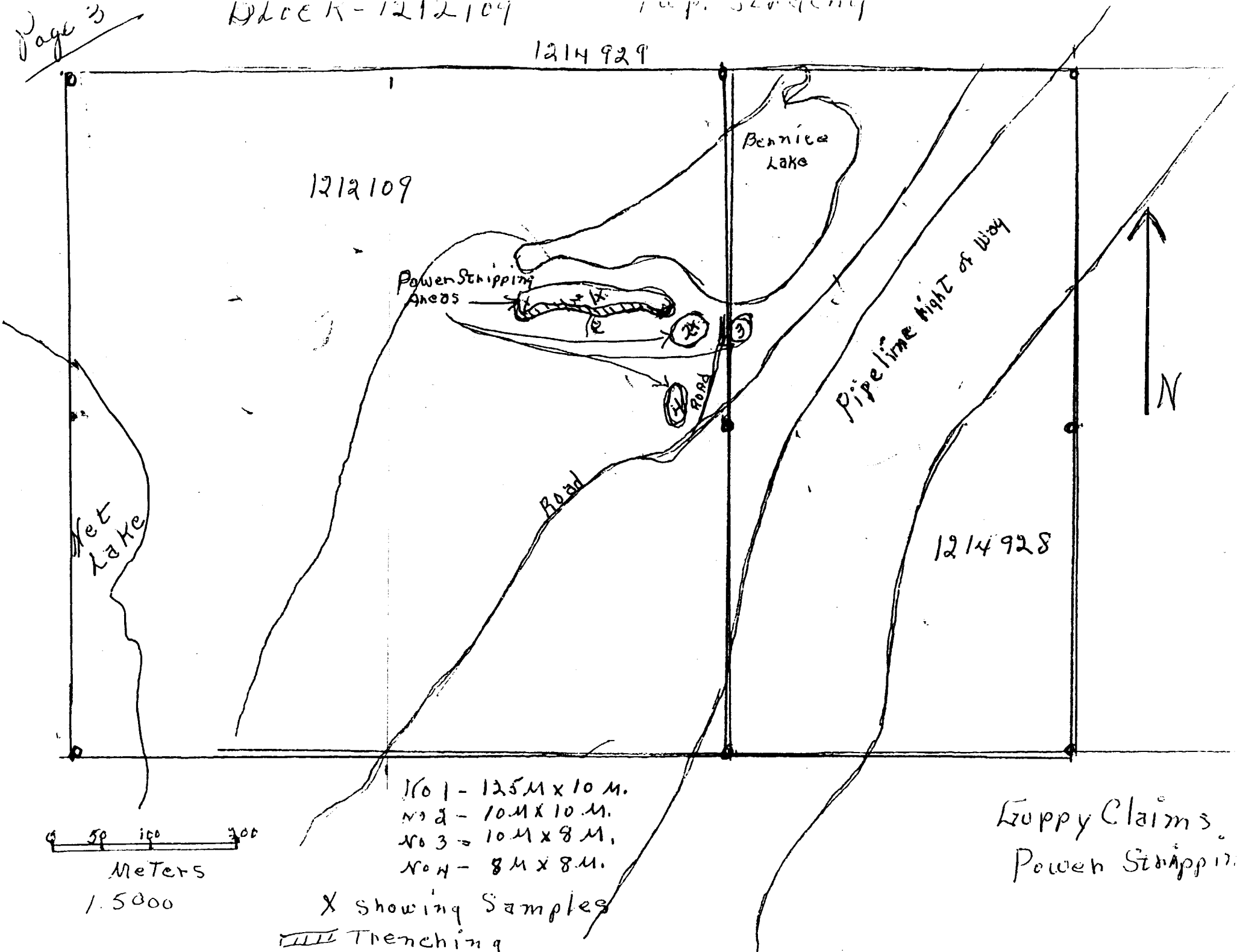

Bernice Lake



astronomic

1 125 x 10m.

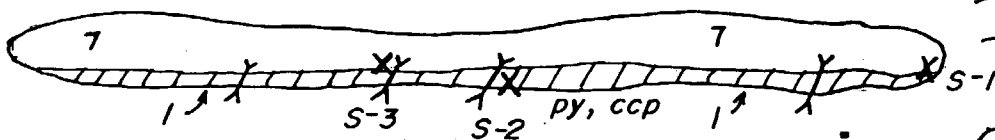

T

mountain

T

2

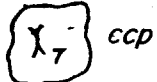

10 x 10 m.

3



10 x 8 m.

1212109

1214928

X sample (grab)

○ stripped areas

T trenching

▨ mafic sill (mineralized)

▨ diabase

T intermediate to felsic intrusive

I mafic volcanic

4



8 x 8 m.

road

line post

0 10 20 30 40 m.



PLAN VIEW
STRIPPING & TRENCHING
Guppy Claims

1:1,000 4/99.
D. Laronde



Swastika Laboratories

A Division of Assayers Corporation Ltd.

Assaying - Consulting - Representation

Established 1928

Assay Certificate

8W-0489-RA1

Company: **C. GUPPY**

Date: MAR-05-98

Project:

Attn: C. Guppy

We hereby certify the following Assay of 2 Rock samples submitted MAR-02-98 by .

Sample Number	Au oz/ton	Au Check oz/ton	Cu %	Pd g/tonne	Pt g/tonne
S-Bernice Lake ✓	0.004	0.003	0.90	<0.005	<0.001
Bernice Gully	Nil	-	0.007	<0.005	<0.001

Sample 5-1

One assay ton portion used. 1

Certified by



Swastika Laboratories

A Division of Assayers Corporation Ltd.

Assaying - Consulting - Representation

Established 1928

Assay Certificate

8W-0083-RA1

Company: **MR. GUPPY**

Date: JAN-22-98

Project:

Attn: Mr. Guppy

We hereby certify the following Assay of 1 Rock samples submitted JAN-16-98 by .

Sample Number	Au oz / ton	Au Check oz / ton	Cu %	Pt oz / ton	Pd oz / ton
Below Sill	0.020	0.029	0.006	<0.001	<0.001
running E to W	-	-	-	-	-
South Bernice #2	-	-	-	-	-

Sample 52

One assay ton portion used. 1

Certified by



Swastika Laboratories

A Division of TSL/Assayers Inc.

Assaying - Consulting - Representation

Established 1928

Assay Certificate

7W-3977-RA1

Company: **C. GUPPY**

Date: OCT-14-97

Project:

Attn: C. Guppy

We hereby certify the following Assay of 2 Rock samples submitted OCT-08-97 by .

Sample Number	Au oz/ton	Au Check oz/ton	Multi-Element Results to follow
Bernice	0.037	0.029	
Perpendicular	0.001	-	

Sample S-3

One assay ton portion used. 1

Certified by



31M04NW2007 2.19060 STRATHY 900

sections 66(2) and 66(3) of the Mining Act. Under section 8 of the Mining Act, all work and correspond with the mining land holder. Questions about this collection and Mines, 3rd Floor, 833 Ramsey Lake Road, Sudbury, Ontario, P3E 0B5.

Instructions: - For work performed on Crown Lands before recording a claim, use form 0240.
 - Please type or print in ink.

2.19060

1. Recorded holder(s) (Attach a list if necessary)

Name <i>Clifford Geo. Guppy</i>	Client Number <i>140 218</i>
Address <i>Box 306 Temagami, Ont. P0H2H0</i>	Telephone Number <i>705-569-3324</i>
	Fax Number
Name	Client Number
Address	Telephone Number
	Fax Number

2. Type of work performed: Check (✓) and report on only ONE of the following groups for this declaration.

Geotechnical: prospecting, surveys, assays and work under section 18 (regs)
 Physical: drilling stripping, trenching and associated assays
 Rehabilitation

Work Type	Office Use
	Commodity <i>1</i>
	Total \$ Value of Work Claimed <i>8560</i>
Dates Work Performed From <i>1 Oct.</i> To <i>16 Nov.</i>	NTS Reference
Global Positioning System Data (if available)	Mining Division <i>Sudbury</i>
Township/Area <i>Strathy</i>	Resident Geologist District <i>Kirkland Lake</i>
M or G-Plan Number	

Please remember to: - obtain a work permit from the Ministry of Natural Resources as required;
 - provide proper notice to surface rights holders before starting work;
 - complete and attach a Statement of Costs, form 0212;
 - provide a map showing contiguous mining lands that are linked for assigning work;
 - include two copies of your technical report.

3. Person or companies who prepared the technical report (Attach a list if necessary)

Name	Telephone Number
Address	Fax Number
Name	Telephone Number
Address	Fax Number
Name	Telephone Number
Address	Fax Number

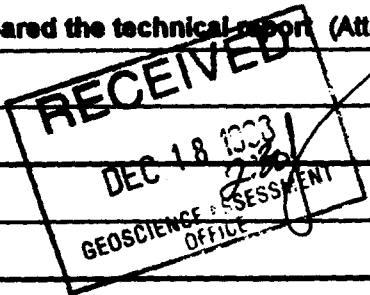

4. Certification by Recorded Holder or Agent

I, _____, do hereby certify that I have personal knowledge of the facts set forth in this Declaration of Assessment Work having caused the work to be performed or witnessed the same during or after its completion and, to the best of my knowledge, the annexed report is true.

Signature of Recorded Holder or Agent <i>Clifford Guppy</i>	Date <i>Dec 18 / 98</i>
Agent's Address <i>Box 306 Temagami Ont P0H2H0</i>	Telephone Number <i>705-569-3324</i>
	Fax Number

Deemed Mar. 18/99

5. Work to be recorded and distributed. Work can only be assigned to claims that are contiguous (adjoining) to the mining land where work was performed, at the time work was performed. A map showing the contiguous link must accompany this form.

W9870.00599 2. 19060

Mining Claim Number. Or if work was done on other eligible mining land, show in this column the location number indicated on the claim map.	Number of Claim Units. For other mining land, list hectares.	Value of work performed on this claim or other mining land.	Value of work applied to this claim.	Value of work assigned to other mining claims.	Bank. Value of work to be distributed at a future date
eg TB 7827	18 ha	\$28,825	N/A	\$24,000	\$2,825
eg 1234567	12	0	\$24,000	0	0
eg 1234568	2	\$ 8,882	\$ 4,000	0	\$4,882
1 1212109	4	8,560	8000		560
2					
3					
4					
5					
6					
7					
8					
9					
10					
11					
12					
13					
14					
15					
Column Totals					

RECEIVED
 DEC 18 1998
 GEOSCIENCE ASSESSMENT
 OFFICE

I, Clifford Geo Guppy, do hereby certify that the above work credits are eligible under subsection 7 (1) of the Assessment Work Regulation 6/96 for assignment to contiguous claims or for application to the claim where the work was done.

Signature of Recorded Holder or Agent Authorized in Writing

Date

Clifford Guppy

Dec 18/98

6. Instructions for cutting back credits that are not approved.

Some of the credits claimed in this declaration may be cut back. Please check (✓) in the boxes below to show how you wish to prioritize the deletion of credits:

- 1. Credits are to be cut back from the Bank first, followed by option 2 or 3 or 4 as indicated.
- 2. Credits are to be cut back starting with the claims listed last, working backwards; or
- 3. Credits are to be cut back equally over all claims listed in this declaration; or
- 4. Credits are to be cut back as prioritized on the attached appendix or as follows (describe):

Note: If you have not indicated how your credits are to be deleted, credits will be cut back from the Bank first, followed by option number 2 if necessary.

For Office Use Only

Received Stamp

Deemed Approved Date	Date Notification Sent
Date Approved	Total Value of Credit Approved
Approved for Recording by Mining Recorder (Signature)	

Geoscience Assessment Office
933 Ramsey Lake Road
6th Floor
Sudbury, Ontario
P3E 6B5

Telephone: (888) 415-9846
Fax: (877) 670-1555

April 16, 1999

CLIFFORD GEORGE GUPPY
BOX 306
FIRST STREET
TEMAGAMI, Ontario
P0H-2H0

Visit our website at:
www.gov.on.ca/MNDM/MINES/LANDS/mlsmnpge.htm

Dear Sir or Madam:

Submission Number: 2.19060

Status

Subject: Transaction Number(s): W9870.00599 Approval After Notice

We have reviewed your Assessment Work submission with the above noted Transaction Number(s). The attached summary page(s) indicate the results of the review. WE RECOMMEND YOU READ THIS SUMMARY FOR THE DETAILS PERTAINING TO YOUR ASSESSMENT WORK.

If the status for a transaction is a 45 Day Notice, the summary will outline the reasons for the notice, and any steps you can take to remedy deficiencies. The 90-day deemed approval provision, subsection 6(7) of the Assessment Work Regulation, will no longer be in effect for assessment work which has received a 45 Day Notice. Allowable changes to your credit distribution can be made by contacting the Geoscience Assessment Office within this 45 Day period, otherwise assessment credit will be cut back and distributed as outlined in Section #6 of the Declaration of Assessment work form.

Please note any revisions must be submitted in DUPLICATE to the Geoscience Assessment Office, by the response date on the summary.

If you have any questions regarding this correspondence, please contact Lucille Jerome by e-mail at lucille.jerome@ndm.gov.on.ca or by telephone at (705) 670-5858.

Yours sincerely,



ORIGINAL SIGNED BY
Blair Kite
Supervisor, Geoscience Assessment Office
Mining Lands Section

Work Report Assessment Results

Submission Number: 2.19060

Date Correspondence Sent: April 16, 1999

Assessor: Lucille Jerome

Transaction Number	First Claim Number	Township(s) / Area(s)	Status	Approval Date
W9870.00599	1212109	STRATHY	Approval After Notice	April 15, 1999

Section:

10 Physical PSTRIP
10 Physical PTRNCH

The revisions outlined in the Notice dated March 11, 1999, have been corrected. Accordingly, assessment work credit has been approved as outlined on the Declaration of Assessment Work Form accompanying this submission.

Correspondence to:

Resident Geologist
Kirkland Lake, ON

Recorded Holder(s) and/or Agent(s):

CLIFFORD GEORGE GUPPY
TEMAGAMI, Ontario

Assessment Files Library
Sudbury, ON
