

2.21957

PROSPECTOR REPORT
on the
KING CLAIM 1076672

STRATHY TOWNSHIP
SUDBURY MINING DIVISION
DISTRICT OF NIPISSING

August 11, 2001

Douglas King
254 Eighth Ave.
Kitchener, Ontario
N2C 1S7

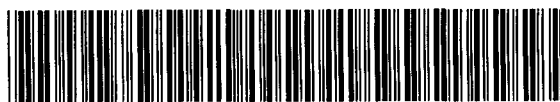
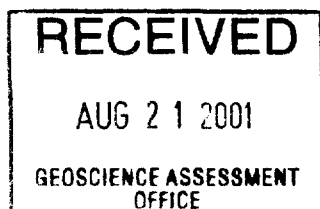

31M04NW2016 2.21957 STRATHY

010

TABLE OF CONTENTS

INTRODUCTION. 3

GENERAL GEOLOGY 4

PRESENTATION OF FIELD OBSERVATIONS. 5

CERTIFICATE

ASSAYER'S CERTIFICATE **S.**

FIGURES

1. REGIONAL LOCATION 1

2. CLAIM LOCATION 2

3. SKETCH MAP: GEOLOGY, TRAVERSES, SAMPLE LOCATIONS
(Back Pocket)



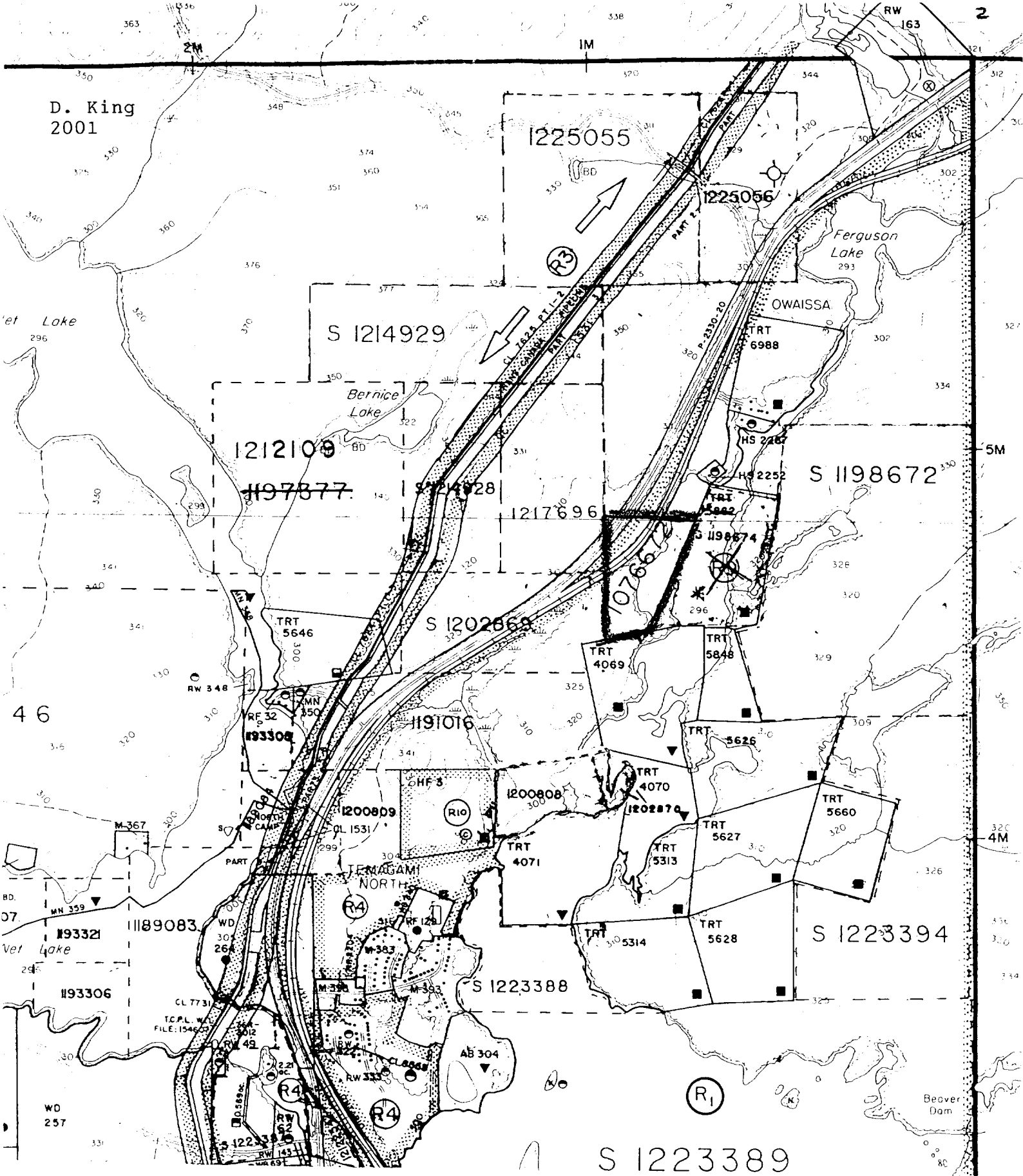

Figure 2 Claim location STRATHY TOWNSHIP
 Taken from Claim Map Plan G-3451 (claim 1076672)

D. King
2001

INTRODUCTION

Claim 1076672 is a one-unit unpatented mining claim located north of my former claim 1202869 in the north-eastern part of Strathy township on the western part of Net Lake and west shore to No. 11 Highway (see Regional and Claim Map locations, illustrations Figures 1 and 2).

Ownership of claim: Douglas King, 254 Eighth Ave., Kitchener, Ontario, N2C 1S7.

D. King
2001

GENERAL GEOLOGY

The O.G.S. Report 165, titled Geology of North Eastern Temagami Area, by G. Bennett, 1978, indicates on the geological map 2323, that Chambers and Strathy townships are part of the Strathy-Chambers batholith.

PRESENTATION OF FIELD OBSERVATIONS

The field data are presented on a map at a horizontal scale of 2 cm to 25 m, Figure 3, back pocket.

The dates compiling, prospecting, traversing, sampling and working are as follows:

2001

July 29 and 31: Traverse to the mineralized areas previously prospected (July 21-22, 1999 Report) stripping small areas and collecting samples for assay.

Continue prospecting surrounding area in search of outcrops.

Field survey conducted by D. King.

Respectfully submitted,

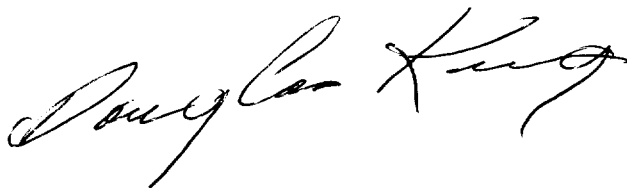
A handwritten signature in cursive script that reads "Douglas King". The signature is written in black ink and is positioned below the typed name.

Douglas King

Bona Fide Prospector

August 11, 2001

Quality Analysis...



Innovative Technologies

2.21957

Invoice No.: 22540
Work Order: 22826
Invoice Date: 05-SEP-01
Date Submitted: 08-AUG-01
Your Reference: NONE
Account Number: 2869
GST # R121979355

DOUGLAS KING
254 8TH AVENUE
KITCHENER, ONTARIO
N2C 1S7

No. samples	Description	Unit Price	Total
2	RX2	\$ 6.50	\$ 13.00
2	1H	\$ 22.00	\$ 44.00
Subtotal			: \$ 57.00

GST (7.0%) : \$ 3.99

AMOUNT DUE : \$ 60.99

Net 30 days 1 1/2 % per month charged on overdue accounts.
THE ABOVE AMOUNT DUE HAS BEEN CHARGED TO VISA. AUTH# 553062

PAID



31M04NW2016 2.21957 STRATHY 020

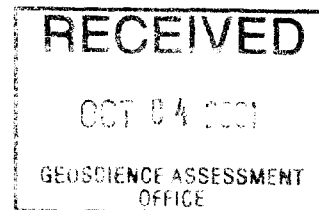

ACTIVATION LABORATORIES LTD.

1336 Sandhill Drive, Ancaster, Ontario Canada L9G 4V5 TELEPHONE +1.905.648.9611 or +1.888.228.5227 FAX +1.905.648.9613

E-MAIL ancaster@actlabs.com ACTLABS GROUP WEBSITE <http://www.actlabs.com>

15198931405

BILL OF LADING NO NOT NEGOTIABLE 1936 797 3575

SENDER FROM / EXPÉDITEUR (CI)
DOUGLAS KING
 STREET ADDRESS / ADRESSE (N° ET RUE)
254 EIGHTH AVE NRC 157
 CITY / VILLE
KITCHENER ONT.

RECEIVER TO / DESTINATAIRE (A)
ACTIVATION LABORATOIRE LTD
 STREET ADDRESS / ADRESSE (N° ET RUE)
1336 SANDHILL DRIVE
 CITY / VILLE
ANCASTER ONT. L9G 4V5
 IMPORTANT TELEPHONE (SERVICE)
(905) 648-9611

SHIP MODE / MODE DE TRANSPORT
 AIRTEL AIRTEL

PKG / EMBAL SERVICE
 PARCEL 9 AM
 LETTER 9h
 MAIL 10:30 AM
 AIR 10 P. 30
 OTHER SAT. HWAY
 AUTRE SAMEDI

PAYMENT / PAIEMENT
 CASH CREDIT
 LOGNOMY CREDIT

THIRD PARTY
 TIERS

SENDER EXPÉDITEUR RECEIVER DESTINATAIRE

SHIPMENT / DÉTAILS / EXPÉDITION
 # Nbre PCS / 14 MAXIMUM
 WEIGHT / POIDS
 22

DECLARED VALUE / VALEUR DÉCLARÉE
 \$

Purolator
 1 888 SHIP-123 www.purolator.com

COURIER INITIALS / INITIALES DU COURRIER
 COURIER ROUTE / ITINÉRAIRE DU COURRIER
 MC / DY / JR
 YR / AN

NO. / N° TYPE / TYPE VISA / MC / AMEX
 EXP. DATE / D'EXP.
551 2100 2477 8524 0502

THIRD PARTY ACCT. NO. / N° DE COMPTE DU TIERS
 CHARGES / FRAIS
28.06
 TOTAL AMOUNT / MONTANT TOTAL

THIRD PARTY BILLING NAME & ADDRESS / FACTURATION À UN TIERS (NOM & ADRESSE)

LIMITATION OF LIABILITY - IMPORTANT - PLEASE READ
 THE AMOUNT OF ANY LOSS OR DAMAGE FOR WHICH THE CARRIER MAY BE LIABLE SHALL NOT EXCEED \$2.00 PER POUND (OR \$4.41 PER KILOGRAM) COMPUTED ON THE TOTAL WEIGHT OF THE SHIPMENT UNLESS A HIGHER VALUE IS DECLARED ON THE FACE OF THE BILL OF LADING BY THE CONSIGNOR (SENDER). MAXIMUM DECLARED VALUE SHALL NOT EXCEED \$5,000. N.B. NOTE CAREFULLY AND EXCLUSIONS OF CARRIER'S LIABILITY, WHICH ARE HEREBY ACCEPTED.

PLEASE REFER TO BILL OF LADING NUMBER FOR SHIPMENT STATUS / INQUIRIES POUR TOUT RENSEIGNEMENT, VEUILLEZ NOUS COMMUNIQUER LE NUMERO DE CONNAISSEMENT.

SENDER RETAIN THIS COPY / COPIE DE L'EXPÉDITEUR

SENDER RETAIN THIS COPY / COPIE DE L'EXPÉDITEUR

PICK UP / CUELLETTE - N DE CONF

SENDER SIGNATURE / SIGNATURE DE L'EXPÉDITEUR
Douglas King

Activation Laboratories Ltd. Work Order No. 22826 Report No. 22540B

'Near Total' Digestion Analysis

SAMPLE	Ag	Cd	Cu	Mn	Mo	Ni	Pb	Zn	Al	Be	Bi	Ca	K	Mg	P	Sr	Ti	V	Y	S
	ppm	ppm	ppm	ppm	ppm	ppm	ppm	ppm	%	ppm	ppm	%	%	%	%	ppm	%	ppm	ppm	%
S-72-4	-0.3	-0.3	30	1283	-1	41	79	149	6.04	2	-2	4.11	1.19	2.98	0.316	1519	1.62	246	41	0.254
S-72-5	7.1	-0.3	6524	1681	-1	1105	20	156	7.03	1	-2	5.88	0.43	3.79	0.079	224	0.39	153	11	0.794
S-72-5 (PULP DUP)	6.7	-0.3	6418	1668	1	1071	44	147	7.30	1	-2	6.01	0.46	3.78	0.075	219	0.41	152	12	0.826
G-2 cert	0.04	<u>0.016</u>	11	<u>232</u>	(1.1	(5	<u>30</u>	<u>86</u>	<u>8.147</u>	2.5	<u>0.037</u>	<u>1.401</u>	<u>3.718</u>	<u>0.452</u>	<u>0.061</u>	<u>478</u>	<u>0.288</u>	<u>36</u>	<u>11</u>	(0.01
G-2	-0.3	-0.3	17	232	1	1	37	78	4.47	3	-2	1.17	3.60	0.32	0.046	298	0.28	32	5	0.023
SDC-1 cert	0.041	(.08	<u>30</u>	<u>883</u>	(.25	<u>38</u>	<u>25</u>	<u>103</u>	<u>8.338</u>	<u>3.0</u>	<u>0.26</u>	<u>1.001</u>	<u>2.722</u>	<u>1.019</u>	<u>0.069</u>	<u>183</u>	<u>0.606</u>	<u>102</u>	<u>40</u>	<u>0.065</u>
SDC-1	-0.3	-0.3	48	820	-1	35	28	100	4.94	3	-2	0.83	2.59	0.84	0.060	155	0.60	92	17	0.076
DNC-1 cert	(.027	(.182	<u>96</u>	<u>1154</u>	(.7	<u>247</u>	<u>6.3</u>	<u>66</u>	<u>9.687</u>	1	(.02	<u>8.055</u>	<u>0.19</u>	<u>6.06</u>	<u>0.037</u>	<u>145</u>	<u>0.287</u>	<u>148</u>	<u>18</u>	(0.039
DNC-1	-0.3	-0.3	106	1107	-1	272	-3	51	8.87	-1	-2	8.66	0.15	5.06	0.029	150	0.31	145	14	0.080
SCO-1 cert	<u>0.134</u>	<u>0.14</u>	<u>28.7</u>	<u>410</u>	<u>1.37</u>	<u>27</u>	<u>31</u>	<u>103</u>	<u>7.24</u>	<u>1.84</u>	<u>0.37</u>	<u>1.87</u>	<u>2.30</u>	<u>1.64</u>	<u>0.090</u>	<u>174</u>	<u>0.38</u>	<u>131</u>	<u>26</u>	<u>0.063</u>
SCO-1	0.3	-0.3	34	370	-1	24	39	109	6.61	2	-2	1.82	2.24	1.66	0.085	157	0.32	120	17	0.068
GXR-6 cert	1.3	(1	<u>66</u>	<u>1008</u>	2.4	27	<u>101</u>	<u>118</u>	<u>17.68</u>	1.4	(.29	<u>0.179</u>	<u>1.87</u>	<u>0.61</u>	<u>0.035</u>	<u>35</u>	<u>0.498</u>	<u>186</u>	<u>14</u>	<u>0.016</u>
GXR-6	0.5	-0.3	70	967	-1	24	109	120	6.64	1	-2	0.11	1.46	0.29	0.061	22	0.49	183	2	0.022
GXR-2 cert	17	4.1	<u>76</u>	<u>1008</u>	(2.1	<u>21</u>	<u>690</u>	<u>530</u>	<u>16.46</u>	1.7	(.69	<u>0.929</u>	<u>1.37</u>	<u>0.85</u>	<u>0.105</u>	<u>160</u>	<u>0.3</u>	<u>52</u>	<u>17</u>	<u>0.031</u>
GXR-2	15.9	2.0	81	947	-1	17	677	353	5.70	2	-2	0.81	1.18	0.68	0.061	130	0.26	47	7	0.029
GXR-1 cert	31	3.3	<u>1110</u>	<u>853</u>	18	<u>41</u>	<u>730</u>	<u>760</u>	<u>3.52</u>	1.22	<u>1380</u>	<u>0.958</u>	<u>0.05</u>	<u>0.22</u>	<u>0.065</u>	<u>275</u>	<u>0.036</u>	<u>80</u>	<u>32</u>	<u>0.257</u>
GXR-1	32.6	0.9	1165	978	14	40	755	479	1.61	1	1161	0.92	0.06	0.23	0.067	317	0.02	79	28	0.253
GXR-4 cert	4	(.86	<u>6520</u>	<u>155</u>	<u>310</u>	<u>42</u>	<u>52</u>	<u>73</u>	<u>7.20</u>	1.9	<u>19</u>	<u>1.01</u>	<u>4.01</u>	<u>1.66</u>	<u>0.120</u>	<u>221</u>	<u>0.29</u>	<u>87</u>	<u>14</u>	<u>1.770</u>
GXR-4	3.5	-0.3	5900	141	305	36	64	81	12.16	3	22	1.22	5.07	2.72	0.147	339	0.24	78	24	1.697

Note: Certificate data underlined are recommended values; other values are proposed except those preceded by a "(" which are information values.

Barite, gahnite, chromite, cassiterite, zircon, sphene, and magnetite may not be totally dissolved.

Clients are advised to obtain assays for Ag>100 ppm and Pb>5000 ppm due to potential solubility problems.

Values for Cu, Ni, Zn, Mo greater than 1% should be assayed if accuracy better than +/-10-15% is required.

Values above 1% are for informational purposes only and should not be relied upon for promotional or ore reserve calculations. Assays are recommended for this purpose.

Sulphur will precipitate in samples containing massive sulphides.

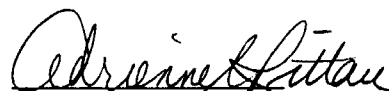

Adrienne I. Rittau, B.Sc., C.Chem
ICP Technical Manager

Negative values indicate less than the reporting limit

99999 indicates greater than 10%

Activation Laboratories Ltd. Work Order: 22826 Report: 22540

Sample ID	Au ppb	Ag ppm	As ppm	Ba ppm	Br ppm	Ca %	Co ppm	Cr ppm	Cs ppm	Fe %	Hf ppm	Hg ppm	Ir ppb	Mo ppm	Na %	Ni ppm	Rb ppm	Sb ppm	Sc ppm	Se ppm	Sn %	Sr %	Ta ppm	Th ppm	U ppm	W ppm	Zn ppm	La ppm	Ce ppm
S-72-4	-2	-5	4.8	2600	-0.5	4	56	32	1	13	6	-1	-5	-1	2.09	45	73	0.6	29.5	-3	-0.02	-0.05	1.6	3.7	-0.5	-1	183	38.3	74
S-72-5	37	-5	32	330	-0.5	7	96	183	3	11.8	1	-1	-5	-1	1.79	1090	30	1.2	30.9	-3	-0.02	-0.05	-0.5	-0.2	-0.5	11	240	7.5	16
S-72-5 (PULP DUP)	33	-5	30.2	350	-0.5	7	99	183	2	11.7	-1	-1	-5	-1	1.81	1130	33	1.6	30.7	-3	-0.02	-0.05	-0.5	-0.2	-0.5	10	218	7.4	15
DMMAS-18-1708	685	-5	2130	390	2.6	7	66	145	2	8.66	2	-1	-5	-2	0.75	142	58	12.1	21.7	-3	-0.03	-0.05	0.8	1.1	-0.5	20	265	12.8	25
Accepted Value-DMMAS-18B	544+-72		2020+-224	435+-150	2.5+-1.5	7+-2	58+-15	151+-20		8.05+-0.85	2+-1				0.74+-0.48	38+-10	12+-3	20.5+-3.4						1.5+-0.5	19+-2	250+-50	12.2+-1.3	23+-3	

Activation Laboratories Ltd. Work Order: 22826 Report: 22540

Sample ID	Nd ppm	Sm ppm	Eu ppm	Tb ppm	Yb ppm	Lu ppm	Mass g
S-72-4	34	9.2	3	1.3	5	0.75	30.98
S-72-5	7	2	0.9	-0.5	1.9	0.28	28.6
S-72-5 (PULP DUP)	6	2	0.9	0.5	1.9	0.29	27.21
DMMAS-18-1708	11	4.1	1.3	-0.5	3.8	0.56	25.84
Accepted Value-DMMAS-18B	11±3	4.1±0.5	1.2±0.2	0.8±0.35	3.6±0.6	0.54±0.05	



Ontario

INVOICE

2.21957

Invoice Date : 09/05/2001

GL Job No. : 01-0215

Invoice # : 22127

Submission Date : 08/01/2001

P.O./Project # : n/a

NTR Code : 9212 FL05

Issued To : Mr. D King Consultant 254 8th Avenue Kitchener, ON N2C 1S7	Data To : Mr. D King Consultant 254 8th Avenue Kitchener, ON N2C 1S7
Phone : 519-893-1405 Fax : - E-Mail :	Phone : 519-893-1405 Fax : - E-Mail :

Qty	Method Code	Description	Unit Price	Extended Price
1	GFA	Gravimetric Fire Assay	20.00	20.00
1	IM100B	ICP_MS Total Digestion	0.00	0.00
1	OT4	OT4 OPEN BEAKER DIGEST	0.00	0.00
1	SPG	Geo Sample Prep	0.00	0.00
Sub Total				20.00
GST				1.40
Total Due				21.40

Please make cheque payable to :/Paiements a l'orde du : The Minister Of Finance / Ministre Des Finance
 Ministry of Northern Development and Mines
 Accounting Services
 Suite 701, 159 Cedar St.
 Sudbury, ON, Canada
 P3E 6A5 GST License # : R124668666

SERVICE CHARGE OF \$35.00 WILL APPLY TO ALL RETURNED CHEQUE
DES FRAIS DE \$35.00 SERONT IMPOSES POUR TOUT CHEQUES SANS PROVISIO
 Please direct any inquiries to Tel. # 705-670-5637, quoting GL Job numbe
 Geoscience Laboratories
 933 Ramsey Lake Road, Bldg A4
 Sudbury, On P3E 6B5
 Phone : (705)670-5637
 Fax : (705)670-3047

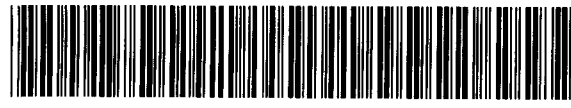
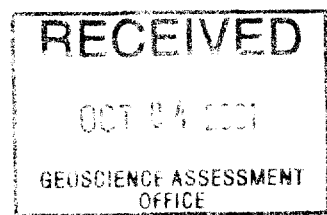

31M04NW2016 2.21957 STRATHY 030

Bank of Montreal  Banque de Montréal

HIWAY CENTRE
1375 WEBER ST. EAST
KITCHENER, ONTARIO, CANADA N2A 3A7

167195

CTI

Canadian Dollar Money Order - not exceeding **\$2,500 Cdn.**
Mandat en dollars Canadiens - n'excedant pas

Date SEPT 10 / 01

Canadian Dollars Canadiens

Name of payee
Nom du Beneficiaire MINISTER OF FINANCE

\$ 2140
CAD



/100 Canadian Dollars Canadiens

DOUGLAS KING
254 EIGHTH AVE. KITCHENER
ONT. N2C 1S7

Upon presentation of the Money Order, the number printed hereon and correct, endorsed the amount will be paid by Bank of Montreal. Should the order be lost, stolen or destroyed a refund will be made to the purchaser against presentation of this copy and all receipts acceptable to the Bank.
La presentation du Mandat conferera au porteur le montant inscrit sur le Mandat et endorsement sera paye par la Banque de Montreal. Dans l'event d'une perte, vol ou destruction, un remboursement sera fait au porteur contre presentation de cette copie et de tous documents acceptables par la Banque.

011671955

GEO SCIENCE LABORATORIES
CERTIFICATE OF ANALYSIS



CLIENT : King
GL JOB # : 01-0215
DATE : 08/13/2001
METHOD CODE : GFA



Client ID	Ag	Au
Units	oz/ton	oz/ton
Detection Limit	0.10	0.010

S-3	N.D.	N.D.
<i>S-72-3</i>		

GEOSCIENCE LABORATORIES CERTIFICATE OF ANALYSIS

CLIENT : King
GL JOB # : 01-0215
DATE : 08/17/2001
METHOD CODE : IM100A

CLIENT ID	Ag	Au	Ti	Li	Be	Mg	Al	Ca	Sc	V	Cr	Mn	Fe	Co
Units	ppm	ppm	ppm	ppm	ppm	ppm	ppm	ppm	ppm	ppm	ppm	ppm	ppm	ppm
Detection Limit	0.5	0.05	10	1	2	20	100	100	0.5	1	1	0.1	5	1
S-3 S-72-3	N.M.	N.M.13000.00	81.01		N.D.	36920.40	66847.50	33542.00	25.81	281.74	31.86	1186.50	126532.00	51.43

GEOSCIENCE LABORATORIES CERTIFICATE OF ANALYSIS

CLIENT : King
 GL JOB # : 01-0215
 DATE : 08/17/2001
 METHOD CODE : IM100B

CLIENT ID	Rb	Sr	Y	Zr	Nb	Cs	La	Ce	Pr	Nd	Sm	Eu	Gd	Tb
Units	ppm	ppm	ppm	ppm	ppm	ppm	ppm	ppm	ppm	ppm	ppm	ppm	ppm	ppm
Detection Limit	1	2	0.05	1	0.02	0.1	0.2	0.2	0.2	0.5	0.5	0.2	0.3	0.5
S-3	79.42	176.76	37.61	170.81	14.43	1.51	27.36	60.97	8.68	37.66	7.50	2.57	7.27	1.15
<i>S-72-3</i>														

GEOSCIENCE LABORATORIES CERTIFICATE OF ANALYSIS

CLIENT : King
GL JOB # : 01-0215
DATE : 08/17/2001
METHOD CODE : IM100A

CLIENT ID	Ni	Cu	Zn	Ga	Mo	Cd	Sn	Sb	Ba	W	Hg	Tl	Pb
Units	ppm	ppm	ppm	ppm	ppm	ppm	ppm	ppm	ppm	ppm	ppm	ppm	ppm
Detection Limit	5	2	5	1	1	1	0.1	0.5	5	0.05	n/a	0.3	0.1
S-3 <i>S-72-3</i>	51.92	17.17	151.74	21.26	5.84	N.D.	1.42	N.D.	3359.56	1.85	N.M.	0.33	3.20

GEOSCIENCE LABORATORIES CERTIFICATE OF ANALYSIS

CLIENT : King
GL JOB # : 01-0215
DATE : 08/17/2001
METHOD CODE : IM100B

CLIENT ID	Dy	Ho	Er	Tm	Yb	Lu	Hf	Ta	Th	U
Units	ppm	ppm	ppm	ppm	ppm	ppm	ppm	ppm	ppm	ppm
Detection Limit	0.3	0.2	0.05	0.3	0.5	0.01	0.01	0.5	0.5	0.03

S-3 <i>S-72-3</i>	5.94	1.29	3.38	0.44	2.76	0.43	4.59	0.85	1.52	0.40
----------------------	------	------	------	------	------	------	------	------	------	------

Date: 2001-OCT-05

GEOSCIENCE ASSESSMENT OFFICE
933 RAMSEY LAKE ROAD, 6th FLOOR
SUDBURY, ONTARIO
P3E 6B5

DOUGLAS F KING
254 8TH AVENUE
KITCHENER, ONTARIO
N2C 1S7 CANADA

Tel: (888) 415-9845
Fax: (877) 670-1555

Submission Number: 2.21957
Transaction Number(s): W0170.30611

Dear Sir or Madam

Subject: Approval of Assessment Work

We have approved your Assessment Work Submission with the above noted Transaction Number(s). The attached Work Report Summary indicates the results of the approval.

At the discretion of the Ministry, the assessment work performed on the mining lands noted in this work report may be subject to inspection and/or investigation at any time.

If you have any question regarding this correspondence, please contact JIM MCAULEY by email at james.mcauley@ndm.gov.on.ca or by phone at (705) 670-5855.

Yours Sincerely,



Ron Gashinski
Supervisor, Geoscience Assessment Office

Cc: Resident Geologist

Douglas F King
(Claim Holder)

Assessment File Library

Douglas F King
(Assessment Office)

**2.21957
PROSP. ASSAY.**

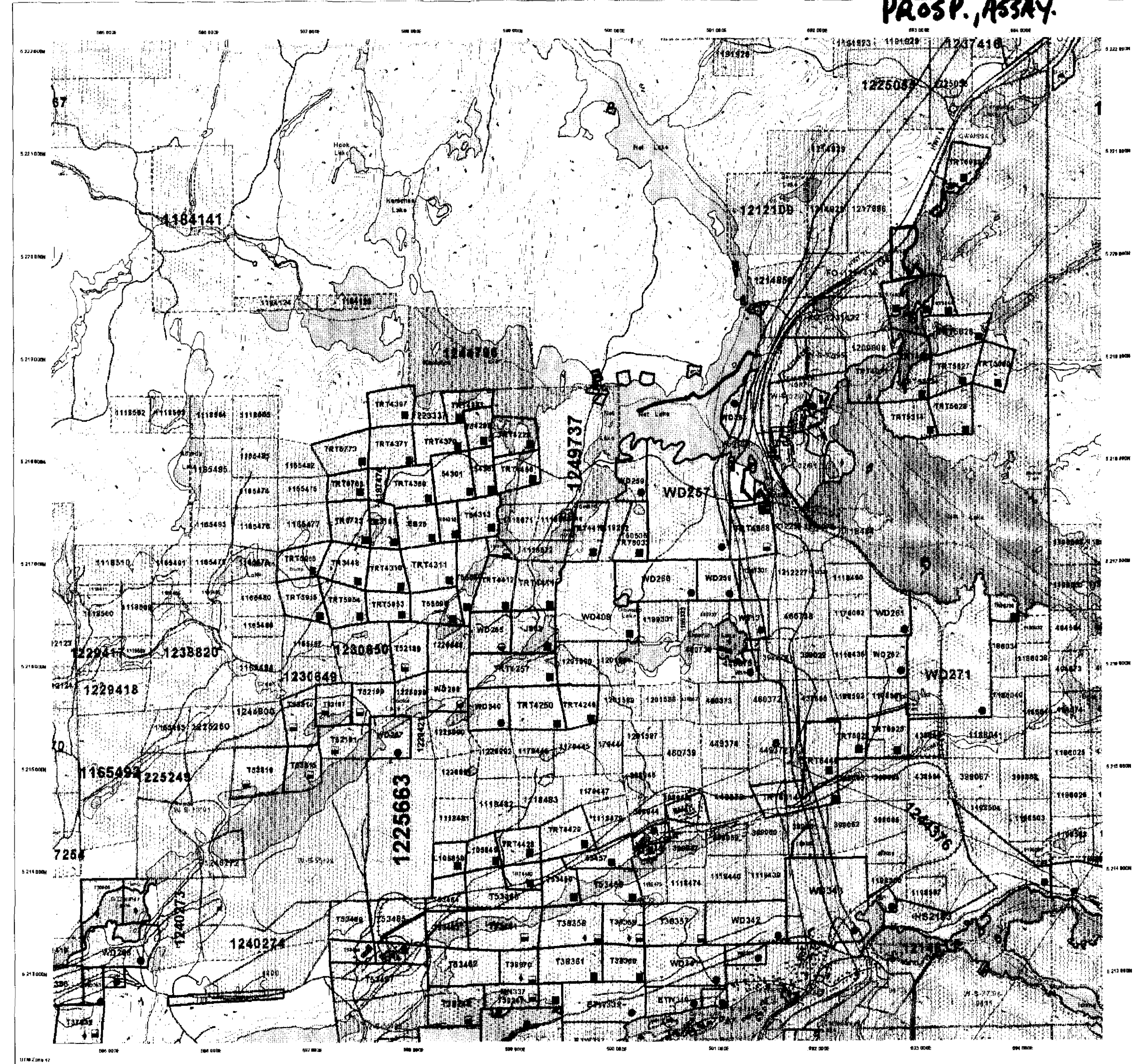

**Mining Land Tenure
Map**

Date / Time of Issue: Jul 6 2001 15:12h Eastern
TOWNSHIP / AREA: PLAN
STRATHY: G-3451

ADMINISTRATIVE DISTRICTS / DIVISIONS
Mining Division: Sudbury
Land Titles/Registry Division: NIPISSING
Ministry of Natural Resources District: NORTH BAY

TOPOGRAPHIC

- Administrative Boundaries
- Topography
- Conservation Line
- Provincial Park
- Local Planning
- City/Township
- Control
- Control - Approval Application
- Street
- Mini Highways
- Railway
- Foot
- Trail
- Railroad Crossings
- Hydro Lines
- Communication Lines
- Wooded Area
- Manure/Water/Other Hazardous Materials

LAND TENURE

- Feehold Patent
- Surface and Mining Rights
- Exchange Rights Only
- Mining Rights Only
- Leasehold Patent
- Surface and Mining Rights
- Exchange Rights Only
- Mining Rights Only
- Licence of Occupancy
- Freehold Surface
- Surface and Mining Rights
- Surface Rights Only
- Mining Rights Only
- Leasehold Patent
- Surface and Mining Rights
- Mining Rights Only
- Leasehold Patent
- Surface and Mining Rights
- Mining Rights Only

LAND TENURE WITHDRAWALS

- Along Withdrawal From Disposition
- Mining Act Withdrawal
- Surface Rights Only
- Mining Rights Only
- Other in Crown Withdrawal System
- Surface and Mining Rights
- Mining Rights Only
- Other in Crown Withdrawal System
- Surface and Mining Rights
- Mining Rights Only
- Other in Crown Withdrawal System

IMPORTANT NOTICES

LAND TENURE WITHDRAWAL DESCRIPTIONS

Year	Type	Date	Description
0974	When	Jul 1 2001	"TEMAGANI TOWNSHIP"
2076	When	Jun 1 2001	"TEMAGANI TOWNSHIP"
6770	When	Jul 1 2001	30 JUN 2001 10:00 AM 2022# SKO. 1004
6780	When	Jul 1 2001	ISLAND 27 BELONGS WITH STRATHCONA TWP
6800	When	Jul 1 2001	PENDING DISPOSITION UNDER THE PUBLIC LANDS ACT LAND NOT OPER FOR STAKING
9400	When	Jun 1 2001	REQ. SECTION 30(5) OF THE MINING ACT R.O. 1980 NOTICE RECEIVED 97-JAN-04
9412	When	Jun 1 2001	Provisional Disposition Under Public Lands Act
9417	When	Jun 1 2001	PLEASE NOTE THE ISLANDS ON LAKE TEMAGANIC ARE WITHDRAWN
9418	When	Jun 1 2001	AND WILL NOT BE OPEN TO PROSPECTING AND STAKING OUT
9420	When	Jun 1 2001	NOT OPEN FOR STAKING - CONSERVATION
9421	When	Jun 1 2001	RESERVE SECTION OF THE MINING ACT
9422	When	Jun 1 2001	NOT OPEN FOR STAKING - CONSERVATION
9423	When	Jun 1 2001	RESERVE SECTION OF THE MINING ACT
9424	When	Jun 1 2001	PENDING DISPOSITION NOT OPEN FOR STAKING
9425	When	Jun 1 2001	PENDING DISPOSITION UNDER PUBLIC LANDS
9426	When	Jun 1 2001	PLEASE NOTE THE ISLANDS ON LAKE TEMAGANIC ARE WITHDRAWN
9427	When	Jun 1 2001	AND WILL NOT BE OPEN TO PROSPECTING AND STAKING OUT
9428	When	Jun 1 2001	NOT OPEN FOR STAKING - CONSERVATION
9429	When	Jun 1 2001	RESERVE SECTION OF THE MINING ACT
9430	When	Jun 1 2001	NOT OPEN FOR STAKING - CONSERVATION
9431	When	Jun 1 2001	RESERVE SECTION OF THE MINING ACT
9432	When	Jun 1 2001	PENDING DISPOSITION NOT OPEN FOR STAKING
9433	When	Jun 1 2001	PENDING DISPOSITION UNDER PUBLIC LANDS
9434	When	Jun 1 2001	PLEASE NOTE THE ISLANDS ON LAKE TEMAGANIC ARE WITHDRAWN
9435	When	Jun 1 2001	AND WILL NOT BE OPEN TO PROSPECTING AND STAKING OUT
9436	When	Jun 1 2001	NOT OPEN FOR STAKING - CONSERVATION
9437	When	Jun 1 2001	RESERVE SECTION OF THE MINING ACT
9438	When	Jun 1 2001	NOT OPEN FOR STAKING - CONSERVATION
9439	When	Jun 1 2001	RESERVE SECTION OF THE MINING ACT
9440	When	Jun 1 2001	PENDING DISPOSITION NOT OPEN FOR STAKING
9441	When	Jun 1 2001	PENDING DISPOSITION UNDER PUBLIC LANDS
9442	When	Jun 1 2001	PLEASE NOTE THE ISLANDS ON LAKE TEMAGANIC ARE WITHDRAWN
9443	When	Jun 1 2001	AND WILL NOT BE OPEN TO PROSPECTING AND STAKING OUT
9444	When	Jun 1 2001	NOT OPEN FOR STAKING - CONSERVATION
9445	When	Jun 1 2001	RESERVE SECTION OF THE MINING ACT
9446	When	Jun 1 2001	NOT OPEN FOR STAKING - CONSERVATION
9447	When	Jun 1 2001	RESERVE SECTION OF THE MINING ACT
9448	When	Jun 1 2001	PENDING DISPOSITION NOT OPEN FOR STAKING
9449	When	Jun 1 2001	PENDING DISPOSITION UNDER PUBLIC LANDS
9450	When	Jun 1 2001	PLEASE NOTE THE ISLANDS ON LAKE TEMAGANIC ARE WITHDRAWN
9451	When	Jun 1 2001	AND WILL NOT BE OPEN TO PROSPECTING AND STAKING OUT
9452	When	Jun 1 2001	NOT OPEN FOR STAKING - CONSERVATION
9453	When	Jun 1 2001	RESERVE SECTION OF THE MINING ACT
9454	When	Jun 1 2001	NOT OPEN FOR STAKING - CONSERVATION
9455	When	Jun 1 2001	RESERVE SECTION OF THE MINING ACT
9456	When	Jun 1 2001	PENDING DISPOSITION NOT OPEN FOR STAKING
9457	When	Jun 1 2001	PENDING DISPOSITION UNDER PUBLIC LANDS
9458	When	Jun 1 2001	PLEASE NOTE THE ISLANDS ON LAKE TEMAGANIC ARE WITHDRAWN
9459	When	Jun 1 2001	AND WILL NOT BE OPEN TO PROSPECTING AND STAKING OUT
9460	When	Jun 1 2001	NOT OPEN FOR STAKING - CONSERVATION
9461	When	Jun 1 2001	RESERVE SECTION OF THE MINING ACT
9462	When	Jun 1 2001	NOT OPEN FOR STAKING - CONSERVATION
9463	When	Jun 1 2001	RESERVE SECTION OF THE MINING ACT
9464	When	Jun 1 2001	PENDING DISPOSITION NOT OPEN FOR STAKING
9465	When	Jun 1 2001	PENDING DISPOSITION UNDER PUBLIC LANDS
9466	When	Jun 1 2001	PLEASE NOTE THE ISLANDS ON LAKE TEMAGANIC ARE WITHDRAWN
9467	When	Jun 1 2001	AND WILL NOT BE OPEN TO PROSPECTING AND STAKING OUT
9468	When	Jun 1 2001	NOT OPEN FOR STAKING - CONSERVATION
9469	When	Jun 1 2001	RESERVE SECTION OF THE MINING ACT
9470	When	Jun 1 2001	NOT OPEN FOR STAKING - CONSERVATION
9471	When	Jun 1 2001	RESERVE SECTION OF THE MINING ACT
9472	When	Jun 1 2001	PENDING DISPOSITION NOT OPEN FOR STAKING
9473	When	Jun 1 2001	PENDING DISPOSITION UNDER PUBLIC LANDS
9474	When	Jun 1 2001	PLEASE NOTE THE ISLANDS ON LAKE TEMAGANIC ARE WITHDRAWN
9475	When	Jun 1 2001	AND WILL NOT BE OPEN TO PROSPECTING AND STAKING OUT
9476	When	Jun 1 2001	NOT OPEN FOR STAKING - CONSERVATION
9477	When	Jun 1 2001	RESERVE SECTION OF THE MINING ACT
9478	When	Jun 1 2001	NOT OPEN FOR STAKING - CONSERVATION
9479	When	Jun 1 2001	RESERVE SECTION OF THE MINING ACT
9480	When	Jun 1 2001	PENDING DISPOSITION NOT OPEN FOR STAKING
9481	When	Jun 1 2001	PENDING DISPOSITION UNDER PUBLIC LANDS
9482	When	Jun 1 2001	PLEASE NOTE THE ISLANDS ON LAKE TEMAGANIC ARE WITHDRAWN
9483	When	Jun 1 2001	AND WILL NOT BE OPEN TO PROSPECTING AND STAKING OUT
9484	When	Jun 1 2001	NOT OPEN FOR STAKING - CONSERVATION
9485	When	Jun 1 2001	RESERVE SECTION OF THE MINING ACT
9486	When	Jun 1 2001	NOT OPEN FOR STAKING - CONSERVATION
9487	When	Jun 1 2001	RESERVE SECTION OF THE MINING ACT
9488	When	Jun 1 2001	PENDING DISPOSITION NOT OPEN FOR STAKING
9489	When	Jun 1 2001	PENDING DISPOSITION UNDER PUBLIC LANDS
9490	When	Jun 1 2001	PLEASE NOTE THE ISLANDS ON LAKE TEMAGANIC ARE WITHDRAWN
9491	When	Jun 1 2001	AND WILL NOT BE OPEN TO PROSPECTING AND STAKING OUT
9492	When	Jun 1 2001	NOT OPEN FOR STAKING - CONSERVATION
9493	When	Jun 1 2001	RESERVE SECTION OF THE MINING ACT
9494	When	Jun 1 2001	NOT OPEN FOR STAKING - CONSERVATION
9495	When	Jun 1 2001	RESERVE SECTION OF THE MINING ACT
9496	When	Jun 1 2001	PENDING DISPOSITION NOT OPEN FOR STAKING
9497	When	Jun 1 2001	PENDING DISPOSITION UNDER PUBLIC LANDS
9498	When	Jun 1 2001	PLEASE NOTE THE ISLANDS ON LAKE TEMAGANIC ARE WITHDRAWN
9499	When	Jun 1 2001	AND WILL NOT BE OPEN TO PROSPECTING AND STAKING OUT
9500	When	Jun 1 2001	NOT OPEN FOR STAKING - CONSERVATION

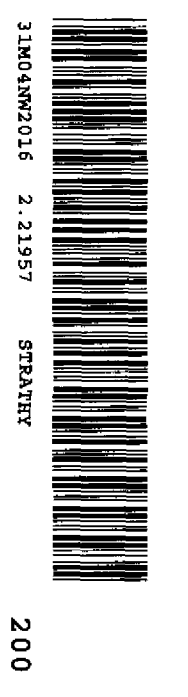

General Information and Limitations

This map was prepared by the Ministry of Natural Resources and Environment of Ontario. It is based on information provided to the Ministry of Natural Resources and Environment of Ontario by the Provincial Mining Recorders' Office. The information shown is derived from digital files available in the Provincial Mining Recorders' Office at the time of its preparation. The Ministry of Natural Resources and Environment of Ontario does not assume any responsibility for the accuracy or completeness of the information shown on this map. The Ministry of Natural Resources and Environment of Ontario is not responsible for the accuracy or completeness of the information shown on this map. The Ministry of Natural Resources and Environment of Ontario is not responsible for the accuracy or completeness of the information shown on this map.

D KING
1999.2001

CLAIM NO. 1076672

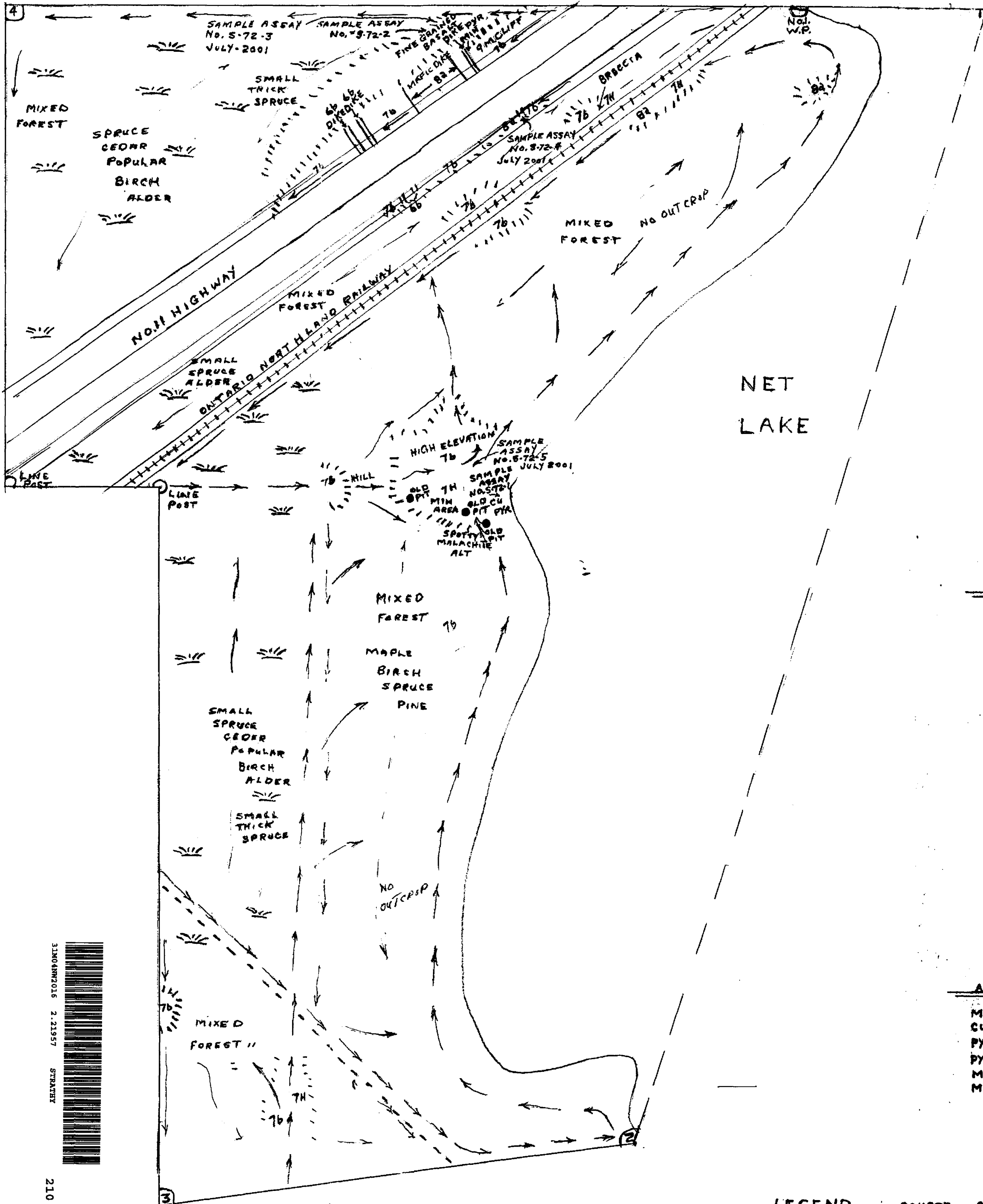
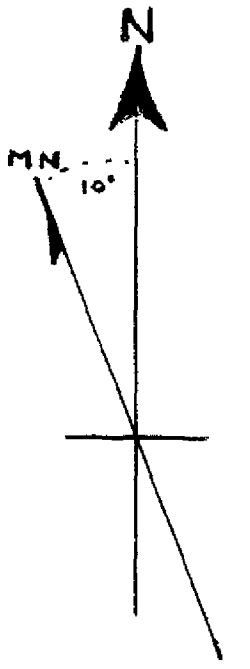

- SYMBOLS**
- TRAILS
 - ROCK OUTCROP
 - TRAVERSES
 - BEEPER MAT INSTRUMENTATION
 - ASSAY SAMPLE NO.
 - PIT
 - TRENCH
 - SMART
 - MUSKOGEE OR SWAMP
- ABBREVIATIONS**
- MO. MOLYBDENITE.
 - CU. COPPER
 - PYR. PYRITE
 - PYRR. PYRRHOTITE
 - MIN. MINERALIZED
 - MA. MAGNETIC ATTRACTION



CLAIM PLAN
STRATHY T.W.P.
DISTRICT OF NIPPISSING
SCALE 2CM = 25 M

- LEGEND** SOURCE - GEOLOGICAL MAP 2323
- 8** MAFIC INTRUSIVE ROCKS
CBOTITE AND HORNBLENDE-RICH LAMPROPHYRE
GRANITIC INTRUSIVE ROCKS
 - 7** QUARTZ MONZONITE
QUARTZ DIORITE, GRANODIORITE (CONTAMINATED PHASES)
 - 6** HYPERBYSSAL FELSIC INTRUSIVE ROCKS
QUARTZ PORPHYRY
QUARTZ FELSPAR PORPHYRY
 - 5** INTERMEDIATE TO ULTRAMAFIC INTRUSIVE ROCKS
 - 1** MAFIC TO INTERMEDIATE META VOLCANICS
MASSIVE TO FOLIATED ANDESITE AND BASALT
PORPHYRITIC ANDESITE AND BASALT
FINE-GRAINED AMPHIBOLITE HORNFELS