



Swastika Laboratories

A Division

Assaying - Co

Established 1928



31M04SE0025 2.15941 SOUTH LORRAINE

010

Geochemical Analysis Certificate

2.15941 4W-2275-RG1

Date: OCT-03-94

Company: **D. L. GODDARD**

Project:

Attn: **D. L. Goddard**

We hereby certify the following Geochemical Analysis of 10 Rock samples submitted SEP-23-94 by :

Sample Number	Au PPB	Au Check PPB	Ag PPM	Cu PPM	Ni PPM	Pd PPB
1 150' N 10W shaft	31	-	1.8	-	-	-
2 Shaft area	21	14	1.5	3740	8680	<5
3 250' to shaft	17	-	10.5	-	-	-
4 Shaft area (hoist)	10	-	1.1	3070	3910	<5
2-4 Shaft area	10	-	1.4	3730	10800	<5
5 unknown	7	-	101.2	30400	192	<5
6 Shaft area no numbe	41	27	15.5	-	-	-
1-O Cooper Lake	Nil	-	0.6	-	-	-
2-O Cooper Lake	16	-	8.1	-	-	-
3-O Cooper Lake	Nil	-	0.2	-	-	-

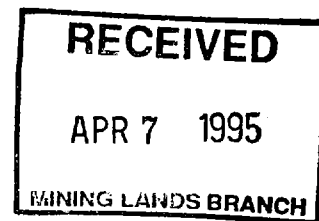

Certified by *Louis Swastika*

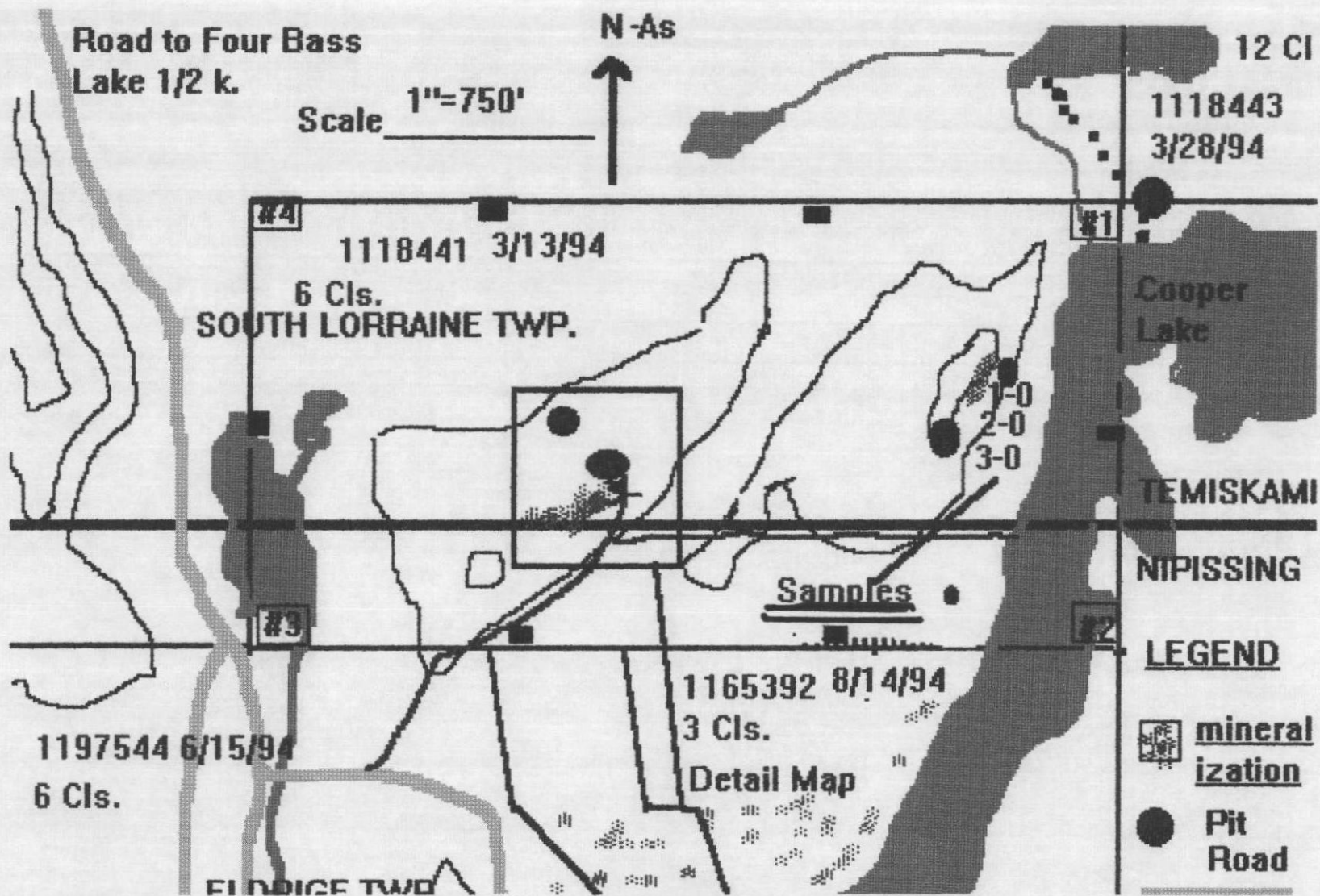

Detail Map Attached



Report of Work Conducted After Recording Claim

Transaction Number

W9580.00181

Ontario

Mining Act

D. L. Goddard - P. 1011

Personal information collected on this form is obtained under the authority of the this collection should be directed to the Provincial Manager, Mining Lands, M Sudbury, Ontario, P3E 8A5, telephone (705) 670-7264.



31M04SE0025 2.15941 SOUTH LORRAINE

900

- Instructions:**
- Please type or print and submit in duplicate.
 - Refer to the Mining Act and Regulations for recorder.
 - A separate copy of this form must be completed for each Work Group.
 - Technical reports and maps must accompany this form in duplicate.
 - A sketch, showing the claims the work is assigned to, must accompany this form.

Recorded Holder(s) D. L. Goddard		Client No. 137227
Address Box 219 Temagami Ont P0H2H0		Telephone No. 705-569-3399
Mining Division Larder Lake	Township/Area South Lorraine	M or G Plan No. M 591
Date Work Performed From: May 5 / 94	To: Oct. 31 / 94	

Work Performed (Check One Work Group Only)

Work Group	Type
<input type="checkbox"/> Geotechnical Survey	
<input type="checkbox"/> Physical Work, including Drilling	
<input type="checkbox"/> Rehabilitation	
<input type="checkbox"/> Other Authorized Work	
<input checked="" type="checkbox"/> Assays	Assays
<input type="checkbox"/> Assignment from Reserve	

RECEIVED

APR 7 1995

MINING LANDS BRANCH

UJY

Total Assessment Work Claimed on the Attached Statement of Costs \$ 206.00

Note: The Minister may reject for assessment work credit all or part of the assessment work submitted if the recorded holder cannot verify expenditures claimed in the statement of costs within 30 days of a request for verification.

Persons and Survey Company Who Performed the Work (Give Name and Address of Author of Report)

Name	Address
Swastika Labs	P.O. Box 10 Swastika Ont P0K1T0

(attach a schedule if necessary)

Certification of Beneficial Interest * See Note No. 1 on reverse side

I certify that at the time the work was performed, the claims covered in this work report were recorded in the current holder's name or held under a beneficial interest by the current recorded holder.	Date	Recorded Holder or Agent (Signature)
	Apr 4 / 95	D. L. Goddard

Certification of Work Report

I certify that I have a personal knowledge of the facts set forth in this Work report, having performed the work or witnessed same during and/or after its completion and annexed report is true.		
Name and Address of Person Certifying D. L. Goddard Box 219 Temagami Ont. P0H2H0		
Telephone No. 705-569-3399	Date Apr. 4 / 95	Certified By (Signature) D. L. Goddard

For Office Use Only

Total Value Cr. Recorded \$ 206.00	Date Recorded Apr. 6 / 95	Mining Recorder <i>[Signature]</i>	Received Stamp MINING DIVISION 95 APR 6 11 15
	Deemed Approval Date July 4 / 95	Date Approved <i>[Signature]</i>	
	Date Notice for Amendments Sent		

Statement of Costs for Assessment Credit
État des coûts aux fins du crédit d'évaluation

Transaction No./N° de transaction
 W 9580.0018

Mining Act/Loi sur les mines

2.15941

Personal information collected on this form is obtained under the authority of the Mining Act. This information will be used to maintain a record and ongoing status of the mining claim(s). Questions about this collection should be directed to the Provincial Manager, Minings Lands, Ministry of Northern Development and Mines, 4th Floor, 159 Cedar Street, Sudbury, Ontario P3E 6A5, telephone (705) 870-7264.

Les renseignements personnels contenus dans la présente formule sont recueillis en vertu de la Loi sur les mines et serviront à tenir à jour un registre des concessions minières. Adresser toute question sur la collecte de ces renseignements au chef provincial des terrains miniers, ministère du Développement du Nord et des Mines, 159, rue Cedar, 4^e étage, Sudbury (Ontario) P3E 6A5, téléphone (705) 870-7264.

1. Direct Costs/Coûts directs

Type	Description	Amount Montant	Totals Total global
Wages Salaires	Labour Main-d'oeuvre		
	Field Supervision Supervision sur le terrain		
Contractor's and Consultant's Fees Droits de l'entrepreneur et de l'expert-conseil	Type		
Supplies Used Fournitures utilisées	Type		
	Assay	172.	
Equipment Rental Location de matériel	Type		
Total Direct Costs Total des coûts directs			172.

2. Indirect Costs/Coûts indirects

** Note: When claiming Rehabilitation work Indirect costs are not allowable as assessment work. Pour le remboursement des travaux de réhabilitation, les coûts indirects ne sont pas admissibles en tant que travaux d'évaluation.

Type	Description	Amount Montant	Totals Total global
Transportation Transport	Type		
	Truck	34.0	
Sub Total of Indirect Costs Total partiel des coûts indirects			34.00
Amount Allowable (not greater than 20% of Direct Costs) Montant admissible (n'excédant pas 20 % des coûts directs)			34.00
Total Value of Assessment Credit (Total of Direct and Allowable Indirect costs) Valeur totale du crédit d'évaluation (Total des coûts directs et indirects admissibles)			206.00

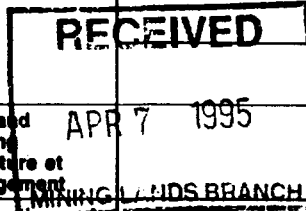

Note: The recorded holder will be required to verify expenditures claimed in this statement of costs within 30 days of a request for verification. If verification is not made, the Minister may reject for assessment work all or part of the assessment work submitted.

Note : Le titulaire enregistré sera tenu de vérifier les dépenses demandées dans le présent état des coûts dans les 30 jours suivant une demande à cet effet. Si la vérification n'est pas effectuée, le ministre peut rejeter tout ou une partie des travaux d'évaluation présentés.

Filing Discounts

1. Work filed within two years of completion is claimed at 100% of the above Total Value of Assessment Credit.
2. Work filed three, four or five years after completion is claimed at 50% of the above Total Value of Assessment Credit. See calculations below:

Total Value of Assessment Credit	Total Assessment Claimed
	× 0.50 =

Remises pour dépôt

1. Les travaux déposés dans les deux ans suivant leur achèvement sont remboursés à 100 % de la valeur totale susmentionnée du crédit d'évaluation.
2. Les travaux déposés trois, quatre ou cinq ans après leur achèvement sont remboursés à 50 % de la valeur totale du crédit d'évaluation susmentionné. Voir les calculs ci-dessous.

Valeur totale du crédit d'évaluation	Évaluation totale demandée
	× 0,50 =

Certification Verifying Statement of Costs

I hereby certify: that the amounts shown are as accurate as possible and these costs were incurred while conducting assessment work on the lands shown on the accompanying Report of Work form.

that as Recorded Holder I am authorized (Recorded Holder, Agent, Position in Company)

to make this certification

Attestation de l'état des coûts

J'atteste par la présente : que les montants indiqués sont le plus exact possible et que ces dépenses ont été engagées pour effectuer les travaux d'évaluation sur les terrains indiqués dans la formule de rapport de travail ci-joint.

Et qu'à titre de _____ je suis autorisé (titulaire enregistré, représentant, poste occupé dans la compagnie)

à faire cette attestation...

Signature [Signature] Date Apr. 6/95

Ministry of
Northern Development
and Mines

Ministère du
Développement du Nord
et des Mines

Geoscience Approvals Office
933 Ramsey Lake Road
6th Floor
Sudbury, Ontario
P3E 6B5

Telephone: (705) 670-5853
Fax: (705) 670-5863

May 05, 1995

Our File: 2.15941
Transaction #: W9580.00181

Mining Recorder
Ministry of Northern Development & Mines
4 Government Road East
Kirkland Lake, Ontario
P2N 1A2

Dear Mr. Spooner:

**Subject: APPROVAL OF ASSESSMENT WORK CREDITS ON MINING CLAIM
1118441 IN SOUTH LORRAINE TOWNSHIP**

Assessment work credits have been approved as outlined on the report of work form. The credits have been approved under Section 17 (Assays) of the Mining Act Regulations.

The approval date is May 04, 1995.

If you have any questions regarding this correspondence, please contact Steven Beneteau at (705) 670-5858.

ORIGINAL SIGNED BY:



Ron C. Gashinski
Senior Manager, Mining Lands Section
Mining and Land Management Branch
Mines and Minerals Division

 SBB/jl
Enclosure:

cc: Resident Geologist
Cobalt, Ontario

✓ Assessment Files Library
Sudbury, Ontario

