

31M04SW0040 2.2680 STRATHCONA

010

RECEIVED
MAY 11 1978
PROJECTS UNIT

REPORT ON MAGNETIC
SURVEY ON CLAIMS
399084 and 399085
(LOWELL LAKE PROPERTY)

Toronto, Ontario.
May 8, 1978

W.Ng-See-Quan
St. Joseph Explorations Ltd.

SUMMARY

This survey did not indicate any significant magnetic anomaly.

INTRODUCTION

The ground magnetometer survey was run on claims 399084 and 399085 as part of the geophysical coverage of the Lowell Lake Property. These two claims were not covered in the earlier magnetometer survey (see Report on Ground Magnetometer Survey - Lowell Lake Property by W.Ng-See-Quan, December 15, 1977).

PROPERTY, DESCRIPTION and LOCATION

These two claims are located in the northwest part of the Lowell Lake Property (see map in pocket).

ACCESS

Access to these two claims is via Hwy. 11 which runs through both claims.

GEOPHYSICAL SURVEY

These two claims were surveyed using a Barringer Proton Magnetometer GM-122 (see appendix I for equipment specifications). The main base station was set at L18N, 8+50W, with additional base stations set up on the western ends of the lines for diurnal corrections. Readings were taken every 25 m.

RESULTS and INTERPRETATION

The results on the survey are presented on Map 1 (in pocket).

The magnetic background is about 59000 γ . This survey ties in with the previous magnetic survey on the property without any significant shift in datum.

Access across property on L16N just east of Hwy. 11 was not permitted by owner resulting in no data being taken at two stations. The other no readings (N.R.) were due to interference of the hydroline that runs parallel to and on the west side of Hwy.11.

This survey did not indicate any significant magnetic anomaly.

CONCLUSIONS and RECOMMENDATIONS

No further work is warranted on these two claims.

Respectfully submitted,

Wallace Ng-See-Quan

WN*MS

Wallace Ng-See-Quan

BARRINGER RESEARCH LIMITED

GROUND MAGNETOMETER

MODEL GM-122

SPECIFICATIONS

Range: 20,000 to 99,999 in 12 ranges
Accuracy: \pm 1 gamma through operating temperature range
Sensitivity: 1 gamma
Gradient Tolerance: 600 gamma/ft.
Power: 12 "D" cells
Power Consumption: <50 Joules (Wsec) per reading
Polarizing Power: 0.8 A @ 13.5 V for 1.5 sec. (3 second cycle)
0.8 A @ 13.5 V for 3 sec. (6 second cycle)
Number of Readings with 1 Battery Set: 2,000 - 10,000 depending on type of batteries
Frequency of Readings: 1 every 3 seconds
1 every 6 seconds
Controls: Pushbutton switch
Range Selection switch - Slide switch for 3 and 6 sec. located on P/C Board
Output: 5 digit incandescent filament readout
Indicators: LED point
Lock Indicator - last three digits of the display blanked off when phaselock not achieved
Segment Function Indicator - all segments light up to permit visual inspection of the display function

Mechanical:

Instrument: Dimensions: 7" x 3.5" x 11"
(18 cm x 9 cm x 28 cm)
Weight: 8 lbs (3.6 kg) including batteries
Sensor: Omnidirectional noise cancelling toroidal sensing head
Dimensions: 4-7/8" (12 cm) diameter
4-3/8" (11 cm) height
Weight: 3 lbs (1.4 kg)
Ambient Conditions: Operating Temperature Range -
-40°F to 131°F (-40°C to 55°C)
Relative Humidity - 0 to 100%
Environmental: Instrument and sensor case made of high impact plastic



TO BE ATTACHED AS AN APPENDIX TO TECHNICAL REPORT
FACTS SHOWN HERE NEED NOT BE REPEATED IN REPORT
TECHNICAL REPORT MUST CONTAIN INTERPRETATION, CONCLUSIONS ETC.

Type of Survey(s) Ground Magnetometer
Township or Area Strathcona Twp.
Claim Holder(s) St. Joseph Explorations Ltd.
Survey Company St. Joseph Explorations Ltd.
Author of Report W. Ng-See-Quan
Address of Author 90 Eglinton Ave. W., Ste. 505, Toronto, Ontario. M4R 2E4
Covering Dates of Survey Jan. 02 - Feb. 04, 1978
Total Miles of Line Cut 2.5 km

MINING CLAIMS TRAVERSED
List numerically

Table with columns for prefix and number. Contains entries: S 399084, S 399085. Total Claims: 2

SPECIAL PROVISIONS
CREDITS REQUESTED

ENTER 40 days (includes line cutting) for first survey.
ENTER 20 days for each additional survey using same grid.

Table with columns: Geophysical, Geological, Geochemical, DAYS per claim. Includes entries for Electromagnetic (40), Magnetometer (40), Radiometric, Other.

AIRBORNE CREDITS (Special provision credits do not apply to airborne surveys)

Magnetometer Electromagnetic Radiometric
(enter days per claim)

DATE: May 08, 1978 SIGNATURE: Wallace Ng-See-Quan
Author of Report or Agent

Res. Geol. L.D. Qualifications 2.1668

Previous Surveys

Table with columns: File No., Type, Date, Claim Holder. Empty table.

If space insufficient, attach list

GEOPHYSICAL TECHNICAL DATA

GROUND SURVEYS - If more than one survey, specify data for each type of survey

Number of Stations 101 Number of Readings 101
Station interval 25 m. Line spacing 100 m.
Profile scale
Contour interval 1000 y

MAGNETIC

Instrument Barringer Proton Magnetometer GM-122
Accuracy - Scale constant +/- 1 y
Diurnal correction method Main base station and other base station at end of lines
Base Station check-in interval (hours) 1/2 hr.
Base Station location and value Main base station L18N, 8+50W - 59058 y

ELECTROMAGNETIC

Instrument
Coil configuration
Coil separation
Accuracy
Method: [] Fixed transmitter [] Shoot back [] In line [] Parallel line
Frequency (specify V.L.F. station)
Parameters measured

GRAVITY

Instrument
Scale constant
Corrections made
Base station value and location
Elevation accuracy

INDUCED POLARIZATION RESISTIVITY

Instrument
Method [] Time Domain [] Frequency Domain
Parameters - On time Frequency
- Off time Range
- Delay time
- Integration time
Power
Electrode array
Electrode spacing
Type of electrode

NOTES

400' surface rights reservation along the shores of all lakes and rivers.

SAND and GRAVEL

- ① Gravel File 132830
- ② Gravel File 146693

Sand and gravel in this township reserved until further notice.

AREAS WITHDRAWN FROM STAKING

S.R. - SURFACE RIGHTS M.R. - MINING RIGHTS

Section	Order No	Date	Disposition	File
43 (R.S.O. 1970)	W 70/76	13/12/76	S.R.	146693

- Island 25 (Bell Id.) - all Crown land reserved. File 68120
- " 27 - " " " " " " " 181119
- " 49 (O'Connor) - " " " " " " " 181200

Islands in Lake Timagami NOT OPENED FOR STAKING.

This Township lies within THE CORPORATION OF THE IMPROVEMENT DISTRICT OF TEMAGAMI. File 176049.

Township closed to staking effective May 8 '78, Sec 387 of Mining Act.

DATE OF ISSUE

MAY 17 1978

SURVEYS AND MAPPING
BRANCH

STRATHY TP. M.596

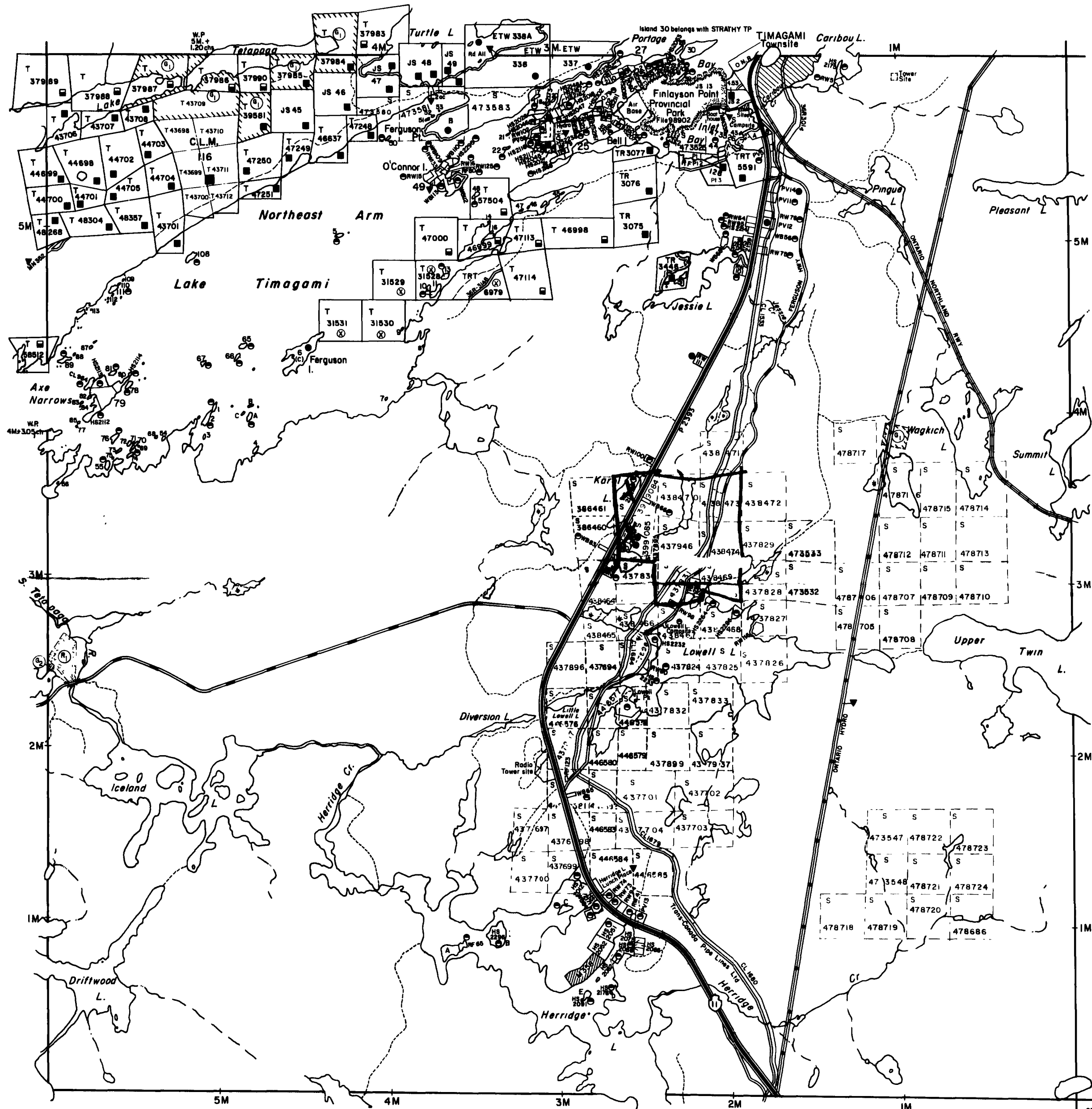

LAW TP. M.529

SE CORNER co-ordinates
LAT 46°58'20" APPROX
DEP 79°45'20"

LEGEND

- HIGHWAY AND ROUTE No.
- OTHER ROADS
- TRAILS
- SURVEYED LINES
- TOWNSHIPS, BASE LINES, ETC.
- LOTS, MINING CLAIMS, PARCELS, ETC.
- UNSURVEYED LINES
- LOT LINES
- PARCEL BOUNDARY
- MINING CLAIMS ETC
- RAILWAY AND RIGHT OF WAY
- UTILITY LINES
- NON-PERENNIAL STREAM
- FLOODING OR FLOODING RIGHTS
- SUBDIVISION
- ORIGINAL SHORELINE
- MARSH OR MUSKEG
- MINES

DISPOSITION OF CROWN LANDS

TYPE OF DOCUMENT	SYMBOL
PATENT, SURFACE & MINING RIGHTS	●
" SURFACE RIGHTS ONLY	○
" MINING RIGHTS ONLY	◐
LEASE, SURFACE & MINING RIGHTS	■
" SURFACE RIGHTS ONLY	◼
" MINING RIGHTS ONLY	◑
LICENCE OF OCCUPATION	◔
CROWN LAND SALE	C.S.
ORDER-IN-COUNCIL	OC
RESERVATION	⊙
CANCELLED	⊖
SAND & GRAVEL	⊕

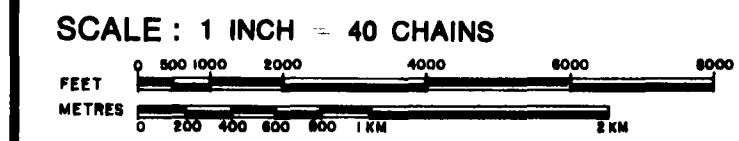

ACRES	HECTARES
40	16

TOWNSHIP
STRATHCONA
2.2680

DISTRICT
NIPISSING

MINING DIVISION
SUDBURY

Ministry of Natural Resources
Ontario Surveys and Mapping Branch

Date MAY 1978 Plan No
Whitney Block **M.595**
Queen's Park, Toronto

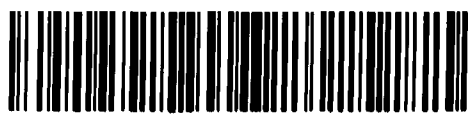

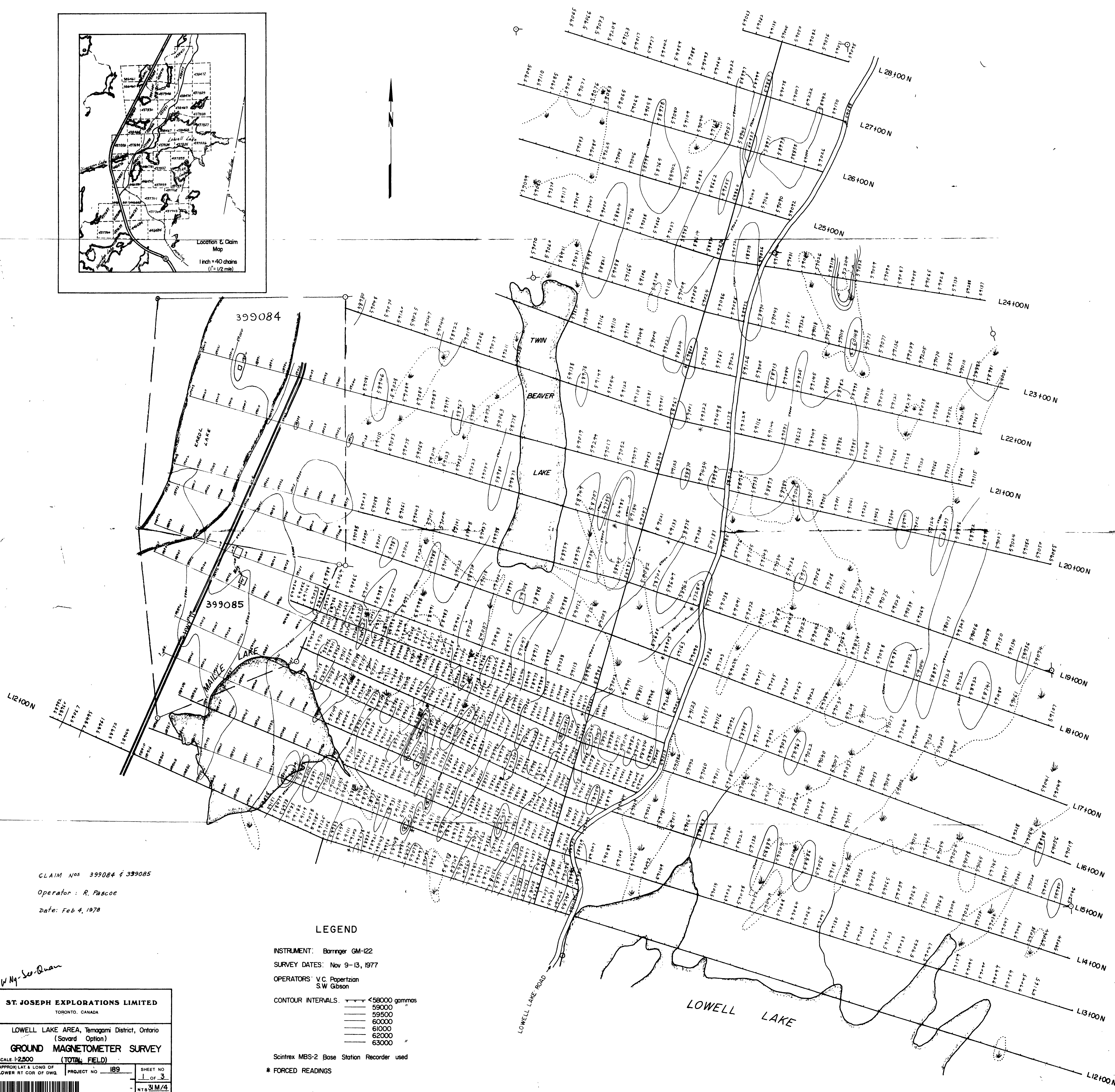
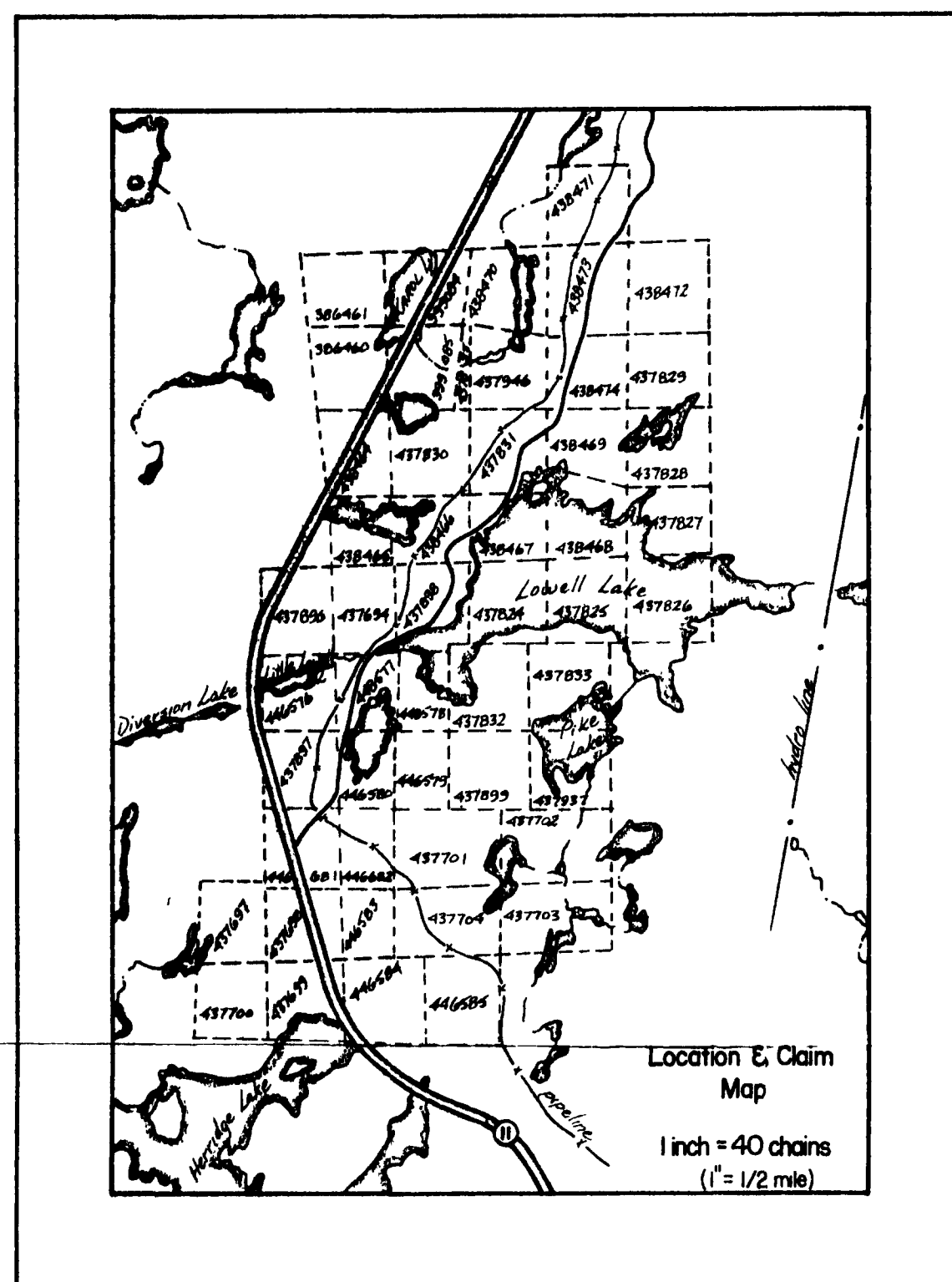

CLAIM Nos 399084 & 399085
Operator : R. Pascoe
Date: Feb 4, 1978

LEGEND

- INSTRUMENT: Barringer GM-122
SURVEY DATES: Nov 9-13, 1977
OPERATORS: V.C. Papertzion
SW Gibson
- CONTOUR INTERVALS.
- < 58000 gammas
 - 59000
 - 59500
 - 60000
 - 61000
 - 62000
 - 63000
- Scintrex MBS-2 Base Station Recorder used
* FORCED READINGS

ST. JOSEPH EXPLORATIONS LIMITED
TORONTO, CANADA

LOWELL LAKE AREA, Temagami District, Ontario
(Savard Option)
GROUND MAGNETOMETER SURVEY

SCALE: 1:2500 (TOTAL FIELD)
APPROX. LAT. & LONG. OF LOWER RT. COR. OF DWG. PROJECT NO. 189 SHEET NO. 1 OF 3
NTS 3M/4